



Contents [[hide](#)]

- [1 CUBE 93517 FPILink for Computer Adapter Navigation](#)
- [2 Product Information](#)
- [3 Usage Instructions](#)
- [4 GENERAL](#)
- [5 SAFETY INSTRUCTIONS FOR ACCESSORIES](#)
- [6 Components](#)
- [7 Installation Instructions](#)
- [8 CLEANING AND CARE](#)
- [9 OTHER INFORMATION](#)
- [10 FAQ](#)
- [11 Documents / Resources](#)
 - [11.1 References](#)



CUBE 93517 FPILink for Computer Adapter Navigation



Product Information

- The product user manual provides important information on assembly, initial operation, maintenance, cleaning, and disposal of the product.
- It includes safety instructions to prevent accidents and injuries.

Usage Instructions

- Read all enclosed instructions carefully before assembling the product. Ensure to follow the safety guidelines provided in the manual during the assembly process.
- Before using the product, make sure to read and understand the safety instructions for operation. Follow all guidelines to prevent accidents or damage.
- Regular maintenance is essential for the product's longevity. Follow the maintenance instructions provided in the manual to prevent malfunctions due to wear or loose connections.
- Use water and a mild detergent with a soft cloth for cleaning the product. Improper handling of cleaning agents can cause damage, so follow the cleaning instructions carefully.
- Ensure all parts are completely dry before storing the product to prevent any damage. Proper storage helps maintain the product's condition for longer use.
- Dispose of the product packaging properly by separating materials for recycling. Follow the disposal instructions provided in the manual for environmentally friendly

practices.

GENERAL

READ AND KEEP THE MANUAL

- This and other accompanying instructions contain important information on the assembly, initial operation, and maintenance of the product.
- Read all enclosed instructions carefully before assembling or using the product, especially the general safety instructions. Non-observance of this manual may result in serious injury or damage to the product itself and your vehicle. Keep the enclosed instructions close to hand for further use. If you pass on the product or the vehicle equipped with the product to a third party, always include all accompanying instructions.
- The enclosed instructions are subject to European legislation. If the product or vehicle is delivered outside Europe, the manufacturer/importer may have to provide additional instructions.

EXPLANATION OF SYMBOLS

- The following symbols and signal words are used in the enclosed instructions, on the product or on the packaging.

WARNING!





-  A medium risk of hazard which may result in death or serious injury if not avoided.

CAUTION!

-  A low risk of hazard which may result in moderate or minor injury if not avoided.

NOTICE!

Warning of possible damage to property.

-  Useful additional information for assembly or operation.
-  Read and observe the enclosed instructions.
-  Reference to further documentation – See instructions (Doc. – Number)
-  Use a torque wrench. Use the torque values indicated in the symbol.

SAFETY INSTRUCTIONS FOR ACCESSORIES

WARNING!

Risk of accident and injury!

- Read all safety notes and instructions. Failure to observe the safety instructions and instructions can cause accidents, serious injury and damage.

Safety instructions for assembly

- The pull system is attached under the saddle.
- Before going uphill, you should stop to attach the rope to the stem of the towed bicycle.
- The pull system must not be used on carbon saddles or seat posts.
- Before assembly, check the scope of delivery of the product for completeness.
- Before assembly, check all components of the product and the vehicle for damage, sharp edges or burrs.
- If the scope of delivery for the product is not complete or if you notice any damage, sharp edges or burrs on the product, components or vehicle, do not use it.
- Have the product and the vehicle checked by your dealer.
- Use only parts and accessories intended for the product. Components from other manufacturers may affect optimal function.
- If you intend to combine this product with vehicles of other manufacturers, be sure to check their specifications and check dimensional accuracy and compatibility according to the instructions in the enclosed manuals and the owner's manual of your vehicle.
- Screw connections must be tightened correctly with a torque wrench and with correct

torque values.

- If you are not experienced in using a torque wrench or do not have a suitable torque wrench, have loose screw connections checked by your dealer.
- Note special torques for components made of aluminium or carbon fiber reinforced polymer.
- Please also read and follow the operating instructions of your vehicle.

Safety Instructions for Operation

Please note that accessories can have a significant influence on the characteristics of the vehicle. Adapt your riding style to the changed riding characteristics.

- If you are not absolutely sure or if you have questions, please contact your dealer.
- Before first use or installation, a compatibility check between the computer and the holder is essential to ensure safe use.
- In particular, the clearance between the computer and the handlebars must also be checked; the computer must not touch the handlebars under any circumstances
- When using a computer mount, the bike computer must also be secured to the handlebars or stem with a special safety strap from the respective manufacturer. This minimises the risk of damage in the event of a fall or external impact and the associated loosening of the computer from the mount
- Consequential damage resulting from failure to observe the above instructions will not be recognised by us as a defect
- The range of use of the bike always changes to use category 2.
- The enclosed instructions cannot cover every possible combination of the product with all vehicle models.

Safety instructions for maintenance

Prevent malfunctions due to excessive wear, material fatigue or loose screw connections:

- Check the product and your vehicle regularly.
- Do not use the product and your vehicle if you notice excessive wear or loose screw connections.
- Do not use the vehicle if you notice cracks, deformation or color changes.
- Have the vehicle inspected immediately by your dealer if you notice excessive wear,

loose screw connections, deformation, cracks or color changes.

Components

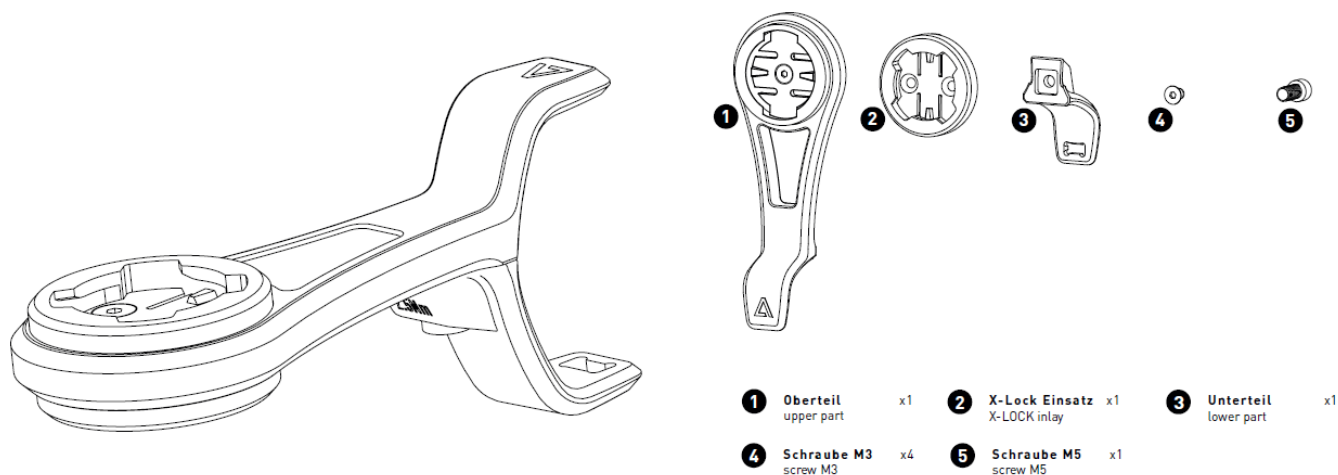

Installation Instructions

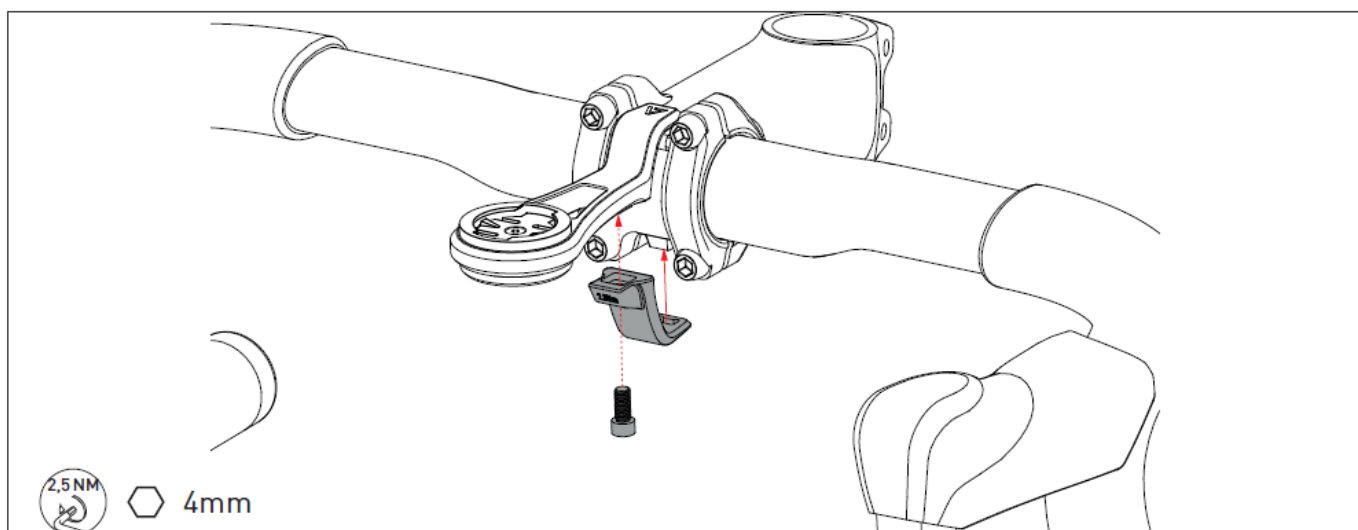
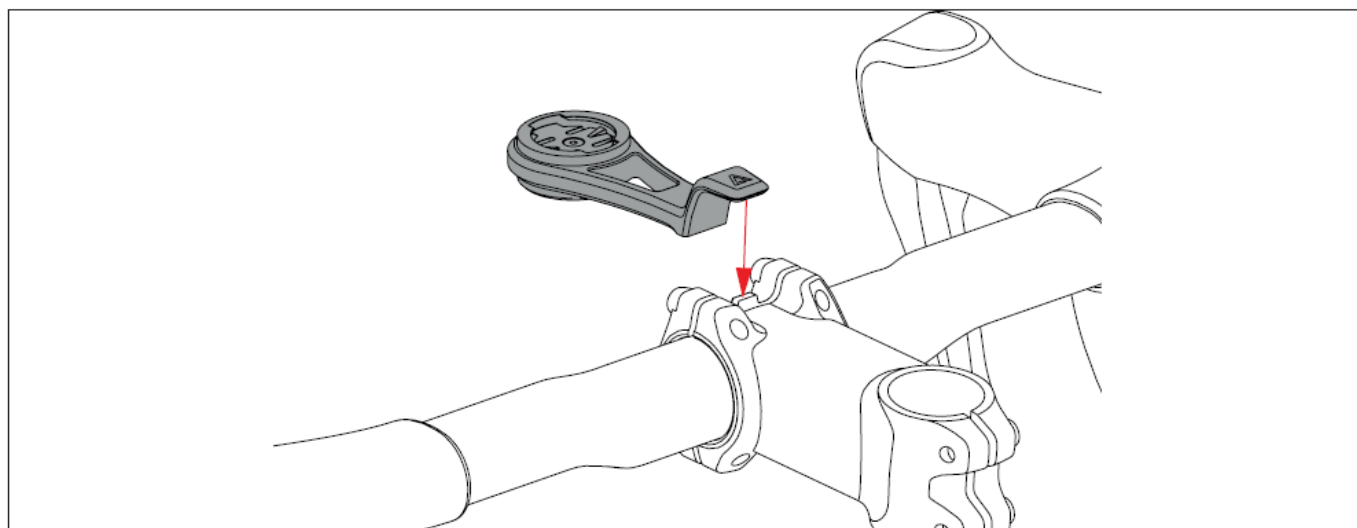

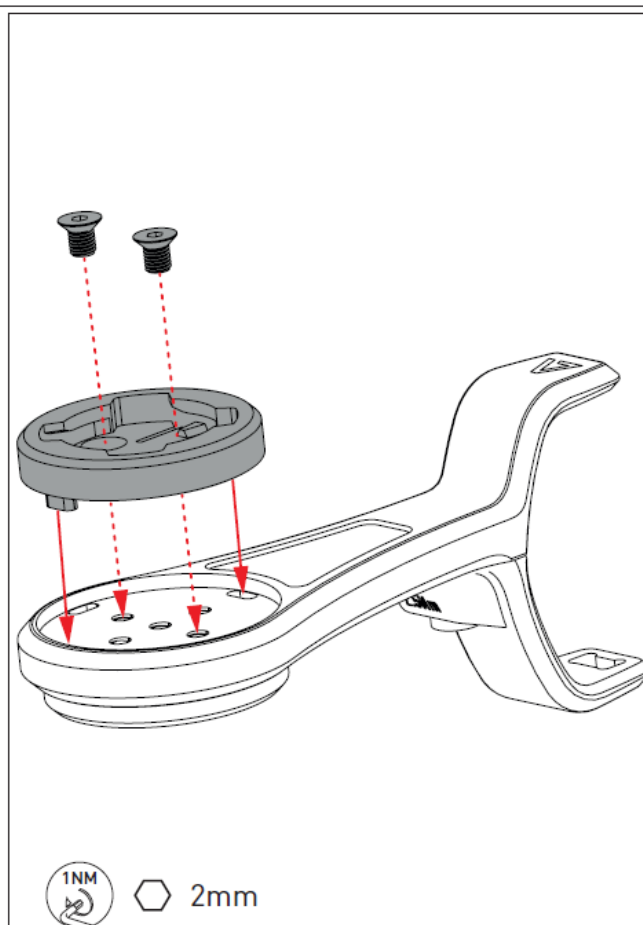
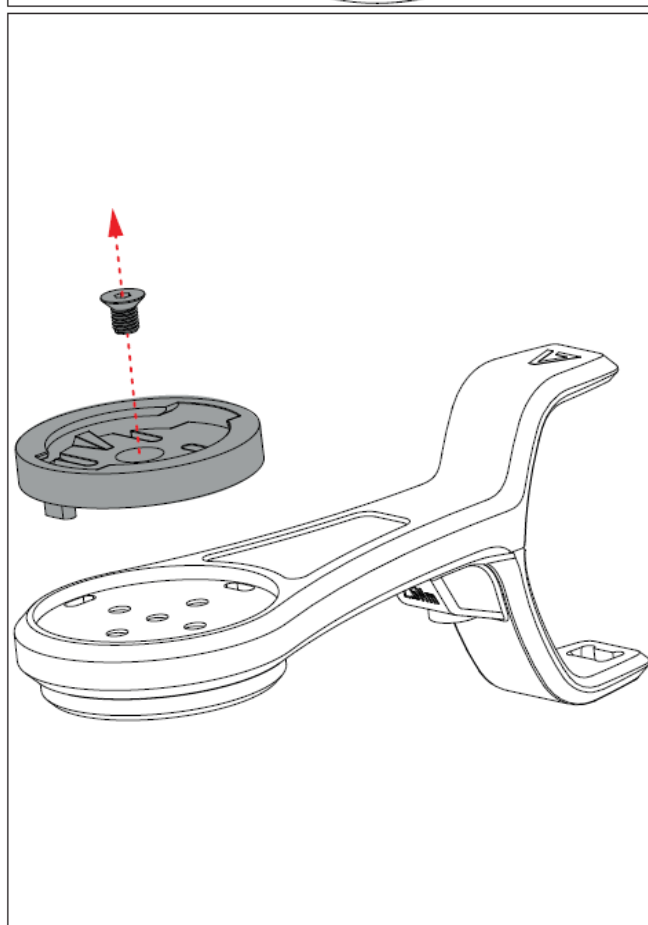
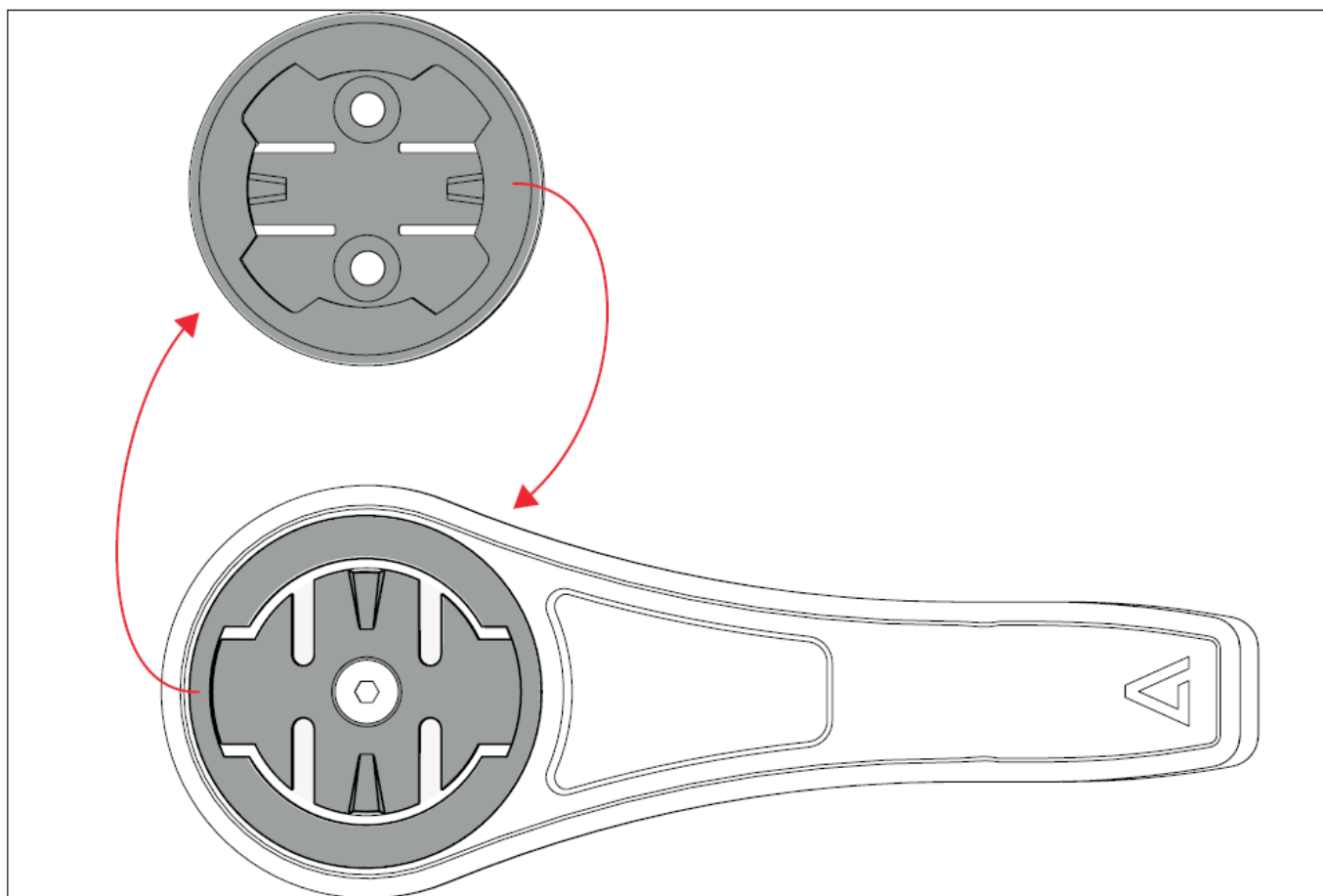

1NM 2mm

CLEANING AND CARE

NOTICE!

Risk of damage!

- Improper handling of cleaning agents can cause damage to the product.
- Do not use aggressive cleaning agents, brushes with metal or nylon bristles or sharp or metallic cleaning objects such as knives, hard spatulas and the like. These can damage the surfaces and the product.
- Clean the product regularly with water (add a mild detergent if necessary) and a soft cloth.

STORAGE

All parts must be completely dry before storage.

- Always store the product in a dry place.
- Protect the product from direct sunlight.

DISPOSAL

- Dispose of the packaging according to its type. Add cardboard and cartons to your waste paper collection, and films and plastic parts to your recyclables collection.
- Dispose of the product in accordance with the laws and regulations valid in your country.



LIABILITY FOR MATERIAL DEFECTS

- If there are any defects, please contact the dealer from whom you purchased the product.
- In order to ensure that your complaint is processed smoothly, you must present proof of purchase and proof of inspection.
- Please keep them in a safe place.
- To ensure a long service life and durability of your product or your vehicle, you may only use it in accordance with its intended purpose. You must observe the information in the operating instructions of your vehicle.
- Furthermore, the installation instructions (especially torques for screws) and the

prescribed maintenance intervals must be observed.

OTHER INFORMATION

Please visit us occasionally on our website at www.CUBE.eu. There you will find news, information and the latest versions of our manuals as well as the addresses of our specialist dealers.

- Pending System GmbH & Co. KG
- Ludwig-Hüttner-Str. 5-7
- D-95679 Waldershof
- +49 (0)9231 97 007 80
- www.cube.eu

FAQ

Q: What should I do if I lose the user manual?

A: In case of losing the user manual, you can contact the manufacturer, Pending System GmbH & Co. KG, for a replacement copy or check their website for digital versions.

Q: How often should I perform maintenance on the product?

A: Regular maintenance is recommended to prevent malfunctions. Follow the maintenance schedule provided in the manual or based on your usage frequency.

Documents / Resources



[CUBE 93517 FPILink for Computer Adapter Navigation \[pdf\]](#) Instruction Manual
93517, 93517 FPILink for Computer Adapter Navigation, FPILink for Computer Adapter Navigation, Computer Adapter Navigation, Adapter Navigation

References

- [User Manual](#)

■ CUBE

◆ 93517, 93517 FPILink for Computer Adapter Navigation, Adapter Navigation, Computer Adapter Navigation, Cube, FPILink for Computer Adapter Navigation

Leave a comment

Your email address will not be published. Required fields are marked *

Comment *

Name

Email

Website

☐ Save my name, email, and website in this browser for the next time I comment.

Post Comment

Search:

e.g. whirlpool wrf535swhz

Search

[Manuals+](#) | [Upload](#) | [Deep Search](#) | [Privacy Policy](#) | [@manuals.plus](#) | [YouTube](#)

This website is an independent publication and is neither affiliated with nor endorsed by any of the trademark owners. The "Bluetooth®" word mark and logos are registered trademarks owned by Bluetooth SIG, Inc. The "Wi-Fi®" word mark and logos are registered trademarks owned by the Wi-Fi Alliance. Any use of these marks on this website does not imply any affiliation with or endorsement.