



## CTA PAD-LEDPARAF Premium Floor Stand with LED Light Add-On Instruction Manual

[Home](#) » [CTA](#) » CTA PAD-LEDPARAF Premium Floor Stand with LED Light Add-On Instruction Manual 



Premium Floorstand with LED  
Light Add-On for 9-11" Tablets  
**PAD-LEDPARAF**  
INSTRUCTION – MANUAL

**Contents**

- 1 PAD-LEDPARAF Premium Floor Stand with LED Light Add-On
- 2 INSTALLATION:
- 3 Documents / Resources
  - 3.1 References

**PAD-LEDPARAF Premium Floor Stand with LED Light Add-On**

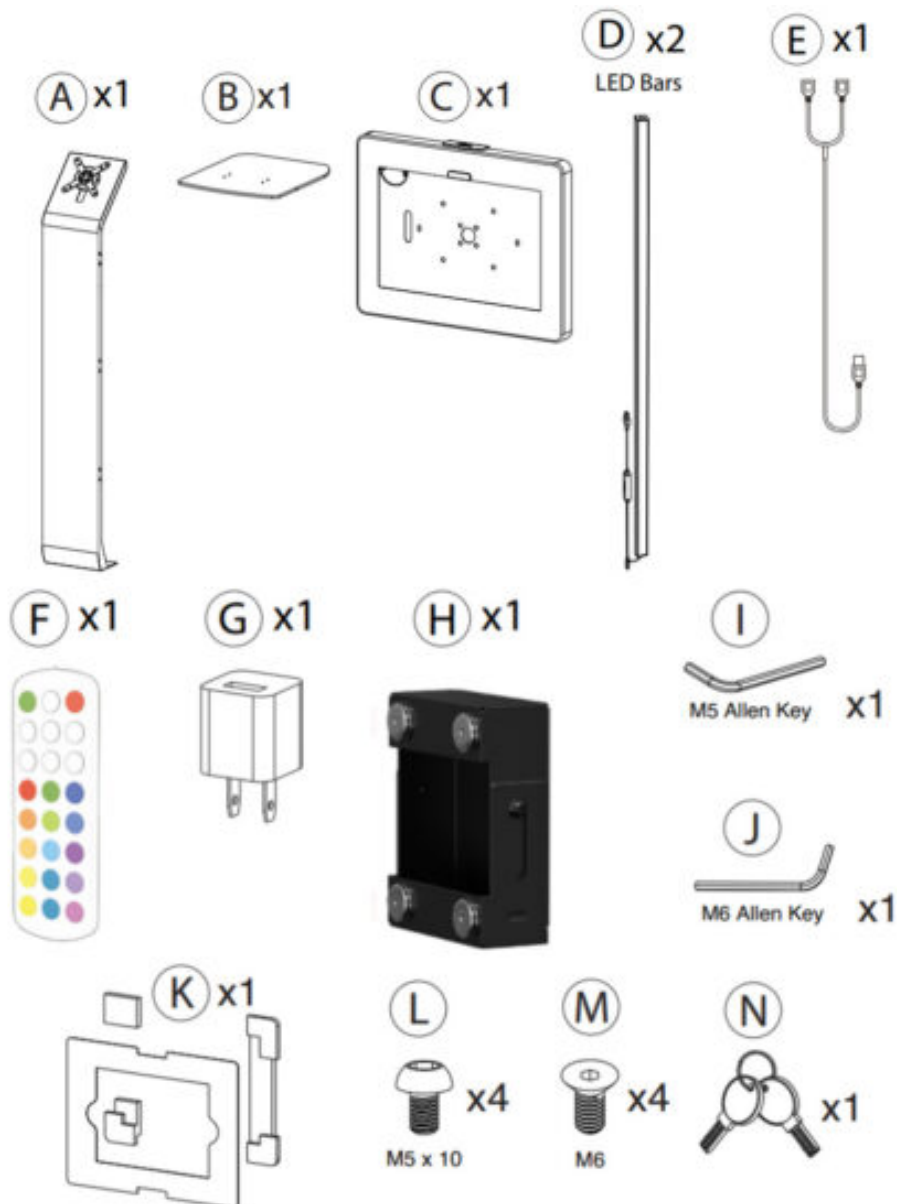

**INSTALLATION:**

**1. Assembling floorstand base:**

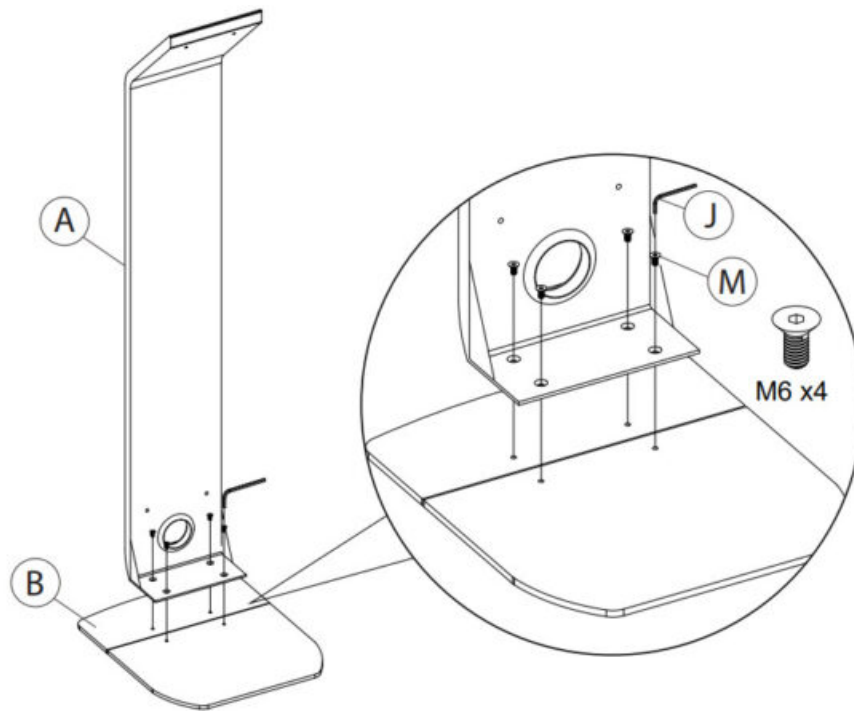

1A. Align the holes on the stand (A) with holes on the base (B) and turn in screws (M) with provided allen tool (J) until securely tightened. Shown above.

## 2. Cable routing:

2A. To route a charge cable through the stand, attach the weighted pendant to your charge cable, then pass through the cutout at the top of the stand.

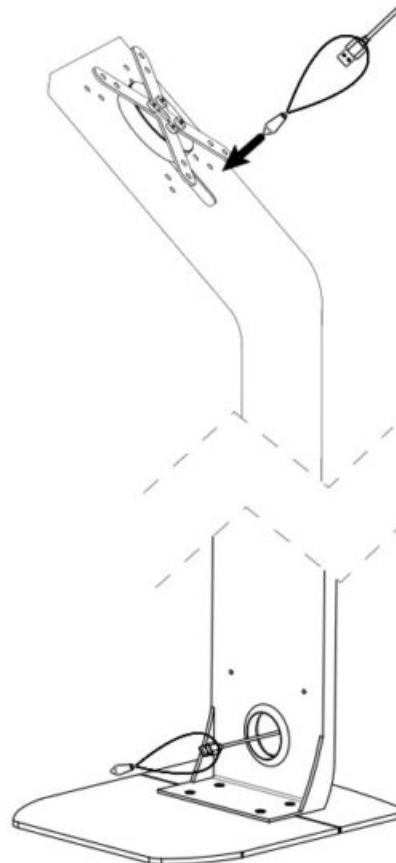

2B. When the cable reaches the bottom of the stand, pull through the hole at the stand back and remove the weighted pendant as shown.

## 3. Attaching enclosure to VESA plate:

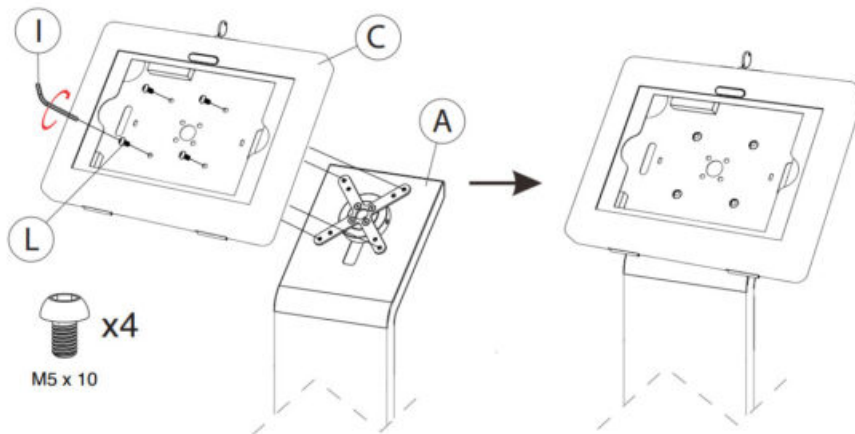

3A. Align enclosure (C) VESA holes to VESA plate holes in stand (A) and from the front of enclosure turn in screws (L) into the threaded VESA holes with provided allen tool (I) until securely thightened. Shown above.

#### 4. Inserting tablet into enclosure:

\*\*Tablet for illustration only, NOT INCLUDED

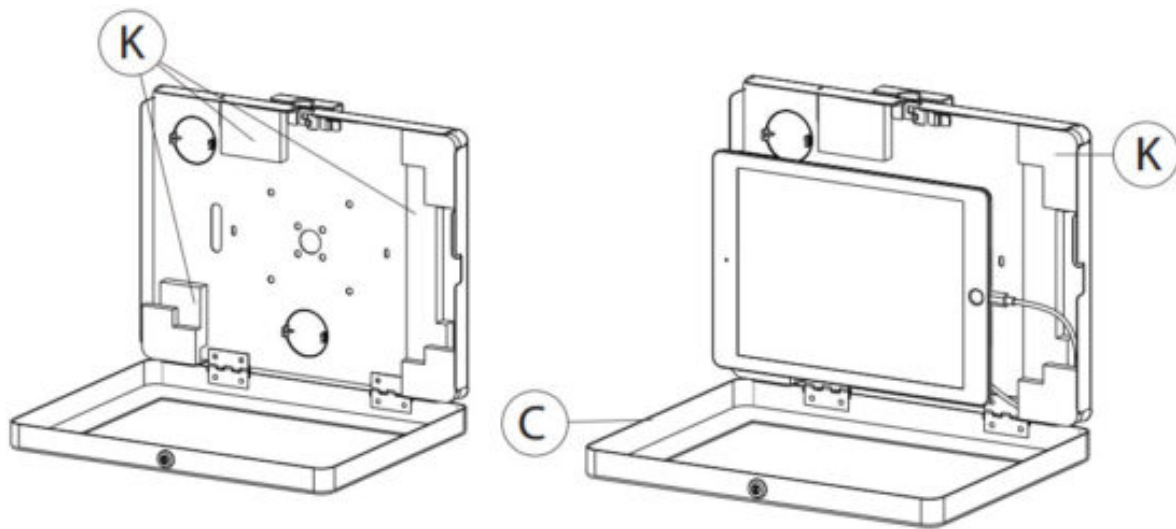

4A. Find the appropriate size foam padding (K) for the tablet you wish to use.

Make sure device is compatible for the enclosure. if having power/data cord attached to tablet, slide it through the back of the foam as shown and out the opening in the back.

#### 5. Optional – Placing blank sheet insert into enclosure:

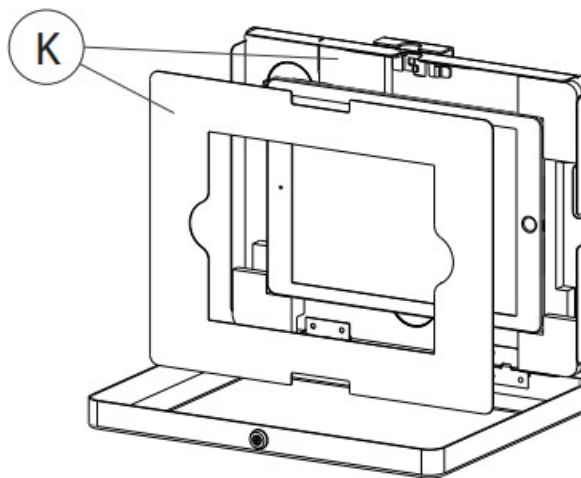

5A. Lay-in correct masking insert from bundle (K) as needed the correct fitted look for your device.

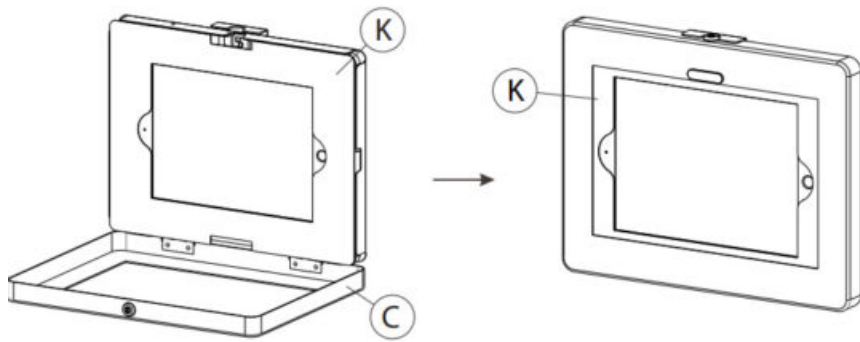

5B. Close and lock enclosure afterwards and you're set

**6. Removing back covers:**

\*\*Tablet for illustration only,

**NOT INCLUDED**

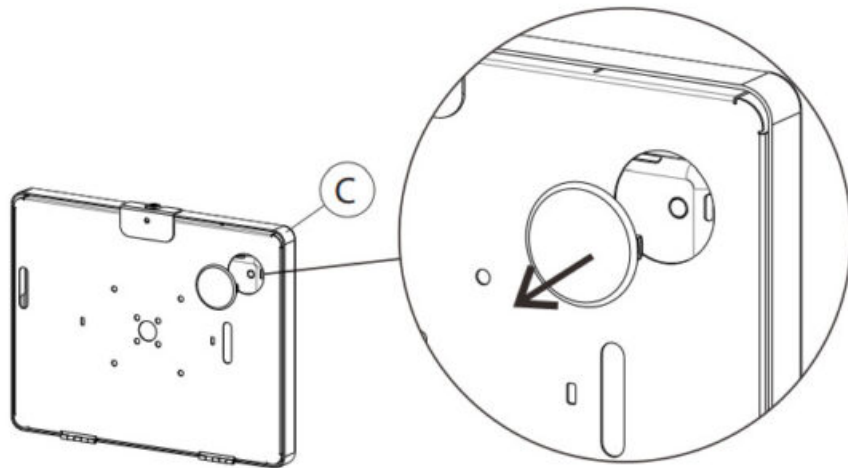

6A. When installing device into enclosure (C), identify where the camera is. Then simply remove and pop out the cover prior to mounting or setting up tablet to properly expose camera.

**7. Setting up security:**

\*\*Tablet for illustration only,

**NOT INCLUDED**

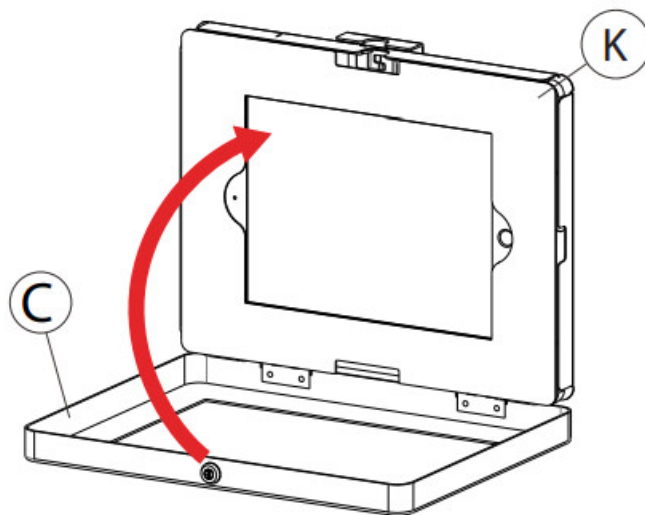

7A. Once the tablet device is set up, close the front lid of the enclosure (C).

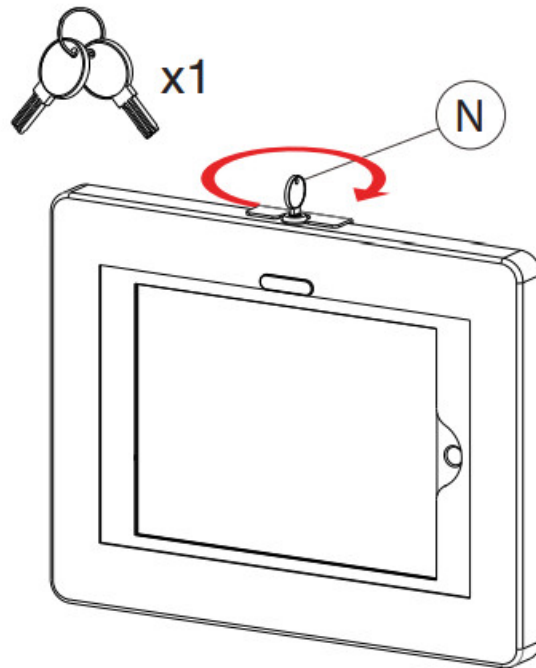

7B. Insert the key (N) in the keyhole on top of enclosure, and turn clockwise to lock the enclosure in place.

#### 8. Setting Up LED Bar:

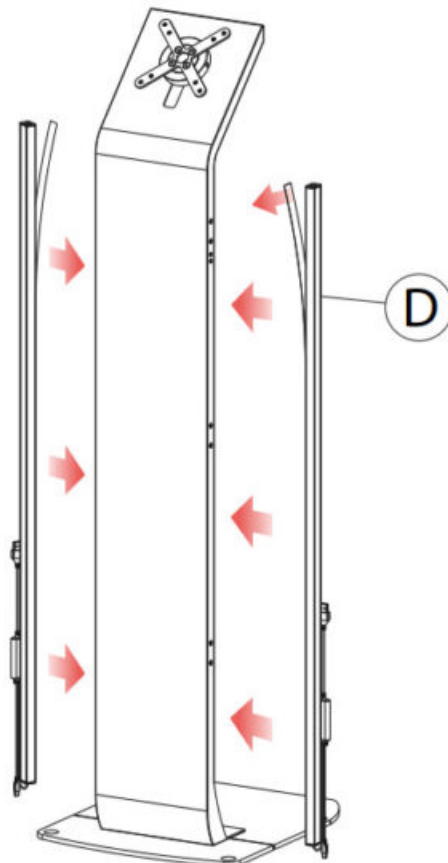

1A. Peel off the 3M adhesive sticker on the back of the LED light bar (D) as illustrated. Attach the LED bar onto the edge of the CTA floor stand with the wire end on the bottom side. Repeat same steps for the LED bar on the other side of the floor stand.

#### 9. Attaching Wire Storage Component:

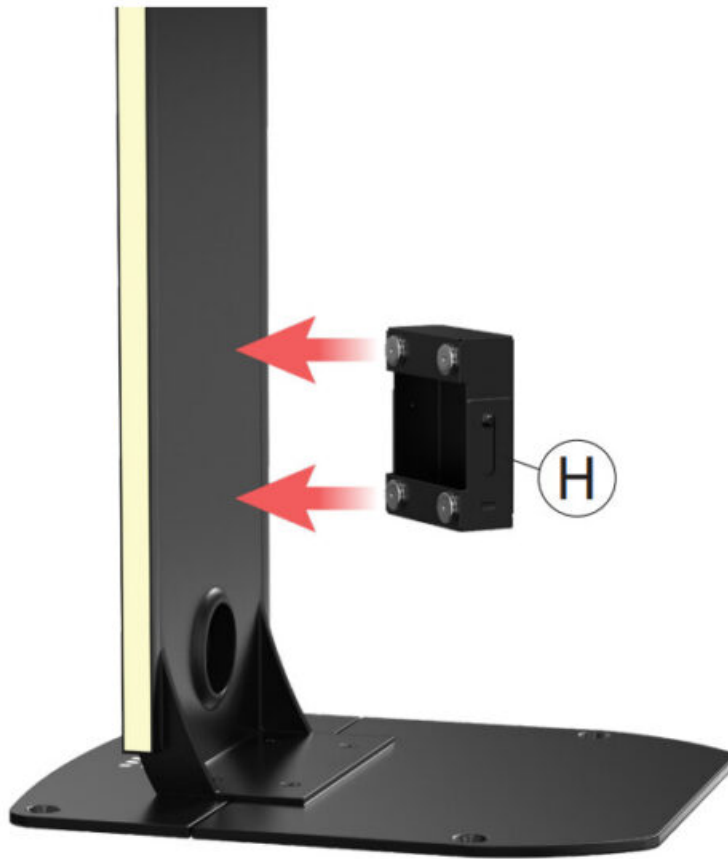

2A. Take the cable storage (H) and magnetically affix onto the backside of the floor stand as illustrated above. Be sure to have the openings at the bottom side when orienting storage component .

#### 10. Cable Routing and Cable Management:

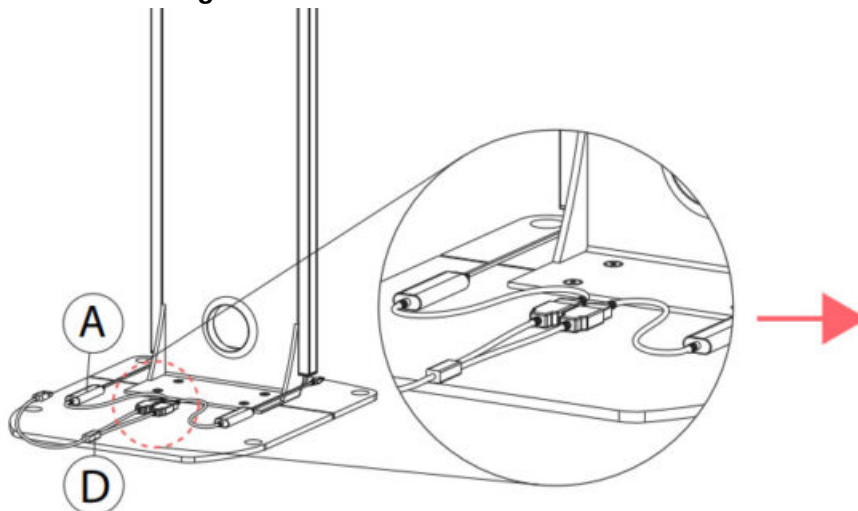

10A. Take the cables attached to the LED (A) and attach them to the bottom half power cable (B) via USB connection.

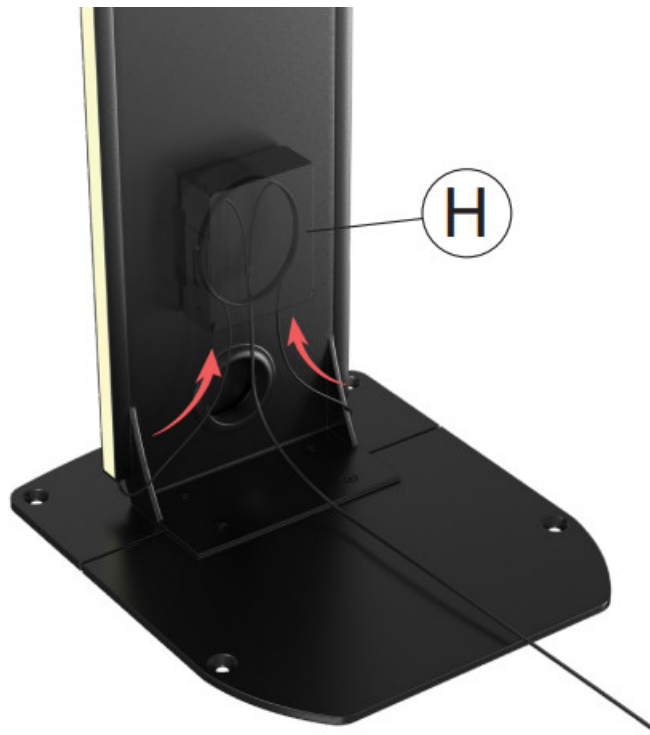

10B. Route all the cables into the cable storage component (E) as illustrated.

### 11. Cable Routing and Cable Management

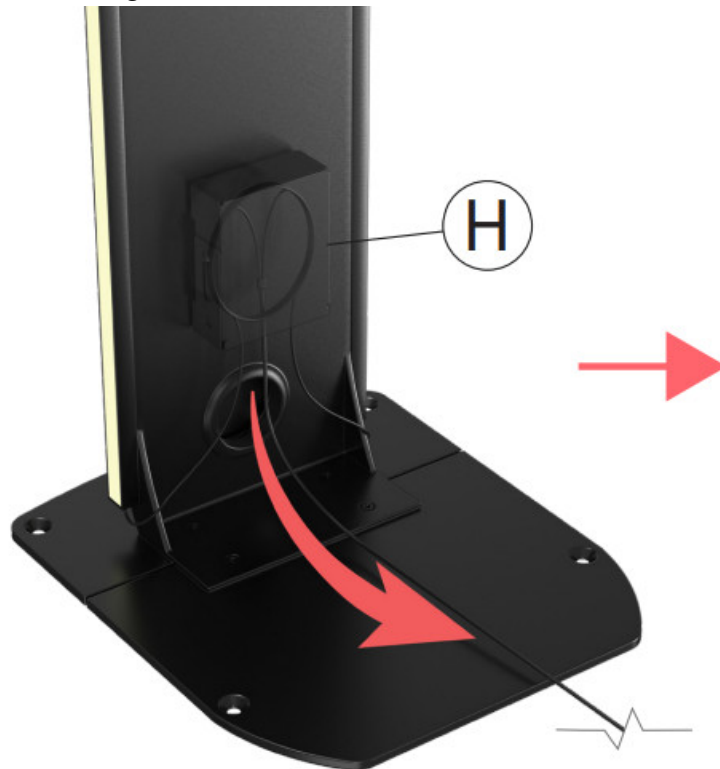

11A. Route the power cable out the bottom of the cable storage (H)



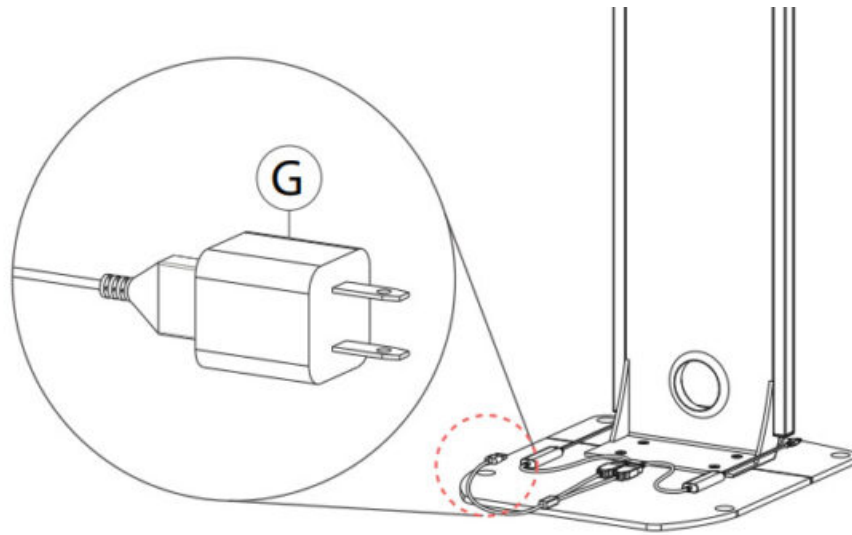

11B. Attach the power adapter (D) to the end of the cable as illustrated. Then plug into power source as needed.



36 Taaffe Place Brooklyn, NY 11205



[support@ctadigital.com](mailto:support@ctadigital.com)



[718-963-9845](tel:718-963-9845)



[www.ctadigital.com](http://www.ctadigital.com)

## Documents / Resources

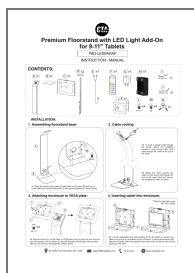

[CTA PAD-LEDPARAF Premium Floor Stand with LED Light Add-On](#) [pdf] Instruction Manual  
PAD-LEDPARAF Premium Floor Stand with LED Light Add-On, PAD-LEDPARAF, Premium Floor Stand with LED Light Add-On, Floor Stand with LED Light Add-On, Stand with LED Light Add-On, LED Light Add-On, Light Add-On, Add-On

## References

- [User Manual](#)

[Manuals+](#), [Privacy Policy](#)

This website is an independent publication and is neither affiliated with nor endorsed by any of the trademark owners. The "Bluetooth®" word mark and logos are registered trademarks owned by Bluetooth SIG, Inc. The "Wi-Fi®" word mark and logos are registered trademarks owned by the Wi-Fi Alliance. Any use of these marks on this website does not imply any affiliation with or endorsement.