



CSI Controls 1069213A CSION RF Alarm System Instruction Manual

[Home](#) » [CSI Controls](#) » CSI Controls 1069213A CSION RF Alarm System Instruction Manual 

Contents

- [1 CSI Controls 1069213A CSION RF Alarm System](#)
- [2 Electrical Warnings](#)
- [3 Included with alarm](#)
- [4 Specifications](#)
- [5 Alarm System](#)
- [6 Refer to the operation guide for a startup](#)
- [7 Documents / Resources](#)
 - [7.1 References](#)
- [8 Related Posts](#)

CSION® RF

CSI Controls 1069213A CSION RF Alarm System



Electrical Warnings

Failure to follow these precautions could result in serious injury or death. Replace the float switch immediately if the cable becomes damaged or severed. Keep these instructions with a warranty after installation. This product must be installed in accordance with National Electric Code, ANSI/NFPA 70 so as to prevent moisture from entering or accumulating within boxes, conduit bodies, fittings, float housing, or cable.

Included with alarm

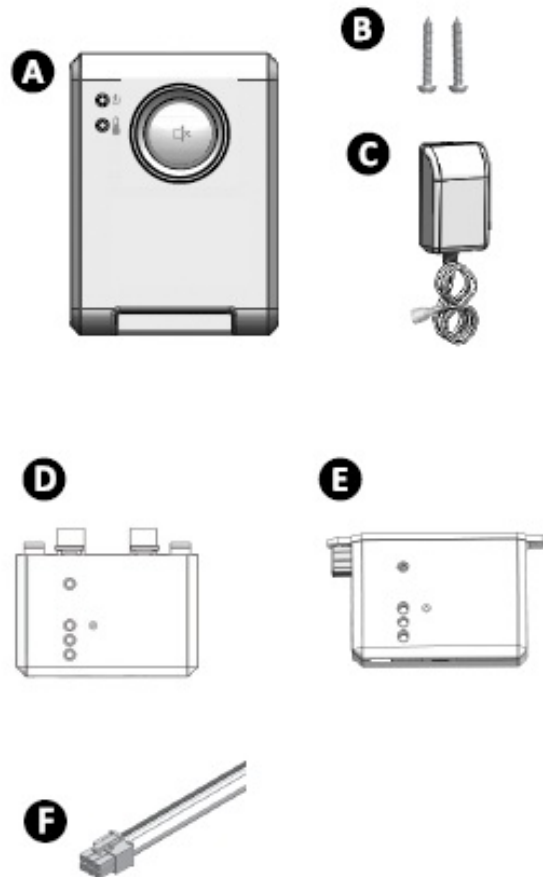

Specifications

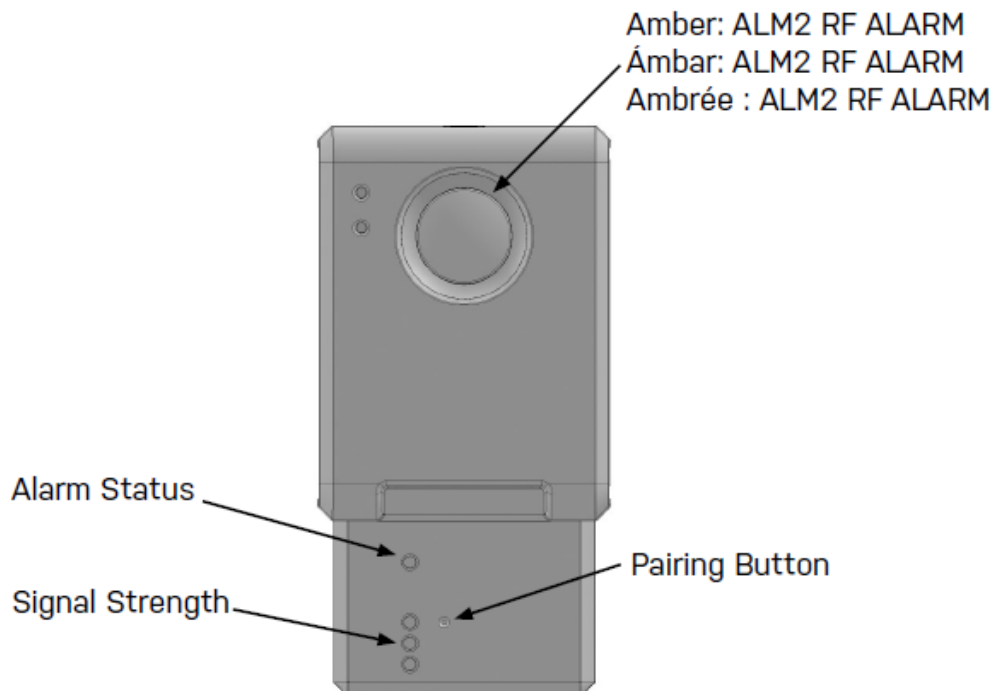

Use this product only with the USB power supply provided.

Alarm System

Installation Instructions

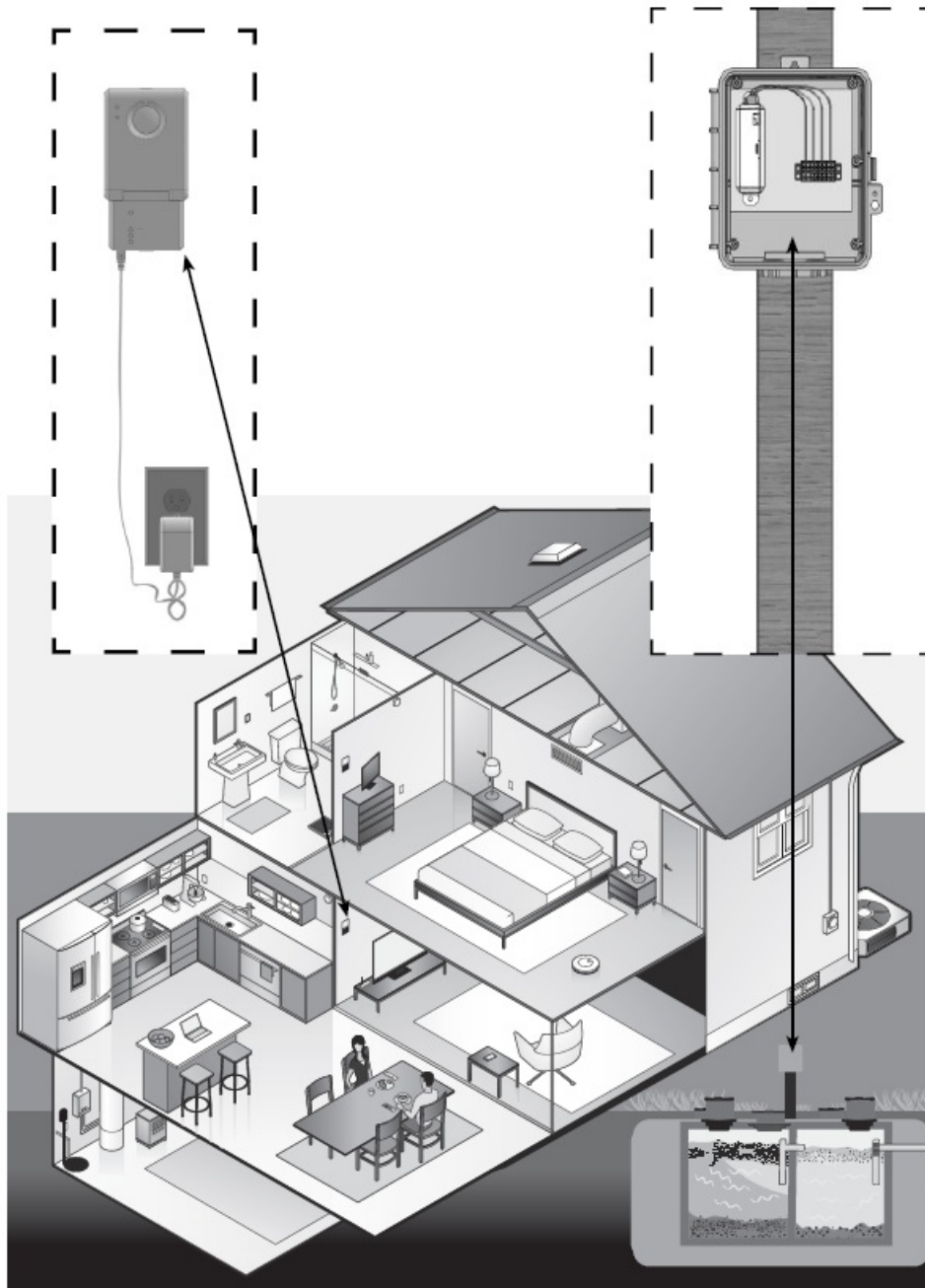

Panel Installation

Install the panel module securely in a 4X rated enclosure.

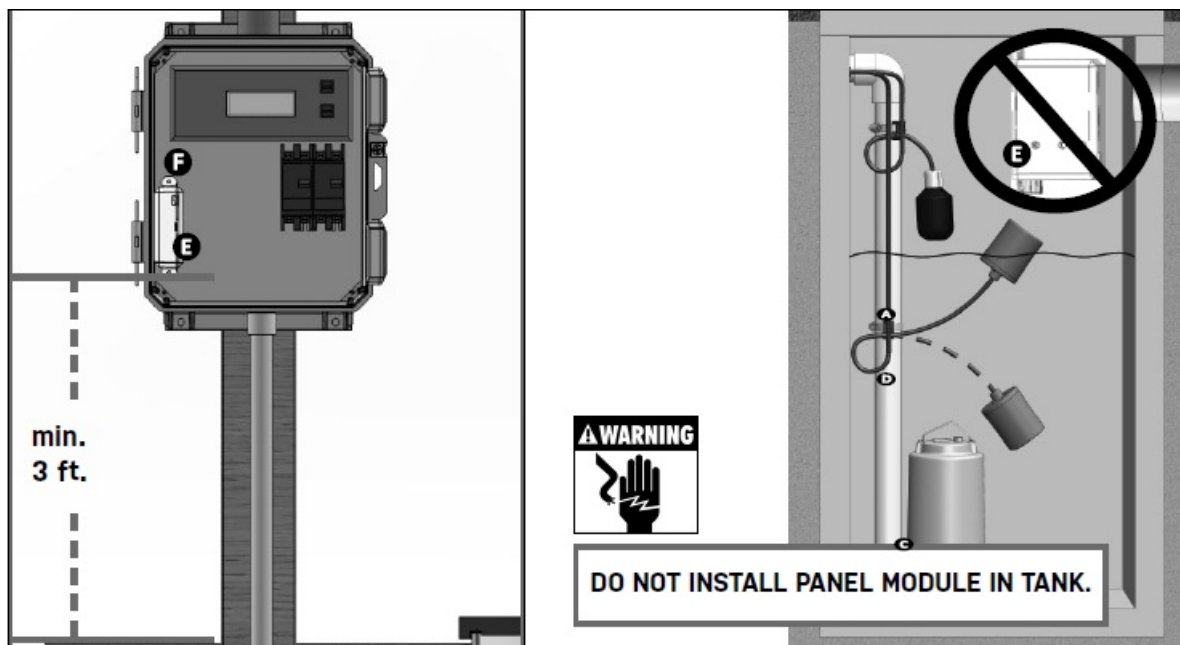

4X Installation

Securely mount 4X enclosure. Refer to the schematic for the wiring panel module.

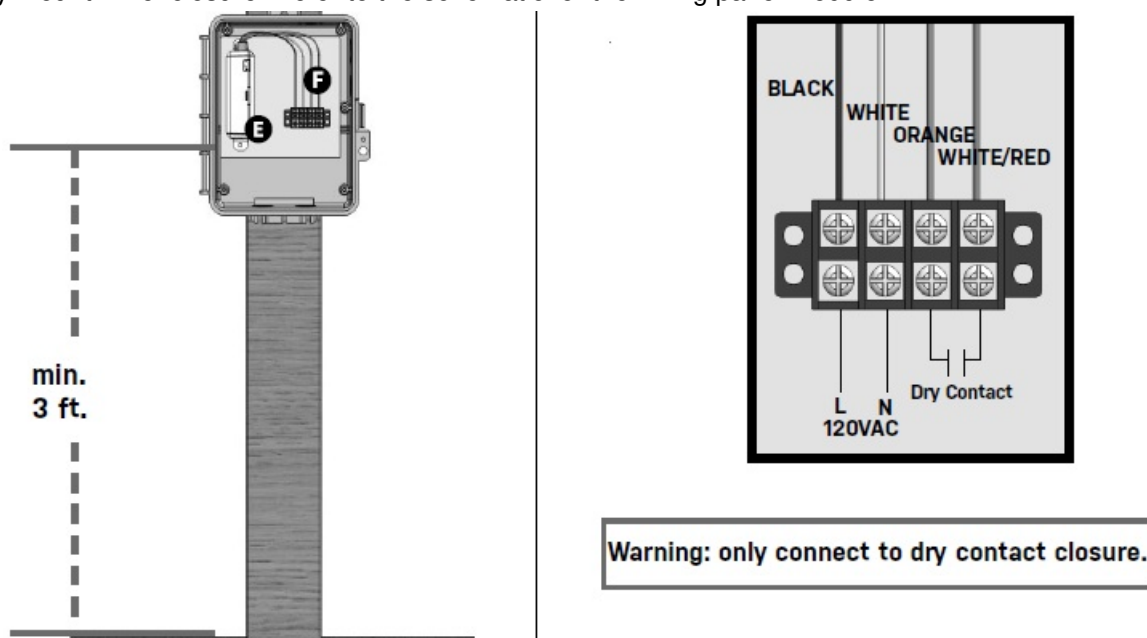

Remove CSION® alarm cover. Insert the alarm module into the USB port. Mount alarm (indoor only) using a keyhole on the back of the unit.

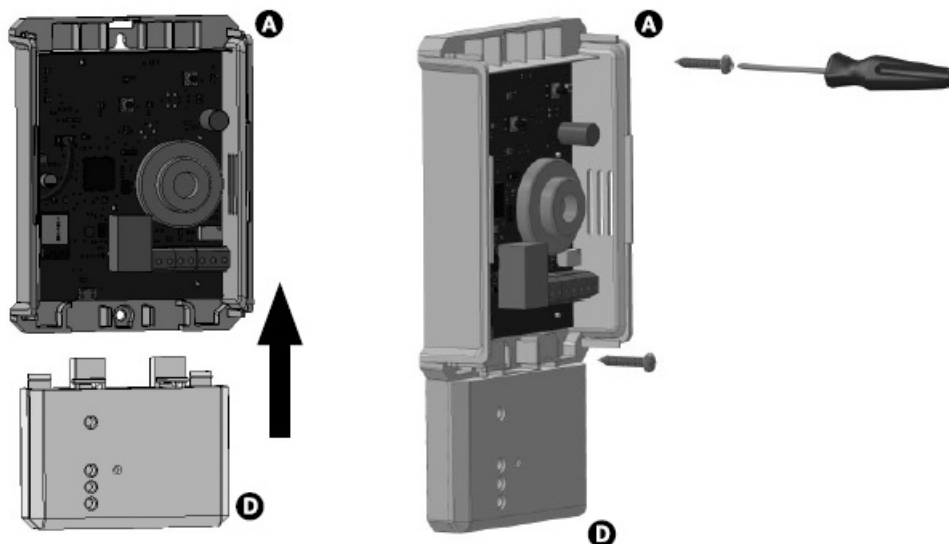

Replace the cover and connect the USB power cable. Refer to CSION® alarm instructions for float switch installation, battery backup, and operation.

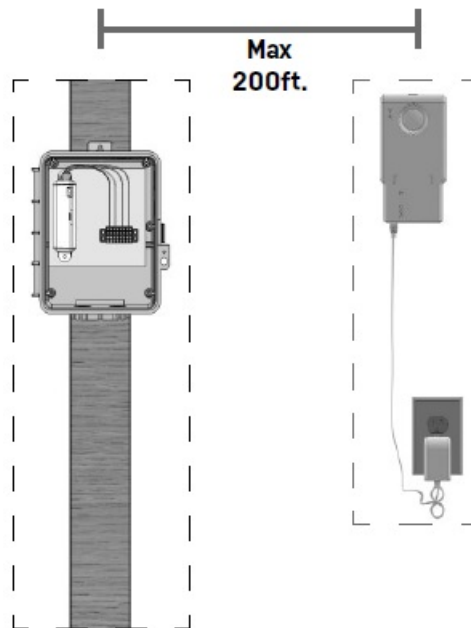

Test alarm weekly to insure proper operation.

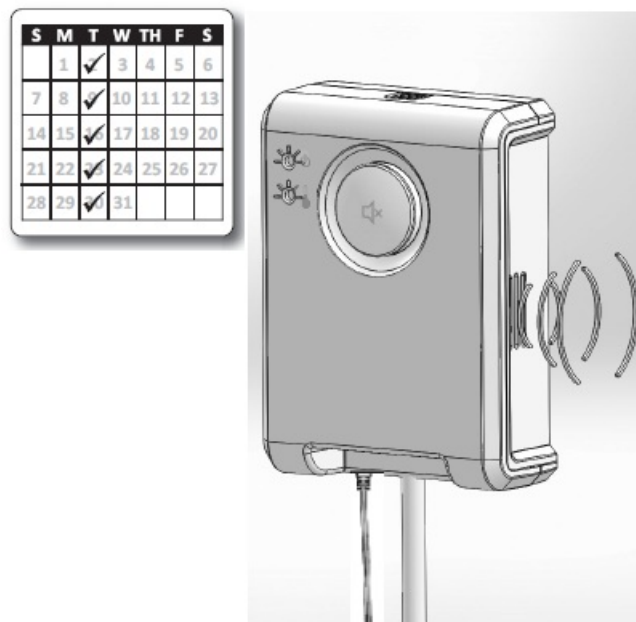

Refer to the operation guide for a startup

CSION® RF Alarm Operation Guide

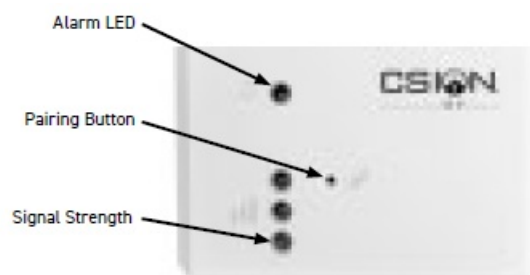

Step 1: Installation

Mount and wire the alarm according to the installation instructions. The maximum distance between modules should be 200ft.

Step 2: Signal Strength Check

Press the pairing button for 1 second on the panel module to enter setup mode for fast signal strength updates. Reposition the indoor module until 1 or more signal LEDs are illuminated green.

Step 3: Test Alarm

Verify the alarm is functioning by triggering an alarm condition on the outdoor panel and verify the indoor CSION® alarm is alarming. Alarm LED on CSION® RF and CSION® alarms will illuminate amber in color when alarming and the audible alarm will sound. For CSION® WiFi alarm units, verify a text or email notification of alarm was received.

Monthly Testing

Verify at least 1 or more signal LEDs are illuminated green monthly and repeat step 3 as you are able.

Documents / Resources

	<p>CSI Controls 1069213A CSION RF Alarm System [pdf] Instruction Manual 1069213A, CSION RF, Alarm System, CSION RF Alarm System, 1069213A CSION RF Alarm System</p>
---	---

References

-  [Home - CSI Controls](#)