

 CS TECHNOLOGIES
CS TECHNOLOGIES
CS8101 25kHz
Proximity Mullion
Reader



CS TECHNOLOGIES CS8101 25kHz Proximity Mullion Reader Installation Guide

[Home](#) » [CS TECHNOLOGIES](#) » CS TECHNOLOGIES CS8101 25kHz Proximity Mullion Reader Installation Guide



Contents

- [1 CS TECHNOLOGIES CS8101 25kHz Proximity Mullion Reader](#)
- [2 Product Usage Instructions](#)
- [3 Specifications](#)
- [4 Regulatory Information](#)
- [5 FCC](#)
- [6 INSTALLATION GUIDE](#)
- [7 Maintenance](#)
- [8 Warranty](#)
- [9 Documents / Resources](#)
 - [9.1 References](#)
- [10 Related Posts](#)



CS TECHNOLOGIES CS8101 25kHz Proximity Mullion Reader



Specifications:

- Output protocols Supported
- Card formats Power and Current consumption
- Read range Operating temperature
- Relative humidity Reader dimensions
- Status LED Audible tone Colour finish
- IP rating

Product Usage Instructions

Disassembly:

1. Use fingers to squeeze the reader cover.
2. Pull the cover from the top of the reader.

Note: DO NOT use a screwdriver or other implement to remove the cover. Incorrect removal may damage the LED and void the warranty.

Mounting:

1. If necessary, use the provided drilling template to drill holes.
2. The mounting screw size is #3 gauge.

Note: Be careful of cables when drilling. For installation on a standard electrical gang box, a universal mounting adaptor plate can be used. Contact CS for more information.

Wire Connection:

1. Connect the power wires to the designated point.
2. Connect the Wiegand data wires.
3. Connect the Buzzer and LED wires.
4. Connect the 12V DC wire.

Note: Place the reader on the wall ensuring wires are not crushed to avoid warranty voiding due to damage. Hand tighten screws and ensure reader is level before final tightening. Check functionality according to application specification.

Cover Attachment:

1. After checking reader function, attach the front cover back to the reader.
2. Align the bottom of the front cover with the bottom of the reader.

Note: Make sure LED is aligned to the LED hole on the cover. Push the cover onto the reader until a click sound is heard. Replace the reader if the case is damaged.

Troubleshooting Steps:

1. Check connections.
2. Check the voltage at the reader.
3. Check the current capability of the power supply.

FAQ:

- **What is covered under the warranty?**

The Company warrants that CS Tech Branded Products are covered by a return to base warranty for defects in materials and workmanship affecting normal use for a specified period from the invoice date. The Company will repair or replace faulty products at its discretion during this period.

- **What should I do if I encounter issues with the product?**

If problems persist after troubleshooting steps, contact your distributor for technical support. Ensure connections are correct, voltage levels are adequate, and components are functioning according to specifications.

-

Drilling template

- 10mm (0.39") diameter hole for wire entry
- 2 x 3.6mm (0.14") diameter holes for mounting screws

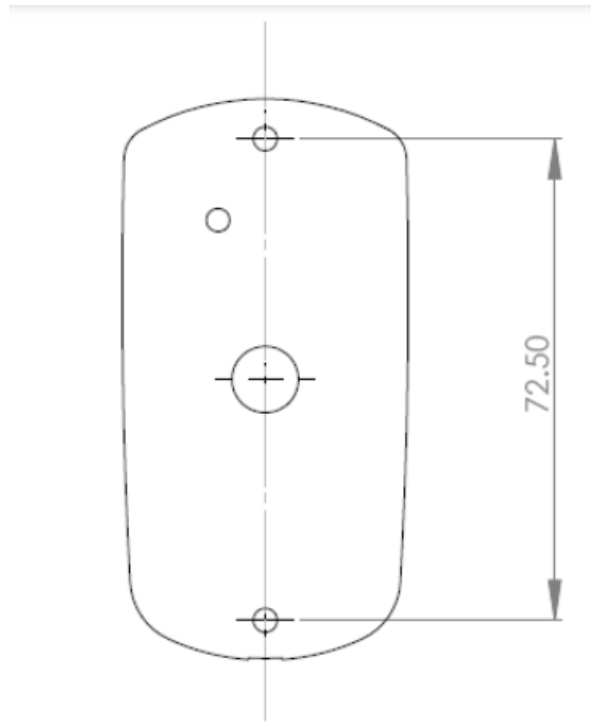

Specifications

Output protocols	Wiegand
Supported Card formats	125khz HiD, up to 37bit, plus 40bit and 52bit
Power and Current consumption	8VDC to 16VDC (nominal operating voltage 12VDC) 60mA (Average) 160mA (Peak)
Read range	20mm to 40mm (0.8" to 1.6") at 12VDC depends on the type of card used
Operating temperature	-25°C to +65°C (-13°F to +149°F)
Relative humidity	90% max, operating non-condensing
Reader dimensions	85mm(L) x 43mm(W) x 22mm(D) (3.35" x 1.69" x 0.87")
Status LED	Green & Red
Audible tone	Internal and external buzzer control
Colour finish	Charcoal
IP rating	IP65

© 2024 CS Technologies. All rights reserved.

For more information and contact details please visit, www.cs-technologies.com.au

Wiring diagram

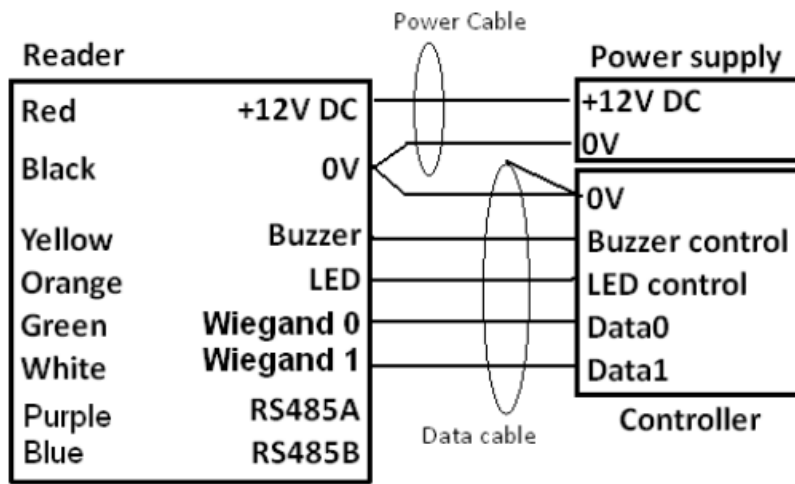

Note:

- A shielded cable is recommended to be used. The shield is connected to controller 0V reference
- Maximum wiegand data cable length: 150 meters (500 feet)
- Buzzer and LED are low activated.
- RS485 lines are disabled in this version.
- Insulate all unused wires (do not terminate).

Regulatory Information

C-Tick: This device is C-Tick complied.

CE: The device has passed all relevant tests and obtained CE approval.

FCC

FCC: This device complies with Part 15 of the FCC Rules. Operation is subject to the following two conditions:

1. This device may not cause interference and
2. This device must accept any interference, including interference that may cause undesired operation of the device.

Warning: This equipment has been tested and found to comply with the limits for a Class B digital device, pursuant to part 15 of the FCC rules. These limits are designed to provide reasonable protection against harmful interference in a residential installation. This equipment generates uses and can radiate radio frequency energy and, if not installed and used in accordance with the instructions, may cause harmful interference to radio communications. However, there is no guarantee that interference will not occur in a particular installation. If this equipment does cause harmful interference to radio or television reception, which can be determined by turning the equipment off and on, the user is encouraged to try to correct the interference by one or more of the following measures:

- Reorient or relocate the receiving antenna.
- Increase the separation between the equipment and receiver.
- Connect the equipment into an outlet on a circuit different from that to which the receiver is connected.
- Consult the dealer or an experienced radio/TV technician for help.

INSTALLATION GUIDE

Disassemble

1. Use fingers to squeeze the reader cover
2. Pull the cover from the top of reader

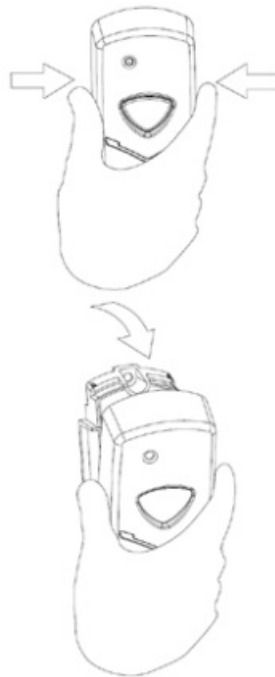

Note: DO NOT use a screw driver or other implement to remove cover. Incorrect removal of cover may damage the LED and void the warranty.

Mounting

1. If necessary, use the drilling template provided to drill holes.
2. The mounting screw size is #3 gauge.

Note: Be careful of cables when drilling

For installation on standard electrical gang box, a universal mounting adaptor plate can be used. Please contact CS for further information.

Wire connection

Note:

Power to the unit is provided from the listed control unit or from a separately UL listed 12V DC power-limited, access control power source. DO NOT supply power during installation.

Wiring methods shall be in accordance with the Electrical Wiring Regulation in your country/region

Check your circuit diagram for the colour coding of the circuit wiring. The reader can be damaged beyond repair if the wiring is connected incorrectly. This will void the warranty.

1. Connect the 0V wire to the power 0V line;

Note: The 0V line of all power supplies must be connected to a common 0V reference point.

2. Connect the Wiegand data wires;
3. Connect the Buzzer and LED wires;
4. Connect 12V DC wire;
5. Place reader on the wall (Make sure the wires are not crushed. This will void the warranty of damage occurs)
6. Insert and hand tighten the screws;
7. Check that the reader is level before tightening the screws;

Note: Excessive tightening of screws may deform the casing, resulting in a damaged unit. This will void the warranty.

8. Turn on the 12V DC power to power up reader.
9. Allow 5 – 10 seconds for reader to finish initialization (depends on the application). Make sure reader is functioning correctly according to the application specification.

Cover

After checking reader function, attach front cover back to the reader

1. Align the bottom of front cover with the bottom of reader;

Note: Make sure LED is aligned to the LED hole on the cover;

2. Push the cover onto reader and a click sound can be heard.



External Use

- Make sure the wire bundle to the reader has an IP rating of at least IP65

Handling

- Handle the reader with care. DO NOT damage or drop unit before installation. This will void the warranty.
- If the case is damaged, the reader may not be to the specified IP rating. Replace the reader if the case is damaged.

Maintenance

- Once installed the reader requires no maintenance.

Troubleshooting

Problem	Troubleshooting steps
Power on reader – reader does not start up	<ol style="list-style-type: none"> 1. Check connections 2. Check the voltage at the reader 3. Check the current capability of the power supply
Power on reader – reader keeps beeping	<ol style="list-style-type: none"> 1. Check buzzer line 2. Check the voltage at the reader 3. Check the current capability of the power supply
Power on reader – LED stays green	<ol style="list-style-type: none"> 1. Check LED line
Present a card to reader – a beep is heard but reader does not output any data	<ol style="list-style-type: none"> 1. Check whether the card has data encoded 2. Check the wiegand connection to controller 3. Check the voltage level on wiegand data lines
Present a card to reader – no response from reader	<ol style="list-style-type: none"> 1. Try a known working card 2. Check if the reader requires to be configured with a configuration card

If the problem still persists, please contact your distributor for technical support.

Warranty

Unless specified otherwise, the Company warrants to the Customer that 'CS Tech Branded Products' (excluding third party products and software) are covered by a return to base warranty on defects in materials and workmanship affecting normal use for a period of the Warranty offered under the Standard Terms and Conditions of Sale from CS Technologies

This standard warranty does not cover damage, fault, failure or malfunction due to external causes including; accident, misuse, problems with electrical power, servicing not authorised by the Company, usage and/or storage and/or installation not in accordance with Product instructions, failure to perform required preventative maintenance, normal wear and tear, act of God, fire, flood, war, any violent or similar occurrence; any attempt by any person other than Company personnel or any person authorised by the Company to repair or support the Products and problems caused by use of parts and components not supplied by the Company.

During the warranty, period beginning on the invoice date, the Company will repair or replace faulty products (at its absolute discretion) returned to its' factory. The Customer must prepay shipping and transportation costs and insure the shipment or accept the risk of loss or damage during such transportation.

The Customer shall be solely responsible for determining suitability for use and the Company will, in no event, be liable in this respect. This standard warranty is given in place of all warranties, conditions, terms, undertakings and obligations implied by statute, common law, trade usage, and course of dealing or otherwise including warranties or conditions of merchantability, fitness for purpose, satisfactory quality and / or compliance with description, all of which are hereby excluded to the fullest extent permitted by law.

Documents / Resources

 The image shows a technical diagram of the CS8101 reader with dimensions and a photograph of the physical device. The device is a black, cylindrical unit with a circular lens in the center. Text on the page includes 'CS8101' and '25kHz Proximity Mullion Reader'.	<p>CS TECHNOLOGIES CS8101 25kHz Proximity Mullion Reader [pdf] Installation Guide CS8101 25kHz Proximity Mullion Reader, CS8101, 25kHz Proximity Mullion Reader, Proximity Mullion Reader, Mullion Reader</p>
--	---

References

-  [CS Technologies Australia | Access Control Solutions](#)
- [User Manual](#)

Manuals+, Privacy Policy

This website is an independent publication and is neither affiliated with nor endorsed by any of the trademark owners. The "Bluetooth®" word mark and logos are registered trademarks owned by Bluetooth SIG, Inc. The "Wi-Fi®" word mark and logos are registered trademarks owned by the Wi-Fi Alliance. Any use of these marks on this website does not imply any affiliation with or endorsement.