



CRUX SWRGM-48 Radio Replacement Interface with Steering Wheel Control Installation Guide

[Home](#) » [CRUX](#) » CRUX SWRGM-48 Radio Replacement Interface with Steering Wheel Control Installation Guide



SWRGM-48

Radio Replacement Interface with Steering Wheel Control
Retention for select GM Class II Vehicles

Contents

- 1 **PRODUCT FEATURES:**
- 2 **PARTS INCLUDED:**
- 3 **INSTALLATION DIAGRAM:**
- 4 **DIP SWITCH SETTINGS:**
- 5 **SELECTING THE AUDIO SYSTEM:**
- 6 **CHIME VOLUME ADJUSTMENT:**
- 7 **STEERING WHEEL CONTROL BUTTON FUNCTIONS:**
- 8 **STEERING WHEEL CONTROL SETTINGS:**
- 9 **VEHICLE APPLICATIONS:**
- 10 **Documents / Resources**
 - 10.1 **References**

PRODUCT FEATURES:

- Retains factory features in select GM Class II Data Bus vehicles while functioning with an aftermarket radio.
- Pre-programmed to retain factory Steering Wheel Controls.
- Voice Recognition Command from factory SWC.

- Supports Bose, non-Bose and Y-91 audio systems.
- Retains chime functions.
- Built-in chime volume adjustment.
- EIA color coded wiring for easy installation.

PARTS INCLUDED:



SWRGM-48 MODULE



SWRGM-48 HARNESS



SWC CABLE

INSTALLATION DIAGRAM:

TROUBLESHOOTING

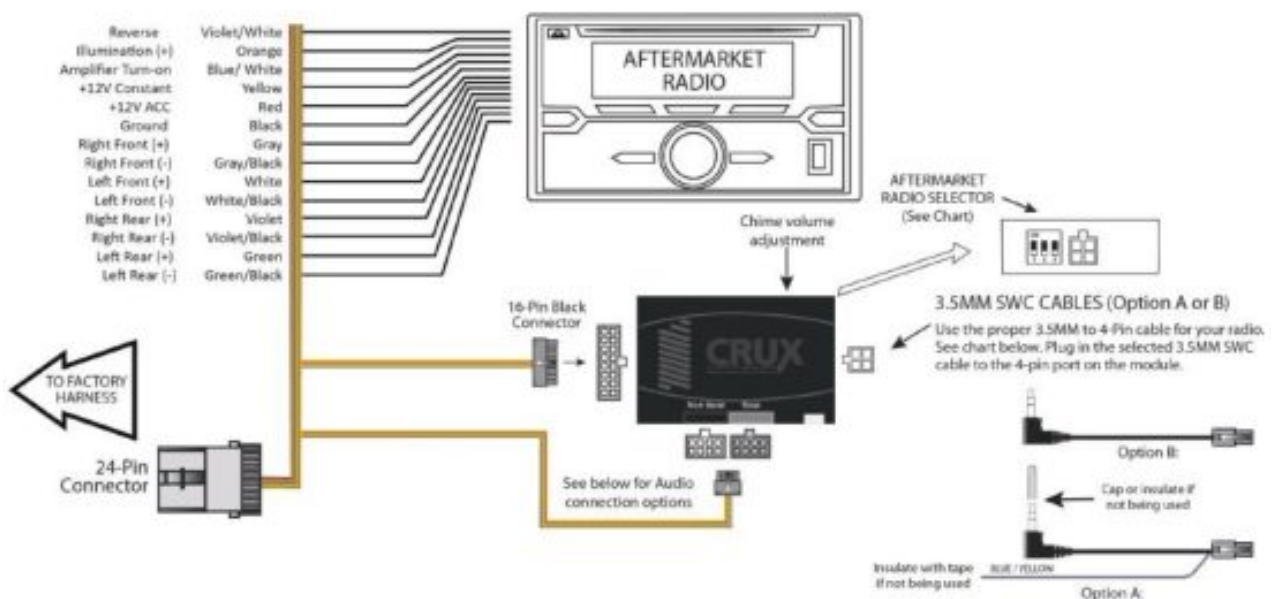

LED LIGHT	LED MODULE FEEDBACK
Solid blue	CAN recognized
Flashing blue	CAN not recognized
Solid red	Module providing 12V ACC
Red off	12V ACC OFF

DIP SWITCH SETTINGS:

AFTERMARKET RADIO DIP SWITCH SETTINGS:

RADIO BRAND:	DIP#:	1	2	3
Atoto, Dual, Fahrenheit, Jensen, Nakamichi,		OFF	ON	ON
Pioneer, Power Acoustik, Soundstream		OFF	ON	ON
Blaupunkt, Most off-brand Radio		OFF	ON	ON
Alpine		OFF	OFF	OFF
Clarion		ON	ON	OFF
Kenwood		ON	ON	ON
JVC		ON	OFF	ON
Boss, Old Sony		ON	OFF	OFF
New Sony (with CarPlay)		OFF	ON	OFF

SWC MODULE DIP SWITCH

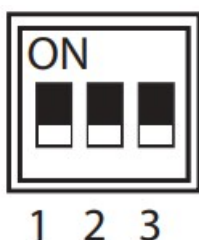

NOTE: For Atoto, Blaupunkt, Dual, Fahrenheit, Nakamichi, Power Acoustik, Soundstream, and most off-brand radios, check the aftermarket radio's manual to see if the SWC buttons need to be programmed.

SWC Troubleshoot option



Located internally Need to take plastic Casing off module

- If Steering Wheel Controls don't work or work properly please switch internal dip switch from 3v3 to 5v as shown in picture above.

4-PIN SWC CABLE

Use the proper 3.5MM to 4-Pin SWC cable for the aftermarket radio you are using.

OPTION A is used for ALPINE, CLARION. Use the Blue/Yellow wire for JVC and KENWOOD units.

OPTION B is used for ATOTO, BLAUPUNKT, BOSS, DUAL, FARENHEIT, JENSEN, POWER ACOUSTIK, PIONEER, SONY, SOUNDSTREAM and Most Off-Brand Radios.

NOTE: Cap or insulate the 3.5mm plug or Blue/Yellow wire if not being used.

For aftermarket radios that have wires for SWC connections, cut off the 3.5mm plug on the Crux SWC Cable (option B) and connect the SWC wires as follows:

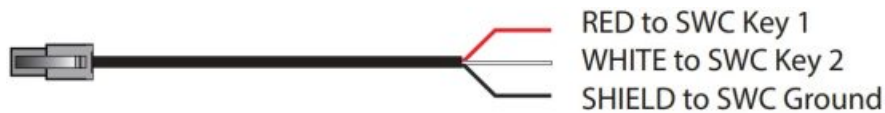

Note that there are some radios that only have SWC1 and SWC2, in this case "shield" does not need to be connected.

SELECTING THE AUDIO SYSTEM:

If the vehicle is equipped with an amplified audio system, the SWRGM-48 has a built-in audio level adaptor that outputs the proper audio level from the aftermarket radio to the factory amplifier. To use this feature, plug in the male 8-pin connector on the SWRGM-48 harness to the GRAY female 8-pin connector on the SWRGM-48 module. The module is also labeled "Bose" and "Non Bose" to avoid confusion. (see picture below)

If the vehicle is NOT equipped with a factory amplified system, plug in the male 8-pin connector to the BLACK female 8-pin on the SWRGM-48 module.

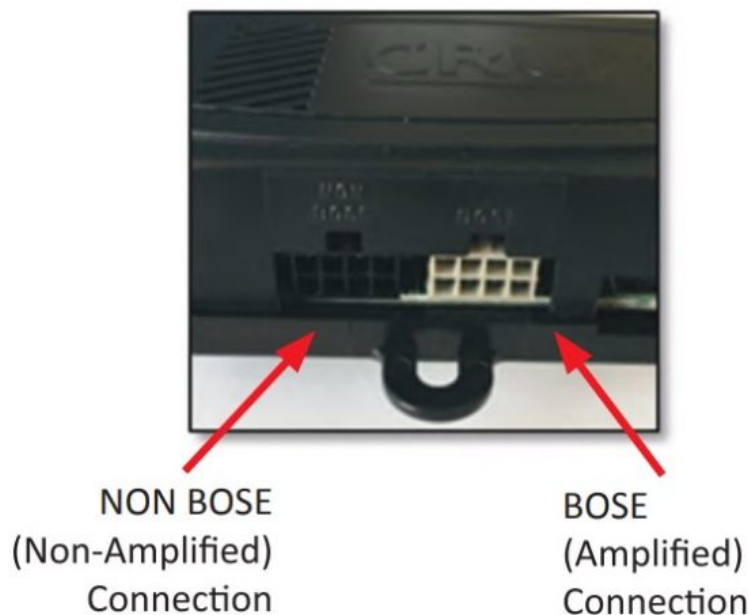

CHIME VOLUME ADJUSTMENT:

The SWRGM-48 has a potentiometer to adjust the chime volume. It is set at half way by default. To adjust the volume, simply use a suitable screw driver and turn the potentiometer clockwise to increase the volume and counter-clockwise to decrease the volume.

Chime
Volume
Adjustment



STEERING WHEEL CONTROL BUTTON FUNCTIONS:

4 BUTTON SWC

SWC Button	SHORT PRESS	LONG PRESS
VOL + VOL - AM/FM Preset	Step Increment Step Decrement Source Activate VR /	Continuous VOL + Continuous VOL - Pick Up Call End Call
NOTES: To Deactivate VR = on Pioneer, press "PRESET" on JVC = say "Cancel"		To Deactivate VR = on Kenwood, long press of PRESET

4 BUTTON SWC

SWC Button	SHORT PRESS	LONG PRESS
ALPINE VOL + VOL - Seek Up ▲ Seek Down ▼ Source Up Source Down Prog Voice	Step Increment Step Decrement Seek Up Seek Down Pick up Call Source	Continuous VOL + Continuous VOL - N/A N/A End Call N/A
SWC Button	SHORT PRESS	LONG PRESS
CLARION VOL + VOL - Seek Up ▲ Seek Down ▼ Source Up Source Down Prog Voice	Step Increment Step Decrement Preset Up Preset Down Pick up Call Source Mute Mute	Continuous VOL + Continuous VOL - N/A N/A End Call N/A N/A N/A

SWC Button	SHORT PRESS	LONG PRESS
JVC		
VOL +	Step Increment	Continuous VOL +
VOL -	Step Decrement	Continuous VOL -
Seek Up	Seek Up	N/A
Seek Up ▲	Seek Down	N/A
Seek Down ▼	Pick up Call	End Call
Source Down	Source	N/A
Prog	Activate Voice Recognition	N/A
Voice	Activate Voice Recognition	N/A

NOTE: Say "CANCEL" to Deactivate VR

SWC Button	SHORT PRESS	LONG PRESS
KENWOOD		
VOL +	Step Increment	Continuous VOL +
VOL -	Step Decrement	Continuous VOL -
Seek Up ▲	Seek Up	Tune Up
Seek Down ▼	Seek Down	Tune Down
Source Up	Pick up Call	End Call, Deactivate VR
Source Down	Source	N/A
Prog	Activate Voice Recognition	Deactivate VR
Voice	Activate Voice Recognition	N/A

NOTE: BT Inactive, Source Up Activate Call History

SWC Button	SHORT PRESS	LONG PRESS
PIONEER		
VOL +	Step Increment	Continuous VOL +
VOL -	Step Decrement	Continuous VOL -
Seek Up ▲	Preset Up	N/A
Seek Down ▼	Preset Down	N/A
Source Up	Pick up Call	End Call
Source Down	Source	N/A
Prog	Activate Voice Recognition	Deactivate VR, End Call
Voice	Activate Voice Recognition	Deactivate VR

ANALOG SWC

BUICK – Century, LaCrosse, Rainier, Rendezvous, Terraza

CHEVROLET – Corvette, Impala, Monte Carlo

OLDSMOBILE – Alero, Bravada, Silhouette

PONTIAC – Aztec, Grand Am, Grand Prix, Montana, Sunfire

SWC Button	SHORT PRESS	LONG PRESS
ALPINE		
VOL +	Step Increment	Continuous VOL +
VOL -	Step Decrement	Continuous VOL -
Mode / Play	Source	N/A
MUTE	Attenuation	N/A
Seek Up ▲	Seek Up	N/A
Seek Down ▼	Seek Down	N/A
Type Seek / Band	Pick up Call	N/A
Preset / 1-6		End Call

SWC Button	SHORT PRESS	LONG PRESS
CLARION		
VOL +	Step Increment	Continuous VOL +
VOL -	Step Decrement	Continuous VOL -
Mode / Play	Source	N/A
MUTE	Mute	N/A
Seek Up ▲	Preset Up	N/A
Seek Down ▼	Preset Down	N/A
Type Seek / Band	Pick up Call	End Call
Preset / 1-6	N/A	N/A

SWC Button	SHORT PRESS	LONG PRESS
JVC		
VOL +	Step Increment	Continuous VOL +
VOL -	Step Decrement	Continuous VOL -
Mode / Play	Source	N/A
MUTE	Mute	N/A
Seek Up ▲	Seek Up	N/A
Seek Down ▼	Seek Down	N/A
Type Seek / Band	Pick up Call	End Call
Preset / 1-6	Activate Voice Recognition	N/A

NOTE: Say "CANCEL" to Deactivate VR

SWC Button	SHORT PRESS	LONG PRESS
KENWOOD		
VOL +	Step Increment	Continuous VOL +
VOL -	Step Decrement	Continuous VOL -
Mode / Play	Source	N/A
MUTE	Attenuation	N/A
Seek Up ▲	Seek Up	N/A
Seek Down ▼	Seek Down	N/A
Type Seek / Band	Pick up Call	End Call, Deactivate VR
Preset / 1-6	Activate Voice Recognition	N/A

SWC Button	SHORT PRESS	LONG PRESS
PIONEER		
VOL +	Step Increment	Continuous VOL +
VOL -	Step Decrement	Continuous VOL -
Mode / Play	Source	N/A
MUTE	Mute	N/A
Seek Up ▲	Preset Up	N/A
Seek Down ▼	Preset Down	N/A
Type Seek / Band	Pick up Call	End Call
Preset / 1-6	Activate Voice Recognition / Deactivate Voice Recognition	N/A

STEERING WHEEL CONTROL SETTINGS:

Note: Identify Alpine SWC learning radios by checking for three SWC cables and a SWC learn menu, instead of a 3.5mm SWC input.

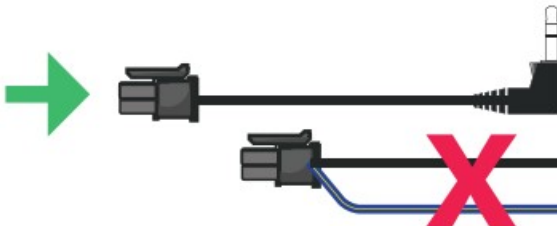
If Interface has one SWR-100 Cable included	If Interface has two SWR Cables inclu
1 – Find the included SWC adapter cable.	1 – Identify appropriate SWC adapter ca Do not use cable with Blue / Yellow wi
	

2 – Prepare the SWC Cable: Cut the SWC cable. You will find a red wire, a white wire, and a ground (shield) wire inside.

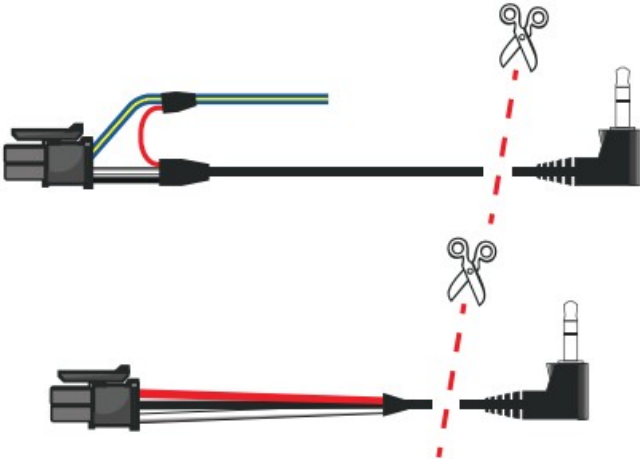

3 – Adjust the Module Settings: Set the module to the Pioneer dip switch setting. This configures the module to communicate correctly with the Alpine radio.

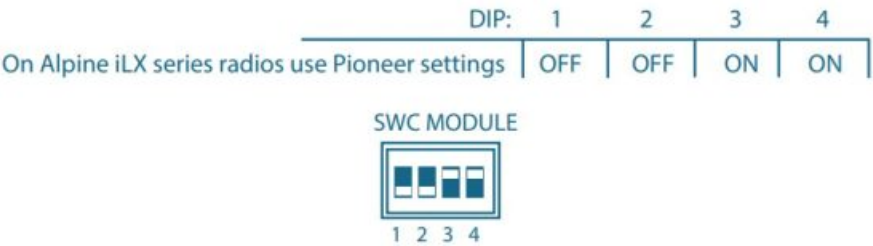

4 – Configure the Alpine Radio: On your Alpine radio, select the setting that includes an adapter for SWC. This ensures the radio will recognize the steering wheel controls.



5 – Connect the Wires: Connect both the SWC1 and SWC2 wires from aftermarket radio to the red wire from our SWC cable. Connect the SWC ground wire to the shield (ground) wire of our SWC cable. These steps should enable the steering wheel controls on your Alpine iLX series radio.

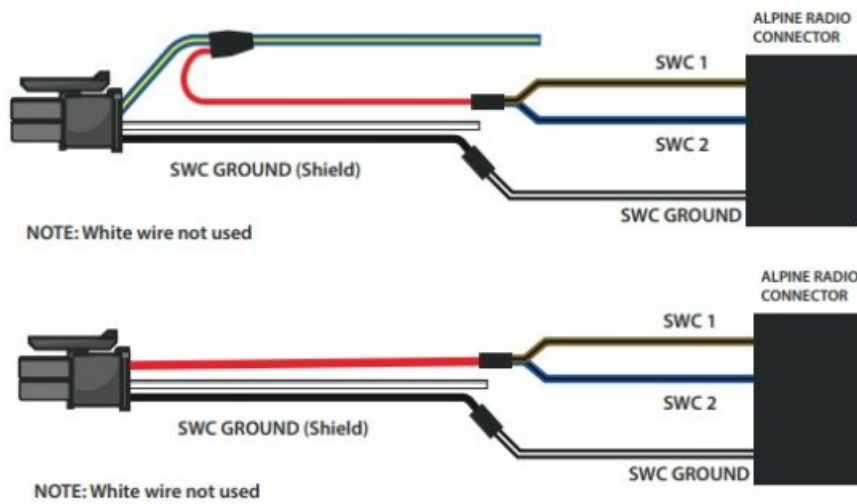

6. Program the SWC: Navigate to the SWC settings on your Alpine radio to assign and test each control function.

VEHICLE APPLICATIONS:

Buick

2004-2005	Century*
2005-2007	LaCrosse*
2004-2007	Rainier*
2003-2007	Rendezvous*
2005-2007	Terraza*

Cadillac

2003-2006	Escalade
-----------	----------

Chevrolet

2003-2006	Avalanche
2000-2005	Cavalier
2004-2013	Colorado
2005-2013	Corvette*
2004-2007	Express
2000-2005	Impala*
2001-2003	Malibu
2000-2005	Monte Carlo*
2003-2004	S-10
2003-2006	Silverado
2007	Silverado Classic
2003-2006	SSR
2003-2006	Suburban
2003-2006	Tahoe
2002-2009	Trailblazer
2005-2008	Uplander
2003-2005	Venture

Isuzu

2003-2008	Ascender
-----------	----------

GMC

2004-2011	Canyon
2002-2009	Envoy
2003-2007	Savana
2003-2006	Sierra
2007	Sierra Classic
2003-2006	Yukon

Hummer

2003-2007	H2
2005-2010	H3

Oldsmobile

2001-2004	Alero*
2002-2004	Bravada*
2000-2004	Silhouette*

Saab

2005-2008	9-7X
-----------	------

Saturn

2005-2007	Relay
-----------	-------

*Analog Steering Wheel Controls. See pages 5 and 6 for SWC button functions.



<http://www.cruxinterfacing.com/>

rev.070124

Crux Interfacing Solutions Chatsworth, CA 91311

phone: [818-609-9299](tel:818-609-9299)

fax: [818-996-8188](tel:818-996-8188)

www.cruxinterfacing.com

Documents / Resources

	<p>CRUX SWRGM-48 Radio Replacement Interface with Steering Wheel Control [pdf] Installati on Guide</p> <p>SWRGM-48, CS-GMC2, SWRGM-48 Radio Replacement Interface with Steering Wheel Contro l, SWRGM-48, Radio Replacement Interface with Steering Wheel Control, Replacement Interfac e with Steering Wheel Control, Interface with Steering Wheel Control, Steering Wheel Control, Wheel Control</p>
---	---

References

- [User Manual](#)

[Manuals+](#), [Privacy Policy](#)

This website is an independent publication and is neither affiliated with nor endorsed by any of the trademark owners. The "Bluetooth®" word mark and logos are registered trademarks owned by Bluetooth SIG, Inc. The "Wi-Fi®" word mark and logos are registered trademarks owned by the Wi-Fi Alliance. Any use of these marks on this website does not imply any affiliation with or endorsement.