



Crosley T400 Turntable Record Player Instruction Manual

[Home](#) » [Crosley](#) » Crosley T400 Turntable Record Player Instruction Manual 

Contents

- [1 Crosley T400 Turntable Record Player](#)
- [2 Safety Instructions](#)
- [3 Items in this package](#)
- [4 Specifications](#)
- [5 Product Description](#)
- [6 Initial Setup](#)
- [7 Stereo System Connection](#)
- [8 Turntable Operation](#)
- [9 Needle Replacement](#)
- [10 Bluetooth Streaming Operation](#)
- [11 Turntable Maintenance](#)
- [12 Troubleshooting](#)
- [13 FCC Statements](#)
- [14 FREQUENTLY ASKED QUESTIONS](#)



Crosley T400 Turntable Record Player



Safety Instructions

Read and understand this entire manual before using this product. Keep these instructions for future reference.

1. Do not use this product near water.
2. This product should be operated only by the type of power source indicated on the marking label or in this instruction manual.
3. Do not defeat the safety purpose of the polarized plug. A polarized plug has two blades with one blade wider than the other. This plug will fit into the power outlet only one way. If you are unable to insert the plug fully into the outlet try reversing the plug. If the plug should still fail to fit, contact your electrician.
4. Protect the power cord from being walked on or pinched particularly at plugs, convenience receptacles, and the point where they exit from the product.
5. Do not overload wall outlets, extension cords, or integral convenience receptacles as this can result in a risk of fire or electric shock.
6. Never push objects of any kind into this product through openings as they may touch dangerous voltage points or short-out parts that could result in a fire or electric shock. Never spill liquid of any kind on the product.
7. Do not attempt to service this product yourself as opening or removing covers may expose you to dangerous voltage or other hazards. Refer all servicing to qualified service personnel.
8. Changes or modifications to this unit not expressly approved by the party responsible for compliance could void the user's authority to operate the equipment.
9. Do not use attachments not recommended by the product manufacturer as they may cause hazards.
10. A product and cart combination should be moved with care. Quick stops, excessive force, and uneven surfaces may cause the product and cart combination to overturn.
11. Slots and openings in the cabinet are provided for ventilation and to ensure reliable operation of the product and to protect it from overheating. Do not block or cover these openings.
12. Unplug the product during lightning storm or when unused for long periods of time.

Items in this package

Before throwing away any packaging materials, please check thoroughly and make sure you find the following items that come along with this package:

- Turntable
- Turntable Lid
- Turntable Platter
- Turntable Slip Mat
- 45 RPM Adapter
- Power Adaptor

Please contact Crosley Customer Service if there is any accessory missing from the package. Retain the original packaging materials for exchange or return purposes.

Specifications

- **Power:** AC power adaptor, DC output 12V 200mA
- **Power consumption:** 2W
- **Turntable speed:** 33 1/3, 45 RPM
- **Replacement needle:** Crosley NP5

Note:

- Design and specifications are subject to change without notice.
- To help save power consumption, some models will comply with ERP energy-saving standards. When there is no audio input for 20 minutes, their powers will automatically cut-off. To turn the power back on and resume playing, you will need to turn off the power and turn it on again.

Product Description

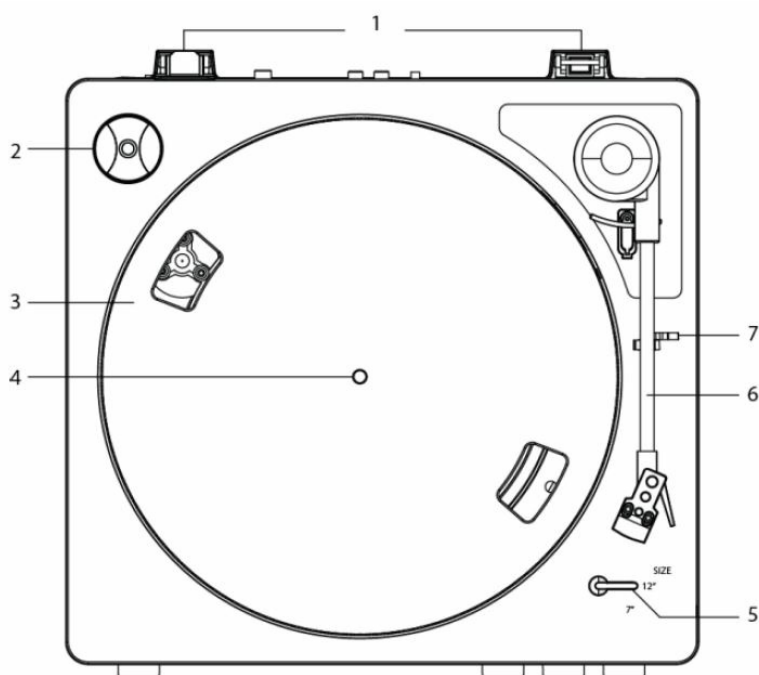

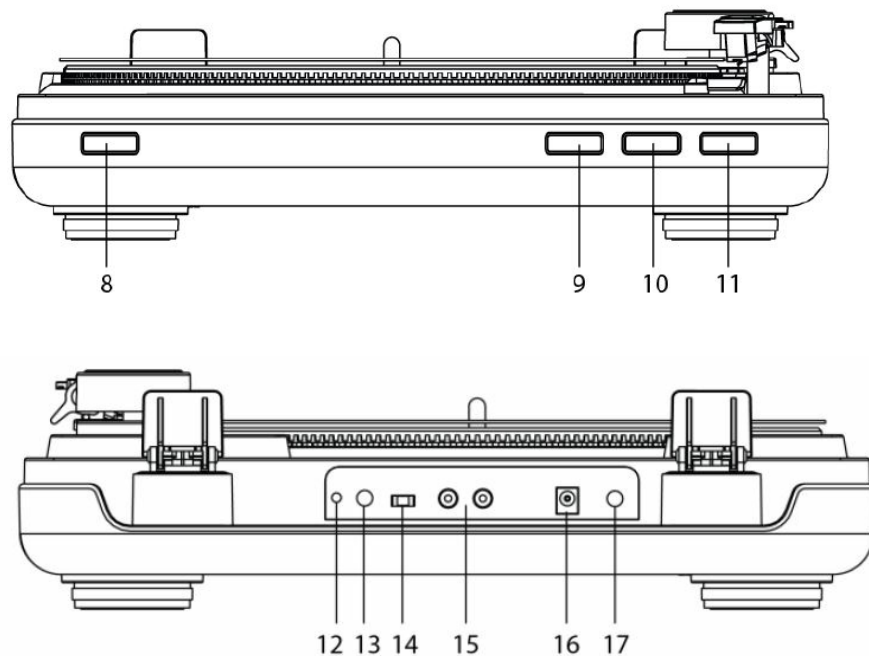

1. Hinges
2. 45 RPM Adapter
3. Turntable Platter
4. Turntable Spindle
5. Size Selector
6. Tonearm
7. Hold Down Clip
8. Speed Selector
9. Start Button
10. Stop Button
11. Lift Button
12. Bluetooth Indicator
13. Bluetooth Button
14. Phone Line Switch
15. RCA Jack
16. Power Jack
17. ON/OFF Button

Initial Setup

Essential Setup

1. Place the unit on a flat and level surface. The selected location should be stable and free from vibration.
2. Install the turntable lid to the hinges.
3. Remove the tie-wrap that is holding the tonearm.
4. Install the turntable platter and drive belt accordingly.
5. Place the slip mat on top of the turntable platter.
6. Connect AC adaptor to the Power Jack of the unit.

Note: Do not plug the AC power adaptor to the power outlet before all the assembly is completed. Before turning the power on, make sure again all the connection settings are correct. Always turn off the power when connecting or disconnecting.

Turntable Platter and Belt Setup

1. Install the drive belt over the inner ring under the platter and make sure it won't fall off during the setup.
2. Place the platter through the turntable spindle, then rotate the platter until you see the drive motor pulley through the window at the top right corner.
3. Carefully grab the drive belt and put it around the slot of the motor pulley.

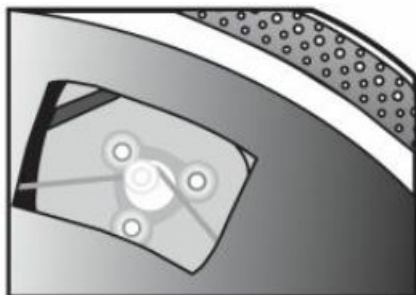

Stereo System Connection

RCA Jacks

- The RCA Jacks output analog line-level signals and could be connected directly with a pair of active/powered speakers or the appropriate input of your stereo system.
- The Red plug connects with the Right channel and the White plug connects with the Left channel.

Note: The RCA Jacks are not designed to be connected directly to the passive/unpowered speakers. If connected to the passive speakers, the volume level will be very low.

Turntable Operation

Automatic Operation

1. Press the ON / OFF Button to turn on the power.
2. Set the Size Selector to the appropriate record size.
3. Set the Speed Button accordingly.
4. Place the record on the turntable. Use the 45 RPM Adapter if necessary.
5. Remove the stylus protector from the stylus assembly.

Note: To avoid stylus damage, make certain the included stylus guard is in place whenever the turntable is being moved or cleaned.

6. Release the tonearm Hold Down Clip.

Note: when the turntable is not in use, remember to lock back and hold down the clip.

7. Gently push the START Button. The turntable will start and the tone arm automatically will move to the record. When the record has finished playing, the tone arm will automatically return to the tonearm rest and the turntable will shut off.
8. To stop playing the record before it reaches the end, press the STOP Button. The tone arm will lift and return to

the tone armrest, and the turntable will shut off.

9. To pause the record before it has completed playing, press the Tone Arm Lift Button. Press the Lift button again to continue playing the record.
10. After play is finished, lock the Hold Down Clip to secure the tonearm.

Manual Operation

1. Press the ON / OFF Button to turn on the power.
2. Set the Size Selector to the appropriate record size.
3. Set the Speed Button accordingly.
4. Place the record on the turntable. Use the 45 RPM Adapter if necessary.
5. Remove the stylus protector from the stylus assembly.

Note: To avoid stylus damage, make certain the included stylus guard is in place whenever the turntable is being moved or cleaned.

6. Release the tonearm Hold Down Clip.

Note: when the turntable is not in use, remember to lock back and hold down the clip.

7. Press the Lift Button to raise the tone arm.
8. Gently move the tone arm where play is desired to begin.
9. Press the Lift button again to gently lower the tone arm and play the record.
10. After play is finished, lock the Hold Down Clip to secure the tonearm.

Caution: When the tone arm reaches the end of the record, it will lift and return to the tonearm rest automatically. When this happens, do not interfere with the tone arm's motion, or damage to the mechanism may occur.

Needle Replacement

Removing Needle

1. Gently pull down the front edge of the needle.
2. Pull the needle forward.
3. Pull out and remove.

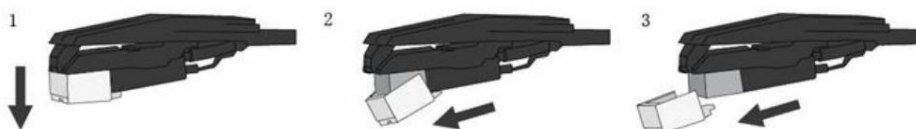

Installing Needle

1. Position the needle with its tip facing down.
2. Line up the back of the needle with the cartridge.
3. Insert the needle with its front end at a downward angle and gently lift the front of the needle upward until it snaps into place.

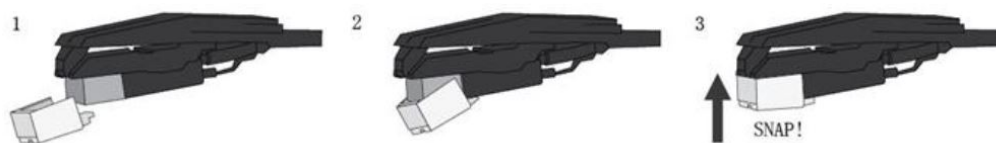

Bluetooth Streaming Operation

1. Turn on the Bluetooth mode of the Bluetooth speaker and prepare it for pairing. Please read the user manual of the speaker for detailed instructions if needed.
2. Press the Bluetooth Button on the back of the unit. The Bluetooth Indicator will begin to flash quickly. If the speaker was pre-registered in the past, the turntable will connect to the speaker automatically during this stage.
3. Once the turntable and the speaker are paired, the Bluetooth Indicator will stay on.
4. Play the record and enjoy the music.
5. To turn off the Bluetooth streaming feature, press the Bluetooth Button. Note:

Bluetooth version – 4.1

When the unit is not connected to a Bluetooth speaker; the Bluetooth Indicator light will flash slowly.

Turntable Maintenance

1. Do not touch the stylus tip with your fingers. Avoid bumping the stylus on the turntable mat or a record's edge.
2. Clean the stylus frequently with a soft brush with a back-to-front motion only.
3. Clean the records to get rid of dust or grease with a record cleaning brush and record cleaning solution.
4. Clean the turntable lid and turntable cabinet with a slightly dampened microfiber cloth.

Note: Do not use a cleanser that contains alcohol, benzene, or any other harsh chemicals which might damage the paint and finish of the turntable.

Crosley offers a product line of different cleaning accessories. Please ask your retailer or check out our website www.crosleyradio.com for more cleaning product information.

Troubleshooting

There is no power

- The power adaptor is not connected correctly.
- No power at the power outlet.
- To help save power consumption, some models will comply with ERP energy-saving standards. When there is no audio input for 20 minutes, their powers will automatically cut off. To turn the power back on and resume playing, turn off the power and turn it on again.

The power is on, but the platter does not turn

- The turntable mode is not selected.

- The turntable's drive belt has slipped off.

The turntable is spinning, but there is no sound, or sound not loud enough

- The Stylus protector is still on.
- Headphones are plugged in.

FCC Statements

FCC Caution:

1. This device complies with Part 15 of the FCC rules/ Industry Canada license-exempt RSS standard(s).
Operation is subject to the following two conditions:
 - This device may not cause harmful interference, and
 - This device must accept any interference received, including interference that may cause undesired operation.
2. This device and its antenna(s) must not be co-located or operating in conjunction with any other antenna or transmitter.
3. Changes or modifications to this unit not expressly approved by the party responsible for compliance could void the user's authority to operate the equipment.

Note:

This equipment has been tested and found to comply with the limits for a Class B digital device, pursuant to Part 15 of the FCC Rules. These limits are designed to provide reasonable protection against harmful interference in a residential installation. This equipment generates, uses, and can radiate radio frequency energy and, if not installed and used in accordance with the instructions, may cause harmful interference to radio communications. However, there is no guarantee that interference will not occur in a particular installation. If this equipment does cause harmful interference to radio or television reception, which can be determined by turning the equipment off and on, the user is encouraged to try to correct the interference by one or more of the following measures:

- Reorient or relocate the receiving antenna.
- Increase the separation between the equipment and the receiver.
- Connect the equipment to a circuit different from that to which the receiver is connected.
- Consult the dealer or an experienced radio TV technician for help.

FREQUENTLY ASKED QUESTIONS

What is the Crosley T400 Turntable Record Player?

The Crosley T400 is a turntable record player manufactured by Crosley, a well-known brand in the audio equipment industry.

What type of turntable is the T400?

The T400 is a belt-drive turntable, meaning it uses a belt to rotate the platter that holds the vinyl records.

What speeds does the T400 support?

The T400 supports three speeds: 33 1/3 RPM, 45 RPM, and 78 RPM, allowing you to play various types of vinyl records.

Does the T400 have built-in speakers?

Yes, the T400 features built-in stereo speakers, so you can listen to your records without the need for additional speakers or amplifiers.

Can I connect external speakers to the T400?

Yes, the T400 has RCA output jacks, allowing you to connect external speakers or a receiver for improved audio output.

Does the T400 have a headphone jack?

Yes, the T400 has a headphone jack that allows you to connect headphones for private listening.

Can the T400 play both stereo and mono records?

Yes, the T400 can play both stereo and mono records, accommodating various vinyl formats.

Does the T400 have a pitch control feature?

No, the T400 does not have a pitch control feature, so you cannot manually adjust the playback speed.

Can I convert vinyl records to digital formats using the T400?

The T400 does not have a built-in USB output for direct digital conversion. If you want to convert vinyl records to digital formats, you would need to connect the turntable to a computer or audio interface with recording software.

Does the T400 have an auto-stop feature?

Yes, the T400 has an auto-stop feature that stops the platter rotation at the end of the record to prevent continuous spinning.

Can I replace the cartridge on the T400?

Yes, the cartridge on the T400 is replaceable. You can replace it with a compatible cartridge recommended by Crosley or consult the manufacturer for guidance.

Does the T400 come with a dust cover?

Yes, the T400 usually comes with a removable dust cover to help protect the turntable and records from dust and debris.

Can I adjust the tracking force and anti-skate settings on the T400?

Yes, the T400 typically allows you to adjust the tracking force and anti-skate settings to optimize the performance and playback quality.

Does the T400 have Bluetooth connectivity?

No, the T400 does not have built-in Bluetooth capabilities, so it cannot be directly connected to Bluetooth speakers or headphones.

Does the T400 have a counterweight adjustment for the tonearm?

Yes, the T400 typically has a counterweight adjustment on the tonearm, allowing you to properly balance the tracking force for accurate playback.

DOWNLOAD THE PDF LINK: [Crosley T400 Turntable Record Player Instruction Manual](#)