

CROSLEY®
CR7023A Serenade
Record Player



CROSLEY CR7023A Serenade Record Player Instruction Manual

[Home](#) » [Crosley](#) » CROSLEY CR7023A Serenade Record Player Instruction Manual 

Contents

- 1 CROSLEY CR7023A Serenade Record Player
- 2 Product Specifications
- 3 Product Description
- 4 Safety Instructions
- 5 Items in this package
- 6 Specifications
- 7 Product Description
- 8 Initial Setup
- 9 Stereo System Connection
- 10 Aux Input Connection
- 11 Bluetooth Operation
- 12 Turntable Operation
- 13 Needle Replacement
- 14 Radio Operation
- 15 CD Playback Operation
- 16 Cassette Operation
- 17 Turntable Maintenance
- 18 Troubleshooting
- 19 FCC Statements
- 20 Documents / Resources
 - 20.1 References

CROSLEY®

CROSLEY CR7023A Serenade Record Player



Product Specifications

- **Power:** AC power adaptor, DC output 12V 1A
- **Power consumption:** 12W
- **Speaker:** 3, 4, 5W x 2
- **Turntable speed:** 33 1/3, 45, 78 RPM
- **Replacement needle:** Crosley NP10
- **Frequency Range:** Standard

Product Description

Initial Setup

1. Turn the turntable on its side and remove plastic pieces from the underside.
2. Insert the legs into the underside of the turntable and tighten.
3. Place the unit on a flat and level surface free from vibration.
4. Remove the tie-wrap holding the tonearm.
5. Connect the power adaptor to the Power Jack of the unit.

Stereo System Connection

To connect an audio device to the unit, follow these steps:

1. Press the Mode Button to select Aux mode.
2. Connect a 3.5mm auxiliary cable between your audio device and the Aux In Jack of the unit.
3. Start playing music from your audio device.

Bluetooth Operation

1. Press the Mode Button to select Bluetooth mode.
2. Turn on Bluetooth on your device and pair with "CROSLEY CR7023A".
3. Upon successful pairing, a confirmation sound will be heard from the unit.

Turntable Operation

1. Select Phono mode by pressing the Mode Button.
2. Adjust the Speed Switch accordingly.
3. Place the record on the turntable, using the 45 RPM Adapter if needed.
4. Remove the stylus protector from the stylus assembly before playing.

Safety Instructions

Read and understand this entire manual before using this product. Keep these instructions for future reference.

1. Do not use this product near water.
2. This product should be operated only by the type of power source indicated on the marking label or in this instruction manual.
3. Do not defeat the safety purpose of the polarized plug. A polarized plug has two blades with one blade wider than the other. This plug will fit into the power outlet only one way. If you are unable to insert the plug fully into the outlet try reversing the plug. If the plug should still fail to fit, contact your electrician.
4. Protect the power cord from being walked on or pinched particularly at plugs, convenience receptacles, and the point where they exit from the product.
5. Do not overload wall outlets, extension cords, or integral convenience receptacles as this can result in a risk of fire or electric shock.
6. Never push objects of any kind into this product through openings as they may touch dangerous voltage points or short-out parts that could result in a fire or electric shock. Never spill liquid of any kind on the product.
7. Do not attempt to service this product yourself as opening or removing covers may expose you to dangerous voltage or other hazards. Refer all servicing to qualified service personnel.
8. Changes or modifications to this unit not expressly approved by the party responsible for compliance could void the user's authority to operate the equipment.
9. Do not use attachments not recommended by the product manufacturer as they may cause hazards.
10. A product and cart combination should be moved with care. Quick stops, excessive force, and uneven surfaces may cause the product and cart combination to overturn.
11. Slots and openings in the cabinet are provided for ventilation and to ensure reliable operation of the product and to protect it from overheating. Do not block or cover these openings.
12. Unplug the product during lightning storms or when unused for long periods of time.

Items in this package

Before throwing away any packaging materials, please check thoroughly and make sure you find the following items that come along with this package:

- Turntable
- 45 RPM adapter

- Power adapter
- 4 Legs
- RCA Cable

Please contact Crosley customer service if there is any accessory missing from the package. Retain the original packaging materials for exchange or return purposes.

Specifications

- **Power** AC power adaptor, DC output 12V 1A
- **Power consumption** 12W
- **Speaker** 3", 4Ω, 5W x 2
- **Turntable speed** 33 1/3, 45, 78 RPM
- **Replacement needle** Crosley NP10
- **Frequency Range**
 - **AM** 530 – 1700 KHz
 - **FM** 88 – 108 MHz

Note:

- Design and specifications are subject to change without notice.
- To help save power consumption, some models will comply with ERP energy saving standard.
When there is no audio input for 20 minutes, their powers will automatically cut-off. To turn power back on and resume playing, you will need to turn off the power and turn it on again.

Product Description

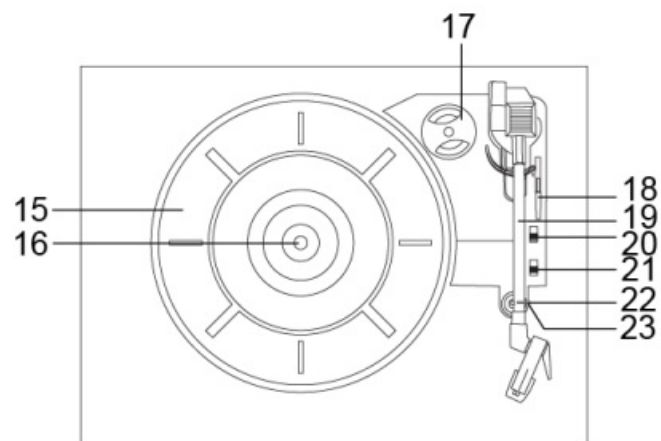
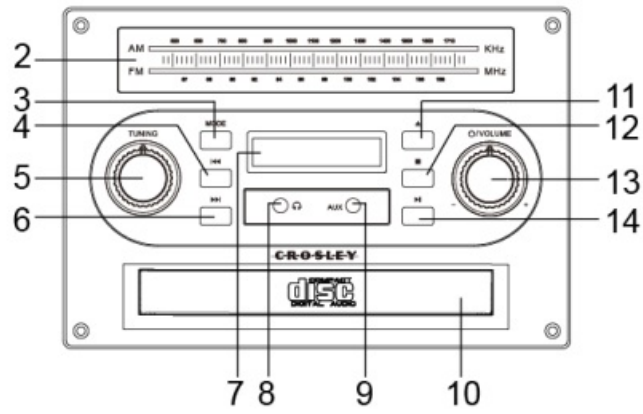
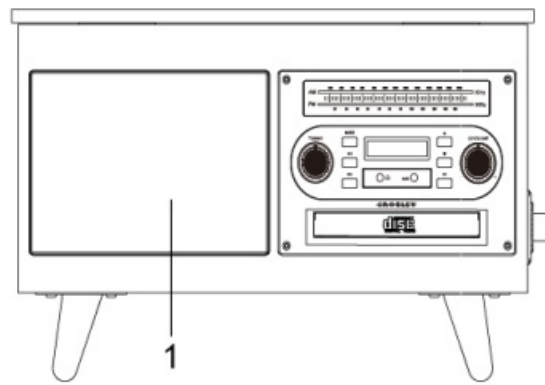

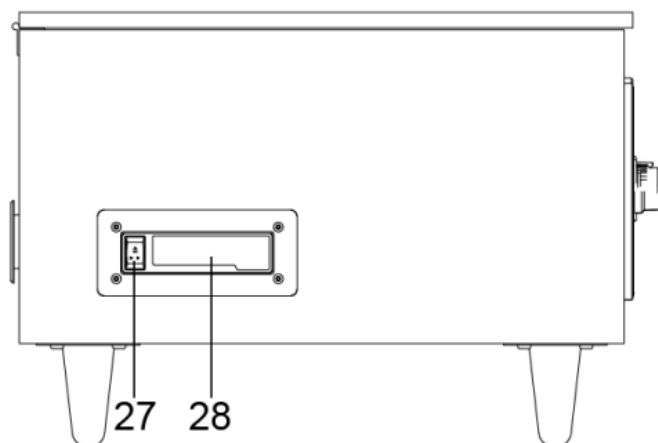
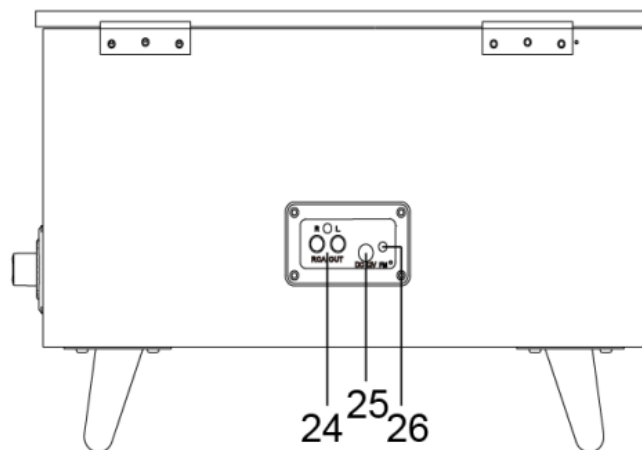

1. Speakers
2. Dial Scale
3. Mode Button
4. Backward Skip Button
5. Tuning Knob
6. Forward Skip Button
7. LED Display
8. Headphone Jack
9. Aux In Jack
10. CD Tray
11. CD Door Open/Close Button
12. Stop Button
13. On/Off Volume Knob
14. Play/Pause Button
15. Turntable Platter
16. Turntable Spindle
17. 45 RPM Adapter
18. Tonearm Lever
19. Tonearm
20. Auto-stop Switch
21. Speed Switch
22. Hold Down Clip

23. Tonearm Rest
24. Speaker Jacks
25. Power Jack
26. External Antenna
27. Cassette Eject/Fast Forward Button
28. Cassette Door

Initial Setup

Essential Setup

1. Turn the turntable on its side and remove plastic pieces from the underside.
2. Insert the legs into the underside of the turntable and tighten.
3. Place the unit on a flat and level surface. The selected location should be stable and free from vibration.
4. Remove the tie-wrap that is holding the tonearm.
5. Connect power adaptor to the Power Jack of the unit.

Stereo System Connection

RCA Jacks

1. The RCA Jacks output analog line-level signals and could be connected directly with a pair of active/powered speakers or the appropriate input of your stereo system.
2. The Red plug connects with the Right channel and the White plug connects with the Left channel.

Note: The RCA Jacks are not designed to be connected directly to the passive/unpowered speakers. If connected to the passive speakers, the volume level will be very low.

Aux Input Connection

You can connect an audio device to this unit and play your music through its speakers. To do this, press the Mode Button repeatedly to select Aux mode, connect the 3.5mm auxiliary cable (not included) between your audio device and the Aux In Jack of this unit and start playing the music.

Note: The LED display will show "Line"

Bluetooth Operation

1. Press the Mode Button repeatedly to select Bluetooth mode.

Note: The LED display will flash "blue"

2. Turn on the Bluetooth feature of your audio device, search for "CROSLEY CR7023A" and pair.
3. Once your device is successfully paired with the unit, you will hear a short confirmation sound from the unit.
4. Play and stream music from your device to the unit.

Note:

Bluetooth version – 5.0

Turntable Operation

1. Press the Mode Button repeatedly to select Phono mode.

Note: The LED display will show “Phon”

2. Set the Speed Switch accordingly.
3. Place the record on the turntable. Use the 45 RPM Adapter if necessary.
4. Remove the stylus protector from the stylus assembly.

Note: To avoid stylus damage, make certain the included stylus guard is in place whenever the turntable is being moved or cleaned.

5. Release the tonearm Hold Down Clip.

Note: When the turntable is not in use, remember to lock back the hold down clip.

6. Use the Tonearm Lever to lift up the tonearm.
7. Gently move the tonearm over the record where play is desired to begin. Set the Tonearm Lever back to the down position, the tonearm will descend slowly onto the record and begin to playback.
8. When the record is finished playing, use the Tonearm Lever again to raise the tonearm and then return it to the Tonearm Rest. Release the lever to let the tonearm sit back at its rest. To suspend the playback, repeat the same steps.
9. Lock the Hold Down Clip to secure the tonearm.

Needle Replacement

Removing Needle

1. Gently pull down the front edge of the needle.
2. Pull needle forward.
3. Pull out and remove.

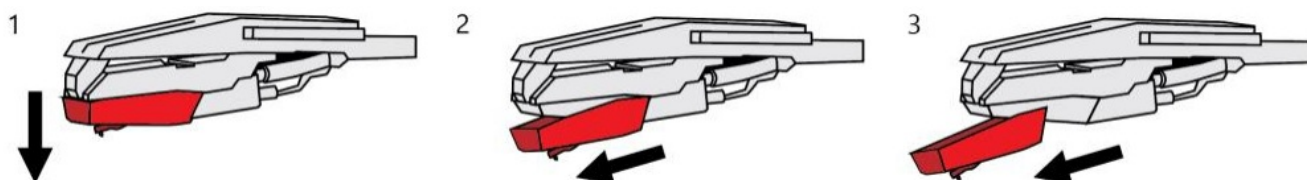

Installing Needle

1. Position the needle with its tip facing down.
2. Line up the back of the needle with the cartridge.
3. Insert the needle with its front end at a downward angle and gently lift the front of the needle upward until it snaps into place.

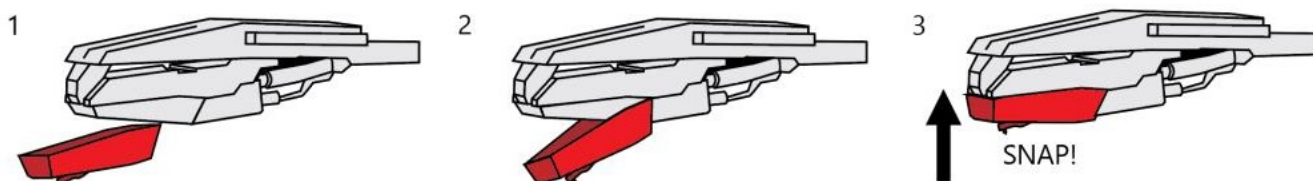

Radio Operation

1. Press the Mode Button repeatedly to select Radio mode.

Note:

- The LED display will show “AM Tune” for AM.
 - The LED display will show “FM Tune” for FM.
2. Rotate the Tuning Knob for the desired radio station.

Note:

1. The unit is equipped with a FM wire antenna. To improve FM reception, move the wire around until the reception is clear without interferences. Do not connect the wire to any additional antenna.
2. The AM antenna is built inside the unit. If AM reception is poor, try to rotate the unit for better reception.

CD Playback Operation

1. Press the Mode Button repeatedly to select CD mode.
2. Press the Open/Close button to open the CD tray and put the CD in the tray with the labeled side facing up.
3. Press the Open/Close button again to close the tray. The LED display will show “Load” for a few seconds. If it is a blank CD or an unrecognizable CD, it will show “Err”.

Note: MP3 or similar types of digital audio files cannot be read by the CD player.

4. During the playback, press the Play/Pause button to pause and press it again to resume playback.
5. To skip to the next or previous track, press the Forward Skip or Backward Skip button correspondingly.
6. Press the Stop button if you want to completely stop playback.

Cassette Operation

1. Press the Mode Button repeatedly to select Tape mode.

Note: The LED display will show “Tape”

2. Insert the prerecorded cassette through the cassette door and it will start playing automatically.
3. To fast forward, press the cassette Eject/F.F button half way in. To stop fast forwarding and return to the playback mode, press the button again.

Note: To rewind the cassette, you would need to reject the tape and flip it over for the other side and fast forward.

4. To stop the playback and eject the cassette, press the Eject/F.F. button all the way in.
5. When one side of the cassette finishes playing, it will stop automatically. Note: Remove the cassette from the cassette holder when it is not in use.

Turntable Maintenance

1. Do not touch the stylus tip with your fingers. Avoid bumping the stylus on the turntable mat or a record's edge.
2. Clean the stylus frequently with a soft brush with a back-to-front motion only.
3. Clean the records to get rid of dust or grease with a record cleaning brush and record cleaning solution.
4. Clean the turntable lid and turntable cabinet with a slightly dampened microfiber cloth.

Note: Do not use a cleanser that contains alcohol, benzene, or any other harsh chemicals, which might damage the paint and finish of the turntable.

** Crosley offers a product line of different cleaning accessories. Please ask your retailer or check out our website www.crosleyradio.com for more cleaning product information.

Troubleshooting

- **There is no power**

- No power at the power outlet.
- To help save power consumption, some models will comply with the ERP energy saving standard. When there is no audio input for 20 minutes, the power will automatically cut-off. To turn power back on and resume playing, turn off the main power switch and turn it on again.

- **Power is on, but the platter does not turn**

- Turntable mode is not selected.
- Turntable's drive belt has slipped off.

- **Turntable is spinning, but there is no sound, or sound not loud enough**

- Stylus protector is still on.
- Tone arm is lifted up by the lever.
- Turn up the volume knob.

- **CD does not play**

- Function mode is not set to CD.
- The CD is blank.
- The CD is placed on the tray incorrectly with the label side facing down.
- The CD has unsupported digital audio files like MP3 and similar types of format.
- The CD has too many scratches or is dirty.

- **Cannot pause the cassette**

The feature is not available and you have to stop the cassette completely.

FCC Statements

This device complies with part 15 of the FCC Rules. Operation is subject to the following two conditions:

1. This device may not cause harmful interference, and
2. this device must accept any interference received, including interference that may cause undesired operation.

Note: This equipment has been tested and found to comply with the limits for a Class B digital device, pursuant to part 15 of the FCC Rules. These limits are designed to provide reasonable protection against harmful interference in a residential installation. This equipment generates, uses and can radiate radio frequency energy and, if not installed and used in accordance with the instructions, may cause harmful interference to radio communications. However, there is no guarantee that interference will not occur in a particular installation. If this equipment does cause harmful interference to radio or television reception, which can be determined by turning the equipment off and on, the user is encouraged to try to correct the interference by one or more of the following measures:

- Reorient or relocate the receiving antenna.
- Increase the separation between the equipment and receiver.
- Connect the equipment into an outlet on a circuit different from that to which the receiver is connected.
- Consult the dealer or an experienced radio/TV technician for help.

Note: The Grantee is not responsible for any changes or modifications not expressly approved by the party responsible for compliance. such modifications could void the user's authority to operate the equipment. The device has been evaluated to meet general RF exposure requirement. To maintain compliance with FCC's RF exposure guidelines, the distance must be at least 20 cm between the

radiator and your body, and fully supported by the operating and installation configurations of the transmitter and its antenna(s).

SIMPLIFIED EU DECLARATION OF CONFORMITY

Hereby, Modern Marketing Concepts Inc. dba Crosley Brands, declares that the radio equipment type is in compliance with Directive 2014/53/EU. The full text of the EU declaration of conformity is available at the following internet address: <http://crosleybrands.com/euDoC>

Documents / Resources

	<p>CROSLEY CR7023A Serenade Record Player [pdf] Instruction Manual CR7023A, AUSCR7023A, CR7023A Serenade Record Player, CR7023A, Serenade Record Player, Record Player, Player</p>
---	--

References

- crosleyradio.com
- crosleyradio.com/
- [User Manual](#)

Manuals+, Privacy Policy

This website is an independent publication and is neither affiliated with nor endorsed by any of the trademark owners. The "Bluetooth®" word mark and logos are registered trademarks owned by Bluetooth SIG, Inc. The "Wi-Fi®" word mark and logos are registered trademarks owned by the Wi-Fi Alliance. Any use of these marks on this website does not imply any affiliation with or endorsement.