



CREATIVE BT-W3 Bluetooth 5.0 USB-C Audio Transmitter User Guide

[Home](#) » [Creative](#) » CREATIVE BT-W3 Bluetooth 5.0 USB-C Audio Transmitter User Guide 

CREATIVE®

BT-W3
Bluetooth® 5.0 Audio Transmitter
Model No: SA0160
QUICK START GUIDE

Hereby, Creative Labs Pte. Ltd. declares the Bluetooth Audio Transmitter, model no. SA0160 is in compliance with Directive 2014/53/EU. The full text of the EU declaration of conformity is available at <http://www.creative.com/EUDoC>

Contents

- [1 Overview](#)
- [2 Device Setup](#)
- [3 Product Registration](#)
- [4 Technical Specification](#)
- [5 Documents / Resources](#)
 - [5.1 References](#)
- [6 Related Posts](#)

Overview

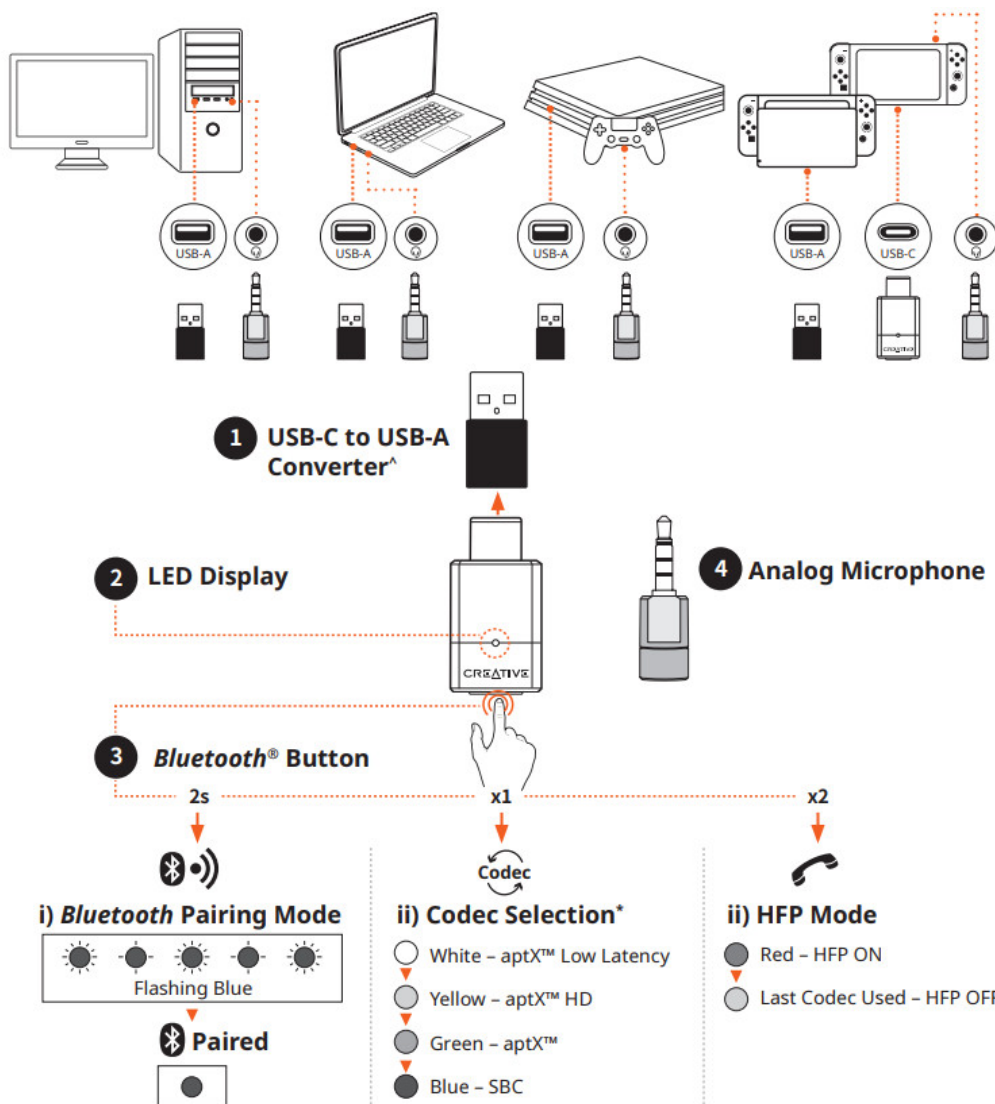

Note:

[^] USB-C to USB-A Converter is meant for USB data transfer only and does not support USB-PD charging. Do not use the converter for anything other than the intended purpose.

* Press and hold for 5s to perform Master Reset. The device LED will flash in red, then revert to Bluetooth Pairing mode. Creative BT-W3 will revert to the last codec used upon exiting HFP mode, or when plugged into an available USB port after device removal.

Device Setup

PS4™, PS4 Pro, PS4 Slim Setup

- Connect Creative BT-W3 to an available USB port
- On the console: Settings > Devices > Audio Devices> Uncheck “Switch Output Device Automatically” > Ensure that “Output Device” is shown as “USB Headset (Creative BT-W3)”
- Connect the bundled 3.5 mm Analog Microphone 1 to the PS4 controller’s headset jack
- Select Output to Headphones > All Audio

Nintendo Switch™ Setup

Enabling Voice Chat2:

- Connect Creative BT-W3 to the PC’s USB port

- Download and install HFP-off 3 firmware from creative.com/support/BTW3. Follow the instructions on-screen to install the firmware
- Unplug Creative BT-W3 from the PC and plug it into Nintendo Switch's USB port
- Connect the bundled 3.5 mm Analog Microphone to the console's headset jack

Note:

1. Reconnect either device if necessary.
2. The voice chat function is title-dependent. Please ensure that the voice chat function is already enabled in the respective application's settings.
3. Please note that HFP-off firmware will disable the HFP function on your Creative BT-W3. To enable HFP mode again, install the HFP-on firmware available on creative.com/support/BTW3.

Product Registration

Registering your product ensures you receive the most appropriate service and product support available. You can register your product at creative.com/register. Please note that your warranty rights are not dependent on registration.

Other Information

Please visit creative.com/compliance/BTW3 for the user guide, safety, and regulatory information.

Warranty

Warranty information is supplied with your product in a separate document. Please keep your Proof of Purchase for the duration of the Warranty Period.

Keep this document for future reference.



The use of the WEEE Symbol indicates that this product may Bruken av WEEE-symbolet indikerer at dette produktet ikke kan Clignotant bleu not be treated as household waste. By ensuring this product is disposed of correctly, you will help protect the environment. For more detailed information about the recycling of this product, please contact your local authority, your household waste disposal service provider, or the shop where you purchase the product.

Technical Specification

Operating Frequency: 2402–2480 MHz

Wireless Technology: Bluetooth 5.0

Bluetooth Profiles:

- A2DP (Wireless Stereo Bluetooth)
- AVRCP (Bluetooth remote control ^)
- HFP (Hands-Free Profile)

Audio Codec *: SBC, aptX, aptX Low Latency, aptX HD

Operating Range: Up to 30m / 100 ft (unobstructed line-of-sight)

Operating Temperature: 0–45°C

Max. RF Output Power: 8 dBm

Input: 5V  100 mA

^Controlled from the connected receiver

*Receivers must be able to support the mentioned codecs to use them

© 2020 Creative Technology Ltd. All rights reserved. Creative and the Creative logo are trademarks or registered

trademarks of Creative Technology Ltd in the United States and/or other countries. Qualcomm ® aptX™ is a product of Qualcomm Technologies, Inc. and/or its subsidiaries. Qualcomm is a trademark of Qualcomm Incorporated, registered in the United States and other countries. aptX is a trademark of Qualcomm Technologies International, Ltd., registered in the United States and other countries. The Bluetooth ® word mark and logo are owned by the Bluetooth SIG, Inc. and any use of such marks by Creative Technology Ltd is under license. All other trademarks are the property of their respective owners and are hereby recognized as such. All specifications are subject to change without notice. The actual product may differ slightly from the images shown. Use of this product is subject to a limited warranty.

Documents / Resources

| | |
|---|---|
|  | <p>CREATIVE BT-W3 Bluetooth 5.0 USB-C Audio Transmitter [pdf] User Guide BT-W3, Bluetooth 5.0 USB-C Audio Transmitter</p> |
|---|---|

References

- [△ Creative Worldwide SupportCreative BT-W3](#)
- [△ Creative Technology - Declaration of Conformity](#)
- [△ Creative Worldwide Support - Creative BT-W3](#)