



# CREATE Wipebot Smart Window Cleaning Robot User Guide

[Home](#) » [CREATE](#) » CREATE Wipebot Smart Window Cleaning Robot User Guide 

## Contents

- 1 [CREATE Wipebot Smart Window Cleaning Robot](#)
- 2 [PRODUCT OVERVIEW](#)
- 3 [PART LIST](#)
- 4 [REMOTE CONTROL](#)
- 5 [INSTALLATION INSTRUCTIONS](#)
- 6 [OPERATION INSTRUCTIONS AND ATTENTIONS](#)
- 7 [Documents / Resources](#)
- 8 [Related Posts](#)

# CREATE

## CREATE Wipebot Smart Window Cleaning Robot



## PRODUCT OVERVIEW

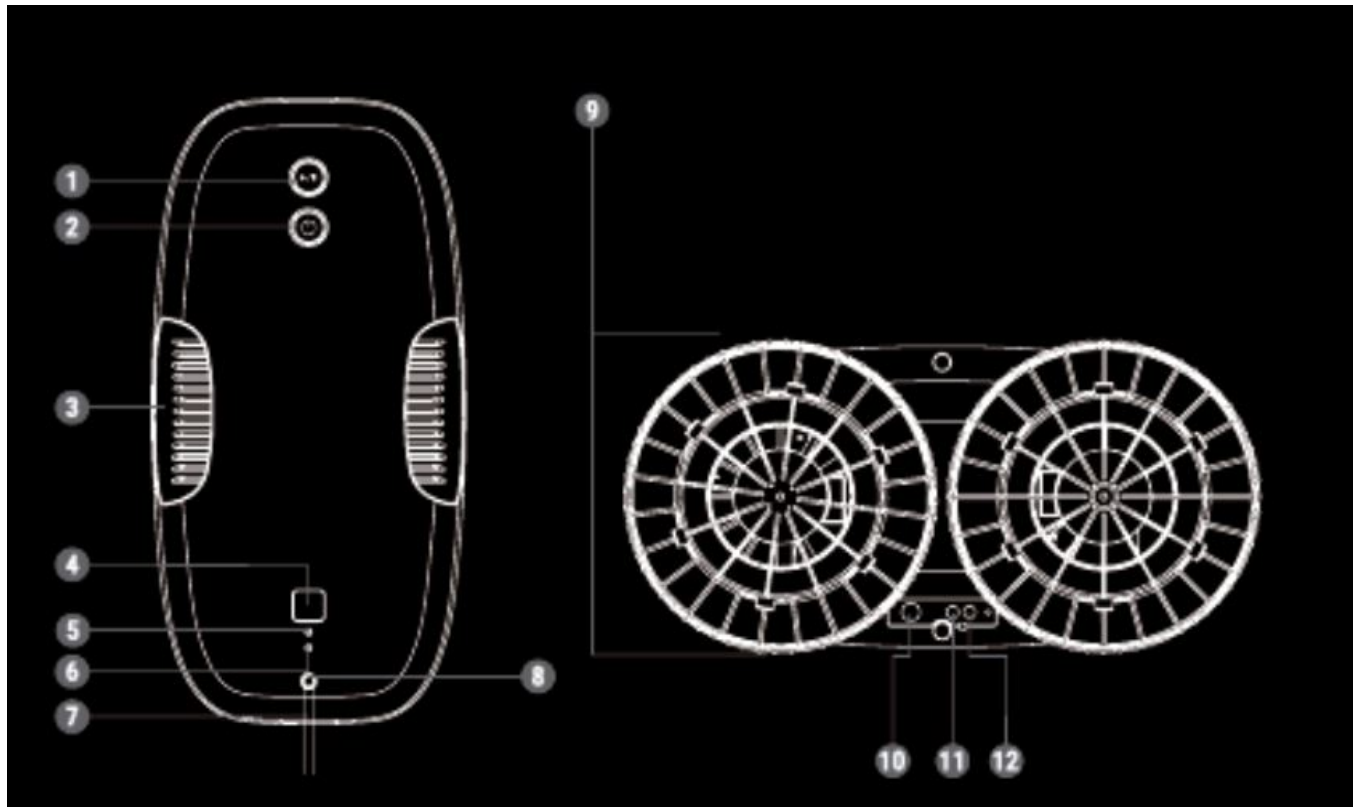

1. Start / Pause button
2. ON / OFF power button
3. Air outlet
4. Signal receiver
5. Charging indicator

6. Error indicator
7. Power line
8. Safety rope mounting hole
9. Mop holder
10. Bottom signal receiver
11. Bottom error indicator (green)
12. Bottom error indicator (red)

## PART LIST

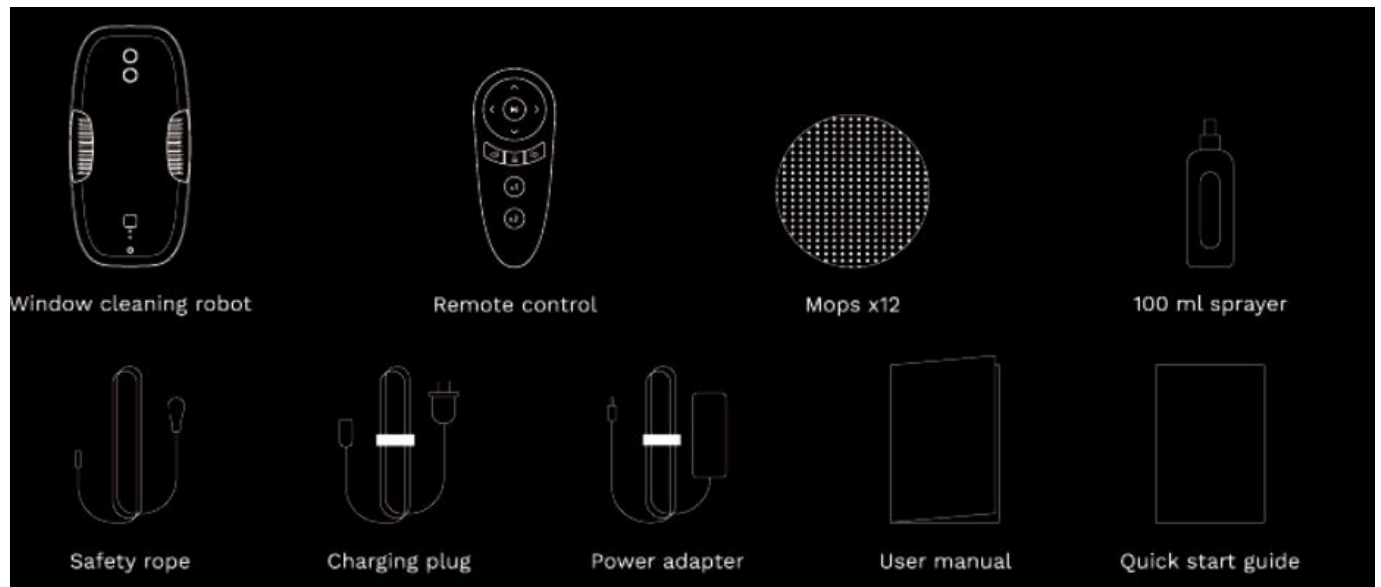

## REMOTE CONTROL



- Pause/Continue
- (1) Clean once
- Move down to the end of the glass \*

- Clean twice
- Move up to the end of the glass\*
- Move left to the end of the glass \*
- Move right to the end of the glass \*
- Continue cleaning and move up from the current position
- Continue cleaning and move left from the current position
- Continue cleaning and move right from the current position

## INSTALLATION INSTRUCTIONS



1. Cover the holder with a mop.
2. Install the mop holders covered with a mop to the round cleaning roller. After installation, stand beside and observe the Connection between the mop holder and the cleaning roller. Ensure they are toughly connected and flush with each other,and have no air leakage.
3. Insert the windows cleaner power cord to the end of the adapter and tighten them.
4. Ensure the knob of the safety rope is fully tightened to the frame. We recommend to fasten the buckle side of the safety rope to an object which is strong enough and will not be dragged, and reserve a suitable length for the device to work.

## OPERATION INSTRUCTIONS AND ATTENTIONS

1. SAFETY ROPE. Carefully inspect the safety rope, ensure there's no damage on it and that it is toughly buckled to an object.
2. INSPECTION OF THE WORKING ENVIRONMENT. Guarantee the glass is nos excessively wet. Don't use this device under the condition of rain or on a damaged glass or with cracks on it.  
When the product is working high above the ground at outside, it's necessary to set ground safety warnings which can avoid personal injuries caused by accident.
3. CLEANING. When there is no dust or sand on the glass, spray the glass directly, but do not make the mop or the glass all wet. Fill water in the sprayer and add some cleaning product. If there is dust or sand on the glass before starting using this robot, clean it with a dry cloth. Otherwise, the mops could mix the cleaning product moisture with the dirt and scratch or damage the glass.
4. GETTING STARTED. Ensure the power line and plug are completely connected. Long press the power button (more than 3 seconds), the robot will get started. After the fan is running, attach the robot to a location far away from the window frame. Ensure the robot is stuck on the window, and then release it. Press the Start button and the product will start running.
5. TAKING DOWN THE ROBOT. When the robot is running, hold the safety rope with one hand, and take down the robot with the other hand. If your hand can't reach the robot, please use the remote control or safety rope and pull it back. Pull the robot from one side which is as close to the glass as possible, prevent it from dropping out. After completely taking down the robot, long-press the power button (more than 3 seconds) to stop it.

6. POWER-OFF PROTECTION.This robot accidentally removed from the power cord andit will raise an audible and visual alarm. equipped with an internal battery, which can hold on the robot for twenty minutes in case the robot is Please take down the robot as soon as possible. When the electric quantity of the internal battery is too low to start the robot, please charge the built-in battery. Turn off the robot and connect it to the power line. When the blue lamp is flashing, it means that the robot is under the condition of charging; when the blue lamp is fixed, it means that the robot is fully charged. Copvfish

Documents / Resources

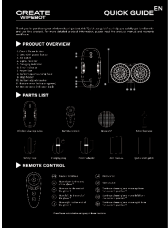

[CREATE Wipebot Smart Window Cleaning Robot](#) [pdf] User Guide  
Wipebot Smart Window Cleaning Robot