

**CREATE
Record
Player
Portable
Case**



CREATE Record Player Portable Case User Manual

[Home](#) » [CREATE](#) » CREATE Record Player Portable Case User Manual 

Contents

- [1 CREATE Record Player Portable Case](#)
- [2 Product Usage Instructions](#)
- [3 FAQ](#)
- [4 SECURITY INSTRUCTIONS](#)
- [5 PARTS LIST](#)
- [6 FUNCTIONING](#)
- [7 BLUETOOTH SETTINGS](#)
- [8 MAINTENANCE](#)
- [9 REPLACE THE HEAD NEEDLE](#)
- [10 Documents / Resources](#)
 - [10.1 References](#)
- [11 Related Posts](#)

CREATE

CREATE Record Player Portable Case



Specifications:

- **Model:** Record Player Pro
- **Speeds:** 33, 45, 78 RPM
- Bluetooth connectivity
- Auxiliary input
- Includes 45 RPM adapter

Product Usage Instructions

Security Instructions:

Always follow standard electrical safety precautions when using the record player.

Parts List:

1. Right speaker
2. Turntable
3. Turntable cover
4. 45 RPM adapter
5. Turntable arm
6. Left speaker
7. Power wheel/Volume controller
8. Turntable arm head
9. Turntable arm support
10. Speed selection
11. Automatic stop
12. Arm controller

Functioning:

1. Plug in the power cord.
2. Place a vinyl record on the turntable.
3. Select the desired speed (33, 45, or 78 RPM).
4. Turn on the turntable.
5. Lift the arm and place it on the record.

Bluetooth Settings:

1. Connect to Bluetooth by searching for "RECORD PLAYER PRO".
2. Confirm connection with a beep.
3. Control playback through the app.
4. To stop Bluetooth, remove the arm from the record.

Adapter 45 RPM:

1. Remove the adapter.
2. Insert it onto the turntable.
3. Place the 45 RPM record on the turntable.
4. Enjoy your music!

Auxiliary Input:

1. Turn on the turntable.
2. Connect an external audio device via AUX IN jack.
3. Adjust volume using the power wheel or external device controls.

FAQ

Problem: The turntable arm does not move properly.

Solution: Check if the arm holder lock is released and the arm is placed correctly on the record.

Problem: Bluetooth connection fails.

Solution: Ensure proper pairing by following the Bluetooth settings instructions. Remove and reconnect the device if needed.

Problem: No sound from speakers.

Solution: Check the volume settings on both the device and speakers. Make sure all connections are secure.

Thank you very much for choosing our turntable. Before using this product, read the instructions carefully for its correct use.

The included safety precautions reduce the risk of electric shock, injury, and even death if strictly followed. Please keep this manual in a safe place for future reference, along with your completed product warranty card, original product packaging, and proof of purchase. If possible, give these instructions to the next owner of the appliance. Always follow basic safety precautions and accident prevention rules when using an appliance. We decline all liability arising from non-compliance with these instructions by clients.

SECURITY INSTRUCTIONS

Before using any electrical appliance, basic safety precautions should always be observed.

- If the cable of the product is damaged, do not repair it yourself, contact technical service for repair.
- Both the appliance and the power cable must always be easily accessible.
- This device is not intended for use by persons (including children) with reduced physical, sensory or mental capabilities or lack of experience and/or knowledge, unless they have been given supervision or instruction concerning use of the appliance in a safe way and understand the hazards involved.
- Children should always be supervised to ensure that they do not play with the device.
- This appliance should not be exposed to dripping or splashing water.
- Objects filled with liquid, such as vases, should not be placed on the device.
- Always leave a minimum distance of 10 cm around the unit to ensure sufficient ventilation.
- Sources of open flame, such as candles, should not be placed on top of the device.
- The device is designed to be used only in a temperate climate.
- Listening to the device at full volume for a long time may damage the user's hearing and cause hearing problems (temporary or permanent deafness, tinnitus, hyperacusis). Therefore, we recommend not listening to the device at high audio volume for more than one hour a day.
- Only qualified persons are authorized to install or repair this product.
- Shutdown in restricted areas: Turn off the device when the use of mobile devices is not permitted or when there is a risk of causing interference or danger, for example on board an aircraft, near medical equipment, fuel, chemicals or explosion sites.
- All wireless devices are susceptible to interference which can affect their performance.
- Accessories: Only use chargers or other accessories that are compatible with this equipment. Never connect incompatible products.
- Keep equipment dry: This equipment is not waterproof. Always keep it in a dry place away from areas that could be wet.
- Keep your device in a safe place, out of the reach of small children. The device contains small parts that may present a choking hazard.

PARTS LIST

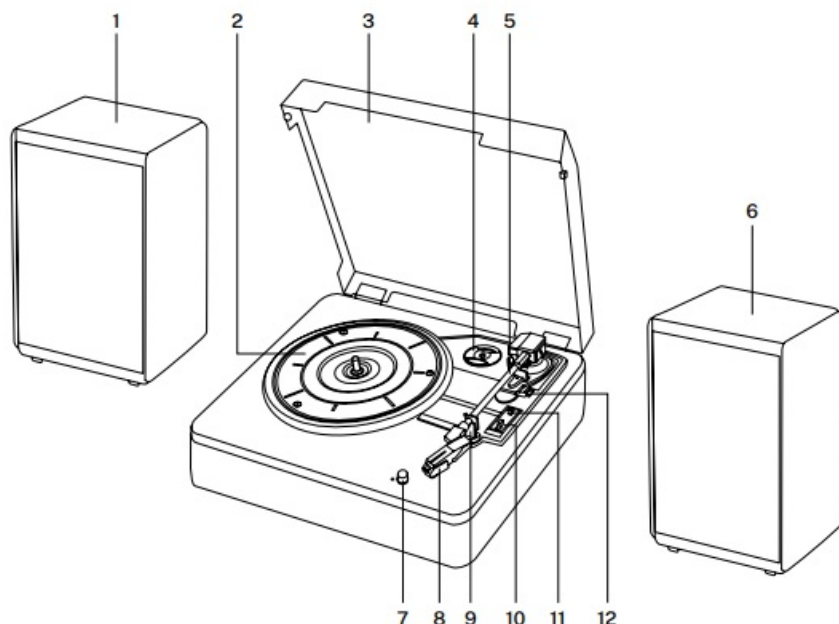

1. Right speaker
2. Turntable
3. Turntable cover
4. 45 RPM adapter
5. Turntable arm
6. Left speaker
7. Power wheel / Volume controller
8. Turntable arm head
9. Turntable arm support
10. Speed selection
11. Automatic stop
12. Arm controller

FUNCTIONING

1. Plug the power cord of the turntable into the electrical outlet.
2. Place the vinyl record of your choice on the turntable.
3. Set the speed you want for your vinyl record playback using the speed selection switch. You can choose between 33, 45 and 78 RPM.
4. Turn on the turntable with the power knob, note that this also controls the volume. After-wards a beep will sound, this means that the turntable is in Bluetooth mode on.
5. Release the lock of the turntable arm holder, lift the arm slightly with your hand, and place the needle head vertically over the first track of the record, the turntable will start rotating automatically. The turntable will switch to vinyl mode and Bluetooth mode will be disabled. Once the arm of the turntable is placed on the vinyl, it will begin to play the music on the vinyl.
6. When a recording reaches the end, the turntable will stop automatically.
7. Lift the arm of the turntable and put it back on the armrest, the turntable will switch back to Bluetooth on mode.
8. Replace the turntable arm support lock.
9. Turn off the turntable with the power switch and disconnect from the mains power supply.

BLUETOOTH SETTINGS

1. Connect your device's Bluetooth, search "RECORD PLAYER PRO" and link the turntable to your device.
2. A beep will sound to confirm that the device has been connected correctly.
3. Through the APP you can play or pause the turntable and switch between songs.
4. To deactivate the device and stop Bluetooth, simply remove the turntable arm from the vinyl area.

ADAPTER 45 RPM

The 45 RPM adapter allows you to play smaller vinyl records, known as singles.

1. Remove the 45 RPM adapter.
2. Insert the 45 RPM adapter onto the turntable.
3. Gently place the 45 rpm record into the turntable.
4. Place the turntable arm head on the vinyl and you can enjoy your vinyl.

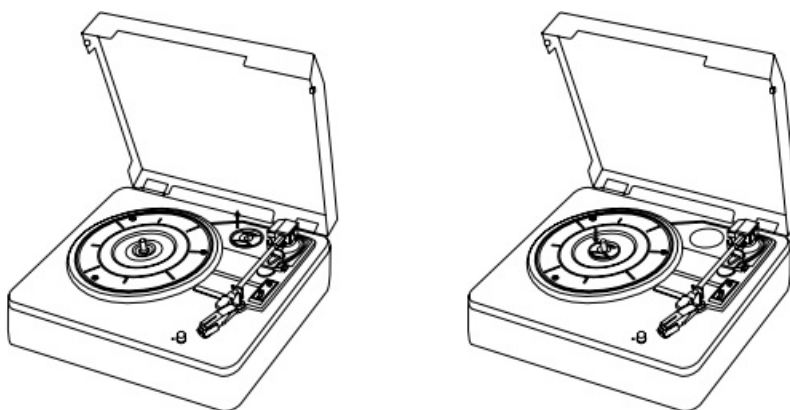

AUXILIARY INPUT

1. Turn on the turntable with the power knob.
2. Using a 3.5mm stereo cable, connect the external audio device to the AUX IN jack on the back of the device.
3. Use the power wheel to adjust the music volume or use the external audio device controllers to control the playback/volume functions.

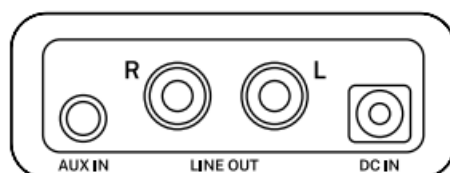

MAINTENANCE

- It is recommended that you clean your vinyl records with an anti-static cloth for maximum enjoyment and longevity.
- For maximum durability, your stylus should be replaced periodically (approximately every 250 hours).
- Remove dust from the stylus occasionally using a very soft brush dipped in alcohol, brushing from the back of

the cartridge to the front.

REPLACE THE HEAD NEEDLE

In addition to deterioration in sound quality, vinyl records may also suffer damage as the tip of the stylus wears out. It is recommended to change this needle every 3 or 4 months of continuous use of the turntable. These needles are easily found in specialized stores and websites.

Note: Before changing the needle, be sure to disconnect the product from the power outlet.

1. Release the turntable arm headlock.
2. Lift the turntable arm up and, to remove the needle, hold the turntable head firmly.

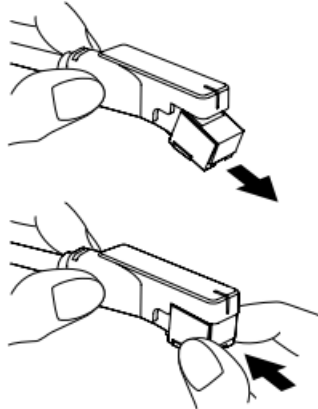

3. Pull out the front of the needle in a forward and downward motion.
4. Install the new replacement needle the same way you removed the old one. Raise the needle until you hear a click.

Make sure the stylus is securely installed and there is no gap between the new stylus and the turntable arm head.

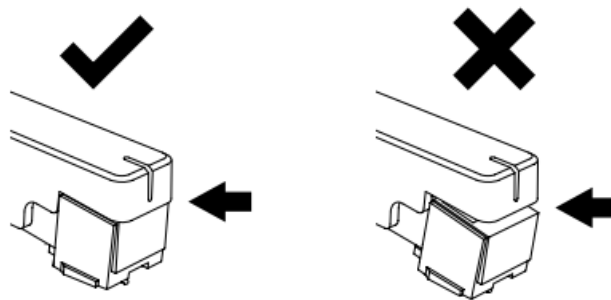

PROBLEM RESOLUTION

The device is connected but does not work.

- Make sure the turntable is connected to power and check that you have turned it on and turned up the volume.

A strange sound is heard through the speakers.

- Check that the vinyl record is not damaged.
- Make sure the needle is in good condition and should not be replaced. (The needle should be replaced every 3~4 months of continuous use.)

- Do not set the volume to maximum to avoid sound distortion.

In compliance with Directives: 2012/19/EU and 2015/863/EU on the restriction of the use of dangerous substances in elec-tric and electronic equipment as well as their waste disposal. The symbol with the crossed dustbin shown on the package indicates that the product at the end of its service life shall be collected as separate waste. Therefore, any products that have reached the end of their useful life must be given to waste disposal centres specialising in separate collection of waste electrical and electronic equipment, or given back to the retailer at the time of purchasing new similar equipment, on a one for one basis. The adequate separate collection for the subsequent start-up of the equipment sent to be recycled, treated and disposed of in an environmentally compatible way contributes to preventing possible negative effects on the environment and health and optimises the recycling and reuse of components making up the apparatus. Abusive disposal of the product by the user involves application of the administrative sanctions according to the laws.



Documents / Resources

<div><div>CREATE</div><div></div><div>Record Player Pro</div><div>User manual Manual de instrucciones</div></div>	<div>CREATE Record Player Portable Case [pdf] User Manual</div> <div>Record Player Portable Case, Player Portable Case, Portable Case, Case</div>
---	---

References

- [User Manual](#)

[Manuals+.](#) [Privacy Policy](#)

This website is an independent publication and is neither affiliated with nor endorsed by any of the trademark owners. The "Bluetooth®" word mark and logos are registered trademarks owned by Bluetooth SIG, Inc. The "Wi-Fi®" word mark and logos are registered trademarks owned by the Wi-Fi Alliance. Any use of these marks on this website does not imply any affiliation with or endorsement.