



**40830 Light
Up Tracing
Pad**



Crayola 40830 Light Up Tracing Pad User Manual

[Home](#) » [Support](#) » Crayola 40830 Light Up Tracing Pad User Manual 

Contents

- [1 Crayola 40830 Light Up Tracing Pad](#)
- [2 Product Overview](#)
- [3 Contents](#)
- [4 How to Use Your Light-Up Tracing Pad](#)
- [5 Insert Batteries](#)
- [6 FCC](#)
- [7 FAQs](#)
- [8 References](#)
- [9 Related Posts](#)



Crayola 40830 Light Up Tracing Pad



Product Overview

On/Off Switch
Interrupteur ON/OFF
Interruptor de
encender/apagar (on/off)

Light Screen
Écran lumineux
Pantalla con luz

Battery Case
Compartiment des piles
Compartimiento de pilas

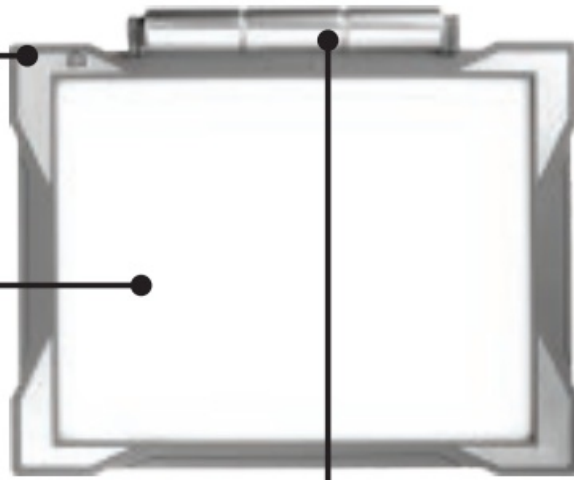

Contents

- 10 Design Template Sheets

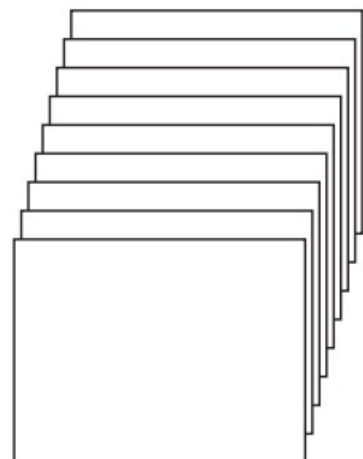
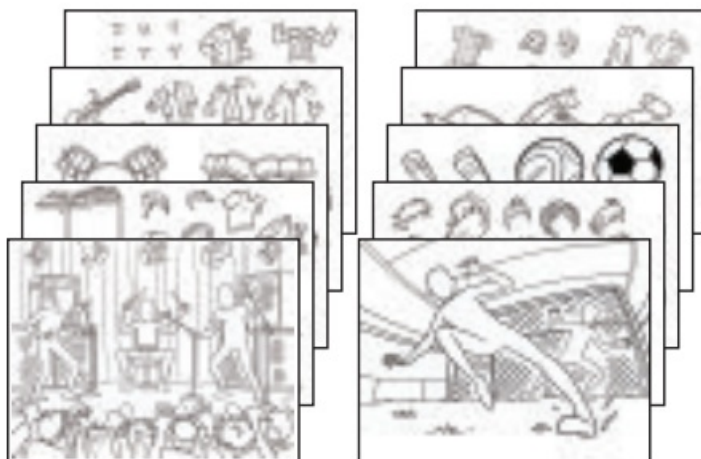

- 10 Blank Tracing Sheets
- 12 Colored Pencils

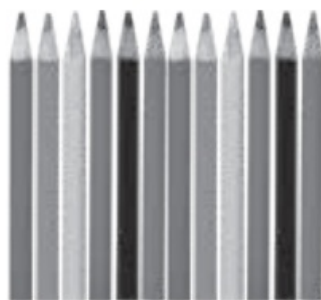

- Graphite Pencil

Plus more tracing sheets at: [Crayola.com/tracing](https://www.crayola.com/tracing)

Additional Items Needed: 3 AA alkaline batteries & Phillips screwdriver (Not included)

How to Use Your Light-Up Tracing Pad

1. Slide light switch to “On” position.



2. Lay a design sheet on the screen. Cover with a blank tracing sheet.



3. Trace, then replace! Swap the first design sheet with new ones to add different details.



4. When your design is just the way you want, color it in.



Insert Batteries

CAUTION: BATTERIES MUST BE INSTALLED BY AN ADULT ONLY.

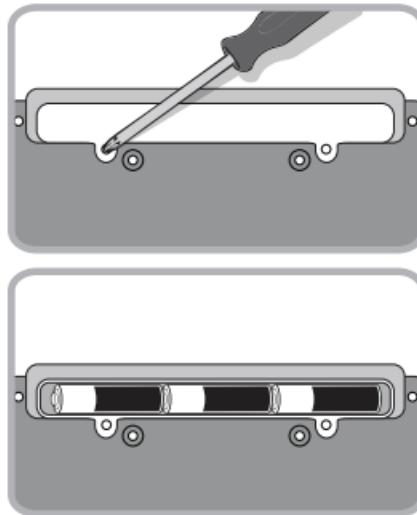

1. Use Phillips screwdriver (not included) to loosen the battery cover screws underneath the pad.
2. Remove the used batteries and dispose of them properly. Insert three (3) AA alkaline batteries. Ensure that the direction matches the diagram inside the battery case.
3. Replace battery cover and tighten the screws.

For Best Results

- Use one design sheet & one drawing sheet at a time.
- Trace outline lightly with a pencil & color as desired.
- Any standard writing or copier paper may be used with the Tracing Pad.
- Also use Crayola Crayons, Markers or Colored Pencils for tracing & coloring.
- Turn Tracing Pad to “Off” position when not in use.
- Wipe any marks or dust off screen with a soft, damp cloth. Do NOT immerse Tracing Pad in water

NO BATTERIES INCLUDED

The Wheelie Bin symbol indicates that the product and the batteries must not be disposed of with other household waste as they may contain elements that can hurt the environment and human health. Please use designated collection points or recycling facilities when disposing of the item and the batteries. To help locate your nearest facility see: www.recyclenow.com

FCC

CAUTION: changes or modifications not expressly approved by the party responsible for compliance could void the user's authority to operate the equipment.

NOTE: This equipment has been tested and found to comply with the limits for a Class B digital device, under Part 15 of the FCC Rules. These limits are designed to provide reasonable protection against harmful interference in a residential installation. This equipment generates, uses and can radiate radio frequency energy and, if not installed and used by the instructions, may cause harmful interference to radio communications. However, there is no guarantee that interference will not occur in a particular installation. If this equipment does cause harmful interference to radio or television reception, which can be determined by turning the equipment off and on, the user is encouraged to try to correct the interference by one or more of the following measures:

- Reorient or relocate the receiving antenna.
- Increase the separation between the equipment and the receiver.
- Connect the equipment to an outlet on a circuit different from that to which the receiver is connected.
- Consult the dealer or experienced radio/TV technician for help.

QUESTIONS/COMMENTS

U.S.A. & Canada: 1-800-CRAYOLA ([800-272-9652](tel:800-272-9652))

QUALITY GUARANTEE

We guarantee the quality of all Crayola products. If this product does not perform properly, please contact us M-F, 9 AM-4 PM ET/AEST:

- U.S.A. & CANADA (Call/Text): 1-800-CRAYOLA ([800-272-9652](tel:800-272-9652))
Text charges may apply.
- **AUSTRALIA:** 1-800-657-353
M-F, 9 AM-5 PM LOCAL TIME:
- **UK:** 0800 389 6238
- **ITALY:** +39 (0) 543 720997
- **MEXICO:** 800 7178 222
- **BENELUX:** +31 (0)104596 580
- **FRANCE:** +33 (0) 1 41 06 54 54
- **GERMANY:** +496103 459180

FAQs

What is the primary function of the Crayola 40830?

The Crayola 40830 is designed to help children trace images easily using its illuminated surface.

What materials are included with the Crayola 40830?

The Crayola 40830 comes with a coloring board, colored pencils, tracing sheets, and blank sheets.

What age group is the Crayola 40830 suitable for?

The Crayola 40830 is recommended for children aged 6 and up.

How does the Crayola 40830 improve visibility when tracing?

The Crayola 40830 features an LED light that illuminates the surface, enhancing visibility for tracing.

What kind of batteries does the Crayola 40830 require?

The Crayola 40830 requires 3 AA batteries, which are sold separately.

How do you turn on the Crayola 40830?

The Crayola 40830 has a simple on/off switch for easy operation.

Does the Crayola 40830 have adjustable brightness?

Some models of the Crayola 40830 may include adjustable brightness settings.

What is the purpose of the paper-locking frame in the Crayola 40830?

The paper-locking frame holds tracing paper in place for crisp tracing lines.

How can you clean the Crayola 40830?

You can wipe the surface of the Crayola 40830 with a soft, damp cloth to keep it clean.

What should you do if the Crayola 40830 flickers?

If the Crayola 40830 flickers, check the battery connections and replace the batteries if necessary.

How can the Crayola 40830 assist in developing drawing skills?

The Crayola 40830 allows children to practice tracing, which can enhance their drawing and fine motor skills.

Download this Manual: [Crayola 40830 Light Up Tracing Pad User Manual](#)

References

- [User Manual](#)

[Manuals+](#), [Privacy Policy](#)

This website is an independent publication and is neither affiliated with nor endorsed by any of the trademark owners. The "Bluetooth®" word mark and logos are registered trademarks owned by Bluetooth SIG, Inc. The "Wi-Fi®" word mark and logos are registered trademarks owned by the Wi-Fi Alliance. Any use of these marks on this website does not imply any affiliation with or endorsement.