



## Crate and Barrel Eli 60 Double Vanity ML User Manual

[Home](#) » [Crate and Barrel](#) » **Crate and Barrel Eli 60 Double Vanity ML User Manual** 

### Contents

- [1 Crate and Barrel Eli 60 Double Vanity ML](#)
- [2 Product Information](#)
- [3 Product Usage Instructions](#)
- [4 CONTENTS](#)
- [5 INSTRUCTIONS](#)
- [6 IMPORTANT SAFETY INSTRUCTIONS](#)
- [7 Cleaning and Care](#)
- [8 Documents / Resources](#)
  - [8.1 References](#)
- [9 Related Posts](#)

# Crate&Barrel

**Crate and Barrel Eli 60 Double Vanity ML**



### Specifications:

- Product Name: Bath Vanity
- Origin: Made in Vietnam
- Manufacturer Contact: 800.967.6696 | [crateandbarrel.com](https://www.crateandbarrel.com)

### Product Information

The Bath Vanity is a high-quality product designed to enhance your bathroom space. It comes with various components and hardware for assembly. Proper installation is crucial to prevent personal injury and property damage.

### Product Usage Instructions

- **Unpacking and Preparation:**

Identify all the components included in the box and place them on a carpeted or padded area to prevent damage during assembly.

- **Assembly:**

Follow the assembly instructions closely to ensure proper setup. Incorrect assembly can lead to safety hazards.

- **Mounting:**

For safe mounting, consult a qualified professional to install the Bath Vanity. Use appropriate wall anchors based on your wall type (plaster, drywall, concrete) and mount to wood studs.

- **Sink Attachment:**

Adhere the sink to the countertop using white caulk. Take your time and proceed slowly to ensure a secure attachment.

- **Cleaning and Maintenance:**

Clean surfaces with a dry or damp soft cloth. Avoid abrasive cleaners, furniture wax, or polish. Use coasters to protect the surface from heat and water. Periodically check and tighten hardware as needed.

## FAQ:

- Q: Can I install the Bath Vanity myself?

A: We highly recommend consulting a licensed professional for installation to ensure safety and proper setup.

- Q: How should I clean the Bath Vanity?

A: Use a soft cloth for cleaning; avoid abrasive cleaners, wax, or polish. Regularly check and tighten hardware as required.

This page lists the contents included in the box. Please take time to identify the hardware as well as the individual components of the product. As you unpack and prepare for assembly, place the contents on a carpeted or padded area to protect them from damage. Please follow the assembly instructions closely. Improper assembly can result in personal or property damage.

## CONTENTS

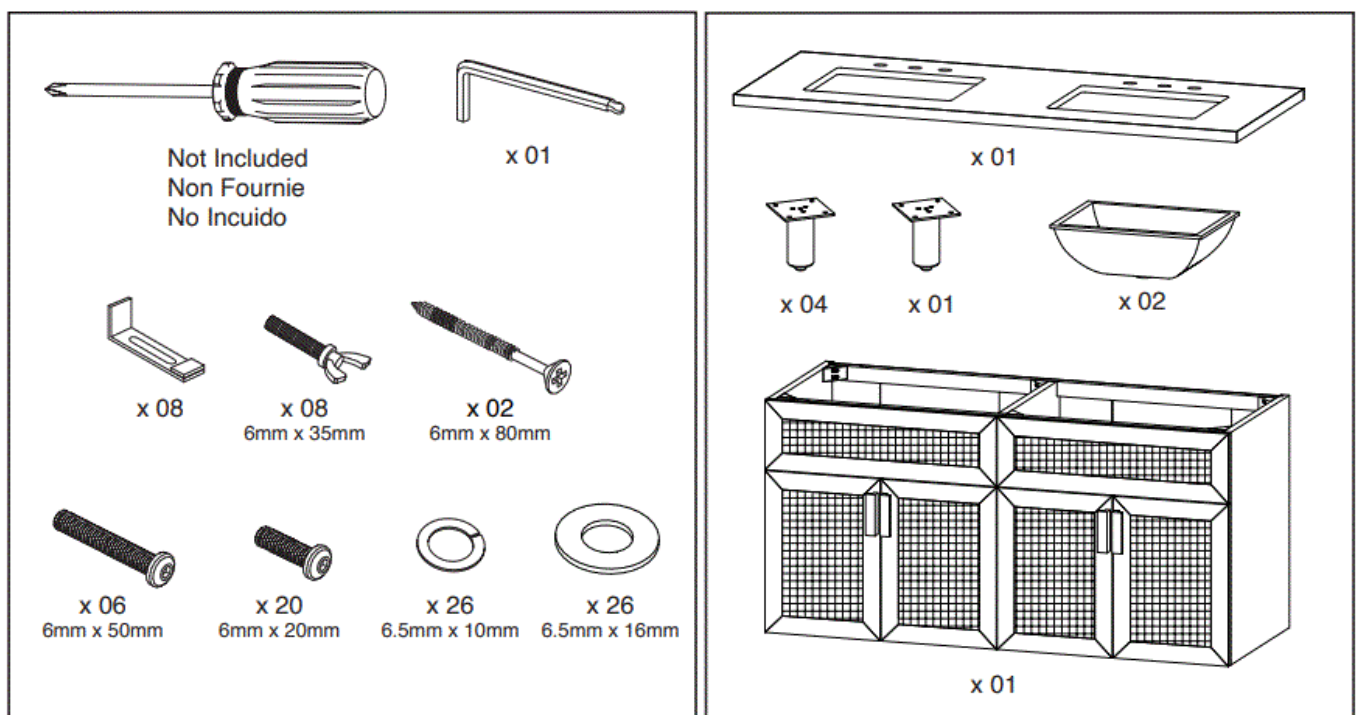

## IMPORTANT WARNING

- IT IS HIGHLY RECOMMENDED YOU CONSULT A QUALIFIED PROFESSIONAL TO ENSURE THAT THE VANITY IS INSTALLED PROPERLY.
- Improper installation can result in personal injury and property damage.
- For safe mounting, it is essential to use wall anchors appropriate to your wall type (i.e. plaster, drywall, concrete, etc.). Mount to wood studs.

## INSTRUCTIONS

1

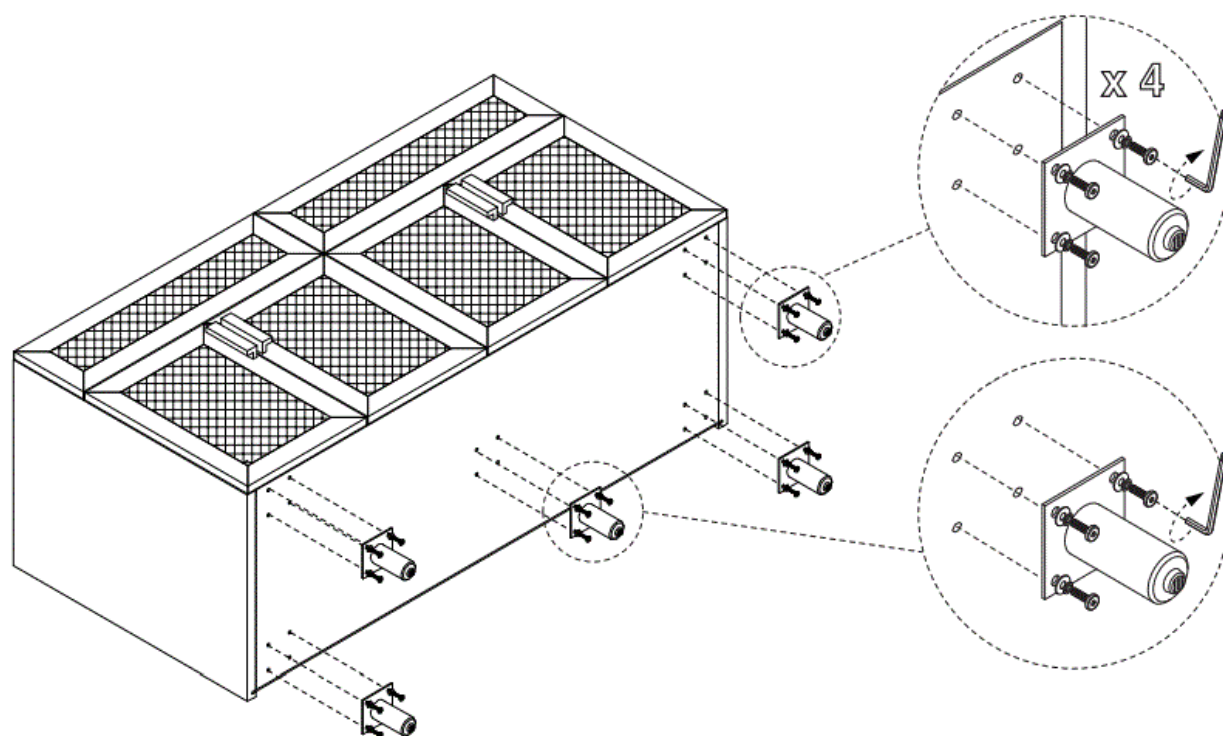

2

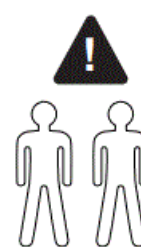
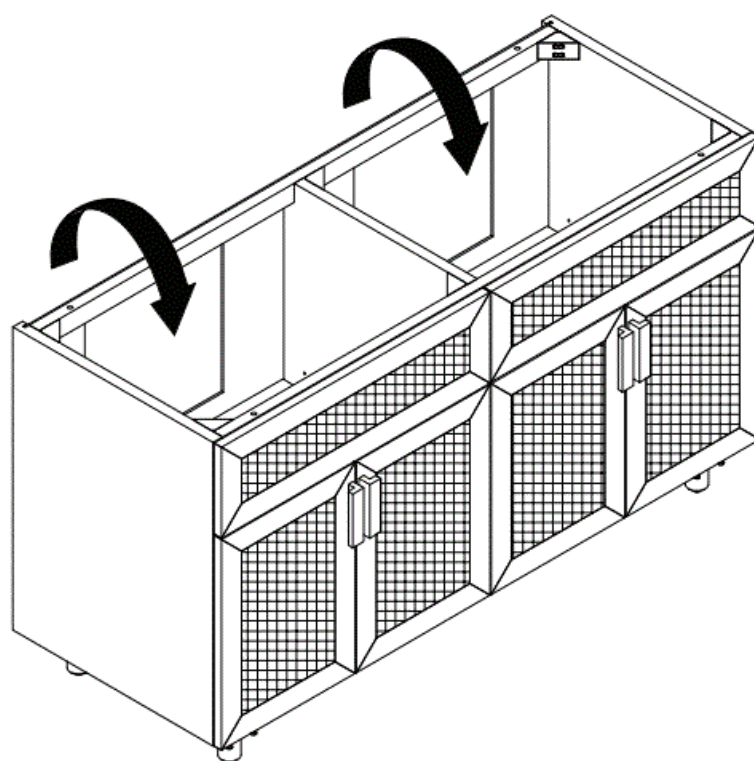

3

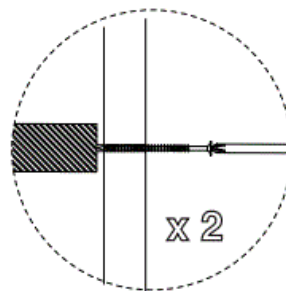
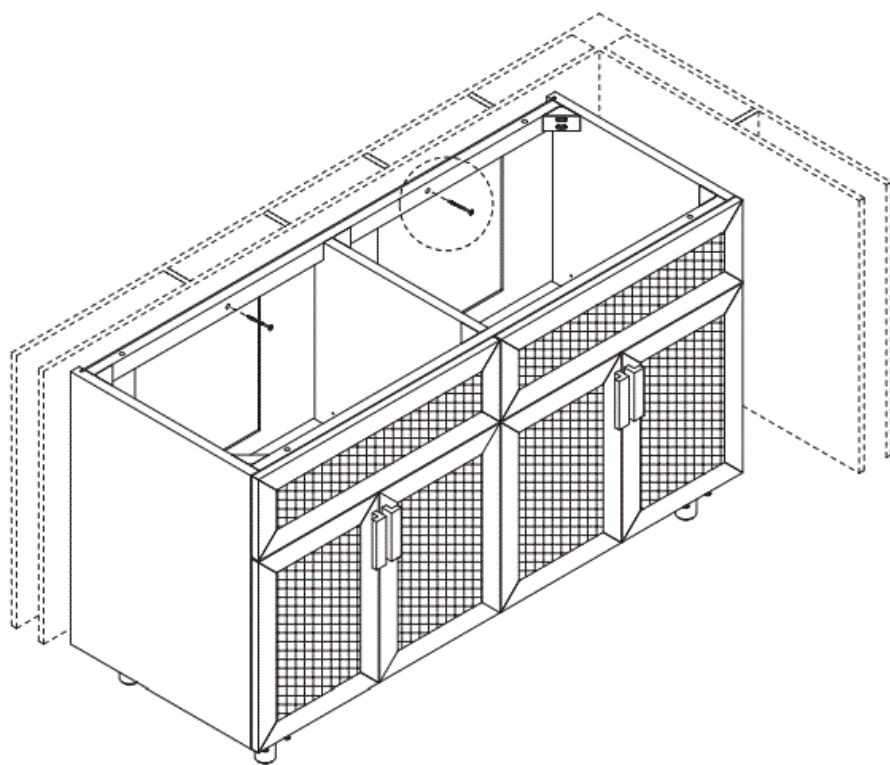

4

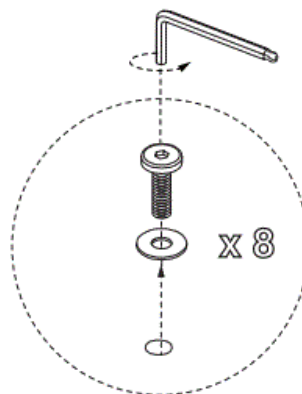
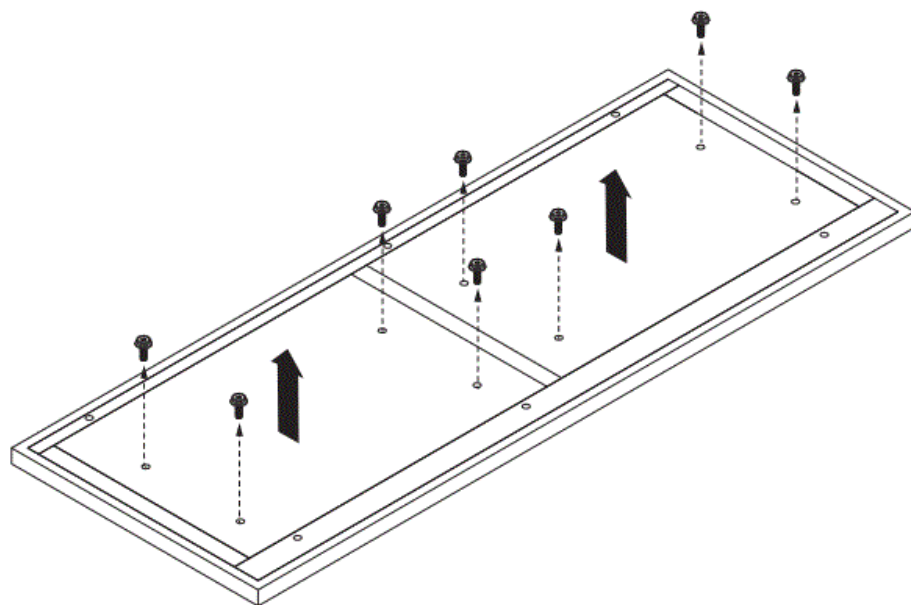

- ⑤ **⚠ NOTE:** Use white caulk to adhere sink to stone top

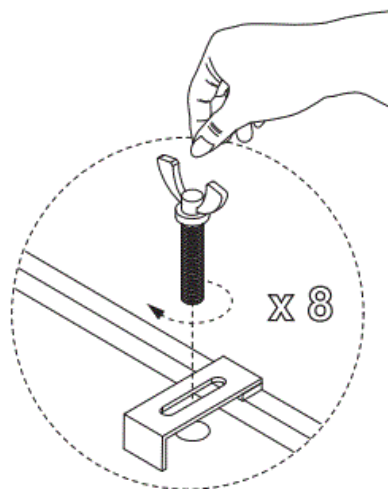
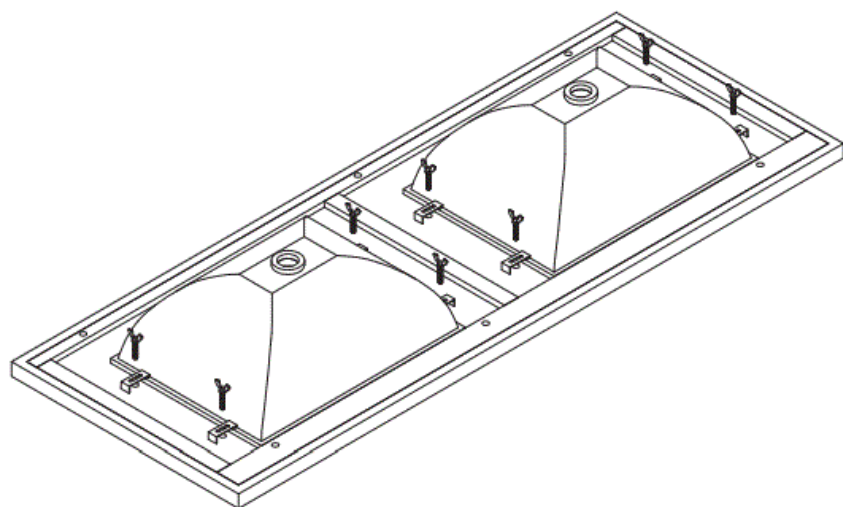

⑥

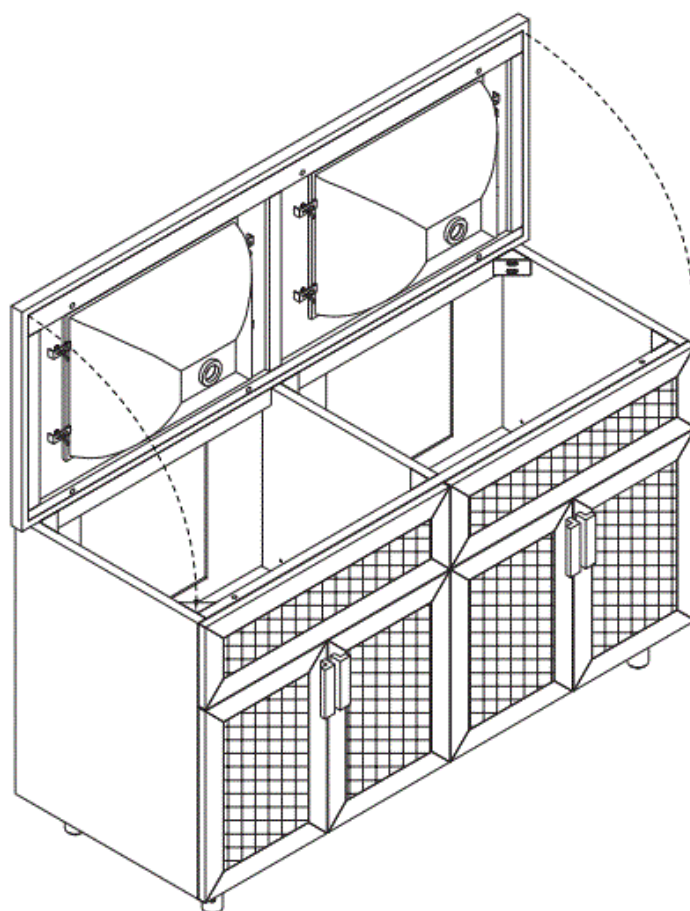

**⚠ SLOWLY**





⑦

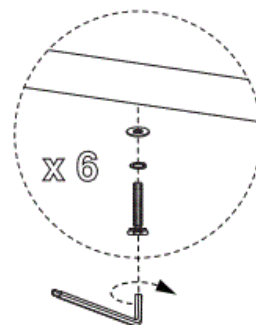
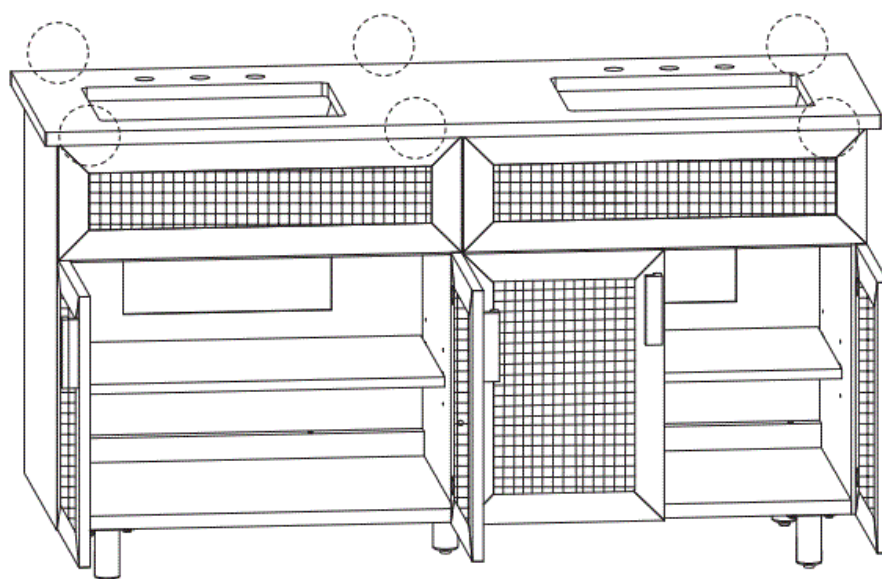

⑧

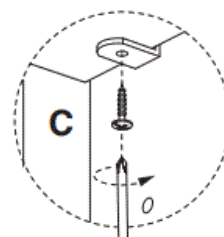
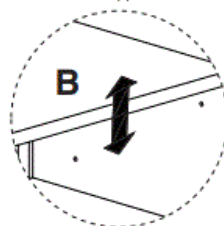
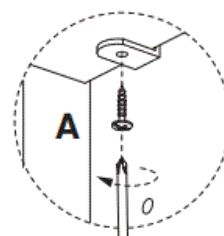
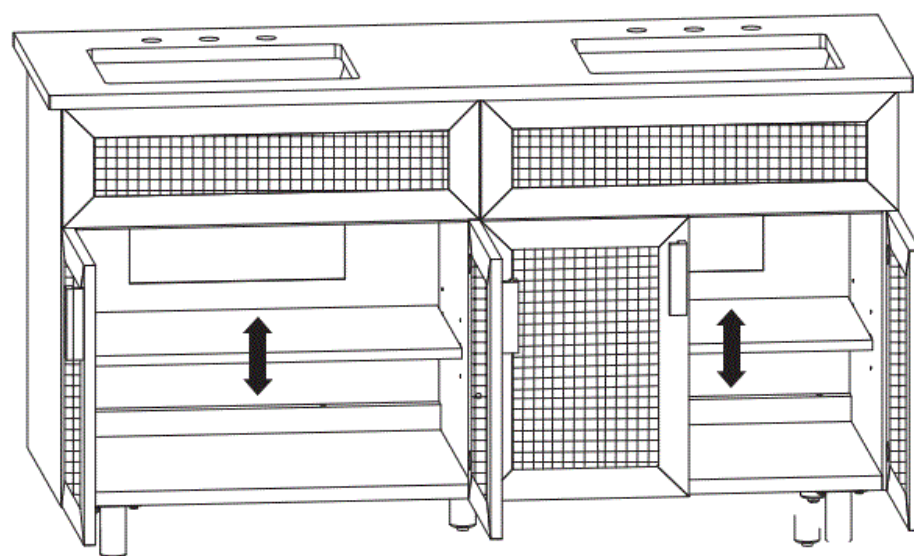

9

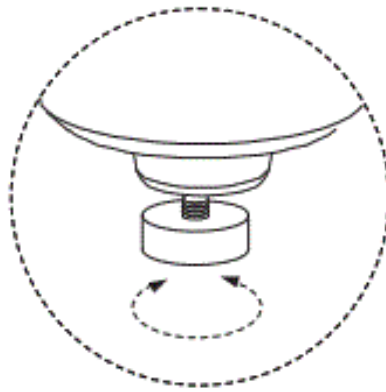
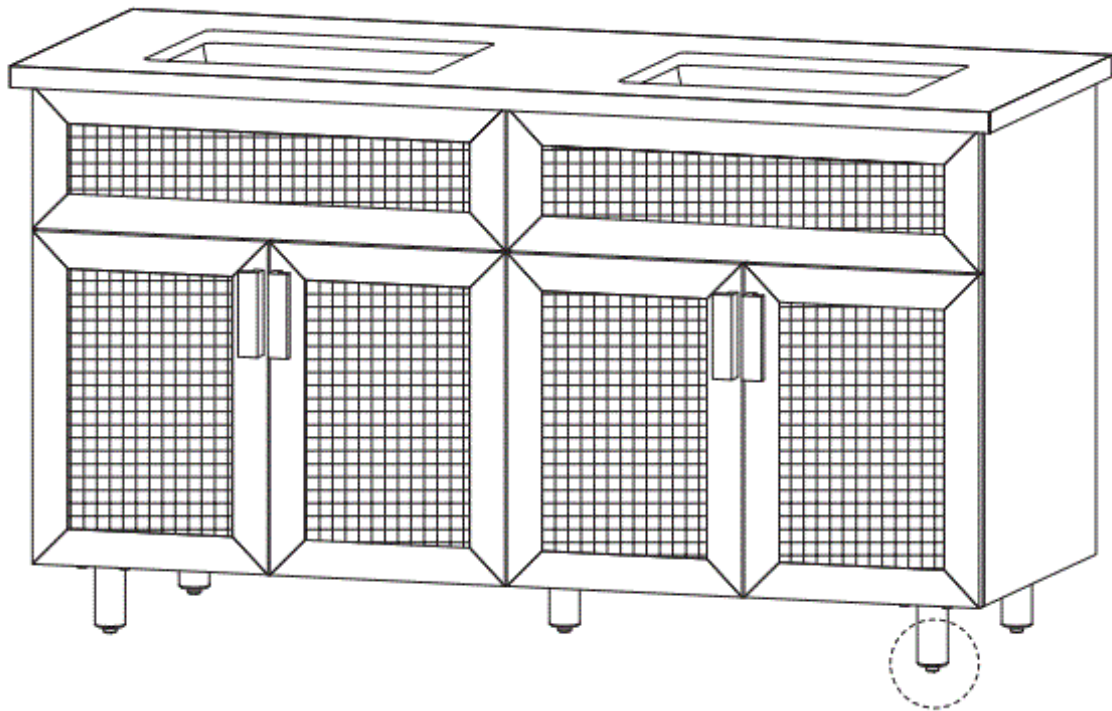

**NOTE:** Please do the following if the unit is not level.

### **IMPORTANT SAFETY INSTRUCTIONS**

- We recommend installation of this bath vanity be performed by a licensed professional.



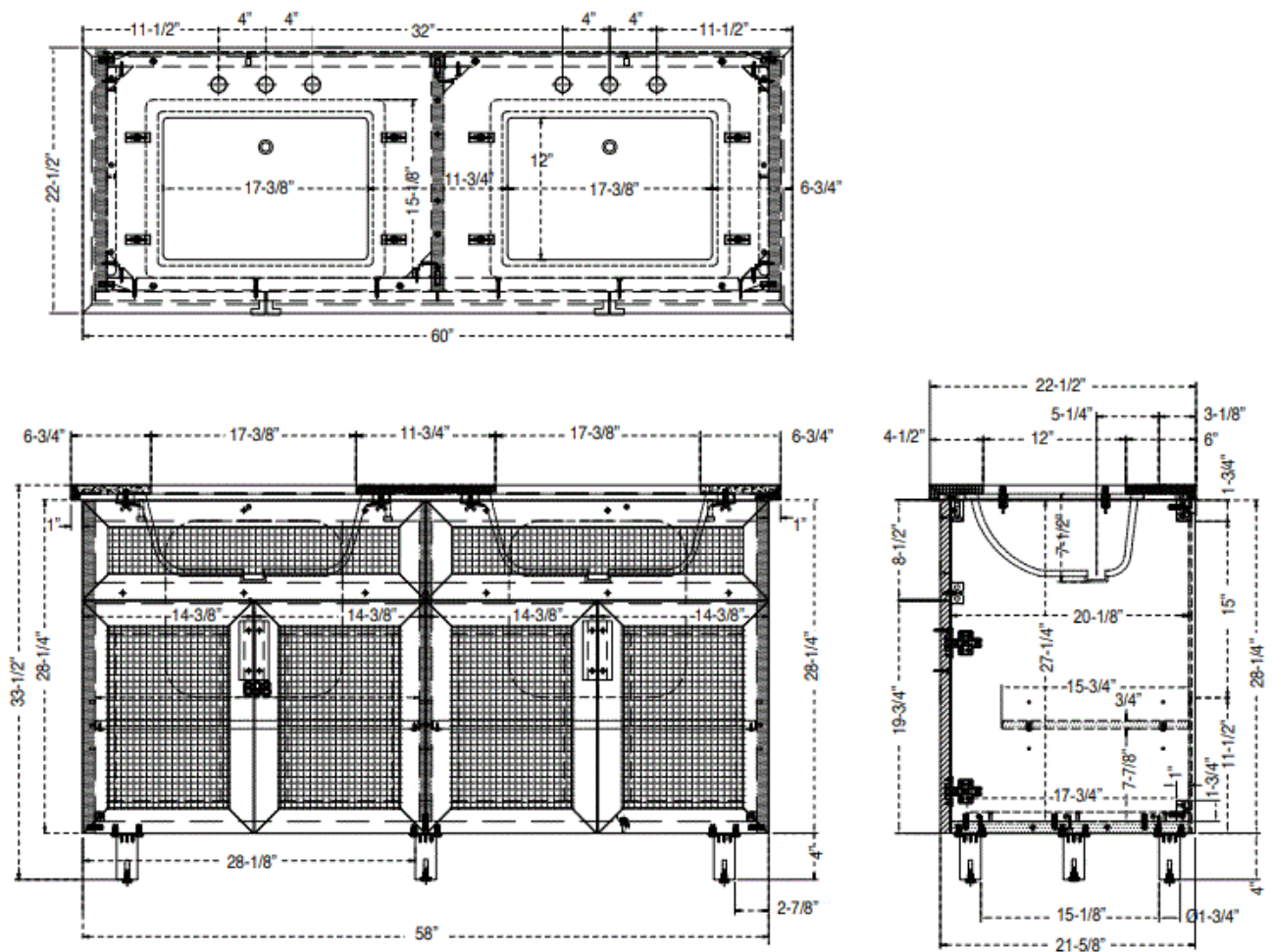

## Cleaning and Care

Clean surfaces with a dry or damp soft cloth. Do not use abrasive cleaners. Do not use furniture wax or polish. It is recommended to use coasters to protect the surface from heat and water. Periodically check and tighten hardware as necessary.

[crateandbarrel.com](https://www.crateandbarrel.com)

## Documents / Resources

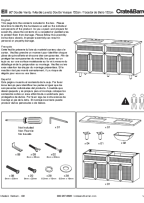
	<p><a href="#">Crate and Barrel Eli 60 Double Vanity ML</a> [pdf] User Manual Eli 60 Double Vanity ML, Eli 60, Double Vanity ML, Vanity ML</p>
---	--

## References

-  [Modern Furniture Store, Home Decor & Wedding Registry | Crate & Barrel](#)
- [User Manual](#)

## **Manuals+. Privacy Policy**

This website is an independent publication and is neither affiliated with nor endorsed by any of the trademark owners. The "Bluetooth®" word mark and logos are registered trademarks owned by Bluetooth SIG, Inc. The "Wi-Fi®" word mark and logos are registered trademarks owned by the Wi-Fi Alliance. Any use of these marks on this website does not imply any affiliation with or endorsement.