

Craftsman CMCST900 String Trimmer/Edger



Craftsman CMCST900 String Trimmer/Edger User Manual

[Home](#) » [Craftsman](#) » Craftsman CMCST900 String Trimmer/Edger User Manual 

Contents

- [1 Craftsman CMCST900 String Trimmer/Edger User Manual](#)
- [2 ASSEMBLY AND ADJUSTMENTS](#)
- [3 OPERATION](#)
- [4 MAINTENANCE](#)
- [5 Three-Year Limited Warranty](#)
- [6 References](#)



Craftsman CMCST900 String Trimmer/Edger User Manual



Definitions: Safety Alert Symbols and Words

This instruction manual uses the following safety alert symbols and words to alert you to hazardous situations and your risk of personal injury or property damage.

DANGER: Indicates an imminently hazardous situation that, if not avoided, will result in death or serious injury.

WARNING: Indicates a potentially hazardous situation which, if not avoided, could result in death or serious injury.

CAUTION: Indicates a potentially hazardous situation which, if not avoided, may result in minor or moderate injury. (Used without a word) Indicates a safety-related message.

NOTICE: Indicates a practice not related to personal injury which, if not avoided, may result in property damage.

Fig. A

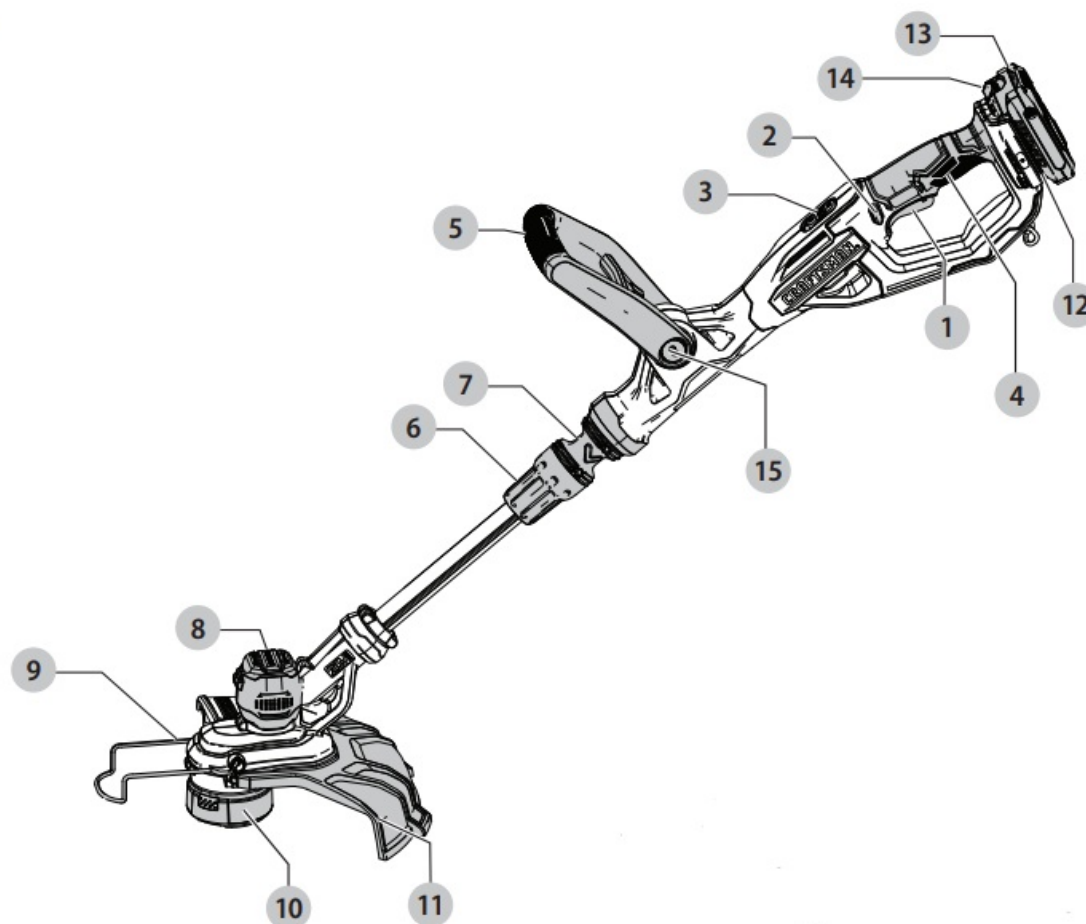

1. On/Off trigger
2. Lock-off button
3. Speed control switch
4. Main handle
5. Auxiliary handle
6. Height-adjust collar
7. Turn-to-edge collar
8. Trimmer head
9. Wire edge guide
10. Spool housing
11. Guard
12. Battery housing
13. Battery pack
14. Battery release button
15. Auxiliary handle adjustment buttons

WARNING: Read all safety warnings and all instructions. Failure to follow the warnings and instructions may result in electric shock, fire and/ or serious injury.

WARNING: Never modify the product or any part of it. Damage or personal injury could result.

WARNING: To reduce the risk of injury, read the instruction manual. If you have any questions or comments about this or any product, call CRAFTSMAN toll-free at 1-888-331-4569.

IMPORTANT SAFETY INSTRUCTIONS

WARNING: To reduce the risk of injury:

- Before any use, be sure everyone using this unit reads and understands all safety instructions and other information contained in this manual.
- Save these instructions and review them frequently.

WARNING: When using electric gardening appliances, basic safety precautions should always be followed to reduce the risk of fire, electric shock, and personal injury, including the following.

1. Avoid Dangerous Environment – Don't use appliances in damp locations.
2. Don't Use In Rain.
3. Keep Children Away – All visitors should be kept at a distance from the work area.
4. Dress Properly – Do not wear loose clothing or jewellery. They can be caught in moving parts. The use of rubber gloves and substantial footwear is recommended when working outdoors.
5. Wear a protective hair covering to contain long hair.
6. Use Safety Glasses – Always use a face or dust mask if the operation is dusty.
7. Use the Right Appliance – Do not use the appliance for any job except that for which it is intended.
8. Don't grasp the exposed cutting blades or cutting edges when picking up or holding the appliance.
9. Don't Force Appliance – It will do the job better and with less likelihood of a risk of injury at the rate for which it was designed.
10. Don't Overreach – Keep proper footing and balance at all times.
11. Stay Alert – Watch what you are doing. Use common sense. Do not operate appliances when you are tired.
12. Disconnect Appliance – Remove the battery when not in use, before servicing, and when changing accessories such as blades, and the like.
13. Store Idle Appliances Indoors – When not in use, appliances should be stored indoors in a dry, and high or locked-up place – out of reach of children.
14. Maintain Appliance With Care – Keep cutting edge sharp and clean for best performance and to reduce the risk of injury. Follow instructions for lubricating and changing accessories. Inspect appliance power source periodically, and if damaged, have it repaired by an authorized service facility. Keep handles dry, clean, and free from oil and grease.
15. Check Damaged Parts – Before further use of the appliance, a guard or other part that is damaged should be carefully checked to determine that it will operate properly and perform its intended function.
16. Check for alignment of moving parts, binding of moving parts, breakage of parts, mounting, and any other condition that may affect its operation.
17. A guard or other part that is damaged should be properly repaired or replaced by an authorized service centre unless indicated elsewhere in this manual.

Additional Safety Warnings

WARNING: To reduce the risk of rebound (ricochet) injury, work going away from any nearby solid object such as a wall, steps, large stone, tree, etc.

- **GUARD** – Do not use this appliance without a guard attached.
- **DRESS PROPERLY** – Do not wear loose clothing or jewellery. They can be caught in moving parts. Gloves and substantial rubber-soled footwear are recommended when working outdoors.
- Don't operate the appliance when barefoot or wearing open sandals. Wear heavy long pants to protect your legs. Wear a protective hair covering to contain long hair.
- **KEEP FACE, HANDS AND FEET CLEAR OF ROTATING NYLON LINE AT ALL TIMES.** The rotating line

performs a cutting function and uses care when trimming around screens and desirable plantings.













- KEEP ALL BYSTANDERS AWAY – at a safe distance from the work area, especially children. MAKE SURE that other persons and pets are at least 100' (30 m) away.
- WHEN BEING USED AS AN EDGER – stones, pieces of metal and other objects can be thrown out at high speed by the line. The appliance and guard are designed to reduce the danger. To reduce the risk of rebound (ricochet) injury, work away from any nearby solid object such as a wall, steps, large stone, tree, etc.
- USE GREAT CARE when working close to solid objects and where necessary, do trimming by hand.
- AVOID ACCIDENTALLY STARTING – Don't carry with a trigger finger when the battery is installed.
- DAMAGE TO UNIT – If you strike or become entangled with a foreign object, stop the appliance immediately, remove the battery, check for damage and have any damage repaired before further operation is attempted. Do not operate with a broken hub or spool.
- DO NOT OPERATE portable electric appliances in gaseous or explosive atmospheres. Motors in these appliances normally spark, and the sparks might ignite fumes.
- STAY ALERT – Do not operate this unit when you are tired, ill, or under the influence of alcohol, drugs, or medication.
- DO NOT immerse the appliance in water or squirt it with a hose.
- DO NOT allow any liquid to get inside it. If the appliance does get wet, allow it to dry for a minimum of 48 hours.
- DO NOT clean with a pressure washer.
- DO NOT store the appliance on or adjacent to fertilizers or chemicals.
- DO NOT charge appliances in rain, or wet locations.

Additional Safety Information

WARNING: ALWAYS use safety glasses. Everyday eyeglasses are NOT safety glasses. Also, use a face or dust mask if the operation is dusty.

ALWAYS WEAR CERTIFIED SAFETY EQUIPMENT

- ANSI Z87.1 eye protection (CAN/CSA Z94.3),
- ANSI S12.6 (S3.19) hearing protection,
- NIOSH/OSHA/MSHA respiratory protection.
- WARNING: Some dust contains chemicals known to the State of California to cause cancer, birth defects or other reproductive harm. Some examples of these chemicals are:
 - compounds in fertilizers,
 - compounds in insecticides, herbicides and pesticides,
 - arsenic and chromium from chemically treated lumber.
- To reduce your exposure to these chemicals, wear approved safety equipment such as dust masks that are specially designed to filter out microscopic particles.
- Avoid prolonged contact with dust from power sanding, sawing, grinding, drilling, and other construction activities. Wear protective clothing and wash exposed areas with soap and water. Allowing dust to get into your mouth, and eyes, or lay on the skin may promote the absorption of harmful chemicals.
- WARNING: Use of this tool can generate and/or disperse dust, which may cause serious and permanent respiratory or other injury. Always use NIOSH/OSHA-approved respiratory protection appropriate for dust exposure. Direct particles away from the face and body.
- WARNING: Always wear proper personal hearing protection that conforms to ANSI S12.6 (S3.19) during use. Under some conditions and duration of use, noise from this product may contribute to hearing loss.

V	volts	 or AC/DC....	alternating or direct current
Hz	hertz		
min	minutes		Class II
 or DC....	direct current		Construction (double insulated)
	Class I Construction (grounded)	n_0	no load speed
.../min.....	per minute	n	rated speed
BPM.....	beats per minute		earthing terminal
IPM.....	impacts per minute		safety alert symbol
RPM.....	revolutions per minute		visible radiation
sfpmin	surface feet per minute		avoid staring at light
SPM	strokes per minute		wear respiratory protection
OPM.....	oscillations per minute		wear eye protection
A	amperes		wear hearing protection
W	watts		read all documentation
 or AC.....	alternating current	IPXX	IP symbol

CAUTION: When not in use, place the tool on its side on a stable surface where it will not cause a tripping or falling hazard. Some tools with a large battery pack will stand upright but may be easily knocked over. Air vents often cover moving parts and should be avoided. Loose clothes, jewellery or long hair can be caught in moving parts. The label on your tool may include the following symbols. The symbols and their definitions are as follows:

BATTERIES AND CHARGERS

The battery pack is not fully charged out of the carton. Before using the battery pack and charger, read the safety instructions below and then follow the charging procedures outlined. When ordering replacement battery packs, be sure to include the catalogue number and voltage.

READ ALL INSTRUCTIONS

Important Safety Instructions for All Battery Packs

WARNING: Read all safety warnings, instructions, and cautionary markings for the battery pack, charger and product. Failure to follow the warnings and instructions may result in electric shock, fire and/or serious injury.

- Do not charge or use the battery pack in explosive atmospheres, such as in the presence of flammable liquids, gases or dust. Inserting or removing the battery pack from the charger may ignite the dust or fumes.
- When the battery pack is not in use, keep it away from other metal objects, like paper clips, coins, keys, nails, screws, or other small metal objects, that can make a connection from one terminal to another. Shorting the

battery terminals together may cause burns or a fire.

- NEVER force the battery pack into the charger. DO NOT modify the battery pack in any way to fit into a non-compatible charger as a battery pack may rupture causing serious personal injury. Consult the chart at the end of this manual for compatibility of batteries and chargers.
- Charge the battery packs only in CRAFTSMAN chargers.
- DO NOT splash or immerse in water or other liquids.
- Do not store or use the tool and battery pack in locations where the temperature may reach or exceed 104 °F (40 °C) (such as outside sheds or metal buildings in summer). For best life store battery packs in a cool, dry location.

NOTE: Do not store the battery packs in a tool with the trigger switch locked on. Never tape the trigger switch in the ON position.

- Do not incinerate the battery pack even if it is severely damaged or is completely worn out. The battery pack can explode in a fire. Toxic fumes and materials are created when lithium-ion battery packs are burned.
- If battery contents come into contact with the skin, immediately wash the area with mild soap and water. If battery liquid gets into the eye, rinse water over the open eye for 15 minutes or until irritation ceases. If medical attention is needed, the battery electrolyte is composed of a mixture of liquid organic carbonates and lithium salts.
- Contents of opened battery cells may cause respiratory irritation. Provide fresh air. If symptoms persist, seek medical attention.
- WARNING: Burn hazard. Battery liquid may be flammable if exposed to a spark or flame.
- WARNING: Fire hazard. Never attempt to open the battery pack for any reason. If the battery pack case is cracked or damaged, do not insert it into the charger. Do not crush, drop or damage the battery pack. Do not use a battery pack or charger that has received a sharp blow, been dropped, run over or damaged in any way (e.g., pierced with a nail, hit with a hammer, stepped on). Damaged battery packs should be returned to the service centre for recycling.

Storage Recommendations

1. The best storage place is one that is cool and dry, away from direct sunlight and excess heat or cold.
2. For long storage, it is recommended to store a fully charged battery pack in a cool dry place out of the charger for optimal results.

NOTE: Battery packs should not be stored completely depleted of charge. The battery pack will need to be recharged before use.

Battery Pack Cleaning Instructions

Dirt and grease may be removed from the exterior of the battery using a cloth or soft non-metallic brush. Do not use water or any cleaning solutions. The RBRC® Seal The RBRC® (Rechargeable Battery Recycling Corporation) Seal on the nickel-cadmium, nickel metal hydride or lithium-ion batteries (or battery packs) indicates that the costs to recycle these batteries (or battery packs) at the end of their useful life have already been paid by CRAFTSMAN. In some areas, it is illegal to place spent nickel cadmium, nickel metal hydride or lithium-ion batteries in the trash or municipal solid waste stream and the Call 2 Recycle® program provides an environmentally conscious alternative.

Call 2 Recycle, Inc., in cooperation with CRAFTSMAN and other battery users have established the program in the United States and Canada to facilitate the collection of spent nickel cadmium, nickel metal hydride or lithium-ion batteries. Help protect our environment and conserve natural resources by returning the spent nickel cadmium, nickel metal hydride or lithium-ion batteries to an authorized service centre or your local retailer for recycling. You

may also contact your local recycling centre for information on where to drop off the spent battery. RBRC® is a registered trademark of Call 2 Recycle, Inc.

Transportation

WARNING: Fire hazard. Do not store or carry the battery pack so that metal objects can contact exposed battery terminals. For example, do not place the battery pack in aprons, pockets, tool boxes, product kit boxes, drawers, etc., with loose nails, screws, keys, etc. Transporting batteries can cause fires if the battery terminals inadvertently come in contact with conductive materials such as keys, coins, hand tools and the like.

The US Department of Transportation Hazardous Material Regulations (HMR) prohibit transporting batteries in commerce or on aeroplanes in carry-on baggage UNLESS they are properly protected from short circuits. So when transporting individual battery packs, make sure that the battery terminals are protected and well insulated from materials that could contact them and cause a short circuit.

NOTE: LI-ion batteries should not be put in checked baggage.

Important Safety Instructions for All Battery Chargers

WARNING: Read all safety warnings, instructions, and cautionary markings for the battery pack, charger and product. Failure to Follow the warnings and instructions may result in electric shock, fire and/or serious injury.

- DO NOT attempt to charge the battery pack with any chargers other than a CRAFTSMAN charger. CRAFTSMAN charger and battery pack are specifically designed to work together.
- These chargers are not intended for any use other than charging CRAFTSMAN rechargeable batteries. Any other uses may result in a risk of fire, electric shock or electrocution.
- Do not expose the charger to rain or snow.
- Pull by the plug rather than the cord when disconnecting the charger. This will reduce the risk of damage to the electric plug and cord.
- Make sure that the cord is located so that it will not be stepped on, tripped over or otherwise subjected to damage or stress.
- Do not use an extension cord unless it is necessary. Use of improper extension cords could result in risk of fire, electric shock or electrocution.
- When operating a charger outdoors, always provide a dry location and use an extension cord suitable for outdoor use. The use of a cord suitable for outdoor use reduces the risk of electric shock.
- An extension cord must have adequate wire size (AWG or American Wire Gauge) for safety. The smaller the gauge number of the wire, the greater the capacity of the cable, that is, 16 gauge has more capacity than 18 gauge. An undersized cord will cause a drop in line voltage resulting in loss of power and overheating.
- When using more than one extension to make up the total length, be sure each extension contains at least the minimum wire size.
- The following table shows the correct size to use depending on cord length and nameplate ampere rating. If in doubt, use the next heavier gauge. The lower the gauge number, the heavier the cord.

Minimum Gauge for Cord Sets

Volts		Total Length of Cord in Feet (meters)			
120 V		25 (7.6)	50 (15.2)	100 (30.5)	150 (45.7)
240 V		50 (15.2)	100 (30.5)	200 (61.0)	300 (91.4)
Ampere Rating		American Wire Gauge			
More Than	Not More Than				
0	6	18	16	16	14
6	10	18	16	14	12
10	12	16	16	14	12
12	16	14	12	Not Recommended	

Charging a Battery

NOTE: To ensure maximum performance and life of lithium-ion battery packs, charge the battery pack fully before first use.

1. Plug the charger into an appropriate outlet before inserting the battery pack.
2. Connect the charger and battery pack, making sure the battery is fully seated. The (charging) light will blink continuously indicating that the charging process has started.
3. The completion of the charge will be indicated by the light remaining ON continuously. The battery pack is fully charged and may be removed and used at this time or left in the charger.

NOTE: To remove the battery pack, some chargers require the battery pack release button to be pressed.

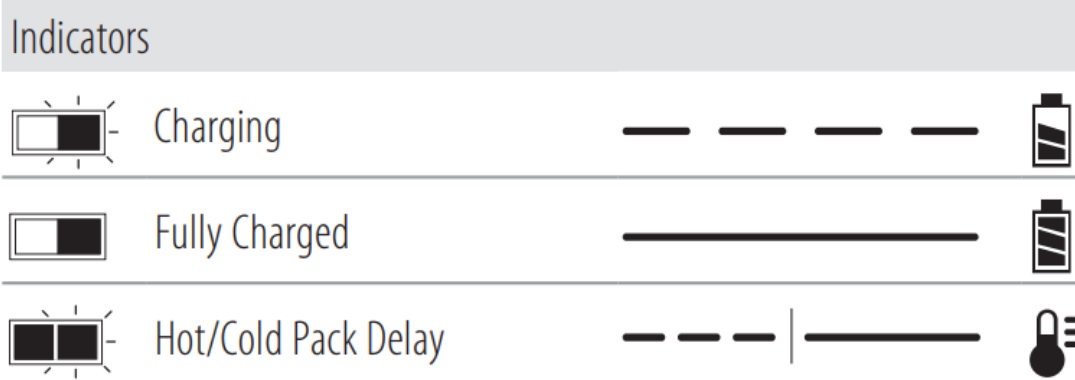

4. The battery pack should be recharged when it fails to produce sufficient power on jobs that were easily done previously. DO NOT CONTINUE to use under these conditions. Follow the charging procedure. You may also charge a partially used pack whenever you desire with no adverse effect on the battery pack.
5. Foreign materials of a conductive nature such as, but not limited to, grinding dust, metal chips, steel wool, aluminium foil, or any buildup of metallic particles should be kept away from charger cavities. Always unplug the charger from the power supply when there is no battery pack in the cavity. Unplug the charger before attempting to clean it.
6. Do not freeze or immerse the charger in water or any other liquid.

7. A charger will not charge a faulty battery pack. The charger refusing to light could indicate a problem with the charger.

NOTE: If the charger refuses to light, take the charger and battery pack to be tested at an authorized service centre.

Hot/Cold Pack Delay

When the charger detects a battery pack that is too hot or too cold, it automatically starts a Hot/Cold Pack Delay, suspending charging until the battery pack has reached an appropriate temperature. The charger then automatically switches to the pack charging mode. This feature ensures maximum battery pack life. A cold battery pack may charge at a slower rate than a warm battery pack.

Important Charging Notes

1. The longest life and best performance can be obtained if the battery pack is charged when the air temperature is between 65 °F – 75 °F (18 °C–24 °C). DO NOT charge when the battery pack is below +40 °F (+4.5 °C), or above +104 °F (+40 °C). This is important and will prevent serious damage to the battery pack.
2. The charger and battery pack may become warm to the touch while charging. This is a normal condition and does not indicate a problem. To facilitate the cooling of the battery pack after use, avoid placing the charger or battery pack in a warm environment such as in a metal shed or an uninsulated trailer.
3. If the battery pack does not charge properly:
 - Check the operation of the receptacle by plugging in a lamp or other appliance;
 - Check to see if the receptacle is connected to a light switch which turns power off when you turn out the lights;
 - Move the charger and battery pack to a location where the surrounding air temperature is approximately 65 °F–75 °F (18 °C–24 °C);
 - If charging problems persist, take the tool, battery pack and charger to your local service centre.

Charger Cleaning Instructions

WARNING: Shock hazard. Disconnect the charger from the AC outlet before cleaning. Dirt and grease may be removed from the exterior of the charger using a cloth or soft non-metallic brush. Do not use water or any cleaning solutions.

Wall Mounting

These chargers are designed to be wall mountable or to sit upright on a table or work surface. If wall mounting, locate the charger within reach of an electrical outlet, and away from a corner or other obstructions which may impede airflow. Use the back of the charger as a template for the location of the mounting screws on the wall. Mount the charger securely using drywall screws (purchased separately) at least 1" (25.4 mm) long, with a screw head diameter of 0.28–0.35" (7–9 mm), screwed into wood to an optimal depth leaving approximately 7/32" (5.5 mm) of the screw exposed. Align the slots on the back of the charger with the exposed screws and fully engage them in the slots.

Versatrack™

CRAFTSMAN chargers can be mounted to the wall using CRAFTSMAN Versatrack™ Trackwall. Hooks and accessories are sold separately. Please refer to the Versatrack™ Trackwall accessory sheet for further information. SAVE THESE INSTRUCTIONS FOR FUTURE USE COMPONENTS (FIG. A)

Intended Use

This string trimmer is designed for household trimming and edging applications. DO NOT use it under wet conditions or in the presence of flammable liquids or gases. DO NOT let children come into contact with the tool. Supervision is required when inexperienced operators use this tool.

ASSEMBLY AND ADJUSTMENTS

WARNING

To reduce the risk of serious personal injury, turn the unit off and remove the battery pack before making any adjustments or removing/installing attachments or accessories, when replacing the line, or before cleaning. An accidental start-up can cause injury.

Attaching Guard (Fig. B, C)

WARNING: Never remove the guard.
Damage or personal injury could result.

WARNING: NEVER OPERATE APPLIANCE WITHOUT GUARD FIRMLY IN PLACE.

The guard must always be properly attached to the appliance to protect the user.

1. Remove the guard screw 16.
2. Slide guard 11 fully onto the trimmer head 8. Make sure tab 17 on the guard engages the ribs on the trimmer head.
3. Continue to slide the guard on until it “snaps” into place. The locking tab should snap into the housing slot.
4. Using a crosshead screwdriver, insert the guard screw and tighten it securely.
5. Once the guard is installed, remove the covering from the line cut-off blade, located on the edge of the guard.

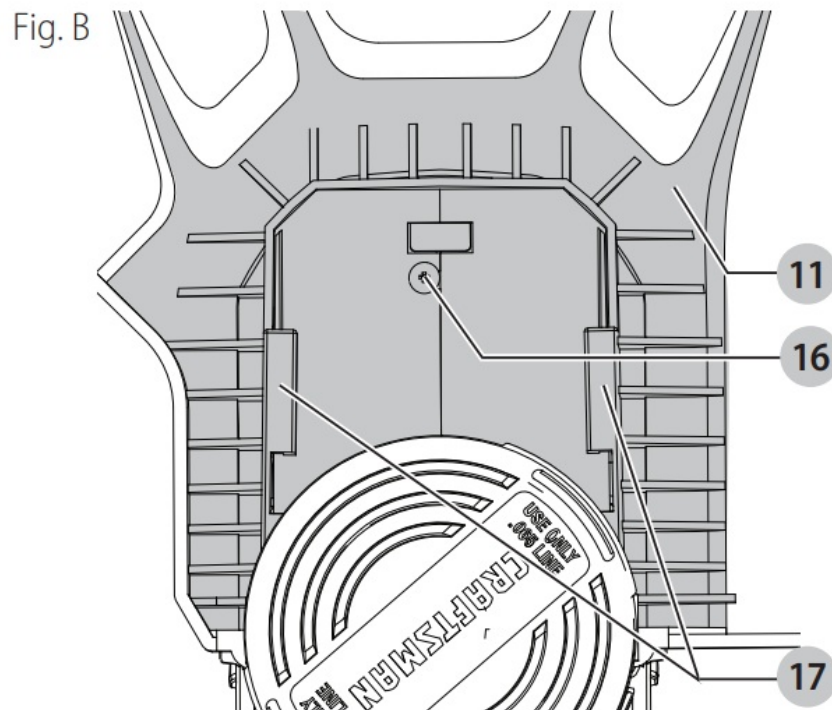
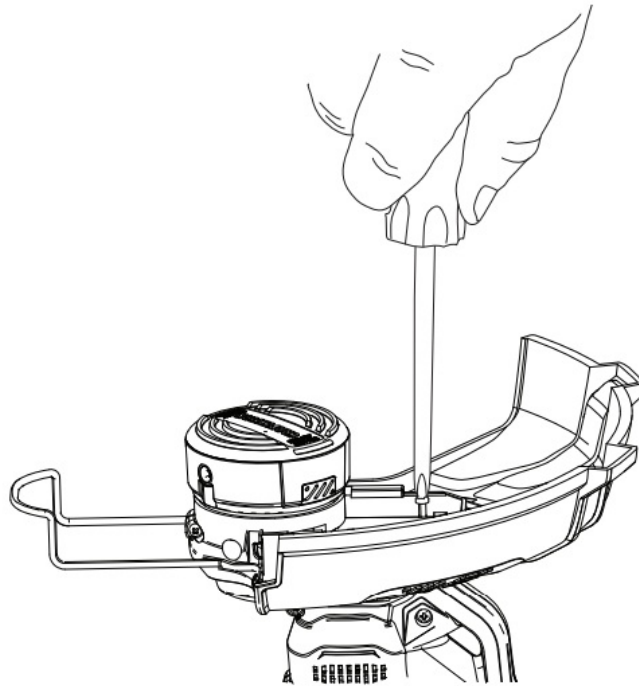
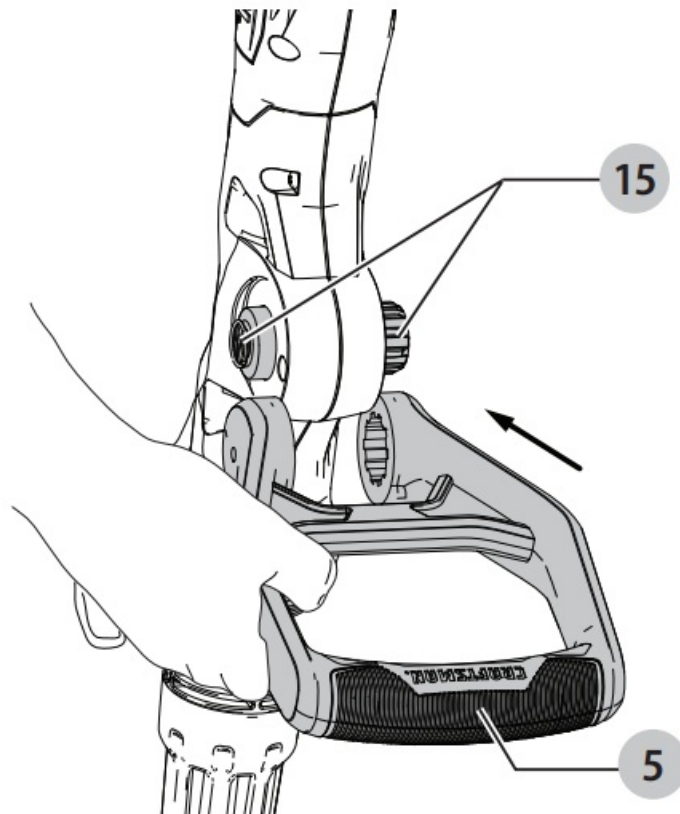

Fig. C



Attaching the Auxiliary Handle (Fig. D)

Fig. D



For some models, the auxiliary handle may need to be attached. If the model needs the auxiliary handle attached, please refer to these instructions.

1. To attach the auxiliary handle 5, press the auxiliary handle adjustment button 15 on both sides of the upper housing as shown in Figure D.
2. Position the auxiliary handle as shown in Figure D. Partially push the auxiliary handle on so it will hold the buttons in when you release them with your hand.
3. Push the auxiliary handle completely onto the housing and position it slightly until it “snaps” into place.

NOTE: To adjust the auxiliary handle up or down, press the buttons and raise or lower the handle.

NOTE: The handle should be adjusted so that your front arm is straight when the trimmer is in the working position.

Height Adjustment (Fig. E)

Fig. E

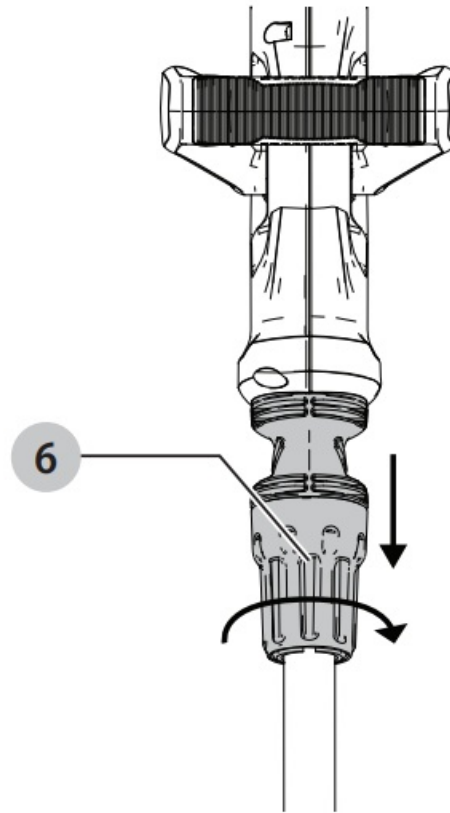

CAUTION: Adjust the length of the trimmer to obtain proper working positions.

1. The overall height of the trimmer can be adjusted by loosening the height-adjust collar 6 by rotating it in the direction of the arrow shown in Figure E.
2. Move the upper housing straight up or down. When the desired height is achieved, tighten the collar by rotating it opposite of the opposite direction shown in Figure E. Fig. E

Releasing the Cutting Line (Fig. A)

In transit, the cutting line is taped to the spool housing 10. Remove the tape holding the cutting line to the spool housing.

OPERATION

WARNING: To reduce the risk of serious personal injury, turn the unit off and remove the battery pack before making any adjustments or removing/installing attachments or accessories, when replacing the line, or before cleaning. An accidental start-up can cause injury.

WARNING: Always use proper eye protection that conforms to ANSI Z87.1 (CAN/CSA Z94.3) while operating this appliance.

WARNING: Remove the battery before making any assembly, adjustments, or changing accessories. Such preventive safety measures reduce the risk of starting the trimmer accidentally.

CAUTION: Before you begin trimming, only use the appropriate type of cutting line.

CAUTION: Inspect the area to be trimmed and remove any wire, cord, or string-like objects that could become entangled in the rotating line or spool. Be particularly careful to avoid any wire that might be bent outwardly into the path of the appliance, such as barbs at the base of a chain link fence.

Installing and Removing the Battery Pack (Fig. F)

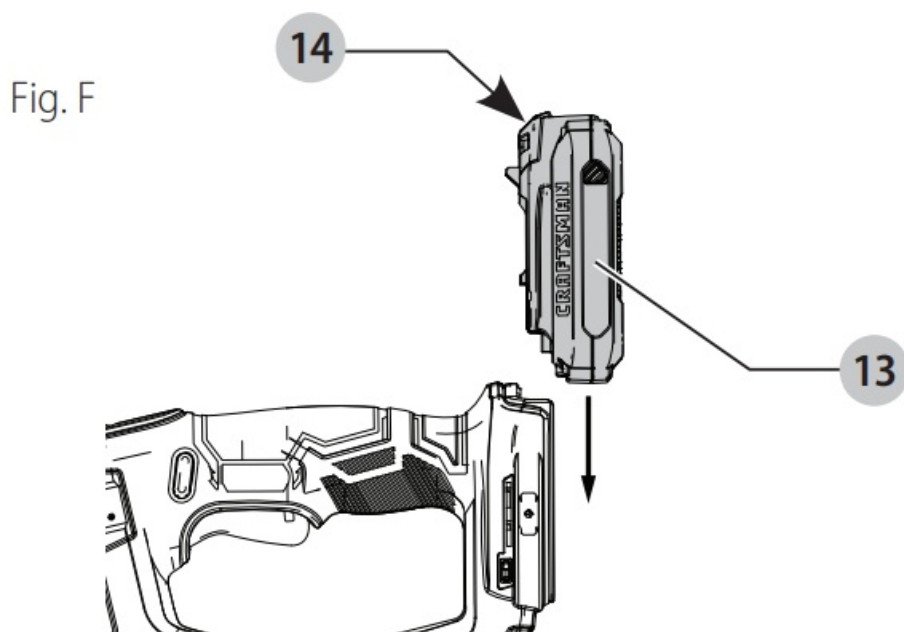

NOTE: For best results, make sure your battery pack is fully charged. To install battery pack 13 into the tool handle, align the battery pack with the rails inside the tool's handle and slide it into the handle until the battery pack is firmly seated in the tool and ensure that it does not disengage. To remove the battery pack from the tool, press the release button 14 and firmly pull the battery pack out of the tool handle. Insert it into the charger as described in the charger section of this manual.

Proper Hand Position (Fig. G)

Fig. G

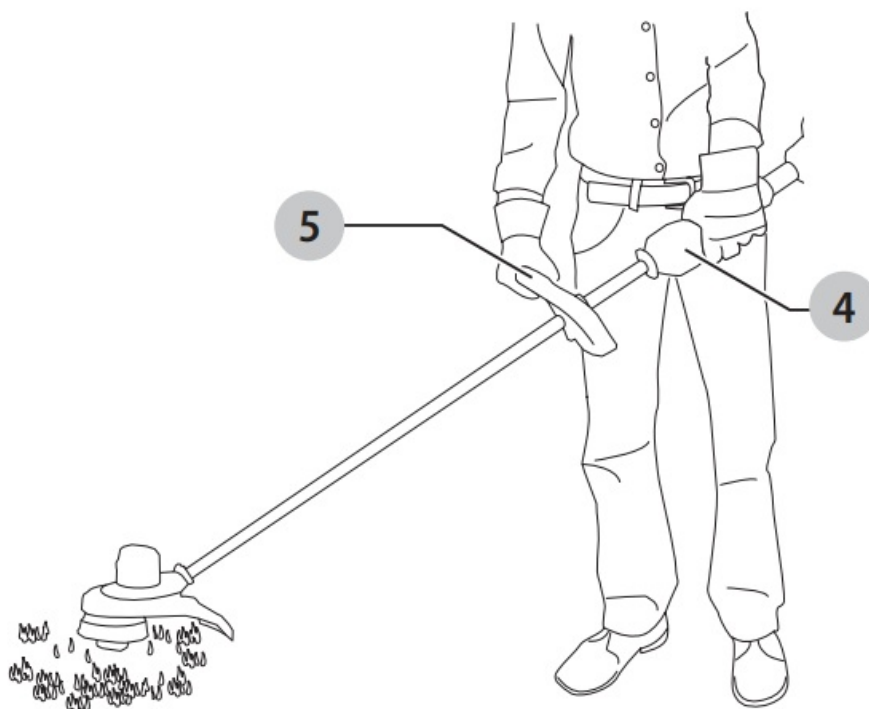

WARNING: To reduce the risk of serious personal injury, ALWAYS use proper hand position as shown.

WARNING: To reduce the risk of serious personal injury, ALWAYS hold securely in anticipation of a sudden reaction. Proper hand position requires one hand on the main handle 4 and one hand on the auxiliary handle 5.

Fig. G

Switching Trimmer On and Off (Fig. A)

WARNING: Never attempt to lock the trigger in the on position. To turn the appliance on, squeeze the lock-off button 2 and then the On/Off trigger 1. Once the unit is running, you may release the lock-off button. To turn the appliance off, release the On/Off trigger.

Speed Control Switch (Fig. A)

This string trimmer gives you the choice to operate at a more efficient speed to extend the runtime for larger jobs or accelerate the trimmer speed for high-performance cutting. To extend runtime, pull the speed control switch 12 into the “LO” position. This mode is best for larger projects that require more time to complete. To accelerate the trimmer, push the speed control switch 3 forward toward the auxiliary handle 5 into the “HI,” position. This mode is best for cutting through heavier growth and for applications that need higher RPM.

NOTE: When in “HI” mode, runtime will be decreased as compared to when the trimmer is in “LO” mode.

Trimming (Fig. H, I)

With the trimmer on, angle it and swing side to side as shown in Figure H. Maintain a cutting angle of 5° to 10° as shown in Figure I. Do not exceed 10°. Cut with the tip of the line. Maintain a minimum distance of 24" (610 mm) between the guard and your feet as shown in Figure I.

Fig. H

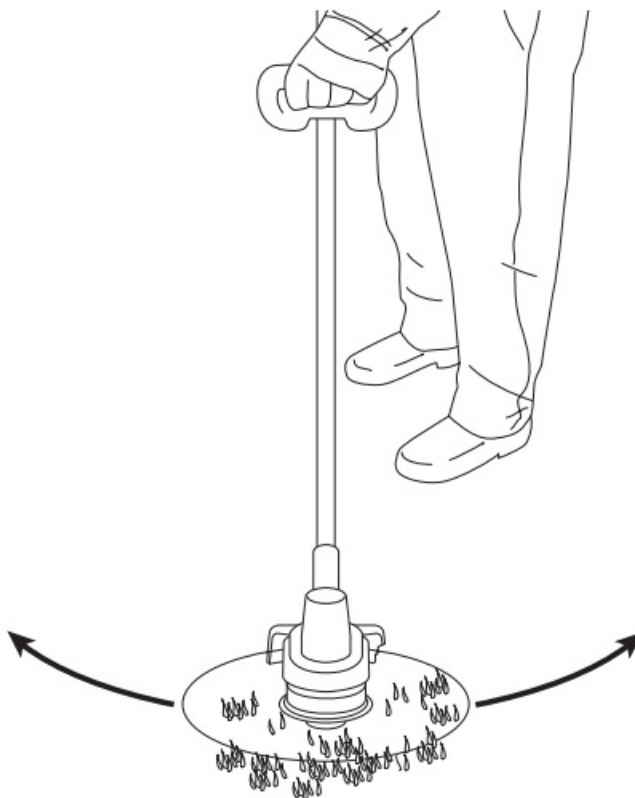
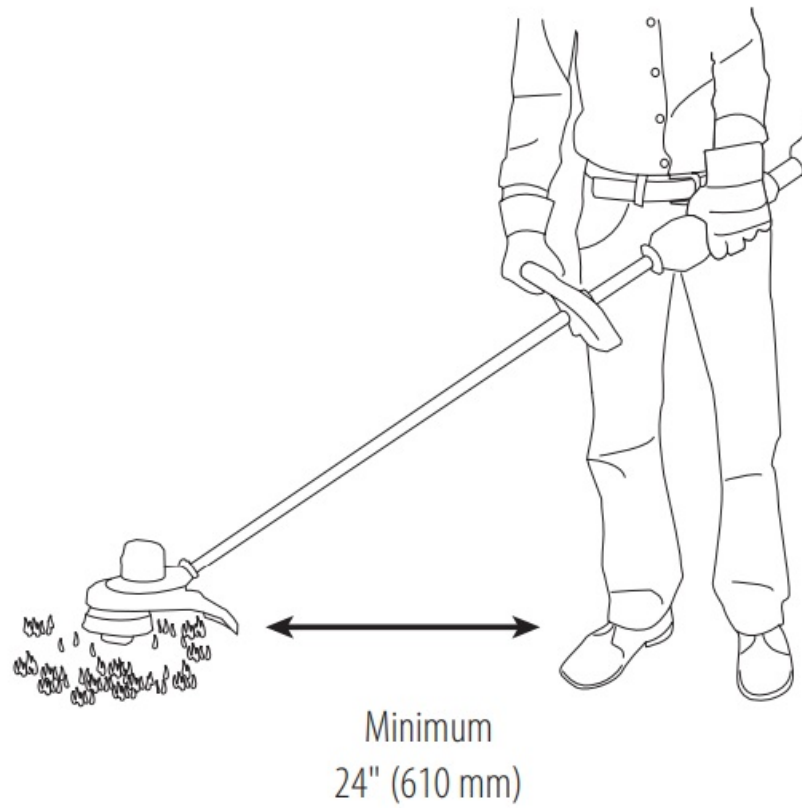

Fig. I



Convert to Edging Mode (Fig. J)

CAUTION: The wire edge guide should only be used when in the edging mode. The trimmer can be used in trimming mode or edging mode to trim overhanging grass along lawn edges and flower beds. To convert the trimmer to edging mode:

Fig. J

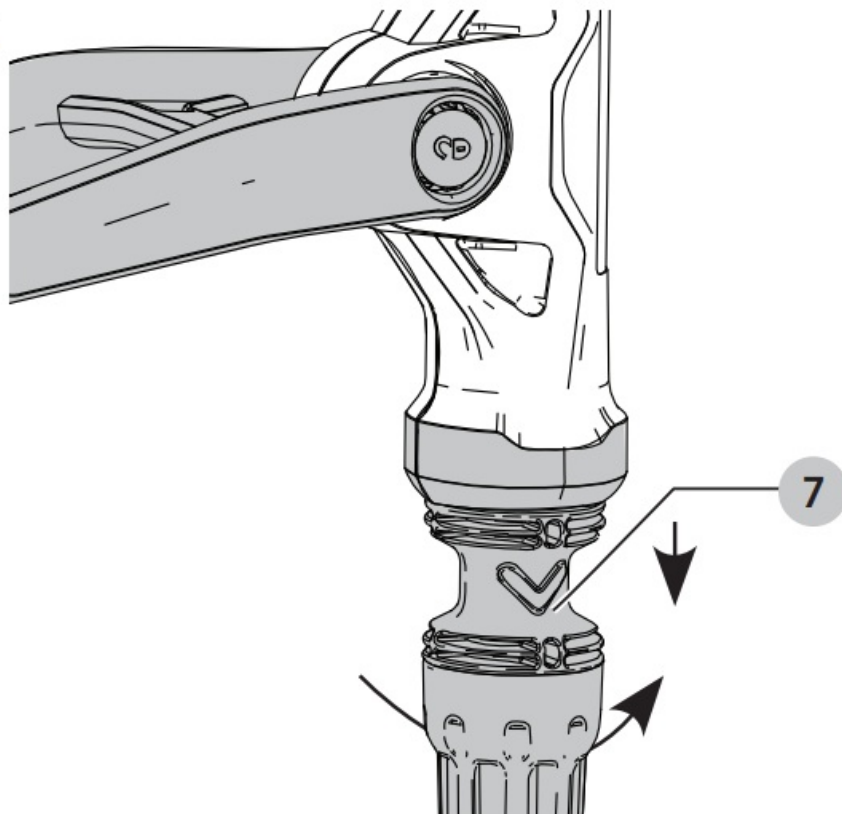

1. Remove the battery from the trimmer.
2. Grasp the turn-to-edge collar 7 and pull it down as shown in Figure J.

3. Rotate the turn-to-edge collar 180° counterclockwise as shown in Figure J., until the handle snaps back into the the upper half of the trimmer.
4. To return to the trimming position, pull the turn-to-edge collar up and rotate the head clockwise back to its original position.

NOTE: You will experience faster-than-normal cutting line wear if the trimmer line is positioned directly over the sidewalk or abrasive surface.

Edging Mode Operation (Fig. A, H)

WARNING: When being used as an edger, stones, pieces of metal and other objects can be thrown out at high speed by the line. The trimmer and guard are designed to reduce the danger. However, **MAKE SURE** that other persons and pets are at least 100' (30 m) away. Optimum cutting results are achieved on edges deeper than 2" (50 mm).

- Do not use this trimmer to create trenches.
- Using the wire edge guide 9, guide the trimmer.
- Position the wire edge guide on the edge of the sidewalk or abrasive surface so the cutting line is over the grass or dirt area to be edged.
- To make a closer cut, slightly tilt the trimmer.

Helpful Cutting Tips (Fig. K)

Fig. K

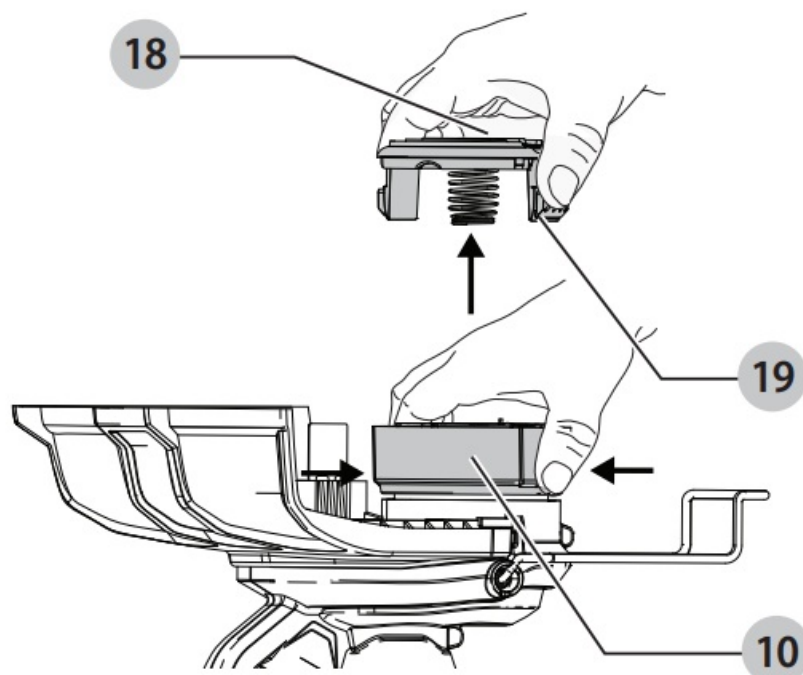

- Use the tip of the string to do the cutting; do not force the string head into uncut grass. Use edge guide along such things as fences, houses and flower beds for best practices.
- Wire and picket fences cause extra string wear, even breakage. Stone and brick walls, curbs, and wood may wear string rapidly.
- Do not allow spool cap 18 to drag on the ground or other surfaces.
- In long growth, cut from the top down and do not exceed 12" (305 mm) high.
- Keep the trimmer tilted toward the area being cut; this is the best cutting area.

- The trimmer cuts when passing the unit from left to right. This will avoid throwing debris at the operator. Avoid trees and shrubs.
- Tree bark, wood mouldings, siding and fence posts can easily be damaged by the string.

Cutting Line/Line Feeding

Your trimmer uses a .065" (1.65 mm) diameter, ROUND nylon line. During use, the tips of the nylon lines will become frayed and worn and the special self-feeding spool will automatically feed and trim a fresh length of line. Cutting lines will wear faster and require more feeding if the cutting or edging is done along sidewalks or other abrasive surfaces or heavier weeds are being cut. The advanced automatic line feeding mechanism senses when more cutting line is needed and feeds and trims the correct length of the line whenever it's required. Do not bump the unit on the ground in an attempt to feed the line or for any other purposes.

Clearing Jams and Tangled Line (Fig. K)

WARNING: Remove the battery from the trimmer before making any assembly, adjustments or changing accessories. Such preventive safety measures reduce the risk of starting the appliance accidentally. From time to time, especially when cutting thick or stalky weeds, the line feeding hub may become clogged with sap or other material and the line will become jammed as a result. To clear the jam, follow the steps listed below.

CAUTION: To avoid appliance damage, if the cutting line protrudes beyond the trimming blade, cut it off so that it just reaches the blade.

1. Remove the battery from the trimmer.
2. Press the release tabs 19 on the spool cap 18, and remove the spool cap from the spool housing 10 (Figure K).
3. Pull the nylon line spool out and clear any broken lines or cutting debris from the spool area.
4. Place spool and line into spool cap with line "parked" in slots provided.
5. Insert the line end through the appropriate hole in the pool housing. Pull the slack line through until it pulls out of the holding slots.
6. Press the spool down GENTLY and rotate it until you feel it drop into place and then push to snap into place.
(When in place, the spool will turn a few degrees left and right freely).
7. Take care to keep the line from becoming trapped under the spool.
8. Fit the spool onto the appliance as described in Replacing Spool Assembly

Replacing Spool Assembly (Fig. K, L)

Fig. L

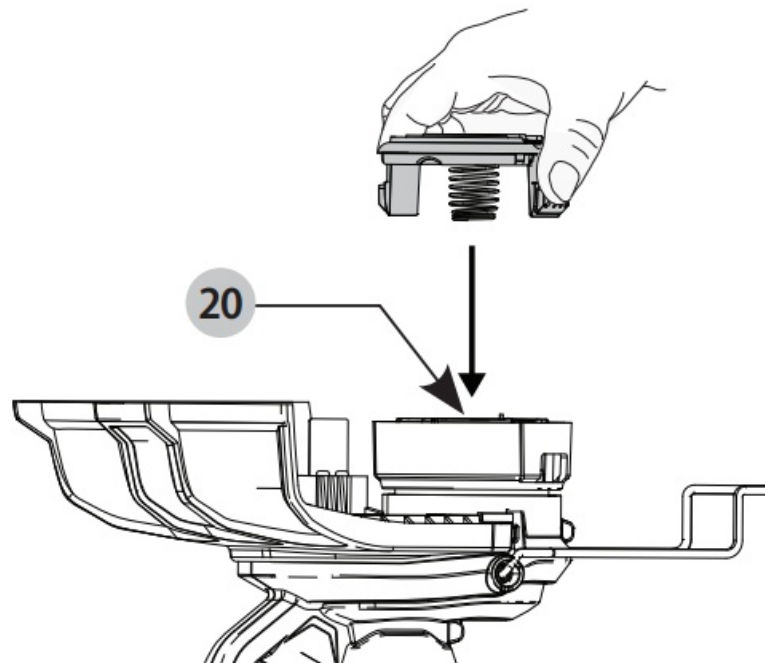

WARNING: The use of any accessory not recommended by CRAFTSMAN for use with this appliance could be hazardous.

WARNING: Do not use any blades, or any accessory or attachment other than those recommended by CRAFTSMAN on this trimmer. Serious injury or product damage may result. Reload the nylon line (either bulk or pre-wound replacement spool) as shown in this manual.

USE ONLY .065" (1.65 mm) DIAMETER ROUND NYLON MONOFILAMENT LINE

Do not use serrated or heavier gauge lines, as they will overload the motor and cause overheating. This line is available at your local dealer or authorized service centre.

1. Remove the battery from the appliance.
2. Press the release tabs 19 on the spool cap 18, and remove the spool cap from the spool housing 10 (Figure K).
3. For best results, replace the spool with CRAFTSMAN Model CMZST065.
4. If the lever in the base of the housing becomes dislodged, replace it in the correct position before inserting a new spool into the housing.
5. Remove any dirt and grass from the spool cap and spool housing.
6. Unfasten the end of the cutting line and guide the line into the eyelet.
7. Take the new spool and push it onto the boss 20 in the housing. Rotate the spool slightly until it is seated.
8. The line should protrude approximately 5-3/8" (136 mm) from the housing.
9. Align the release tabs on the spool cap with the slots in the spool housing.
10. Snap the spool cap back on by depressing the release tabs and pressing into the spool housing.
11. Push the cap onto the housing until it snaps securely into place.

NOTE: Make sure that the cover is fully positioned, listen for two audible clicks to ensure both release tabs are correctly located. Power the appliance on. In a few seconds or less, you'll hear the nylon line being cut automatically to the proper length.

NOTE: Other replacement parts (guards, spool caps, etc.) are available through authorized service centres. To find your local service location call: 1-888-331-4569 or visit www.craftsman.com. Rewinding Spool from Bulk Line (use only .065" (1.65 mm) ROUND diameter line) (Fig. A, M, N) Bulk line is also available for purchase from your local retailer. NOTE: Hand-wound spools from the bulk line are likely to become tangled more frequently than CRAFTSMAN factory wound spools. For best results, factory wound spools are recommended.

1. Remove the battery from the appliance.
2. Remove the empty spool from the appliance as described in Replacing Spool Assembly.
3. Remove any remaining cutting line from the spool.
4. Make a fold at the end of the cutting line at about 3/4" (19 mm) 21. Feed the cutting line into one of the line anchoring slots 22.
5. Insert the 3/4" (19 mm) end of the bulk line into hole 23 in the spool adjacent to the slot. Make sure the line is pulled tight against the spool.
6. Wind the cutting line onto the spool in the direction of the arrow on the spool. Make sure to wind the line on neatly and in layers. Do not crisscross.
7. When the wound-cutting line reaches the recesses 24 cut the line.
8. Fit the spool onto the appliance as described in Replacing Spool Assembly. Fig. M

Fig. M

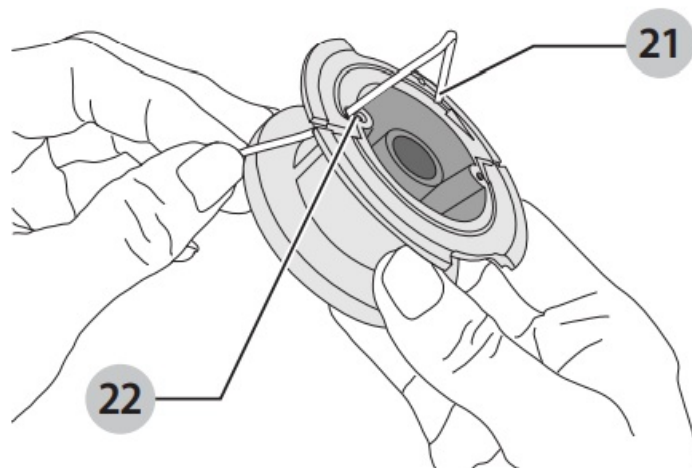
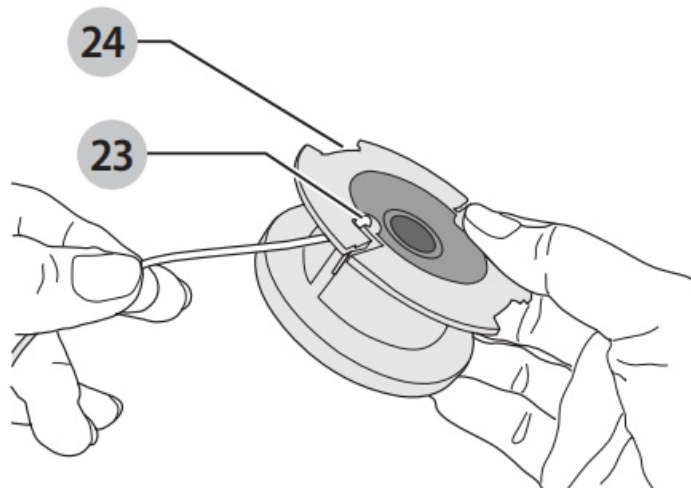

Fig. N



MAINTENANCE

WARNING

To reduce the risk of serious personal injury, turn the unit off and remove the battery pack before making any adjustments or removing/installing attachments or accessories, when replacing the line, or before cleaning. An accidental start-up can cause injury.

Accessories

WARNING: Since accessories, other than those offered by CRAFTSMAN, have not been tested with this product, the use of such accessories with this tool could be hazardous. To reduce the risk of injury, only CRAFTSMAN-recommended accessories should be used with this product. Recommended accessories for use with your tool are available at extra cost from your local dealer or authorized service centre. If you need assistance in locating any accessory, please contact CRAFTSMAN, or call 1-888-331-4569.

Fig. O

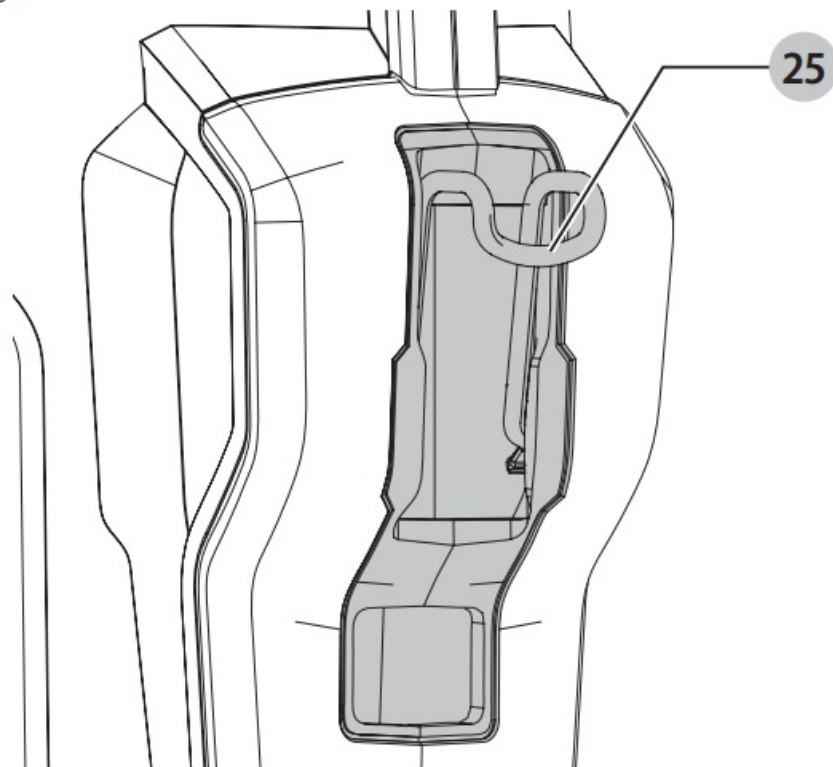

To reduce the risk of serious personal injury, do not use a damaged Versatrack™ integral hang hook or Versatrack™ Trackwall. A damaged Versatrack™ integral hang hook or Versatrack™ Trackwall will not support the weight of the tool.

WARNING: To reduce the risk of serious personal injury, DO NOT suspend tool overhead or suspend objects from the integral hang hook. ONLY suspend the tool on the Versatrack™ Trackwall using the integral hang hook.

WARNING: The Versatrack™ integral hang hook is intended to mount the tool onto a Versatrack™ Trackwall rail. Do not use the integral hang hook to mount the tool to any other surface.

WARNING: The Versatrack™ integral hang hook is not a belt hook.

WARNING: When hanging objects on a Versatrack™ Trackwall rail, adequately space the tools to not exceed 75 lb (35 kg) per linear foot.

WARNING: Before using the tool make sure that the Versatrack™ integral hang hook is returned to its original position

IMPORTANT: Versatrack™ accessories mount compatible tools securely to the Versatrack™ Trackwall system.

1. Turn the tool off, remove the battery pack and remove accessories.

CAUTION: Any product with exposed cutting teeth must have them covered securely if it is to be on the Versatrack™ Trackwall.

2. Mount the integral hang hook 25 to the Versatrack™ Trackwall.

NOTE: Versatrack™ accessories for use with your tool are available at extra cost from your local dealer or authorized service centre. If you need assistance in locating any accessory, please contact CRAFTSMAN, call 1-888-331-4569

Cleaning

WARNING: Blow dirt and dust out of all air vents with clean, dry air at least once a week. To minimize the risk of eye injury, always wear ANSI Z87.1-approved eye protection when performing this procedure.

WARNING: Never use solvents or other harsh chemicals for cleaning the non-metallic parts of the tool. These chemicals may weaken the plastic materials used in these parts. Use a cloth dampened only with water and mild soap. Never let any liquid get inside the tool; never immerse any part of the tool into a liquid.

Repairs

The charger and battery pack are not serviceable. There are no serviceable parts inside the charger or battery pack.

WARNING: To assure product SAFETY and RELIABILITY, repairs, maintenance and adjustment (including brush inspection and replacement, when applicable) should be performed by a CRAFTSMAN factory service centre or a CRAFTSMAN authorized service centre. Always use identical replacement parts.

Register Online

Thank you for your purchase. Register your product now for:

- **WARRANTY SERVICE:** Registering your product will help you obtain more efficient warranty service in case there is a problem with your product.
- **CONFIRMATION OF OWNERSHIP:** In case of an insurance loss, such as fire, flood or theft, your registration of ownership will serve as your proof of purchase.

FOR YOUR SAFETY

Registering your product will allow us to contact you in the unlikely event that a safety notification is required under the Federal Consumer Safety Act. Register online at www.craftsman.com/registration

Three-Year Limited Warranty

CRAFTSMAN will repair or replace, without charge, any defects due to faulty materials or workmanship for three years from the date of purchase (two years for batteries). This warranty does not cover part failure due to normal wear or tool abuse. For further details on warranty coverage and warranty repair information, visit www.craftsman.com or call 1-888-331-4569. This warranty does not apply to accessories or damage caused where repairs have been made or attempted by others.

THIS LIMITED WARRANTY IS GIVEN INSTEAD OF ALL OTHERS, INCLUDING THE IMPLIED WARRANTY OF MERCHANTABILITY AND FITNESS FOR A PARTICULAR PURPOSE, AND EXCLUDES ALL INCIDENTAL OR CONSEQUENTIAL DAMAGES. Some states do not allow limitations on how long an implied warranty lasts or the exclusion or limitation of incidental or consequential damages, so these limitations may not apply to you. This warranty gives you specific legal rights and you may have other rights which vary in certain states or provinces.

2 YEARS FREE SERVICE ON CRAFTSMAN BATTERY PACK CMCB201, CMCB2011

3-YEAR FREE SERVICE ON CRAFTSMAN BATTERY PACKS

CMCB202, CMCB204

NOTE: Battery warranty voided if the battery pack is tampered with in any way. CRAFTSMAN is not responsible for any injury caused by tampering and may prosecute warranty fraud to the fullest extent permitted by law.

90 DAY MONEY BACK GUARANTEE

If you are not completely satisfied with the performance of your CRAFTSMAN Power Tool or Nailer for any reason, you can return it within 90 days from the date of purchase with a receipt for a full refund – no questions asked.

LATIN AMERICA: This warranty does not apply to products sold in Latin America. For products sold in Latin America, see country-specific warranty information contained in the packaging, call the local company or see the website for warranty information.

FREE WARNING

Label Replacement

NOTE: If your warning labels become illegible or are missing, call 1-888-331-4569 for a free replacement.

Compatible battery packs and chargers

20V Max* Li-Ion	Battery Packs Blocs-piles Baterías	CMCB201, CMCB2011, CMCB202, CMCB204
	Chargers Chargeurs Cargadores	CMCB100, CMCB102, CMCB104, CMCB1104

60V Max* Li-Ion	Battery Packs Blocs-piles Baterías	CMCB6025, CMCB6050, CMCB6075
	Chargers Chargeurs Cargadores	CMCB602

Maximum initial battery voltage (measured without a workload) is 20, 60 or 120 volts. The nominal voltage is 18, 54 or 108. (120V Max* is based on using two 60V Max* lithium-ion batteries combined.)

WARNING: Use of any other battery packs may create a risk of injury and fire.

CRAFTSMAN, 701 East Joppa Road, Towson, MD 21286 Copyright © 2018, 2020

Download PDF: [Craftsman CMCB900 String Trimmer Edger User Manual](#)

References

- [User Manual](#)

[Manuals+](#), [Privacy Policy](#)

This website is an independent publication and is neither affiliated with nor endorsed by any of the trademark owners. The "Bluetooth®" word mark and logos are registered trademarks owned by Bluetooth SIG, Inc. The "Wi-Fi®" word mark and logos are registered trademarks owned by the Wi-Fi Alliance. Any use of these marks on this website does not imply any affiliation with or endorsement.