



# CRAFTSMAN CMCST910 20V Max String Trimmer-Edger Instruction Manual

[Home](#) » [Craftsman](#) » CRAFTSMAN CMCST910 20V Max String Trimmer-Edger Instruction Manual

## Contents [ [hide](#) ]

- 1 CRAFTSMAN CMCST910 20V Max String Trimmer-Edger
- 2 Components
- 3 Intended Use
  - 3.1 Service
- 4 Important Safety Warnings
  - 4.1 Additional Safety Information
- 5 Important Safety Instructions for All Battery Packs
- 6 Important Charging Notes
  - 6.1 Charger Cleaning Instructions
- 7 ASSEMBLY AND ADJUSTMENTS
  - 7.1 Installing the Guard (Fig. E, F)
  - 7.2 Attaching the Auxiliary Handle (Fig. G)
- 8 OPERATION
- 9 MAINTENANCE
- 10 Accessories
  - 10.1 Repairs
- 11 Three-Year Limited Warranty
- 12 Documents / Resources
  - 12.1 References
- 13 Related Posts



**CRAFTSMAN CMCST910 20V Max String Trimmer-Edger**



## Components

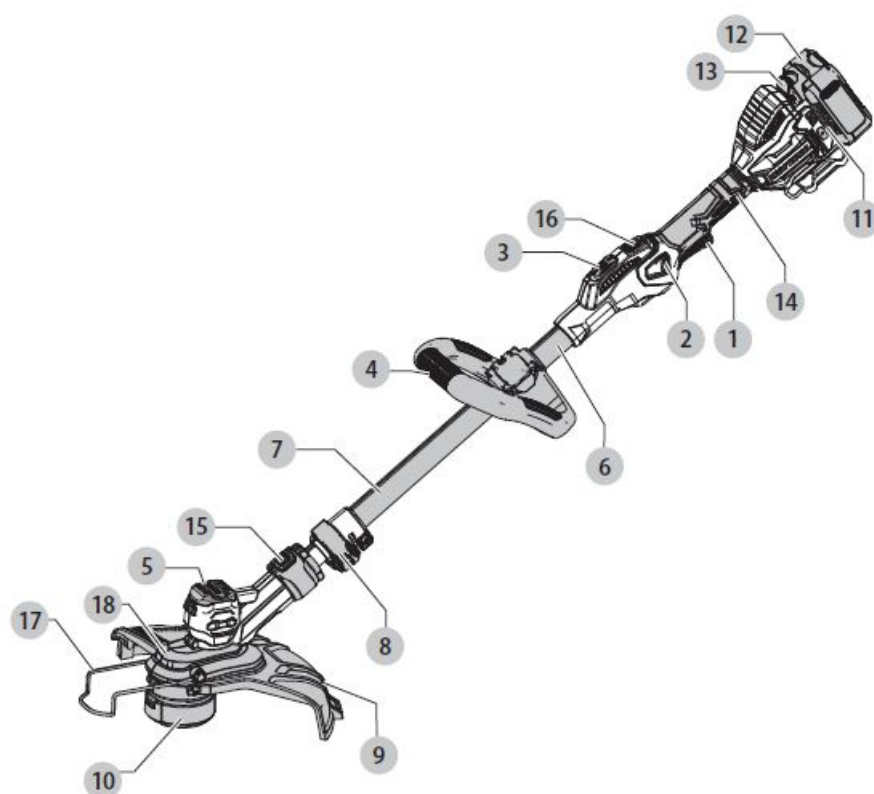

1. Trigger
2. Lock-off button
3. Speed control switch
4. Auxiliary handle
5. Upper trimmer pole

6. Lower trimmer pole
7. Pole bracket
8. Guard
9. Spool housing
10. Battery housing
11. Battery pack
12. Battery release button 14 Main handle
13. Convert-to-edge button 16 Line feed button
14. Wire edge guide
15. Trimmer's head

**WARNING:** Read all safety warnings and all instructions. Failure to follow the warnings and instructions may result in electric shock, fire and/ or serious injury.

**WARNING:** To reduce the risk of injury, read the instruction manual.

## Intended Use

- This string trimmer is designed for household trimming and edging applications.
- DO NOT use under wet conditions or in presence of flammable liquids or gases.
- DO NOT let children come into contact with the tool. Supervision is required when inexperienced operators use this tool.
- Definitions: Safety Alert Symbols and Words
- This instruction manual uses the following safety alert symbols and words to alert you to hazardous situations and your risk of personal injury or property damage.
- DANGER: Indicates an imminently hazardous situation that, if not avoided, will result in death or serious injury.
- WARNING: Indicates a potentially hazardous situation that, if not avoided, could result in death or serious injury.
- CAUTION: Indicates a potentially hazardous situation that, if not avoided, may result in minor or moderate injury. (Used without a word) Indicates a safety-related message.
- NOTICE: Indicates a practice not related to personal injury that, if not avoided, may result in property damage.

## GENERAL POWER TOOL SAFETY WARNINGS

**WARNING:** Read all safety warnings, instructions, illustrations and specifications provided with this power tool. Failure to follow all instructions listed below may result in electric shock, fire and/or serious injury.

The term "power tool" in the warnings refers to your mains-operated (corded) power tool or battery-operated (cordless) power tool.

## Work Area Safety

- Keep work area clean and well-lit. Cluttered or dark areas invite accidents.
- Do not operate power tools in explosive atmospheres, such as in the presence of flammable liquids, gases or dust. Power tools create sparks that may ignite the dust or fumes.
- Keep children and bystanders away while operating a power tool. Distractions can cause you to lose control.

## Electrical Safety

- Power tool plugs must match the outlet. Never modify the plug in any way. Do not use any adapter plugs with earthed (grounded) power tools. Unmodified plugs and matching outlets will reduce risk of electric shock.
- Avoid body contact with earthed or grounded surfaces, such as pipes, radiators, ranges and refrigerators. There is an increased risk of electric shock if your body is earthed or grounded.
- Do not expose power tools to rain or wet conditions. Water entering a power tool will increase the risk of electric shock.
- Do not abuse the cord. Never use the cord for carrying, pulling or unplugging the power tool. Keep cord away from heat, oil, sharp edges or moving parts. Damaged or entangled cords increase the risk of electric shock.
- When operating a power tool outdoors, use an extension cord suitable for outdoor use. Use of a cord suitable for outdoor use reduces the risk of electric shock.
- If operating a power tool in a damp location is unavoidable, use a ground fault circuit interrupter (GFCI) protected supply. Use of a GFCI reduces the risk of electric shock.

## Personal Safety

- Stay alert, watch what you are doing and use common sense when operating a power tool. Do not use a power tool while you are tired or under the influence of drugs, alcohol or medication. A moment of inattention while operating power tools may result in serious personal injury.
- Use personal protective equipment. Always wear eye protection. Protective equipment such as a dust mask, non-skid safety shoes, hard hat, or hearing protection used for appropriate conditions will reduce personal injuries.
- Prevent unintentional starting. Ensure the switch is in the off-position before connecting to power source and/or battery pack, picking up or carrying the tool. Carrying power tools with your finger on the switch or energizing power tools that have the switch on invites accidents.
- Remove any adjusting key or wrench before turning the power tool on. A wrench or a key left attached to a rotating part of the power tool may result in personal injury.
- Do not overreach. Keep proper footing and balance at all times. This enables better control of the power tool in unexpected situations.
- Dress properly. Do not wear loose clothing or jewelry. Keep your hair, clothing and gloves away from moving parts. Loose clothes, jewelry or long hair can be caught in moving parts.
- If devices are provided for the connection of dust extraction and collection facilities, ensure these are connected and properly used. Use of dust collection can reduce dust-related hazards.
- Do not let familiarity gained from frequent use of tools allow you to become complacent and ignore tool safety principles. A careless action can cause severe injury within a fraction of a second.
- Power Tool Use and Care Do not force the power tool. Use the correct power tool for your application. The correct power tool will do the job better and safer at the rate for which it was designed.
- Do not use the power tool if the switch does not turn it on and off. Any power tool that cannot be controlled with the switch is dangerous and must be repaired.
- Disconnect the plug from the power source and/ or remove the battery pack, if detachable, from the power tool before making any adjustments, changing accessories, or storing power tools. Such preventive safety measures reduce the risk of starting the power tool accidentally.
- Store idle power tools out of the reach of children and do not allow persons unfamiliar with the power tool or

these instructions to operate the

power tool. Power tools are dangerous in the hands of untrained users.

- Maintain power tools and accessories. Check for misalignment or binding of moving parts, breakage of parts and any other condition that may affect the power tool's operation. If damaged, have the power tool repaired before use. Many accidents are caused by poorly maintained power tools.
- Keep cutting tools sharp and clean. Properly maintained cutting tools with sharp cutting edges are less likely to bind and are easier to control.
- Use the power tool, accessories and tool bits etc. in accordance with these instructions, taking into account the working conditions and the work to be performed. Use of the power tool for operations different from those intended could result in a hazardous situation.
- Keep handles and grasping surfaces dry, clean and free from oil and grease. Slippery handles and grasping surfaces do not allow for safe handling and control of the tool in unexpected situations.

### **Battery Tool Use and Care**

- Recharge only with the charger specified by the manufacturer. A charger that is suitable for one type of battery pack may create a risk of fire when used with another battery pack.
- Use power tools only with specifically designated battery packs. Use of any other battery packs may create a risk of injury and fire.
- When the battery pack is not in use, keep it away from other metal objects, like paper clips, coins, keys, nails, screws or other small metal objects, that can make a connection from one terminal to another. Shorting the battery terminals together may cause burns or a fire.
- Under abusive conditions, liquid may be ejected from the battery; avoid contact. If contact accidentally occurs, flush with water. If liquid contacts eyes, additionally seek medical help. Liquid ejected from the battery may cause irritation or burns.
- Do not use a battery pack or tool that is damaged or modified. Damaged or modified batteries may exhibit unpredictable behavior resulting in fire, explosion or risk of injury.
- Do not expose a battery pack or tool to fire or excessive temperature. Exposure to fire or temperature above 265 °F (130 °C) may cause an explosion.
- Follow all charging instructions and do not charge the battery pack or tool outside the temperature range specified in the instructions. Charging improperly or at temperatures outside the specified range may damage the battery and increase the risk of fire.

### **Service**

- Have your power tool serviced by a qualified repair person using only identical replacement parts. This will ensure that the safety of the power tool is maintained.
- Never service damaged battery packs. Service of battery packs should only be performed by the manufacturer or authorized service providers.

### **Important Safety Warnings**

- **WARNING:** When using electric gardening appliances, basic safety precautions should always be followed to reduce risk of fire, electric shock, and personal injury, including the following.

- **WARNING:** Do not remove guard. The guard must be attached during use. Operating this trimmer without the guard will violate the product warranty.
- **CAUTION:** When replacing the line, use only 0.080" (2 mm) diameter twisted nylon monofilament line. Other diameters or shapes may degrade performance or cause damage to the trimmer.
- **ALWAYS WEAR EYE PROTECTION** – Wear safety spectacles or goggles at all times when the battery is installed. These items are available for purchase.
- **GUARD** - Do not use this appliance without the guard attached.
- **DRESS PROPERLY** – Do not wear loose clothing or jewelry. They can be caught in moving parts. Gloves and substantial rubber-soled footwear are recommended when working outdoors. Don't operate the appliance when barefoot or wearing open sandals. Wear heavy long pants to protect your legs. Wear protective hair covering to contain long hair.
- **NYLON LINE** – Keep face, hands and feet clear of rotating nylon line at all times.
- **THE ROTATING LINE PERFORMS A CUTTING FUNCTION** – Use care when trimming around screens and desirable plantings.
- **DO NOT USE** materials not recommended, such as metal wire, rope, and the like.
- **KEEP ALL BYSTANDERS AWAY** – at a safe distance from the work area, especially for children.
- **KEEP CHILDREN, BYSTANDERS AND ANIMALS AWAY** from the work area a minimum of 30 feet (10 meters) when starting or operating the unit.
- **TO REDUCE THE RISK** of rebound (ricochet) injury, work going away from any nearby solid object such as wall, steps, large stone, tree, etc. Use great care when working close to solid objects and where necessary, do trimming by hand.
- **AVOID ACCIDENTALLY STARTING** – Don't carry a plugged-in trimmer with a finger on the trigger.
- **USE THE RIGHT appliance** – Do not use this appliance for any job except that for which it is intended.  
**DON'T OVERREACH** – Keep proper footing and balance at all times.
- **DON'T FORCE APPLIANCE** – It will do the job better and with less likelihood of a risk of injury at the rate for which it was designed
- **DAMAGE TO UNIT** – If you strike or become entangled with a foreign object, stop appliance immediately, unplug, check for damage and have any damage repaired before further operation is attempted. Do not operate with a broken hub or spool.
- **DISCONNECT TRIMMER** – Remove the battery when not in use, when replacing line, or prior to cleaning.
- **AVOID DANGEROUS ENVIRONMENTAL CONDITIONS**
- Do not use electric appliances in damp or wet locations. Follow all instructions in this Instruction Manual for the proper operation of your appliance. Don't use the appliance in the rain.
- **DO NOT OPERATE** portable electric appliances in gaseous or explosive atmospheres. Motors in these appliances normally spark, and the sparks might ignite fumes.
- **STORE IDLE APPLIANCES INDOORS** – Remove the battery when not in use, appliances should be stored indoors in a dry, locked-up place out of reach of children.
- **STAY ALERT** – Do not operate this unit when you are tired, ill, or under the influence of alcohol, drugs, or medication.
- **MAINTAIN APPLIANCES WITH CARE** – Follow instructions in the Maintenance section. Keep handles dry, clean and free from oil and grease.
- **CHECK DAMAGED PARTS** – Before further use of the appliance, a guard or other part that is damaged should

be carefully checked to determine that it will operate properly and perform its intended function. Check for alignment of moving parts, binding of moving parts, breakage of parts, mounting, and any other condition that may affect its operation. A guard or other part that is damaged should be properly repaired or replaced by an authorized service center unless otherwise indicated elsewhere in this manual.

- DO NOT immerse the appliance in water or squirt it with a hose. DO NOT allow any liquid to get inside it.
- DO NOT store the appliance on or adjacent to fertilizers or chemicals.
- DO NOT clean with a pressure washer.
- Keep guards in place and in working order.
- Keep hands and feet away from the cutting area.
- INSPECT THE AREA before using the unit. Remove all debris and hard objects such as rocks, glass, wire, etc. that can ricochet, be thrown, or otherwise cause injury or damage during operation.

**WARNING:** Do not use the appliance if the switch trigger does not turn the appliance on or off. Any appliance that can not be controlled with the switch trigger is dangerous and must be repaired.

### **Additional Safety Warnings**

**WARNING:** To reduce the risk of rebound (ricochet) injury, work going away from any nearby solid object such as wall, steps, large stone, tree, etc.

- **GUARD** – Do not use this appliance without guard attached.
- **DRESS PROPERLY** – Do not wear loose clothing or jewelry. They can be caught in moving parts. Gloves and substantial rubber-soled footwear are recommended when working outdoors. Don't operate the appliance when barefoot or wearing open sandals. Wear heavy long pants to protect your legs. Wear protective hair covering to contain long hair.
- **KEEP FACE, HANDS AND FEET CLEAR OF ROTATING NYLON LINE AT ALL TIMES.** The rotating line performs a cutting function use care when trimming around screens and desirable plantings.
- **KEEP ALL BYSTANDERS AWAY** – at a safe distance from the work area, especially for children. **MAKE SURE** that other persons and pets are at least 100 feet (30 m) away.
- **WHEN BEING USED AS AN EDGER** – stones, pieces of metal and other objects can be thrown out at high speed by the line. The appliance and guard are designed to reduce the danger. To reduce the risk of rebound (ricochet) injury, work going away from any nearby solid object such as wall, steps, large stone, tree, etc.
- **USE GREAT CARE** when working close to solid objects and where necessary, do trimming by hand.
- **DAMAGE TO UNIT** – If you strike or become entangled with a foreign object, stop the appliance immediately, remove the battery, check for damage and have any damage repaired before further operation is attempted. Do not operate with a broken hub or spool.
- **DO NOT OPERATE** portable electric appliances in gaseous or explosive atmospheres. Motors in these appliances normally spark, and the sparks might ignite fumes.
- **STAY ALERT** – Do not operate this unit when you are tired, ill, or under the influence of alcohol, drugs, or medication. DO NOT immerse the appliance in water or squirt it with a hose.
- DO NOT allow any liquid to get inside it. If the appliance does get wet, allow to dry for a minimum of 48 hours.
- DO NOT clean with a pressure washer.
- DO NOT store the appliance on or adjacent to fertilizers or chemicals.

- DO NOT charge appliances in rain, or in wet locations.
- STORE IDLE APPLIANCES INDOORS – When not in use, appliances should be stored indoors in a dry, locked-up place out of reach of children.

### **Additional Safety Information**

- **WARNING:** Never modify the power tool or any part of it. Damage or personal injury could result.

**WARNING:** ALWAYS use safety glasses.

Everyday eyeglasses are NOT safety glasses. Also, use face or dust mask if the operation is dusty. ALWAYS

**WEAR CERTIFIED SAFETY EQUIPMENT:**

- ANSI Z87.1 eye protection (CAN/CSA Z94.3),
- ANSI S12.6 (S3.19) hearing protection,
- NIOSH/OSHA/MSHA respiratory protection.
- **WARNING:** Some dust contains chemicals known to State of California to cause cancer, birth defects or other reproductive harm. Some examples of these chemicals are:
  - compounds in fertilizers,
  - compounds in insecticides, herbicides and pesticides,
  - arsenic and chromium from chemically treated lumber.

To reduce your exposure to these chemicals, wear approved safety equipment such as dust masks that are specially designed to filter out microscopic particles.
- **WARNING:** Use of this tool can generate and/or disperse dust, which may cause serious and permanent respiratory or another injury. Always use NIOSH/OSHA-approved respiratory protection appropriate for the dust exposure. Direct particles away from face and body.
 

**WARNING:** Always wear proper personal hearing protection that conforms to ANSI S12.6 (S3.19) during use. Under some conditions and duration of use, noise from this product may contribute to hearing loss.

**CAUTION:** When not in use, place tool on its side on a stable surface where it will not cause tripping or falling hazard. Some tools with a the large battery pack will stand upright but may be easily knocked over.
- Air vents often cover moving parts and should be avoided. Loose clothes, jewelry or long hair can be caught in moving parts.
 

The label on your tool may include the following symbols. The symbols and their definitions are as follows:



V..... volts	Ah..... amp hours
Hz ..... hertz	~ or AC..... alternating current
min ..... minutes	⎓ or AC/DC.... alternating or direct current
≡ or DC..... direct current	
ⓘ ..... Class I Construction (grounded)	Ⓜ ..... Class II Construction (double insulated)
.../min..... per minute	n <sub>0</sub> ..... no load speed
BPM..... beats per minute	n ..... rated speed
IPM ..... impacts per minute	⏏ ..... earthing terminal
RPM..... revolutions per minute	⚠ ..... safety alert symbol
	⚠ ..... visible radiation
sfpmin ..... surface feet per minute	☑ ..... wear respiratory protection
SPM ..... strokes per minute	☑ ..... wear eye protection
A ..... amperes	☑ ..... wear hearing protection
W..... watts	
Wh..... watt hours	📖 ..... read all documentation

## BATTERIES AND CHARGERS

The battery pack is not fully

charged out of the carton. Before using the battery pack and charger, read the safety instructions below and then follow charging procedures outlined. When ordering replacement battery packs, be sure to include the catalog number and voltage.

## Important Safety Instructions for All Battery Packs

**WARNING:** Read all safety warnings, instructions, and cautionary markings for the battery pack, charger and product. Failure to follow the warnings and instructions may result in electric shock, fire and/or serious injury.

- Do not charge or use the battery pack in explosive atmospheres, such as in the presence of flammable liquids, gases or dust. Inserting or removing the battery pack from the charger may ignite the dust or fumes.
- NEVER force the battery pack into the charger. DO NOT modify the battery pack in any way to fit into a non-compatible charger as battery pack may rupture causing serious personal injury. Consult the chart at the end of this manual for compatibility of batteries and chargers.
- Charge the battery packs only in CRAFTSMAN chargers.
- DO NOT splash or immerse in water or other liquids.
- DO NOT allow water or any liquid to enter the battery pack.
- Do not store or use the tool and battery pack in locations where the temperature may reach or exceed 104 °F (40 °C) (such as outside sheds or metal buildings in summer). For best life store battery packs in a cool, dry location.

NOTE: Do not store the battery packs in a tool with the trigger switch locked on. Never tape the trigger switch in the ON position.

- Do not incinerate the battery pack even if it is severely damaged or is completely worn out. The battery pack can explode in a fire. Toxic fumes and materials are created when lithium-ion battery packs are burned.

- Do not expose a battery pack or appliance to fire or excessive temperature. Exposure to fire or temperature above 265 °F (130 °C) may cause an explosion.
- Follow all charging instructions and do not charge the battery pack or appliance outside of the temperature range specified in the instructions. Charging improperly or at temperatures outside of the specified range may damage the battery and increase the risk of fire.
- If battery contents come into contact with the skin, immediately wash area with mild soap and water. If battery liquid gets into the eye, rinse water over the open eye for 15 minutes or until irritation ceases. If medical attention is needed, the battery electrolyte is composed of a mixture of liquid organic carbonates and lithium salts.
- Contents of opened battery cells may cause respiratory irritation. Provide fresh air. If symptoms persist, seek medical attention.
- Battery liquid may be flammable if exposed to spark or flame.

Never attempt to open the battery pack for any reason. If the battery pack case is cracked or damaged, do not insert it into the charger. Do not crush, drop or damage the battery pack. Do not use a battery pack or charger that has received a sharp blow, been dropped, run over or damaged in any way (e.g., pierced with a nail, hit with a hammer, stepped on). Damaged battery packs should be returned to the service center for recycling.

### Storage Recommendations

The best storage place is one that is cool and dry, away from direct sunlight and excess heat or cold. Store the fully charged battery pack out of the charger.

### Battery Pack Cleaning Instructions

Dirt and grease may be removed from the exterior of the battery pack using a cloth or soft non-metallic brush. Do not use water or any cleaning solutions.

### Fuel Gauge Battery Packs (Fig. B)

Some battery packs include a fuel gauge. When the fuel gauge button is pressed and held, the LED lights will indicate the approximate level of charge remaining. This does not indicate tool functionality and is subject to variation based on product components, temperature, and end-user application.

CRAFTSMAN-CMCST910-20V-Max-String-Trimder-fig-2

### Transportation

**WARNING:** Fire hazard. Do not store, carry, or transport the battery pack so that metal objects can contact exposed battery terminals. For example, do not place the battery pack in aprons, pockets, tool boxes, product kit boxes, drawers, etc., with loose nails, screws, keys, coins, hand tools, etc. When transporting individual battery packs, make sure that the battery terminals are protected and well insulated from materials that could contact them and cause a short circuit. NOTE: Li-ion battery packs should not be put in checked baggage on airplanes and must be properly protected from short circuits if they are in carry-on baggage.

### The RBRC® Seal

Please take your spent battery packs to an authorized CRAFTSMAN service center or to your local retailer for recycling. In some areas, it is illegal to place spent battery packs in the trash. You may also contact your local recycling center for information on where to drop off the spent battery pack. Do not place in curbside recycling. For more information visit [www.call2recycle.org](http://www.call2recycle.org). or call the toll-free number in the RBRC® Seal. RBRC® is a registered trademark of Call 2 Recycle, Inc.

**WARNING:** Read all safety warnings, instructions, and cautionary markings for the battery pack, charger and product. Failure to follow the warnings and instructions may result in electric shock, fire and/or serious injury.

- DO NOT attempt to charge the battery pack with any chargers other than a CRAFTSMAN charger. CRAFTSMAN chargers and battery packs are specifically designed to work together.
- These chargers are not intended for any uses other than charging CRAFTSMAN rechargeable battery packs. Charging other types of battery packs may cause them to overheat and burst, resulting in personal injury, property damage, fire, electric shock or electrocution.
- Do not expose the charger to rain or snow.
- Do not allow water or any liquid to enter charger.
- Pull by the plug rather than the cord when disconnecting the charger. This will reduce the risk of damage to the electric plug and cord.
- Make sure that the cord is located so that it will not be stepped on, tripped over or otherwise subjected to damage or stress.
- Do not use an extension cord unless it is absolutely necessary. Use of improper extension cord could result in risk of fire, electric shock or electrocution.
- When operating a charger outdoors, always provide a dry location and use an extension cord suitable for outdoor use. Use of a cord suitable for outdoor use reduces the risk of electric shock.
- An extension cord must have adequate wire size (AWG or American Wire Gauge) for safety. The smaller the gauge number of the wire, the heavier the cord and thus the greater its capacity. An undersized cord will cause a drop in line voltage resulting in loss of power and overheating. The following table shows the correct size to use depending on total length of all extension cords plugged together, and nameplate ampere rating. If in doubt, use the next heavier gauge.

#### Minimum Gauge for Cord Sets

Volts		Total length of Cord in Feet (meters)			
120V		25 (7.6)	50 (15.2)	100 (30.5)	150 (45.7)
Ampere Rating		American Wire gauge			
More Than	Not More Than				
0	6	18	16	16	14
6	10	18	16	14	12
10	12	16	16	14	12
12	16	14	12	Not Recommended	

- Do not place any object on top of the charger or place the charger on a soft surface that might block the ventilation slots and result in excessive internal heat. Place the charger in a position away from any heat source. The charger is ventilated through slots in the top and the bottom of the housing.
- Do not operate the charger with a damaged cord or plug. Have them replaced immediately.
- Do not operate the charger if it has received a sharp blow, been dropped or otherwise damaged in any way.

Take it to an authorized service center.

- Do not disassemble the charger; take it to an authorized service center when service or repair is required. Incorrect reassembly may result in a risk of electric shock, electrocution or fire.
- The charger is designed to operate on standard 120V household electrical power. Do not attempt to use it on any other voltage. This does not apply to the vehicular charger.
- Foreign materials of a conductive nature, such as, but not limited to, grinding dust, metal chips, steel wool, aluminum foil or any buildup of metallic particles should be kept away from the charger cavities and ventilation slots.
- Always unplug the charger from the power supply when there is no battery pack in the cavity.

### Charging a Battery (Fig. C, D)

1. Plug the charger into an appropriate outlet.
2. Insert and fully seat battery pack. Green charging light(s) will continuously blink while charging.
3. Charging is complete when the green charging light(s) remain(s) continuously ON. The battery pack can be left in the charger or removed.

**WARNING:** Only charge batteries in air temperature over 40 ° F (4.5 ° C) and below 104 ° F (+40 ° C).

4. 4. Charger will not charge a faulty battery pack, which may be indicated by the charging light(s) staying OFF. Take charger and battery pack to an authorized service center if light(s) stay(s) OFF.

**NOTE:** Refer to label near charging light(s) on charger for blink patterns.

**NOTE:** To remove the battery pack, some chargers require the battery pack release button to be pressed.

CRAFTSMAN-CMCST910-20V-Max-String-Trimmer-fig-3

CRAFTSMAN-CMCST910-20V-Max-String-Trimmer-fig-4

### Hot/Cold Pack Delay

When the charger detects a battery pack that is too hot or too cold, it automatically starts a Hot/Cold Pack Delay, suspending charging until the battery pack has reached an appropriate temperature. The charger then automatically switches to the pack charging mode. This feature ensures maximum battery pack life. A cold battery pack may charge at a slower rate than a warm battery pack. The hot/cold pack delay will be indicated by the green light(s) continuing to blink but with the red light continuously ON. Once the battery pack has reached an appropriate temperature, the red light will turn OFF and the charger will resume the charging procedure.

### Electronic Protection System

Li-Ion tools are designed with an Electronic Protection System that will protect the battery pack against overloading, overheating or deep discharge. The tool will automatically turn off and the battery pack will need to be recharged.

### Important Charging Notes

1. The charger and battery pack may become warm to the touch while charging. This is a normal condition and does not indicate a problem. To facilitate the cooling of the battery pack after use, avoid placing the charger or battery pack in a warm environment such as in a metal shed or an uninsulated trailer.
2. If the battery pack does not charge properly:
  - Check operation of the receptacle by plugging in a lamp or other appliance;
  - Check to see if the receptacle is connected to a light switch that turns the power off when you turn out the lights;

- If charging problems persist, take the tool, battery pack and charger to your local service center.
3. You may charge a partially used pack whenever you desire with no adverse effect on the battery pack.

### Charger Cleaning Instructions

**WARNING:** Shock hazard. Disconnect the charger from the AC outlet before cleaning. Dirt and grease may be removed from the exterior of the charger using a cloth or soft non-metallic brush. Do not use water or any cleaning solutions.

### Wall Mounting

Some CRAFTSMAN chargers are designed to be wall mountable or to sit upright on a table or work surface. If wall mounting, locate the charger within reach of an electrical outlet, and away from a corner or other obstructions which may impede airflow. Use the back of the charger as a template for the location of the mounting screws on the wall. Mount the charger securely using drywall screws (purchased separately) at least 1" (25.4 mm) long, with a screw head diameter of 0.28–0.35" (7–9 mm), screwed into wood to an optimal depth leaving approximately 7/32" (5.5 mm) of the screw exposed. Align the slots on the back of the charger with the exposed screws and fully engage them in the slots. NOTE: Do not attempt to mount the CMCB101 charger under a bench or table.

**NOTE:** Only mount the CMCB101 charger with the charging lights pointed upward toward the ceiling.  
VersaTrack™

**WARNING:** Do not charge batteries while charger is hung on Trackwall. CRAFTSMAN chargers, except the CMCB101, can be stored on CRAFTSMAN VersaTrack™ Trackwall. Hooks and accessories are sold separately. Please refer to the VersaTrack™ Trackwall accessory sheet for further information.

**NOTE:** The CMCB101 charger is not CRAFTSMAN VersaTrack™ Trackwall compatible.

SAVE THESE INSTRUCTIONS FOR FUTURE USE

## ASSEMBLY AND ADJUSTMENTS

**WARNING:** To reduce the risk of serious personal injury, turn unit off and remove the battery pack before making any adjustments or removing/installing attachments or accessories, when replacing line, or prior to cleaning. An accidental start-up can cause injury.

### Installing the Guard (Fig. E, F)

Fig. F

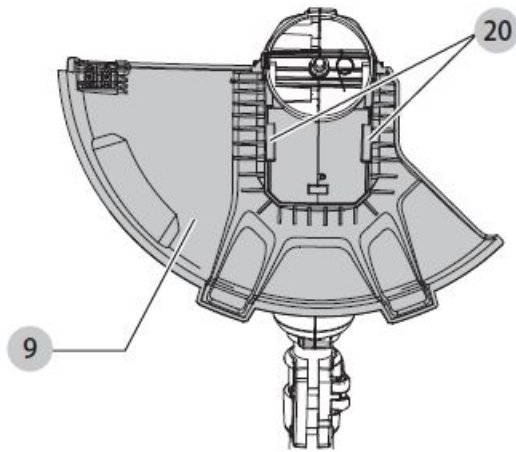

Fig. G

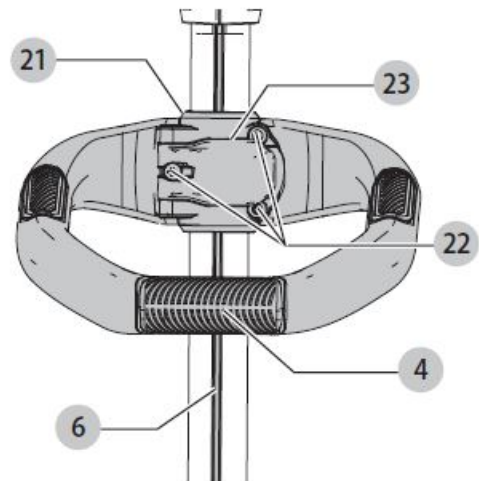

Fig. H

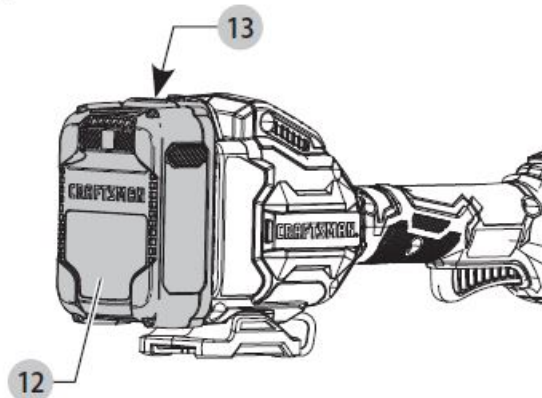
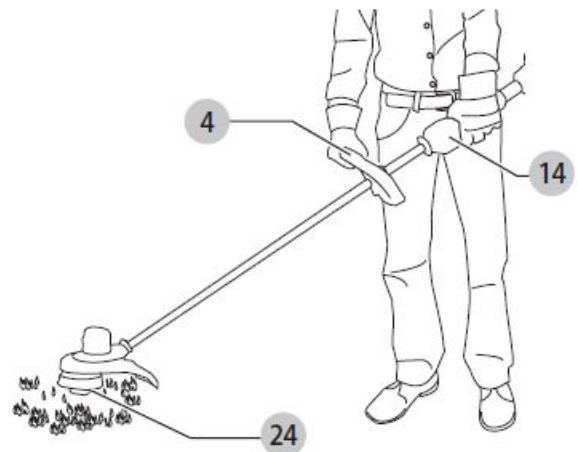

Fig. I



**WARNING:** Never remove the guard. Damage or personal injury could result.

**WARNING:** NEVER OPERATE APPLIANCE WITHOUT GUARD FIRMLY IN PLACE.

The guard must always be properly attached on the appliance to protect the user.

1. Remove the guard screw 19.
2. Slide the guard 9 fully onto the trimmer head 18. Make sure the tabs 20 on the guard engage the ribs on the trimmer head.
3. Continue to slide the guard on until it “snaps” into place. The locking tab should snap into the housing slot.
4. Using a crosshead screwdriver, insert the guard screw and tighten securely.
5. Once the guard is installed, remove the covering from the line cut-off blade, located on the edge of the guard.

#### Attaching the Auxiliary Handle (Fig. G)

1. Place the auxiliary handle 4 onto the top of the upper trimmer pole 6 as shown in Fig. G.
2. Slide bracket 21 of the auxiliary handle onto the bottom of the handle.
3. Thread the handle bolts 22 through the handle and into the bracket from above.
4. Tighten the handle bolts. Ensure the handle is securely attached by closing the handle clamp 23.
5. To adjust the position of the auxiliary handle, open the handle clamp and slide the handle up and down the pole until it is in the desired location. Close the clamp to lock the handle in place.

#### Releasing the Cutting Line (Fig. A)

In transit, the cutting line is taped to the spool housing 10.

- Remove the tape holding the cutting line to the spool housing.

## OPERATION

**WARNING:** To reduce the risk of serious personal injury, turn unit off and remove the battery pack before making any adjustments or removing/installing attachments or accessories, when replacing line, or prior to cleaning. An accidental start-up can cause injury.

### Installing and Removing the Battery Pack (Fig. H)

**NOTE:** For best results, make sure your battery pack is fully charged.

To install the battery pack 12 into the tool handle, align the battery pack with the rails inside the tool's handle and slide it into the handle until the battery pack is firmly seated in the tool and ensure that it does not disengage.

To remove the battery pack from the tool, press the release button 13 and firmly pull the battery pack out of the tool handle. Insert it into the charger as described in the charger section of this manual.

### Proper Hand Position (Fig. I)

- **WARNING:** To reduce the risk of serious personal injury, ALWAYS use proper hand position as shown.
- **WARNING:** To reduce the risk of serious personal injury, ALWAYS hold securely in anticipation of a sudden reaction. Proper hand position requires one hand on the main handle 14 and one hand on the auxiliary handle 4.

### Switching Trimmer On and Off (Fig. A)

**WARNING:** Never attempt to lock the trigger in the on position.

To turn the appliance on, squeeze the lock-off button 2 and then the trigger 1. Once the unit is running, you may release the lock-off button. To turn the appliance off, release the trigger.

### Trimming (Fig. J, K)

With the trimmer on, angle it and swing side to side as shown in Figure J.

Maintain a cutting angle of 5 ° to 10 °. Do not exceed 10 °. Cut with the tip of the line.

Maintain a minimum distance of 24" (610 mm) between the guard and your feet as shown in Figure K.

### Convert to Edging Mode (Fig. A)

- **CAUTION:** The edge guide should only be used when in the edging mode.

**WARNING:** Remove the battery pack from the power source before making any adjustments. The trimmer can be used in trimming mode or edging mode to trim overhanging grass along lawn edges and flower beds. To convert the trimmer to edging mode:

1. Press the convert-to-edge button 15 and rotate the motor housing 5 180 ° counterclockwise, until the motor housing snaps into edge position.
2. To return to the trimming position, Press the convert-to-edge button 15 and rotate the motor housing 5 180 ° clockwise back to its original position.

**NOTE:** You will experience faster than normal cutting line wear if the trimmer line is positioned directly over the sidewalk or abrasive surface.

### Edging Mode Operation (Fig. A)

**WARNING:** When being used as an edger, stones, pieces of metal and other objects can be thrown out at high speed by the line. The trimmer and guard are designed to reduce the danger. However, **MAKE SURE** that other persons and pets are at least 100' (30 m) away. Optimum cutting results are achieved on edges deeper than 2" (50 mm).

- Do not use this trimmer to create trenches.
- Using edge guide 17, guide the trimmer.
- Position the edging guide on the edge of the sidewalk or abrasive surface so the cutting line is over the grass or dirt area to be edged.
- To make a closer cut, slightly tilt the trimmer.

### **Speed Control Switch (Fig. A)**

This string trimmer gives you the choice to operate at a more efficient speed to extend the runtime for larger jobs, or accelerate the trimmer speed for high-performance cutting. To accelerate the trimmer, push the speed control switch 3 forward toward the auxiliary handle 4 into the "HI" position. This mode is best to cut through heavier growth and for applications that need higher RPM.

To extend runtime, pull the speed control switch back toward the battery housing 11 into the "LO" position. This mode is best for larger projects that require more time to complete.

**NOTE:** When in "HI" mode, the runtime will be decreased as compared to when the trimmer is in "LO" mode.

### **Line Feed Button (Fig. A)**

The line feed feature allows you to advance the length of the cutting line available while trimming.

- To extend the cutting line, fully depress the line feed button 16 while trimming and then release.

**NOTE:** The trimmer will stop cutting when the line feed button is pressed and will resume cutting when released. **NOTE:** For maximum line length, press the button multiple times until you hear the cutting line hitting the guard. Do not continue to press the line feed button once the maximum length is reached. This will result in overfeeding and will consume string quickly.

### **Helpful Cutting Tips (Fig. I)**

- Use the tip of the string to do the cutting; do not force string head into uncut grass. Use edge guide along such things as fences, houses and flower beds for best practices.
- Wire and picket fences cause extra string wear, and even breakage. Stone and brick walls, curbs, and wood may wear string rapidly.
- Do not allow spool cap 24 to drag on the ground or other surfaces.
- In long growth, cut from the top down and do not exceed 13" (330 mm) high.
- Keep the trimmer tilted toward the area being cut; this is the best cutting area.
- The trimmer cuts when passing the unit from the left to right. This will avoid throwing debris at the operator.
- Avoid trees and shrubs. Tree bark, wood moldings, siding, and fence posts can easily be damaged by the string.

### **Cutting Line / Line Feeding**

Your trimmer uses a .080" (2 mm) diameter, TWIST nylon line. During use, the tips of the nylon lines will become frayed and worn. Cutting line will wear faster and require more feeding if the cutting or edging is done along sidewalks or other abrasive surfaces or if heavier weeds are being cut.



## Clearing Jams and Tangled Line (Fig. L)

- **WARNING:** Remove the battery from the trimmer before making any assembly, adjustments or changing accessories. Such preventive safety measures reduce the risk of starting the appliance accidentally. From time to time, especially when cutting thick or stalky weeds, the line feeding hub may become clogged with sap or other material and the line will become jammed as a result. To clear the jam, follow the steps listed below.
- **CAUTION:** To avoid appliance damage, if the cutting line protrudes beyond the trimming blade, cut it off so that it just reaches the blade.

1. Remove the battery from the appliance.
2. Press the release tabs 25 on the spool cap 24 , and remove the spool cap from the spool housing 10 .
3. Pull the nylon line spool out and clear any broken line or cutting debris from the spool area.
4. Fit the spool onto the appliance as described in Replacing Spool Assembly.

## Replacing Spool Assembly (Fig. L, M)

- **WARNING:** The use of any accessory not recommended by CRAFTSMAN for use with this appliance could be hazardous.
- **WARNING:** Do not use any blades, or any accessory or attachment other than those recommended by CRAFTSMAN on this trimmer/edger. Serious injury or product damage may result. Reload nylon line (either bulk or rewound replacement spool) as shown in this manual. USE ONLY .080" (2 mm) DIAMETER TWISTED NYLON MONOFILAMENT LINE. Do not use serrated or heavier gauge line, as they will overload the motor and cause overheating. This line is available at your local dealer or authorized service center.

1. Remove the battery from the appliance.
2. Press the release tabs 25 on the spool cap 24 , and remove the spool cap from the spool housing 10 .
3. For best results, replace the spool with CRAFTSMAN Model # CMZST080.
4. If lever in base of the housing becomes dislodged, replace in the correct position before inserting the new spool into the housing. Remove any dirt and grass from the spool cap and spool housing.
5. Unfasten the end of the cutting line and guide the line into the eyelet.
6. Take the new spool and push it onto the boss 26 in the housing. Rotate the spool slightly until it is seated.
7. The line should protrude approximately 5-3/8" (136 mm) from the housing.
8. Align the release tabs on the spool cap with the slots in the spool housing.  
Snap the spool cap back on by depressing release tabs and pressing into the spool housing.
9. Push the cap onto the housing until it snaps securely into place.

**NOTE:** Make sure that cover is fully positioned, listen for two audible clicks to ensure both release tabs are correctly located. Power the appliance on. In a few seconds or less you'll hear the nylon line being cut automatically to the proper length.

Fig. J

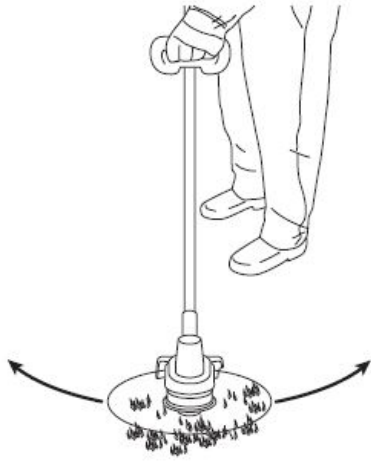

Fig. K

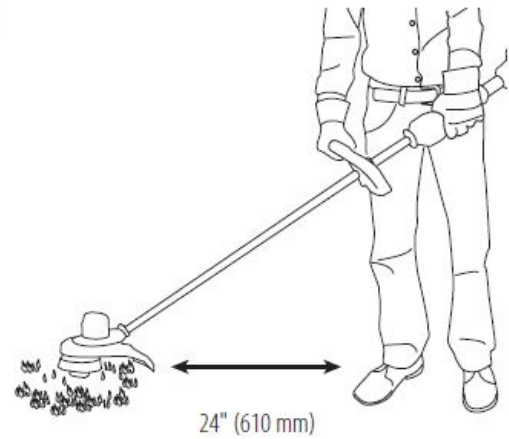

Fig. L

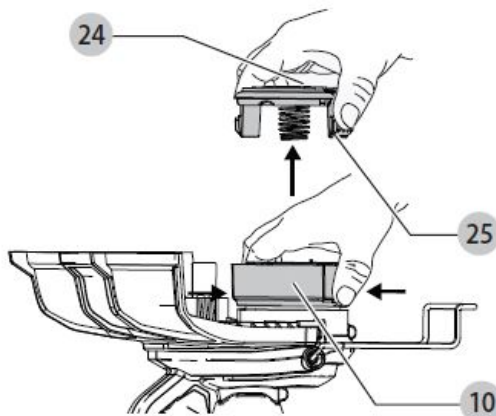
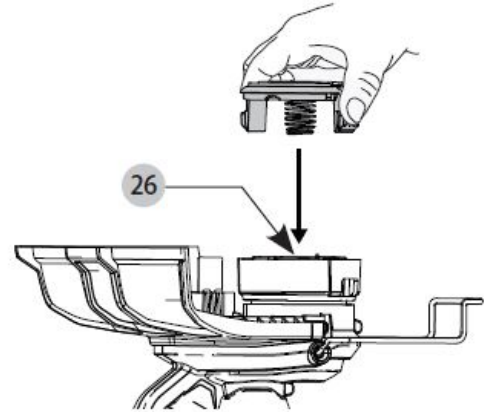

Fig. M



**NOTE:** Other replacement parts (guards, spool caps, etc.) are available through authorized service centers. To find your local service location call: 1-888-331-4569 or visit [www.craftsman.com](http://www.craftsman.com).

Rewinding Spool from Bulk Line (Fig. M, N) Use Only .080" (2 mm) TWISTED Diameter Line The bulk line is also available for purchase from your local retailer. NOTE: Hand-wound spools from bulk line are likely to become tangled more frequently than CRAFTSMAN factory wound spools. For best results, factory wound spools are recommended.

1. Remove battery from the appliance.
2. Remove the empty spool from the appliance as described in Replacing Spool Assembly.
3. Remove any remaining cutting line from the spool.
4. Make a fold at the end of the cutting line at about 3/4" (19 mm) 27 . Feed the cutting line into one of the line anchoring slots 28 .
5. Insert the 3/4" (19 mm) end of the bulk line into hole 29 in the spool adjacent to the slot. Make sure the line is pulled tight against the spool.
6. Wind the cutting line onto the spool in the direction of the arrow on the spool. Make sure to wind the line on neatly and in layers. Do not crisscross.
7. When the wound cutting line reaches the recesses 30 , cut the line.
8. Fit the spool onto the appliance as described in Replacing Spool Assembly.

## MAINTENANCE

**WARNING:** To reduce the risk of serious personal injury, turn unit off and remove the battery pack before making any adjustments or removing/installing attachments or accessories, when replacing line, or prior to cleaning. An accidental start-up can cause injury. Your CRAFTSMAN power tool has been designed to operate over a long period of time with a minimum of maintenance. Continuous satisfactory operation depends upon proper tool care and regular cleaning.

### Cleaning

- **WARNING:** Blow dirt and dust out of all air vents with clean, dry air at least once a week. To minimize the risk of eye injury, always wear ANSI Z87.1 approved eye protection when performing this procedure.
- **WARNING:** Never use solvents or other harsh chemicals for cleaning the non-metallic parts of the tool. These chemicals may weaken the plastic materials used in these parts. Use a cloth dampened only with water and mild soap. Never let any liquid get inside the tool; never immerse any part of the tool into a liquid.

### Accessories

**WARNING:** Since accessories, other than those offered by CRAFTSMAN, have not been tested with this product, use of such accessories with this tool could be hazardous. To reduce the risk of injury, only CRAFTSMAN recommended accessories should be used with this product. Recommended accessories for use with your tool are available at extra cost from your local dealer or authorized service center. If you need assistance in locating any accessory, please contact CRAFTSMAN call 1-888-331-4569.

### Replacing Guard (Fig. E, F)

**WARNING:** Never operate an appliance without guard firmly in place. Damage or personal injury could result.

#### Remove Current Guard

1. Remove the guard screw 19 shown in Fig. E.
2. Slide the guard 9 off.

#### Assembling the New Guard

1. Slide the guard into place as shown in Fig. F.
2. Replace and securely tighten the guard screw 19 .
- 3.

Fig. N

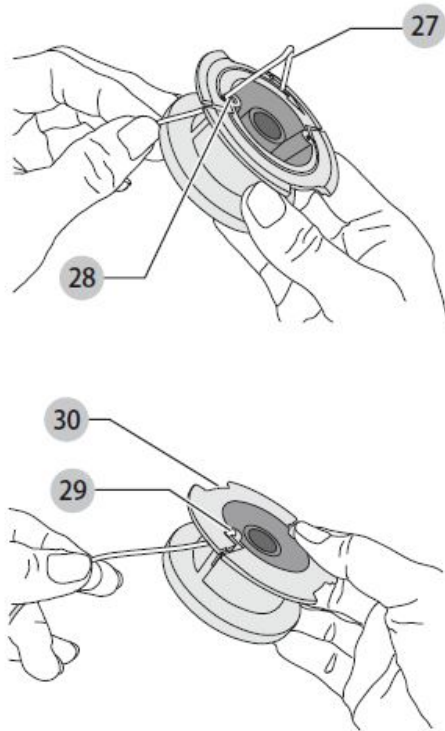
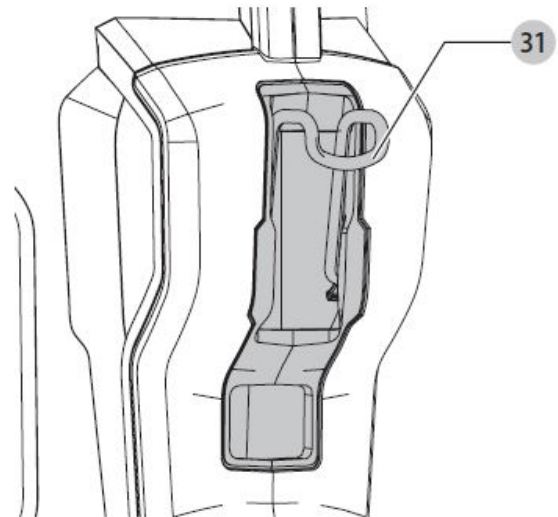

Fig. O



### Versatrack™ (Fig. O)

- **WARNING:** To reduce the risk of serious personal injury, turn unit off and remove the battery pack before making any adjustments or removing/installing attachments or accessories. An accidental start-up can cause injury.

**WARNING:** To reduce the risk of serious

personal injury, do not use a damaged Versatrack™ hang hook or Versatrack™ Trackwall. A damaged Versatrack™ hang hook or Versatrack™ Trackwall will not support the weight of the tool.

**WARNING:** To reduce the risk of serious personal injury, DO NOT suspend tool overhead or suspend objects from the hang hook. ONLY suspend tool on the Versatrack™ Trackwall using the hang hook.

**WARNING:** Ensure that the tool weight does not exceed the maximum rated weight of 20 lb (9 kg) for the selected Versatrack™ hook.

**WARNING:** When hanging objects on a Versatrack™ Trackwall rail, adequately space the tools in order to not exceed 75 lb (35 kg) per linear foot. **IMPORTANT:** Versatrack™ accessories mount compatible tools securely to the Versatrack™ Trackwall system.

1. Turn the tool off, remove the battery pack and accessories.

**CAUTION:** Any product with exposed cutting teeth must have them covered securely if it is to be on the Versatrack™ Trackwall.

2. Flip or pull open the integral hang hook 31 . It clicks when locked into position.
3. Mount the integral hang hook to the Versatrack™ Trackwall.

**NOTE:** Versatrack™ accessories for use with your tool are available at extra cost from your local dealer or authorized service center.

If you need assistance in locating any accessory, please contact CRAFTSMAN, call 1-888-331-4569.

The charger and battery pack are not serviceable. There are no serviceable parts inside the charger or battery pack.

**WARNING:** To assure product SAFETY and RELIABILITY, repairs, maintenance and adjustment (including brush inspection and replacement, when applicable) should be performed by a CRAFTSMAN factory service center or a CRAFTSMAN authorized service center. Always use identical replacement parts.

### Register Online

Thank you for your purchase. Register your product now for:

- **WARRANTY SERVICE:** Registering your product will help you obtain a more efficient warranty service in case there is a problem with your product.
- **CONFIRMATION OF OWNERSHIP:** In case of an insurance loss, such as fire, flood or theft, your registration of ownership will serve as your proof of purchase.
- **FOR YOUR SAFETY:** Registering your product will allow us to contact you in the unlikely event a safety notification is required under the Federal Consumer Safety Act.
- Register online at [www.craftsman.com/registration](http://www.craftsman.com/registration)

### Three-Year Limited Warranty

CRAFTSMAN will repair or replace, without charge, any defects due to faulty materials or workmanship for three years from the date of purchase. This warranty does not cover part failure due to normal wear or tool abuse. For further detail of warranty coverage and warranty repair information, visit [www.craftsman.com](http://www.craftsman.com) or call 1-888-331-4569. This warranty does not apply to accessories or damage caused where repairs have been made or attempted by others. THIS LIMITED WARRANTY

IS GIVEN IN LIEU OF ALL OTHERS, INCLUDING THE IMPLIED WARRANTY OF MERCHANTABILITY AND FITNESS FOR A PARTICULAR PURPOSE, AND EXCLUDES ALL INCIDENTAL OR CONSEQUENTIAL DAMAGES. Some states do not allow limitations on how long an implied warranty lasts or the exclusion or limitation of incidental or consequential damages, so these limitations may not apply to you. This warranty gives you specific legal rights and you may have other rights which vary in certain states or provinces.

### 90-DAY MONEY-BACK GUARANTEE

If you are not completely satisfied with the performance of your CRAFTSMAN Power Tool or Nailer for any reason, you can return it within 90 days from the date of purchase with a receipt for a full refund – no questions asked.

**LATIN AMERICA:** This warranty does not apply to products sold in Latin America. For products sold in Latin America, see country-specific warranty information contained in the packaging, call the local company or see the website for warranty information.

**FREE WARNING LABEL REPLACEMENT:** If your warning labels become illegible or are missing, call 1-888-331-4569 for a free replacement.

### Documents / Resources







20V Max\* String Trimmer/Edger  
 Taille-bordure/coupe-bordure 20 V max\*  
 Podadora/Bordeadora de Cuerda 20 V Mx\*

**CMCST910**

 IF YOU HAVE OUR STUNDS OR COMMENTS, CONTACT US.  
POUR TOUTES SUGERENCES OU TOUTES REMARQUES, NOUS CONTACTER.  
S'IL VOUS PLAIT, NOUS EN VOUS REMERCIERONS.

**1-888-331-4569**    **WWW.CRAFTSMAN.COM**

[CRAFTSMAN CMCST910 20V Max String Trimmer-Edger](#) [pdf] Instruction Manual  
CMCST910, 20V Max String Trimmer-Edger, CMCST910 20V Max String Trimmer-Edger

-  [Home](#) | [CRAFTSMAN](#)
-  [call2recycle.org](http://call2recycle.org)
-  [Home](#) | [CRAFTSMAN](#)
-  [Home](#) | [CRAFTSMAN](#)