



CP PLUS CP-HAS-M99-W Smart Motion Sensor User Manual

[Home](#) » [CP PLUS](#) » CP PLUS CP-HAS-M99-W Smart Motion Sensor User Manual 

Contents

- [1 CP PLUS CP-HAS-M99-W Smart Motion Sensor](#)
- [2 Product Information](#)
- [3 Product Usage Instructions](#)
- [4 Product Introduction](#)
- [5 Illustration](#)
- [6 Technical Parameters](#)
- [7 Networking](#)
- [8 INSTRUCTION](#)
- [9 Visual Indication](#)
- [10 Sensor Detection Mode Description](#)
- [11 Installation Precautions](#)
- [12 Product Installation](#)
- [13 Detecting Area](#)
- [14 Battery Replacement](#)
- [15 Statement](#)
- [16 Documents / Resources](#)
- [17 Related Posts](#)



CP PLUS CP-HAS-M99-W Smart Motion Sensor



Product Information

- This smart motion sensor is designed for indoor use only.
- It utilizes WiFi wireless technology to report real-time detection results to the user's mobile phone app.
- The sensor supports automatic threshold adjustment technology, which improves stability and reduces false alarms.
- It also features automatic temperature compensation technology to prevent sensitivity decrease due to temperature variations.
- Operating Voltage: DC3V
- Detecting Distance: maximum 9m under 25°C

Product Usage Instructions

1. Scan the QR code above to download the EZYKAM+ app and register a user account.
2. Before installation, ensure successful WiFi networking inclusion.
3. Make sure your mobile phone's Bluetooth and WiFi functions are turned on before networking operations, and allow the app access to WiFi and Bluetooth permissions.
4. Push the bracket in the direction of the arrow to install the motion sensor. Remove the insulating film to power it on. The device will enter the warm-up state, indicated by a flashing blue LED for 30 seconds.
5. To enter networking mode, follow either Method one (EZ networking) or Method two (AP networking), as described:
 - Method one (EZ networking): Press and hold the networking button for about 5 seconds. The blue LED will flash quickly, indicating the device has entered networking state.
 - Method two (AP networking): Press and hold the networking button for about 5 seconds, then press and hold it again for about 5 seconds. The blue LED will flash quickly, then start flashing slowly.
6. Open the EZYKAM+ app and click the "+" button to add a new device. Select "Sensors" and then "Motion Sensor (Wi-Fi)".
7. Select either EZ mode or AP mode.
8. Enter your Wi-Fi network and password, and click "NEXT" to follow the app prompts until the network is successfully added.
9. The blue LED will indicate the networking status:

- Blue LED flashes quickly: Networking succeeds or fails.
- Blue LED flashes slowly: Networking in progress.
- Blue LED flashes once: Sensor power on, warm-up completed.

10. Paste the bracket in the desired area after removing the double-sided tape. Ensure the installation surface is smooth, flat, stable, dry, and clean. The arrow mark on the bracket should face upward. Install the sensor onto the bracket.

11. The sensor will go through the following detection modes:

- Warm-up period (about 30 seconds) after power on.
- Test mode (about 5 minutes) after the warm-up period ends.
- Power-saving mode after test mode.

Please read the user manual carefully before operation. The guide picture is for reference only. please in kind prevail.

Product Introduction

This smart motion sensor is for indoor use only. It adopts WiFi wireless technology, can report real-time detection result to user mobile phone APP. It supports automatic threshold adjustment technology which enhances the sensor's performance stability, and efficiently reduce false alarms; Automatic temperature compensation technology greatly prevents the sensor from the decrease in sensitivity resulted from the temperature variation.

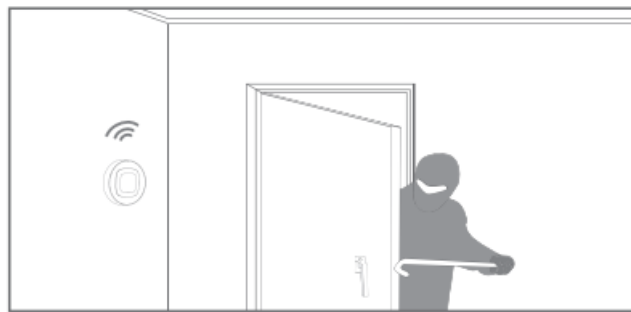

Illustration

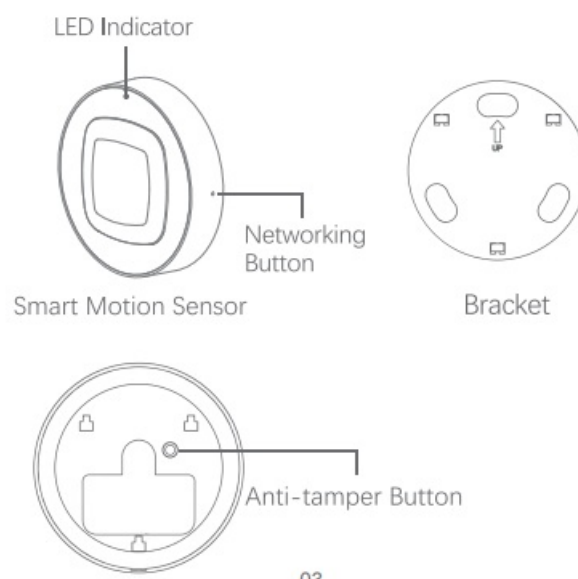

Technical Parameters

1. Operating Voltage: DC3V(CR123A / CR17335 x1)

2. Detecting Distance: max. 9m under 25°C(detecting distance will be different, depending on environment temperature)
3. Detection Angle: 90°
4. Networking: WiFi-2.4GHz
5. WiFi Protocol: IEEE 802.11 b/g/n
6. Working Temperature: -10°C~+50°C
7. Working Humidity: ≤95%(no condensation)
8. Pet Protection Level: 11kg or less
9. Dimension: 80mm x 28.5mm

Networking

Scan the QR code above to download the EZYKAM+ APP and register a user account.



1. Due to software updates, the operation in user manual may be different from APP descriptions. Please follow the operation guideline in APP in actual operation.
2. This sensor support OTA, the user could update to the latest APP version available to get a better user experience.
3. If networking inclusion fails, please move the sensor closer to router, and try again.
4. Make sure WiFi networking inclusion is successful before installation.

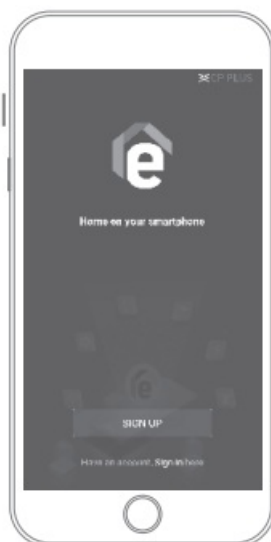

5. Enter the user account and password.

Make sure your mobile phone Bluetooth and WiFi functions are both turned on before networking operations, and APP should be allowed access to WiFi and Bluetooth permission.

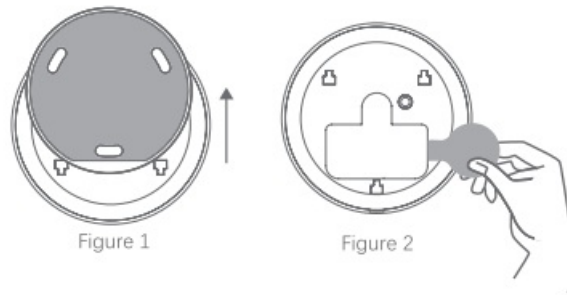

- Push the bracket in the direction of the arrow. (Figure 1)
- Remove the insulating film to power on the motion sensor and the device will enter into warm-up state. Blue LED will flash for 30 seconds and then go off, indicating warm-up is finished. (Figure 2)

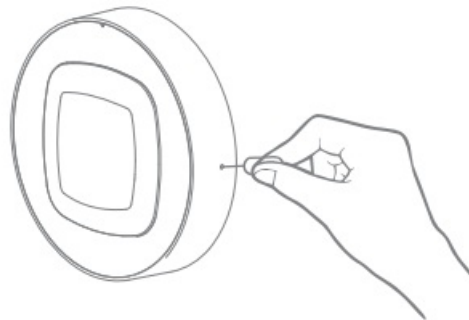

Method one

EZ networking: Press and hold the networking button for about 5 seconds, blue LED will flash quickly (about 2 times per second), and the device enters the networking state.

Method two

- AP networking: Press and hold the networking button for about 5 seconds, blue LED will flash quickly (about 2 times per second), then press and hold the networking button again for about 5 seconds, and blue LED will start to flash slowly (about once every 3 seconds).
- When the device enters in networking state, it's optional for APP



- Click* "+" in the APP to add a new device, Select "Sensors" > Select Motion Sensor (Wi-Fi)

INSTRUCTION

- You can select “EZ mode” or “AP mode”

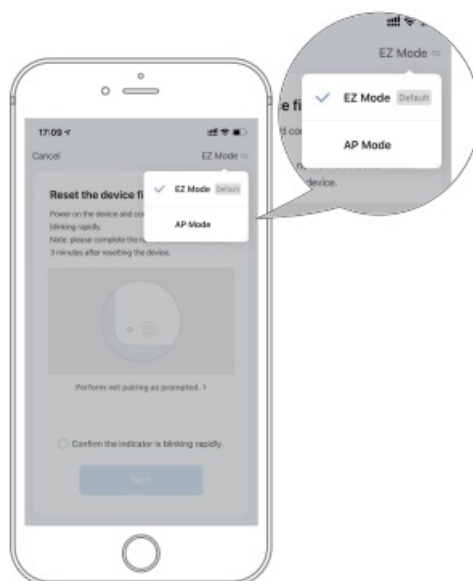

- Enter your “Wi-Fi network and password”, click “NEXT”. Please follow the corresponding APP prompts until the network is successfully added.

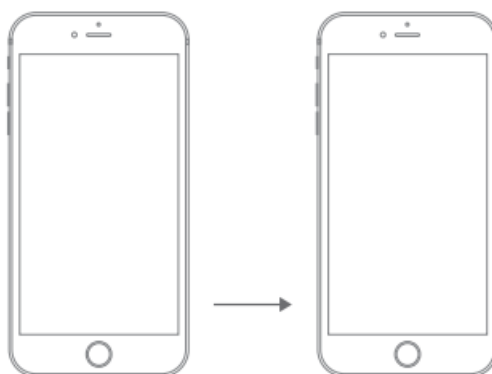

Visual Indication

LED Indicator	Product Status
Blue LED flashes quickly	EZ networking
Blue LED flashes slowly	AP networking
Blue LED off	Networking succeeds or fails.
Blue LED flashes once	Alarm
Power on the sensor, blue LED flashes 30 seconds	Warm-up

Sensor Detection Mode Description

Detection Mode Instruction

- The sensor will enter warm-up period (this period lasts around 30s) after it's powered on;
- When warm-up period ends, the sensor enters test mode (this period lasts around 5 minutes);
- Power-saving mode will be executed after test mode. Warm up period: Blue LED flashes for about 30 seconds;
- Test mode: Detection interval is 10 seconds, the sensor will report "somebody passes" immediately when it detects somebody passes;
- Power-saving mode: It won't repeat alarm report within 30 minutes since last report of "somebody passes". The sensor will report "nobody passes" if nobody passes within 30 minutes, and it will report alarm if being triggered after receiving report of "somebody passes".

Pet Immunity

The sensor should be installed under recommended height, and it won't alarm when pets (weight less than 11kg) pass by. (Customer experiences will differ in different installation environment.)

Installation Precautions



- This product is for indoor use only.
- When installing, note that the LED should face upwards.
- Avoid to install the sensor outdoors, or in places with pets, or near air-conditioners, heat source, rotating objects, in places with direct sunshine.
- The installation surface should be solid without vibration.
- Please install the sensor in places where an intruder may pass easily.

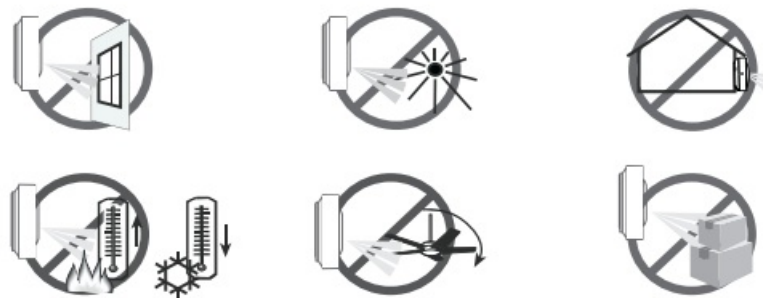

Product Installation

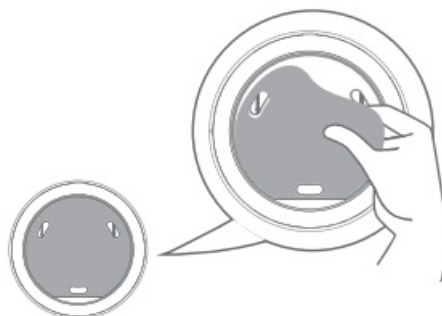

- Paste the bracket in the proper area after removing double-side tape on the bracket.

Installation with double-sided adhesive should pay attention to as follows:

1. Make sure the installation surface is smooth, flat, stable, dry and clean.
2. After installation, regularly check whether the product is attached firmly to the installation surface.

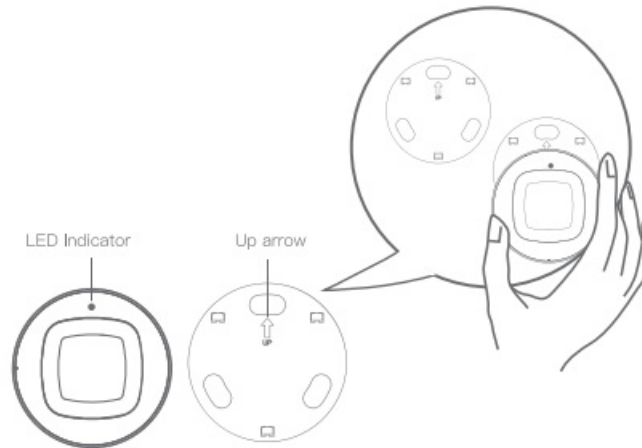

3. After removing double-side adhesive and paste the bracket (arrow mark on the bracket face upward) in the proper area.
4. Make sure the LED indicator is on the upper side of the sensor and install the sensor onto the bracket

Detecting Area

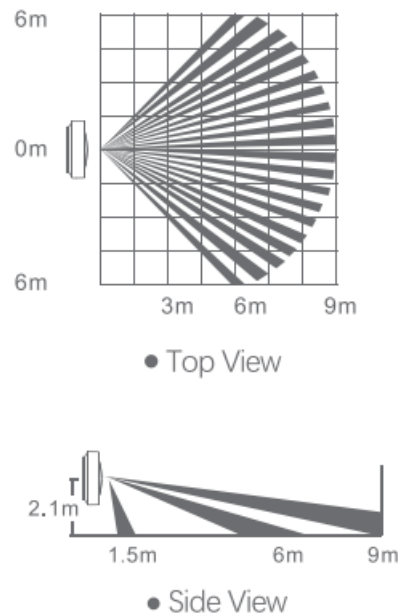

Battery Replacement

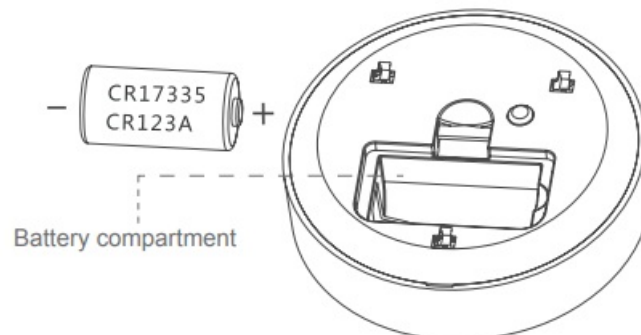

Remove the sensor from the mounting bracket and take out the used battery, insert one new battery into the

battery compartment, and install the sensor back to the bracket.
Attention: Dispose of the used battery properly for environmental protection.

Statement

The information in the user manual is for reference only and does not constitute any form of commitment.

- Without the written permission of the manufacturer, any individual or organization shall not extract or copy part or all of the contents of this user manual, and shall not spread it in any form.
- As the technology is constantly updated, the manufacturer reserves the right to modify the user manual without any prior notice. If the user manual and the actual operations are inconsistent the final interpretation is reserved to the manufacturer herein.

Thank you for choosing
CP Plus products
For further assistance, you can reach us via.
support@cpplusworld.com
Please read the instruction carefully before using the products **

Documents / Resources

	CP PLUS CP-HAS-M99-W Smart Motion Sensor [pdf] User Manual 20210470-72cf-48a5-a9e5-cc17a0c489b3, CP-HAS-M99-W Smart Motion Sensor, CP-HAS-M99-W, Smart Motion Sensor, Motion Sensor, Sensor
--	--