



CP Electronics MWS3A-DBB Surface Mount Back Box Installation Guide

[Home](#) » [CP electronics](#) » CP Electronics MWS3A-DBB Surface Mount Back Box Installation Guide 

Contents

- [1 CP Electronics MWS3A-DBB Surface Mount Back Box](#)
- [2 Product Information](#)
- [3 Product Usage Instructions](#)
- [4 Dimensions](#)
- [5 Installation](#)
- [6 Downloads and Videos](#)
- [7 CONTACT](#)
- [8 Documents / Resources](#)
 - [8.1 References](#)



CP Electronics MWS3A-DBB Surface Mount Back Box



Product Information

- **Product Name:** MWS3A-DBB
- **Model Number:** WD987 Issue 4
- **Installation Guide:** cpelectronics.co.uk/cp/987.
- **Languages:** English, Portuguese, Italian, Russian, Dutch
- **Warning:** This device should be installed by a qualified electrician in accordance with the latest edition of the IEE wiring regulations.

Product Usage Instructions

1. **Surface Fixing:** Use the optional surface mounting box MWS3A-DBB to surface fix the MWS3a.
2. **Ceiling Hole:** Cut a 30mm diameter hole in the ceiling for the wires and mounting holes using the provided template.
3. **Secure to Ceiling:** Secure the mounting box to the ceiling using the cut holes.
4. **Wire Connection:** Wire in plug/s according to the wiring diagram on page 2 of the MWS3a installation guide. Pass the wires through the mounting box and connect the plug/s to the detector.
5. **Spring Attachment:** Bend the springs up and insert the device. The springs will snap back to hold the device in place. Take care when bending springs to avoid injury.

Please refer to the installation guide for detailed instructions and diagrams specific to your language.

Dimensions

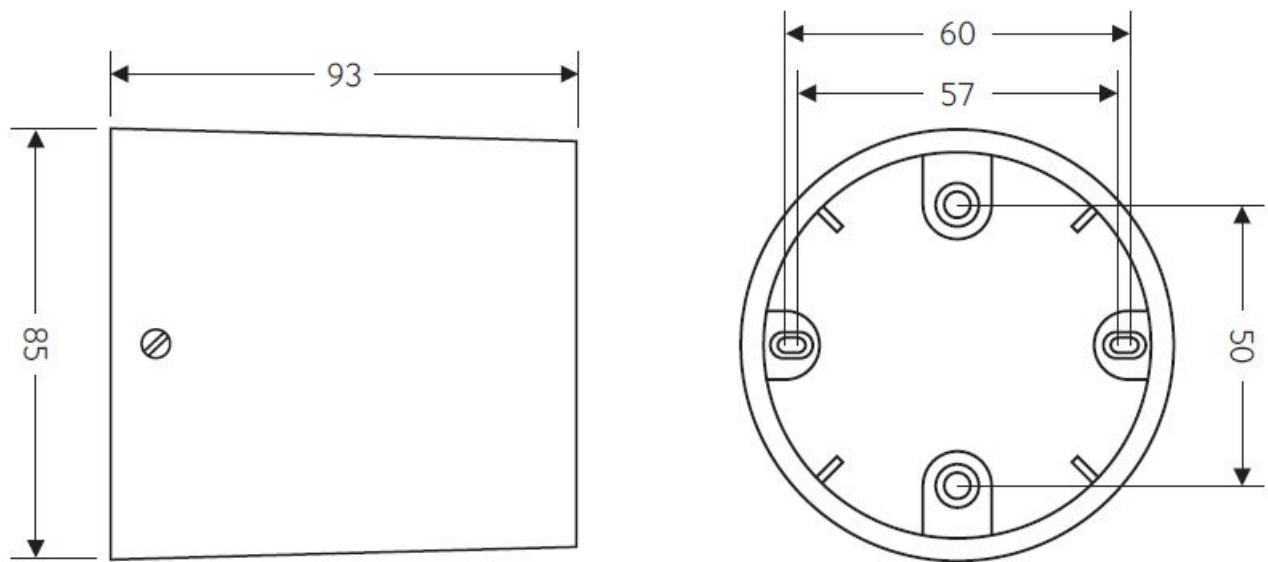

Installation

Surface fixing the MWS3a, using the optional surface mounting box MWS3A-DBB.

Create cut out

Cut a 30mm diameter hole in the ceiling for the wires, and mounting holes using the template shown.

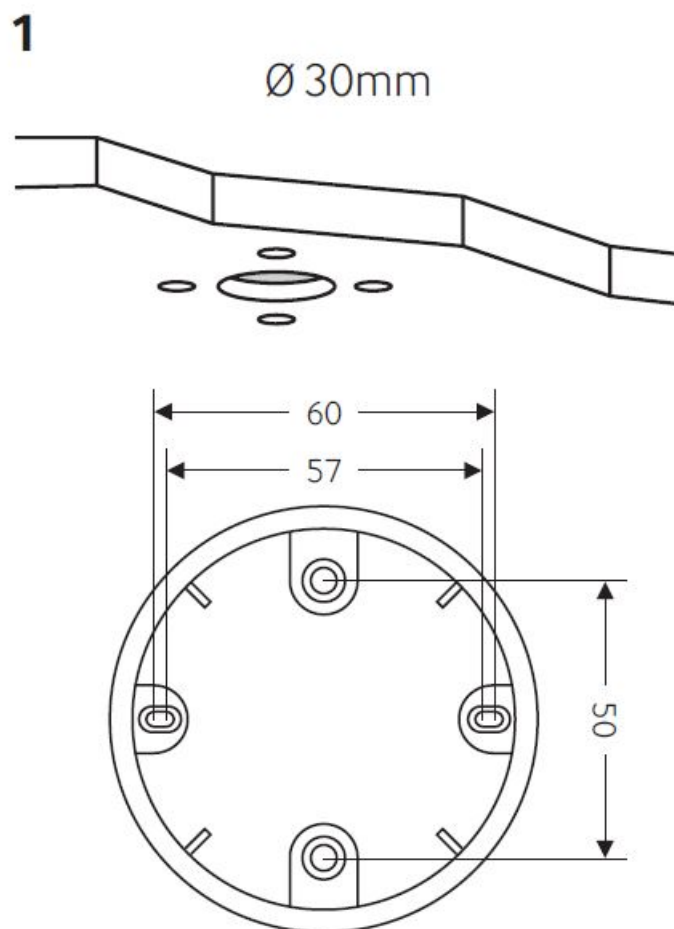

Secure to ceiling

Secure the mounting box to the ceiling using the holes cut.

2

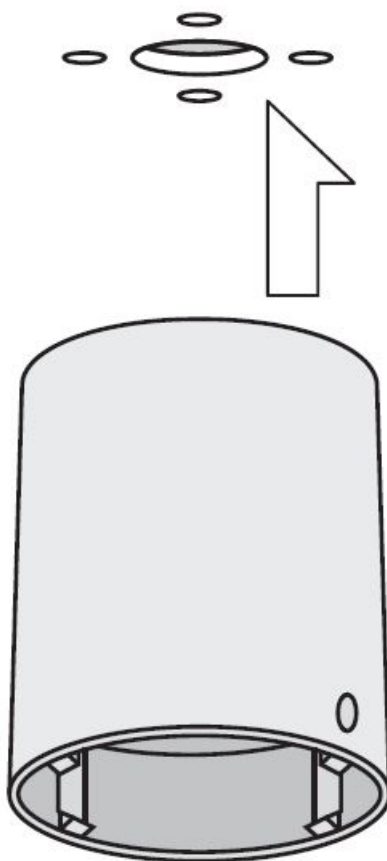

Wire in plugs & connect to detector

Wire in plug/s, using wiring diagram on page 2 of the MWS3a installation guide. Pass the wires through the mounting box and connect the plug/s to the detector.

3

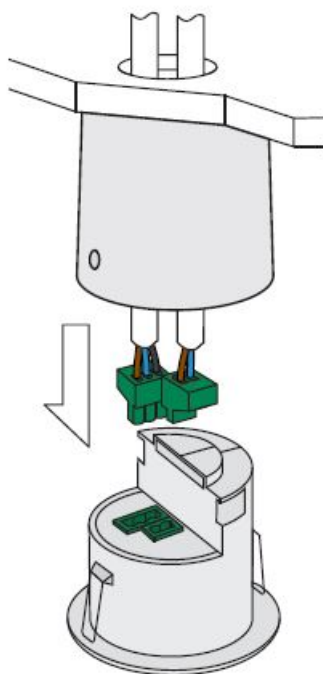

Install detector

Bend the springs up and push detector into the mounting box. When fully inserted the springs snap back to hold the device in place.

To avoid injury, take care when bending springs.

4

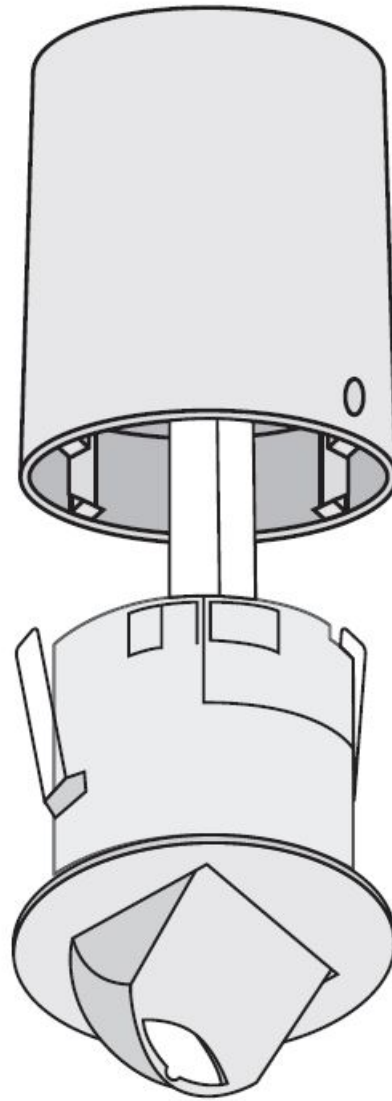

Secure detector to mounting box

Secure detector with the supplied screw into the side of the mounting box.

5

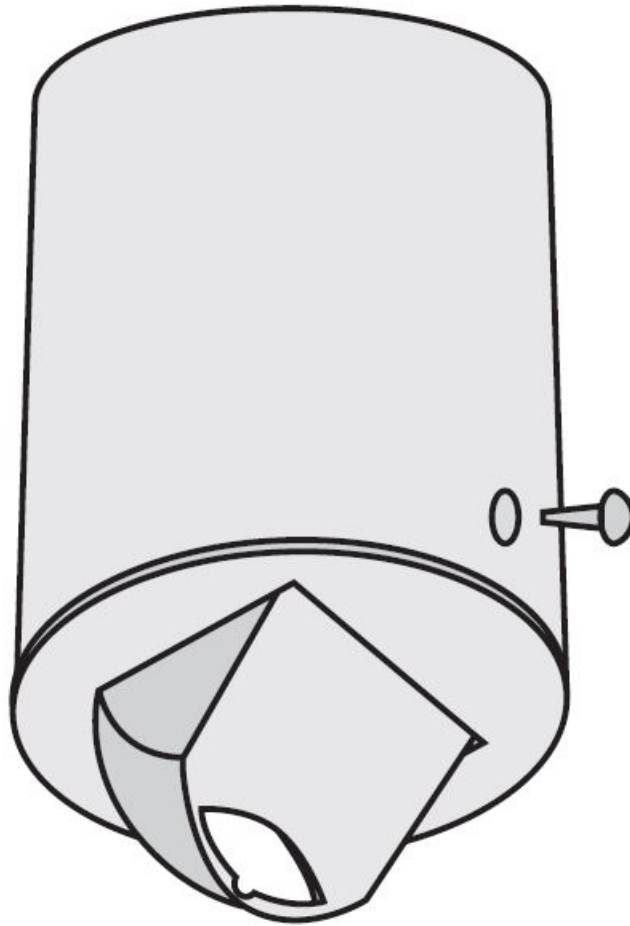

Downloads and Videos

cpelectronics.co.uk/cp/987.



CONTACT

- CP Electronics
- Brent Crescent, London NW10 7XR

- t. +44 (0)333 900 0671
- enquiry@cpelectronics.co.uk.
- www.cpelectronics.co.uk.
- connect with us:    

Due to our policy of continual product improvement CP Electronics reserves the right to alter the specification of this product without prior notice. WD987 Issue 4 Installation Guide, MWS3A-DBB Surface mount back box for MWS3A range WD987 Issue 4 Installation Guide MWS3A-DBB

Documents / Resources

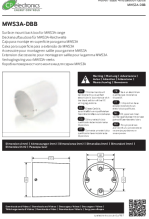
	<p>CP Electronics MWS3A-DBB Surface Mount Back Box [pdf] Installation Guide MWS3A-DBB Surface Mount Back Box, MWS3A-DBB, Surface Mount Back Box, Mount Back Box, Back Box, Box</p>
---	--

References

-  [Home | Legrand](#)
-  [CP Electronics | Brands | Legrand United Kingdom](#)