



COSMO COS-QS90 Range Hood Owner's Manual

[Home](#) » [Cosmo](#) » COSMO COS-QS90 Range Hood Owner's Manual 

COSMO COS-QS90 Range Hood Owner's Manual



Contents

- [1 COS-QS90](#)
- [2 Features](#)
- [3 SPECIFICATIONS](#)
- [4 DIMENSIONS](#)
- [5 Documents / Resources](#)
 - [5.1 References](#)
- [6 Related Posts](#)

COS-QS90

Presenting this professional style range hood, Cosmo's COS-QS90 Range Hood is powered by 500 CFM of suction, LED lights and ARC-FLOW® Stainless Steel Permanent Filters.

Features

- Designed for under cabinet mounting
- 4 fan speeds
- 500 CFM airflow capacity
- Soft touch controls with LCD display & remote control
- ARC-FLOW® permanent filters
- Front LED lights
- Noise level as low as 40 dB*
- Top vented

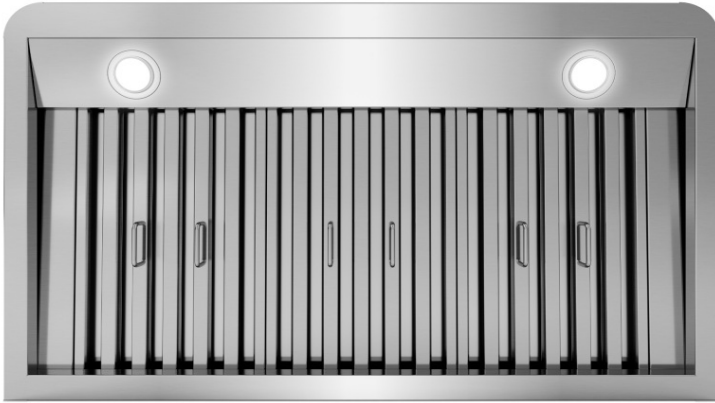

SPECIFICATIONS

- **Size:** 36 Inch
- **Mounting Type:** Under Cabinet
- **Controls:** Touch with LCD Display, Remote
- **Filters:** 3 x Stainless Steel Baffle Filters
- **Material:** 430 Grade Stainless Steel
- **Air Flow:** 500 CFM
- **Noise Level:** 40 dB*
- **Vent Style:** External
- **Lighting:** 2 x Front LED
- **Voltage:** 120V / 60Hz
- **Wattage:** 241W
- **Included Components:** Bulb(s), Damper, Exhaust Vent, Fan Hardware, Installation Kit, Power Cord

4 Fan Speeds



Soft Touch Controls



LED Lighting



DIMENSIONS

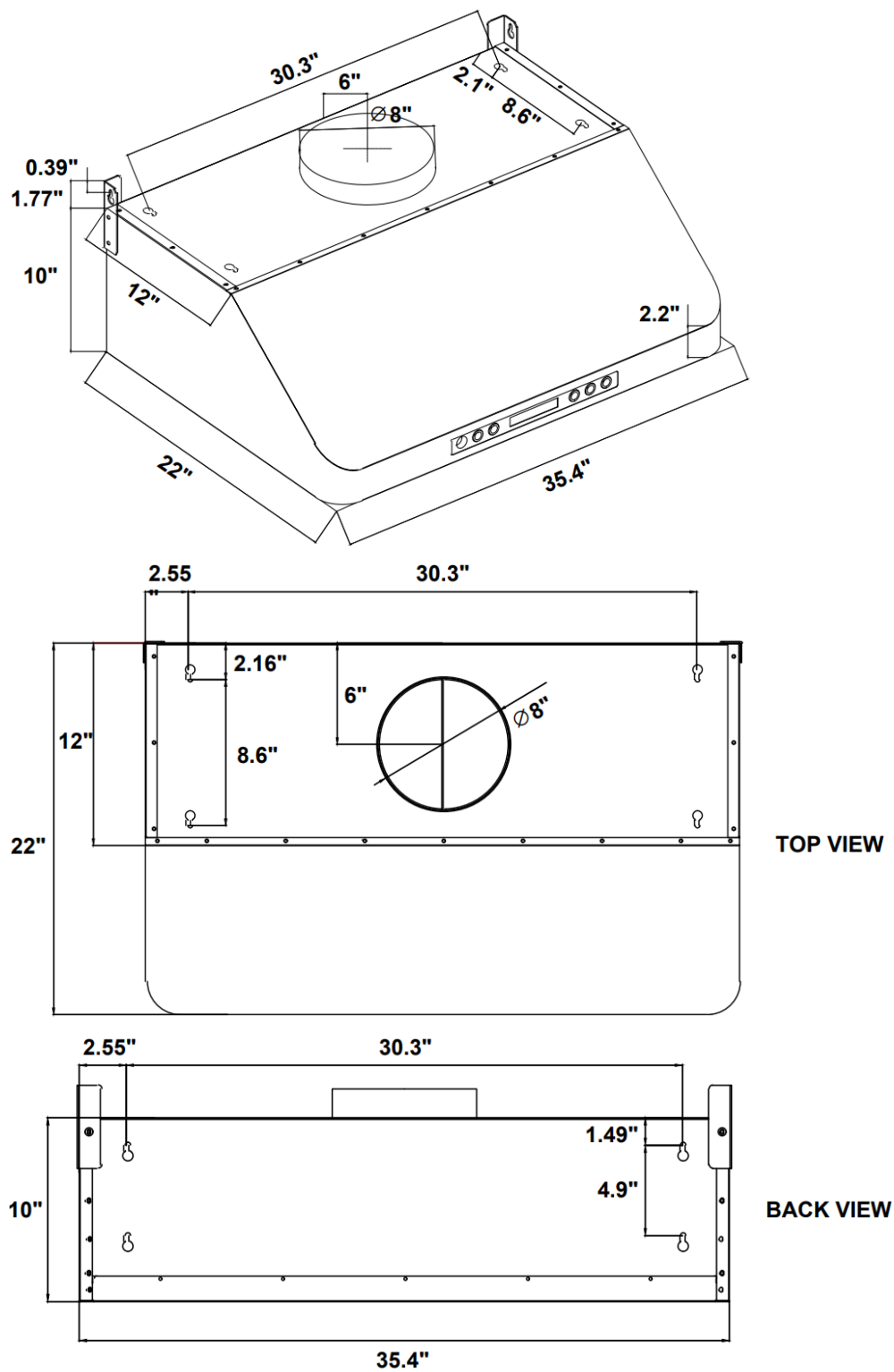

Dimensions (WxDxH): 35.4" x 22" x 10"

For more information, please visit: www.cosmoappliances.com



Documents / Resources

	<p>COSMO COS-QS90 Range Hood [pdf] Owner's Manual COS-QS90 Range Hood, COS-QS90, Range Hood, Hood</p>
---	---

References

- [User Manual](#)