



COSMO COS-QB75 Range Hood Instruction Manual

[Home](#) » [Cosmo](#) » COSMO COS-QB75 Range Hood Instruction Manual 

COSMO COS-QB75 Range Hood Instruction Manual



Contents

- [1 INSTALLATION INSTRUCTION](#)
- [2 Features](#)
- [3 Push Button Controls](#)
- [4 LED Lighting](#)
- [5 Dimension](#)
- [6 TOP VIEW](#)
- [7 BACK VIEW](#)
- [8 Documents / Resources](#)
 - [8.1 References](#)

INSTALLATION INSTRUCTION

COS-QB75

Presenting this professional style range hood, Cosmals COS-QB75 Range Hood is powered by 500 CFM of suction LED lights and ARC-FLOW Stainless Steel Permanent Filters

Features

- Designed for under cabinet mounting
- 3 fan speeds
- 500 CFM airflow capacity
- Push button controls
- ARC-FLOWB permanent filters
- Front LED lights
- Noise level as low as 40 dB
- Top vented

Size	30 Inch
Mounting Type	Under Cabinet
Controls	Push Button
Filters	3 x Stainless Steel Baffle Filters
Material	430 Grade Stainless Steel
Air Flow	500 CFM
Noise Level	40 dB*
Vent Style	External
Lighting	2 x Front LED
Voltage	120V / 60Hz
Wattage	241W
Included Components	Bulb(s), Damper, Exhaust Vent, Fan Hardware, Installation Kit, Power Cord

3 Fan Speeds



Push Button Controls



LED Lighting



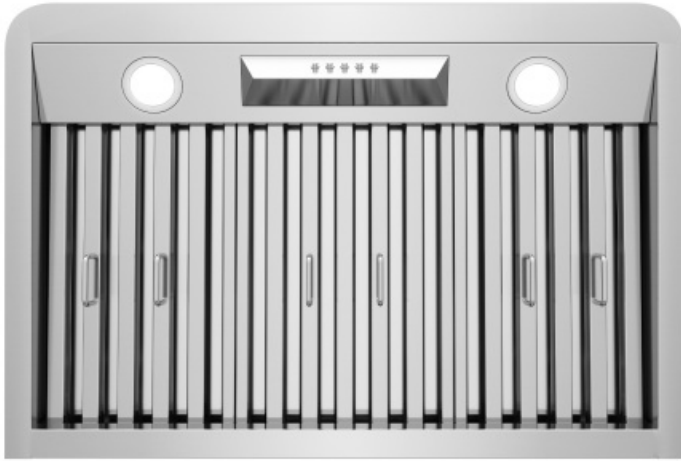

Dimension

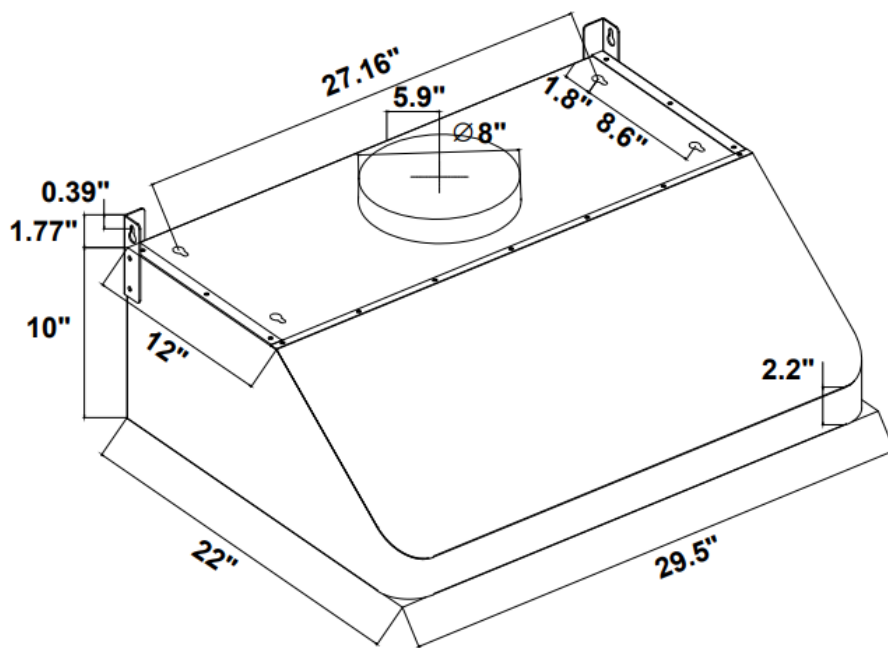

TOP VIEW

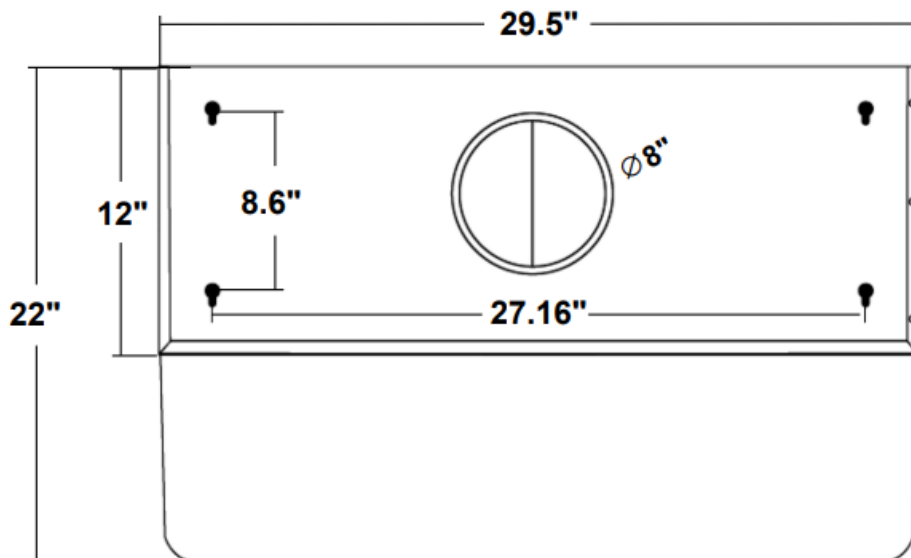

BACK VIEW

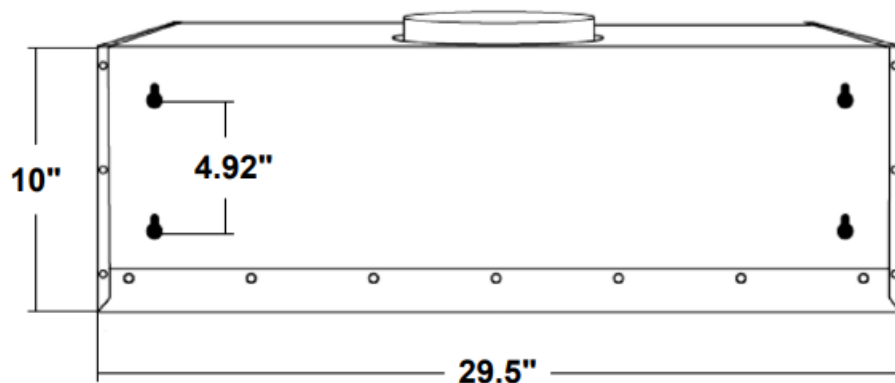

Documents / Resources



[COSMO COS-QB75 Range Hood \[pdf\] Instruction Manual](#)
COS-QB75 Range Hood, COS-QB75, Range Hood, Hood

References

- [C Cosmo Appliances | Luxury Ranges, Cooktops, Range Hoods](#)
- [User Manual](#)

[Manuals+](#), [Privacy Policy](#)

This website is an independent publication and is neither affiliated with nor endorsed by any of the trademark owners. The "Bluetooth®" word mark and logos are registered trademarks owned by Bluetooth SIG, Inc. The "Wi-Fi®" word mark and logos are registered trademarks owned by the Wi-Fi Alliance. Any use of these marks on this website does not imply any affiliation with or endorsement.