

Contents [[hide](#)]

- [1 CORSTON Unsprung Handle Installation Guide](#)
- [2 Unsprung Installation Instructions](#)
- [3 Contents](#)
- [4 Tools you'll need](#)
- [5 Documents / Resources](#)
 - [5.1 References](#)

CORSTON Unsprung Handle Installation Guide



Unsprung Installation Instructions

Contents

- Handles

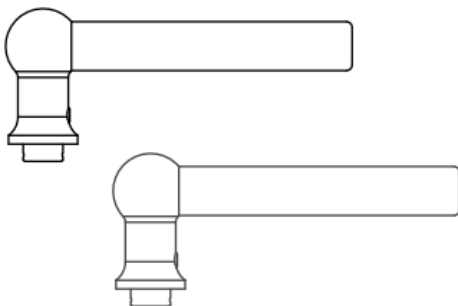

- Wood Screws

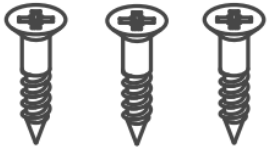
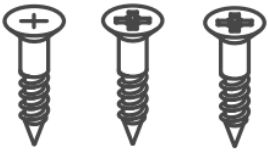

- M4 Through Bolts

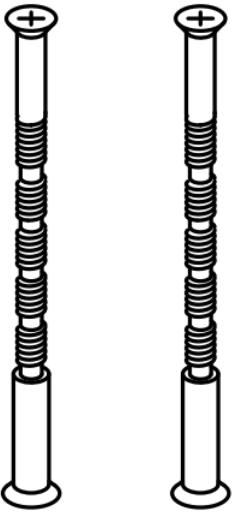

- Roses

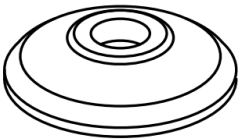
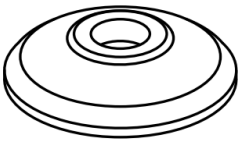

- Thread Lock



- Grub Screws

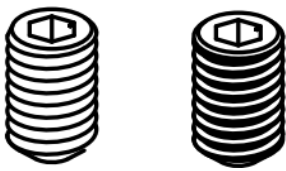

- Fixing Plates

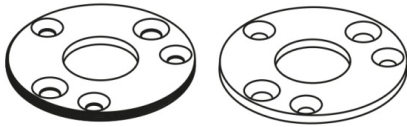

Tools you'll need

- Drill

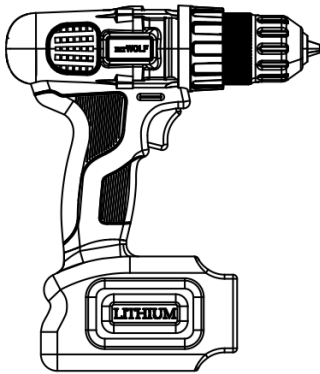

- Cross head Screw Driver

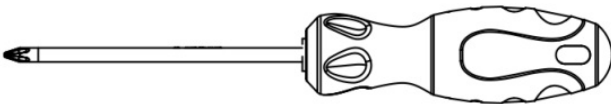

- 12mm Drill Bit



- 8mm Drill Bit



- 2mm Drill Bit



- Pliers

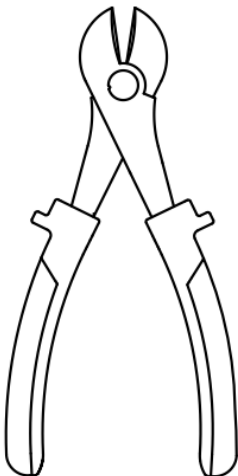

1. Mark the centre lines and hole spacings on both sides the door.

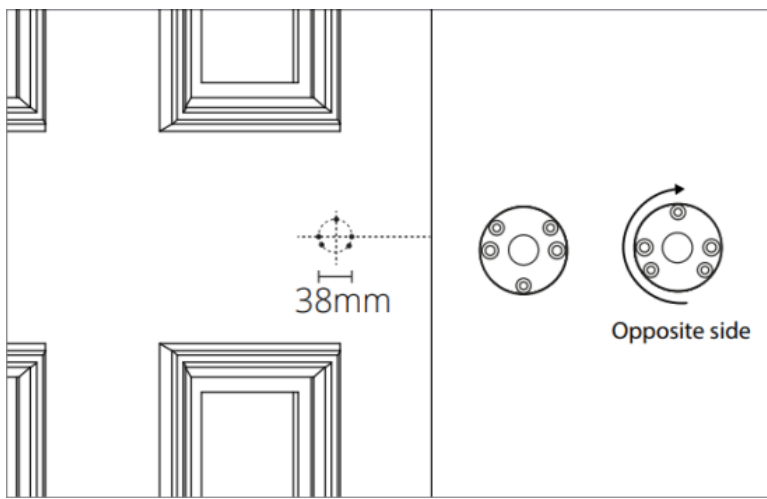

2. Drill holes through the door for the through bolts with the 8mm drill bit.

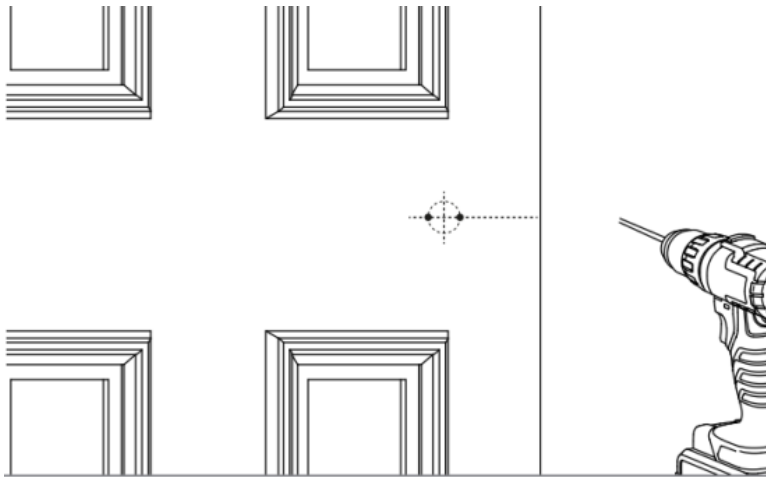

3. Drill pilot holes for the wood screws with the 2mm bit.

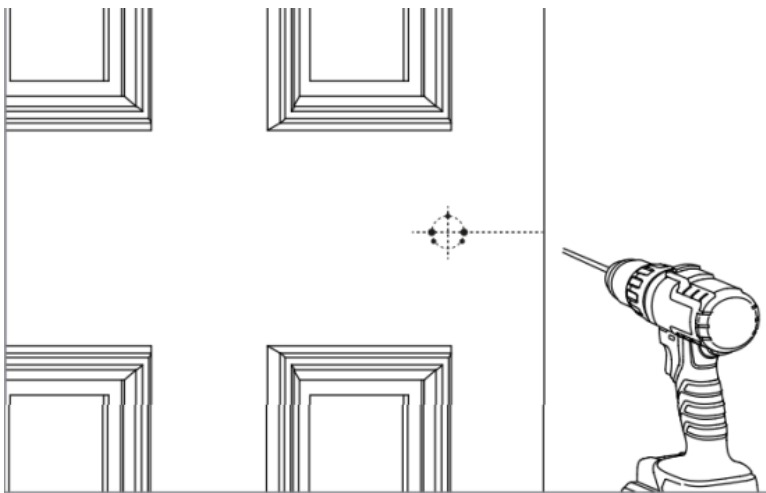

4. Using the 12mm drill bit, drill through the centre for the spindle.

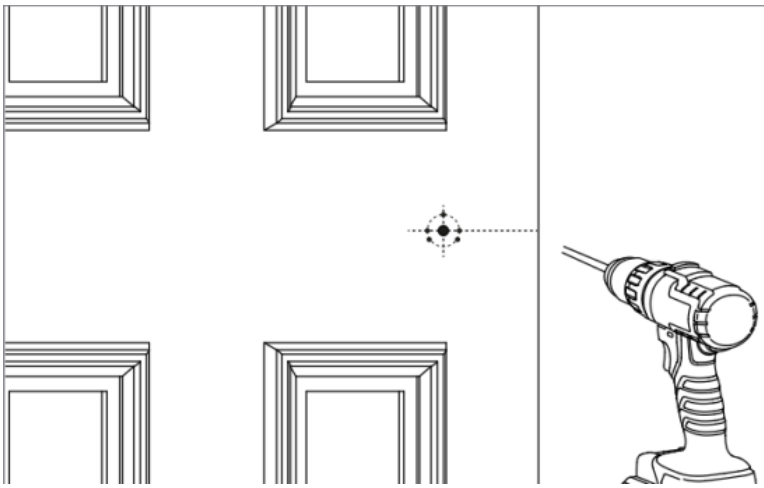

5. Clip snap off screws to size so that they are smaller than the depth of the door.

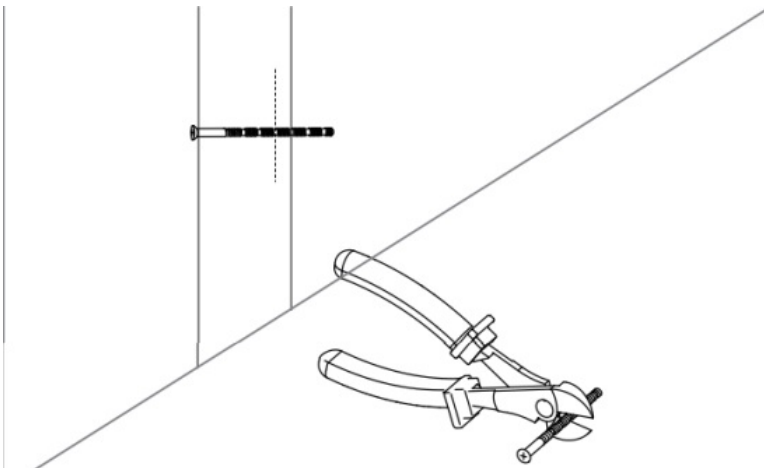

6. crew the fixed spindles to the door with the through bolts.

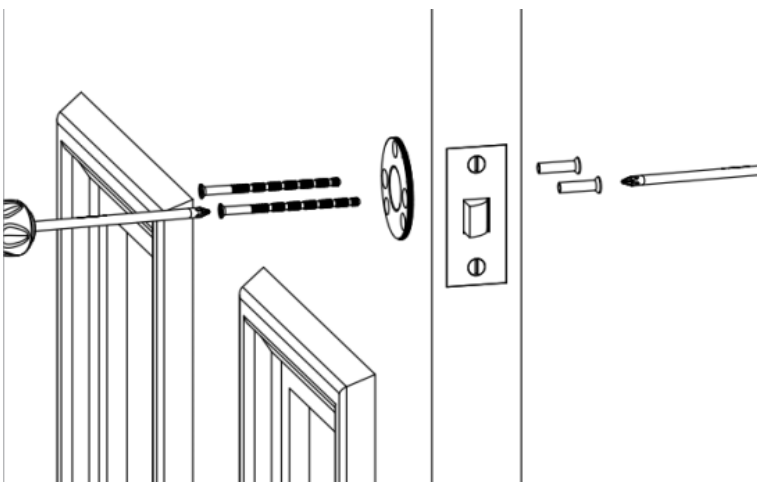

7. Drive the wood screws into the door

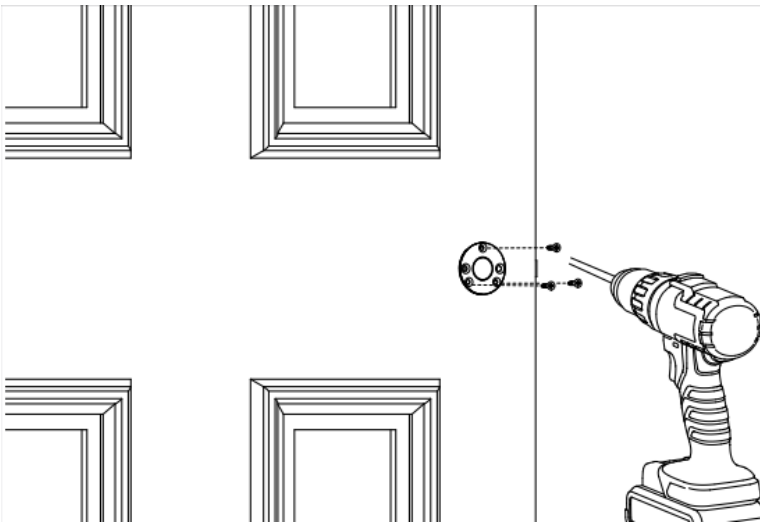

8. Check the spindle fits. The groove in the spindle needs to face away from the door

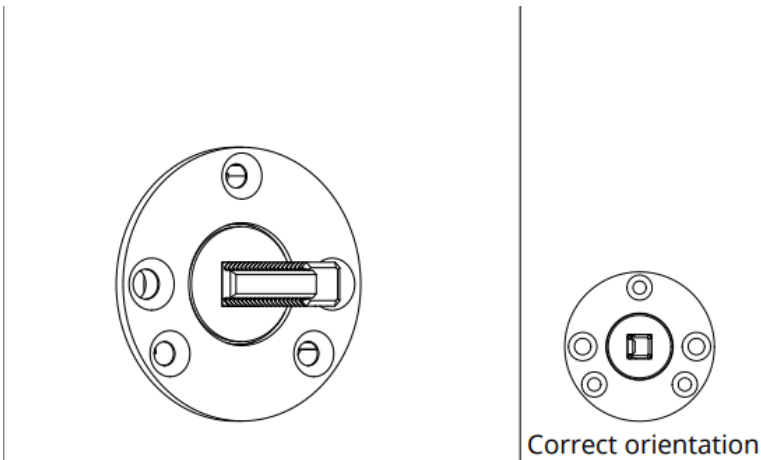

9. Screw the rose on to the fixing plate and then the handle on to the spindle

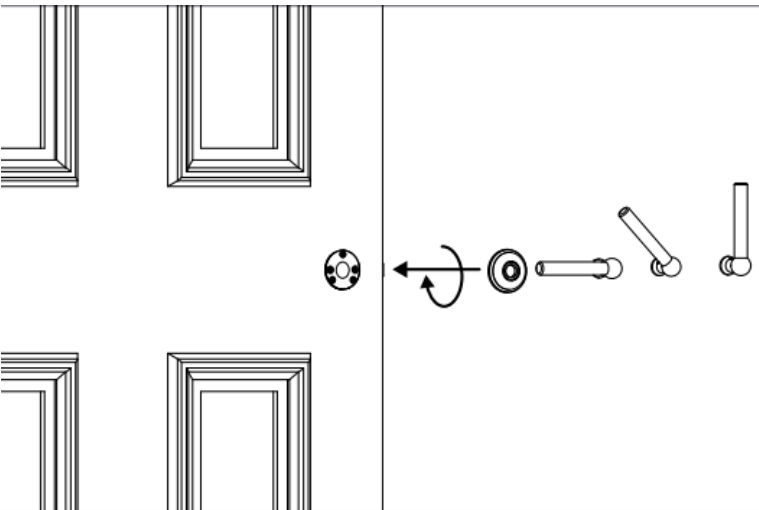

10. if after screwing the handle on there is a gap bigger than a 1mm between the handle and rose, use the washer to fill the gap.

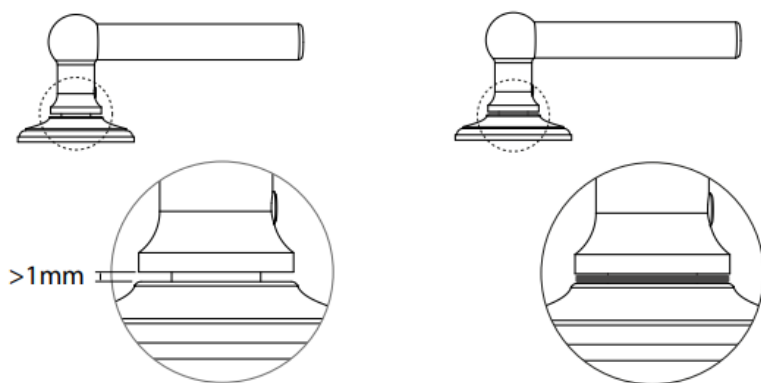

11. Screw the grubscrew in to the handle and make it it is level

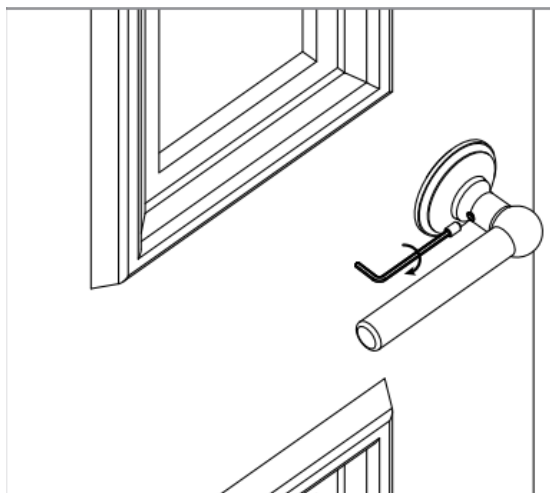

12. Check the handles turns smoothly

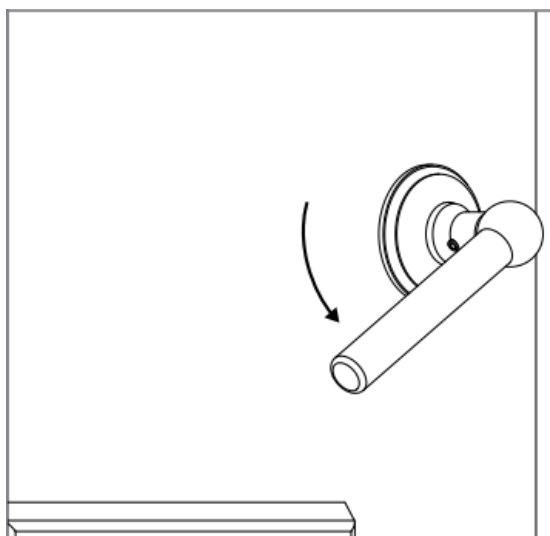

13. Uninstall the handle

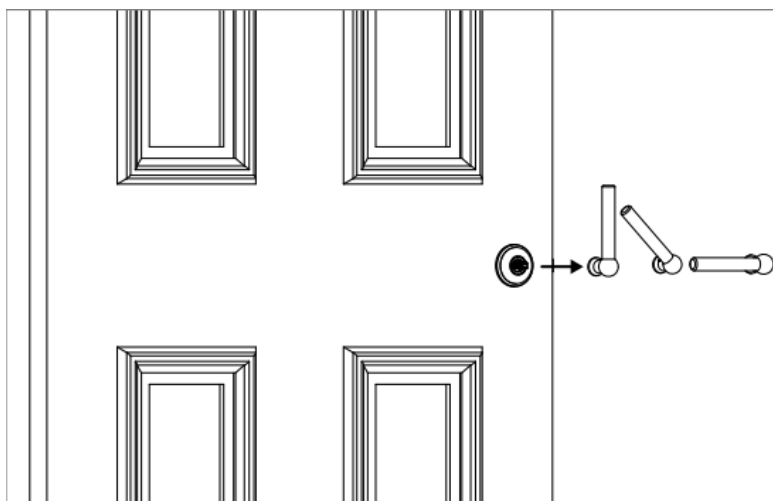

14. Apply the provided thread lock to the spindle.

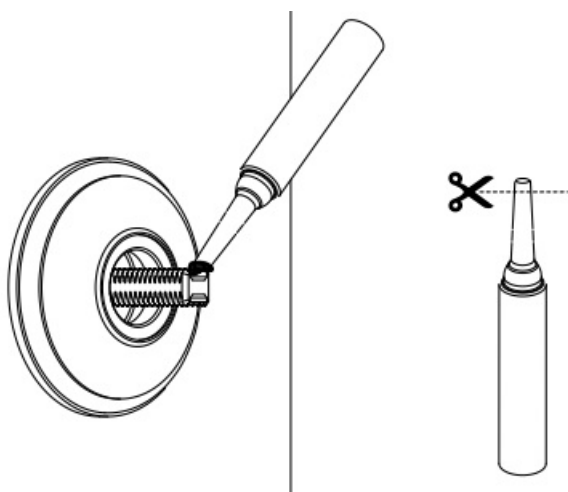

15. Replace the grub screw in the handle with the grub screws with pre-applied thread lock.

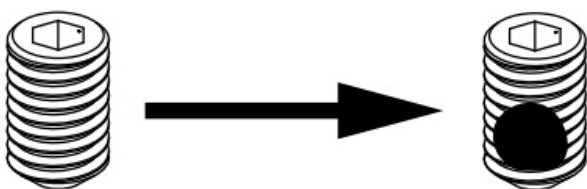

16. Tightly screw in the grub screw and wait for the thread lock to set.

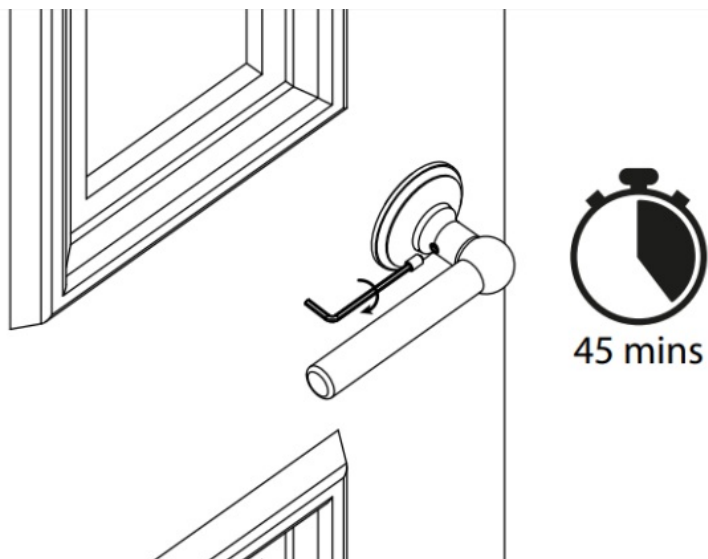

corston.com/instructions

hi@corston.com

+44 (0)1249 549332

CORSTON

ARCHITECTURAL DETAIL

Documents / Resources

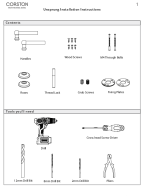
	<p>CORSTON Unsprung Handle [pdf] Installation Guide</p> <p>Unsprung Handle, Handle</p>
---	--

References

- [User Manual](#)

 CORSTON, Handle, Unsprung

 CORSTON Handle

Leave a comment

Your email address will not be published. Required fields are marked *

Comment *

Name

Email

Website

☐ Save my name, email, and website in this browser for the next time I comment.

Post Comment

Search:

e.g. whirlpool wrf535swhz

Search

[Manuals+](#) | [Upload](#) | [Deep Search](#) | [Privacy Policy](#) | [@manuals.plus](#) | [YouTube](#)

This website is an independent publication and is neither affiliated with nor endorsed by any of the trademark owners. The "Bluetooth®" word mark and logos are registered trademarks owned by Bluetooth SIG, Inc. The "Wi-Fi®" word mark and logos are registered trademarks owned by the Wi-Fi Alliance. Any use of these marks on this website does not imply any affiliation with or endorsement.