



# CORSAIR iCUE LINK RX Series PWM Fans User Guide

[Home](#) » [Corsair](#) » CORSAIR iCUE LINK RX Series PWM Fans User Guide 

## Contents

- [1 CORSAIR iCUE LINK RX Series PWM Fans](#)
- [2 Expansion Fan](#)
- [3 GETTING TO KNOW YOUR RX](#)
- [4 FAN INSTALLATION](#)
- [5 SOFTWARE SETUP](#)
- [6 CORSAIR DETACHABLE PLATES](#)
- [COMPATIBILITY](#)
- [7 WARRANTY](#)
- [8 Documents / Resources](#)
  - [8.1 References](#)
- [9 Related Posts](#)



## CORSAIR iCUE LINK RX Series PWM Fans



## Expansion Fan



- One (1) fan
- Two (2) connectors
- Four (4) QuikTurn mounting screws
- 120mm Starter Kit
- 140mm Starter Kit

## GETTING TO KNOW YOUR RX

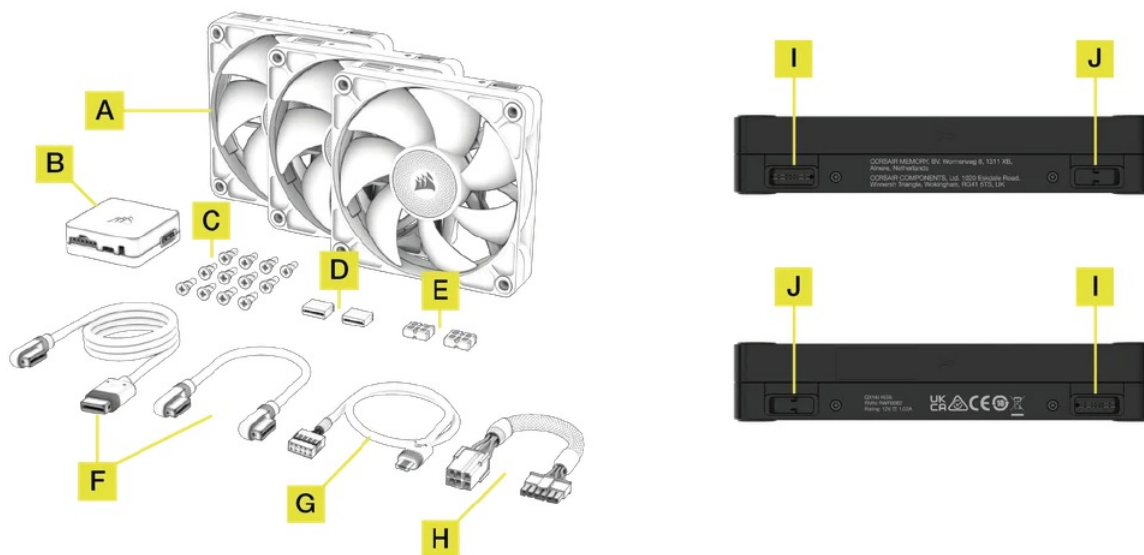

- A. iCUE LINK RX fan
- B. iCUE LINK System Hub
- C. QuikTurn mounting screws
- D. Active bridge connector
- E. Passive connector
- F. iCUE LINK cable
- G. Micro-USB cable

- **H.** Power cable
- **I.** Active port
- **J.** Passive port

## GETTING TO KNOW YOUR SYSTEM HUB

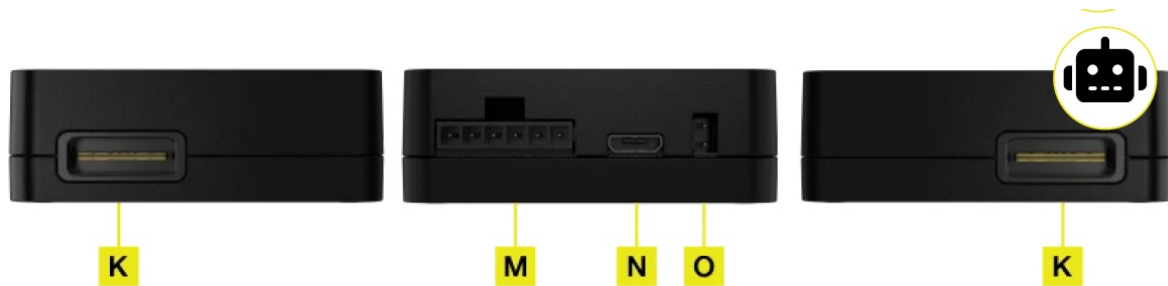

- **I.** Active port
- **K.** Power input
- **L.** USB input
- **M.** Tach output

## FAN INSTALLATION

### BEFORE YOU START

- To ensure proper operation, keep the active ports free of any foreign objects/materials. Please use the RX and accessories as defined in this document.
- Turn the computer off prior to the installation of the RX and accessories.

### STARTER KIT

This section will provide a brief guide on how to install your RX Starter Kit.

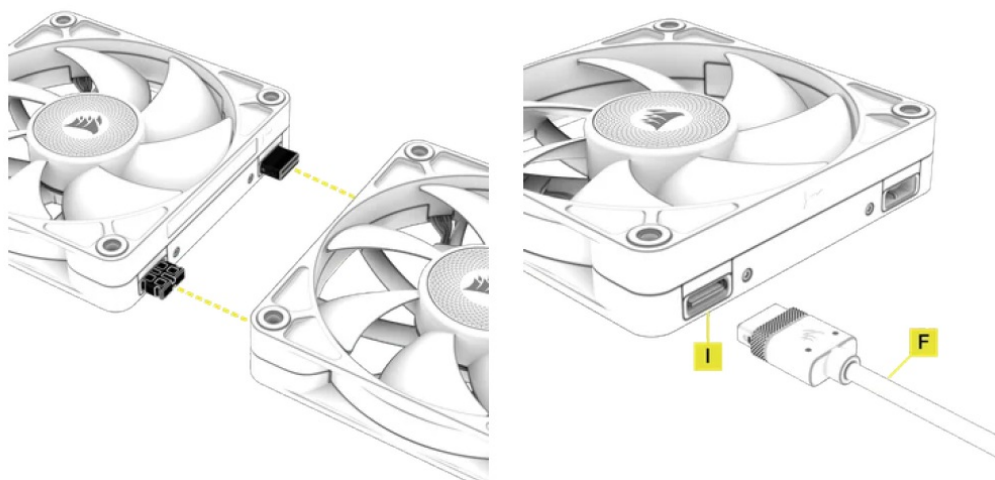

### Create or add into a fan group

Connect the RX fan into an existing fan group by aligning and inserting the connectors into the open active (I) and passive ports (J).

### Set up the RX fan group

After connecting your RX fans together, insert the iCUE LINK cable (F) into an open active port (I) on your RX fan.

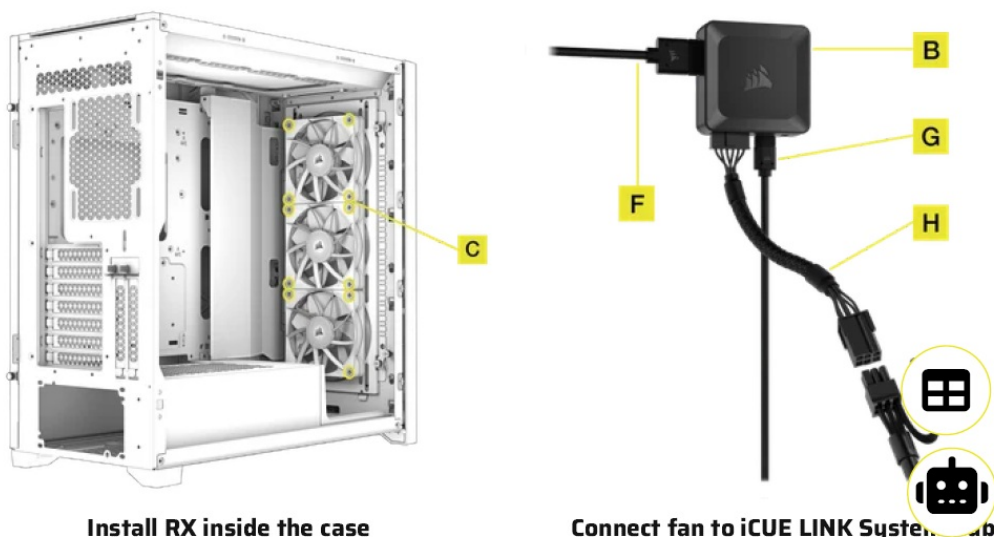

### Install RX inside the case

Mount the RX fans onto your case with the supplied QuikTurn mounting screws (C). Please note that QuikTurn screws thread much faster than traditional self-tapping screws; we advise only hand-tightening QuikTurn screws with a screwdriver to avoid over-threading your RX fans.

### Connect fan to iCUE LINK System Hub

Connect the power cable (H), Micro-USB cable (G), and iCUE LINK cable (F) into the System Hub (B), then connect the power cable (H) and Micro-USB cable (G) into your power supply and motherboard, respectively.

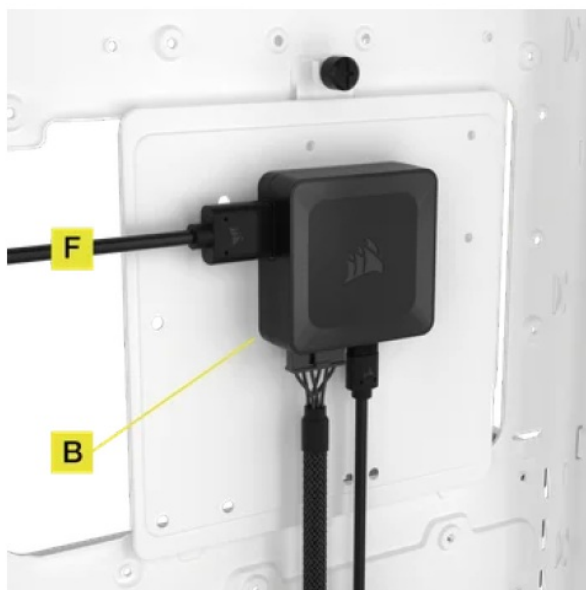

Mount iCUE LINK System Hub to your case. The iCUE LINK System Hub (B) can be magnetically mounted on a steel chassis or adhered to a surface with the supplied mounting tape.

### EXPANSION FAN

This section will provide a brief guide on how to install your RX Expansion fan.

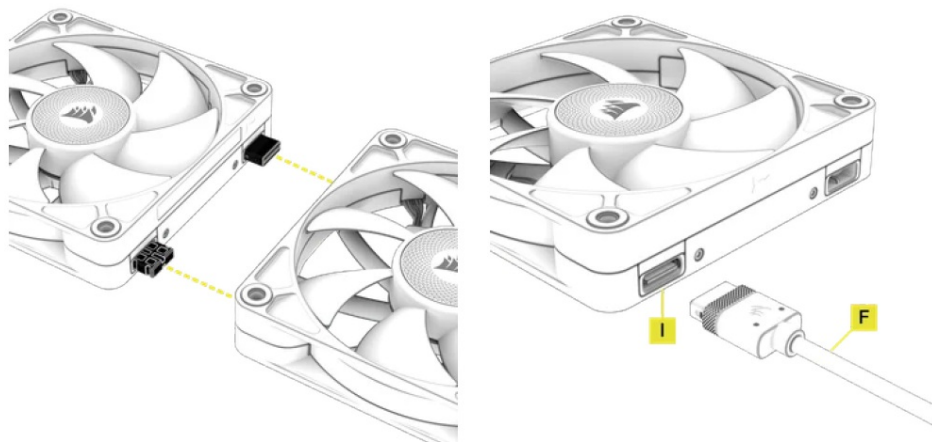

### Create or add into an existing fan group

Connect the RX Expansion fan into an existing fan group by aligning and inserting the connectors into the open active (I) and passive ports (J).

### Connect RX to an iCUE LINK System Hub

Insert the iCUE LINK cable (F) into an openactive port (I) on your RX fan. Connect fan to iCUE LINK System Hub.

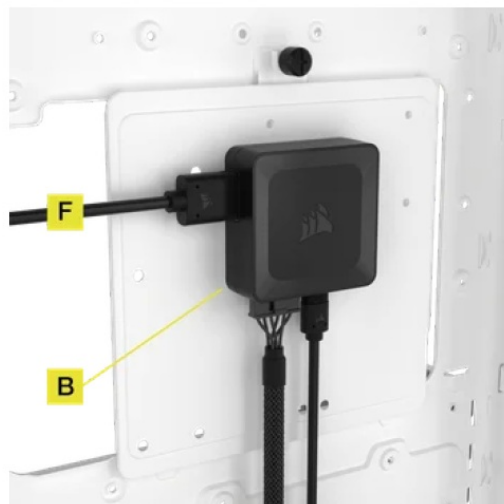

### Connect fan to iCUE LINK System Hub

Connect the iCUE LINK Cable (F) into an available active port (I) on the iCUE LINKSystem Hub (B- sold separately).

## SOFTWARE SETUP

### 1. Install iCUE

Learn more and download the latest CORSAIR iCUE software



### 2. Update iCUE

Once iCUE is installed, run the software. If a newer iCUE version is available or if any of the connected devices need a firmware update, you will be prompted to perform an update via a notification in the top right corner. You can also click the settings (cogwheel icon in the top right corner) and check for the software and firmware updates manually.

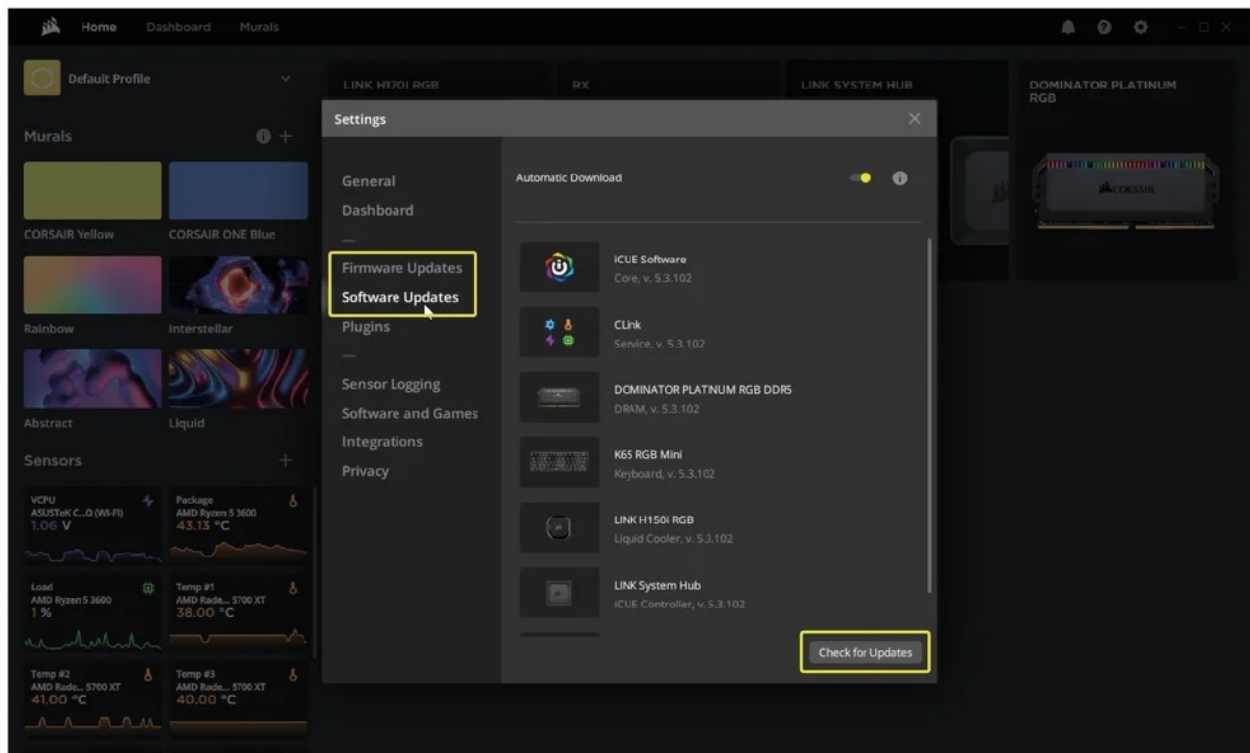

### 3. Configure iCUE – Fan Setup

The Setup page will display all RX fans connected to the System Hub and allow you to re-order them to better match the physical placement inside your system.

Mouse over the LINK System Hub tile and select Lighting Setup.

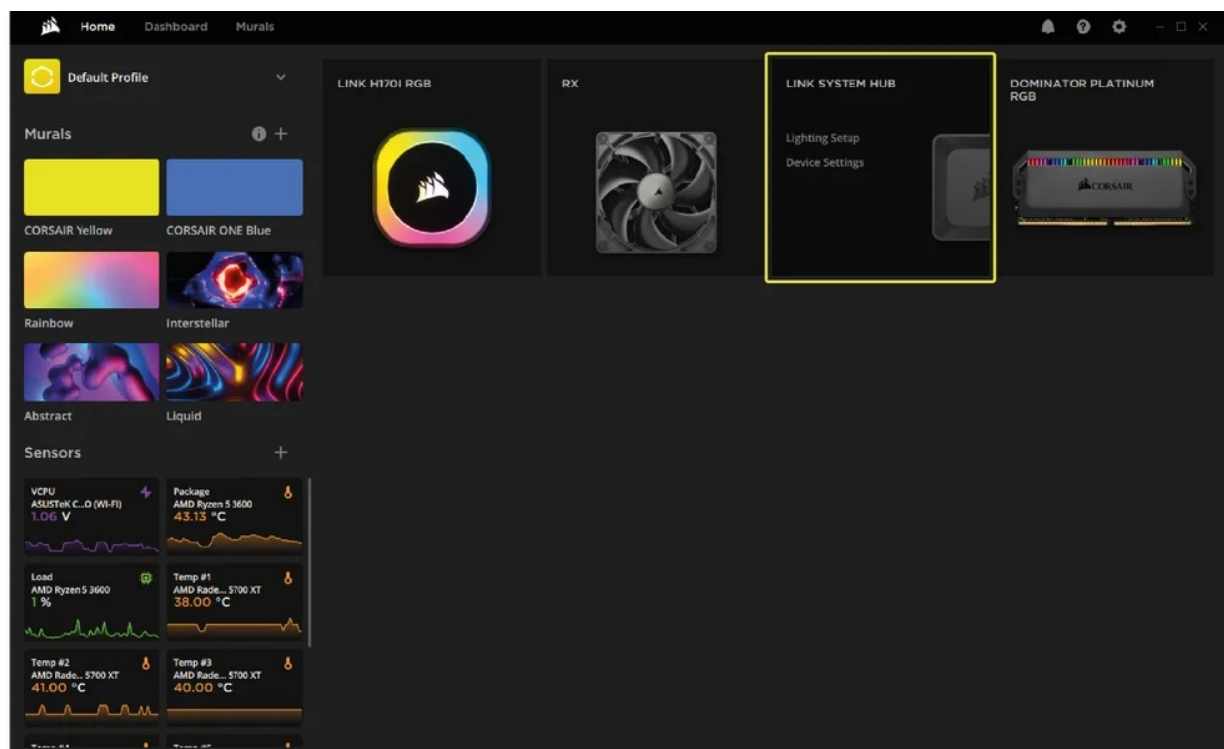

- Select the RX under Lighting Setup to re-arrange your fans.



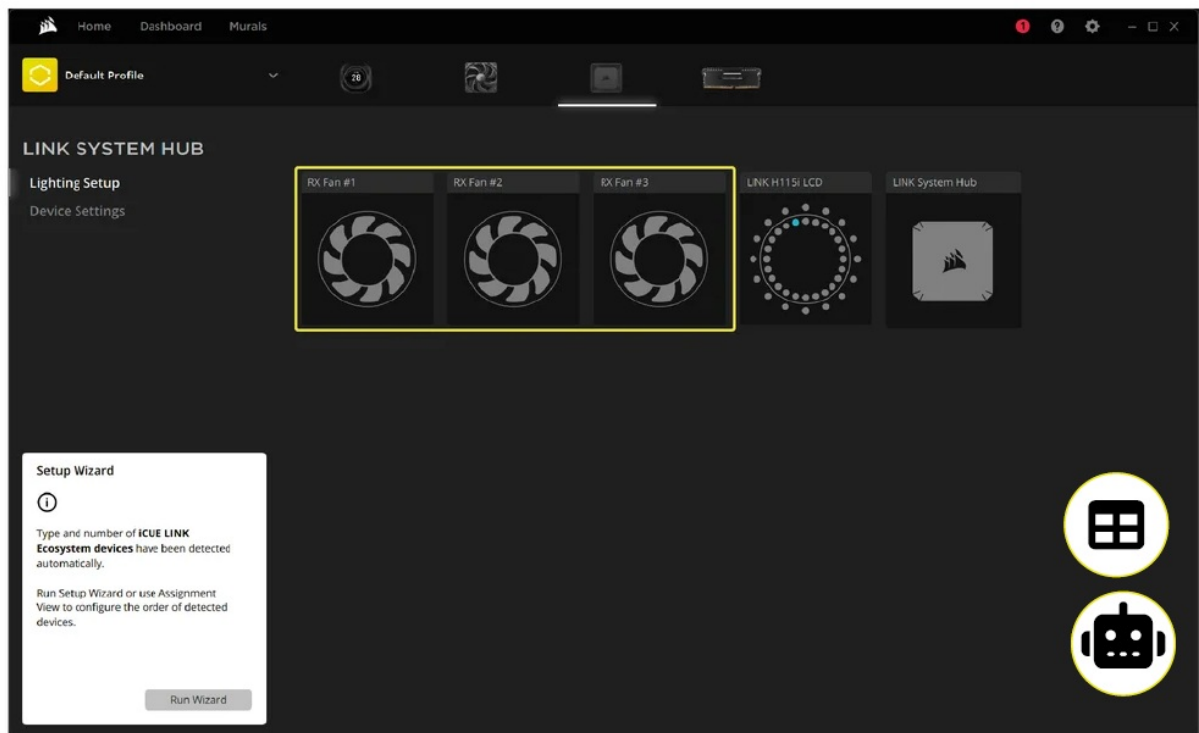

#### 4. Configure iCUE – Fan Performance

- Select your desired fan curve presets between Quiet, Balanced, Extreme, or create your own curve.
- Select the RX from the navigation bar.
- Click “Cooling” to access the fan performance page.
- Select the desired fan curve preset for each fan.
- ... or click the “+” icon under “Cooling Presets” to create a custom fan curve.

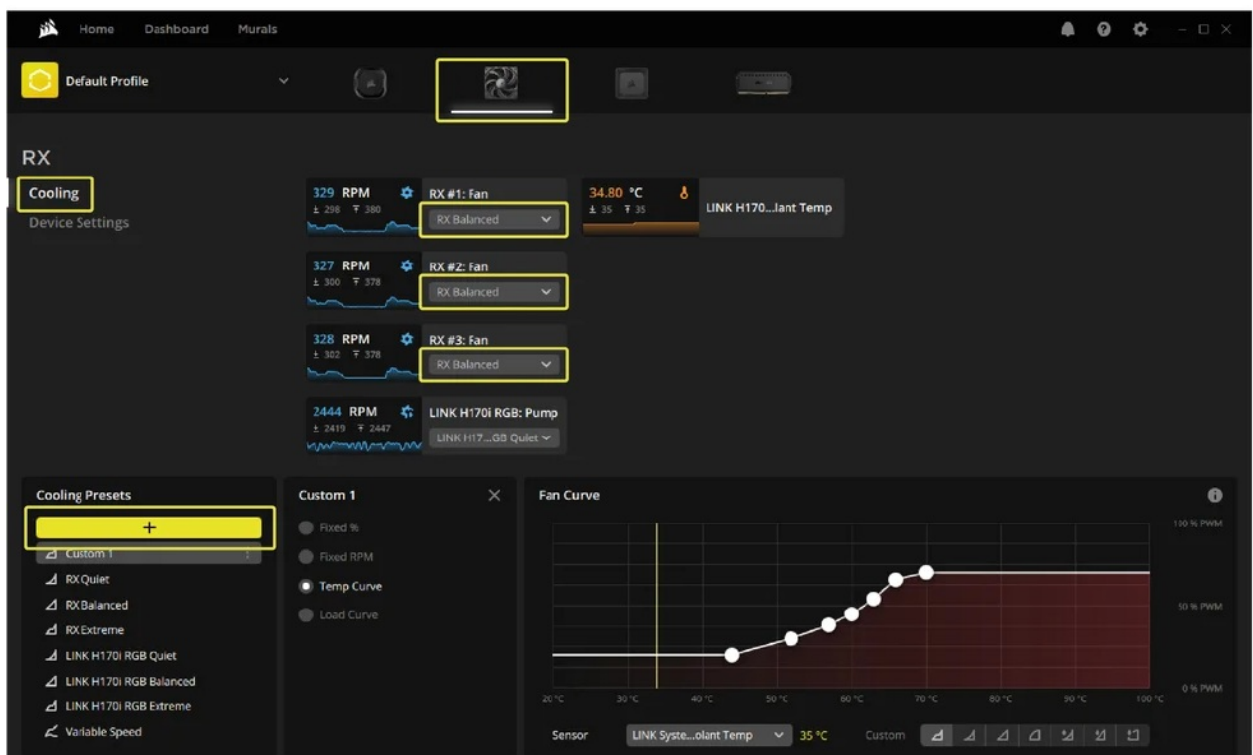

#### 5. Additional Setup

Visit our [CORSAIR LAB](#) for additional iCUE setup, configuration and tips.

### CORSAIR DETACHABLE PLATES COMPATIBILITY

RX fans are compatible with CORSAIR detachable decorative plates (sold separately).



## POWER RATING

- System Hub Output rating: 12Vdc 7A (per port)
- RX120 Input rating: 12Vdc 0.58A
- RX140 Input rating: 12Vdc 0.62A

## WARRANTY



iCUE LINK RX Series fans have a 5-year warranty.

## LEGAL

© 2024 CORSAIR MEMORY, Inc. All rights reserved. CORSAIR and the sails logo are registered trademarks of CORSAIR in the United States and/or other countries. All other trademarks are the property of their respective owners. Product may vary slightly from those pictured.

## SHOP

- New Products
- Special Offers
- [Corsair.com](https://corsair.com) Exclusives
- Where to buy
- Certified Refurbished
- Business Solutions



## EXPLORE

- PC Builder
- CORSAIR Innovation
- Design Your Loop
- Best Gaming Accessories
- Intel 14th Generation Upgrades
- AMD AM5 Upgrades
- DDR5 Memory
- Ambassadors

## CORSAIR

- About
- Investor Relations
- Supply Chain Disclosure
- Careers
- Social Impact
- Press Room
- Contact Us
- Explorer

## SUPPORT

- Downloads
- Customer Support
- Warranty
- Shipping/RMA/Returns
- Terms of Sale































Copyright © 1996 – 2024 CORSAIR. All rights reserved. <https://www.corsair.com/ww/en/explorer/diy-builder/fans/rx-fan/>

## Documents / Resources

	<p><a href="#">CORSAIR iCUE LINK RX Series PWM Fans</a> [pdf] User Guide 120mm Starter Kit, 140mm Starter Kit, iCUE LINK RX Series PWM Fans, iCUE LINK RX Series, PWM Fans, Fans</p>
---	--

## References

- 🏠 [PC Components](#) | [Gaming Gear](#) | [CORSAIR](#)

-  [TikTok - Make Your Day](#)
-  [CORSAIR Newsroom](#)
-  [Corsair](#)
-  [Investor Relations | Corsair Gaming, Inc.](#)
-  [Certified Refurbished PC Components & Gaming Gear | CORSAIR](#)
-  [Custom Cooling Configurator | CORSAIR](#)
-  [CORSAIR:EXPLORER | Articles, Guides & Product Documentation](#)
-  [iCUE Software | Drivers | Software | CORSAIR](#)
-  [Custom PC Builder | PC Build Configurator | CORSAIR](#)
-  [14th Gen Intel® Core™ Processors with CORSAIR](#)
-  [ABOUT CORSAIR](#)
-  [Next Gen Processors | AMD | CORSAIR](#)
-  [CORSAIR Ambassador Program | Creator Partnership](#)
-  [Top Game-Winning Gear - CORSAIR's Best PC Gaming Accessories](#)
-  [Corsair for Business | CORSAIR](#)
-  [CORSAIR CAREERS](#)
-  [CONTACT CORSAIR](#)
-  [DDR5 Computer Memory | CORSAIR](#)
-  [CORSAIR Downloads | CORSAIR iCUE Software](#)
-  [CORSAIR Exclusive Products](#)
-  [Hot New Products](#)
-  [Return Refund Policy](#)
-  [CORSAIR Special Offers](#)
-  [Supply Chain Disclosure](#)
-  [Technology Innovation | CORSAIR](#)
-  [Terms of Sale](#)
-  [Where to buy](#)
-  [iCUE LINK RX Series Fans Quick Start Guide | CORSAIR](#)
-  [Login • Instagram](#)
-  [Twitch](#)
- [User Manual](#)

[Manuals+](#), [Privacy Policy](#)

This website is an independent publication and is neither affiliated with nor endorsed by any of the trademark owners. The "Bluetooth®" word mark and logos are registered trademarks owned by Bluetooth SIG, Inc. The "Wi-Fi®" word mark and logos are registered trademarks owned by the Wi-Fi Alliance. Any use of these marks on this website does not imply any affiliation with or endorsement.