



## CORSAIR AF120 RGB Slim PWM Case Fan User Manual

[Home](#) » [Corsair](#) » CORSAIR AF120 RGB Slim PWM Case Fan User Manual 



# CORSAIR

AF120 RGB SLIM

THIN 15mm PROFILE

HIGH-AIRFLOW PERFORMANCE

BRILLIANT RGB LED LIGHTING

User Manual



## Contents

- 1 AF120 RGB Slim PWM Case Fan
- 2 REQUIRED HARDWARE
- 3 FAN INSTALLATION
- 4 iCUE SETUP
- 5 Documents / Resources
  - 5.1 References

## AF120 RGB Slim PWM Case Fan



## REQUIRED HARDWARE

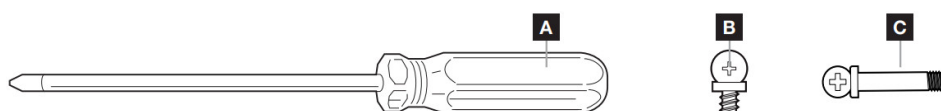

- A** PHILLIPS-HEAD SCREWDRIVER (not included)
- B** SHORT FAN MOUNTING SCREWS
- C** LONG FAN MOUNTING SCREWS (used when installing fans on a radiator)

## FAN INSTALLATION

1. TURN OFF COMPUTER

Turn your system off prior to installing your AF120 RGB SLIM fan.

## 2. MOUNT LIGHTING NODE CORE

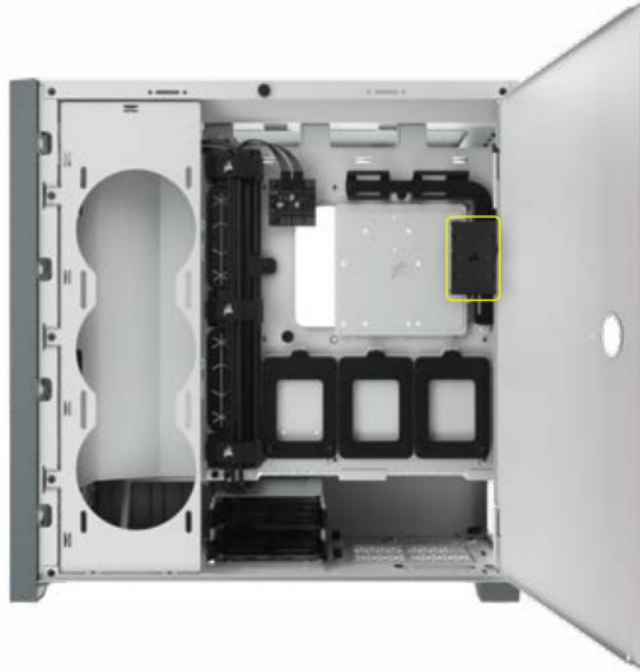

Find a location for the Lighting Node CORE that allows the fan RGB LED cables to reach the Lighting Node CORE, then mount it with the provided mounting strips.

## 3. MOUNT AF120 RGB SLIM

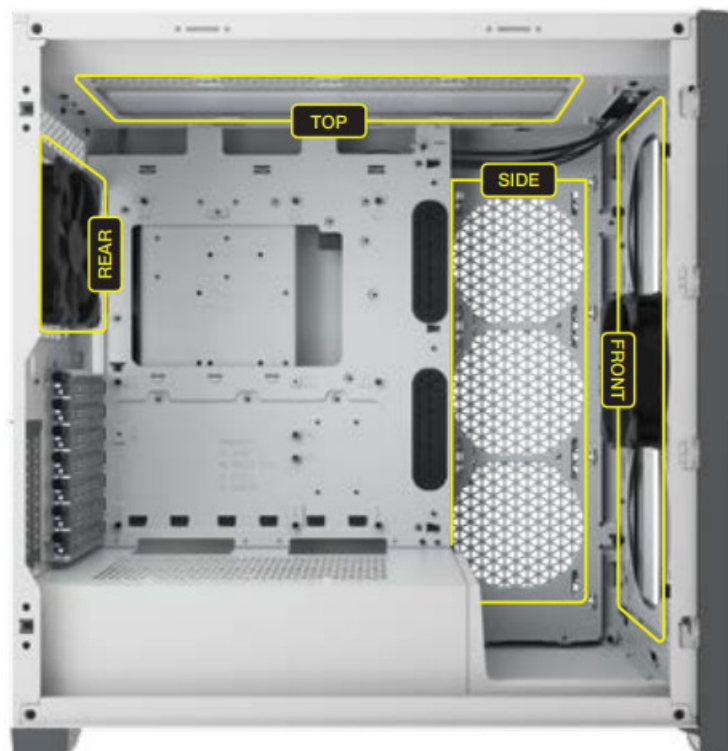

Mount the AF120 RGB SLIM inside your case with the provided short mounting screws [B].

Fan mount locations will vary depending on the case manufacturer.

Please use the long screws [C] if you're mounting the AF120 RGB SLIM on an water cooling radiator.

## 4. CONNECT FAN TO RGB CONTROLLER



Connect the 4-pin RGB connectors from your AF120 RGB SLIM fans into the Lighting Node CORE controller in sequential order from port #1 to #6.

#### 5. **CONNECT LIGHTING NODE CORE TO PC**

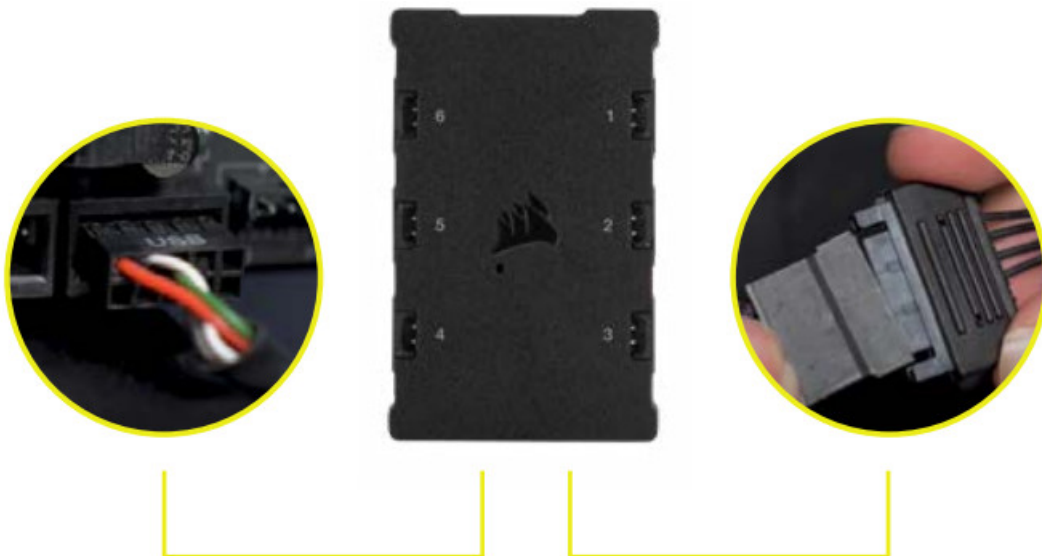

Plug the 9-pin USB cable from the Lighting Node CORE into an available internal USB 2.0 header on your motherboard or USB hub.

Connect the SATA power connector to an available SATA connector from your power supply.

#### 6. **CONNECT TO POWER**



Connect the 4-pin PWM connector into an available 3-pin\* or 4-pin (recommended, if available) fan header on

your motherboard or fan controller.

You can use fan splitter cables (sold separately) if your motherboard or fan controller does not have enough fan headers.

\*Connecting the 4-pin PWM connector into a 3-pin fan header will cause your AF120 RGB SLIM to spin at full speed.

## iCUE SETUP

### 7. INSTALL iCUE

Click the image to download CORSAIR's latest iCUE software.



### 8. CONFIGURE iCUE

Once iCUE is installed, select the “8-LED fan Series” in the Lighting Setup page under Lighting Node CORE.

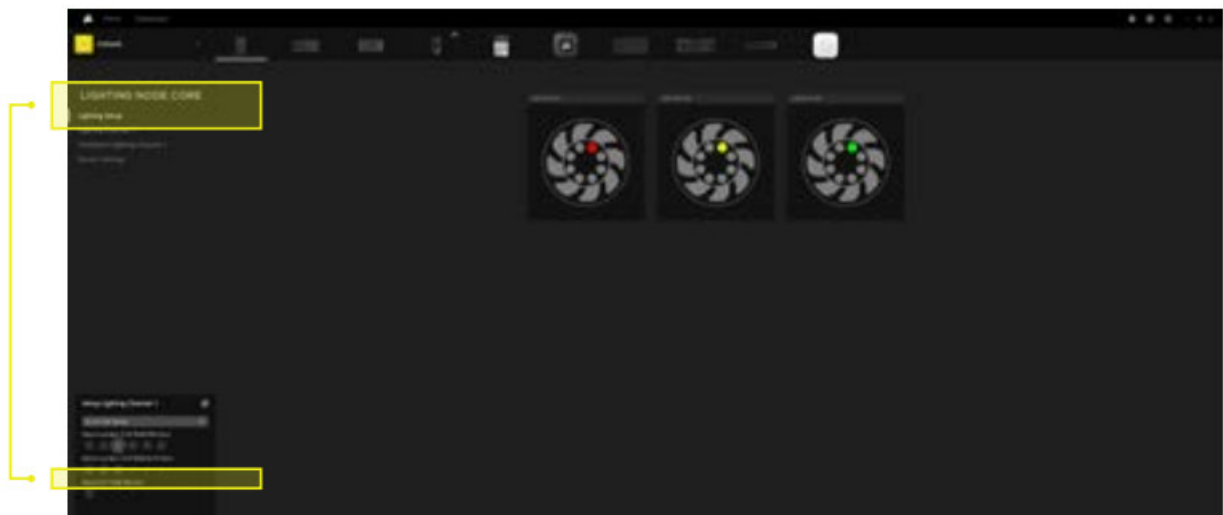

### 9. ADDITIONAL RESOURCES

Please visit our [CORSAIR LAB](#) YouTube channel for more tips and instructions on how to get the most out of your new CORSAIR fans.



Web:	<a href="https://corsair.com">corsair.com</a>
Phone:	(888) 222-4346
Warranty:	<a href="https://corsair.com/support/warranty">corsair.com/support/warranty</a>
Support:	<a href="https://support.corsair.com">support.corsair.com</a>
Blog:	<a href="https://corsair.com/blog">corsair.com/blog</a>
Forum:	<a href="https://forum.corsair.com">forum.corsair.com</a>
YouTube:	<a href="https://youtube.com/corsairhowto">youtube.com/corsairhowto</a>

© 2023 CORSAIR MEMORY, Inc. All rights reserved. CORSAIR and the sails logo are registered trademarks of CORSAIR in the United States and/or other countries. All other trademarks are the property of their respective owners. Product may vary slightly from those pictured.

49-002679 AA



## Documents / Resources

 <p><b>AF120 RGB SLIM</b></p> <p>120mm x 120mm x 25mm</p> <p>• 12V • 0.15A • 18W • 1200 RPM • 1.5mm static pressure</p>	<p><a href="#">CORSAIR AF120 RGB Slim PWM Case Fan</a> [pdf] User Manual</p> <p>AF120 RGB Slim PWM Case Fan, AF120, RGB Slim PWM Case Fan, Case Fan, Fan</p>
--	--

## References

- [PC Components | Gaming Gear | CORSAIR](#)
- [Corsair Blog - Corsair Community](#)
- [Home - Corsair Community](#)