

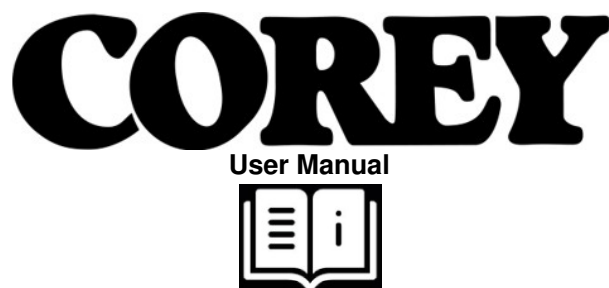

Corey CORGW450X320 Rectangle Gloss White Countertop Basin User Manual

[Home](#) » [Corey](#) » Corey CORGW450X320 Rectangle Gloss White Countertop Basin User Manual 



Thank you for choosing Better Bathrooms.
Please read this manual before installing your product and keep for future reference.

Contents

- [1 Basin Countertop](#)
- [2 Important information](#)
- [3 Installation](#)
- [4 Cleaning](#)
- [5 Documents / Resources](#)
 - [5.1 References](#)

Basin Countertop

- Waste, trap and tap sold separately

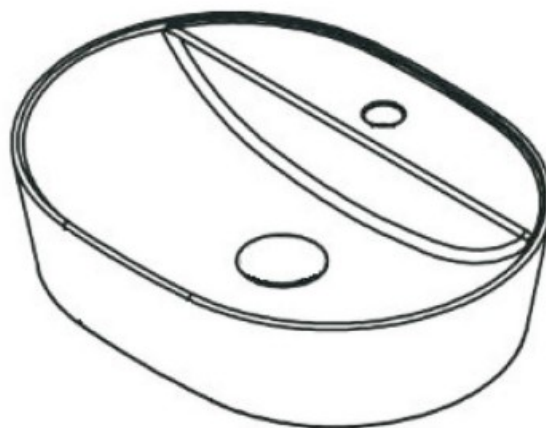
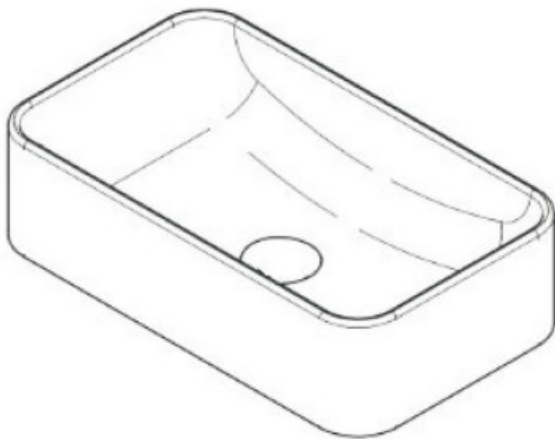

Please note: Image is for illustrative purposes only and may differ slightly to the actual product

- Single-person assembly
- Tools required
- We always recommend using professional tradespeople to install your product

Congratulations on your purchase

And welcome to our growing gang of savvy shoppers

We're on a mission to bring you extraordinary bathroom products, for less. From modern to traditional style ceramics, plus the gorgeous fixtures, fittings and furniture to match. So, you can fall in love with your space every single day.

As one of the UK's largest independent bathroom stores, we've received countless awards; including the National Business Awards UK, the Digital Entrepreneur Awards and being placed on The Sunday Times Fast Track 100. We hope your new product exceeds your highest expectations. However, If you experience any problems, please:

- log Into your account and contact our customer services team via your self-serve portal — betterbathrooms.com/CustomerAccount/Login
- contact us via betterbathrooms.com/content/contact-us

Important information

- Please read these instructions thoroughly and retain for future reference
- Always check for pipes and cables before drilling

Parts

1 x Basin

Tools required

Silicone, drill and hole cutter

Installation

1. Proceed to cut holes for waste and tap as required, ensuring that the tap hole is positioned at a distance which does not cause interference with the basin.

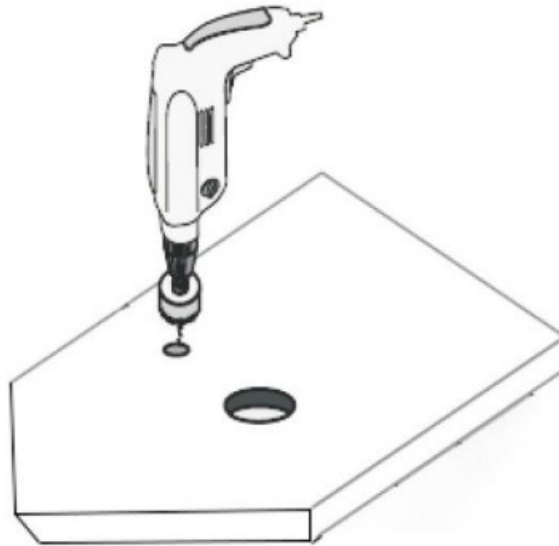

2. Seal the inside and exposed edge after cutting to prevent water or moisture penetration.

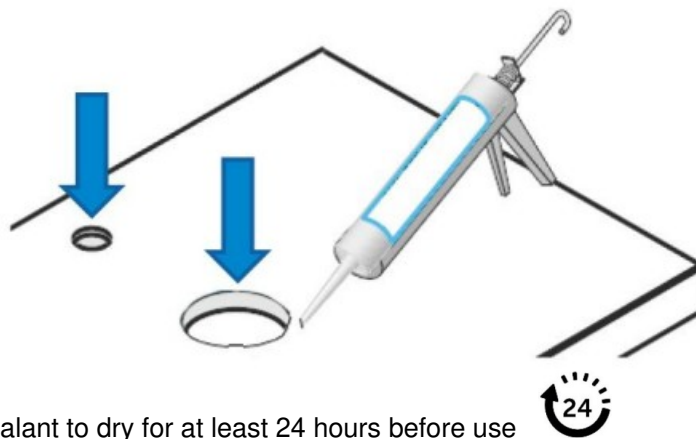

Please note: Allow all sealant to dry for at least 24 hours before use

3. Fit the basin waste to the basin as shown (and follow waste instruction).

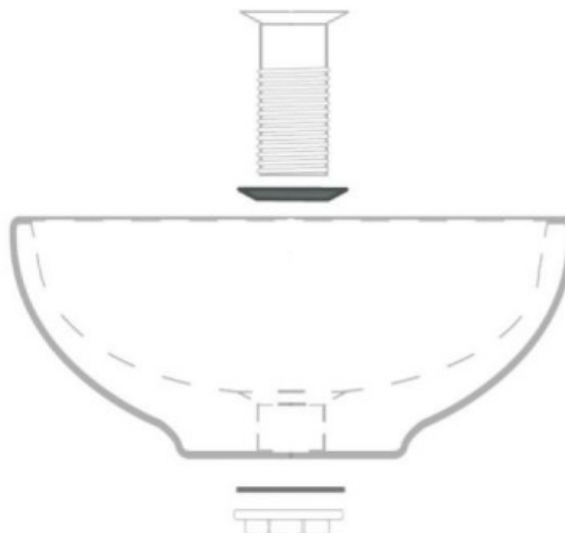

4. Apply a bead of silicone slightly form the edge of the basin.

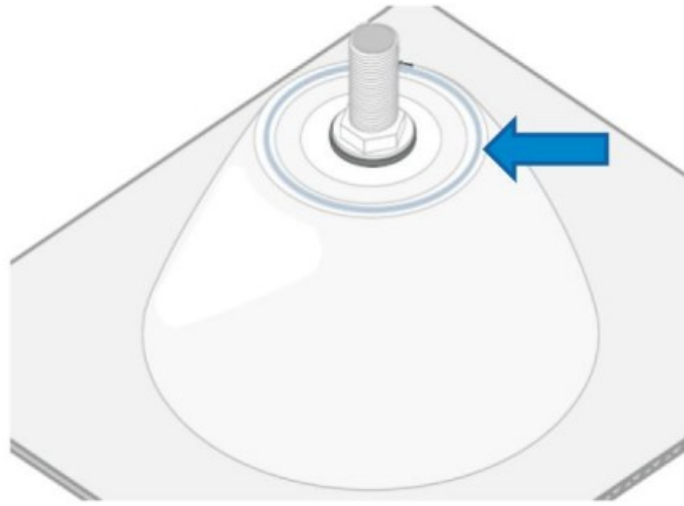

5. Apply the silicone slightly in from the outer edge on the underside of the basin.

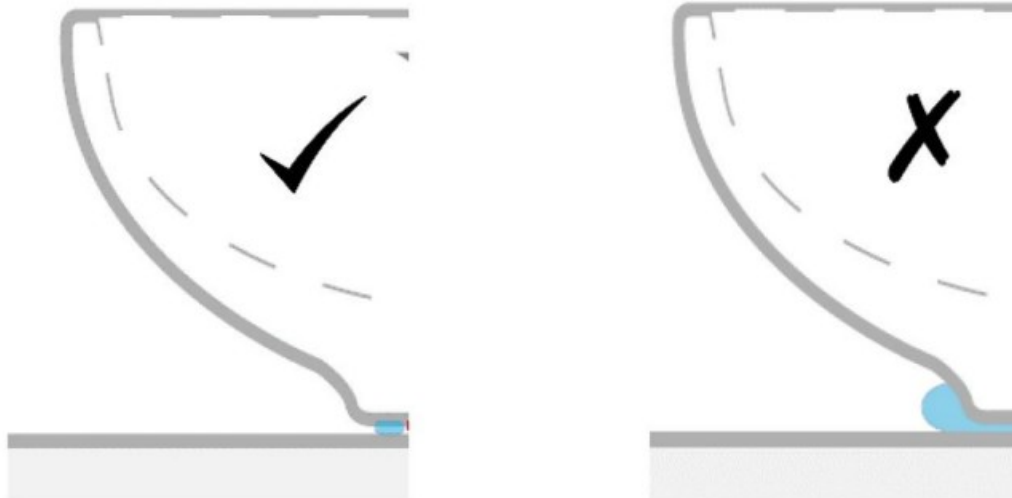

6. Place the basin into position with the waste through the drilled hole to allow connection to the waste trap (not supplied).

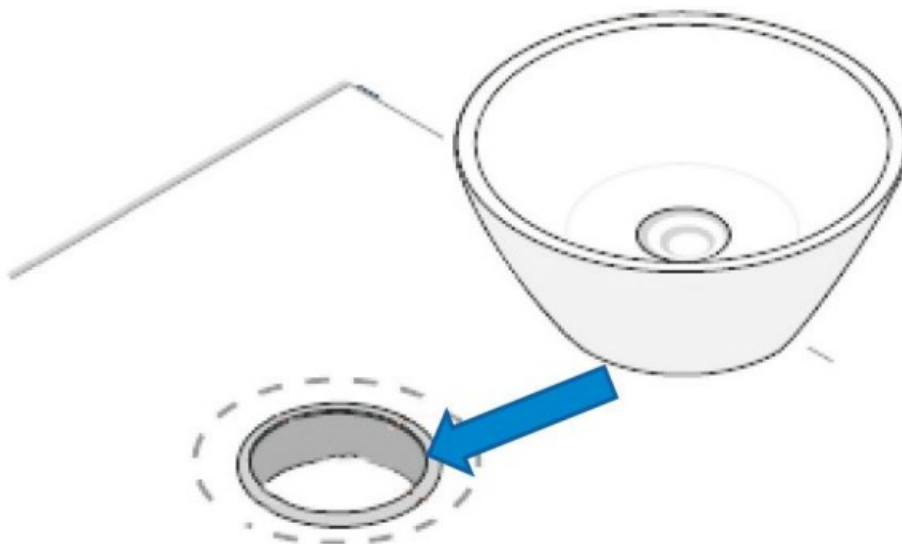

Please note: Allow all sealant to dry for at least 24 hours before use



Cleaning

To maintain the surface finish of your product, wipe clean after every use, using a clean damp cloth, a mild detergent mixture can be used. Do not use abrasive cleaning agents or materials which can strip and scratch the

surface; the use of these agents or materials can Invalidate your guarantee.

For more information

- visit betterbathrooms.com
- email customerservices@buyitdirect.co.uk
- call 0330 390 3062
- write to Trident Business Park, Neptune Way, Huddersfield, HD2 1TUA



Documents / Resources

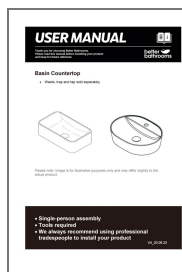

[Corey CORGW450X320 Rectangle Gloss White Countertop Basin](#) [pdf] User Manual
CORGW450X320 Rectangle Gloss White Countertop Basin, CORGW450X320, Rectangle Gloss White Countertop Basin, Gloss White Countertop Basin, Countertop Basin

References

- [User Manual](#)

[Manuals+](#), [Privacy Policy](#)

This website is an independent publication and is neither affiliated with nor endorsed by any of the trademark owners. The "Bluetooth®" word mark and logos are registered trademarks owned by Bluetooth SIG, Inc. The "Wi-Fi®" word mark and logos are registered trademarks owned by the Wi-Fi Alliance. Any use of these marks on this website does not imply any affiliation with or endorsement.