

**core**  
CR-ECT-86-XX-XXX Eclipse  
Smart Home Thermostat



# Core CR-ECT-86-XX-XXX Eclipse Smart Home Thermostat User Guide

[Home](#) » [CORE](#) » Core CR-ECT-86-XX-XXX Eclipse Smart Home Thermostat User Guide 

## Contents

- [1 Core CR-ECT-86-XX-XXX Eclipse Smart Home Thermostat](#)
- [2 Package Contents](#)
- [3 Technical Specification](#)
- [4 Components](#)
- [5 Mounting](#)
- [6 Commissioning](#)
- [7 Documents / Resources](#)
  - [7.1 References](#)



**Core CR-ECT-86-XX-XXX Eclipse Smart Home Thermostat**

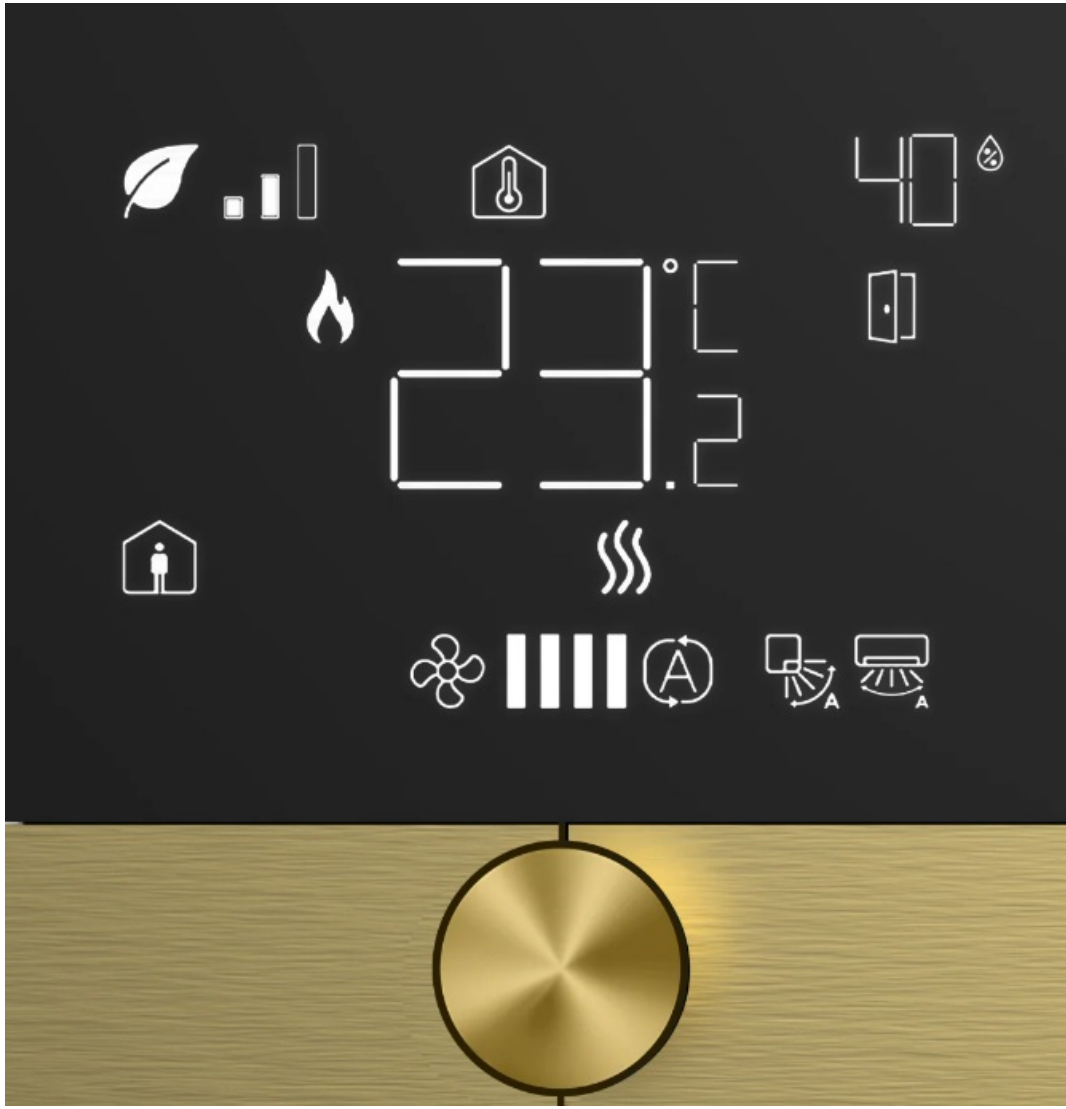

## Package Contents

- Core Eclipse Thermostat Electronic Part
- Metal Mounting Support
- Screws
- Connectors

Core Bina Otomasyon Sistemleri Ltd.  
Fatih Mahallesi Ege Caddesi No:42/5 Gaziemir – izmir – TOrkiye

[www.core.com.tr](http://www.core.com.tr)

## Installation



## Programming Manual



## Technical Specification

### CONCEPT DESCRIPTION

- Sensors: Temperature & Humidity co, Proximity & Light
- Dimensions: 86mm X 86mm X 11mm
- Fold Thickness: 4mm
- Display: 3.5" VA Display
- Power: 29 VDC
- Consumption: <1 5 mA from KNX Bus-line
- Connectivity: KNX-TP
- Programming Tool: ETS
- Installation: German IEC/EN 60670 In wall Box

### To be completed

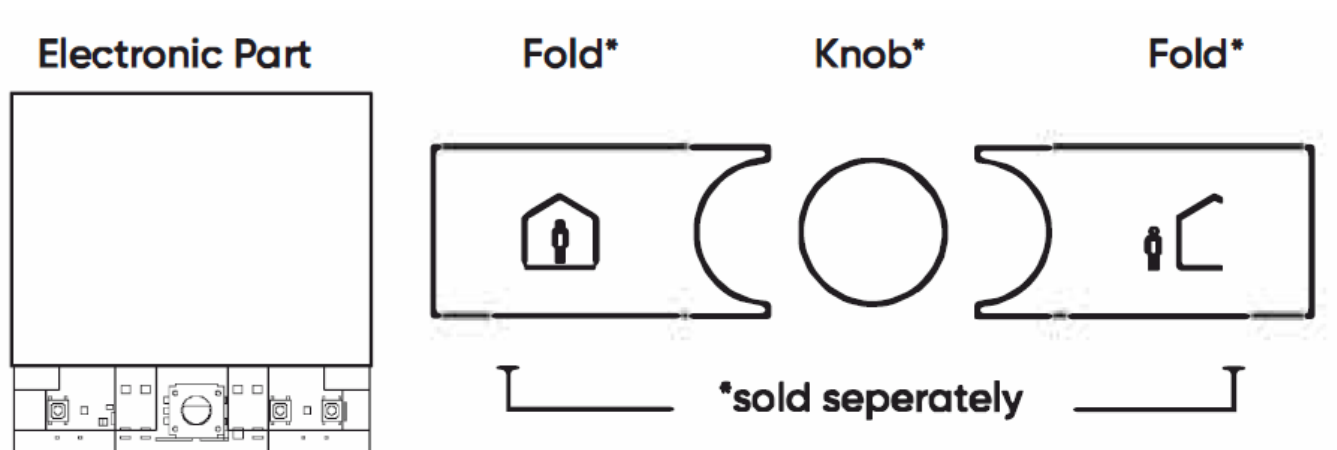

## Components

1. Display

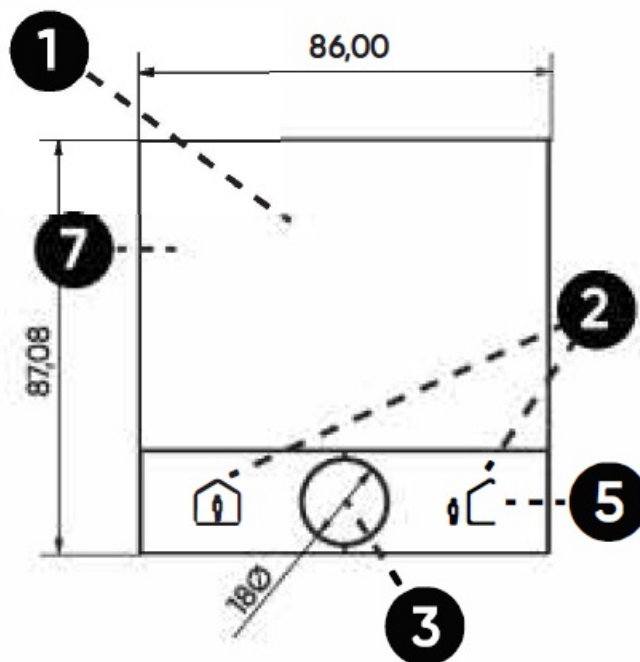

- 2. Buttons
- 3. Supernob
- 4. KNX Connector

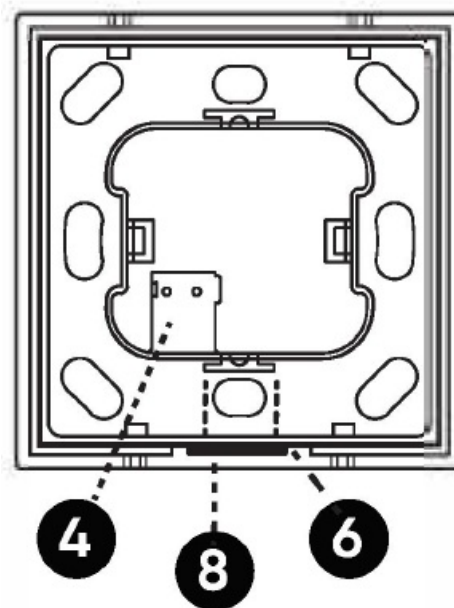

- 5. KNX Programming Button
- 6. CO2 Sensor
- 7. Proximity Sensor

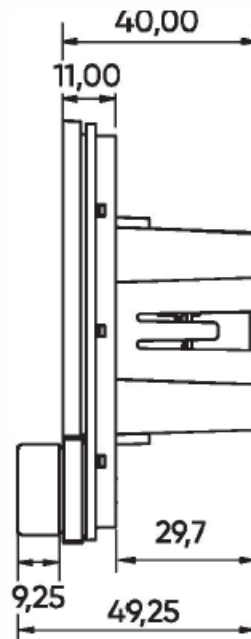

## 8. Temperature and Humidity Sensor

### Safety Remarks

### Warnings

- Installation, electrical connection, and directives for which the device has configuration and commissioning of being certified, is no longer the device can only be carried out guaranteed.
- By qualified personnel in compliance with the applicable technical standards and laws avoided the use of solvents or the respective countries. Other aggressive substances.
- The electrical connection of the device can only be carried out by qualified personnel. Incorrect installation may result in an electric shock or fire.
- Before making the electrical connections, make sure the power supply has been turned off.
- Do not connect the main voltage (230V AC) to the KNX connector of the device.
- Opening the housing of the device causes the immediate end of the warranty period.
- In case of tampering, compliance with the essential requirements of the applicable

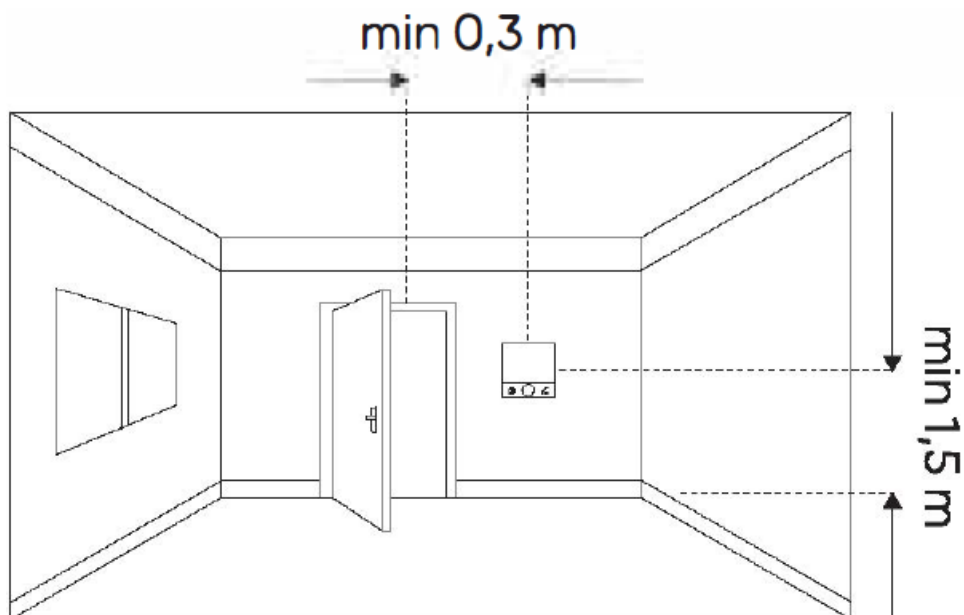

- Contact with fluids to the plate and socket is to be avoided.

- The device can not be installed close to heat sources such as radiators or household appliances or in positions subjected to direct sunlight.
- The device has to be installed preferably on an internal wall at a height of 1,5m and at least 0,3m from doors.

## Mounting

1. Mount the metal mounting support.

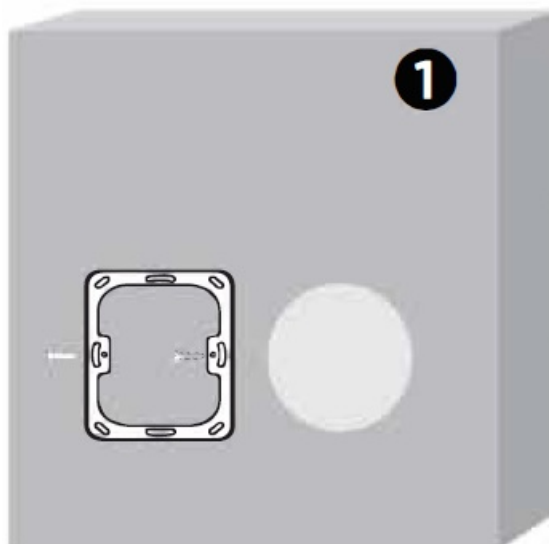

- (Included in the box.) Use screws included in the box (M3x15 mm)

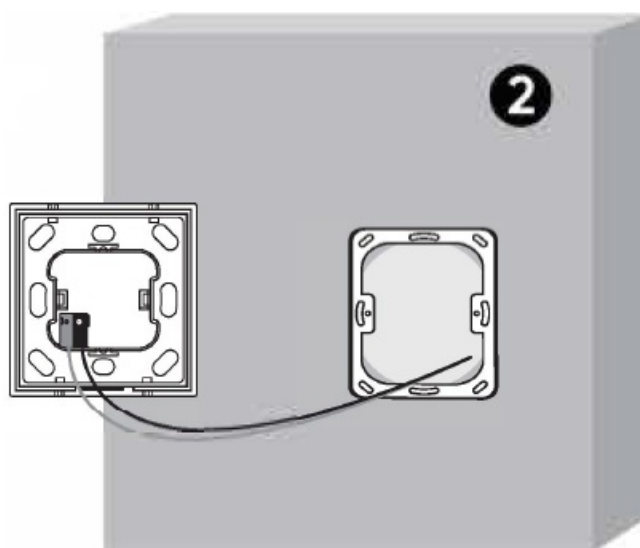

- At. Do not overtighten the screw

2.

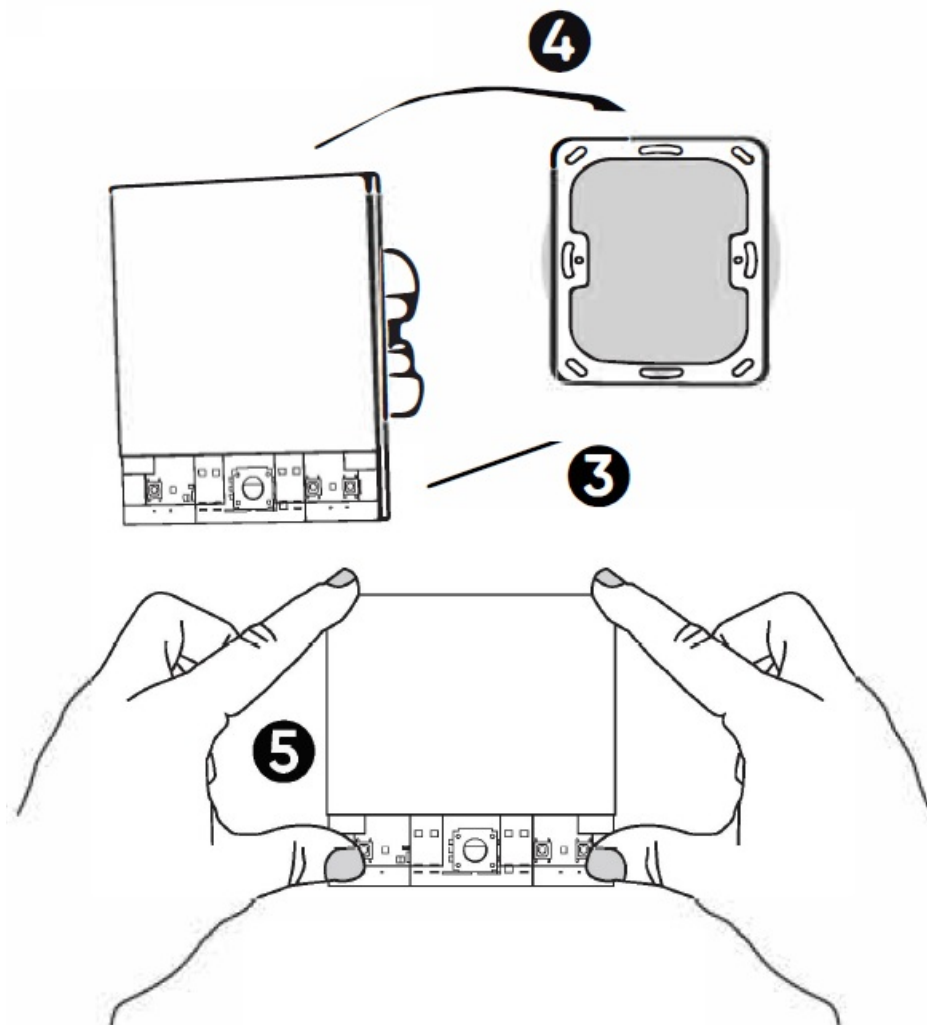

Connect the KNX cable to the device.

3. Check that polarity is correct
4. Place over the lower clips
5. Attach the top clips
6. Press and place the device with both hands simultaneously on the right and left sides.
  - Pushing the device straight into the clips might damage.

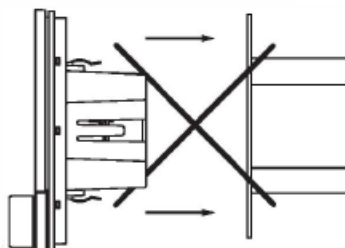

## Mounting

1. Place over side clips of folds

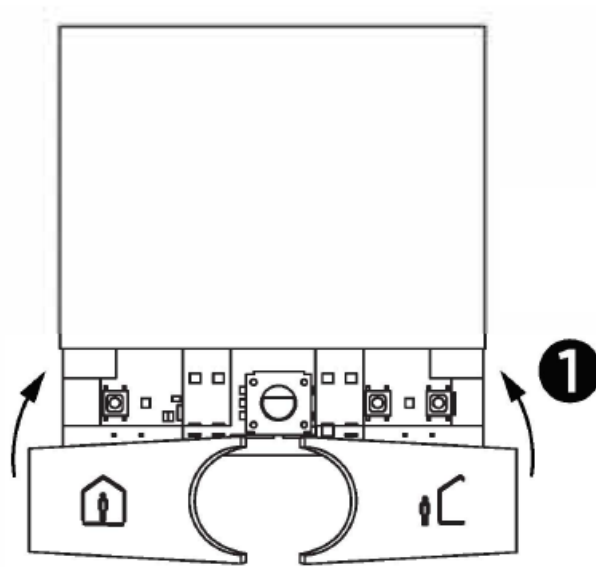

2. Attach middle clips

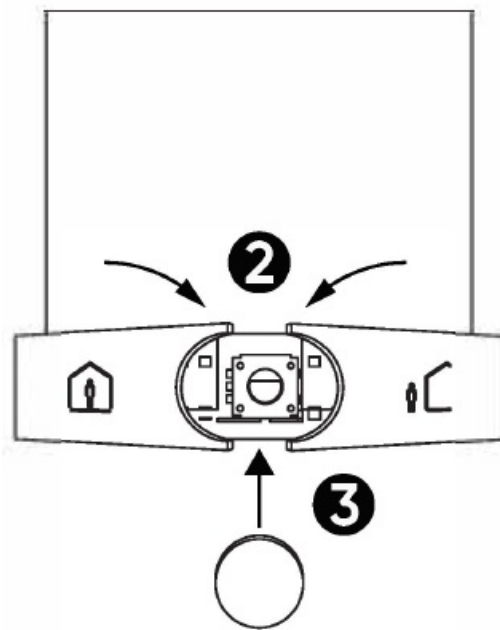

3. Attach the knob

## Commissioning

The configuration and commissioning of the device require the use of the ETS4 or later releases. These activities must be carried out according to the design of the building automation system done by a qualified planner.

- For the configuration of the device parameters, the corresponding application program or the whole Core product database must be loaded in the ETS program. For detailed information on configuration options, refer to the application manual of the device available on the website [www.core.com.tr](http://www.core.com.tr)
- For commissioning the device, the following activities are required
  - Make the electrical connections as described above. Turn on the bus power supply.
  - Switch the device operation to the programming mode



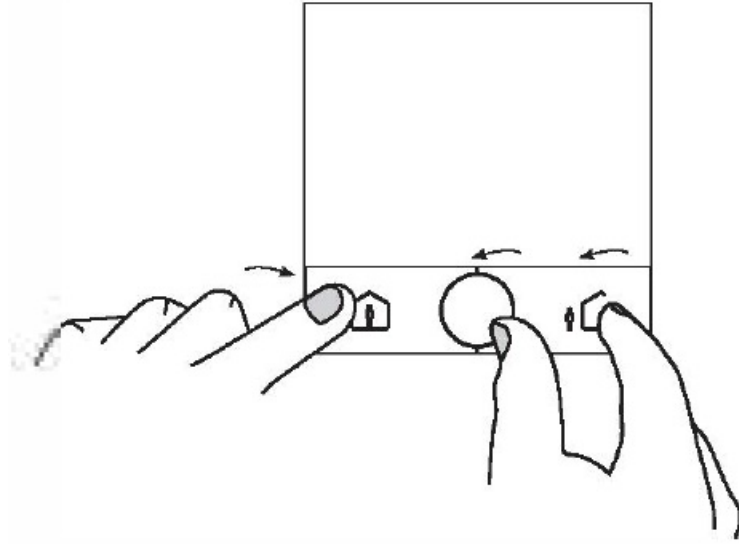

- Alternatively, instead of using programming button, it is possible to Switch the operation of the device to Programming mode by pressing button 1. button 2 and super knob simultaneously download into the device the physical address and the configuration with the ETS program.
- At the end of the download, the operation of the device.
- Returns to normal mode.
- Now, the bus device is programmed and ready to use.

Core Bina Otomasyon Sistemleri Ltd.  
Fatih Mahallesi Ege Caddesi No 42/5  
Gazimir – izmir – TOrkiye  
[www.core.com.tr](http://www.core.com.tr)



## Documents / Resources

	<p><a href="#">core CR-ECT-86-XX-XXX Eclipse Thermostat Core Smart Home</a> [pdf] User Guide CR-ECT-86-XX-XXX Eclipse Thermostat Core Smart Home, CR-ECT-86-XX-XXX, Eclipse Thermostat Core Smart Home, Thermostat Core Smart Home, Core Smart Home, Smart Home</p>
--	---

## References

- [User Manual](#)

[Manuals+](#), [Privacy Policy](#)

This website is an independent publication and is neither affiliated with nor endorsed by any of the trademark owners. The "Bluetooth®" word mark and logos are registered trademarks owned by Bluetooth SIG, Inc. The "Wi-Fi®" word mark and logos are registered trademarks owned by the Wi-Fi Alliance. Any use of these marks on this website does not imply any affiliation with or endorsement.