

**CORDIVARI**  
DESIGN  
**Frame Pro**  
**Towel Rail**



## CORDIVARI Frame Pro Towel Rail User Manual

[Home](#) » [CORDIVARI](#) » CORDIVARI Frame Pro Towel Rail User Manual 

### Contents

- [1 CORDIVARI Frame Pro Towel Rail](#)
- [2 Product Information](#)
- [3 Product Usage Instructions](#)
- [4 General warnings](#)
- [5 Installer information](#)
- [6 Positioning in bathrooms](#)
- [7 Wall mounting](#)
- [8 General information](#)
- [9 Technical Features](#)
- [10 Electrical connection](#)
- [11 Operating modes](#)
- [12 DECLARATION OF CONFORMITY](#)
- [13 Documents / Resources](#)
  - [13.1 References](#)

**CORDIVARI**  
DESIGN

**CORDIVARI Frame Pro Towel Rail**



## Product Information

This manual provides use and maintenance instructions for the Frame Pro and Frame Pro Baden models manufactured by Cordivari. It includes safety precautions and technical specifications for proper installation and operation.

## Specifications

- **Models:** Frame Pro, Frame Pro Baden
- **Websites:** [www.cordivari.com](http://www.cordivari.com), [www.cordivaridesign.com](http://www.cordivaridesign.com)
- **Product Code:** 1910000000088 – nv00

## Product Usage Instructions

### General Warnings

Dear Customer, thank you for choosing our product. Before installing or using the appliance, please read the instructions carefully to understand the associated dangers.

### User Information

Ensure compliance with national installation standards. The power outlet and differential switch must be located in zone 3, and no electrical control device should be accessible to a person using the shower or bathtub.

### Positioning in Bathrooms

Follow the specified distances for positioning in different zones of the bathroom as indicated in the manual. Wall Mounting Refer to the user manual for instructions on wall mounting the Cordivari Design ventilated radiators, including specific models and dimensions.

## Technical Features

Detailed technical specifications including height, width, and weight for various models are provided for reference.

## Electrical Connection

Instructions for electrical connection, including icons and buttons for power and mode settings, are outlined in the manual.

## Disposal

Proper disposal guidelines are included in the manual for environmentally friendly product management.

## FAQs

### • Q: What safety certifications does the product comply with?

A: The product complies with EN 603351:2012, IEC 60335-1:2010, IEC 60335-2-40:2023, EN IEC 55014-1:2021, EN IEC 61000-3-2:2019, and other relevant standards.

## General warnings

Dear Customer,

Thank you for choosing our product. Carefully read the instructions before installing and/or using the appliance.

- The product is intended for the general public.
- It is recommended to have all installation and adjustment operations performed by qualified personnel.
- Once the product is removed from the package check its integrity. If the product is damaged, do not use it and contact the Cordivari assistance network.
- The unit must be installed in compliance with all local and national technical, plant and safety regulations.
- Before making any connection make sure the supply voltage corresponds to the voltage stated on the characteristic label placed on the appliance.
- If the power supply cable is damaged, contact the manufacturer or its technical assistance service to have it replaced, or, in any case, have the operation carried out by a person with similar qualification in order to prevent any risk.
- For correct operation, use a socket dedicated exclusively to the unit and always provide a grounding system.
- It is mandatory to use a suitable electric switch on the unit's power socket.
- WARNING – Some parts of this product may become very hot and cause scalding. Pay extra care when children or vulnerable people are present.
- Unsupervised children under the age of 3 must be kept at a safe distance from the appliance.
- This appliance can't be used by children aged 8 years or older and by people with reduced physical, sensory and mental capabilities, or with no experience and the required knowledge unless they are supervised or they have received instructions on the safe use of the appliance and have understood inherent hazards.
- Children must not play with the appliance;
- Cleaning and maintenance operations intended to be carried out by the user must not be carried out by children without supervision.
- Do not install the device near curtains, other flammable materials, fuels or pressurised containers.
- The appliance must be positioned so that the electronic control can perfectly detect the room temperature, far from external heat sources.
- Do not pour water or other liquids onto the unit, especially on the electrical and electronic components.

- Do not insert or drop objects through the upper air outlet slot. Do not insert objects into the lower air intake area.
- Do not obstruct or cover the upper and lower air passages. It is important to keep the unit well ventilated.
- This manual is available in digital format on the website [www.cordivaridesign.en](http://www.cordivaridesign.en).

### **User information**

To clean the fan coil painted metal casing, use only a non-abrasive cloth soaked in water. Never use detergents or aggressive substances. Avoid any other base or acid solution, chemical, industrial or other substances, aggressive or corrosive substances (bleach, ammonia, baking soda, etc.). Use a dry cloth for cleaning the plastic parts (top cover, control panel and user interface). Do not use abrasive cloths or sponges.

### **Installer information**

Do not open or tamper with the packaging before installation. The unit may only be handled by personnel who are specialised in these operations and have experience of the same. When opening the package, check that the unit has not been damaged during transport and that it is complete along with all its parts. To open the packaging follow the instructions below:

1. Check for visible damage
2. Open the package
3. Check that all the components are correctly present
4. Do not throw away the packaging: the installation template is on the back of the box (see next paragraph)
5. After proper installation, dispose of the packaging materials in compliance with the municipal regulations of the area you are based in

The unit must be handled carefully to avoid damaging the external structure, internal mechanisms and electrical components. Make sure that there are no obstacles on the way to the installation site that could cause the risk of collision, falling or overturning of the unit. All the operations described below must be performed in compliance with all prevailing health and safety at work regulations.

This product is subject to the general warranty conditions set forth in the current official Cordivari catalogue. The warranty is valid from the date of delivery and is void if the production batch label is tampered with and/or removed. The warranty applies after the examination of defects and their causes. The material to be replaced or repaired shall be delivered ex-warehouse at the dealer. The commitment to provide the warranty is subject to the conditions and requirements described below.

The radiator has not been damaged during transport, handling or installation and no repair and/or tampering has been carried out by third parties without express authorisation. Before installation, the material has been stored in good conditions and under shelter from the weather. Product installation must be carried out by qualified personnel and in compliance with these instructions and all national and local regulations concerning installation and safety. N.B. The product does not have a pressure relief valve. It is therefore good installation practice to provide such a device.

### **Positioning in bathrooms**

Since Cordivari Design ventilated radiators are provided with Class II insulation and IP24 minimum protection rating, they must be positioned in hazardous zone 3 (see figure). In any case, always refer to national installation regulations.

The power socket and the differential switch must be positioned in zone 3 and no electric control element must be accessible by a person using the shower or the bath tub.

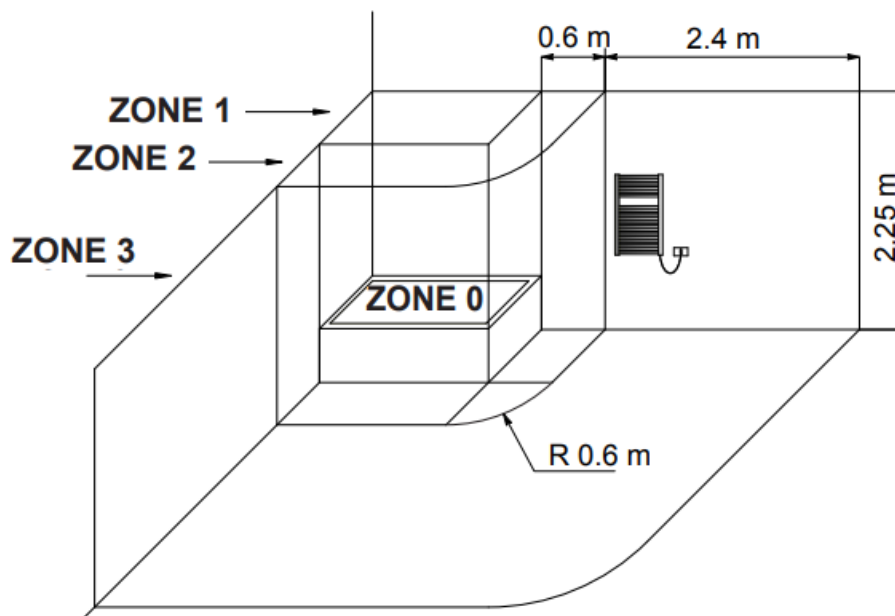

Position the radiator so that the minimum distance from the ground is 100 mm, that no obstacle is at least 400 mm in front of the suction area and, finally, that the minimum distance between the top of the unit and any wall and/or obstacle is not less than 400 mm, in order to allow for proper air discharge.

### Wall mounting

Wall mounting of the unit must be carried out according to the instructions in the mounting kit. The fastening systems (screws+blocks) are suitable for compact walls or hollow brick walls. For walls made of different materials, the installer is responsible for the use of suitable fastening systems. The radiator must never be installed upside down or placed in front of the power supply socket.

### General information

The user instructions as per this booklet refer to Cordivari Design ventilated radiators, in particular to models:

Height [mm]	Width [mm]	Depth [mm]	Net weight [kg]
<b>FRAME PRO BADEN</b>			
1240	408	101	38.4
1240	464	101	45.0
1240	520	101	53.2
1440	408	101	44.1
1440	464	101	52.0
1440	520	101	61.4
<b>FRAME PRO</b>			
1240	408	101	38.4
1240	464	101	45.0
1240	520	101	53.2
1440	408	101	44.1
1440	464	101	52.0
1440	520	101	61.4
1640	408	101	49.7
1640	464	101	58.9
1640	520	101	69.6
1840	408	101	55.7
1840	464	101	65.9
1840	520	101	77.9
2040	408	101	61.4
2040	464	101	72.8
2040	520	101	86.1

The products presented and described in this manual are equipped with on-board control devices that enable their full use.

## Technical Features

<b>FRAME PRO BADEN L. 408 mm</b>	<b>H 1240</b>	<b>H 1440</b>	<b>H 1640</b>	<b>H 1840</b>	<b>H 2040</b>
Thermal powers at $\Delta T$ 30°C					
FAN OFF power [W]	397	459	534	590	637
FAN LOW power [W]	486	577	755	808	938
FAN MED power [W]	518	610	839	900	1025
FAN HIGH power [W]	544	642	913	981	1141
FAN BOOST power [W]	573	670	1040	1120	1276
Thermal powers at $\Delta T$ 50°C					
FAN OFF power [W]	775	895	1035	1144	1242
FAN LOW power [W]	898	1055	1353	1452	1701
FAN MED power [W]	967	1130	1504	1617	1860
FAN HIGH power [W]	1024	1200	1637	1762	2070
FAN BOOST power [W]	1087	1263	1865	2013	2314
<b>FRAME PRO BADEN L. 464 mm</b>	<b>H 1240</b>	<b>H 1440</b>	<b>H 1640</b>	<b>H 1840</b>	<b>H 2040</b>
Thermal powers at $\Delta T$ 30°C					
FAN OFF power [W]	459	531	597	670	738
FAN LOW power [W]	562	668	861	931	1111
FAN MED power [W]	600	706	962	1037	1208
FAN HIGH power [W]	629	744	1051	1131	1337

FAN BOOST power [W]	663	776	1206	1292	1486
Thermal powers at $\Delta T$ 50°C					
FAN OFF power [W]	897	1036	1157	1300	1438
FAN LOW power [W]	1039	1221	1532	1667	1994
FAN MED power [W]	1119	1308	1712	1858	2170
FAN HIGH power [W]	1186	1389	1870	2025	2401
FAN BOOST power [W]	1259	1463	2145	2314	2668
<b>FRAME PRO BADEN L. 520 mm</b>	<b>H 1240</b>	<b>H 1440</b>	<b>H 1640</b>	<b>H 1840</b>	<b>H 2040</b>
Thermal powers at $\Delta T$ 30°C					
FAN OFF power [W]	522	603	677	756	813
FAN LOW power [W]	639	759	942	1088	1231
FAN MED power [W]	681	802	1059	1230	1354
FAN HIGH power [W]	715	845	1163	1356	1518
FAN BOOST power [W]	754	882	1344	1577	1711
Thermal powers at $\Delta T$ 50°C					
FAN OFF power [W]	1019	1177	1313	1475	1587
FAN LOW power [W]	1181	1388	1677	1917	2205
FAN MED power [W]	1272	1487	1885	2167	2425
FAN HIGH power [W]	1347	1578	2070	2389	2719
FAN BOOST power [W]	1431	1662	2391	2780	3063

- Supply voltage 230 V AC 50 Hz
- Electrical insulation: Class II



- Fuse type: FUSE 5X20 T2A FPG2 250 VAC
- Brushless motor DC24V 16W 1400 rpm Class B
- Ambient operating temperature from 5°C to +30°C – 60% RH
- Maximum flow temperature 75 °C
- Maximum operating pressure 5 bar (0.5 Mpa)

## Electrical connection

Before connection, make sure that the equipment rated voltage (230 V AC 50 Hz) is equal to the mains voltage, and that the socket is able to provide the rated current corresponding to the maximum power of the model selected. Moreover, such socket must be controlled through a double-pole switch used to switch the radiator on and off. In case of damage, the repair must be carried out solely and exclusively by the manufacturer. To make the electrical connection, the external wall power supply unit, supplied as standard, must be connected to the socket on the lower part of the product.

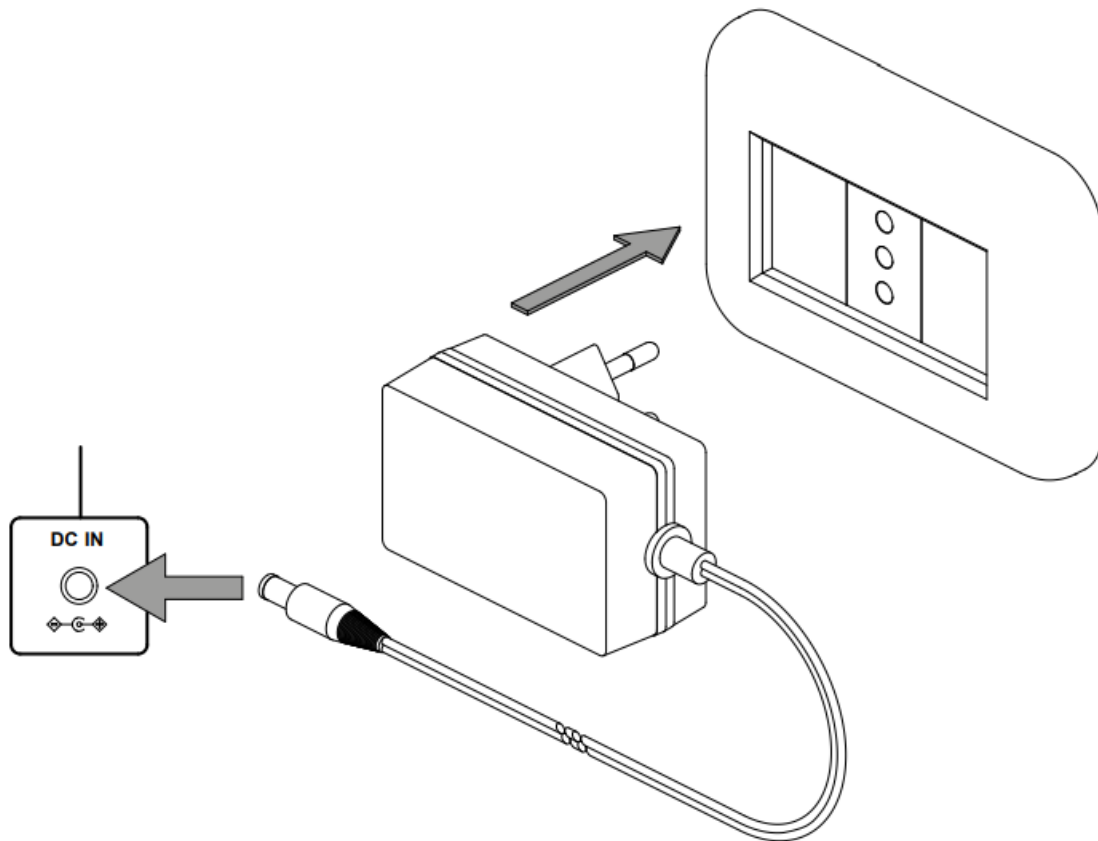

## Operating modes

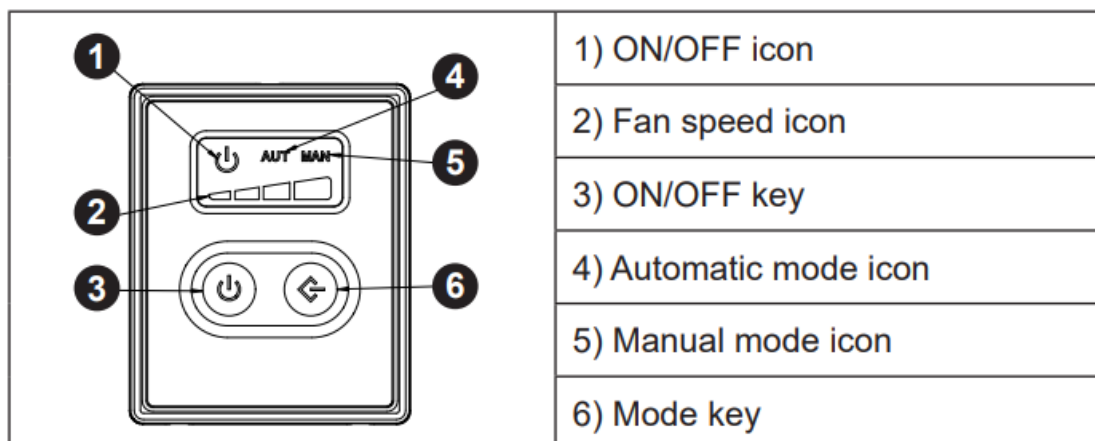

When the power supply unit has been connected to the device, to switch the device on it is necessary to press the “ON/OFF key” [3] with visual feedback of icon [1] which will turn green. When the device is switched on, you will be in manual mode by default. If you want to switch to automatic mode, simply press the “Mode Key” [6] 4 times. To return to manual mode again, simply press the “Mode key” [6] once. To switch off the device, press the “ON/OFF key” again, the icon [1] will turn red. The available operating modes are:

- Manual mode: the user can use the “mode” key to select the 4 fan speeds, regardless of the flow temperature values.
- Automatic mode: the fan speed is automatically adjusted according to the flow temperature read by the NTC probe located on the living radiator. The algorithm will choose whether to switch off, modulate or bring the fan to the maximum speed. The display always shows the current operating status. The correct operation of the product in this mode is strictly dependent on compliance with the water inlet/outlet indications (stickers on the product). The probe, in fact, is positioned close to the water inlet to allow the algorithm to work efficiently.

In case of malfunction due to the disconnection of the NTC probe the icon [1] will turn yellow. With this type of error, the automatic mode is not available, but operation of the living radiator in manual mode is still possible. In any case, it is recommended to contact the Cordivari service network.

### **Manufacturer liability**

The manufacturer declines any liability for damages to persons and property caused by:

- use of the appliance other than intended;
- non-observance of the user manual instructions;
- tampering with even just one part of the appliance;
- use of non-original spare parts.

### **Disposal**

At the end of its working life, this appliance must be delivered to the special collection facilities for recycling, since it is not a standard domestic waste. In case of replacement, it can be delivered to your distributor. This management of the end of the life of a product allows us to preserve our environment and to limit the use of natural resources. This symbol, applied on the product, indicates the obligation to deliver the product at the end of its working life to a special collection facility, in compliance with Directive 2012/19/UE.

## **DECLARATION OF CONFORMITY**

The company Cordivari S.r.l., with registered office in Zona Industriale Pagliare, Morro D'Oro (TE), Italy, declares under its own responsibility that the ventilated radiators referred to in para. 6 comply with the following standards:

EN 603351:2012 + A11:2014 + A13:2017 + A1:2019 + A14:2019 +

A2:2019 + A15:2021

IEC 60335-1:2010 + AMD1:2013 + AMD2:2016

EN IEC 60335-2-40: 2023 + EN IEC 60335-2-40:2023/A11:2023

IEC 60335-2-40:2022

EN IEC 55014-1:2021

EN IEC 55014-2:2021

EN IEC 61000-3-2:2019 + A1:2021

EN 61000-3-3:2013 + A1:2019 + A2:2021

and therefore meet the essential requirements of the following European Regulations and Directives:

Directive 2014/35/EU

Directive 2014/30/EU

Directive 2012/19/EU  
Directive 2009/125/EC  
Directive 2011/65/EU amended by 2015/863/EU and 2017/2102/EU  
Morro D'Oro, 01/07/2024

Cav. Ercole Cordivari  
Amministratore unico



## **CORDIVARI S.r.l.**

Zona Industriale Pagliare 64020 Morro D'Oro (TE) Italia [cordivari.com](http://cordivari.com)  
[cordivaridesign.com](http://cordivaridesign.com)

**Tel.** +39 08580401

**Fax** +39 0858041418

C.F.-P.IVA-VAT Id nr. IT00735570673

REA TE N° 92310

Cap. Sociale €10.000000,00 i.v. UNI EN ISO 9001

UNI EN ISO 14001

UNI EN ISO 45001

[www.cordivari.com](http://www.cordivari.com)

[www.cordivaridesign.com](http://www.cordivaridesign.com)

## **Documents / Resources**

	<p><a href="#">CORDIVARI Frame Pro Towel Rail [pdf] User Manual</a> Frame Pro Towel Rail, Towel Rail, Rail</p>
---	--

## **References**

- [Designer Radiators: modern style radiators | Cordivari Design](#)
- [Designer Radiators: modern style radiators | Cordivari Design](#)
- [User Manual](#)

[Manuals+](#), [Privacy Policy](#)

This website is an independent publication and is neither affiliated with nor endorsed by any of the trademark owners. The "Bluetooth®" word mark and logos are registered trademarks owned by Bluetooth SIG, Inc. The "Wi-Fi®" word mark and logos are registered trademarks owned by the Wi-Fi Alliance. Any use of these marks on this website does not imply any affiliation with or endorsement.