

Container

Container Solutions
20FT Modified
Container House



Container Solutions 20FT Modified Container House Owner's Manual

[Home](#) » [Container Solutions](#) » Container Solutions 20FT Modified Container House Owner's Manual 

Contents

- [1 Container Solutions 20FT Modified Container House](#)
- [2 Product Usage Instructions](#)
- [3 Product Model](#)
- [4 Layout](#)
- [5 Circuit diagram](#)
- [6 Waterway diagram](#)
- [7 Specifications](#)
- [8 Product replaceable parts list](#)
- [9 Documents / Resources](#)
 - [9.1 References](#)
- [10 Related Posts](#)

Container

Container Solutions 20FT Modified Container House



Specifications

1. Overall Dimension: L6070mm*W2440mm*H2900mmL20FT*W8FT*H10FT
2. Main Structure:
 - Main Part: 20HQ Container steel frame, Light gray RAL7035
 - Wallboard: 50MM TPS board + 9MM wood-plastic composite board
 - Roof Board: 50MM TPS board + 9MM wood-plastic composite board
 - Floor: 15MM Ecological board + 3MM anti-slip and wear-resistant plastic-flooring
 - Doors and Windows: White broken bridge aluminum outward-opening window/White broken bridge aluminum Sliding window/Accordion door
 - Bathroom: ventilating fan/closestool/wash basin/mirror cabinet/Shower head/Acrylic push and pull partition/floor drain
 - Furniture: One-piece combination cabinet (with basin)
 - Drain off Water: cold-hotwater 1/2"/drains50/toilet discharge125
 - Power Distribution: Circuit breaker/LED light/Switch/socket
3. Fire Resistance: A1/B2 (Optional)

Product Usage Instructions

Layout

1. Plan Sketch
2. Circuit Diagram
3. Waterway Diagram

Assembly Instructions

1. Follow the plan sketch to assemble the container house.
2. Refer to the circuit diagram for electrical connections.
3. Consult the waterway diagram for plumbing installation.

Maintenance

Regularly check and maintain the container house components including doors, windows, bathroom fixtures, and electrical systems as per the user manual guidelines.

FAQ

Q: Can the container house be customized?

A: Yes, the container house can be customized based on specific requirements. Contact customer support for customization options.

Owner’s Manual

20FT Container House

Product Model

No.	Standard	Product No.	Model No.
1	American Standard 110V	1002420200120080A001	002-20-2001A-US
2	British standard 220V	1002320200120080A00 1	002-20-2001A-UK
3	Australian Standard 240V	1002220200120080A00 1	002-20-2001A-AUS

Layout

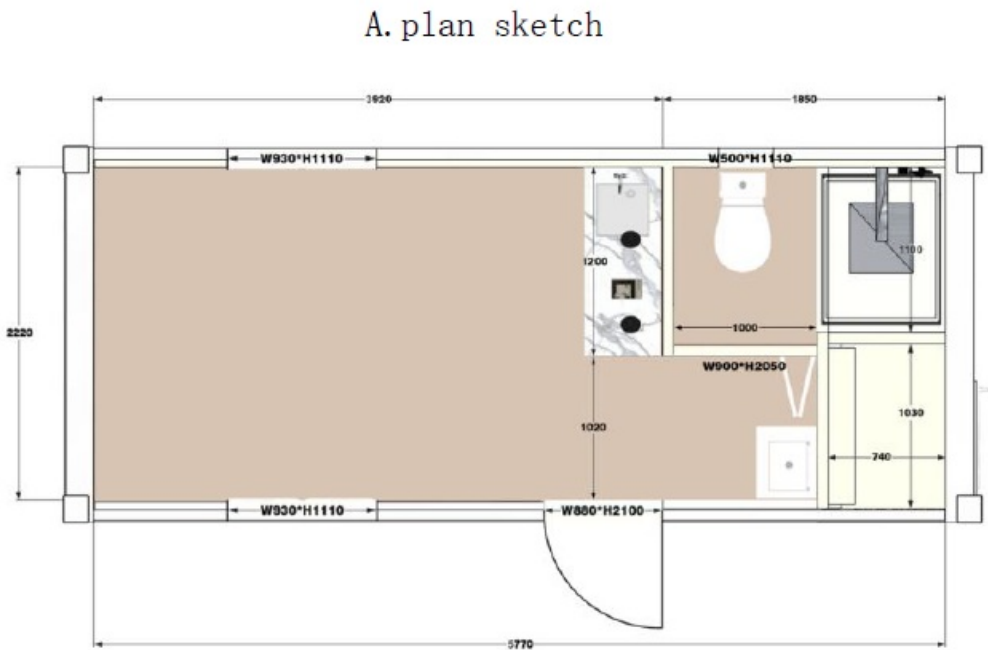

Circuit diagram

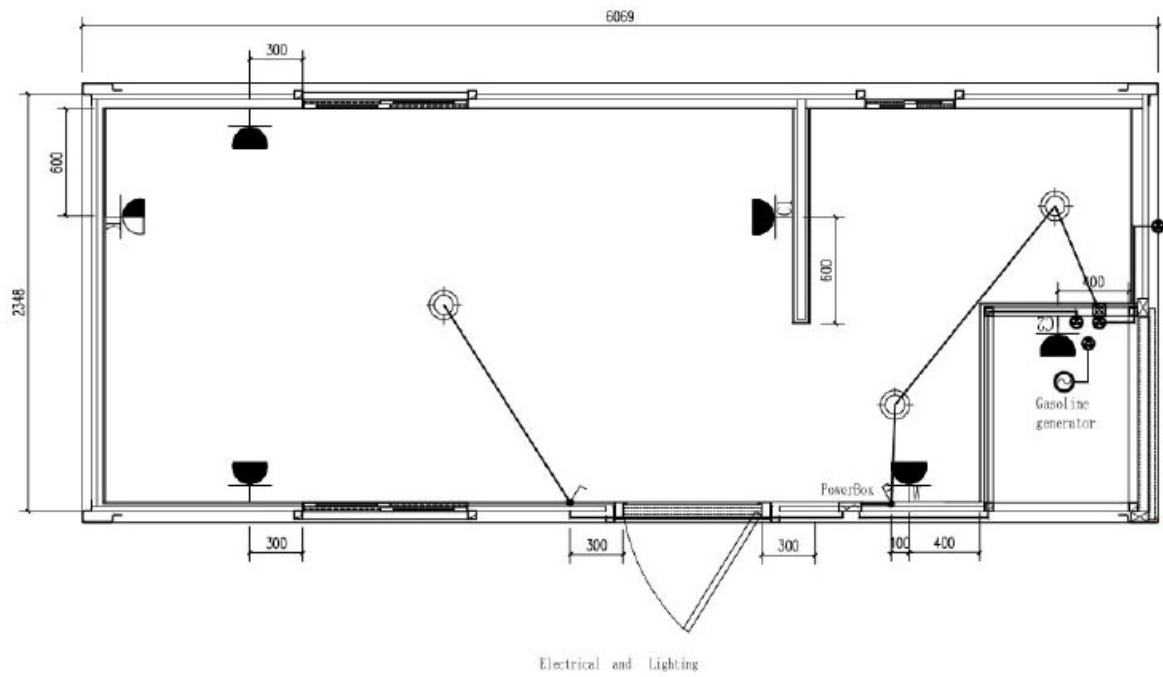

Waterway diagram

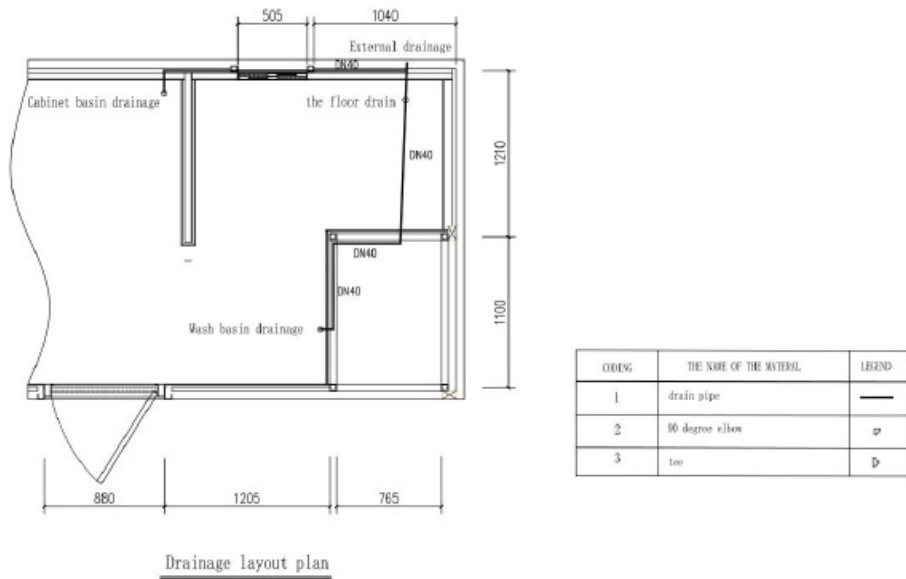
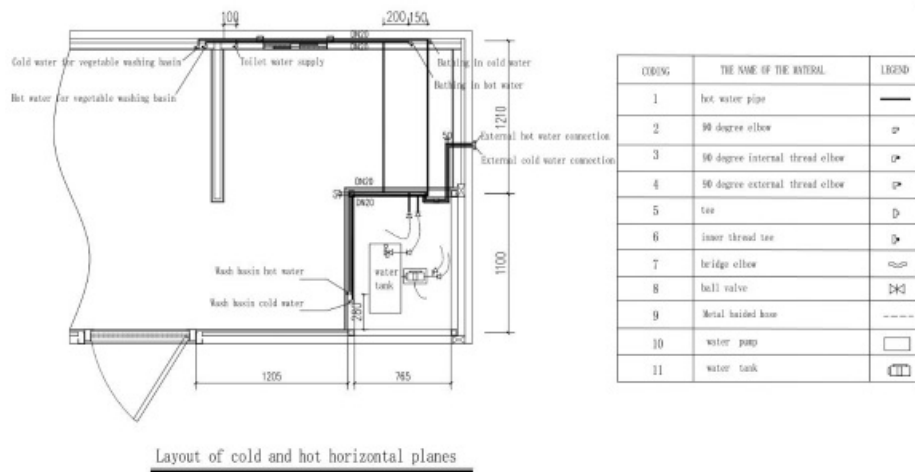

Specifications

1. Overall Dimension: L6070mm*W2440mm*H2900mm L20FT*W8FT*H10FT

2. Main Structure:

- Main Part: 20HQ Container steel frame,Light gray RAL7035
- Wallboard: 50MM TPS board+9MM wood-plastic composite board
- Roof Board: 50MM TPS board+9MM wood-plastic composite board
- Floor: 15MM Ecological board + 3MM anti slip and wear-resistant plastic-flooring
- Doors and Windows: White broken bridge aluminum outward-opening window/White broken bridge aluminum Sliding window/Accordion door
- Bathroom: ventilatingfan/closestool/wash basin/mirror cabinet/ Shower head/Acrylic push and pull partition/floor drain
- Furniture: One-piece combination cabinet (with basin)
- Drain off Water: cold-hot water 1/2"/drainsΦ50/toilet dischargeΦ125
- Power Distribution: Circuit breaker/LED light/Switch/socket
- Attachment: X

3. Configuration Table:

Name	Specifications
Aviation Socket	aviation socket, 16A
Circuit Breaker	
Ceiling Light	LED Ceiling Light moistureproof, dustproof, anti-mosquito , 265mm, 18W,

	6000K, Round
Switch	Unilateral switch/biswitch
Socket	Three-hole socket
Louver Ventilating Fan	louver ventilating fan
Electric generator	3000W
Water tank booster pump	180W
Security door	870×2095×100mm white
Accordion door	W965×H2050, Double door folding, 4mm tempered frosted glass
Broken bridge aluminum outward-opening window	W500×H1110 White, double hollow tempered glass
Broken bridge aluminum Sliding window	W930×H1110 White, double hollow tempered glass, Screened window
Curtain	Roller curtain, curtain size 1190×1200, aluminum alloy cover, crescent aluminum lower rail, bead system
One-piece combination cabinet	L1190×W540×H900, quartz stone countertop, three cabinet door, with washing basin
Wash-basin	550 bathroom sink, cabinet and mirror cabinet
Shower Faucet	shower faucet

Acrylic shower partition	W1090×H 2010, 304 stainless steel frame, 6mm white frosted acrylic panel
Ceramic Toilet	ceramic toilet
Water tank	830×500×500,white,200L
Hot Cold Water Inlet Pipe	20PPR tube, joint specification 20*1/2
Drain-pipe	40 PVC tube, drainage outlet 40 PVC tube

- Fire Resistance: A1/B2 (Optional)

Product replaceable parts list

Serial No.	Name	Specifications
1	Aviation socket	aviation socket, 16A
2	Circuit breaker	
3	Ceiling light	LED Ceiling Light (moistureproof dustproof anti-mosquito , 265mm, 18W, 6000K, Round
4	Switch	unilateral switch/biswitch
5	Socket	three-hole socket
6	Louver ventilating fan	louver ventilating fan
7	Electric generator	3000W
8	Water tank booster pump	180W

9	Accordion door	W965×H2050 Double door folding, 4mm tempered frosted glass
10	Broken bridge aluminum outward-opening window	W500×H1110 White, double hollow tempered glass
11	Broken bridge aluminum Sliding window	W930×H1110 White, double hollow tempered glass,Screened window
12	Curtain	Roller curtain, curtain size 1190×1200, aluminum alloy cover, crescent aluminum lower rail, bead system
13	Acrylic shower partition	W1090×H 2010, 304 stainless steel frame, 6mm white frosted acrylic panel
14	Washbasin	W405×L305×H130mm, white
15	water faucet	hot & cold
16	Basin drainer	Stainless steel
17	S-shaped sewer pipe	Gray
18	Shower head	shower head
19	Soap net	Soap net
20	Toilet	side toilet
21	Toilet brush	toilet brush
22	Tissue holders	Stainless steel
23	Water tank	830×500×500,white,200L

KEEP THESE OWNER'S MANUAL FOR FUTURE REFERENCE.

Documents / Resources

	<p>Container Solutions 20FT Modified Container House [pdf] Owner's Manual 002-20-2001A-US, 002-20-2001A-UK, 002-20-2001A-AUS, 20FT Modified Container House, 20FT, Modified Container House, Container House, House</p>
---	---

References

- [User Manual](#)

Manuals+, Privacy Policy

This website is an independent publication and is neither affiliated with nor endorsed by any of the trademark owners. The "Bluetooth®" word mark and logos are registered trademarks owned by Bluetooth SIG, Inc. The "Wi-Fi®" word mark and logos are registered trademarks owned by the Wi-Fi Alliance. Any use of these marks on this website does not imply any affiliation with or endorsement.