

contacta 
IL-K200 Under the
Counter Loop System

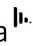

contacta IL-K200 Under the Counter Loop System User Guide

[Home](#) » [contacta](#) » contacta IL-K200 Under the Counter Loop System User Guide 

Contents

- 1 IL-K200 Under the Counter Loop System
- 2 Specifications
- 3 Product Usage Instructions
- 4 Product Overview
- 5 Components
- 6 Recommended Tools
- 7 Installation Instructions
- 8 Initial Set-Up
- 9 Handy Tips
- 10 Using the System
- 11 Maintenance
- 12 Troubleshooting
- 13 FAQs
- 14 Documents / Resources
 - 14.1 References
- 15 Related Posts

contacta 

IL-K200 Under the Counter Loop System



Specifications

- **Product:** Under the Counter Loop System IL-K200
- **Installation & User Guide:** July 2024
- Provides clear communication with hearing device wearers
- Flexible aerial for versatile installation under desks or counters

Product Usage Instructions

Installation Instructions

1. Check the contents of the box to familiarize yourself with the components.
2. Decide on the best locations for each component.
3. Install the aerial under the counter using P-clips or a suitable fixing method.
4. Position the microphone close to the staff member without obstructing and fix it using the double-sided pad.
5. Plan the cable route to the driver location, ensuring proper cable length and access through the countertop.
6. Fix the driver in place using the provided screws.
7. Install the power supply near a power socket using the mounting bracket and screws.
8. Connect all components as instructed.
9. Neatly route all cables to the driver using trunking or cable tacking.

Initial Set-Up

Volume adjustments are not needed as the driver self-adjusts after installation. Test the loop system using a loop listener to ensure proper functionality.

The Loop Driver

The driver has no buttons on the front panel. LED indicators show firmware revision and system status. A solid green halo LED indicates both the microphone and loop are connected and working, while a solid red LED indicates a fault or disconnection.

Contacta has a policy of continuous product development, therefore, small specification changes may not be reflected in this manual. Images, labels, packaging, accessories, and product colours are subject to change without notice.

Product Overview

- Our under-the-counter loop system provides clear communication with hearing device wearers, especially where background noise is a problem or clear speech is restricted.
- It has a flexible aerial that can be bent to shape, allowing it to be installed into many different positions under a desk or counter unit.

Components

1. Installation and User Guide
2. Hearing Loop Aerial
3. Hearing Loop Stickers x 2
4. HLD2 Loop Driver
5. Noise-cancelling Microphone or Mouse Microphone
6. Power Supply
7. IEC Lead

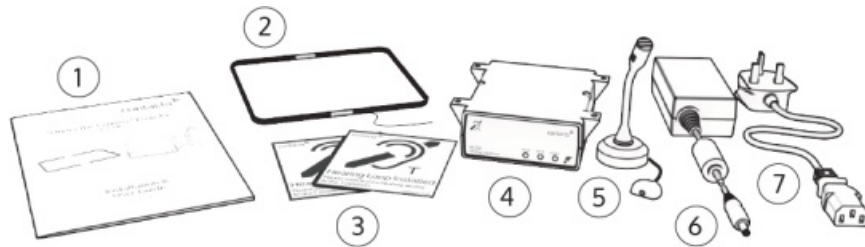

Recommended Tools

- Cable tacker
- 2.5mm flat head screwdriver
- Phillips PH2 screwdriver (or equivalent)
- Wire cutters/strippers
- Battery drill
- Assorted drill bits
- Zip ties
- Electrical insulation tape
- Hearing loop listener

Installation Instructions

We recommend that installation is carried out by a qualified engineer, adhering to the relevant standards.

1. Check the contents of the box to familiarise yourself with the components.
2. Ascertain the best locations for the various components, such as where the driver will be attached.
3. Position the aerial under the counter using either our P-clips or another suitable fixing method of your choice.
See the diagram below for recommended positioning.

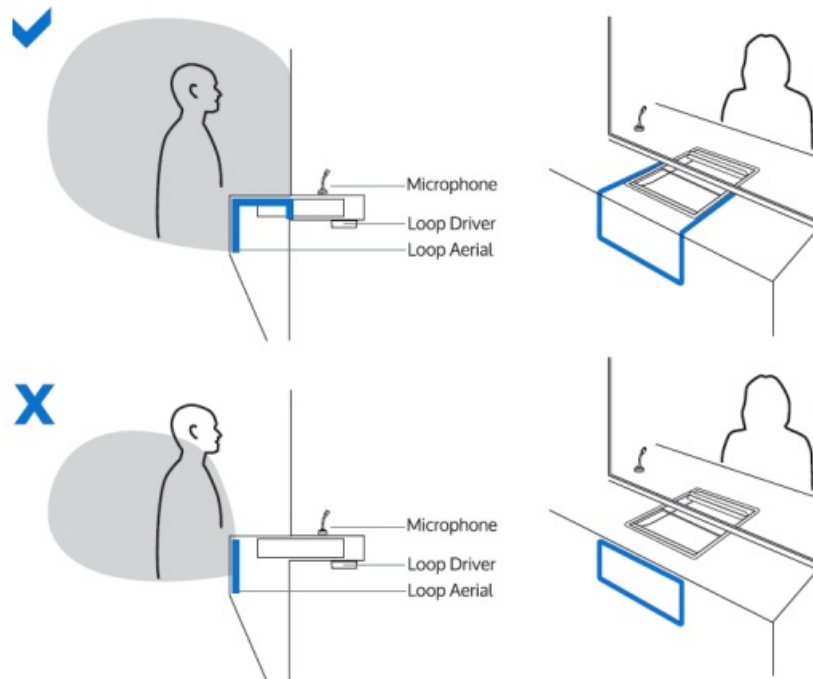

4. Check the cable route to the driver location, especially cable length to other components and access through the countertop.
5. Place the driver in the correct location under the staff counter.
6. Mark the 4 fixing points for drilling.
7. Drill and fix the driver in place using the screws provided.
8. Install the power supply close to a power socket outlet using the supplied mounting bracket and fixing screws.

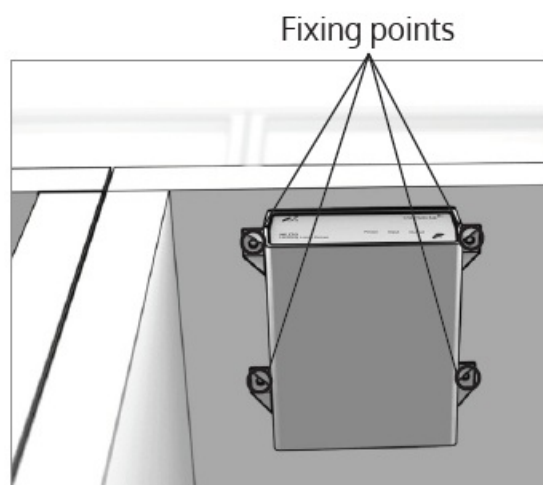

9. Connect all components by following the below:

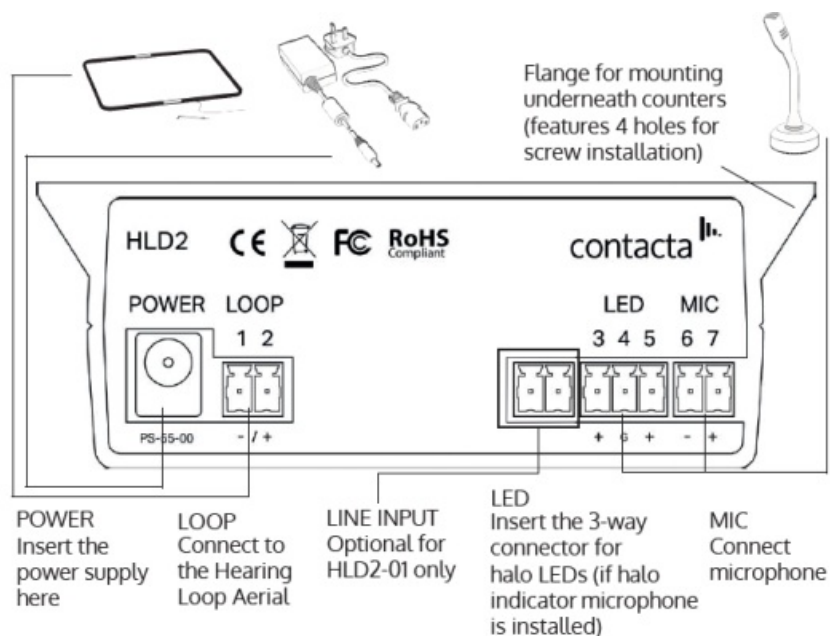

10. Route all the cables neatly to the driver using trunking or cable tacking as necessary.

Initial Set-Up

Once installed, volume adjustments are not required as the driver self-adjusts; the system is ready to operate. Please ensure you test the loop using one of our loop listeners.

The Loop Driver

The driver has no buttons on the front panel. Please see below an overview of the indicators on the front panel of the HLD2 driver.

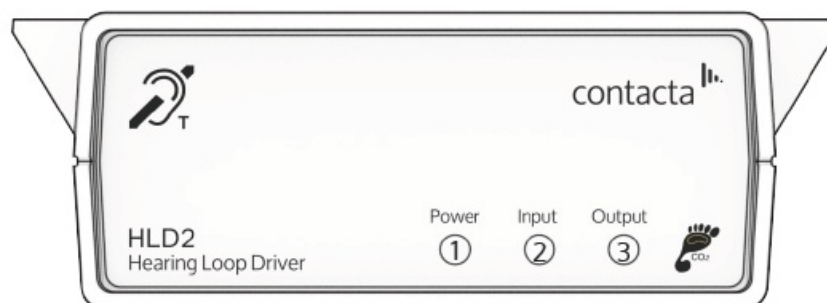

Firmware revision is indicated by the number of blinks on all LEDs after power-on. From revision four onwards, the Input LED and microphone halo indicator (if installed) no longer blinks during activity. In all revisions, the halo LED is solid green if both the microphone and loop are connected and working and solid red if either is faulty or disconnected.

Firmware revision four or newer:

1. Power LED:

It is a solid green when correctly powered.

Flashes green once every 25 seconds when in "Power Save" mode. Solid red when incorrect power supply connected.

2. Input LED:

Solid green when microphone is operating correctly.

Solid red if the microphone is faulty or no input is detected.

No indication for activity.

3. **Output LED:**

Solid green when loop output is functioning correctly. Solid red when loop is faulty/disconnected.

Older than firmware revision four:

1. **Power LED:**

It is a solid green when correctly powered.

Flashes green once every 25 seconds when in "Power Save" mode. Solid red when incorrect power supply connected.

2. **Input LED:**

Flashes green when microphone is operating correctly.

Solid red if the microphone is faulty or no input is detected.

3. **Output:**

Flashes green when loop output is functioning correctly.

Solid red when loop is faulty or disconnected.

Handy Tips

Removing Green Connectors

Each component comes fitted with two-way and three-way connection plugs located in the appropriate sockets at the rear of the driver. If wires require to pass through small apertures, the connection plugs may be removed temporarily.

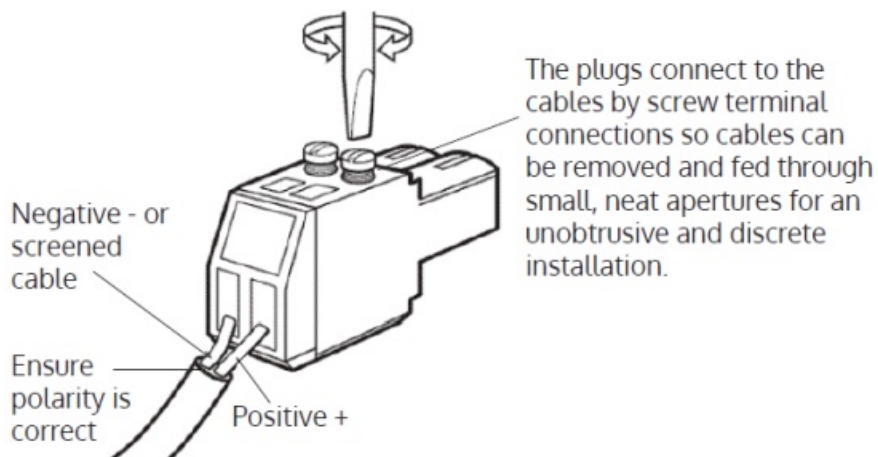

- The cables and plugs must be re-connected correctly, or the system will not operate. If in doubt, mark the wires before disconnecting the plug(s).
- If there is a suitable cable port on the cashier's side, the cables can be diverted through this without the need to remove and reconnect the two-way plugs.

Using the System

- Face the microphone and speak normally from your seated/standing position
- The speech is converted to an alternating magnetic field and transmitted via the loop aerial
- This is picked up by the telecoil in the customer's hearing device and converted back to speech

There's nothing more you need to do!

If the hearing device wearer doesn't pick up the signal:

- Draw their attention to the loop sign, checking their device is in the "T" position
- Ask the hearing device wearer to check the volume setting on their device
- Try moving closer to the microphone to achieve clearer voice pick-up
- Ask the hearing device wearer to move close to the loop sign

Things to Remember

- Ensure the microphone is positioned close to the member of staff on the desk or counter
- Make sure the loop sign is in a prominent position so those with a hearing device are clear as to where assistance is available

Maintenance

To prolong the life of the product, the following procedures should be carried out regularly, keeping the system at its optimal performance:

- Ensure all connectors are firmly inserted into their sockets regularly
- Do not stretch the microphone cable
- Clean the driver and the microphone with a dry soft cloth/cleansing wipes. Do not use solvent-based cleaners
- Do not allow cleaning fluids to enter the driver or back ports/vents of the microphone
- Regularly check that any loop listeners used to check the system are working correctly

Troubleshooting

Symptom	Possible Fault	Action
No power detected through amplifier	1) The power jack is not plugged in or faulty 2) The plug fuse has blown 3) Faulty power supply unit 4) Faulty amplifier	1) Check that the power jack is firmly plugged in 2) Put the unit to one side and seek further advice 3) Change the power supply unit 4) Contact your local dealer

POWER LED illuminated red	1) Faulty or incorrect power supply connected	1) Ensure the correct power supply is connected (PS-55-00) 2) Contact your local dealer if not
INPUT LED illuminated red	1) Faulty or incorrectly connected microphone	1) Check that the microphone is wired correctly in the green plug and connected to the "MICROPHONE" socket on the back of the HLD2 driver
OUTPUT LED illuminated red	1) Faulty or incorrectly connected loop aerial	1) Check loop aerial is connected to "LOOP" socket on back of HLD2 driver
Red LED illuminated on the microphone (if the halo indicator microphone is installed)	1) Constant red LED: Microphone fault 2) Red LED comes on after speech: Hearing loop aerial fault	1) Ensure the microphone is firmly plugged in 2) Check to make sure the hearing loop connector is firmly plugged in
No audio is heard through the hearing loop via a hearing aid or loop listener	1) Hearing loop disconnected 2) The microphone was disconnected	1) Check above for correct connections 2) Ensure the loop listener has a new set of batteries
Interference (buzzing/whistling/ hissing) is heard through the hearing loop	1) Unscreened or poorly earthed third-party equipment is being used nearby 2) Incorrect power supply being used	1) Switch off any third-party equipment to identify the source of interference 2) Ensure that our grounded power supply unit is being used (PS-55-00)
The unit does not go into power saving mode	1) The ambient noise in the area is too high	1) Switch off any air con systems, desktop fans, and or computers to reduce ambient noise

If you are still experiencing problems, please contact your local dealer.

Local dealer:

UK & ROW

- +44 (0) 1732 223900
- sales@contacta.co.uk

US & Canada

- +1 616 392 3400
- info@contactainc.com

www.contacta.co.uk

FAQs

- **Q: Do I need to adjust the volume after installation?**

A: No, the driver self-adjusts after installation. Volume adjustments are not required.

- **Q: How can I test the loop system?**

A: You can test the loop system using one of our loop listeners to ensure proper functionality.

Documents / Resources

	<p>contacta IL-K200 Under the Counter Loop System [pdf] User Guide</p> <p>IL-K200 Under the Counter Loop System, IL-K200, Under the Counter Loop System, Counter Loop System, Loop System</p>
--	---

References

- [Innovative assistive technology solutions | Contacta](#)
- [User Manual](#)

[Manuals](#), [Privacy Policy](#)

This website is an independent publication and is neither affiliated with nor endorsed by any of the trademark owners. The "Bluetooth®" word mark and logos are registered trademarks owned by Bluetooth SIG, Inc. The "Wi-Fi®" word mark and logos are registered trademarks owned by the Wi-Fi Alliance. Any use of these marks on this website does not imply any affiliation with or endorsement.