



[Home](#) » [CONOPU](#) » **CONOPU D020R2EC-12L Timer On Off Auto Humidification Instruction**

Manual 

CONOPU

DEHUMIDIFIER^o

Model: D020R2EC-12L

EU/UK



Contents [[hide](#)]

1 D020R2EC-12L Timer On Off Auto Humidification

2 ATTENTION

3 MAINTAIN AND STORAGE

4 OPERATIONAL ENVIRONMENT

5 STRUCTURE

6 THE INCLUDED ACCESSORIES

7 BEFORE USING

8 INSTALL THE CASTERS

9 SPECIFICATIONS

10 INSTRUCTION

11 CONTINUOUS DRAIN

12 CLEANING AND MAINTENANCE

13 TECHNICAL SPECIFICATIONS

14 TROUBLESHOOTING

15 WARRANTY

16 Documents / Resources

16.1 References

D020R2EC-12L Timer On Off Auto Humidification

This appliance can be used by children aged from 8 years and above and persons with reduced physical, sensory or mental capabilities or lack of experience and knowledge if they have been given supervision or instruction concerning use of the appliance in a safe way and understand the hazards involved. Children shall not play with the appliance. Cleaning and user maintenance shall not be made by children without supervision.

If the supply cord is damaged, it must be replaced by the manufacturer, its service agent or similarly qualified persons in order to avoid a hazard.

The appliance shall be installed in accordance with national wiring regulations.

Please use in an environment at 15-40°C and less than or equal to 90% humidity

Correct Disposal of this product



This marking indicates that this product should not be disposed with other household wastes throughout the EU. To prevent possible harm to the environment or human

health from uncontrolled waste disposal, recycle it responsibly to promote the sustainable reuse of material resources. To return your used device, please use the return and collection systems or contact the retailer where the product was purchased. They can take this product for environmental safe recycling.

ATTENTION

When using this machine for the first time, please leave it for 24 hours before powering it on. In order to avoid injury and unnecessary property damage to you and others, please read and observe the following “Safety Precautions” carefully before use. Safety precautions are divided into “Warning” and “Caution”, which are important for safe use and must be observed.

Warning:

Refers to matters that will result in death or significant injury if not handled properly.

Caution:

Refers to matters that will cause injury or property damage if not handled properly.

WARNING

May cause death or serious injury if used improperly Indicates the situations that may occur

CAUTION

May cause personal injury or property damage if used improperly Indicates matters requiring attention

Symbol Designation

 Prohibited matters.

 What must be implemented

WARNING

Use power plug & power cord properly

- Please clean the dust on the power plug regularly to avoid fire and electric shock due to poor insulation caused by dust accumulation.
- Be sure to plug the power supply to the end to avoid electric shock and fire due to short circuit.
- Be sure to pull out the power cord with the power plug in hand to avoid tugging and damage the power cord and cause electric shock and short circuit.





- Always remove the plug from the socket when the device is not used to avoid injury, burns, electric shock and fire due to aging of insulation.
- If any of the following abnormalities occur, please stop using it immediately, cut off the power supply and unplug it from the power outlet to avoid smoke, fire and electric shock.
 1. Burnt smell, abnormal running noise
 2. Power plug and power cord with abnormal heat.
 3. When moving the power cord, the power is intermittent
 4. Often stop suddenly in operation
 5. Numbness and electric shock when touching
- If the power cable is damaged, it must be replaced by the manufacturer, its service agent or a similarly qualified person to avoid danger
- Do not use broken power cords, power plugs and loose sockets to avoid electric shock and fire due to short circuit.
- Do not use the power cord in a bundle to avoid overheating, which may cause burns and fire. Be sure to extend the power cord for use.
- Do not damage or process the power cord, bend or stretch the power cord, or place heavy objects on the power cord to avoid fire and electric shock due to breakage of the power cord.



- Never insert sticks or other objects into the air outlet of the dehumidifier, otherwise the high-speed rotating blades will cause serious injury.
- Do not use the dehumidifier in a place where oil leakage or flammable gas may occur.
- Do not use the dehumidifier in places where chemicals are placed.
- To avoid fire or explosion, do not place flammable materials or chemicals near the dehumidifier.
- Be careful not to let the air from the dehumidifier blow on the heating equipment.
- To avoid electric shock, do not spray or wet the dehumidifier with water when cleaning.
- Be sure to unplug the power supply after stopping operation to avoid damage to the power cord plug and power outlet, which may result in a fire.





- When cleaning or maintenance is required, please turn off the power and unplug the power supply first. Please wait until the body is completely cooled down before cleaning and maintenance, to avoid burns from touching the high temperature body.

- Do not pour water on the body or immerse the body in water to avoid fire and electric shock.
-  Do not use the dehumidifier outdoors in direct sunlight or rain to avoid overheating, electric shock or fire.
- Do not place objects such as vases on top of the dehumidifier, if accidentally overturned, the moisture will enter the interior of the dehumidifier, which will deteriorate the electrical insulation and may cause leakage, electric shock, fire.
-  Do not plug or unplug the power supply with wet hands to avoid electric shock, burns and injuries.
-  Do not disassemble, repair or modify the machine by yourself to avoid fire, electric shock or fire.

CAUTION

- Place the machine on a flat and stable surface.
- Be sure to use a separate 220-240V power outlet to avoid fire.
- Do not remove the water tank floating box in the water tank.
- When moving the dehumidifier, please cut off the power first and pour off the water.
-  Children should be supervised to ensure that they do not play with the device.
- This product contains 45g of R290 refrigerant gas (Note: the refrigerant is odorless)
- Avoid fire or explosion caused by ignition of refrigerant by electric heaters, stoves or other sources of ignition.



CAUTION

- Do not lean on or step on the product to avoid injury, malfunction or breakage of this product.
-  To avoid icing, do not use the machine when the room temperature is below 5°C
- Do not block the air inlet and outlet of the dehumidifier, and do not drape wet objects on the body.
- Never use the dehumidifier for other purposes to avoid deterioration of product quality.
- Appliance is filled with flammable gas R290.
-  Before using the appliance, read the manual.

- Before installing the appliance, read the installation manual.
- Any repairs you need, contact the nearest authorized Service Centre and strictly follow manufacturer's instruction only.



WARNING:

- Appliance shall be installed, operated and stored in a room with a floor area larger than 4m².
-  Do not use means to accelerate the defrosting process or to clean, other than those recommended by the manufacturer.
- The appliance shall be stored in a room without continuously operating ignition sources (for example: open flames, an operating gas appliance or an operating electric heater).
-  Do not pierce or burn.
- Be aware that refrigerants do not have any odour.

MAINTAIN AND STORAGE

The appliance must be stored in a well ventilated area where the room of the same size as the designated place of use. Equipment should be stored in a room free from open flames (e.g., a device running gas) and ignition sources (e.g., electric heating operations) in a room. The machine should be stored in a place where it is protected from mechanical damage.

OPERATIONAL ENVIRONMENT

Your dehumidifier allows you to install and easily move it to the desired location. Always have at least 20cm of space around the product and place on a flat hard floor to reduce noise and vibration..

Important:

The air must be able to circulate freely, any obstruction that could cause the appliance to overheat. Make sure the dehumidifier is away from curtains.

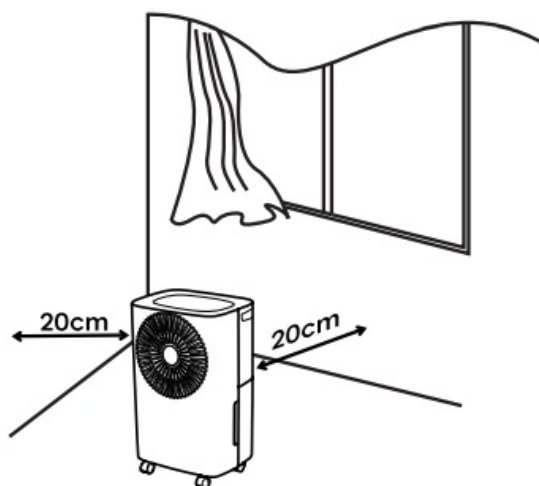

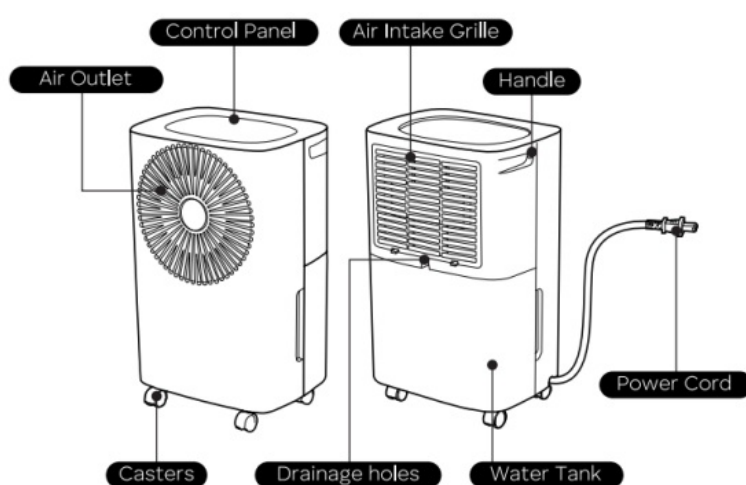

STRUCTURE



THE INCLUDED ACCESSORIES

Note: Some accessories are not in bucket, please find it in packing.

	Castors—4pcs
	Drain pipe (about 0.6m) -1 set

BEFORE USING

The 12L dehumidifier cabinet:

Before use, please remove the accessories from the bucket:

- Remove the securing tape and take out the water tank.
- Open the cover and take out the plug and other accessories.

Reinstall the cover and correctly place the bucket back into the appliance.

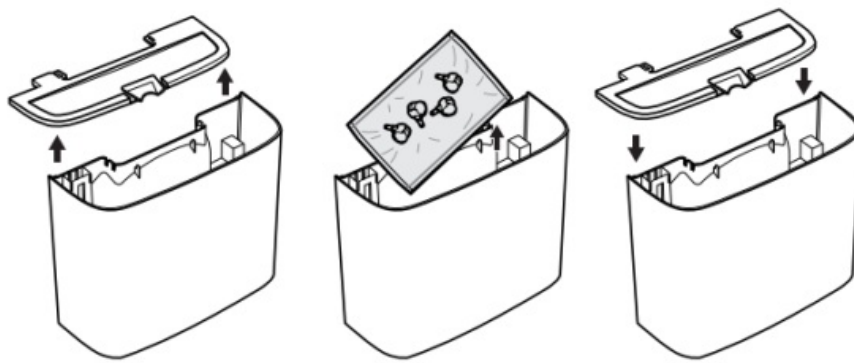

INSTALL THE CASTERS

1. Lay down the unit, remove the four rubber feet from the base and insert the casters into the holes as shown in pic 1. When you hear a “click” sound, it means the casters have been successfully installed.
2. After installing the casters, please let the dehumidifier stand upright for 24 hours (with the power off) before use. This is to allow the lubricating oil to flow back to the bottom of the compressor, ensuring compressor protection during machine operation. (pic 2)

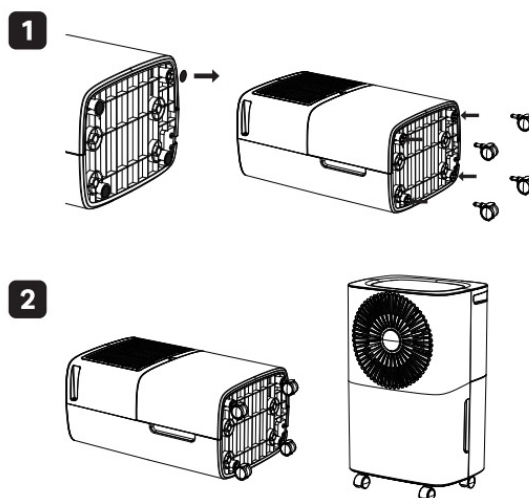

SPECIFICATIONS

Model: D020R2EC-12L	Power Supply: 220-240V~50Hz
Rated Power Input: 210W	Refrigerant / Charge Permissible Excessive: R290/45g

INSTRUCTION

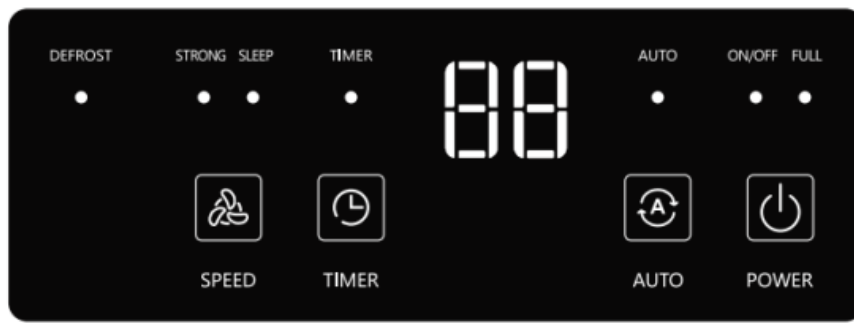

CHECK BEFORE TURNING ON THE APPLIANCE

1. Check if the power cord is under good condition.
2. The product adopts 220-240V AC power supply, before use, please confirm if the rated current of the power socket meets the local requirements with safe grounding device, otherwise, please replace it with the qualified socket.

Insert the plug into the socket and put the device into standby mode

Note:

1. the product built-in compressor, it is recommended to let the product stand for 24 hours before the first use (power off)
2. the compressor each stop, restart need to have 3 minutes interval, better maintenance of machine life

INSTRUCTION

1. POWER BUTTON” ⏻

Tap the power button, used to control the startup or shutdown of appliance.

2. AUTO BUTTON 🔄

Press the automatic button, the automatic dehumidification function of the product is enabled, and the target humidity can be set. The humidity setting range is: 40%-80%.

When the difference between the set humidity and the ambient humidity is more than 5%, the operation will be in high wind speed gear; when the difference is less than 5%, the operation will be in low wind speed gear

Note:

1. The set humidity is the target humidity. When the indoor humidity is lower than the set target humidity, the product cannot start dehumidification.
2. When the compressor stops working when the ambient humidity reaches the preset

humidity, the fan continues to work for a period of time to maintain the indoor humidity. If the ambient humidity does not rise after the compressor stops working for 3 minutes, the fan also stops working.

3. The most comfortable humidity range for human body is between 45% and 55%.

4. To disable the AUTO function, please press the”  “button.

3. **SPEED BUTTON**

Press the speed button to enable continuous dehumidification of the product and select the strong mode and sleep mode.

Strong Mode, the fan will work in the high speed.

Sleep Mode, the fan will work in the low speed.

4. **TIMER BUTTON**

Tap the timing button to set the timing period. The timing interval is 0-24h, with th as the interval. Hold down the timing button for 25 to quickly switch the timing period. Timing function is divided into scheduled startup and shutdown function; Scheduled boot:

The timing period can be set only when the product is powered on and not turned on. When the timing period expires, the product automatically starts to dehumidify.

Timed shutdown:

The timing period can be set only when the product is powered on. When the time expires, the product automatically shuts down and enters the standby mode.

5. **TANK FULL ALARM**

When the product detects that the water is full, the product will stop dehumidification, the indicator light will light up and emit 5 “beep” alarm sounds to remind consumers that the water tank is full and they need to pour water.

6. **WATER TANK PUMPING OFF POWER PROTECTION**

When the product is in the working state, the machine will automatically stop working for protection when the water tank is detected to be pulled away.

If the product is in standby state and the water tank is not installed properly or not installed, the alarm will be sounded and the product cannot be started.

7. **MEMORY FUNCTION**

The system will remember the set humidity and wind speed. If the power is suddenly cut off and then turned on again, it will run based on the latest status prior to power off. If you turn off the machine and unplug it, it will runs based on factory default when power on again.

8. DEFROST PROTECTION

When the coil is completely defrosted, the compressor will restart automatically and dehumidification will resume.

When the ambient temperature is higher than 5° C, the compressor works normally. However, in order to protect the service life of the compressor, the compressor will stop for a few minutes after working for a period of time, which is normal.

CONTINUOUS DRAIN

There is a continuous drainage interface on the back of the product, connecting one end of the free drainage pipe to the drainage port, as shown in the pic 1;

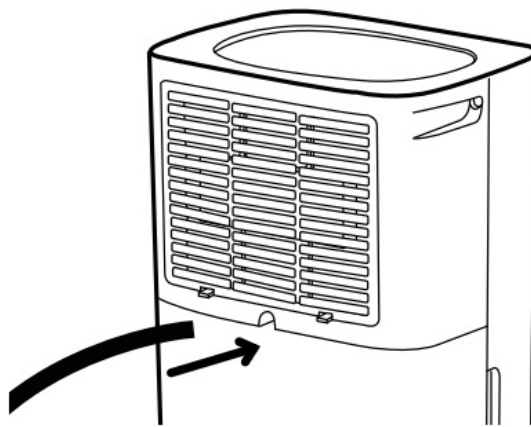

Pic.1

Once installed in place, the dehumidified water will not go through the tank, but directly through the drainage pipe.

Note: If continuous drain is not required, please pull the drainage pipe out of the drainage port(see pic.2), then the water will flow into bucket.

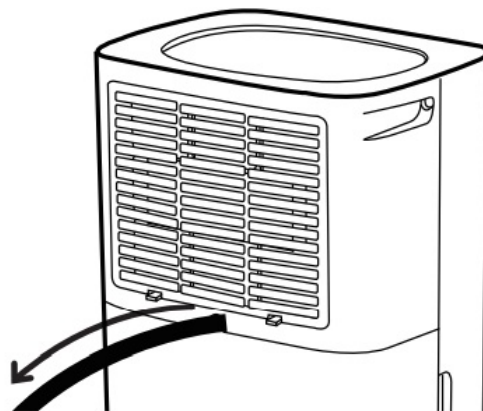

Pic.2

Note: Please install the drain pipe following below picture. Please install the drain pipe correctly, or the water cannot drain from the pipe(see pic.3).

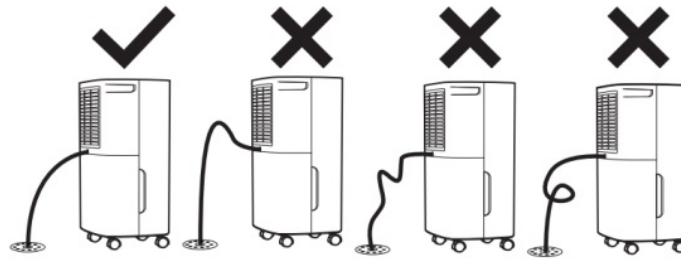

Pic.3

Note:

If the unit is placed on the uneven ground or the drain pipe is not installed correctly, the water will fill the whole bucket and stop running. If that happens, please check whether the ground is flat, and the drain pipe is installed correctly. At the same time, the bucket need to be installed correctly.

NOTE

1. Do not remove the float from the water tank. The water tank full sensor will no longer be able to correctly detect the water level without the float and water will leak from the tank.
2. When replacing the water tank, press the water tank firmly into place with both hands. If the tank is not positioned correctly, the “TANK FULL” sensor will be activated (the indicator lights on) and the dehumidifier will not work.

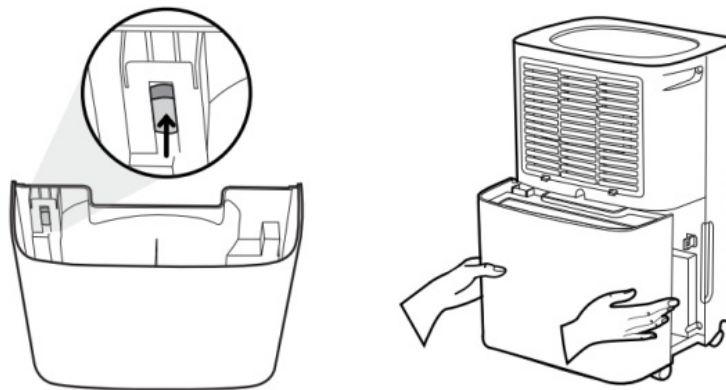

CLEANING AND MAINTENANCE

PRODUCT MAINTENANCE

For all maintenance and cleaning operations, it is **MANDATORY** to unplug the appliance for safety reasons.

Do not use chemicals or detergents for cleaning, which could easily damage or deform your device. Clean the dehumidifier with a slightly damp cloth, and dry it.

AIR FILTER MAINTENANCE

For best efficiency, the air filter should be cleaned after 100 hours of use.

To clean it:

1. Stop the appliance and remove the air filter, regularly use a vacuum cleaner to remove dust.
2. Clean and reinstall the air filter: in case of obvious dirt, wash the filter in lukewarm soapy water, rinse it and dry it before replacing it in its compartment.

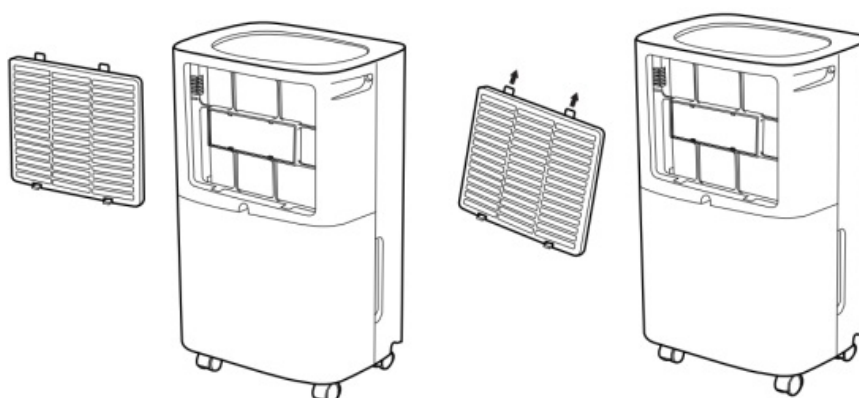

MAINTENANCE AFTER USE

If you do not plan to use the device for an extended period:

1. Drain the water from the tank.
2. Clean the air filter.
3. Store in a cool, dry place.

TECHNICAL SPECIFICATIONS

The dehumidification capacity corresponds to an ambient temperature of 30°C with a relative humidity of 80%.

The operating temperature is between 7°C and 35°C and a maximum relative humidity of 80%. If the ambient temperature is outside this range, the device will not operate normally.

When the unit is operating in a room with an ambient temperature between 5°C and 12°C, the dehumidifier will stop and start defrosting every 30 minutes. If the ambient temperature is below between 12°C and 20°C, the dehumidifier will stop and defrost every 45 minutes.

TROUBLESHOOTING

The following cases are not always malfunctions. Check before contacting the after-sales service.

Troubleshooting and repair

Do not repair or disassemble the dehumidifier by yourself. Any unqualified repair will result in device failure and may damage users or their properties.

Problems	Reasons	Solutions
The dehumidifier does not work	The dehumidifier does not turn on.	-The plug is not plugged in correctly. -The circuit breaker or fuse is blown.
	The full water tank indicator flashes. (Tank full or tank incorrectly replaced)	Drain the water from the tank and reposition the tank properly.
	The ambient temperature is too low or too high.	It is recommended to use the machine at the temperature of 7-35°C
The dehumidifying effect is insufficient or there is no air outlet	Doors or windows are open	Close doors and windows. Check that the filter is not dirty
	The filter is dirty.	Clean the filter.
	The air inlet or outlet is blocked.	Clear any obstructions.
Loud background noise	The device is not placed on a level surface.	Place the dehumidifier on a level floor and a carpet (to reduce noise).

WARRANTY

We appreciate your feedback and will do our best guarantee your satisfaction.

Within 1 year after your purchase, shall the product has defects, we will provide a refund or resend you a new one. Please email us with your concern and order number. Your inquiries will be taken care of as soon as possible.

This warranty only cover orders from authorized brand online stores and our official

website. We are not responsible for any purchases from other distribution channels.

Manufacturer: Dongguan JHS Electrical Co.. Ltd

Manufacturer adress: Dongping Avenue, No. 3 industrial Park, Changping Area,
Dongguan Eastern Industrial District, Dongguan City, 523558 Guangdong,P.R.China

Documents / Resources

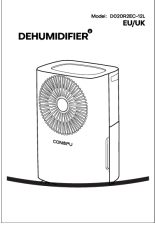
	<p>CONOPU D020R2EC-12L Timer On Off Auto Humidification [pdf] Instructi on Manual</p> <p>D020R2EC-12L Timer On Off Auto Humidification, D020R2EC-12L, Timer On Off Auto Humidification, Off Auto Humidification, Auto Humidification</p>
---	--

References

- [User Manual](#)

CONOPU

Auto Humidification, CONOPU, D020R2EC-12L, D020R2EC-12L Timer On Off Auto Humidification, Off Auto Humidification, Timer On Off Auto Humidification

Leave a comment

Your email address will not be published. Required fields are marked *

Comment *

Name

Email

Website

☐ Save my name, email, and website in this browser for the next time I comment.

Post Comment

Search:

e.g. whirlpool wrf535swhz

Search

[Manuals+](#) | [Upload](#) | [Deep Search](#) | [Privacy Policy](#) | [@manuals.plus](#) | [YouTube](#)

This website is an independent publication and is neither affiliated with nor endorsed by any of the trademark owners. The "Bluetooth®" word mark and logos are registered trademarks owned by Bluetooth SIG, Inc. The "Wi-Fi®" word mark and logos are registered trademarks owned by the Wi-Fi Alliance. Any use of these marks on this website does not imply any affiliation with or endorsement.