



connex CONNECT Google Home Smart Speaker Through Google Assistant User Guide

[Home](#) » [connex CONNECT](#) » connex CONNECT Google Home Smart Speaker Through Google Assistant User Guide 



SMART TECH
Quick Start Guide for
GOOGLE ASSISTANT



To control your Connex Connect smart bulbs or plugs, just say “Hey, Google” then ask a question.

Examples of Google Assistant questions:

“Hey, Google, how’s the weather today?”
“Hey, Google, switch off bedroom light”
“Hey, Google, switch on the fan.”
“Hey, Google, set lounge light to red.”
“Hey, Google, switch on TV.”

Ensure your Google Home Smart Speaker is connected and set up on your home network, then follow these steps.

Step 1: Open Google Home Step App and Select the “” icon.

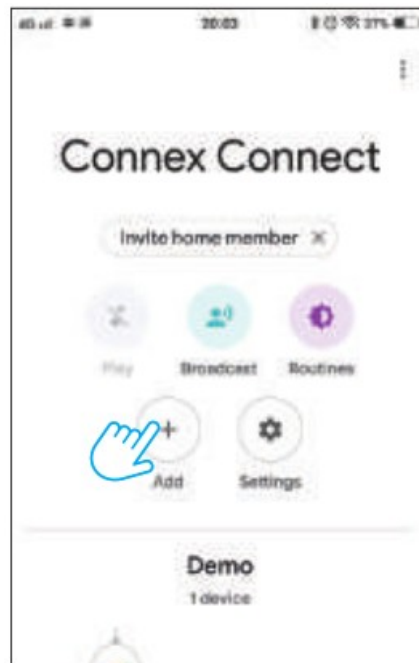

Step 2: Select “Set Up Device”. Select “Works with Google”.

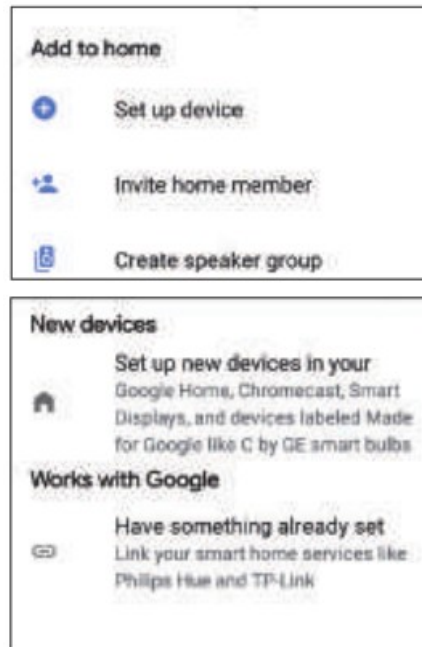

Step 3: Select “Smart Life” from the Home Control partner list.



Step 4: Authorize your account with Google Assistant using your Connex Connect App username and password.

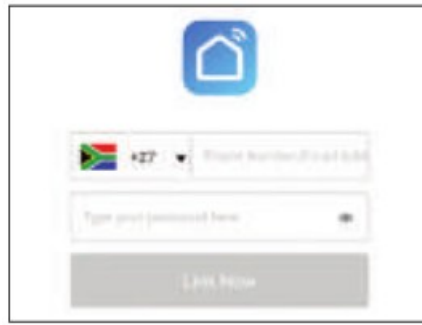

Your Connex Connect devices are now linked to your Google Home Speaker. You can now say “Hey, Google” to control your compatible Connex Connect devices.

Additional Information

Ensure that your Connex Connect Smart Home devices and Google Home are on the same 2.4 GHz Wi-Fi network, so that they can talk to each other.

You can rename your devices in the Connex Connect App and Google Assistant will refer to them by the same name. Please keep the names short SO as not to confuse Google Assistant.

You can rename and assign groups by room e.g. all the bulbs in your lounge can be grouped into “Lounge Lights”.

You can either use Google Voice Assistant, Connex Connect or Google Home Apps to manage via your mobile.

More detailed descriptions of Google Assistant functionality can be found at <https://assistant.google.com> or <https://connexconnect.com>



SMART TECH Quick Start Guide for AMAZON ALEXA



To control your Connex Connect smart bulbs or plugs, just ask Alexa.

Examples of Alexa questions:

“Alexa, how’s the weather today?”

“Alexa, switch off bedroom light”

“Alexa, switch on the fan”

“Alexa, set lounge light to red.”

“Alexa, switch on TV.”

Ensure your Amazon Alex Smart Speaker is connected and set up on your home network, then follow these steps.

Step 1: Open Alexa App and select the “Skills” tab in the menu.

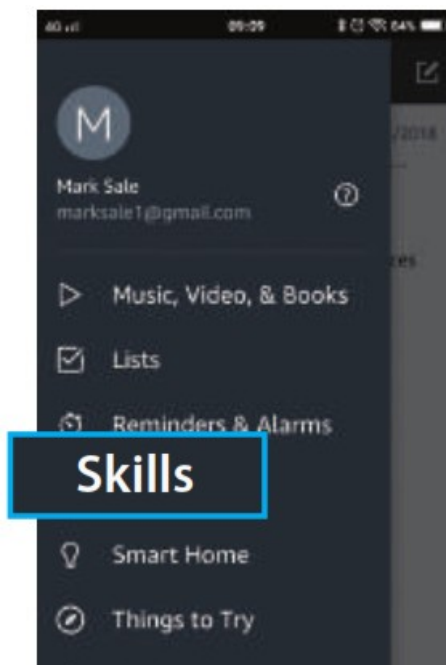

Step 2: Search for “Smart Life” Skill, then select “Enable”

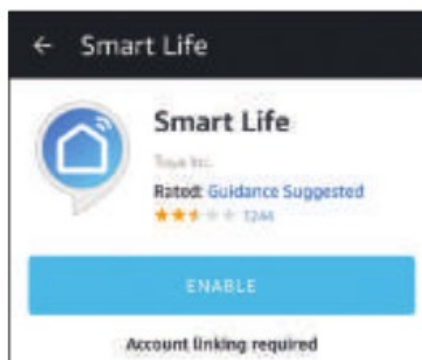
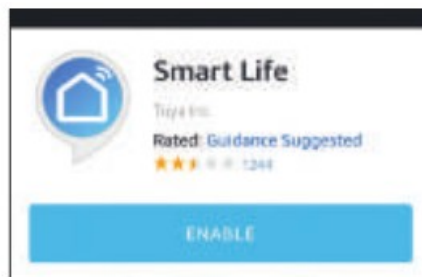

Step 3: Authorize your account with Alexa Smart Home Skills using your Connex Connect App username and password.

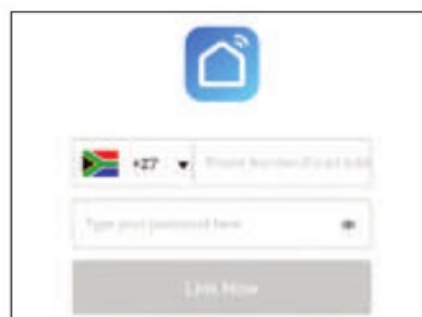

Step 4: Select “Discover Devices”. Your Connex Connect devices will be displayed under Smart Home in the Alexa App.

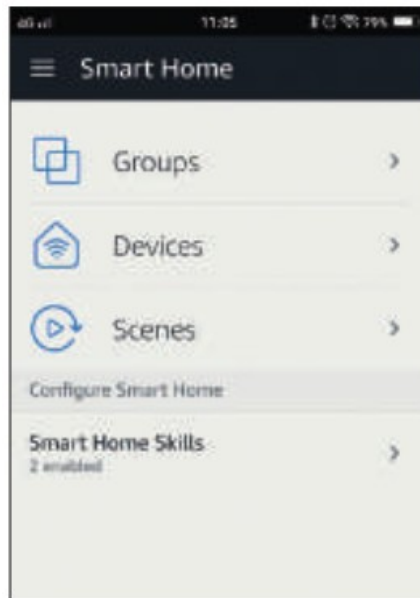

Your Connex Connect devices are now linked to your Alexa Speaker. You can now say “Alexa” to control your compatible Connex Connect devices.

Additional Information

Ensure that your Connex Connect Smart Home devices and Alexa Speaker are on the same 2.4 GHz Wi-Fi network, so that they can talk to each other.

You can rename your devices in the Connex Connect App and Alexa Smart Home will refer to them by the same name. Please keep the names short so as not to confuse Alexa.

You can rename and assign groups by room e.g. all the bulbs in your lounge can be grouped into “Lounge Lights”.

You can either use Amazon Alexa, Connex Connect or Alexa Smart Home Skills to manage via your mobile.

More detailed descriptions of Amazon Alexa functionality can be found at <https://connexconnect.com>

Contents

[1 Documents /](#)

[Resources](#)

[2 Related Posts](#)

Documents / Resources

	connex CONNECT Google Home Smart Speaker Through Google Assistant [pdf] User Guide Google Home Smart Speaker Through Google Assistant
---	--