



# connex CONNECT CC-C1003 Smart WiFi Camera User Manual

[Home](#) » [connex CONNECT](#) » connex CONNECT CC-C1003 Smart WiFi Camera User Manual 

## Contents

- [1 connex CONNECT CC-C1003 Smart WiFi Camera](#)
- [2 Description of Parts](#)
- [3 What's in the Box](#)
- [4 Specifications](#)
- [5 CE Certification](#)
- [6 Important Information](#)
- [7 Cleaning & Care Instructions](#)
- [8 Documents / Resources](#)
  - [8.1 References](#)
- [9 Related Posts](#)



**connex CONNECT CC-C1003 Smart WiFi Camera**



## Description of Parts

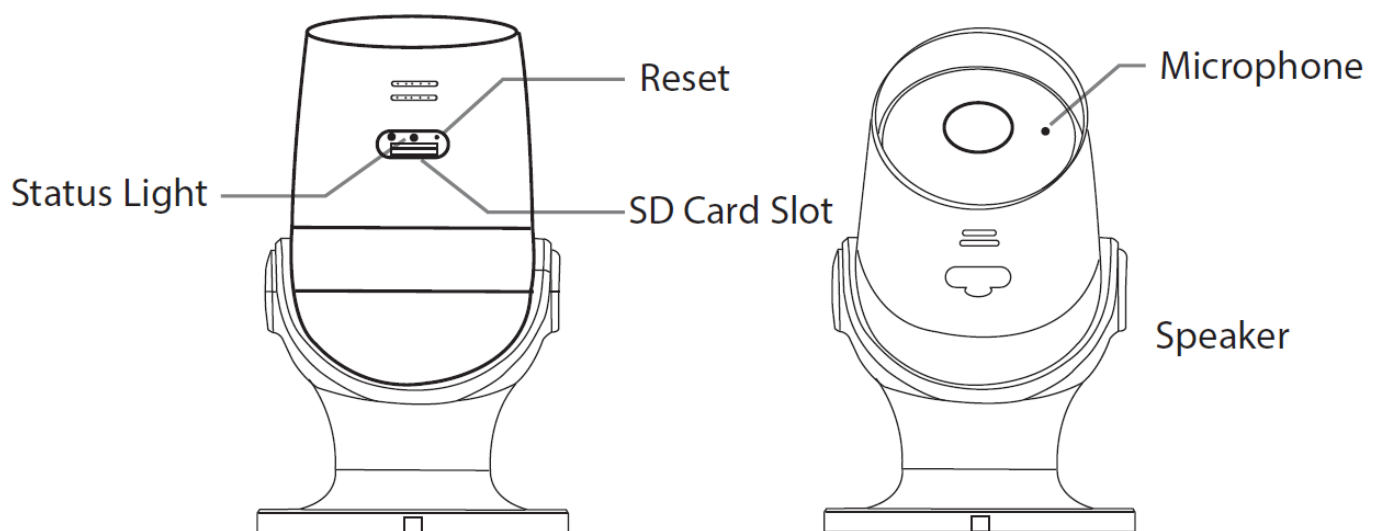

## What's in the Box



- Smart Wi-Fi 1080P Bullet Outdoor IP Camera
- Power Adapter
- USB Cable
- Bracket
- Adhesive Tape
- 3 x Screws
- User Manual

## Requirements

- Make sure you are connecting to a 2.4 GHz Wi-Fi network.
- Connex Connect won't work on a 5 GHz Wi-Fi network.
- Have your Wi-Fi network name and password ready.
- Make sure your mobile device is running iOS® 8 or higher or Android TM 4.1 or higher.

## Video Storage and Memory

4G		16G	32G	64G	128G					
1080P HD Recording	0.6 Days	2.4 Days	4.8 Days	9.7 Days	19.4 Days					
					4G		16G	32G	64G	128G
					1080P HD Recording	0.6 Days	2.4 Days	4.8 Days	9.7 Days	19.4 Days

**Step 1** from Google Play or iOS store.



Connex  
Connect



**Get the App!**



**Step 2** Connex Connect App

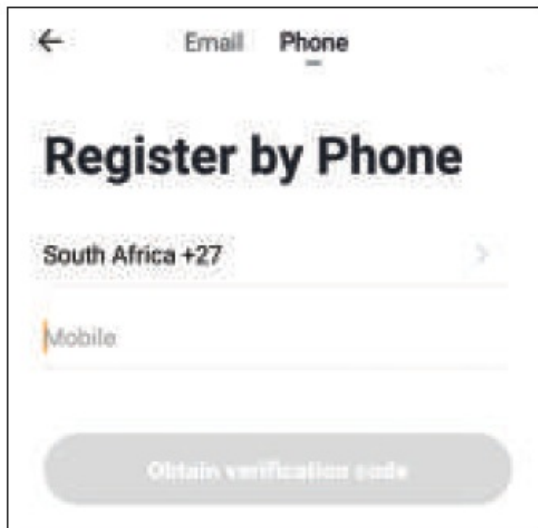

← Email Phone

## Register by Phone

South Africa +27 >

Mobile

Obtain verification code

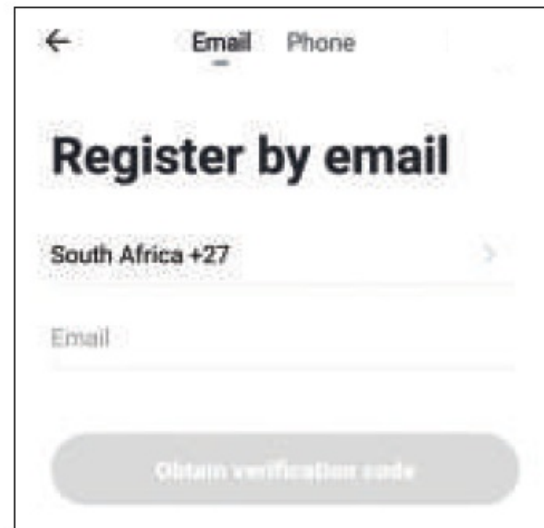

← Email Phone

## Register by email

South Africa +27 >

Email

Obtain verification code

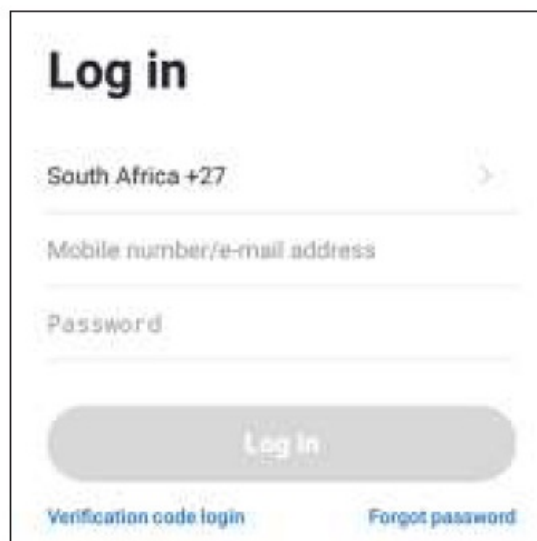

## Log in

South Africa +27 >

Mobile number/e-mail address

Password

Log in

[Verification code login](#) [Forgot password](#)

### Step 3 Plug In and Connect

Plug in the Connex Connect Camera and power it on. (The LED will flash repeatedly, 2 x per second: Easy Mode)

### How to Reset the Device

- Reset the Camera by using the “Reset” tool provided, to gently push the reset button, positioned underneath the Waterproof Bung, as shown on “What’s in the Box Page”

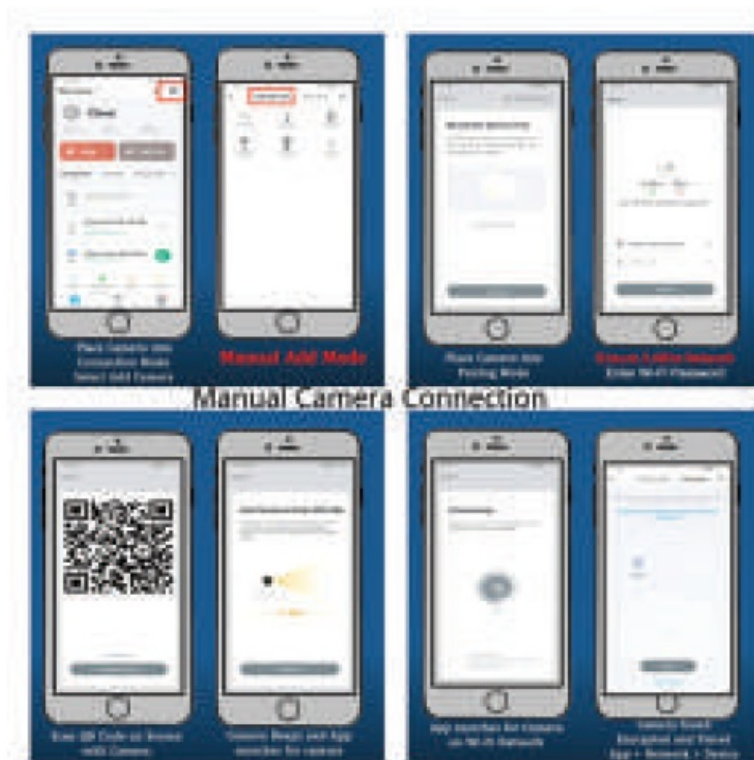

#### Step 4 Connection Mode

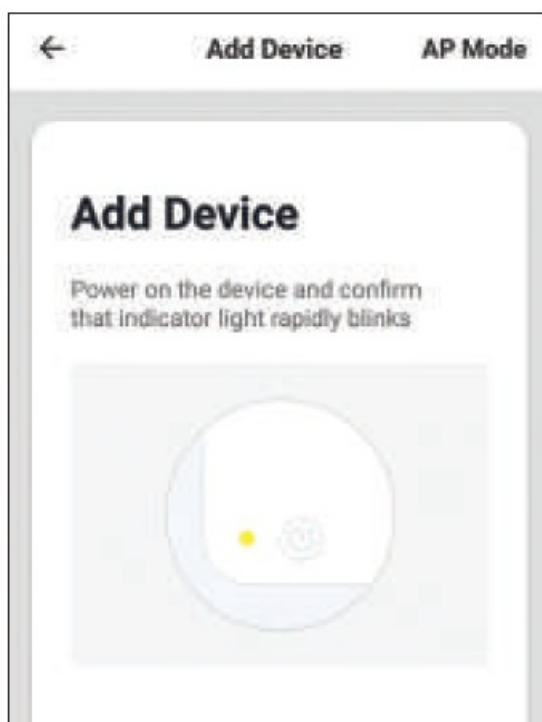

Make sure the LED is flashing RED rapidly indicating "ready to connect".

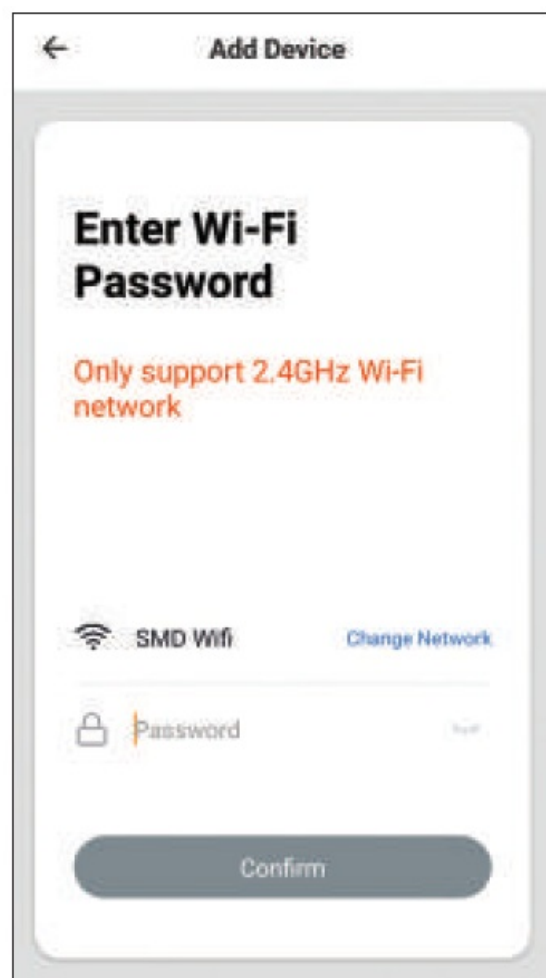

Enter your Wi-Fi network and password.

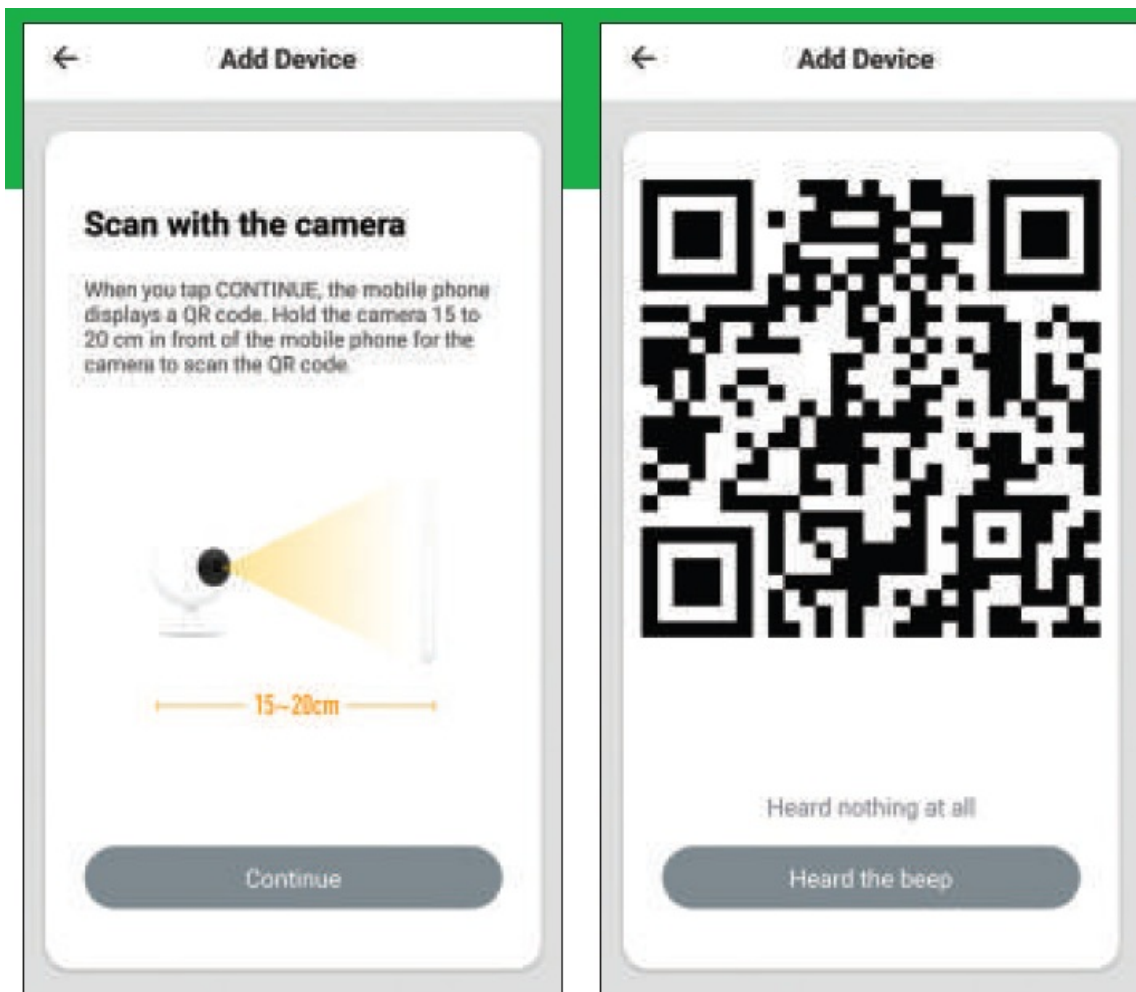

- The Connex Connect App will generate a QR Code that identifies your camera.
- Position the QR Code on your mobile, 15 – 20 cm from the camera, until you hear the camera beep.

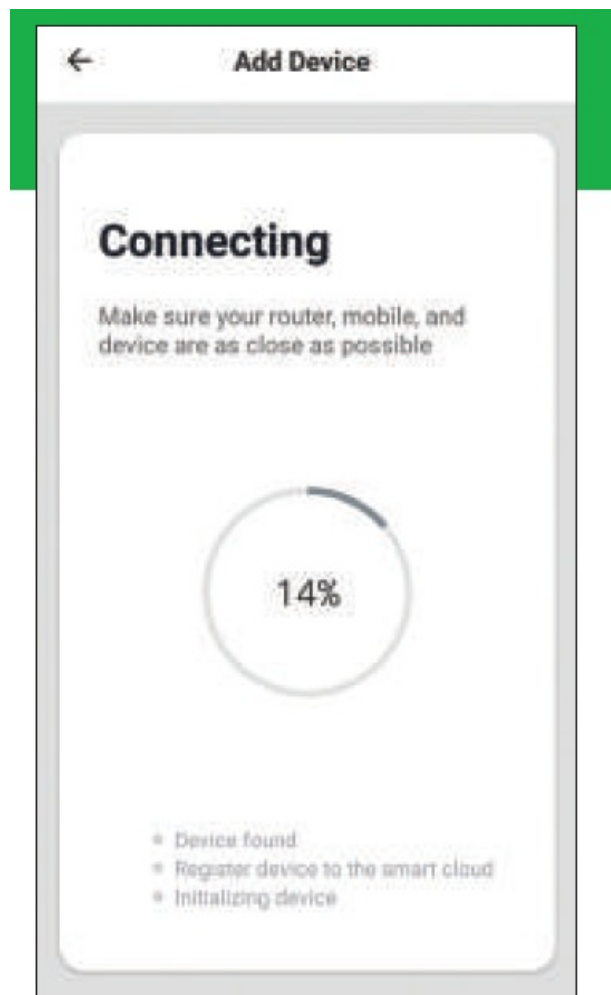

- The Connex Connect App will connect to your device and the LED light will turn BLUE.

## Specifications

- App:
- Frame Rate :
- Image Settings:
- Audio:
- Storage:
- Communication Protocol:
- Connectivity:
- Wi-Fi Security:
- Data Security:
- Working Temperature :
- Power Consumption:
- Maximum Picture Size:
- Rated Input Power:
- Camera Resolution:
- Bit Rate:
- Sensor Type:
- Pixels
- Lens:



- Shutter:
- IR:
- Waterproof:
- Connex Connect
- 25 Per Second
- Supports HD, SD & Mirror
- 2-Way Audio
- Supports SD Card (Max. 128 GB) Requires Class 10 SD
- HTTP, DHCP, DNS, RTSP
- Wi-Fi 802.11bgn 2.4 GHz (Wi-Fi 4) WPA – PSK, WPA2 – PSK
- AES 128
- -20 °C to 55 °C / – 68 °F to 131 °F 2.5 W Maximum
- 5 V DC, 1 A
- 1080 px
- 23 Kbps – 2 Mbps
- 1/3" CMOS
- 2 Mp
- 4 mm F2.0
- 1/25 – 1/100 000 per second 10 m high power LED with ICR IP651920 x 1080 px

## FAQ's

### 1. How many devices can I control?

Connex Connect App can control unlimited number of devices and locations. Your router has a limit as to how many devices can connect to it.

### 2. How do I group multiple Connex Connect devices?

You can group multiple similar devices together by room or by location. The same device can form part of multiple groups. From the Connex Connect App main screen, select the device you want to group. Select edit in top right corner. Then select "Create Group". You can then select devices which you would like to group and will be able to rename them.

### 3. How do I share devices with family and friends?

You can share devices by selecting the "Me" icon Home Management Add Family. In order to share a family member needs to have downloaded the Connex Connect App and registered.

### 4. What is the wireless range?

The range of your Wi-Fi is dependent on your home router specifications and the strength of your Wi-Fi signal.

### 5. Why does the camera appear off-line?

1. Ensure the camera is powered on (RED LED ON).
2. Make sure your Wi-Fi router is on and in range (your Connex Connect Smart device requires a Wi-Fi signal to function correctly).

### 6. Why can't I connect to my Wi-Fi?

1. Ensure your device and your mobile are on the same home network.
2. Make sure you entered the correct Wi-Fi password during set-up.
3. Ensure your Wi-Fi signal strength extends to your device location.

## System Requirements

- Mobile device running iOS® 8 or higher or Android TM 4.1 or higher.
- An existing 2.4 GHz Wi-Fi network.

## CE Certification

This device complies with CE Radio Equipment Directive [RED] 2014/53/EU & Restriction of Hazardous RoHS Directive 2011/65/EU. Operation is subject to the following two conditions: (1) This device may not cause harmful interference, and (2) This device must accept any interference received, including interference that may cause undesired operation.

## Important Information

Before connecting a camera, please read and follow all instructions, including the following.

**CAUTION:** Risk of electric shock or burns and use in a dry location only.

Do not install the device with wet hands or when standing on a wet or damp surface. Suitable for use in an operating environment between -20 °C and 40 °C (-4 °F and 104 °F). The camera has no serviceable parts.

## Cleaning & Care Instructions

- Before Cleaning: Ensure that your Connex Connect camera is not plugged into any device before cleaning or maintaining it.
- Cleaning: Wipe down the surface of your Connex Connect camera using a soft, slightly damp cloth.
- Do not use any harsh or abrasive cleaning chemicals or materials on your Connex Connect camera as doing so may damage or scratch the surface finish.
- Do not expose your Connex Connect camera to high temperatures for extended periods of time.
- Do not store in temperatures over 60 °C / 140 °F.

## Environmentally Friendly Disposal

Do not dispose of electrical appliances as unsorted municipal waste, use separate collection facilities. Contact your local government for information regarding the collection systems available. If electrical appliances are disposed of in landfills or dumps, hazardous substances can leak into the groundwater and get into the food chain, damaging your health and well-being.

## Support

Please visit us at [www.connexconnect.com](http://www.connexconnect.com) for answers to common issues and to see the full selection of products. If you still have any queries contact us at [info@connexconnect.com](mailto:info@connexconnect.com)

The illustrated product and specifications may differ slightly from those supplied. Connex is a trademark of SMD Technologies (Pty) Ltd. iPhone, Apple and the Apple logo are trademarks of Apple Inc., registered in the U.S. and other countries. App Store is a service mark of Apple Inc. Android Google Assistant, Google Play, and the Google Play logo are trademarks of Google Inc. Google is a trademark of Google LLC. iOS is a registered trademark of Cisco in the U.S. and other countries and is used under license. Amazon, Alexa and all related logos are trademarks of Amazon.com, Inc or its affiliates. All other trademarks and trade names are those of their respective owners. ©2021 Connex Connect (Pty) Ltd 23 Nguni Drive, Long Meadow Business Estate West, Modderfontien, Johannesburg, South Africa, 1609.

## Warranty

This Connex Connect Smart Wi-Fi Camera includes a standard 12-month limited warranty against manufacturing defects and faults. Should your product be unboxed with any faulty parts, poor finishing or visible damage, or fail to perform due to a manufacturing defect or poor workmanship, please return it with your proof of purchase (till slip or invoice) to the store of purchase for an exchange, or repair, depending on the store's returns policy. This warranty commences from the date of purchase. Kindly retain your proof of purchase as well as the packaging for your warranty period.

**NOTE:** The Warranty does not apply to a Product that:

- Has failed due to excessive wear and tear beyond what is considered to be reasonable.
- Has been misused or neglected.
- Has been damaged accidentally or by Force Majeure including fire and flooding.
- Has been used or operated contrary to operating or maintenance instructions outlined in this manual.

The Store of Purchase / Seller cannot accept any returned products that have not been returned in accordance to this warranty or which does not follow their own Returns Policy. Please refer to the Store of Purchase / Sellers Returns Policy for details. Should you require any further assistance or have any questions on your warranty, please contact the store of purchase.

## Documents / Resources

	<a href="#">connex CONNECT CC-C1003 Smart WiFi Camera</a> [pdf] User Manual CC-C1003, Smart WiFi Camera
--	--

## References

- [a Amazon.com. Spend less. Smile more.](#)
- [Control at your Finger Tips - Connex Connect](#)