

Conforama LATT44 Table with Extension Instruction Manual

Contents

1 LATT44

1.1 Assembling instruction

1.1.1 Service

1.1.1.1 GUIDELINES FOR FURNITURE CARE

2 Documents / Resources

2.1 References

3 Related Posts

LATT44



Assembling instruction

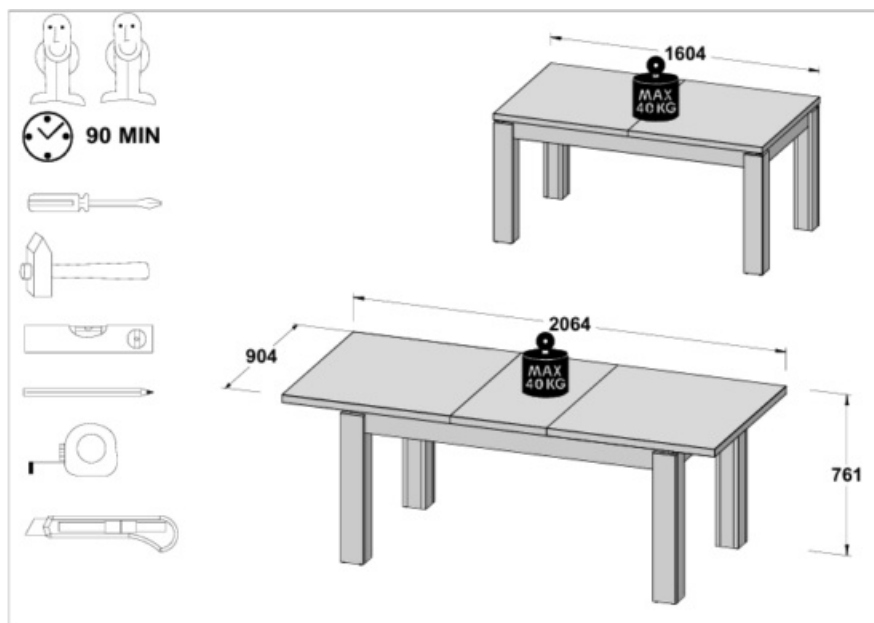

Follow the manufacturer's assembly instructions, otherwise danger may occur.

2024-02-22

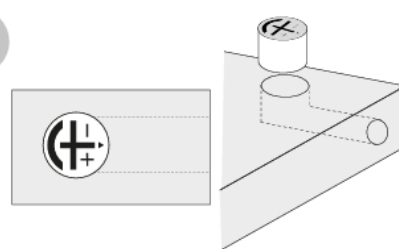
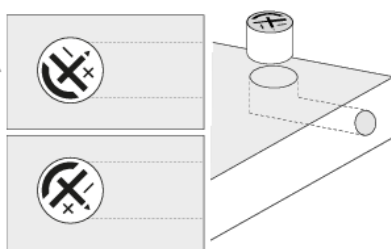
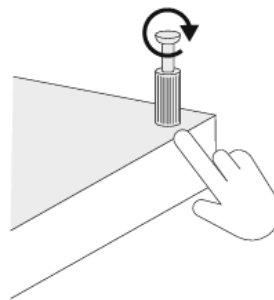
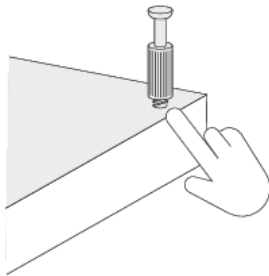
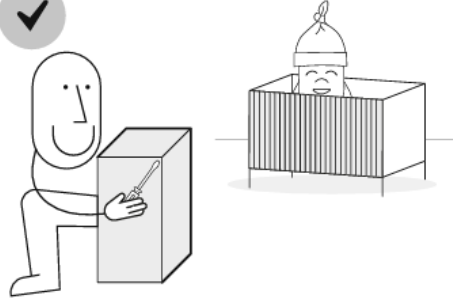
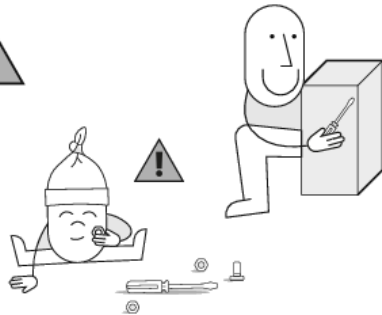
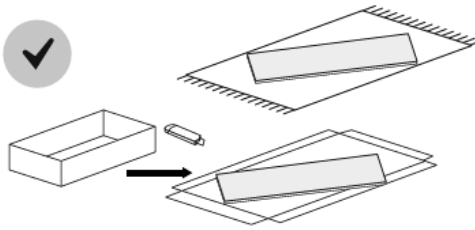
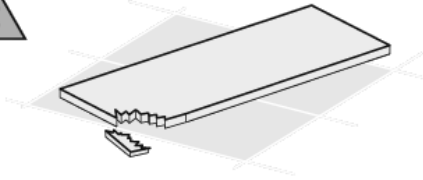
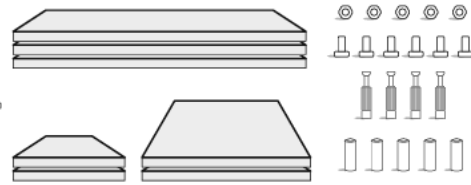
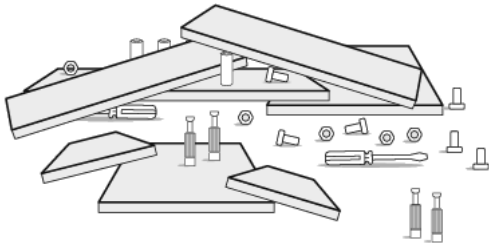
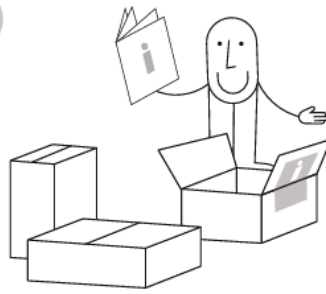
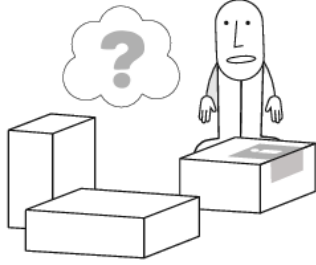

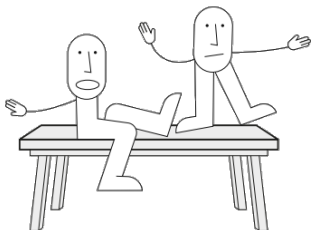
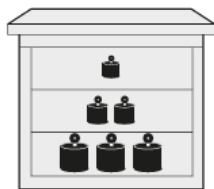
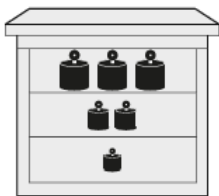
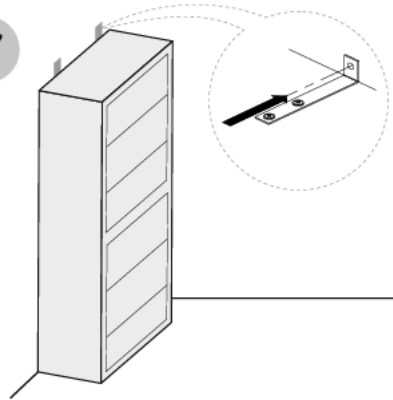
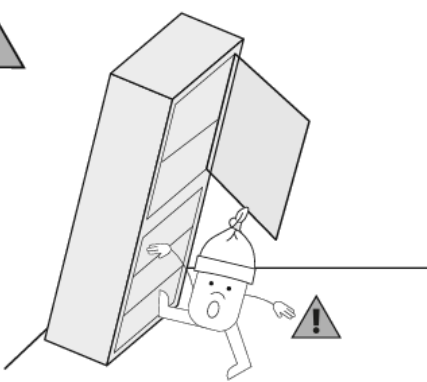
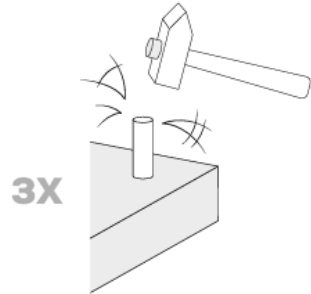
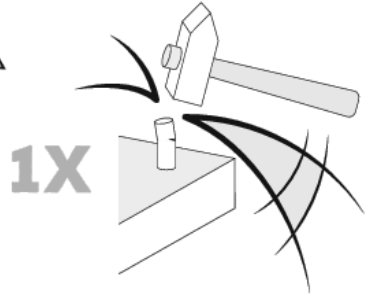
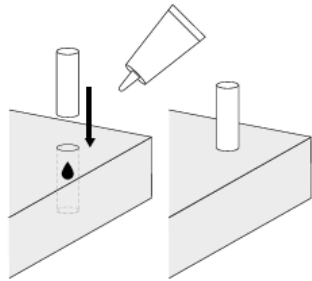
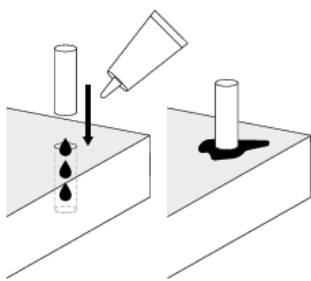

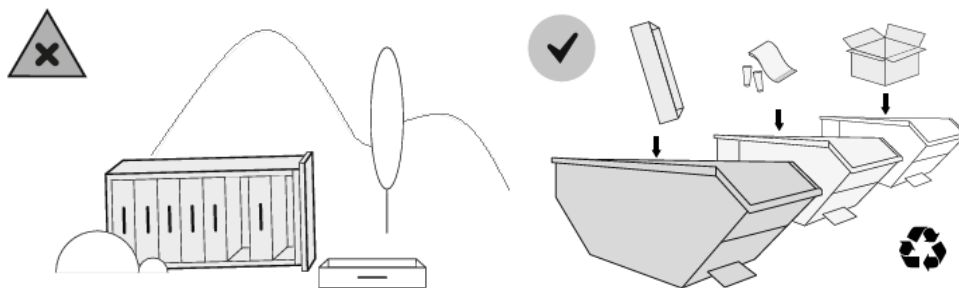

Furniture containing wood-based panels (particle board, fibreboard, plywood etc.) may emit into indoor air inconsiderable amounts of substances used in the production processes. The level of this emission is examined and it meets the applicable standards. After assembling the furniture, it is advised to regularly ventilate the room where the furniture stands, which should last about four weeks or until the smell is eliminated.

Service

| | | |
|------|--|--|
| Name | | |
| № | | |
| Typ | | |
| | | |
| | | |

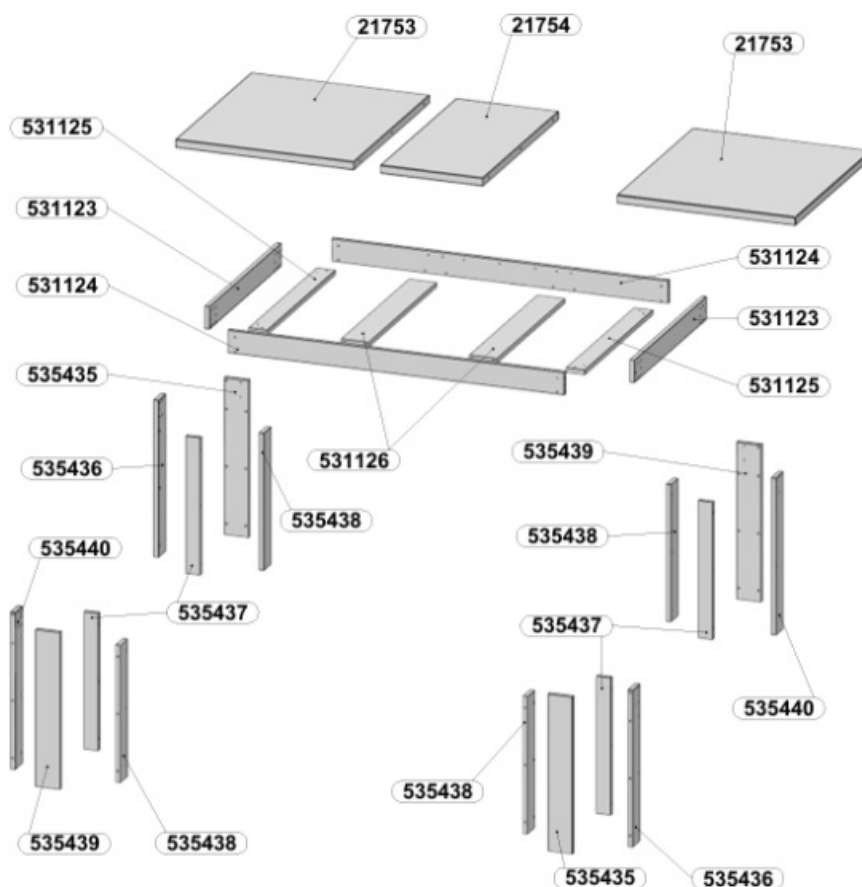

| Code | DIMENSIONS | Colli -0001 | Colli -0002 |
|--------|-------------|----------------|----------------|
| 21753 | 904x802x38 | 2 | |
| 21754 | 904x460x38 | 1 | |
| 531124 | 1511x102x22 | | 2 |
| 531123 | 856x102x22 | | 2 |
| 531125 | 812x85x22 | | 2 |
| 531126 | 812x125x22 | | 2 |
| 535435 | 702x110x22 | | 2 |
| 535436 | 702x88x22 | | 2 |
| 535437 | 614x65x22 | | 4 |
| 535438 | 614x88x22 | | 4 |
| 535439 | 702x110x22 | | 2 |
| 535440 | 702x88x22 | | 2 |

| | | | |
|--|--|--|---|
| 68x S70972 Ø8x36  | 8x S30211  | 8x S30205 Ø15x16  | 8x S32604 Ø4,5x16  |
| 28x S30102 Ø6,3x13  | 20x S33012 Ø6,4x40  | 8x S39256  | 12x S30558  |
| 6x S37089  | 6x S37088  | 4x SF30440  | 1x S30066  |
| 1x S30577  | 3x S20553N  | 8x S30098 Ø4.5x60  | 4x S32287 Ø7x75  |
| 2x S37062-N  | | | |

2x

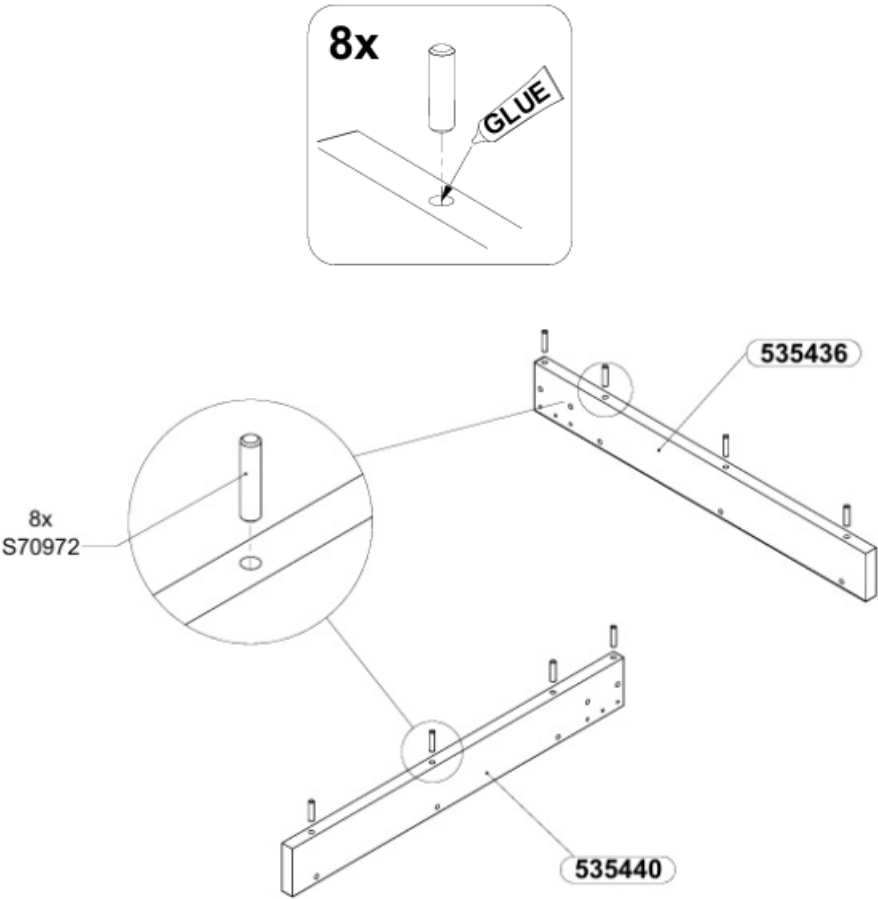

2

4x

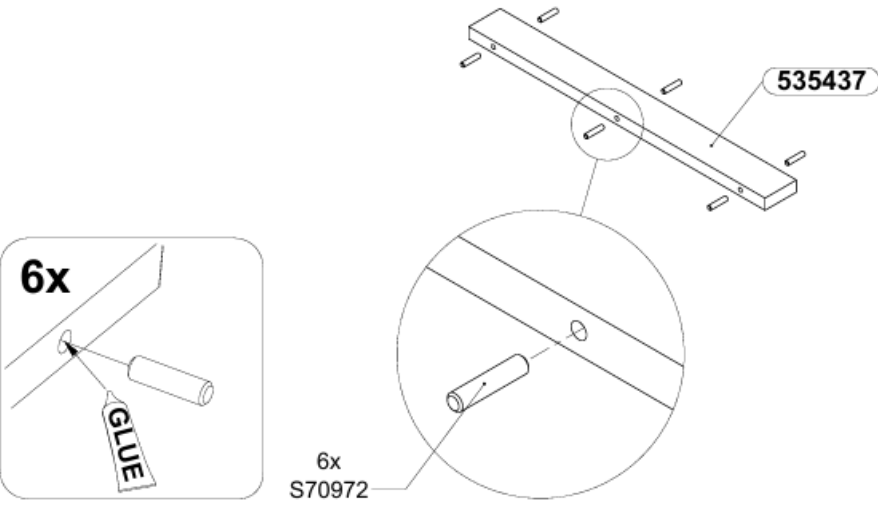

3

2x

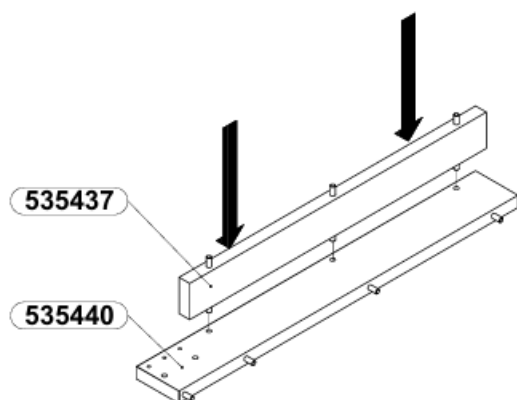
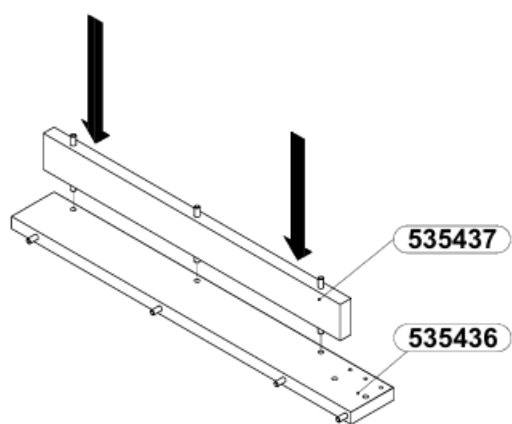
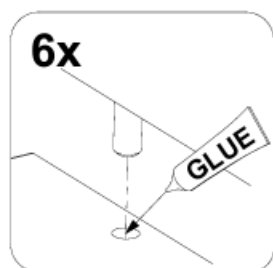

4

4x

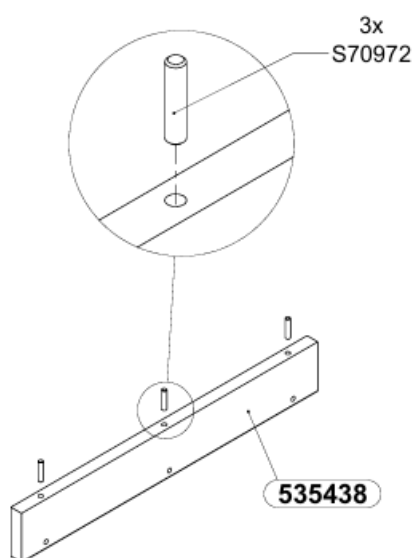
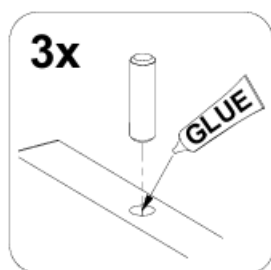

5

2x

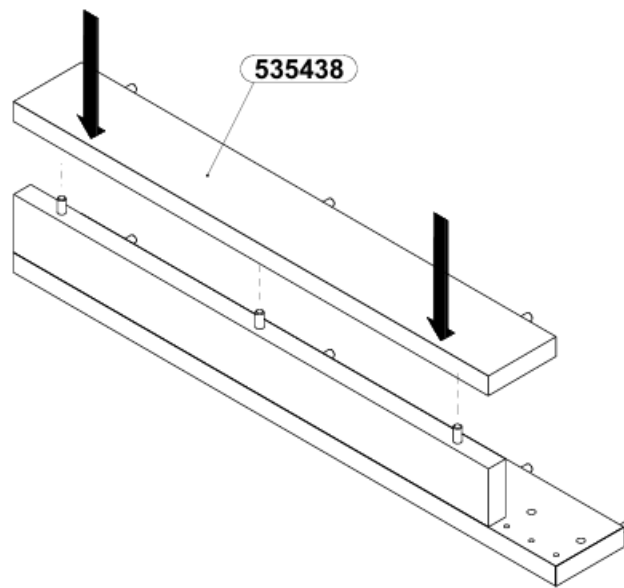
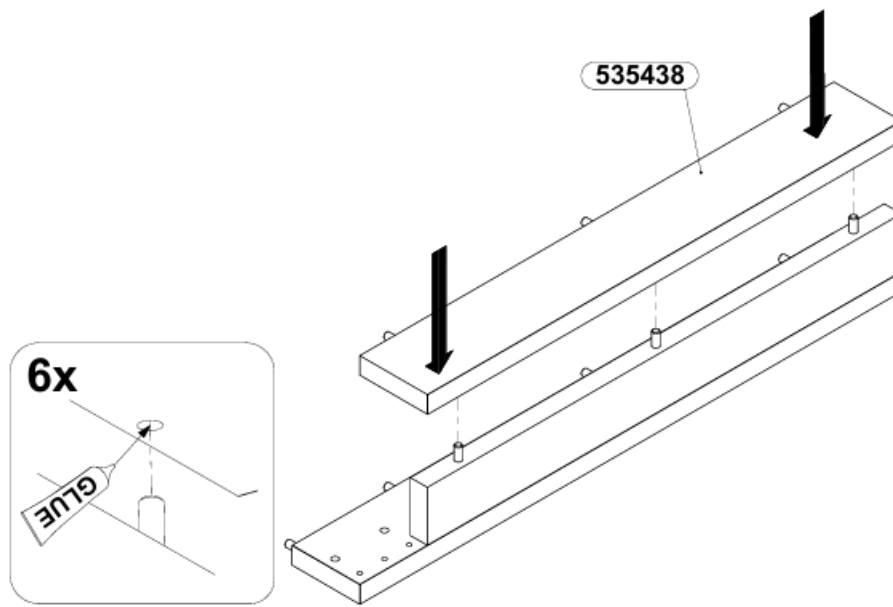

6

2x

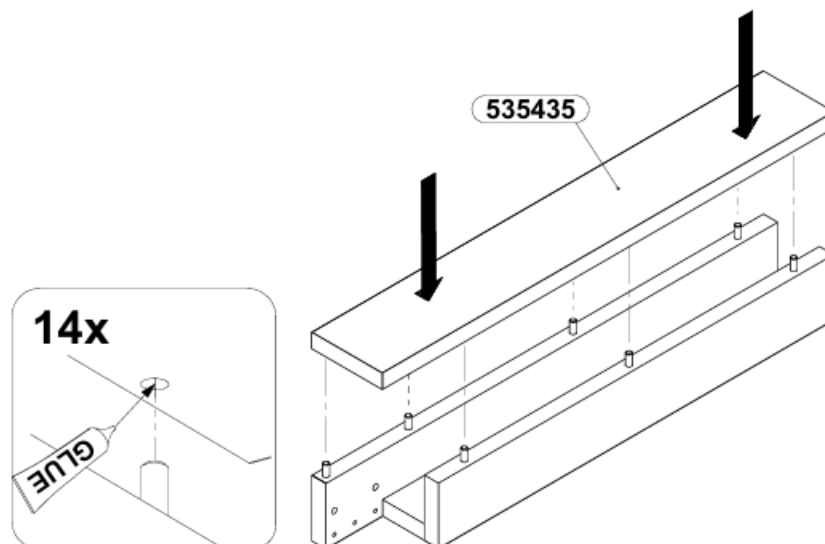

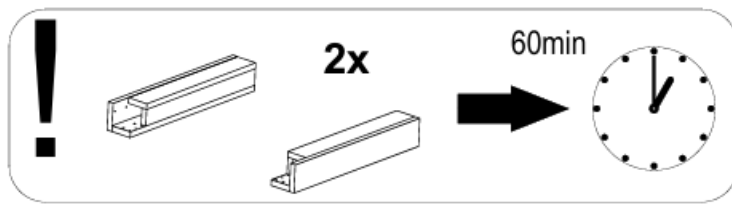
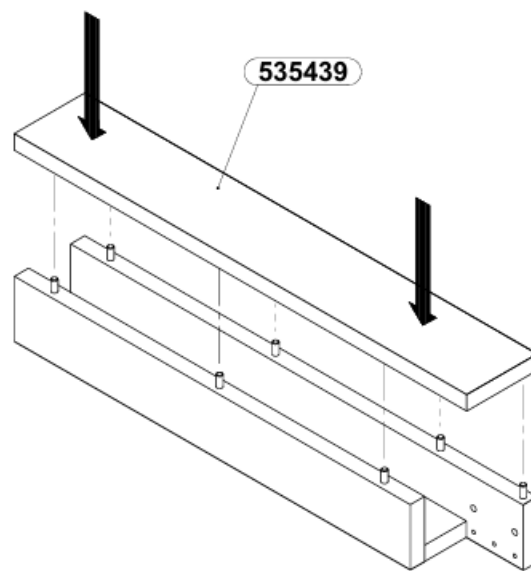

7

2x

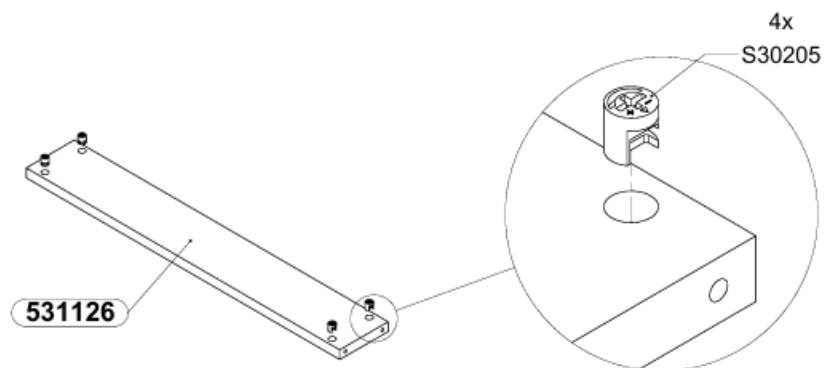

8

2x

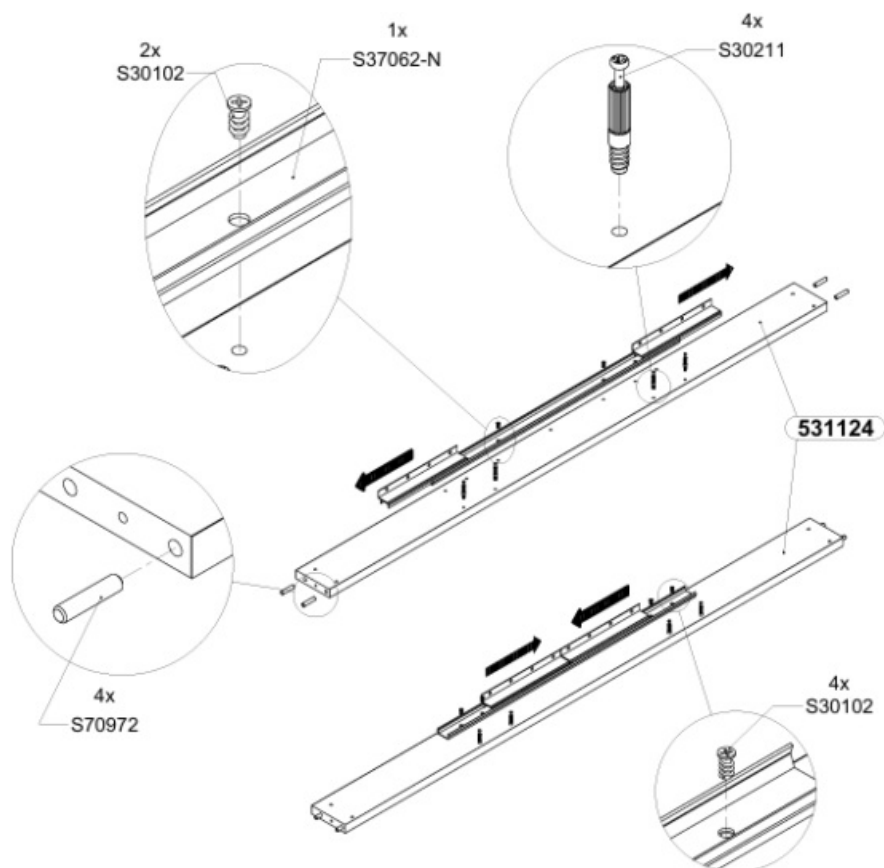

9

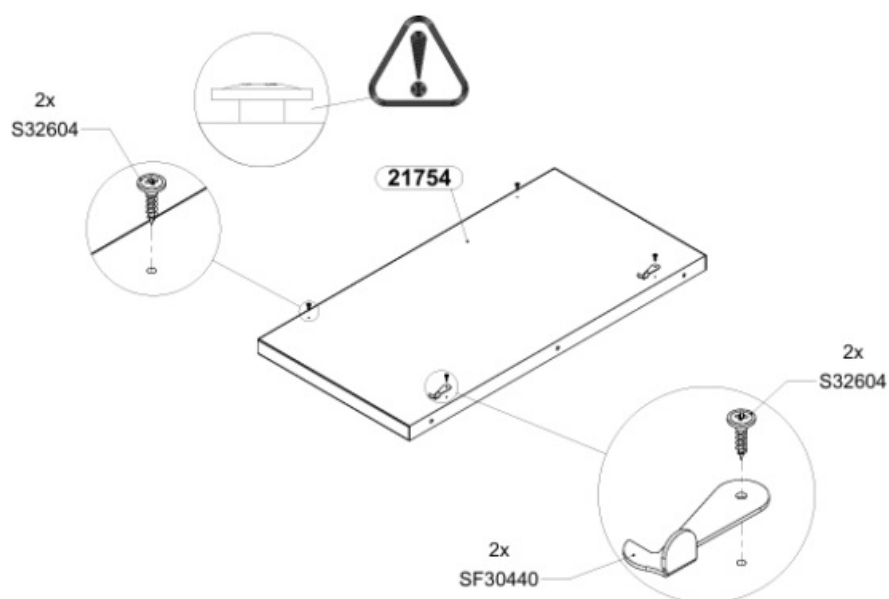

10

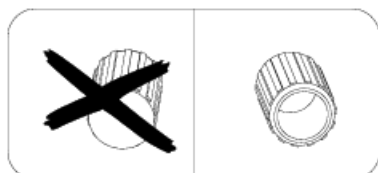

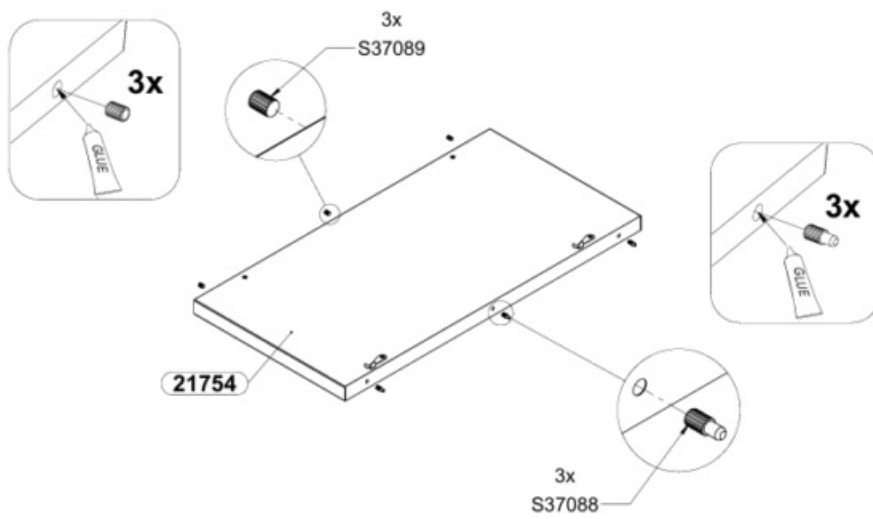

11

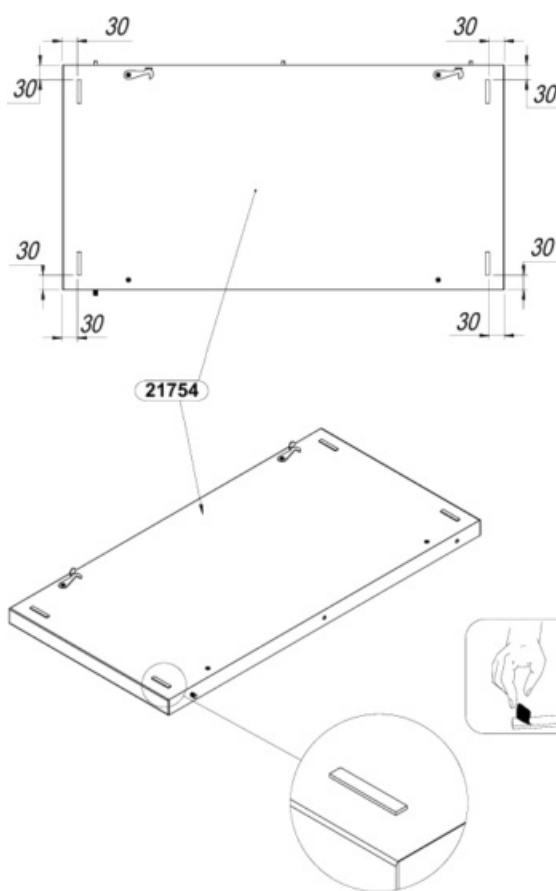

12

1x

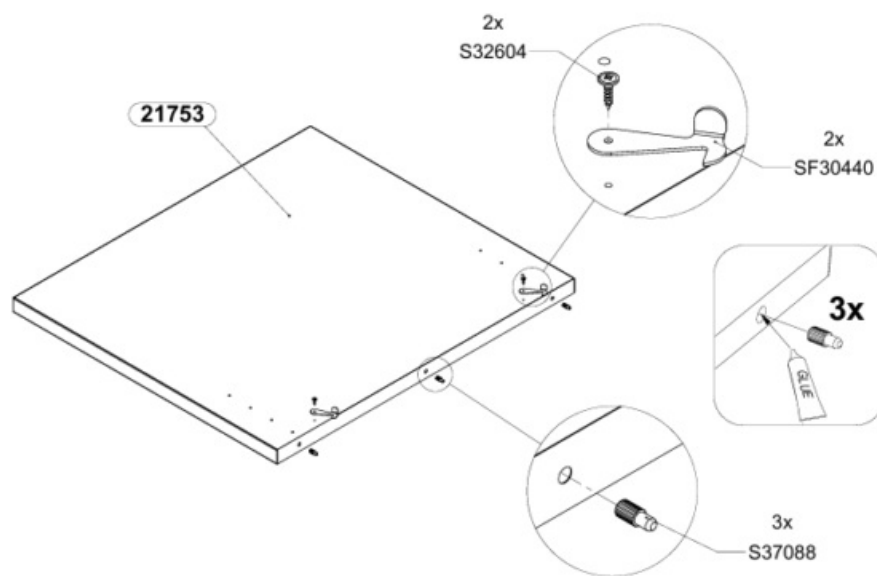

13

1x

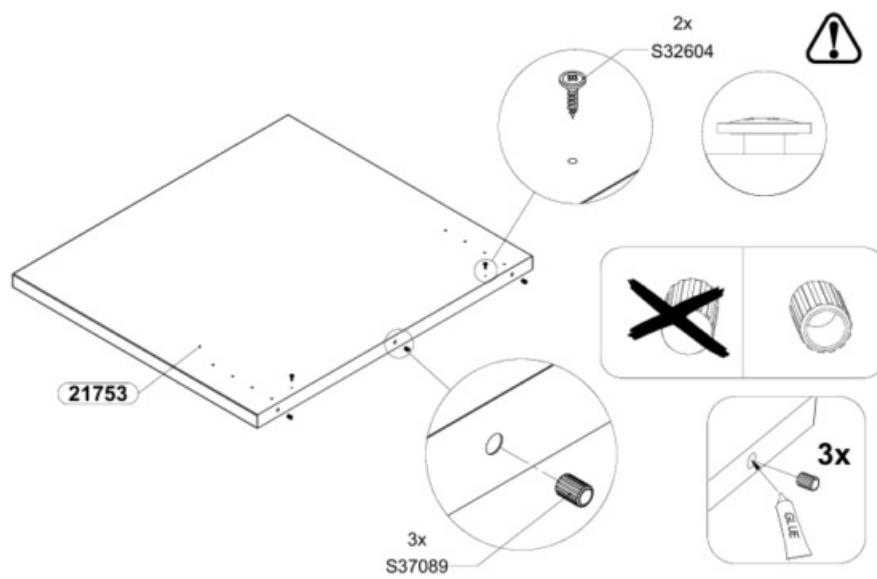

14

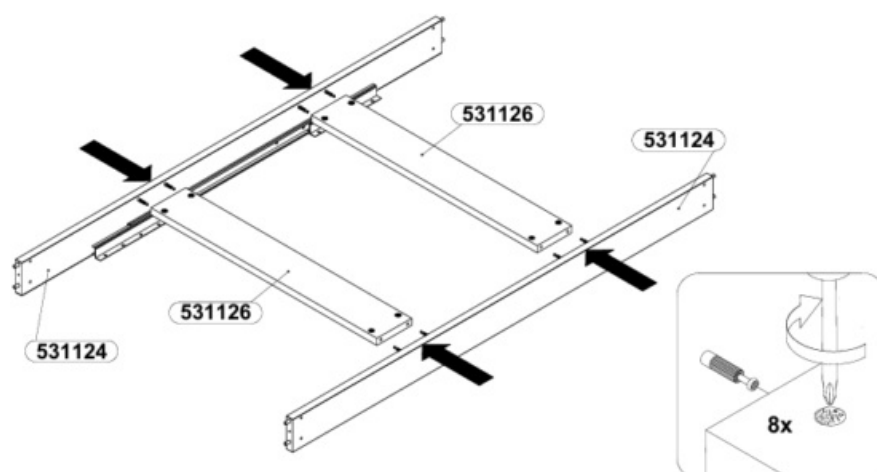

15

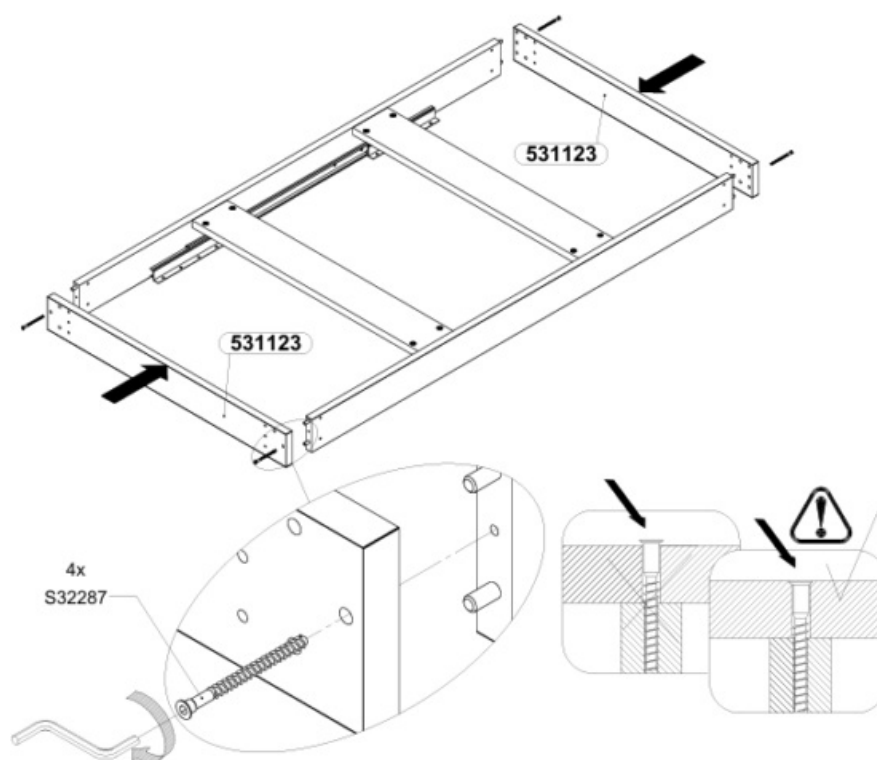

16

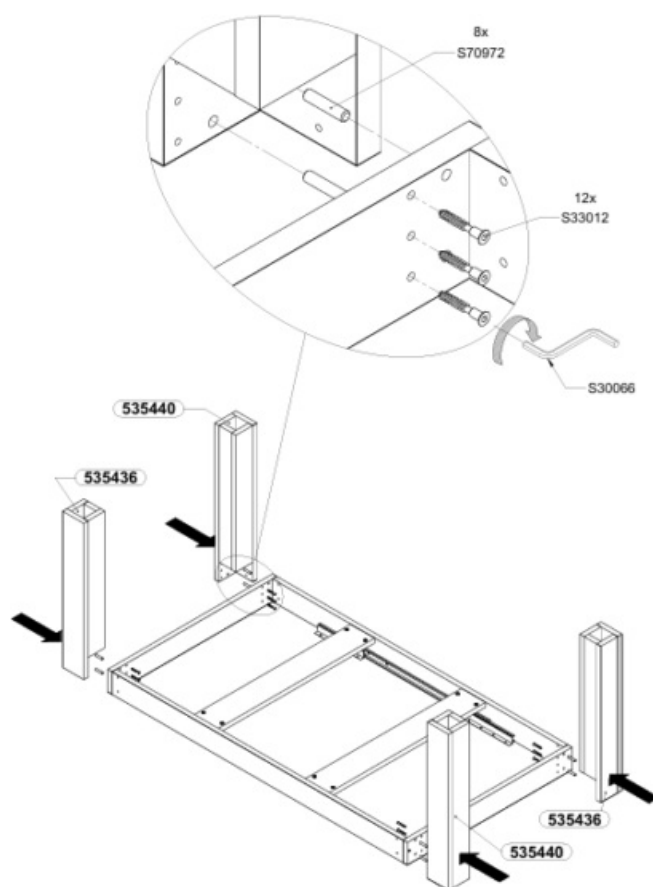

17

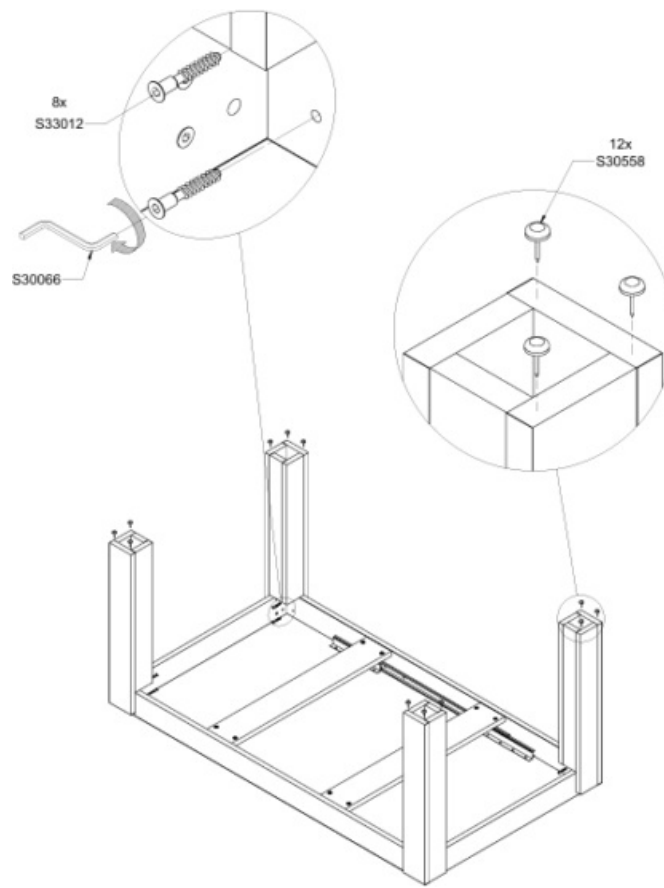

18

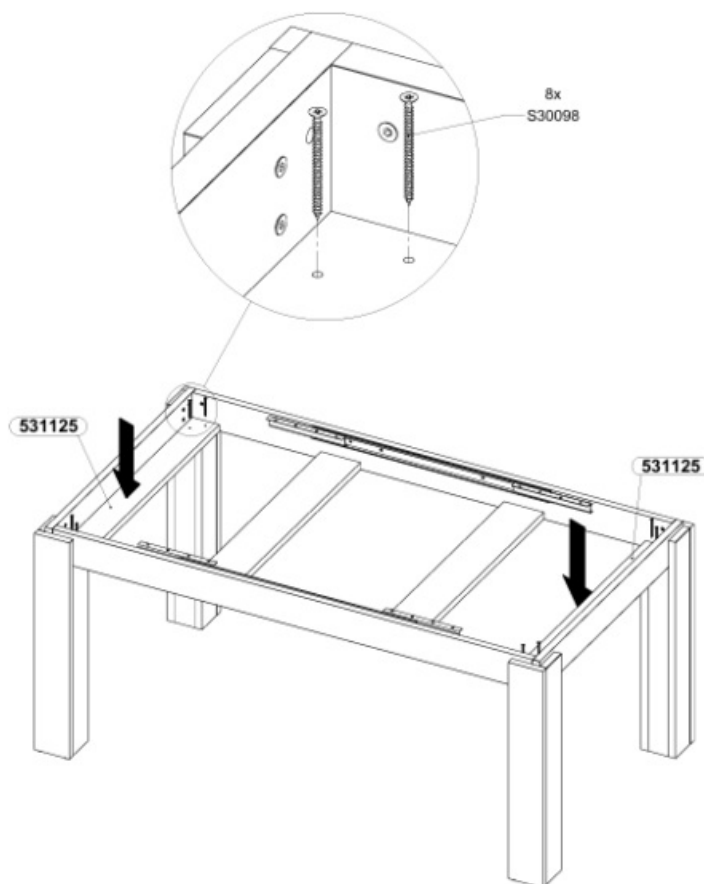

19

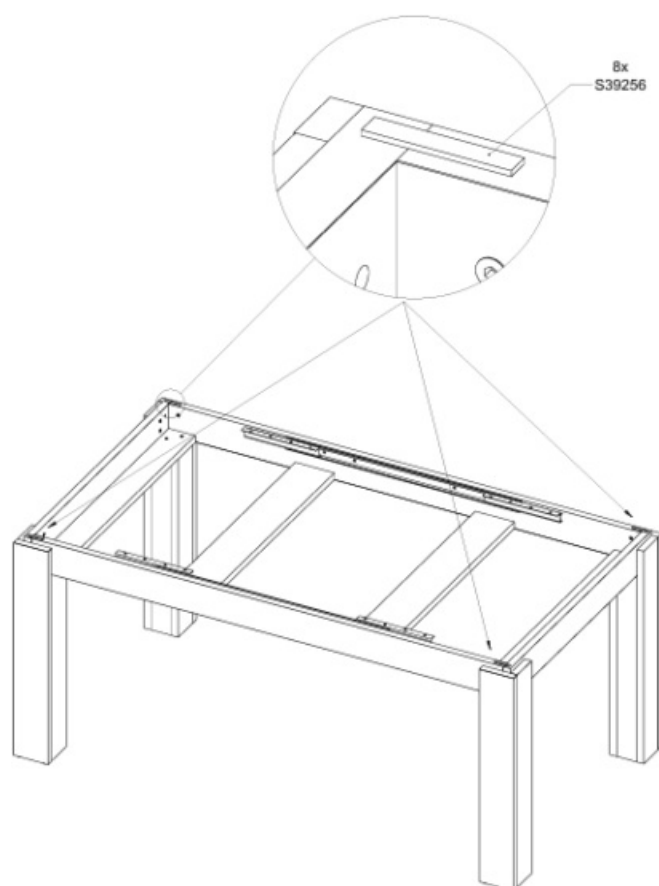

20

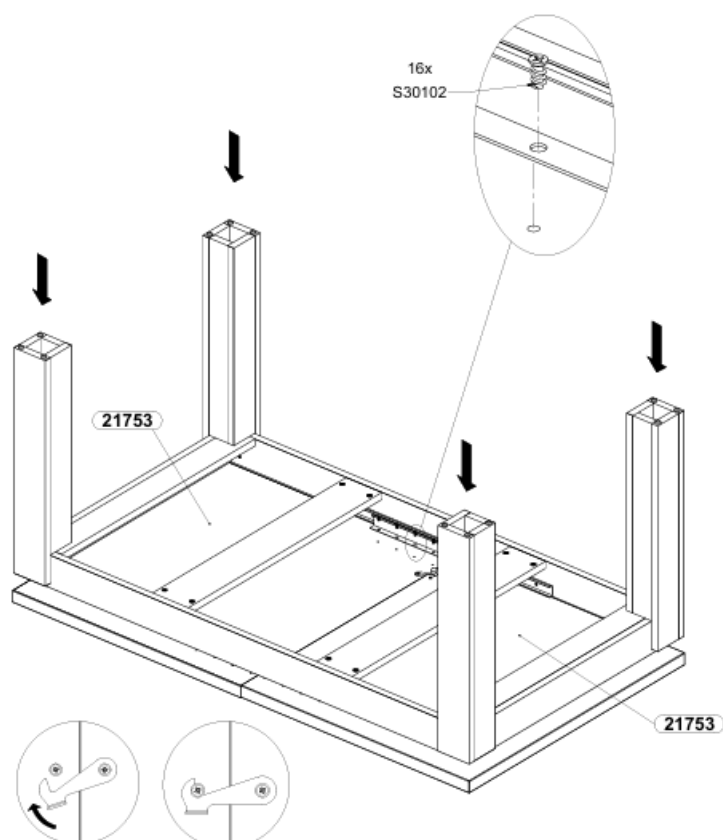

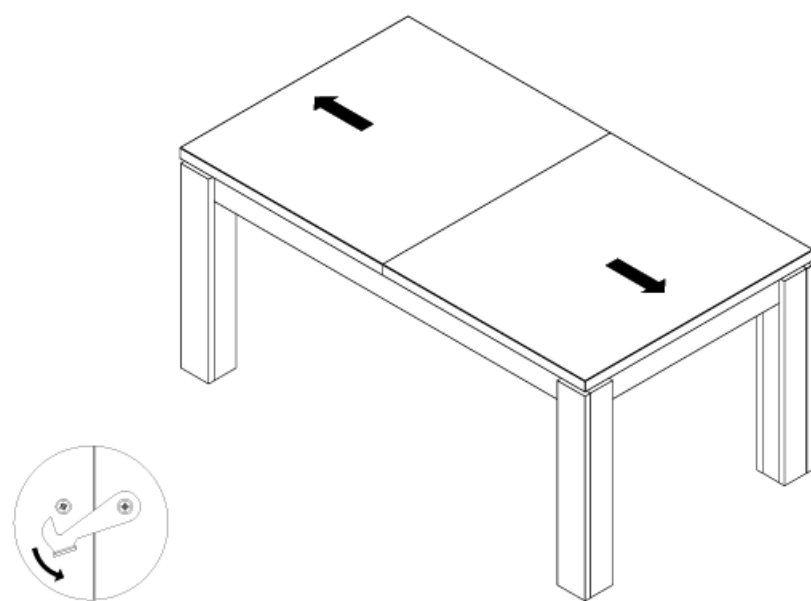
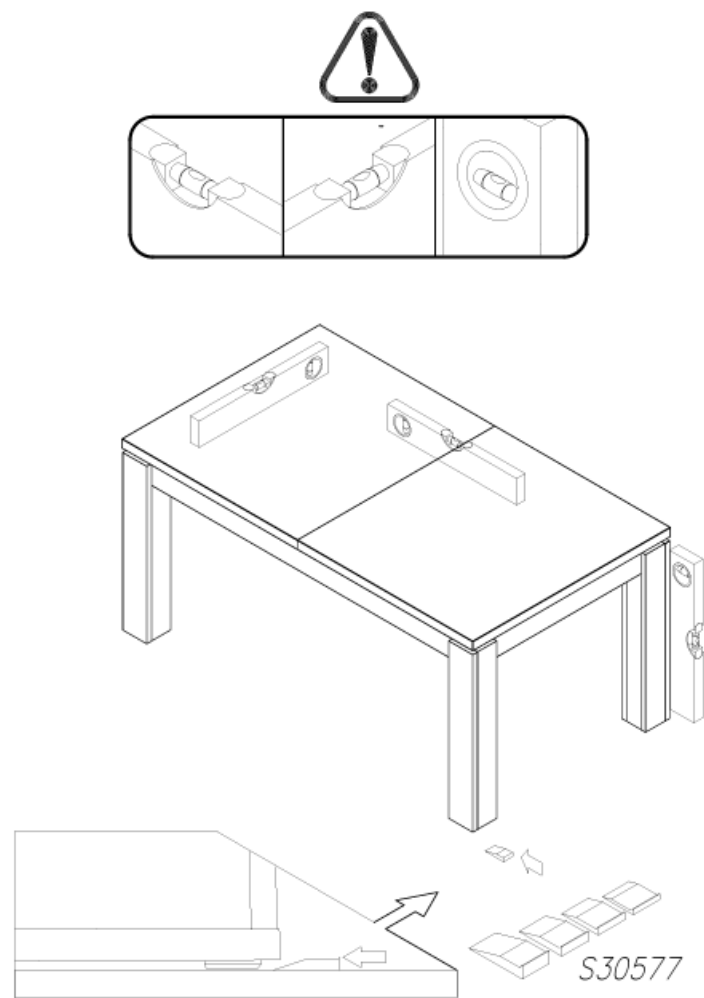

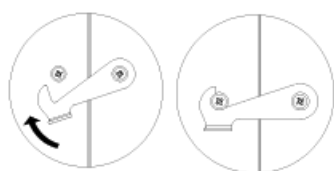
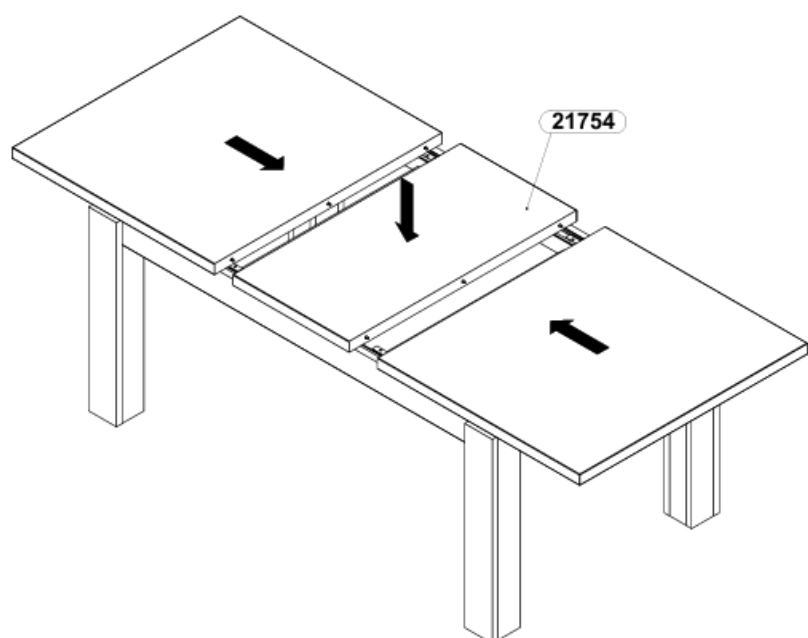

23

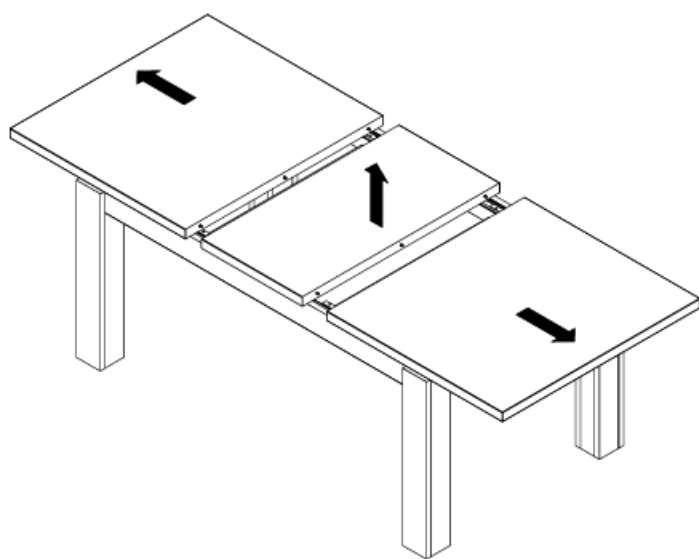

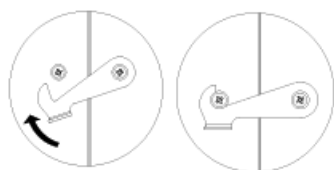
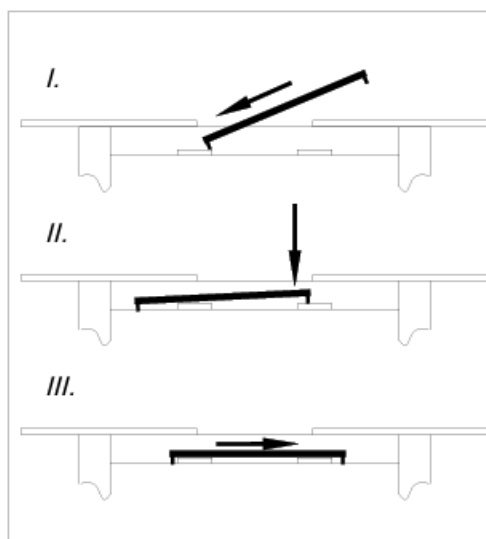
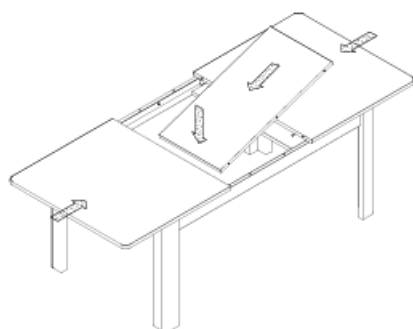

24

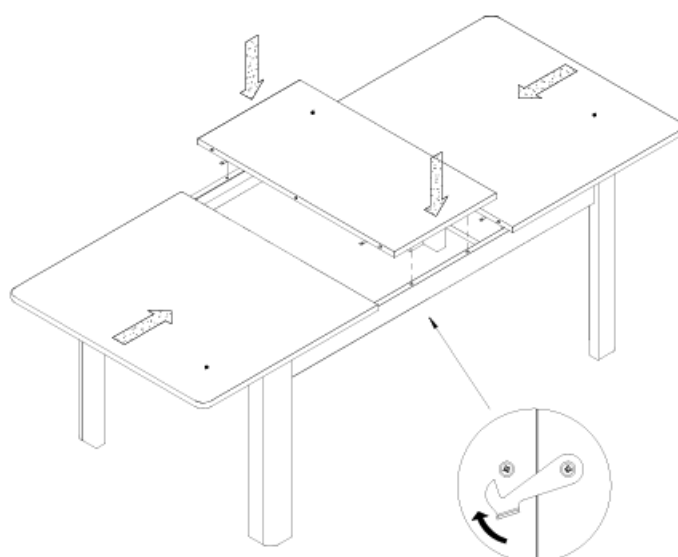
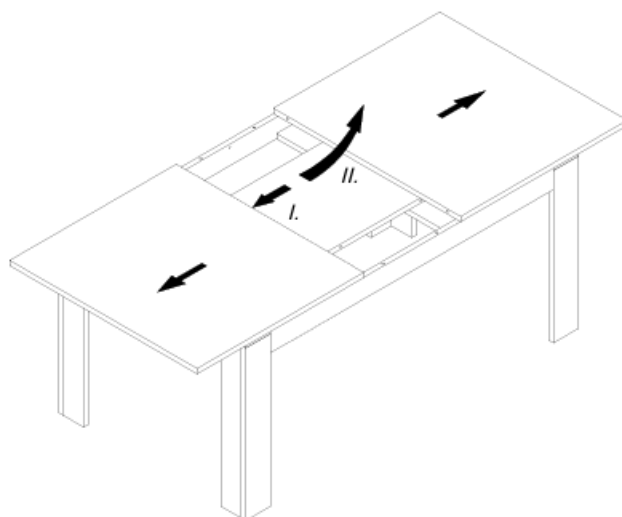

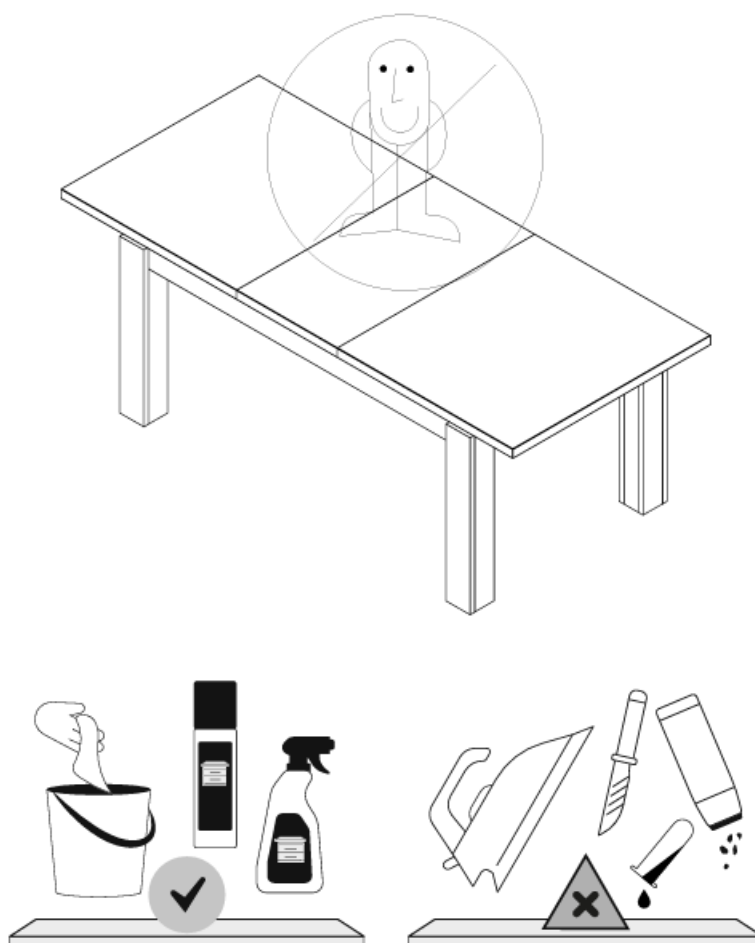

GUIDELINES FOR FURNITURE CARE

Please follow the below specified remarks in order to properly take care of your furniture:

A clean dry soft fabric must be used for cleaning. If the furniture requires thorough cleaning, then you can slightly moistened it with water or cleaning agent designed for furniture cleaning, and subsequently the cleaned elements must be wiped until they're dry. Metal and glass parts must be cleaned using commercially available cleaning agents designed for cleaning of this type of materials, in accordance with the included instructions.

Do not use corrosive agents, scouring agents and other agents if their intended use is unknown.

The cleaning agents must have clear marking that they are intended for cleaning furniture.

WARNING!!! High gloss elements, from which the protective foil was removed, may be cleaned and used only after 72 hours.

Documents / Resources

| | |
|--|--|
| | <p>Conforama LATT44 Table with Extension [pdf] Instruction Manual 90 MIN, 904, 1604, 2064, 761, LATT44 Table with Extension, LATT44, Table with Extension, with Extension, Extension</p> |
|--|--|

References

- [User Manual](#)

Manuals+. Privacy Policy

This website is an independent publication and is neither affiliated with nor endorsed by any of the trademark owners. The "Bluetooth®" word mark and logos are registered trademarks owned by Bluetooth SIG, Inc. The "Wi-Fi®" word mark and logos are registered trademarks owned by the Wi-Fi Alliance. Any use of these marks on this website does not imply any affiliation with or endorsement.