



## concept2 C2PM5 Rower Model E Installation Guide

[Home](#) » [concept2](#) » concept2 C2PM5 Rower Model E Installation Guide 

### MODELE

#### Contents

- [1 Assembly Instructions](#)
- [2 Documents / Resources](#)
- [3 Related Posts](#)

### Assembly Instructions

**IMPORTANT NOTE:** Use these instructions for **MODELE** assembly.

MODELE

**Weight:** 65 lb (29 kg)

**Dimensions:** 8 ft x 2 ft (244 cm x 61 cm)

Space Required for Use: 9 ft x 4 ft (274 cm x 122 cm)

**Weight Capacity:** 500 lb (227 kg) as tested by Concept2\*

\*300 lb (135 kg) as tested per European Stationary Fitness Equipment Testing Standard EN 20957-7

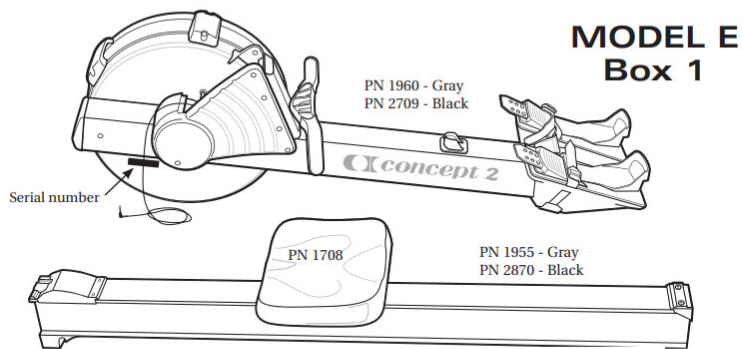

**MODEL E  
Box 2**

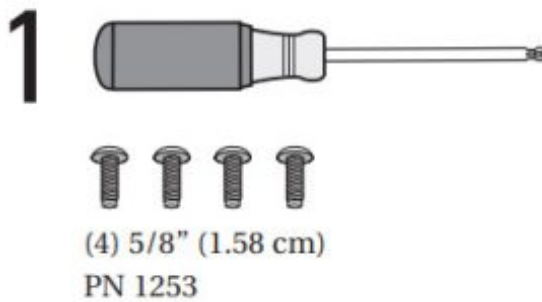
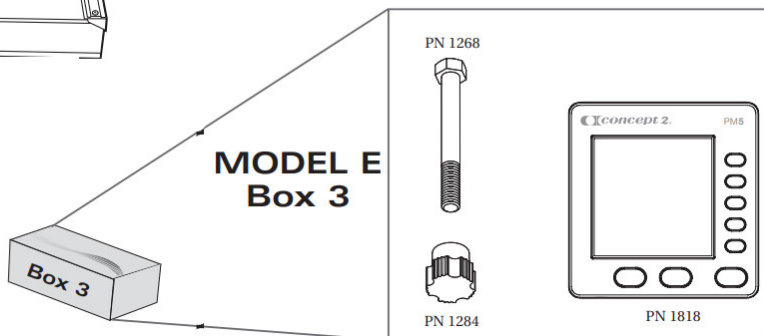
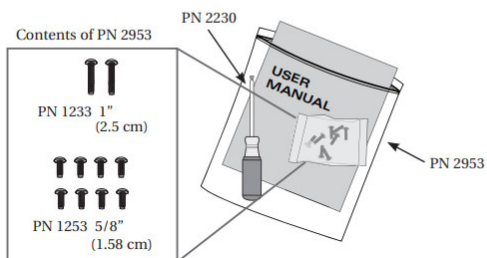
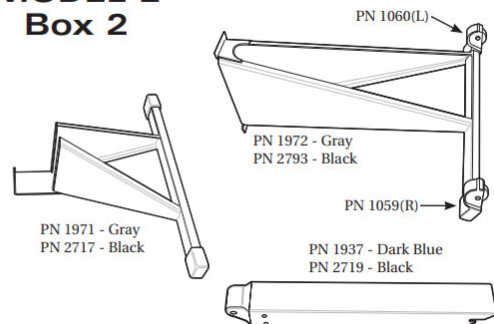

**Assembly Tip**

Do not fully tighten screws until all screws are in place.

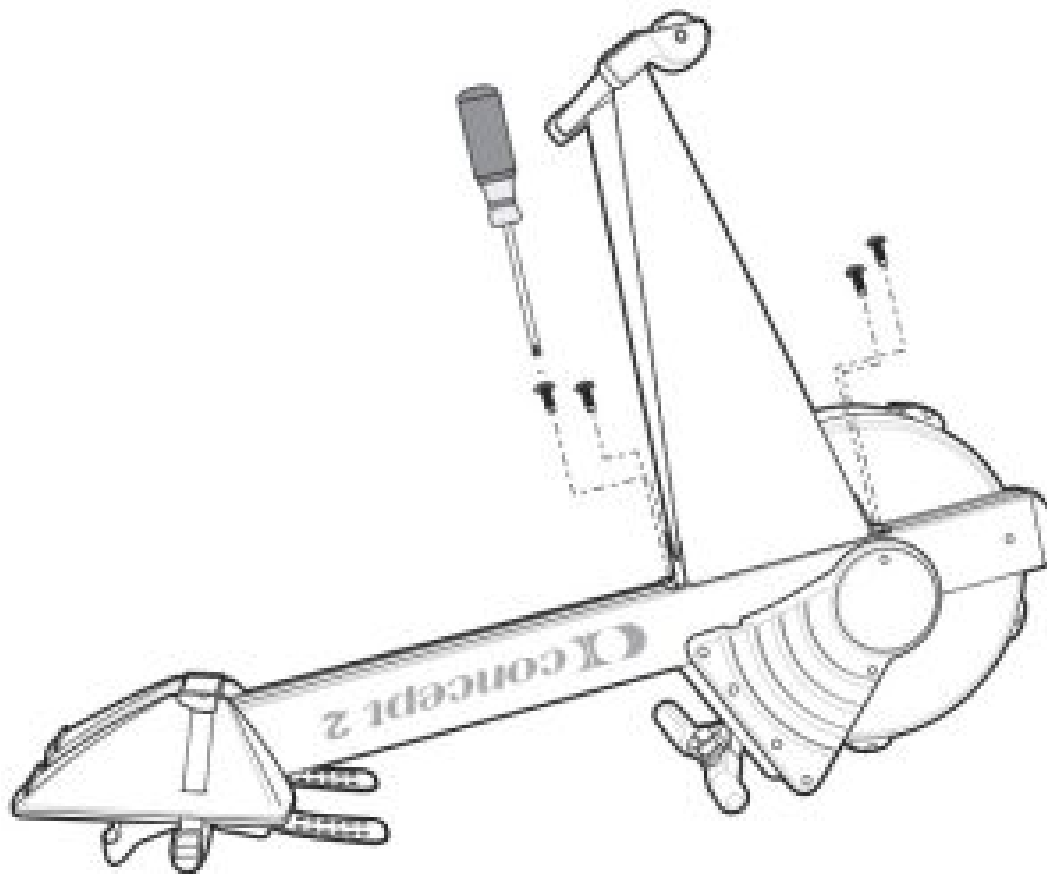

2

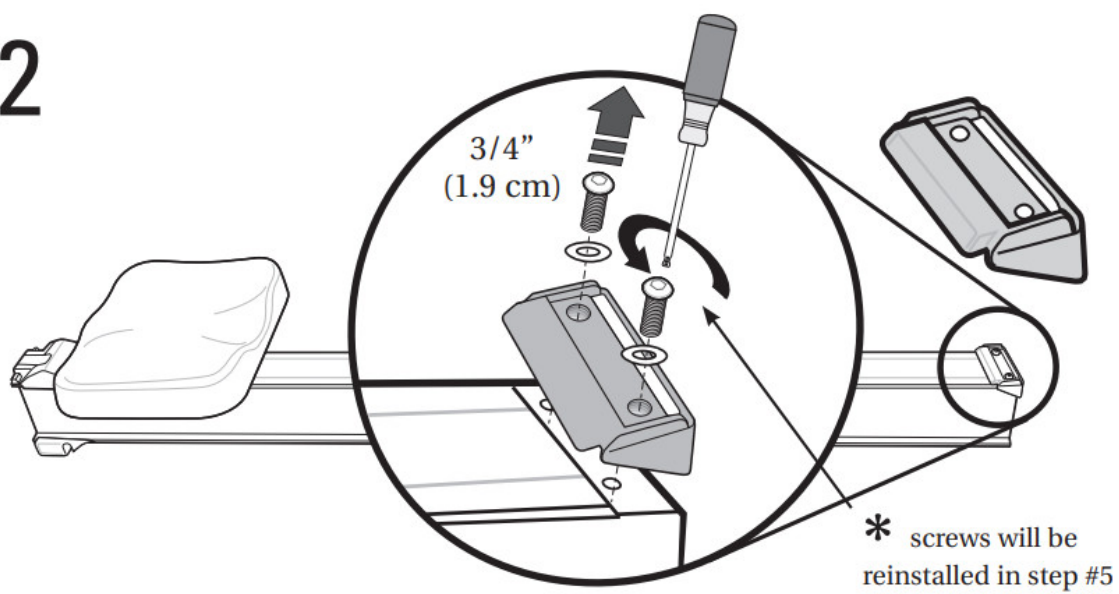

3

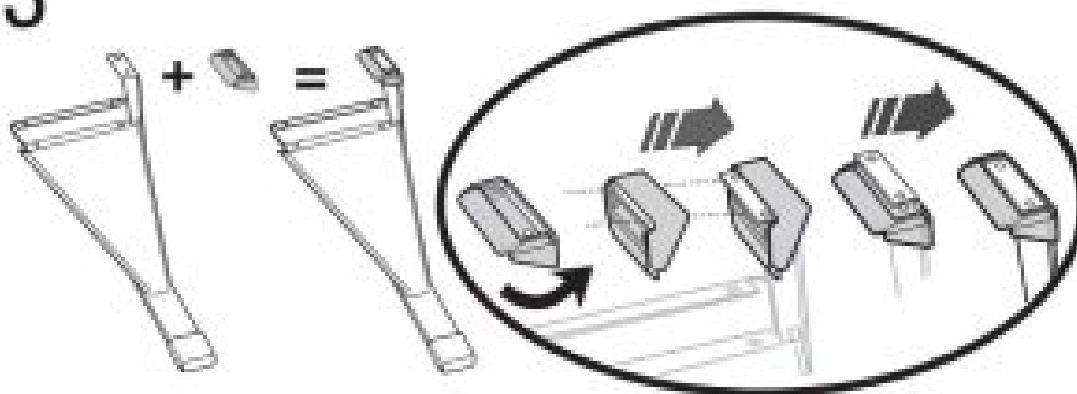

4

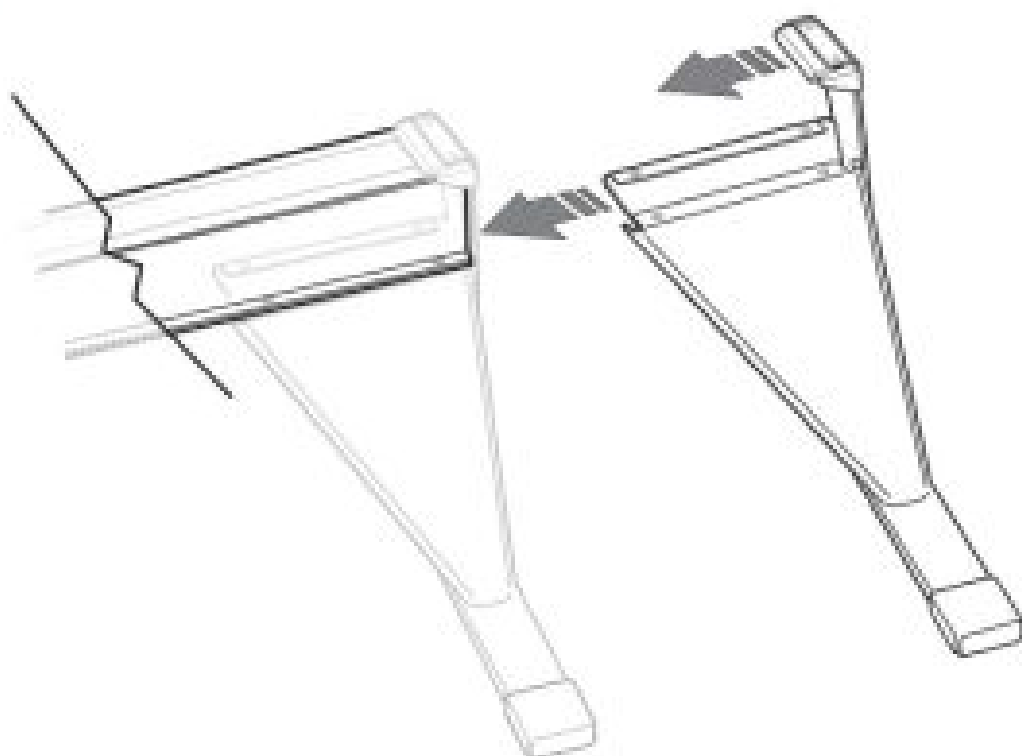

5



(4) 5/8" (1.58 cm)  
PN 1253

from step #2  
(2) 3/4" (1.9 cm) PN 1248

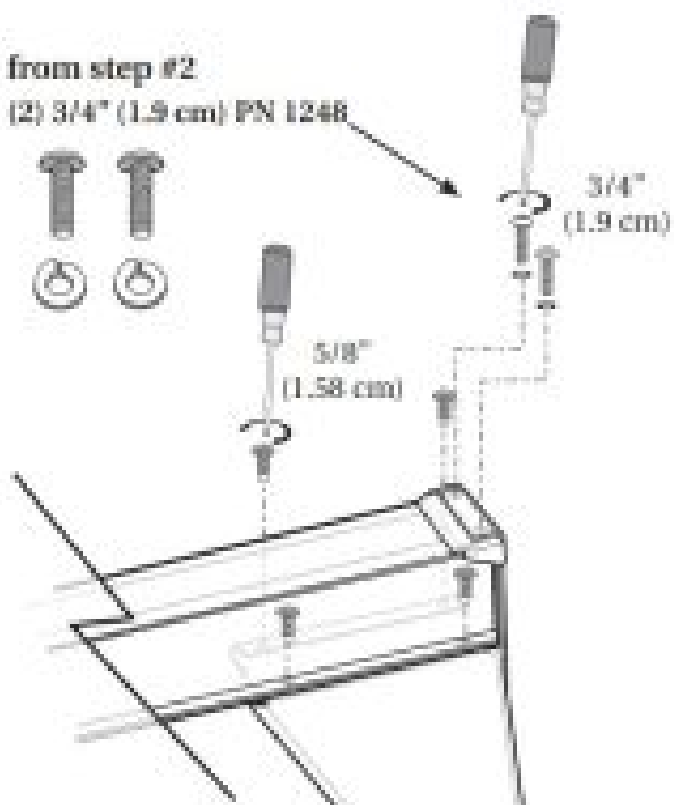
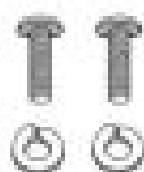

6

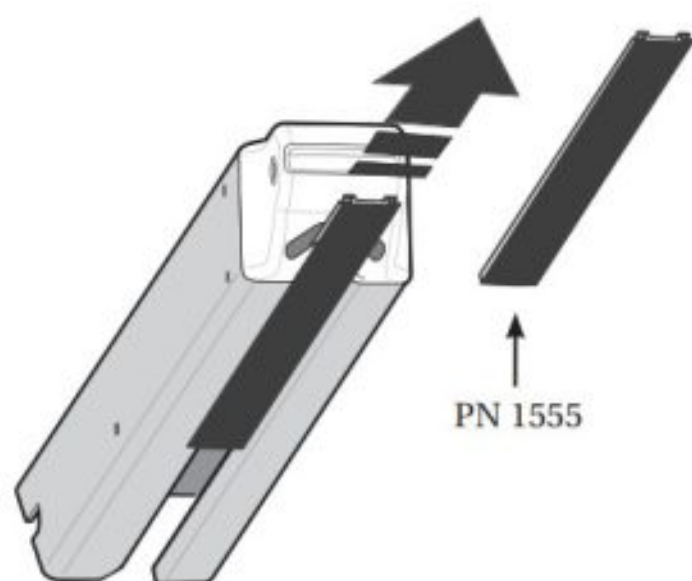

7

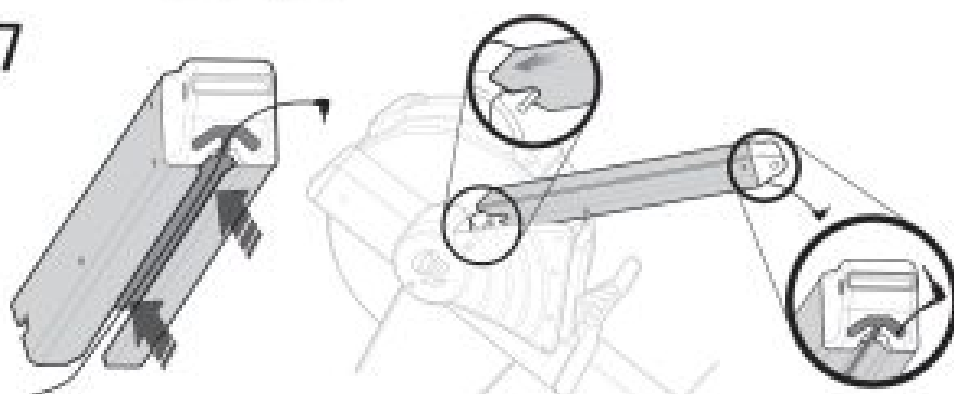

8

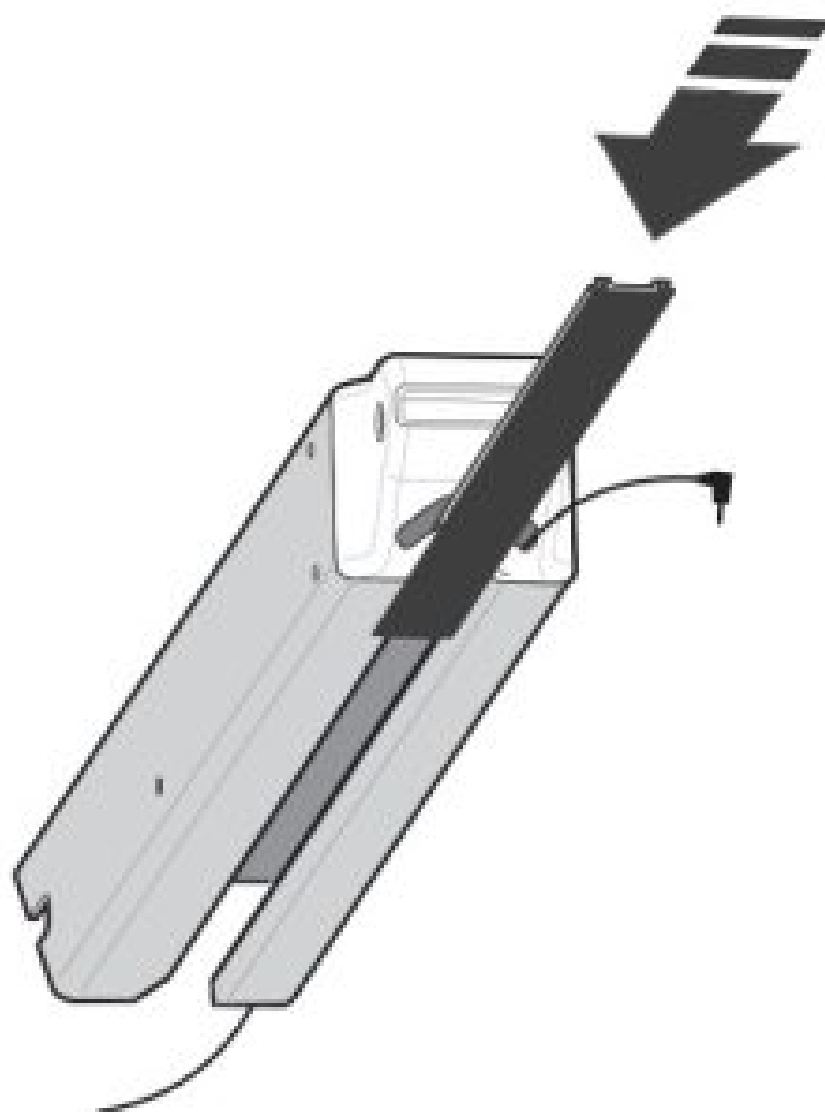

9

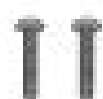

(2) 1" (2.5 cm)  
PW 1203

Tighten  
screw.

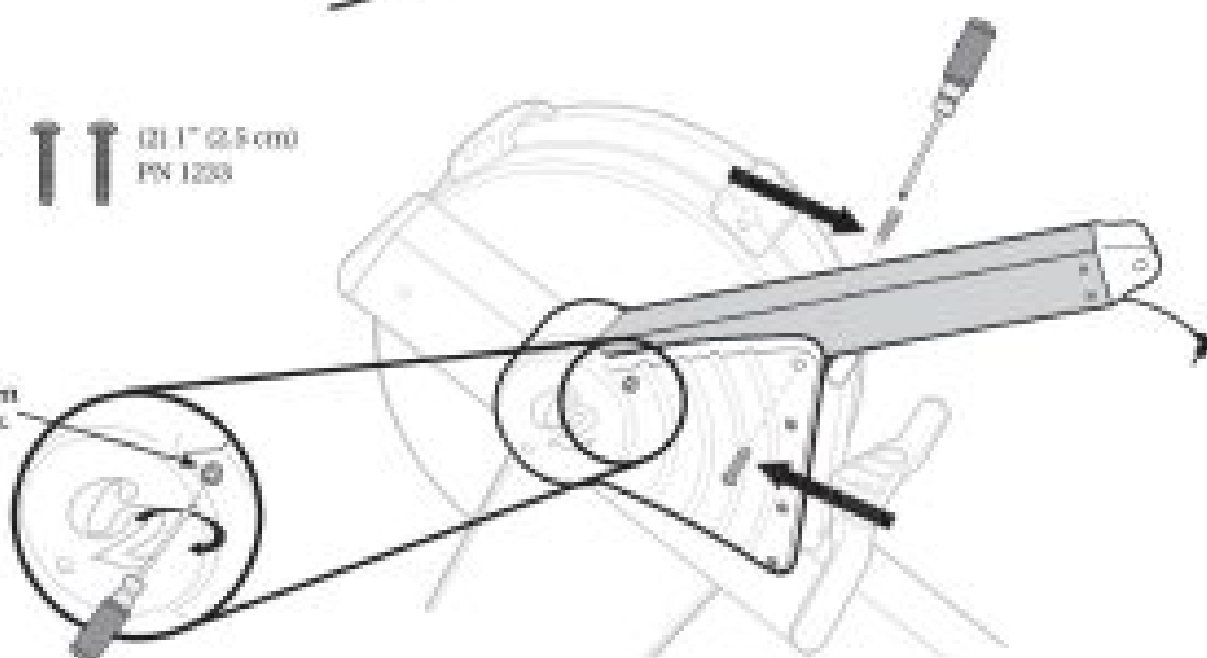

# 10

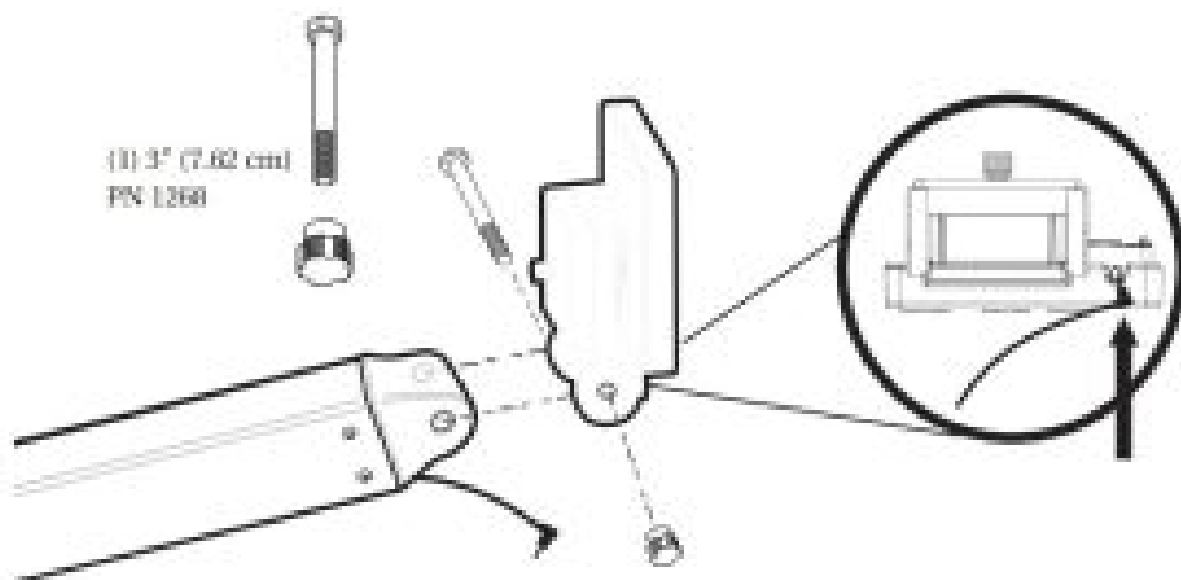

# 11

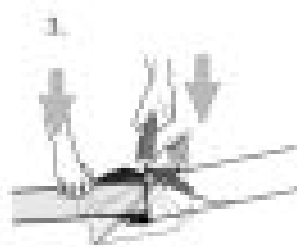
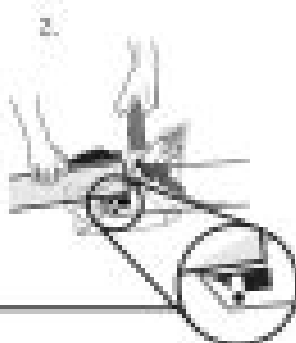
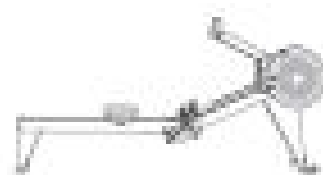
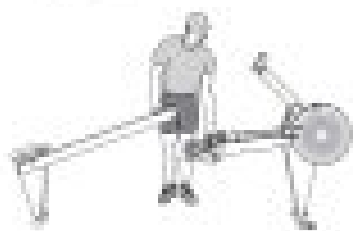

## Documents / Resources

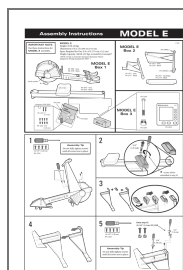

[concept2 C2PM5 Rower Model E](#) [pdf] Installation Guide  
C2PM5, Rower Model E