



concept CK7000 Multi Cooker Instruction Manual

[Home](#) » [concept](#) » concept CK7000 Multi Cooker Instruction Manual 

Contents

- [1 concept CK7000 Multi Cooker](#)
- [2 IMPORTANT SAFETY PRECAUTIONS](#)
- [3 PRODUCT DESCRIPTION](#)
- [4 CONTROL PANEL LAYOUT](#)
- [5 BEFORE FIRST USE](#)
- [6 OPERATING INSTRUCTIONS](#)
- [7 CLEANING AND MAINTENANCE](#)
- [8 ENVIRONMENTAL CONCERNS](#)
- [9 Documents / Resources](#)
 - [9.1 References](#)
- [10 Related Posts](#)

concept

concept CK7000 Multi Cooker



ACKNOWLEDGMENT

Thank you for purchasing a Concept product. We wish you much joy with your new appliance every day you use it. Please read the instruction manual carefully before initial use. To refer to this manual any time you need to, we recommend you to keep it in a safe place. And please pass it to any future owner of the appliance.

Technical specifications	
Voltage	220-240 V~50-60 Hz
Input	1000 W multifunction cooker 1500 W air fryer
Basket capacity	6 l
Adjustable temperature	80-200 °C
Timer	1 min – 24 hours

IMPORTANT

Before connecting to the mains, make a visual check to ensure that the unit is intact and that no damage occurred during transport.

IMPORTANT SAFETY PRECAUTIONS

- Do not use the appliance in any other way than as described in this manual.
- Remove all the covering and marketing materials from the appliance before the first use.
- Make sure the mains voltage corresponds to the values on the rating plate of the product.
- Place the appliance on a stable, flat surface away from other heat sources.
- When disconnecting the appliance from the wall outlet, never pull the power cord, grasp the plug end and

disconnect it by removing it from the receptacle.

- Do not allow children or unauthorized people to handle the appliance, use it out of their reach.
- Persons with reduced mobility, reduced sensory perception, mental disadvantage or persons not familiar with the operation must use the appliance only under the supervision of responsible person, who is familiar with the instructions.
- Pay extra attention if the appliance is used near children.
- Do not use the appliance as a toy.
- Do not cover the appliance.
- Before assembly and disassembly, disconnect the power cord from the wall outlet.
- Before cleaning and after use of the appliance, switch the appliance off and disconnect it from the mains.
- Keep the appliance clean, do not allow foreign objects to into the grid openings. It could cause serious injury, short circuit, damage to the appliance or cause fire.
- Do not use the appliance with a damaged cord or plug and have it repaired immediately by an authorized service centre.
- Do not use the appliance if it is not working properly, has been dropped, damaged or immersed in liquid. Have it checked and repaired by an authorized service centre.
- The appliance is only suitable for home use and is not intended for commercial use.
- Do not touch the appliance with wet hands.
- Do not immerse the power cord, plug or appliance in water or any other liquid.
- Do not repair the appliance yourself. Contact an authorized service centre.
- This appliance can be used by children aged from 8 years and above and persons with reduced physical, sensory or mental capabilities or lack of experience and knowledge if they have been given supervision or instruction concerning the use of the appliance in a safe way and understand the hazards involved. Cleaning and maintenance performed by the user must not be carried out by children unless they are at least 8 years old and under supervision. Children aged under 8 years of age must be kept away from the appliance and its power cord. Do not let children play with the appliance.
- Do not touch hot surfaces
- Do not let the power cord hang freely over the edge of a table or kitchen unit. Do not let the power cord touch hot surfaces.
- Do not place the appliance near a gas or electric burner.
- NOTICE: The surfaces of the appliance may be very hot. Hold the appliance by the handle only and wear protective equipment such as a kitchen glove.
- Pay special attention to prevent water or other liquid from entering the appliance. This could cause an electric shock.
- Always place the ingredients in the appliance basket to prevent them from coming into contact with the heater.
- Never touch the inner surfaces of the appliance during operation or immediately after switching off. Allow the appliance to cool down sufficiently.
- Do not plug in or operate the appliance with wet hands.
- During frying with hot air, hot steam is released through the air outlets, keep your hands and face at a safe distance from the water vapour coming from the air outlets.
- If you see dark smoke coming out of the appliance during operation, switch it off immediately and contact an authorized service centre.
- Before cleaning the appliance allow it to cool down for at least 30 minutes.

Damages from failure to follow the manufacturer's instructions (see safety precautions) are not covered by the warranty.

PRODUCT DESCRIPTION

1. Air outlet
2. Hot-air lid
3. Pressure lid
4. Pressure valve
5. Float valve
6. Sealing
7. Rice spoon
8. Measuring cup
9. Condensate container
10. Frying basket
11. Removable base
12. Inner container
13. Appliance body
14. Control panel

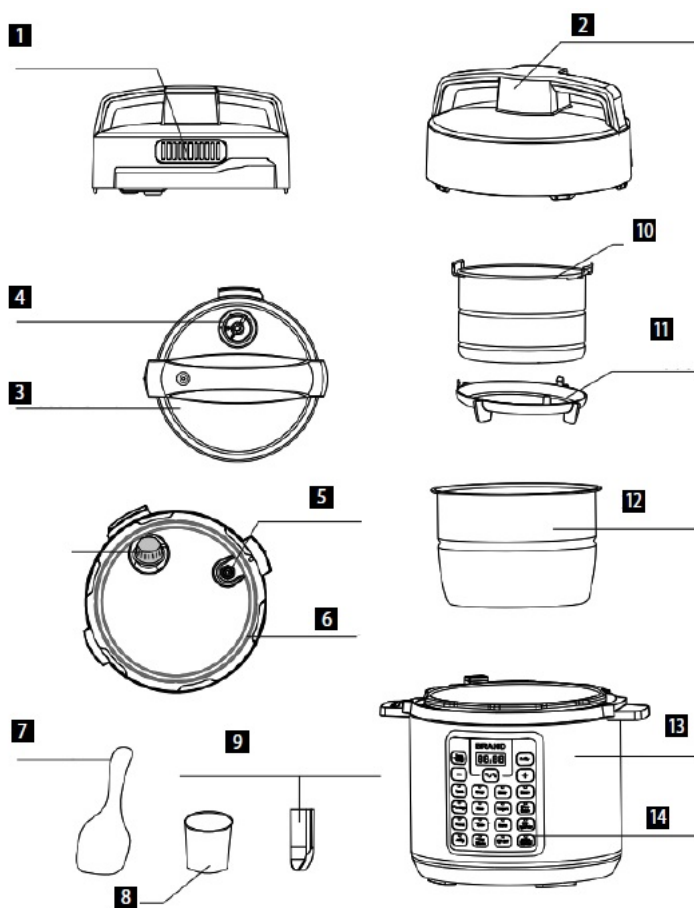

CONTROL PANEL LAYOUT

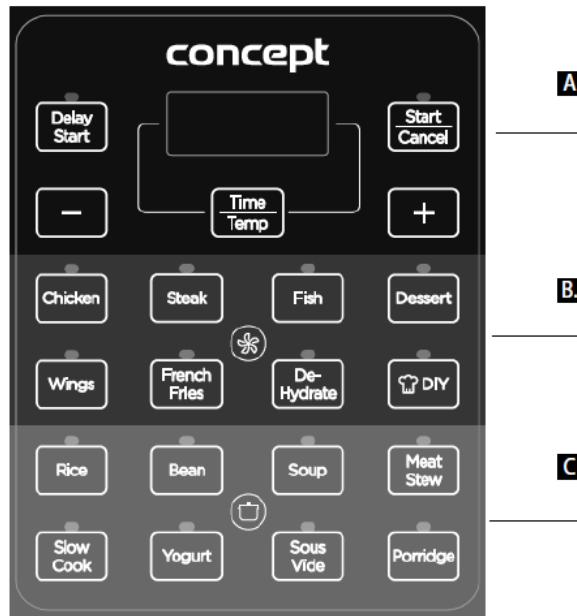

- **A** Control part of the panel
- **B** Menu for the cooker with a hot-air lid
- **C** Menu for the pressure cooker
- **Delay Start** Set the time by which to delay the start of cooking. (This function cannot be used when cooking using a hot-air lid.)
- **Start/Cancel** Start or cancel the cooking after selecting the appropriate program.
- **Time/Temp** Adjust the set time/temperature. (Long press changes °C to F and vice versa.)

The following notifications may appear on the LED display:

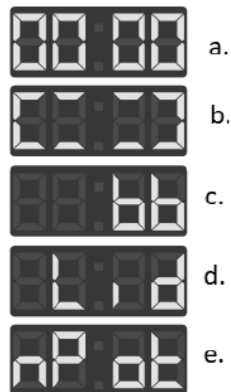

- **a.** The cooker is ready for use
- **b.** The cooker is heating to the required temperature
- **c.** The „Keep Warm“ function – the cooker maintains the temperature
- **d.** The lid is in incorrect position or use a second lid
- **e.** There is not an inner container in the cooker

BEFORE FIRST USE

- Remove all packaging materials from the appliance.
- Remove all labels and stickers from the appliance.

- Wash the inner container (12) with hot water.
- Wipe the appliance thoroughly from the inside and outside with a cloth.

OPERATING INSTRUCTIONS

USING THE COOKER WITH PRESSURE LID (3)

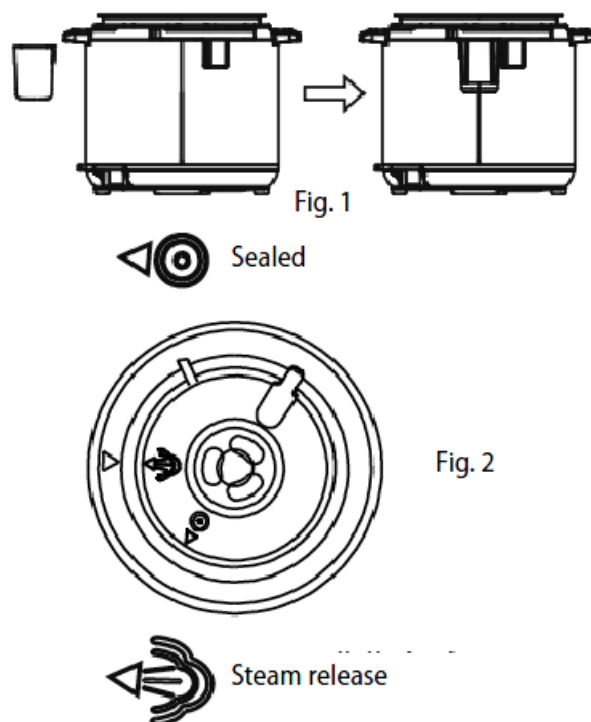

1. Place the appliance in a dry, level place.
2. Place the condensate container (9) in the appliance as shown in the Fig. 1.
3. Prepare the pressure lid (3) as shown in the Fig. 2.
 - Pull the metal protrusion on the underside of the lid to remove the protective cover on which the sealing (6) is fitted. The sealing (6) can be removed and cleaned. Make sure that the sealing (6) is not damaged or torn. If so, it needs to be replaced. Make sure that the float valve (5) is clean and can move freely.
4. Place the appliance in a dry, level place.
5. Grab the pressure lid (3), turn the handle clockwise and lift the lid vertically upwards.
6. Take out the inner container (12). The total volume of foods and water should not exceed 2/3 of the volume of the inner container.
7. Make sure that the inner surface of the appliance (13) is dry and place the inner container (12) in the body of the appliance (13).
8. Place the pressure cover (3) on the appliance and turn it counterclockwise until you hear a click. The lid is now in the correct position.
9. Please bear in mind that the pressure valve (4) must be freely movable for the cooker to function properly.
10. Set the pressure valve to the "Sealed" position, the cooker is now ready for use.
11. For the "Slow Cook" program, set the pressure valve to the "Steam release" position.
12. Plug the power cord into a power outlet.
13. Press the button with name of the required program to select the program from the menu for pressure cooker (C). Press the Start/Cancel button to confirm. The cooker will start to heat to the required temperature (b) and the float valve will start to rise. Once the cooker reaches the required temperature, it will start to count down the

set time. At this point the appliance is already cooking under pressure, the lid is locked and the cooker cannot be opened. NEVER TRY TO OPEN THE COOKER BY FORCE!

14. When cooking is complete, you will hear a sound signal and the cooker will automatically switch to the “Keep Warm” mode to keep the food warm.
15. You can cancel the setting of the cooker at any time by pressing the Start/Cancel button.

When cooking is complete, the pressure can be released in two ways:

1. When cooking is complete, the pressure will gradually decrease. Depending on the amount of liquid, this may take 15-30 minutes. The float valve gradually drops, the lid unlocks and can be opened easily. If it cannot be opened, wait for a bit longer. NEVER OPEN THE COOKER BY FORCE!
2. When cooking is complete, press the Start/Cancel button, wear a pot holder and turn the float valve to the “Steam release” position, the float valve will drop, the lid will unlock and can be opened easily. BE VERY CAREFUL AND USE PROTECTIVE EQUIPMENT, RISK OF STEAM SCALDING!

Delay Start function:

1. Using the Delay Start function, you can delay the start of cooking by up to 24 hours.
2. Follow the operating instructions, press the button with the name of the selected program, then press the Delay Start button and use the “+” and “-” buttons to set the time by which you want to delay the start of cooking. The default setting for delayed start is 30 minutes.
3. Then press the Start/Cancel button. After the set time has elapsed, the selected program starts.

Tips

1. If you select the “Slow Cook” program, you can use the cooker with or without a lid.
2. We recommend using the “Keep Warm” function for a maximum of 1 hour, after that the food will start to lose its quality.
3. The programs are pre-set to prepare food weighing less than 1200 g. If you want to prepare larger portions, use your own custom setting.
4. Use the Delay Start function only for foods that cannot spoil during this time.

USING THE COOKER WITH THE HOT-AIR LID (2)

- Programs from the menu for the hot-air lid can only be started when using the hot-air lid, and programs from the menu for the pressure lid can only be started when using the pressure lid.
 - The cooker with a hot-air lid uses hot air, never fill the cooker with oil or other frying medium.
1. Plug the power cord into a power outlet.
 2. Make sure that the inner surface of the appliance (13) is dry and place the inner container (12) in the body of the appliance (13).
 3. Place the frying basket (10) with removable base (11) in the inner container. Insert the foods. Place the hot-air lid (2) on the appliance.

4. Press the button with name of the required program to select the program from the menu for the cooker with the hot-air lid (B). The pre-set time of the program will flash on the display. Use the “+” and “-” buttons to adjust the cooking time.
5. If you press the Time/Temp button after selecting a program, you can also use the “+” and “-” buttons to adjust the cooking temperature.
6. Press the Start/Cancel button to confirm.
7. During cooking, you can open the hot-air lid (2) at any time to check the food. The selected program will be paused. After placing the lid back on the cooker, the program will resume where it was interrupted.

Tips

During cooking, we recommend turning the foods so they cook evenly.

PRE-SET PROGRAMS

Programs for cooking using the pressure lid		
Programs	Time	Cooking time
Rice	12 min	8-15 min
Bean	40 min	30-60 min
Soup	25 min	20-60 min
Meat Stew	35 min	20-45 min
Slow Cook	4 hours	2-10 hours
Yogurt	12 hours	8-24 hours
Sous Vide	2 hours	2-6 hours
Porridge	12 min	5-20 min

Programs for cooking using the hot-air lid			
Programs	Time	Cooking time	Temperature
Chicken	25 min	1-60 min	200 °C
Steak	7 min	1-60 min	200 °C
Fish	20 min	1-60 min	200 °C

Dessert	35 min	1-60 min	160 °C
Wings	15 min	1-60 min	200 °C
French Fries	18 min	1-60 min	200 °C
Dehydrate	10 hours	0.5-24 hours	55 °C
DIY	30 min	1-60 min	180 °C

CLEANING AND MAINTENANCE

Clean the appliance after each use.

Do not use coarse and chemically aggressive substances such as: sharp objects, scrapers, chemical solvents, thinners, etc.

- Before cleaning always disconnect the appliance from the mains. Never immerse the appliance, hot-air lid or heater in water or any other liquid!
- Before cleaning the appliance allow it to cool down.
- Wipe the outside of the appliance with a damp cloth.
- Fill the inner container with hot water and leave to stand for a while. Then it can be washed with a soft cloth in water with a detergent or in a dishwasher.
- Other parts of the appliance can be washed in water with a detergent.

SERVICE

Extensive maintenance or repair, which requires access to internal parts of the product, has to be performed by a qualified service centre.

ENVIRONMENTAL CONCERNS

- Packaging materials and old appliances should be recycled.
- Packaging materials may be disposed of as sorted waste.
- Dispose the plastic bags made of polyethylene (PE) of as sorted waste.

Recycling of the appliance at the end of its lifespan

This appliance is labelled in accordance with European Directive 2012/19/EU concerning used electrical and electronic appliances (Waste Electrical and Electronic Equipment – WEEE). The symbol on the product or on its packaging indicates that this product may not be treated as household waste. Instead, it should be taken to the appropriate collection point for the recycling of electrical and electronic equipment. By ensuring this product is disposed of correctly, you will help prevent potential negative consequences for the environment and human health, which could otherwise be caused by inappropriate waste handling of this product. The disposal of such material has to be done according to the recycling regulations. For more detailed information about recycling of this appliance see the authorized local office or service for household waste disposal or the shop, where you purchased the appliance.

The product meets all the necessary requirements of the EU directives applicable to the specific product.

Changes in text, design, and technical specifications are subject to change without notice and we reserve the right to change them.

Documents / Resources

 <p>concept</p> <p>Multi Cooker, CK7000, Multi Cooker, CK7000 Multi Cooker</p>	<p>concept CK7000 Multi Cooker [pdf] Instruction Manual</p> <p>CK7000 Multi Cooker, CK7000, Multi Cooker, Cooker, CK7000 Multi Cooker</p>
---	---

References

-  concept.com
-  [Concept – chytré vymyšleno pro život](#)
-  [Domena Concept.pl jest na sprzedaż - SklepDomeny.pl](#)
-  [Luxury Architecture, Concept Architects, Bratislava](#)
-  [Elektronika Banjan d.o.o.](#)
-  [Elektro obchod - servis](#)
-  [Concept](#)
-  [my](#)
-  [Concept](#)
-  [Concept – chytré vymyšleno pro život](#)
-  [Concept innowacje w Twoim życiu!](#)
-  [www.my-concept.sk | vymyslené pre život](#)
-  [Verners](#)