



COMMSCOPE M2400 Patch Panel Instruction Manual

[Home](#) » [CommScope](#) » **COMMSCOPE M2400 Patch Panel Instruction Manual** 

Contents

- [1 COMMSCOPE M2400 Patch Panel](#)
- [2 Product Information](#)
- [3 Product Usage Instructions](#)
- [4 Tools Required](#)
- [5 Install Panel on Rack](#)
- [6 To Remove an Outlet](#)
- [7 Documents / Resources](#)
 - [7.1 References](#)

COMMSCOPE

COMMSCOPE M2400 Patch Panel



Product Information

The M2400 and M2400A modular panels are highly flexible 24-port, front or rear accessible patch panel assemblies available in GigaSPEED, PowerSUM, or UNJ configurations. They are designed to be used with M-series or UNJ information outlets, modular patch cords, and cables. These panels are an integral part of the CommScope connectivity system and can be mounted in a standard 19-inch (483 mm) equipment rack with universal hole spacing.

Ordering Information:

- M2400-1U-GS: M2400 GS panel (GigaSPEED)
- M2400-1U-PS: M2400 PS panel (PowerSUM/UNJ)
- M2400A-1U-GS: M2400A GS panel (GigaSPEED)
- M2400A-1U-PS: M2400A PS panel (PowerSUM/UNJ)
- M2400A-1U-GS-WH: M2400A GS panel (GigaSPEED)

Tools Required: Phillips head screwdriver

Parts List:

- M2400 Panel Assembly
- M2400A Panel Assembly
- Panel End Caps
- MPS/UNJ Outlet Caps
- MGS Outlet Caps – 12-24 x 1/2 Mounting Screws
- Label Sheet
- Instruction Sheet

Separately Orderable Items:

- Rear Cable Management Bar (for use with the M2400/M2400A panel)
- Removal Tool Kit (required for use with the panel)

Contact Information:

For technical assistance:

- Within the United States, contact your local account representative or technical support at 1-800-344-0223.
- Outside the United States, contact your local account representative or Authorized Business Partner.

For reporting missing/damaged parts or other issues:

- Within the United States, contact CommScope Customer Claims at 1-866-539-2795.
- Outside the United States, contact your local account representative or Authorized Business Partner.

Product Usage Instructions

1. Step 1: Install Mounting Screws

Partially install four 12-24 x 1/2 screws in the equipment uprights in a 1U panel spacing.

2. Step 2: Install Panel on Rack

Position the panel against the rack rails offset to the left of the partially installed screws. 2. Align the slots in the panel with the screws and slide the panel to the right to engage the screws.

3. Step 3: Secure Panel to Rack

Use a screwdriver to access the screws through the holes in the panel. 2. Tighten the screws to secure the panel to the rack.

4. **Step 4: Install End Caps**

Snap the end caps into place on the panel.

5. **Step 5: Attach Separately Orderable Cable Management Bar**

Attach the separately orderable cable management bar to the panel according to the provided instructions. Please refer to the provided instruction sheet for more detailed installation information.

M2400 and M2400A Patch Panel Instructions

General

The M2400 and M2400A modular panels are highly flexible 24-port, front or rear accessible patch panel assemblies available in GigaSPEED, PowerSUM, or UNJ configurations. When installed with M-series or UNJ information outlets, modular patch cords, and cables, they are an integral part of the CommScope connectivity system. The panels mount in a standard 19-inch (483 mm) equipment rack with universal hole spacing.

Ordering information is listed below:

Material ID	Part No.	Description
760118323	M2400-1U-GS	M2400 GS panel (GigaSPEED)
760118315	M2400-1U-PS	M2400 PS panel (PowerSUM/UNJ)
760118349	M2400A-1U-GS	M2400A GS panel (GigaSPEED)
760118331	M2400A-1U-PS	M2400A PS panel (PowerSUM/UNJ)
760253535	M2400A-1U-GS-WH	M2400A GS panel (GigaSPEED)

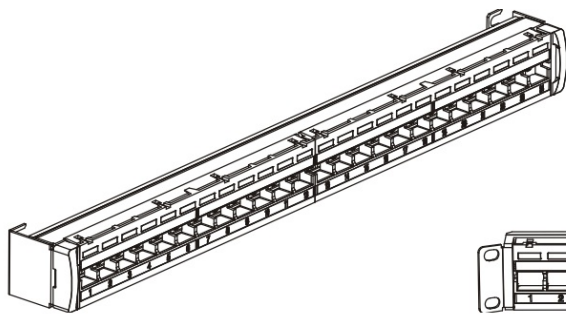

M2400 Patch Panel

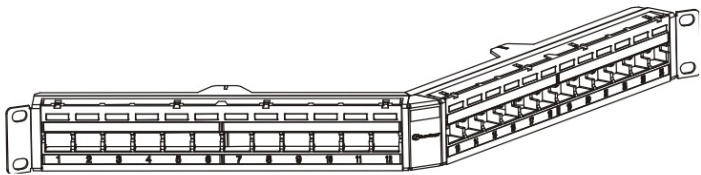

M2400A Patch Panel

How to Contact Us

To find out more about CommScope® products, visit us on the web at <http://www.commscope.com/>

For technical assistance:

- Within the United States, contact your local account representative or technical support at 1- 800-344-0223. Outside the United States, contact your local account representative or Authorized Business Partner.
- Within the United States, report any missing/damaged parts or any other issues to CommScope Customer Claims at 1-866-539-2795. Outside the United States, contact your local account representative or Authorized Business Partner.

Tools Required

- Phillips head screwdriver

Parts List

Verify parts against the parts list below:

Quantity				
M2400 Panel		M2400A Panel		Description
PS	GS	PS	GS	
1	1	—	—	M2400 panel assembly
—	—	1	1	M2400A panel assembly
2	2	—	—	Panel end caps
24	—	24	—	MPS/UNJ outlet caps
—	24	—	24	MGS outlet caps
4	4	4	4	12-24 x 1/2" mounting screws
2	2	2	2	Label sheet
1	1	1	1	Instruction sheet

Separately Orderable Items

A separately orderable rear cable management bar is available for use with the M2400/M2400A panel and a separately orderable removal tool kit is required for use with the panel.

Material ID

- 760104737
- 760122713

Description

- Rack mountable rear cable management bar
- Outlet removal tool kit (5 pack)

Step 1A M2400 Flat Panel Installation

(Skip to Step 1B for Installation of M2400A Angled Panel)

Install Mounting Screws

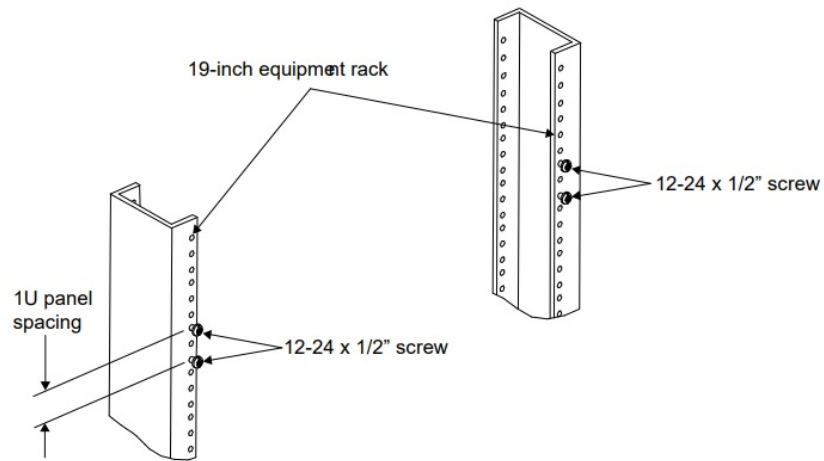

- Partially install four 12-24 x 1/2" screws in equipment uprights in a 1U panel spacing as shown.

Install Panel on Rack

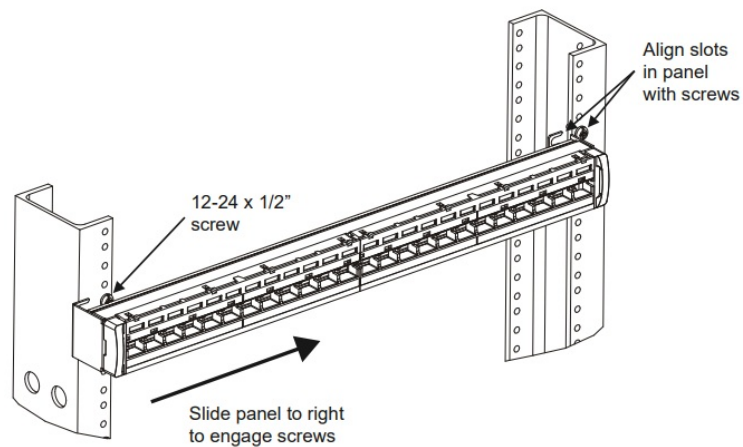

1. Position panel against rack rails offset to the left of the partially installed screws.
2. Align slots in panel with screws and slide panel to right to engage screws.

Secure Panel to Rack

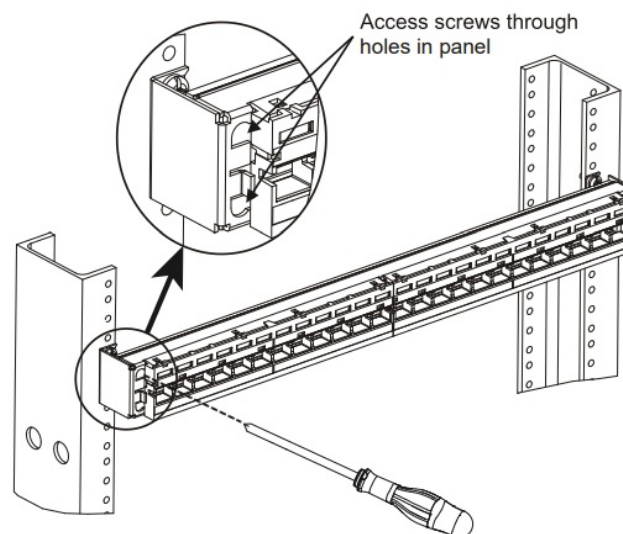

1. Use a screwdriver to access screws through holes in panel. Tighten screws to secure panel to rack.

Install End Caps

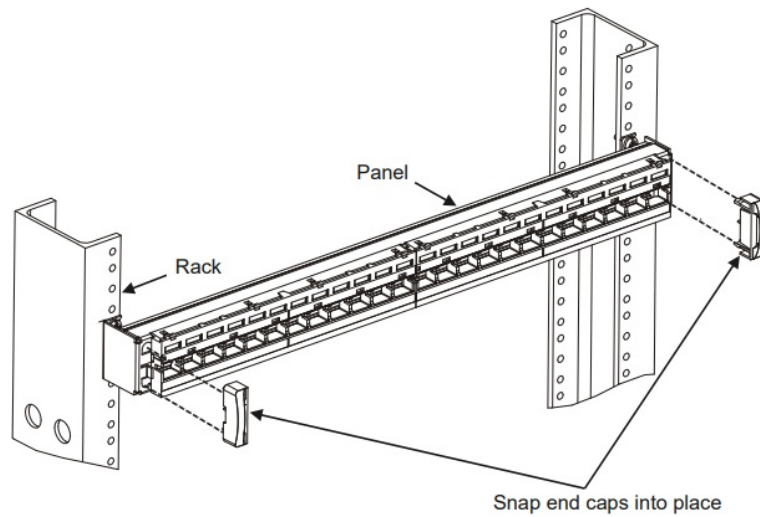

1. Snap end caps into place on panel as shown.

Step 1B M2400A (Angled) Panel Installation

Install Panel on Rack

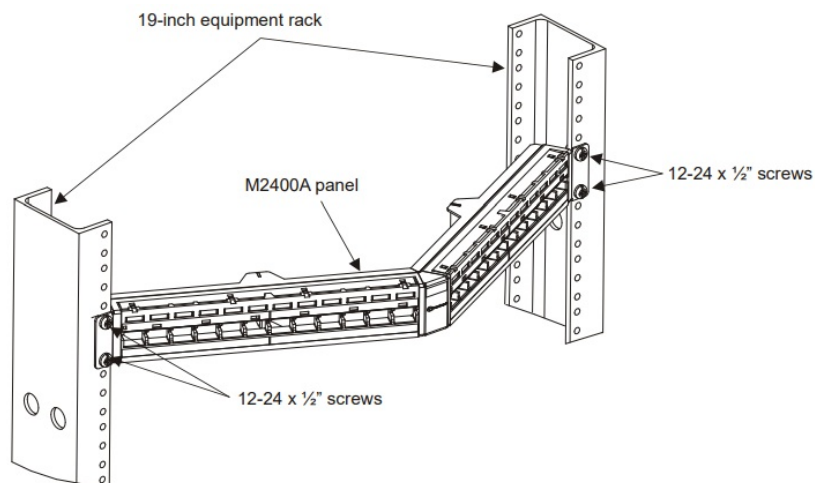

1. Use four supplied 12-24 x 1/2" screws to secure panel to rack.
2. Connect cables to outlets per instructions provided with the individual outlets.

Step 2 Attach Separately Orderable Cable Management Bar

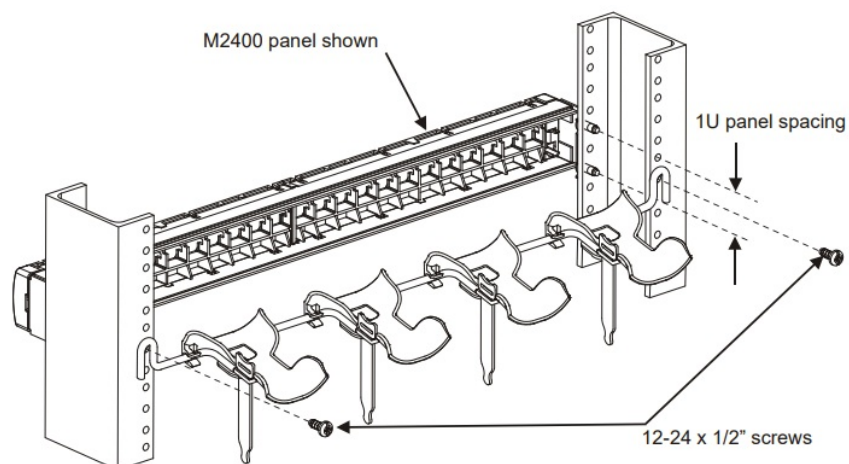

1. Attach cable management bar to rear of equipment rack using the four provided 12-24 x 1/2" screws as shown.

Bar should be level with lower row of outlets.

2. Assemble cable management bar components per instructions provided with the bar.

Step 3 Terminate Outlets, Install Modular Caps on Outlets, and Populate Panel

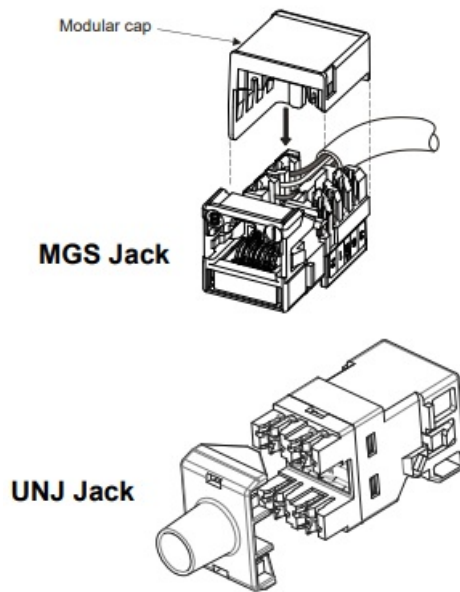

1. Terminate cables to outlets per the instructions provided with the individual outlets.

Note:

- For the MGS jack use a D914 (406477794) impact tool (on HI setting) with M110 cutting blade and hand puck (760034215) or the JackRapid* (JR-SYS-2) termination tool to punch down conductors. Trimming conductors with side-cutters or fine edge cutters is not allowed due to the tight spacing of the outlets.
 - For the UNJ jack, use a D914 impact tool (on HI setting) with M110 cutting blade and hand puck 569949-1 or SL Series termination tool 1725150-1
2. After termination of outlets, snap the provided modular caps onto the outlets.
 3. Populate the panel with outlets, then using the instructions provided with the cable bar, route and secure cables to bar using the provided hook-and-loop straps.

Step 4 Install Port Designation Labels and Icons

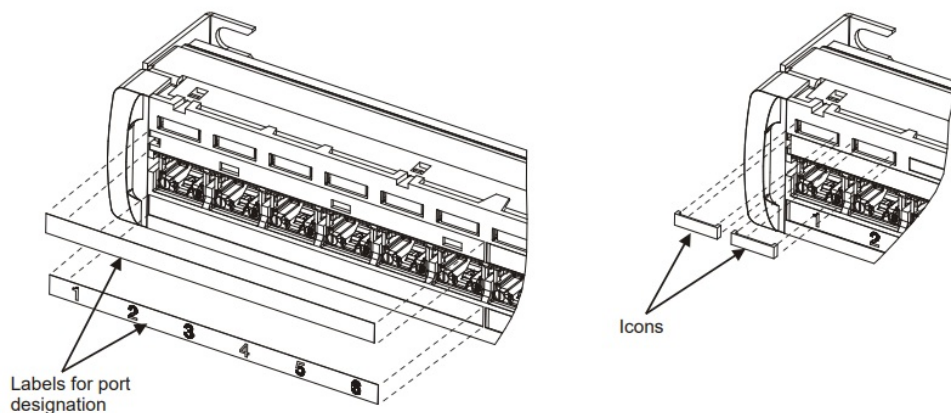

1. Apply labels and icons to front of panel as shown for port designation.

Step 5 Using Module Removal Tool (Part of Removal Tool Kit 760122713)

To Remove End Cap

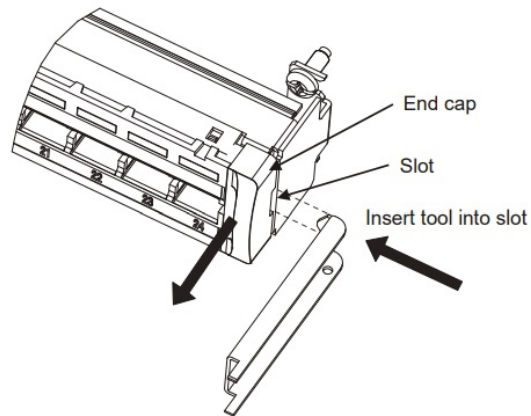

1. Insert provided tool into slot as shown.
2. Use tool to pry end cap loose from panel.

To Remove an Outlet

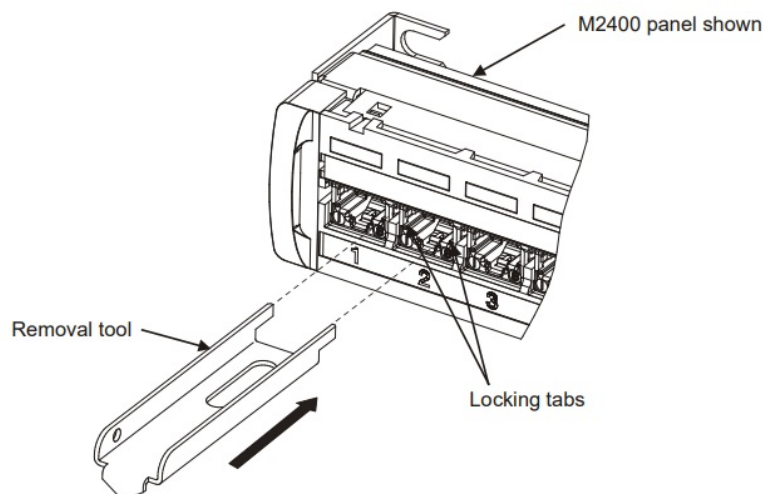

1. Position tool as shown and insert into front of outlet to depress locking tabs.
2. Remove outlet from rear of panel.

To Remove Modular Cap

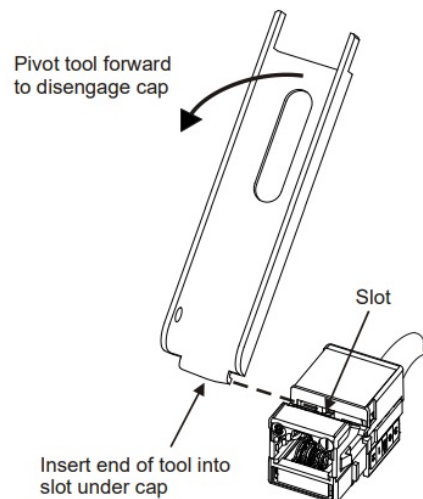

1. Insert tool into slot as shown and pivot forward to disengage modular cap for removal from outlet.

Documents / Resources

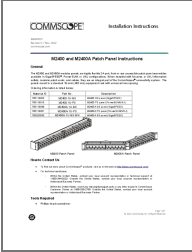
The thumbnail shows the front cover of the 'COMMSCOPE M2400 Patch Panel' instruction manual. It features the COMMSCOPE logo at the top left, followed by the title 'M2400 Patch Panel' and 'Patch Panel'. Below the title is a technical drawing of the patch panel unit. The cover also includes a table of contents and a list of features.

[COMMSCOPE M2400 Patch Panel](#) [pdf] Instruction Manual
M2400 Patch Panel, M2400, Patch Panel, Panel

References

- [CommScope | now meets next](#)
- [CommScope | now meets next](#)
- [CommScope | now meets next](#)