



CommandIQ Ultimate WiFi App Instruction Manual

[Home](#) » [CommandIQ](#) » CommandIQ Ultimate WiFi App Instruction Manual 

CommandIQ Ultimate WiFi App Instruction Manual



Contents

- 1 [Get started with the App](#)
- 2 [Create a Guest Network](#)
- 3 [Parental Control \(Basic\)](#)
- 4 [Update Wi-Fi Network Name and Password](#)
- 5 [Run a Speed Test](#)
- 6 [View Devices on Your Network](#)
- 7 [Notifications](#)
- 8 [Documents / Resources](#)
- 9 [Related Posts](#)

Get started with the App

The app allows you to easily manage your home or small business Wi-Fi network within minutes. Download the app and take control of your Wi-Fi network today!

1. Download the app. You can search either the Apple App Store or Google Play Store for: 'CommandIQ®', then install it on your mobile device.



2. Select "SIGN UP" towards the bottom of the screen.

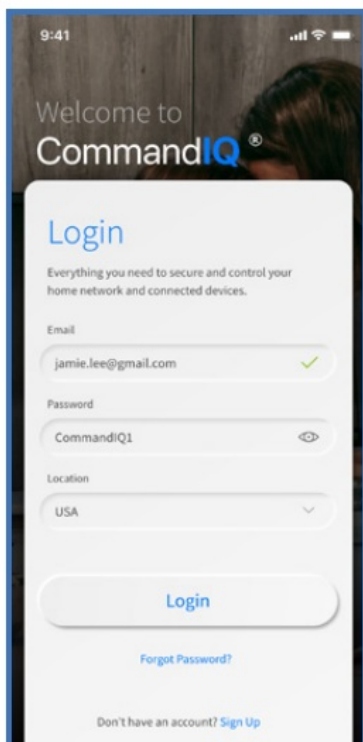

3. Enter your personal information. The password you enter here will be used to access the app.

9:41

Step 1 of 3

Sign Up

Create a new account

First Name

Jamie

Last Name

Lee

Email

jamie.lee@gmail.com

Password

Location

USA

I accept the [terms & conditions](#) & [privacy policy](#)



4. Select "Yes" to continue.

9:41

Step 3 of 3

Setup Wi-Fi

 If you are replacing a router, make sure to use the same Network Name and Password

Network Name (SSID)

Jamie's W

Password

Done

Q W E R T Y U I O P

A S D F G H J K L

Z X C V B N M

5. Tap the QR code that appears within the app. (You will be asked to allow access your camera.) Point your camera at the QR Code found on the bottom of your GigaSpire BLAST System, or on the side of your GigaCenter, (example shown below). Select OK.

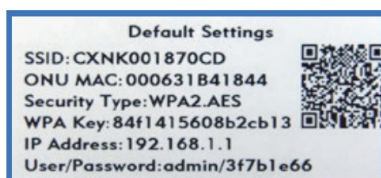

6. Tap the "Click here to skip" text since your Wi-Fi is already working.



Click Submit and you're done!

Create a Guest Network

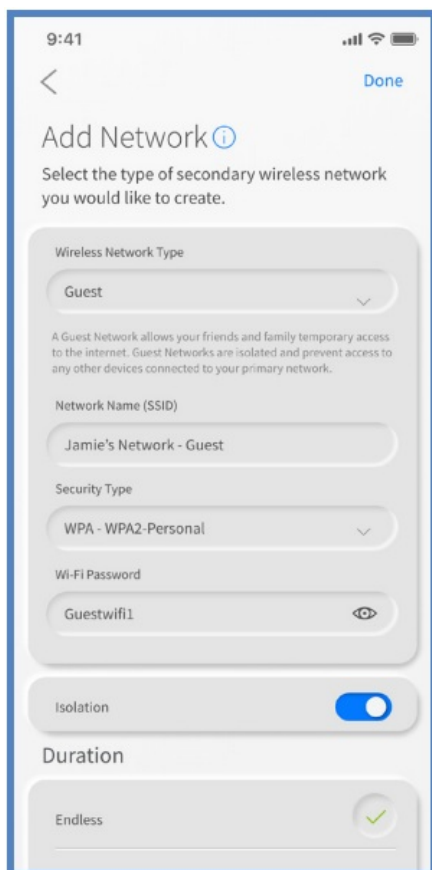

- Tap the “+” icon from the main menu.
- Select “Networks”.
- Select “Guest” in the dropdown menu.
- Give your Guest “Network a Name (SSID)” which will be visible to guests.
- Select “Security Type”, if desired.

- Choose a “Wi-Fi Password”.
- Select isolation if you do not want the user to be able to access your other wireless networks.
- Set the duration to endless or create a custom duration.

Parental Control (Basic)

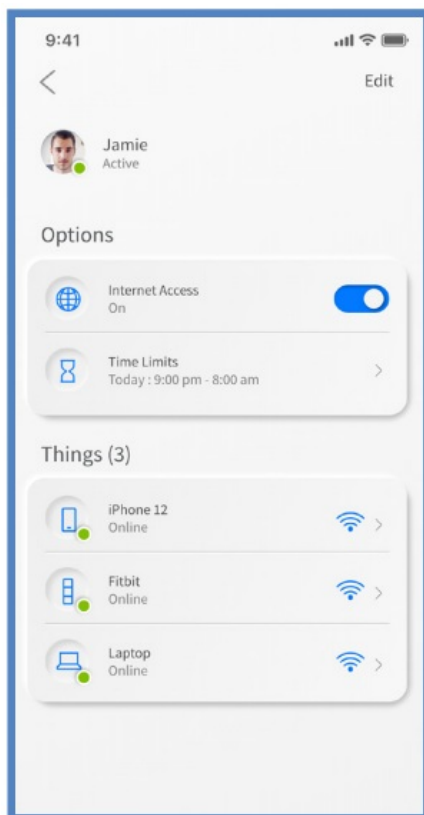

- Tap the “+” icon from the main menu.
- Select “People” to create a new profile.
- Add a name and photo if desired.
- Select the devices which belong to this profile.
- Select “Done”.
- From the home screen, Select “People” and select the desired profile.
- Swipe the “Internet Access” toggle off to pause all devices connected to the profile. Toggle on to bring devices back online.
- Set time limit schedules to turn Internet access off for all assigned devices during specific times and days

Update Wi-Fi Network Name and Password

- Press “My Network” on the Home screen.
- Press “Networks”.
- Select the network you wish to update the name or password for
- Press “Edit” and update your information.

Note: changing your SSID or password will require you to reconnect all your wireless devices previously connected to that network.

Run a Speed Test

- Select “My Network” from the Home screen.
- Select your main router.
- Select “Bandwidth Test”.
- Select “Run Test”.

The speed test will first run between the GigaSpire BLAST and the Internet and then will conduct a speed test between any mesh units and the GigaSpire BLAST. Results will show as a notification in the app and update on the screen.

View Devices on Your Network

- Select “Things” from the Home screen.

Notifications

View notifications from the Home screen by selecting the bell icon in the top right. To edit notifications settings, go to Settings and Notifications.

Need help?

Contact support:

INSERT CONTACT WEBSITE AND/OR TECH SUPPORT PHONE #

www.heartofiowa.cooop

641-486-2211

502 Main St – Union, IA 50258

CommandIQ®

Documents / Resources

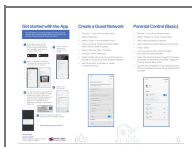

[CommandIQ Ultimate WiFi App](#) [pdf] Instruction Manual
Ultimate, Ultimate WiFi App, WiFi App, App