

COMICA CVM-VM10-K4 Mini and Flexible Smartphone Video Kit User Manual



Contents

1 CVM-VM10-K(1,2,3,4)

1.1 Mini & Flexible Smartphone Video Kit

1.2 User Manual

1.2.1 Foreword

1.2.2 Notice

1.2.3 Main Features

1.2.4 Package Contents

1.2.4.1 CVM-VM10-K1 Package Contents

:

1.2.4.2 CVM-VM10-K2 Package Contents

:

1.2.4.3 CVM-VM10-K3 Package Contents

:

1.2.4.4 CVM-VM10-K4 Package Contents

:

1.2.5 Installation Instructions

1.2.5.1 Flexible Smartphone Clamp:

1.2.5.2 Handle Grip

1.2.6 Bluetooth Remote control Instruction

1.2.7 Specification

2 Documents / Resources

2.1 References

3 Related Posts

CVM-VM10-K(1,2,3,4)

Mini & Flexible Smartphone Video Kit



User Manual

Foreword

Thanks for purchasing Comica Multi-functional Smartphone Video Kit, it's designed in many different combinations for your versatile use, and integrated into multi-functions like: 'Bluetooth One-touch Control' `Exquisite Smartphone Clamp' 'Extensible with Flexible Combinations' etc., which can make your shooting more

professional.

To ensure the safety of the product, please carefully read the user manual for correct installation and operation.

Notice

1. Be careful to follow the assembly steps, otherwise, the parts cannot be paired, which will affect the use.
2. This product has a variety of assembly methods, please assemble correctly according to the needs of users.
3. Bluetooth remote control is an electronic component. Do not use it in rain or humid environment.
4. This product has many small parts, please do not swallow it to avoid life-threatening
5. Do not throw away used batteries, so as to avoid environmental pollution.
6. This Bluetooth remote control is small in size, so please do not place it at will, causing loss and affecting use.
7. Please read the user manual carefully before using.

Main Features

- Detachable Electronic Bluetooth Remote Control for One-touch Video Shooting;
- Compatible with both IOS and Android System;
- Exquisite Smartphone Clamp, Easy to Install;
- Extensible with Flexible Combination;
- Fit for External Accessories like Microphones, LED lights, etc;
- All Metal Material with CNC Processing, Solid and Durable;



One-touch control



Detachable Bluetooth remote control



Easy to install



Flexible combination



Support IOS and Android



CNC processing

Package Contents

CVM-VM10-K1 Package Contents :

1. Microphone
2. Flexible Smartphone Clamp
3. Ordinary Handle Grip (1/4 screw)
4. TRS-TRRS Audio Output Cable for Smartphone

5. WindMuff
6. Portable Case
7. User Manual
8. Warranty Card

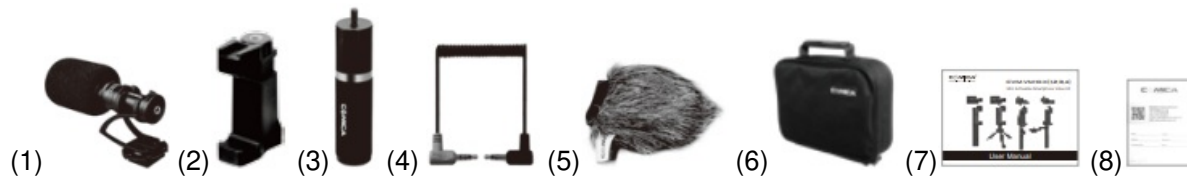

CVM-VM10-K2 Package Contents :

1. Microphone
2. Flexible Smartphone Clamp
3. Tripod
4. TRS-TRRS Audio Output Cable for Smartphone
5. WindMuff
6. Portable Case
7. User Manual
8. Warranty Card

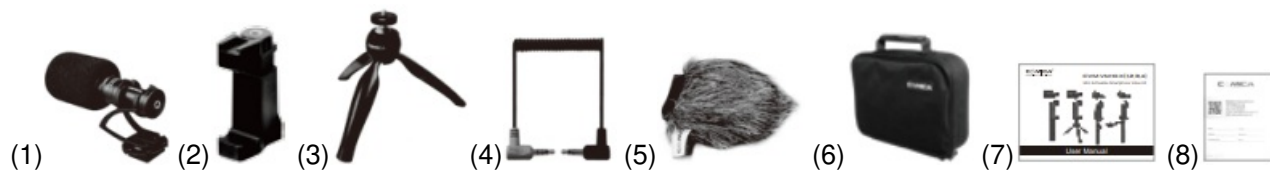

CVM-VM10-K3 Package Contents :

1. Microphone
2. Flexible Smartphone Clamp
3. Electronic Handle Grip
4. Handle Grip Screw
5. TRS-TRRS Audio Output Cable for Smartphone
6. WindMuff
7. Portable Case
8. User Manual
9. Warranty Card

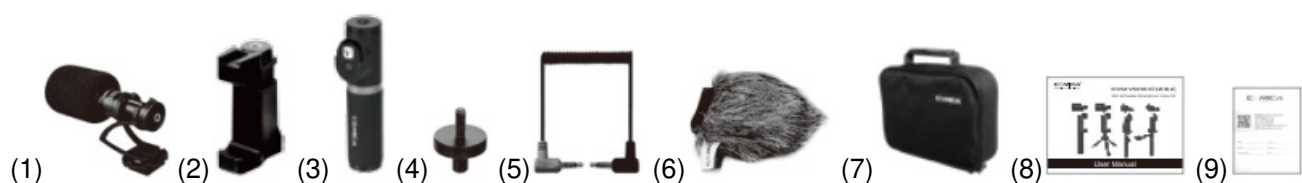

CVM-VM10-K4 Package Contents :

1. Microphone

2. Flexible Smartphone Clamp
3. Ordinary Handle Grip(3/8 Screw Hole)
4. Handle Grip Screw
5. Connecting Rod
6. Cold Shoe
7. Connecting Screw
8. TRS-TRRS Audio Output Cable for Smartphone
9. Windmuff
10. Portable Case
11. User Manual
12. Warranty Card

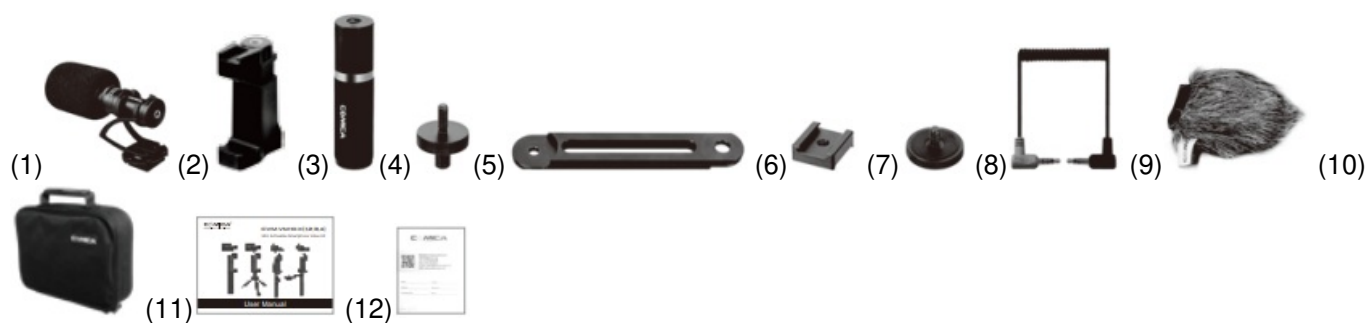

Installation Instructions

Flexible Smartphone Clamp:

1. Install your smartphone onto the flexible smartphone clamp

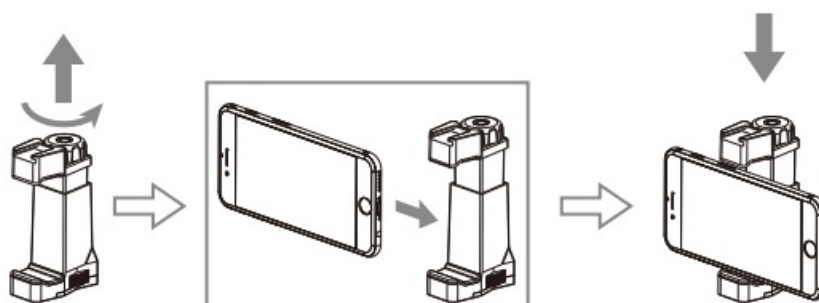

2. Connect the microphone to the Smartphone clamp

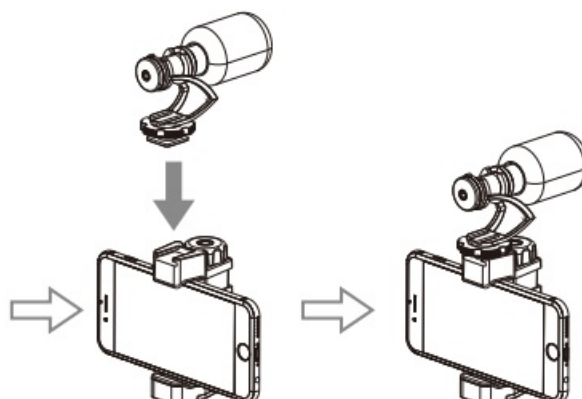

3. Connect the microphone to your smartphone with TRS-TRRS audio output cable

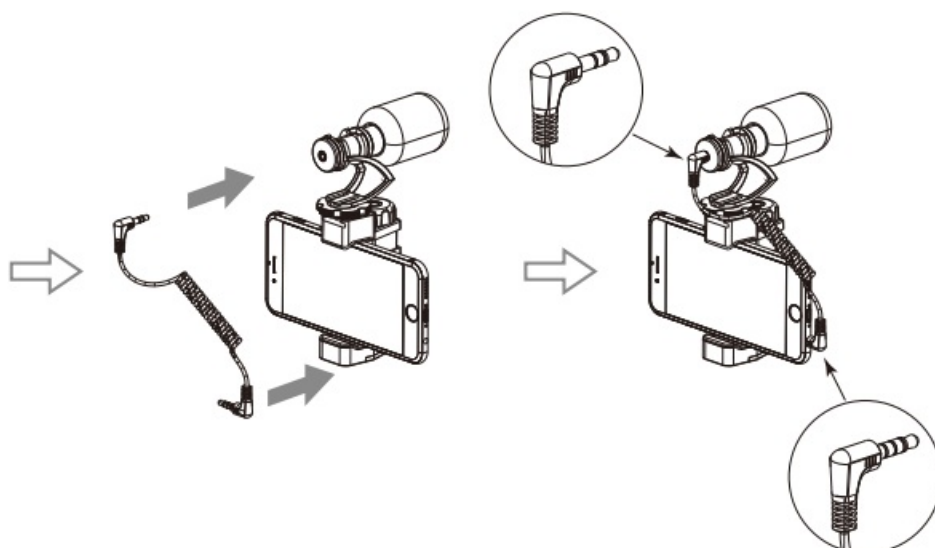

👉 1. Please note that you should connect Cable's TRS end to the microphone, and Cable's TRRS end to the smartphone. Otherwise it'll not work.

2. While you work with the smartphone with Lightning or Type-C interface, you should buy (3.5mm-Lightning, 3.5mm-Type-C) and connect the cable adapter separately.

Handle Grip

CVM-VM10-K1 Kits :

Install the flexible smartphone clamp to the ordinary handle Grip (with 1/4 Screw), then fixing them through smartphone clamp locking screw.

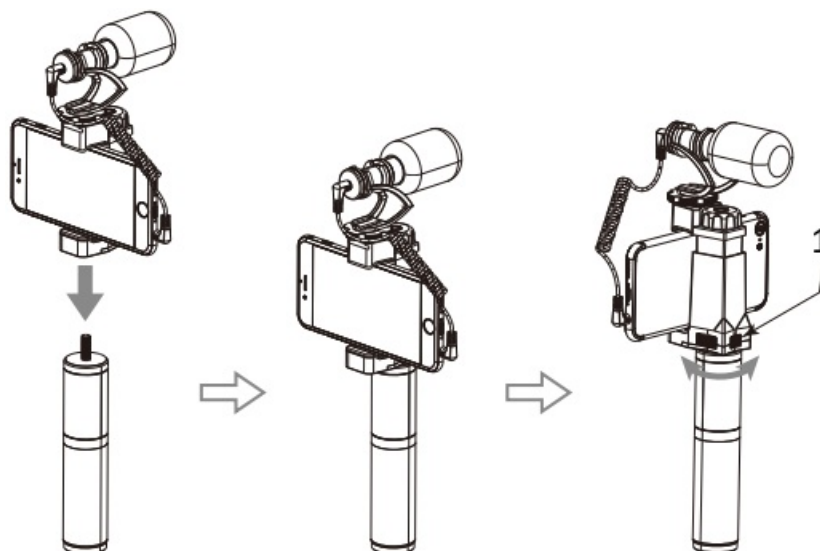

1. Smartphone Clamp Locking Screw

CVM-VM10-K2 Kits :

Install the flexible smartphone clamp to the tripod, then fixing them through smartphone clamp locking screw, and adjust to the suitable angle for shooting.

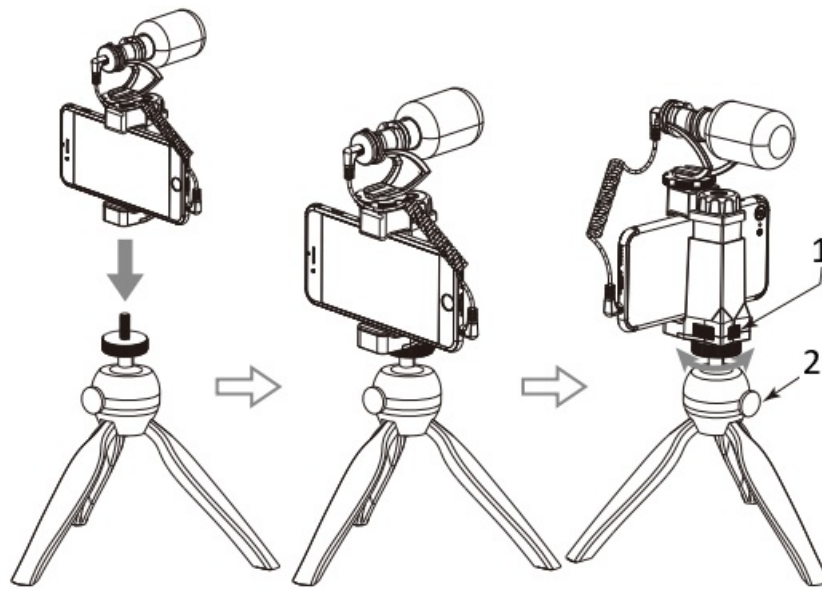

1. Smartphone Clamp Locking Screw
2. Tripod Adjusting Screw

CVM-VM10-K3 Kits :

Install the smartphone clamp to the electronic handle grip, lock them through smartphone locking screw.

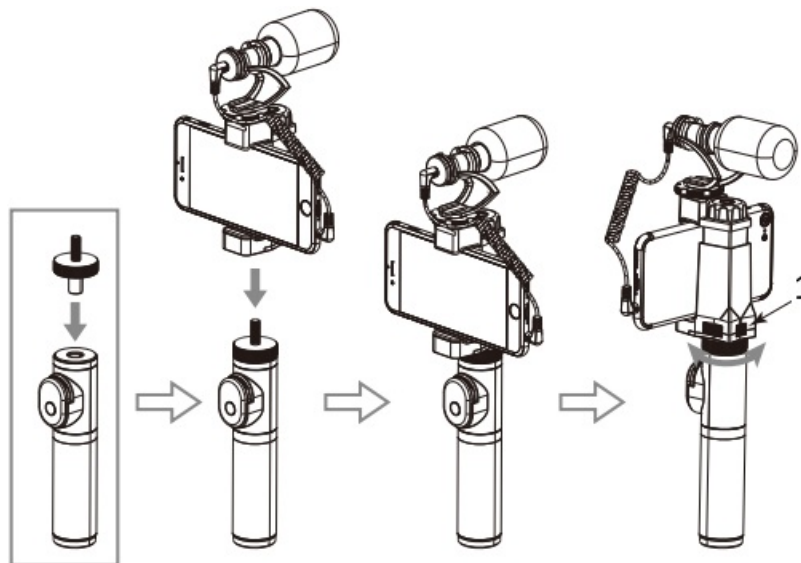

1. Smartphone Clamp Locking Screw

CVM-VM10-K4 Kits :

1. Install the cold shoe, connecting thread screw, ordinary thread screw and connecting rod to ordinary handle grip(with 3/8 Screw)

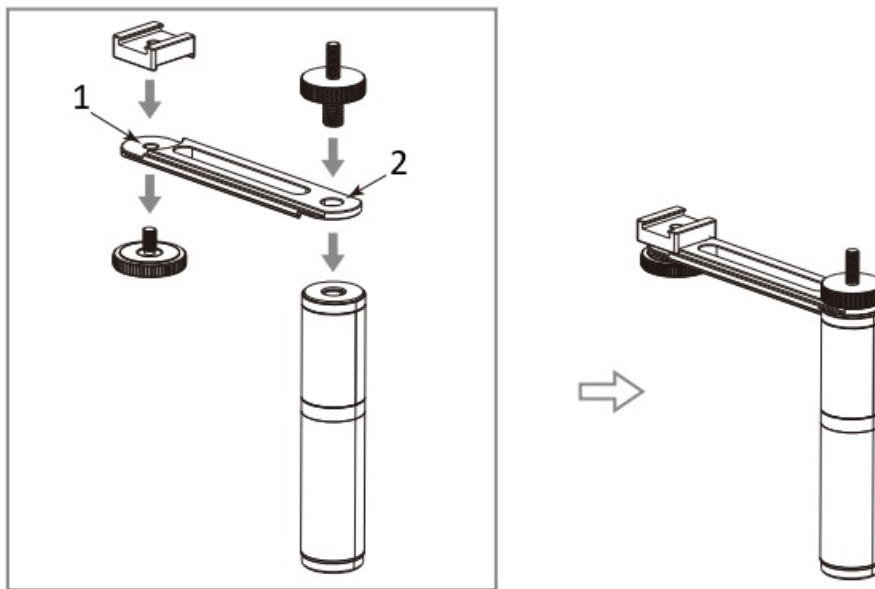

1. 1/4 Screw

2. 3/8 Screw

2. Install the flexible smartphone clamp to ordinary handle grip(with 3/8 Screw), then lock them through smartphone clamp screw

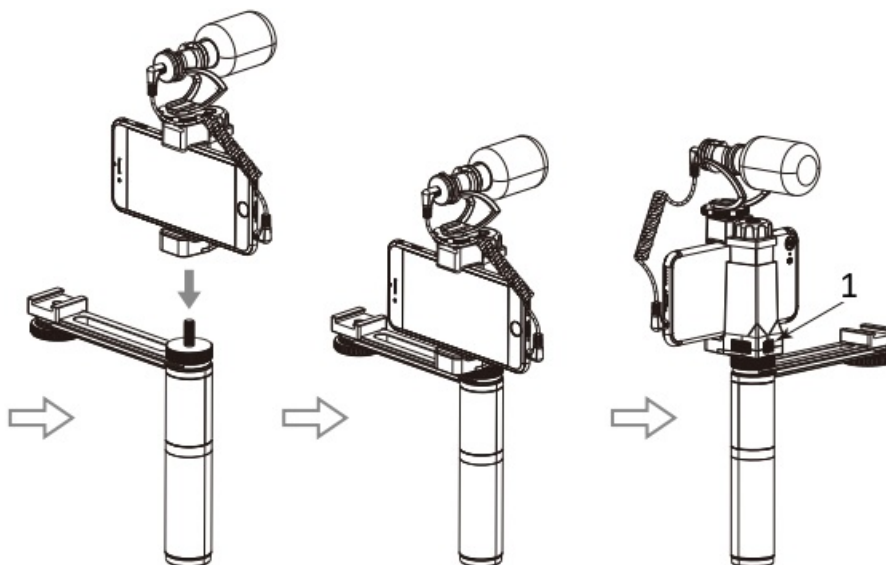

1. Smartphone Clamp Locking Screw

Bluetooth Remote control Instruction

First Step: Start the Bluetooth Remote Control

Press and hold for 2 seconds to start the Bluetooth remote control. When the blue light flickers, find and connect the ViewFlex-H on the smartphone Bluetooth device. If it is connected, the blue light will go out; if it is not connected, the blue light will flicker once every second

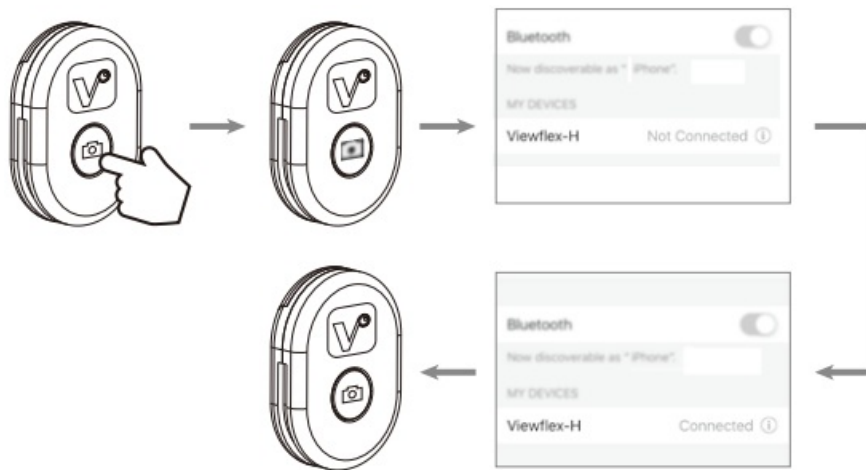

Second Step: Functional operation

Photo Mode:

1. (In the Bluetooth remote control state) When the phone is connected to the View Flex-H Bluetooth device, adjust the smartphone to the photo mode. At this time, the Bluetooth remote control button can replace the smartphone photo button. Short press once, the green light will flicker 3 times and take a picture

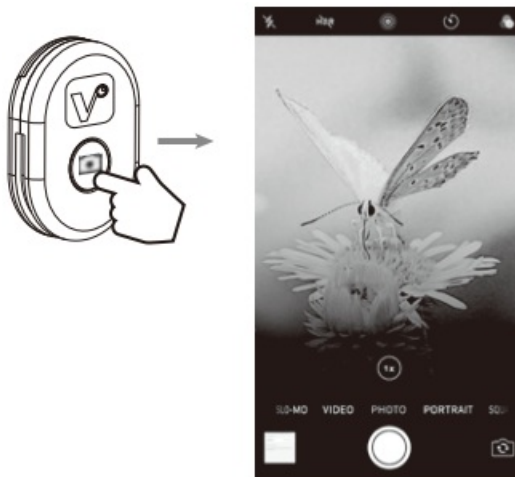

2. Press and hold the Bluetooth remote control button for three seconds, when the green light is on, release the button, and the green light flickers 3 times, the smartphone enters the automatic continuous shooting mode (The continuous shooting time lasts for 3 seconds, and the number of photos is subject to the smartphone)

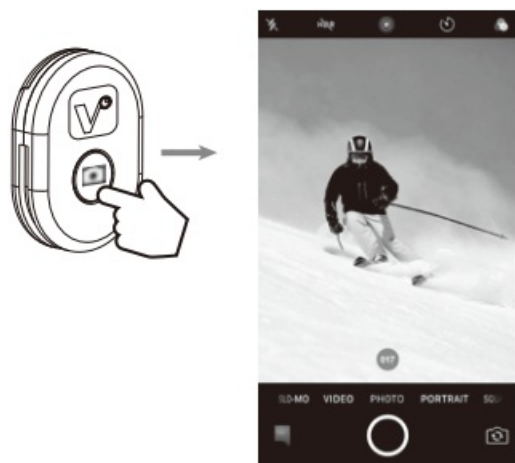

Continuous shooting function is only used for rear camera

Video Mode:

Enter the smartphone video mode, short press the Bluetooth remote control button, the smartphone starts recording, press the Bluetooth remote control button again, then the green light flickers 3 times and the video recording ends

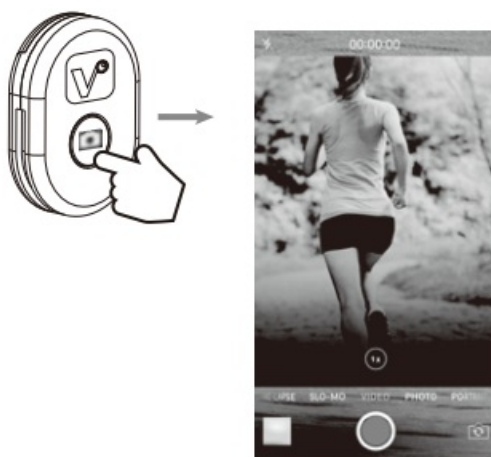

Bluetooth Disconnection:

1. Automatic disconnect

After 10 minutes of no operation, Bluetooth remote control automatically turns off.

2. Manual disconnect

Press and hold the Bluetooth remote control button for 6 seconds. When the blue light is on and start flickering once every second, the smartphone is disconnected from the Bluetooth remote control, and you can reconnect different smartphones

Specification





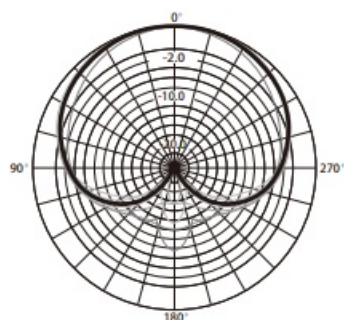

Microphone

Polar Pattern	Cardioid
Frequency Range	60Hz~20kHz
Sensitivity	-33dB \pm 2dB
Signal/Noise	>75dB
Maximum SPL	>105dB
Operating Voltage	1.0V~10V

Polar Pattern



Frequency:

- 125 Hz: 
- 250 Hz: 
- 500 Hz: 
- 1000 Hz: 
- 2000 Hz: 
- 4000 Hz: 
- 8000 Hz: 

Frequency Response

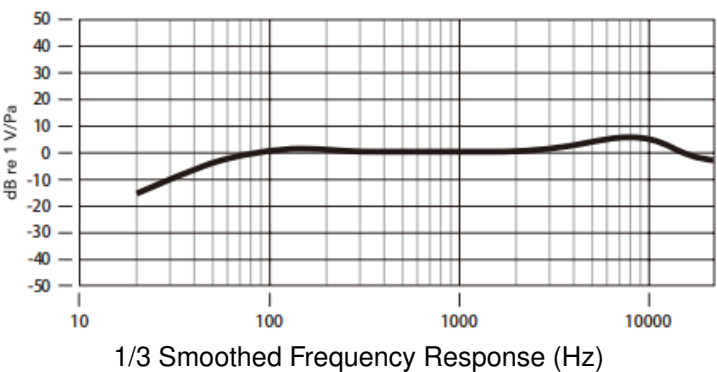

Bluetooth Remote

Version	3.0
Effective Distance	10m
Battery	CR2032 x 1
Power off automatically while no operation	10 Minutes
Size	35x25x8.4mm



www.comica-audio.com

The COMICA logo is trademark which is registered and owned by Commlite Technology Co.,Ltd
Email: support@comica-audio.com



[COMICA CVM-VM10-K4 Mini and Flexible Smartphone Video Kit](#) [pdf] User Manual
CVM-VM10-K4 Mini and Flexible Smartphone Video Kit, CVM-VM10-K4, Mini and Flexible Smartphone Video Kit, Flexible Smartphone Video Kit, Smartphone Video Kit, Video Kit

References

- [Q audio.com - a better way to upload and share audio online](#)
- [Manual-Hub.com - Free PDF manuals!](#)
- [User Manual](#)

Manuals+, Privacy Policy

This website is an independent publication and is neither affiliated with nor endorsed by any of the trademark owners. The "Bluetooth®" word mark and logos are registered trademarks owned by Bluetooth SIG, Inc. The "Wi-Fi®" word mark and logos are registered trademarks owned by the Wi-Fi Alliance. Any use of these marks on this website does not imply any affiliation with or endorsement.