



# COMICA Broadcasting-Level Multi-functional Mini UHF Wireless Microphone User Manual

[Home](#) » [COMICA](#) » COMICA Broadcasting-Level Multi-functional Mini UHF Wireless Microphone User Manual

## Contents [ [hide](#) ]

- [1 Broadcasting-Level Multi-functional Mini UHF Wireless Microphone](#)
- [2 Technology Parameters](#)
- [3 Main Features](#)
- [4 Packing List](#)
  - [4.1 Purchase Options:](#)
- [5 Accessories:](#)
- [6 Components and Instruction](#)
  - [6.1 Transmitter \(TX\):](#)
  - [6.2 Receiver \(RX\)](#)
- [7 Installation](#)
- [8 Function and Usage](#)
- [9 Receiver \(RX\) Screen Display Instruction:](#)
  - [9.1 Receiver \(RX\) Operation Instruction:](#)
- [10 Pairing Method](#)
- [11 Specification](#)
- [12 Documents / Resources](#)
- [13 Related Posts](#)

**Broadcasting-Level Multi-functional Mini UHF Wireless Microphone**



**Technology Parameters**

Transmitter

Channels	48
Group A Wireless Frequency	568.125MHz ~ 579.875MHz
Group B Wireless Frequency	580.125MHz ~ 591.875MHz
Transmitting Power	15dBm

Receiver (RX)

Channels	48
Group A Wireless Frequency	568.125MHz ~ 579.875MHz
Group B Wireless Frequency	580.125MHz ~ 591.875MHz

**Foreword**

Thanks for purchasing COMICA BoomX-U Broadcasting-Level Multi-functional Mini UHF Wireless Microphone. To ensure bring you a good using experience, please read this manual book carefully before using and correctly install and operate.

## Main Features

- Mini and Portable, Broadcast Level
- Dual-Channel UHF Wireless Microphone
- Internal and External Mic Two Input Modes
- Working Distance is Up to 120m
- Multiple Channels Used for Several Devices
- Working Together
- Auto-scanning and Quick IR Pair
- LCF, M/S Switch, 16-Levels Adjusted Gain Control, Muting

### Functions

- Real-time Visual Power and Audio Dynamic Monitor
- Special Anti-loose Design for External Lavalier Mic
- Colorful TFT Display, High Resolution
- Support Screen Flip
- Designed with Multi-functional Belt Clip and Compact

## Notice

- Please make sure the IR sensor are closely aligned when pairing
- Don't block the antenna position to avoid any poor signal generated
- Please attention that it can not realize STEREO function when in single channel mode
- It is recommended to adjust the antenna of transmitter and receiver to appropriate angle for stable transmission and long working distance
- It is recommended to keep a distance more than one meter between the two transmitters when using IR sync function, or it is easy to cause mismatching
- This product belongs to high-precision instruments, please avoid falling, collision or pounding
- Do not use this equipment in the vicinity of heat source or interference source, such as radiator, oven, WIFI AP, intercom or next to the other wireless devices
- If the pick-up distance is close or when used outdoors, please put on the wind muff to prevent sound burst or reduce wind noise
- Do not use the equipment in rain or in a damp environment to avoid short-circuit danger
- Please keep the product in a dry environment.

## Packing List

### Main Parts:

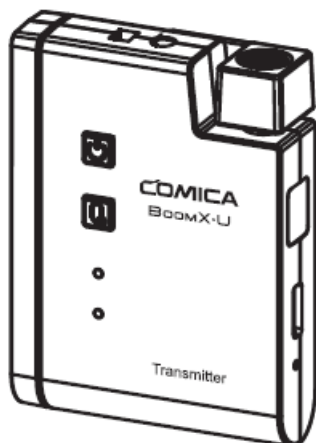

Transmitter(TX)

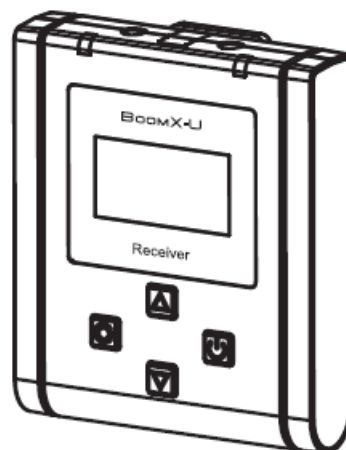

Receiver (RX)

### Purchase Options:



U1 = TX + RX



U2 = TX + TX + RX

### Accessories:

1. 3.5mm Lavalier Mic
2. Wind Muff
3. 3.5mm TRS-TRRS Audio Cable
4. 3.5mm TRS-TRS Audio Cable
5. 3.5mm-XLR Audio Output Cable
6. USB A-USB C Charging Cable
7. Carry Case
8. User Manual
9. Warranty Card



The accessories of each combination include :

U1= ①+②+③+④+⑤+⑥+⑦+⑧+⑨

U2= ①x2+②x2+③+④+⑤+⑥+⑦+⑧+⑨

### Components and Instruction

#### Transmitter (TX):

1. Power / Low Cut Filter Button

2. Muting Button
3. Power / Low Cut Filter Indicator Light
4. Audio Status Indicator Light
5. External Mic Locking Buckle
6. 3.5mm TRS Port of External Mic
7. Internal Mic
8. IR Sensor
9. USB-C Charging Port
10. Reset Hole
11. Belt Clip
12. Antenna

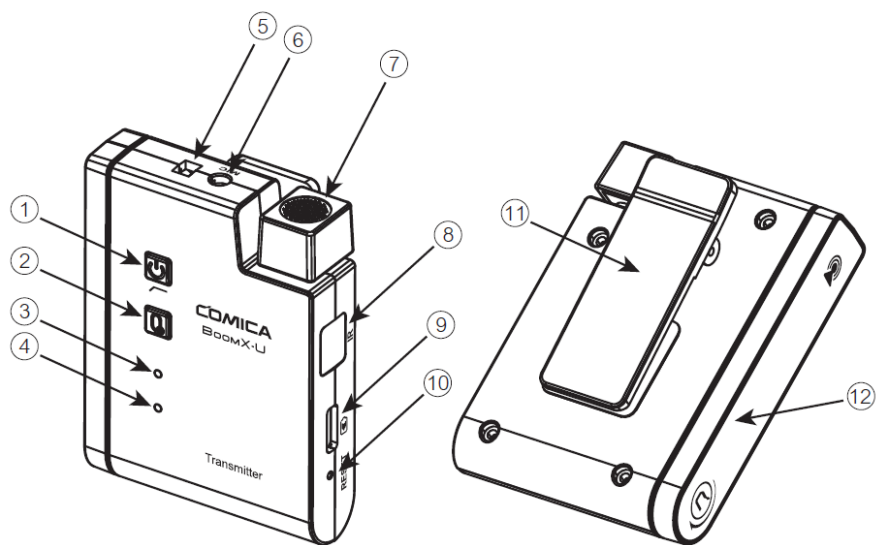

## Receiver (RX)

1. Menu Function Button +
2. Function Setting Button
3. Menu Function Button -
4. Group A Working Status Indicator
5. 3.5mm TRS/TRRS Monitoring Port
6. IR Sensor
7. 3.5mm TRS Audio Output Port
8. Group B Working Status Indicator
9. Reset Hole
10. USB-C Charging Port
11. Power Button
12. Belt Clip
13. Group A Antenna
14. Group B Antenna

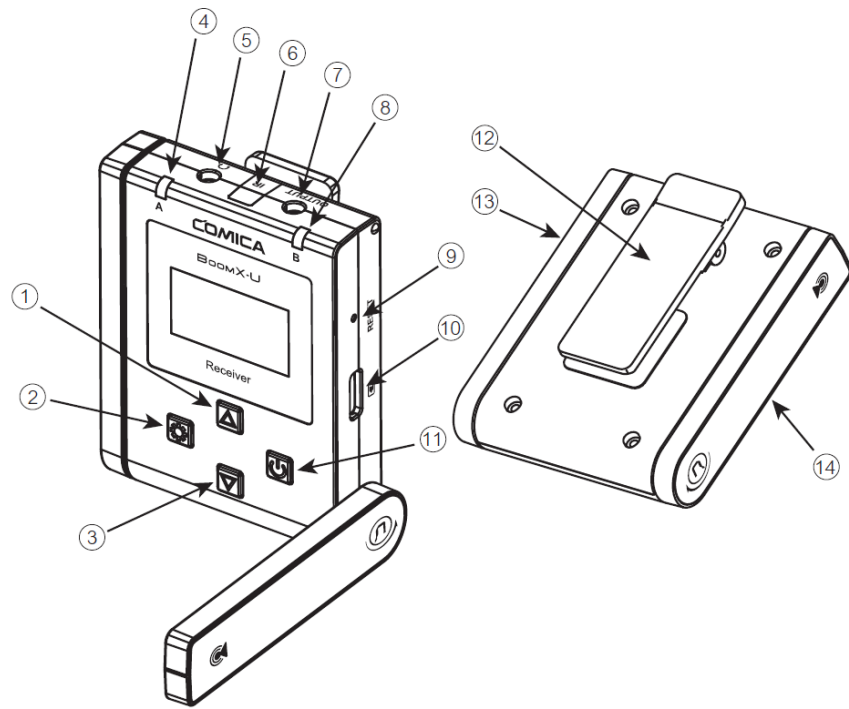

## Installation

### Transmitter (TX)

#### 1. Use internal microphone :

Adjust the antenna angle; Install the transmitter on the collar through the belt clip so that the internal microphone points in the direction of the sound source.

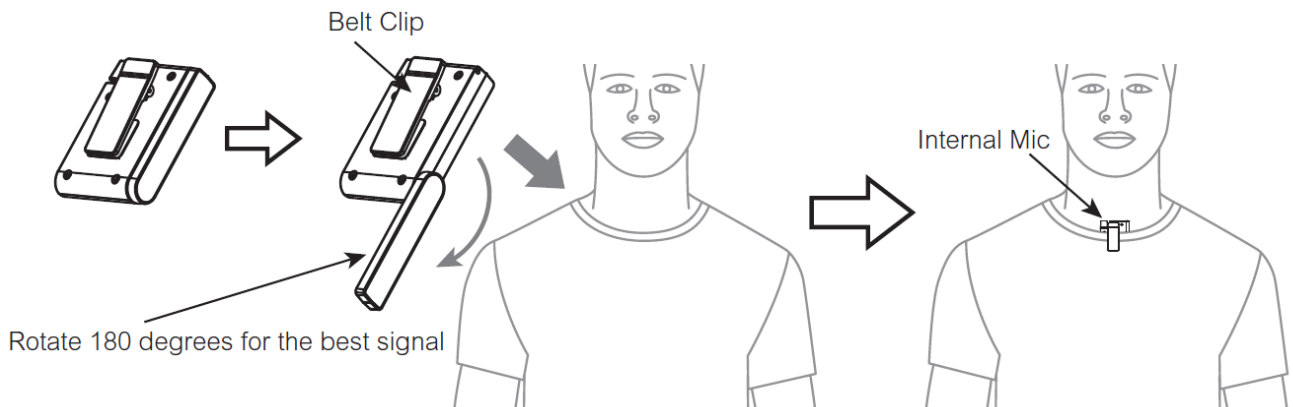

For better concealment during use, it is recommended that the belt clip be fixed and used outwards

#### 2. Use external microphone:

Insert the 3.5mm TRS microphone input cable into the transmitter's 3.5mm TRS external microphone port and tighten it, then clip the transmitter to the belt through the belt clip and clip the lavalier microphone to your collar

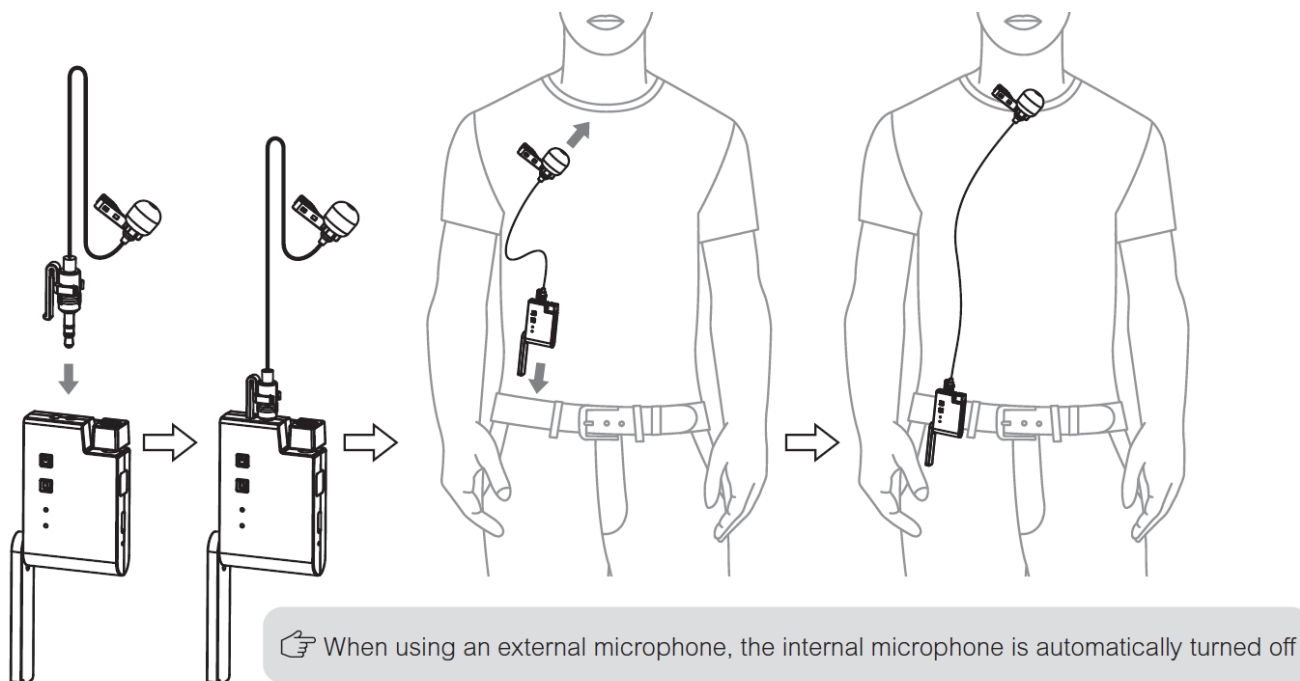

## Receiver (RX)

### 1. Work with Camera:

Adjust the antenna angle; Fix the receiver through the belt clip to the camera's hot shoe mount, then connect the receiver with camera through the 3.5mm TRS-TRS audio cable; Insert the headphone into the monitoring port for monitoring

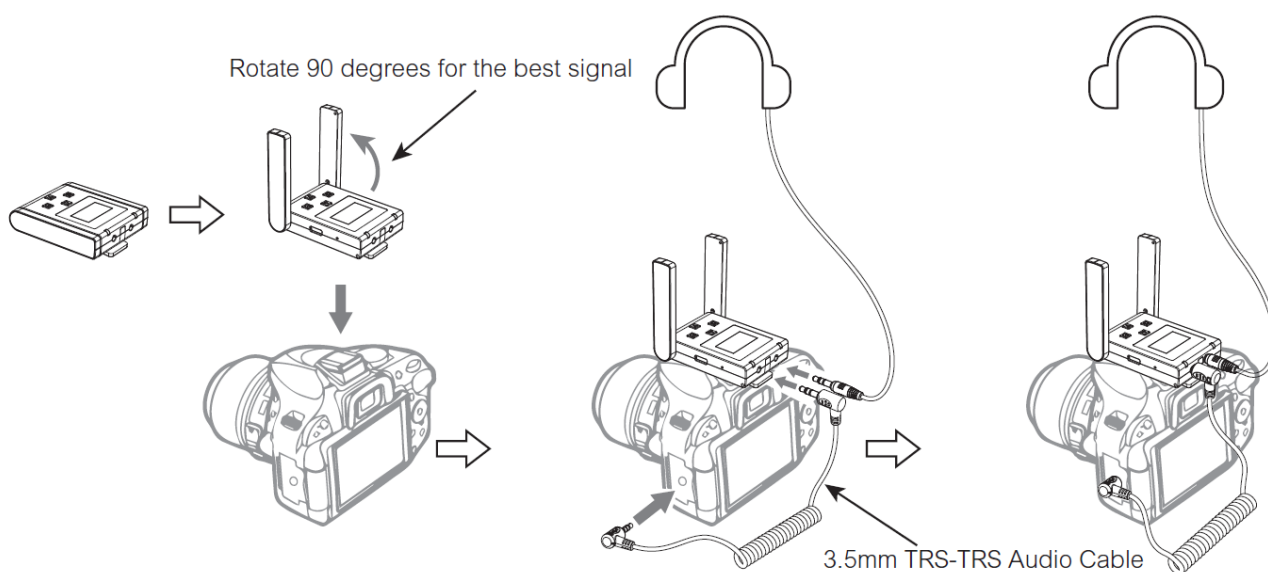

### 2. Work with Smartphone:

Clip the receiver to the cold shoe mount through the belt clip; Connect the receiver with the mobile phone through the 3.5mm TRS-TRRS audio cable and pay attention to the access to the audio output jack of the receiver is the 3.5mm TRS plug, and the access to the mobile phone is the 3.5mm TRRS plug; Insert the headphone to the 3.5 mm TRS/TRRS monitoring port for monitoring.

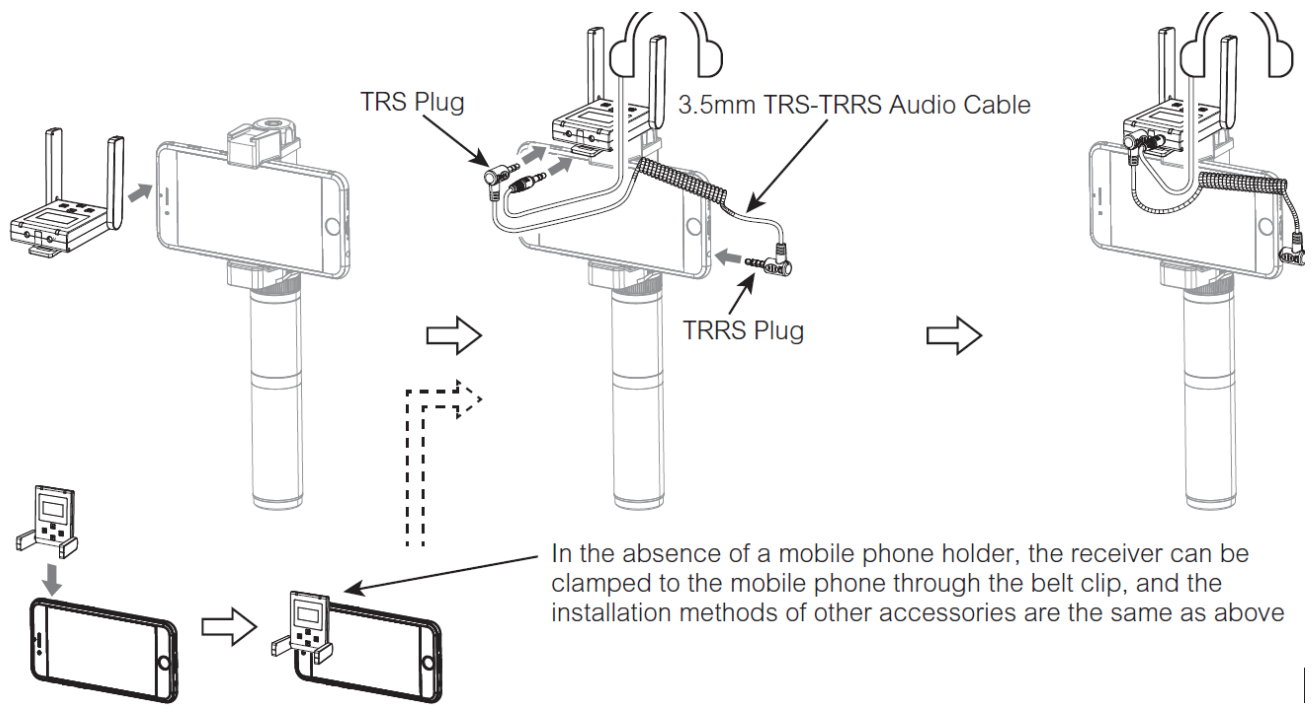

## Function and Usage

### Transmitter (TX)

#### Function Introduction:

1. Power /Low Cut Filter Button  
Long press for On/Off; Short press for Low Cut Filter
2. Muting Button  
Long press to switch between normal recording and mute
3. Power /Low Cut Filter Indicator Light  
Blue light keeps on after turn on the Transmitter; Purple light keeps on after turn on Low Cut Filter mode; Red light flicker when pairing transmitter and receiver or low power; Red light keeps on when charging
4. Audio Status Indicator Light  
Blue light flicker when sound is input; Red light keeps on when sound is crackled or mute status
5. Reset Hole  
If there is an abnormal phenomenon such as the device is crash or unable to turn on it, then insert the reset pin into the reset hole to reset it.
6. Internal Mic  
Turn the Mic to the sound source
7. 3.5mm TRS External Microphone Port  
Insert the 3.5mm TRS microphone input cable, and you can use the external lavalier microphone for recording. At this time, the internal microphone of this device is automatically turned off
8. IR Sensor  
It's paired successfully only when the receiver and transmitter's IR sensor are closely aligned
9. USB-C Charging Port  
Connect the transmitter with the 5V power through the USB A-USB C charging cable to charge



## **Receiver (RX)**

### **Receiver (RX) Function Introduction:**

1. Power Button  
Long press for On/Off; Short press on the function menu interface to exit the current interface
2. SET Function Button  
Short Press can enter the setting display page, then adjust the related function
3. Function Selection Button +  
Short Press for function adjustment (+)
4. Function Selection Button –  
Short Press for function adjustment (-)
5. Group A/B Working Status Indicator  
Indicator light is off when unpaired; Blue light keeps on after paired successfully; Red light flicker when low power; Red light keeps on when charging
6. 3.5mm TRS Audio Output Port  
Connect with mobile phone through the 3.5mm TRS-TRRS audio cable; Connect with camera through the 3.5mm TRS-TRS audio cable
7. IR Sensor  
It's paired successfully only when the receiver and transmitter's IR sensor are closely aligned
8. 3.5mm TRS/TRRS Monitoring Port  
Insert headphone to monitor
9. Screen Flip Function  
You can flip the screen 180 degrees to use according to different scenes
10. Reset Hole  
If there is an abnormal phenomenon such as the device is crash or unable to turn on it, then insert the reset pin into the reset hole to reset it
11. USB-C Charging Port  
Connect the receiver with the 5V power through the USB A-USB C charging cable to charge

## Receiver (RX) Screen Display Instruction:

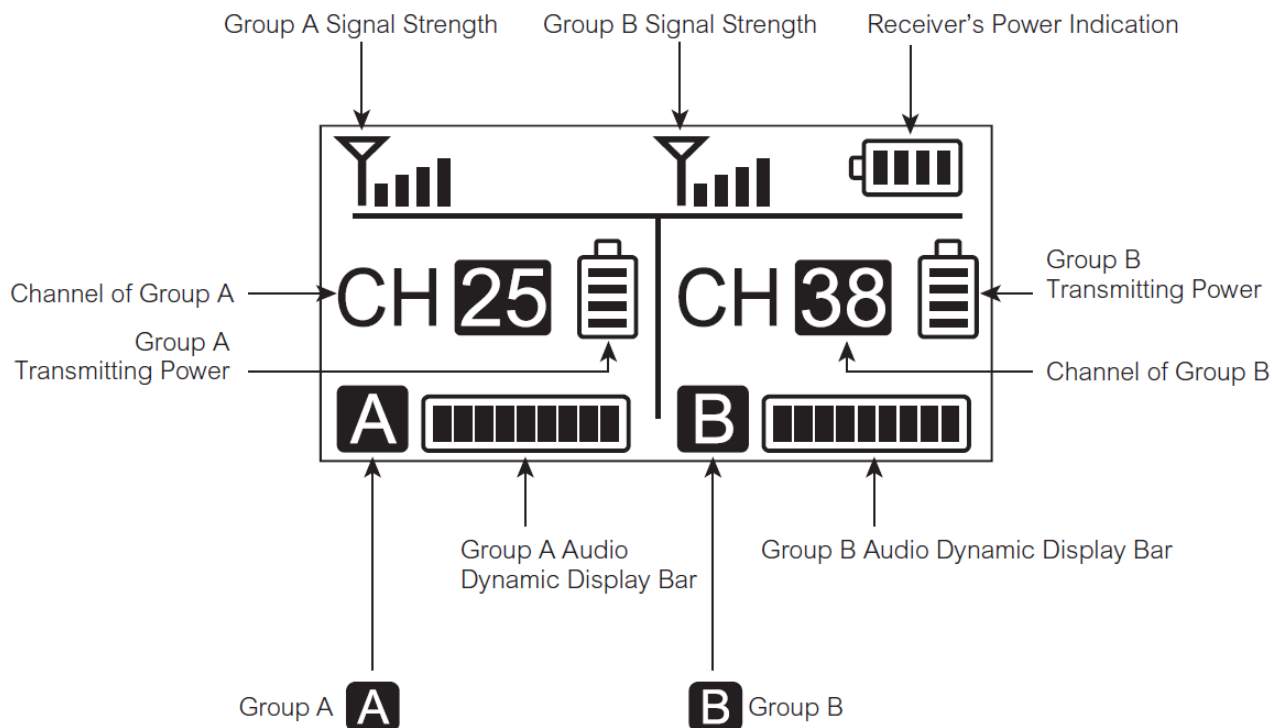

## Receiver (RX) Operation Instruction:

### 1. Pairing of Group A/B

Short press button to "setting" display page; press button to Pair mode of Group A or Group B

Short press button for adjustment, press button to select whether or not pairing, then short press to confirm. It will show "Paired CHXX" to prompt the channel of Paired after successful pairing; it will show "Fail" after unsuccessful pairing.

Please turn on the transmitter and make sure the IR sensor are closely aligned when pairing or it may cause failed pairing! Short press button to back to home screen ( The operation methods for other interfaces are the same as above )

### 2. Volume Adjustment

Group A/B Volume Adjustment

### 3. 'Stereo/Mono' Mode Adjustment

A channel is the left channel and B channel is the right channel in Stereo Mode. Please attention that it can not realize STEREO function when in single channel mode

### 4. Screen Flip Function

You can flip the screen 180 degrees to use according to different scenes

### 5. Version

Menu Version X.X.X

## Pairing Method

### Dual-Channel Mode:

#### 1. Set the display page to A/B Group Pairing

Menu Group A Pair Yes      or      Menu Group B Pair Yes

2. Keep the receiver and transmitter's IR sensor are closely aligned before pairing

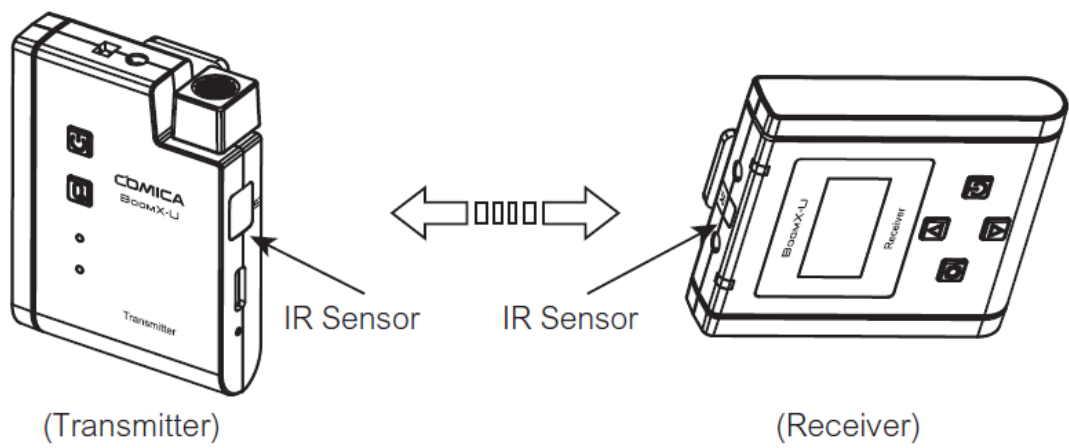

3. Use the pairing function to pair the two transmitters respectively for the A/B Group

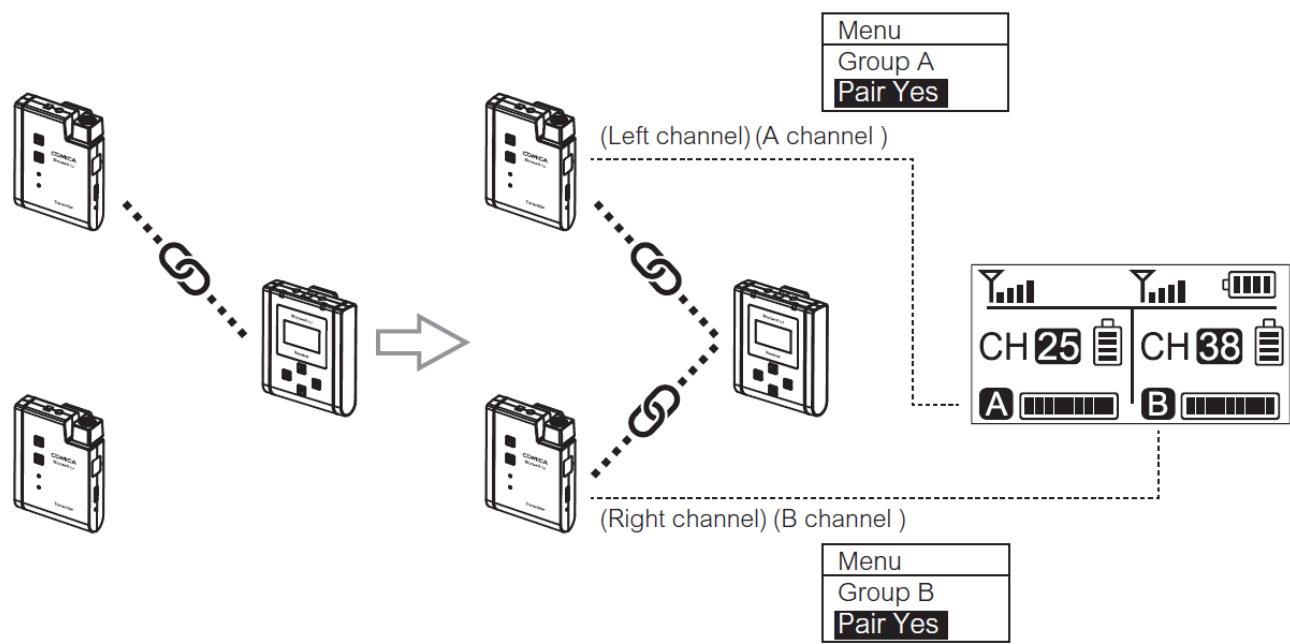

Specification

Transmitter (TX)		Receiver (RX)	
Antenna	PCB Antenna	Antenna	PCB Antenna

Polar Pattern	Omnidirectional
Frequency Response	80Hz ~ 20kHz
Sound Delay	<20ms
External Mic Input Interface	3.5mm TRS
Battery	Li-ion Battery 600mAh 3.7V
Battery Life	6 Hours
Net Weight	47g
Dimension	49 x 22 x 66mm
Operating Temperature	0°C ~ 50°C
Storage Temperature	-20°C ~ 60°C

Receiving Sensitivity	-90dBm
Sound Delay	<20ms
External Mic Input Interface	3.5mm TRS
Monitor Interface	3.5mm TRS/TRRS
Battery	Li-ion Battery 600mAh 3.7V
Battery Life	6 Hours
Net Weight	55g
Dimension	49 x 22 x 66mm
Operating Temperature	0°C ~ 50°C
Storage Temperature	-20°C ~ 60°C



## Documents / Resources



[COMICA Broadcasting-Level Multi-functional Mini UHF Wireless Microphone](#) [pdf] User Manual  
Broadcasting-Level Multi-functional Mini UHF Wireless Microphone, BoomX-U