



Flex Compact eW Color Kinetics Instruction Manual

[Home](#) » [COLOR KINETICS](#) » Flex Compact eW Color Kinetics Instruction Manual 

Contents

- [1 Flex Compact eW Color Kinetics](#)
- [2 SAFETY SAFEGUARDS](#)
- [3 Installation Instructions](#)
- [4 Documents / Resources](#)
 - [4.1 References](#)
- [5 Related Posts](#)

COLOR KINETICS

Flex Compact eW Color Kinetics



SAFETY SAFEGUARDS

- Must be installed by a qualified electrician in accordance with all national and local electrical and construction codes and regulations.
- Before installing this product, please visit the product page at www.colorkinetics.com for the latest version of the installation instructions. Due to continuous improvements and innovations, installation instructions may change without notice.
- Ensure that the main power supply is off before installing or wiring a luminaire.
- Ensure that the device is securely attached, properly mounted, and free of excessive vibration.
- Do not attempt to install or use a luminaire until you read and understand the installation instructions and safety labels.
- Do not use a luminaire if the lens, housing, or power cables are damaged.
- Do not use a luminaire for any voltage for which it is not rated. Do not exceed the specified voltage and current input for any luminaire.
- Do not hot swap luminaires. Ensure that power to the series is off before connecting or disconnecting individual luminaires.
- Ensure that the device is securely attached, properly mounted, and free of excessive vibration.
- **Warning** This is a Class A product. In a domestic environment, this product may cause radio frequency interference in which case the user may be required to take adequate measures.
- This device complies with Part 15 of the FCC Rules. Operation is subject to the following two conditions: (1) this device may not cause harmful interference, and (2) this device must accept any interference received, including interference that may cause undesired operation.
- Do not clean lenses with products containing sodium hydroxide. Use a mild, non-abrasive cleaner
- This product contains a light source of energy efficiency class G. For additional Energy Efficiency Class Information, please refer to <https://colorkinetics.helpdocs.io/article/cviis2p8qq>.

Installation Instructions

1. Confirm all components received

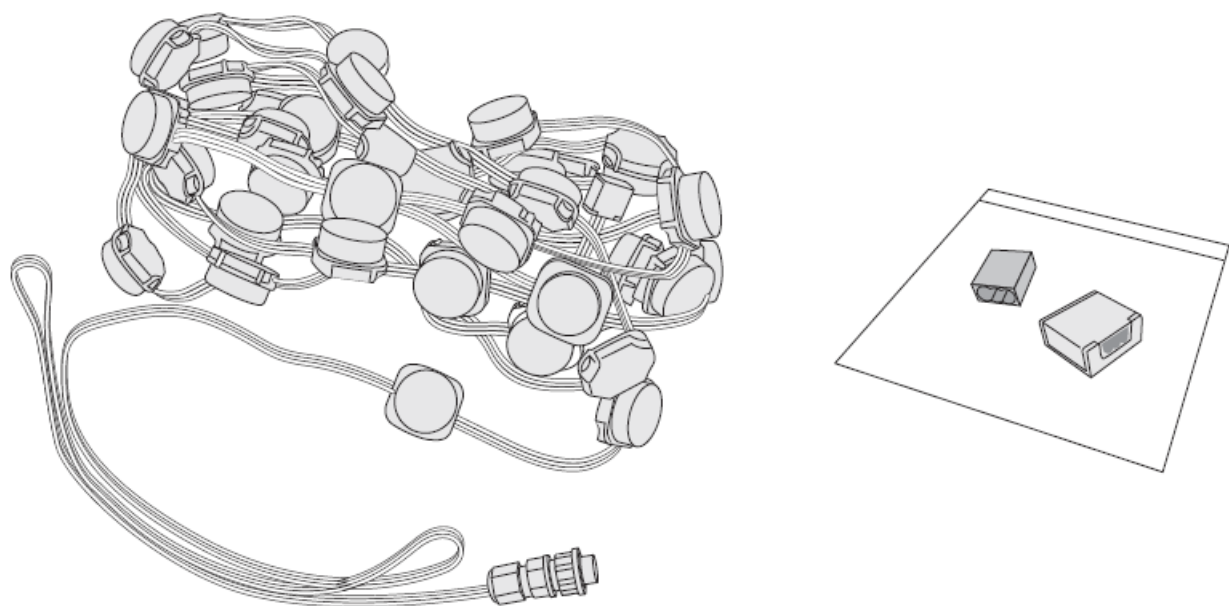

2. Verify the electrical plan and all necessary surge protection requirements.

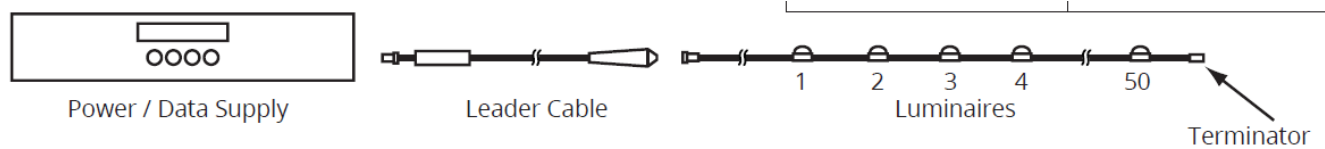

Luminaires supported	Power / Data Supply
1	PDS-60ca 24V
1	sPDS-60ca 24V
8	sPDS-480ca 24V

1. Trim for shorter leader cable For fewer nodes cut and seal wire

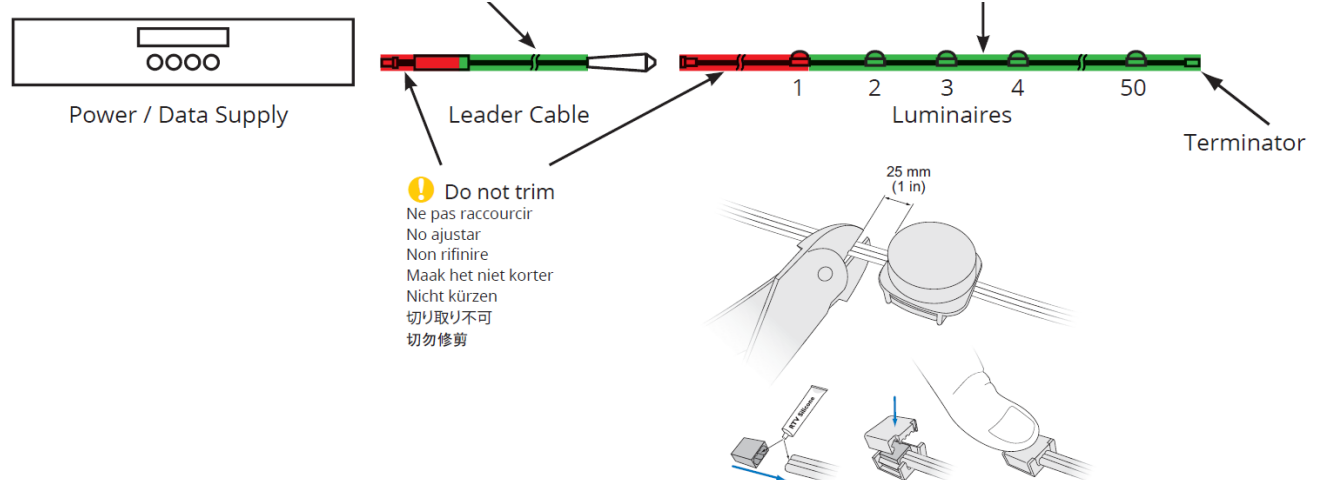

2. Mounting options

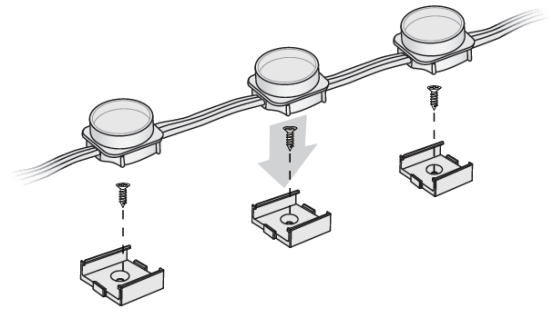
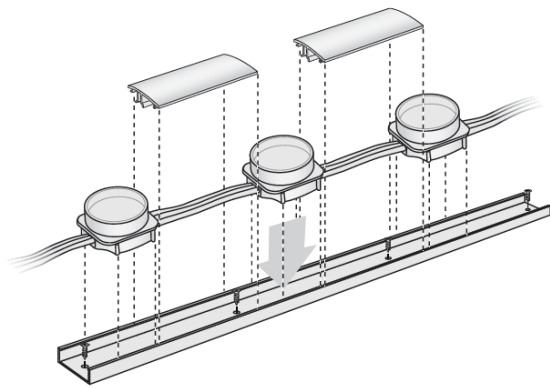

3. Use caution when installing luminaire nodes

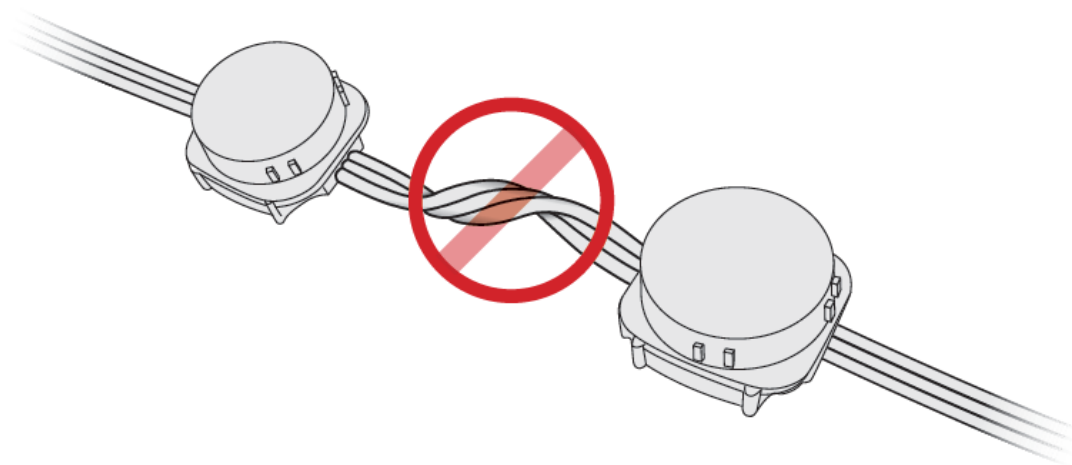

1. Do not twist or loop cable
2. Do not overstretch cable

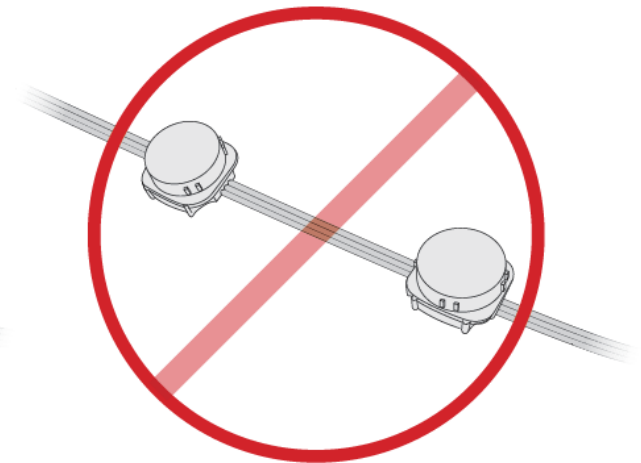
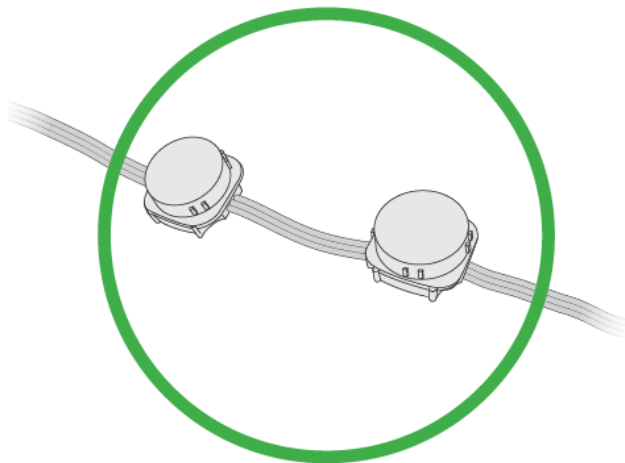

3. Do not pull the cable away from node



4. Mount Marquee Lens Kit

1.6 mm (0.0625 in) Recommended
3.2 mm (0.125 in) Max

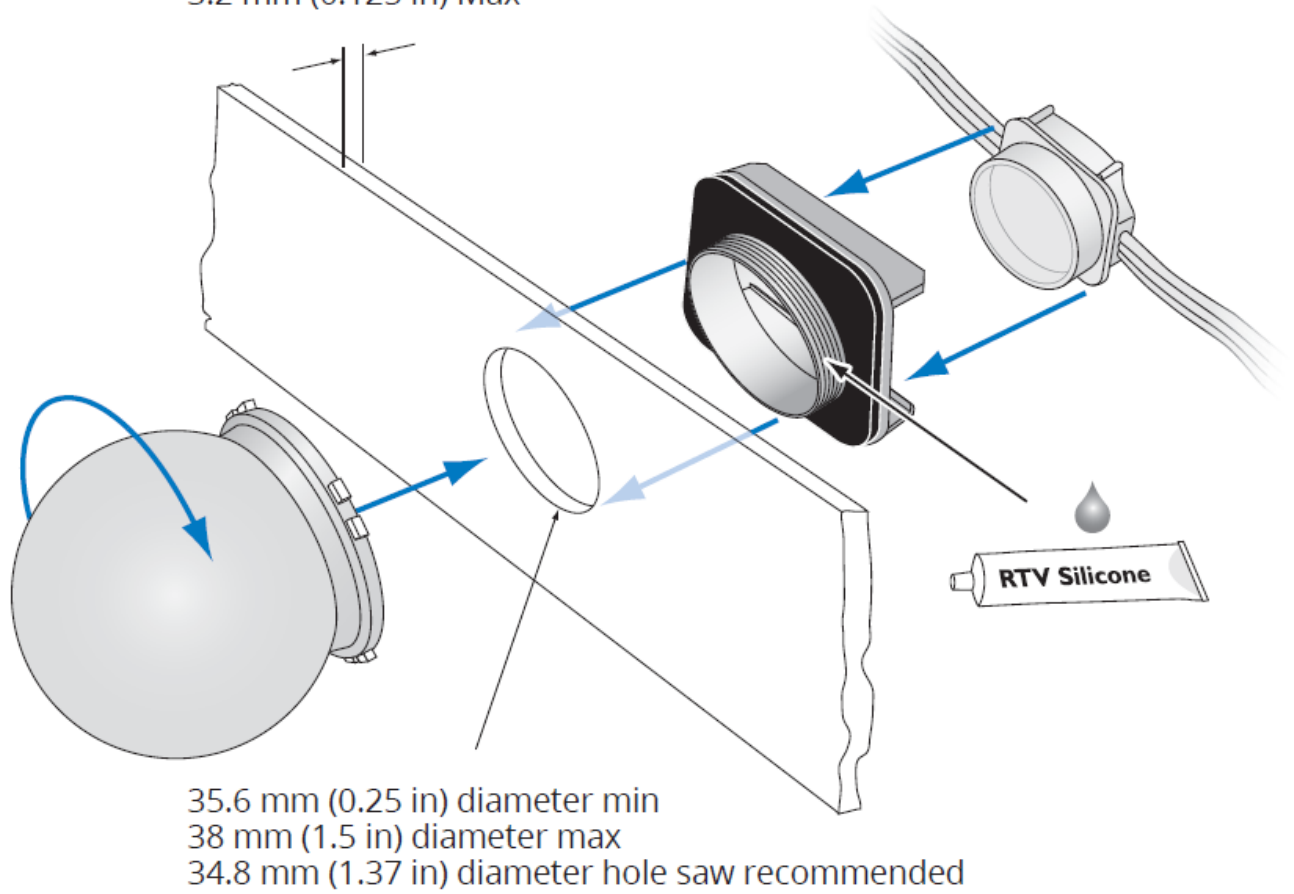

5. Mount

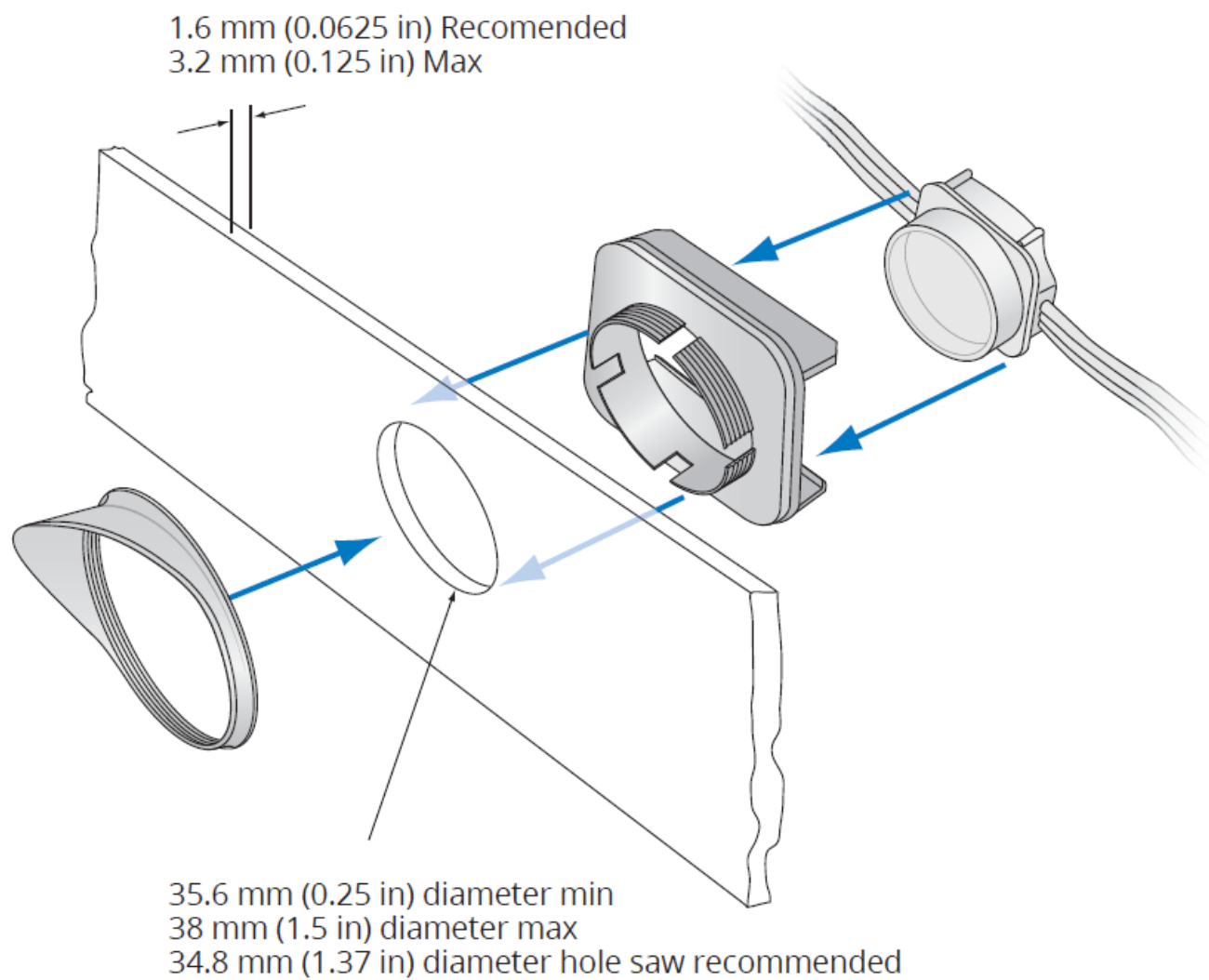

6. Make sure power is OFF

7. Connect leader cable

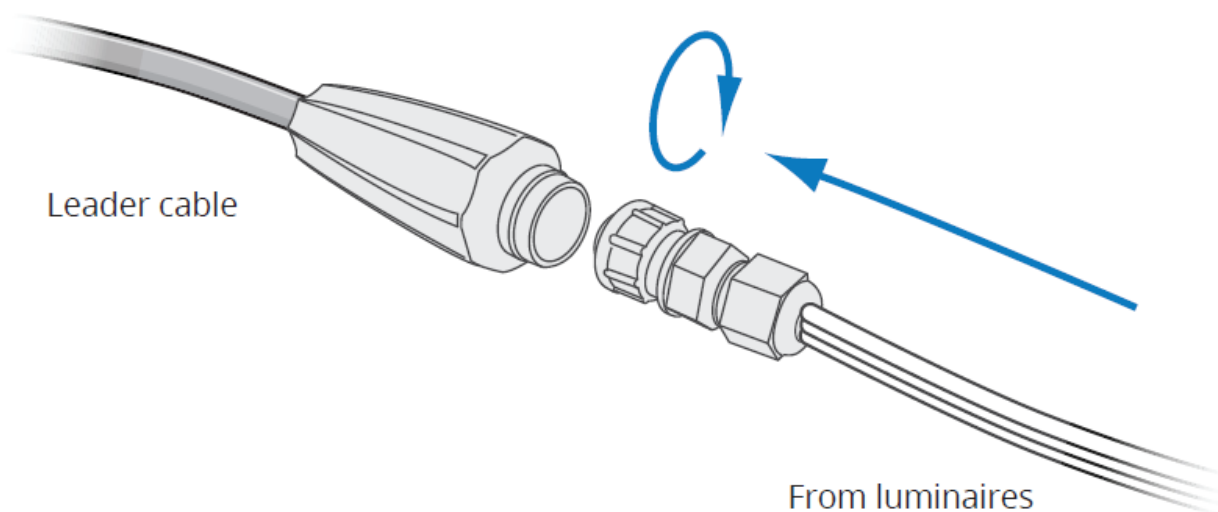

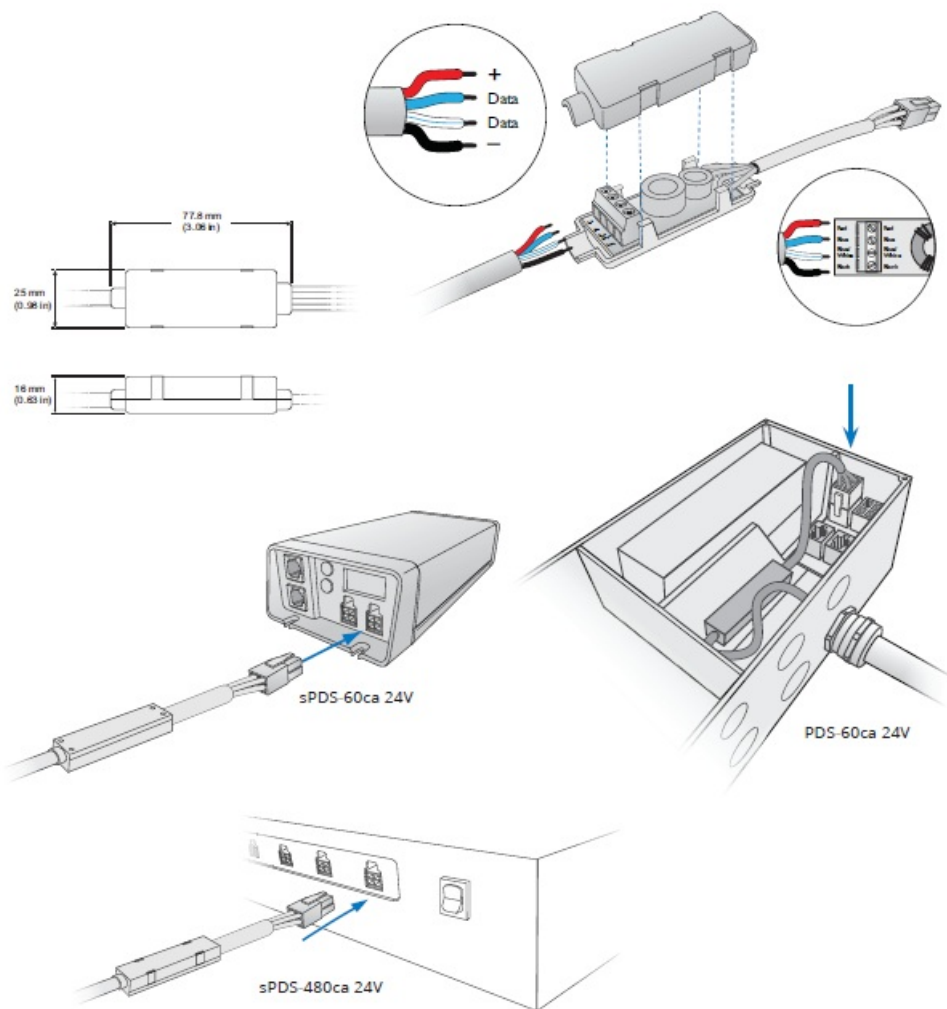

Use caution when handling the cables in sub-freezing temperatures

8. Secure connections and covers

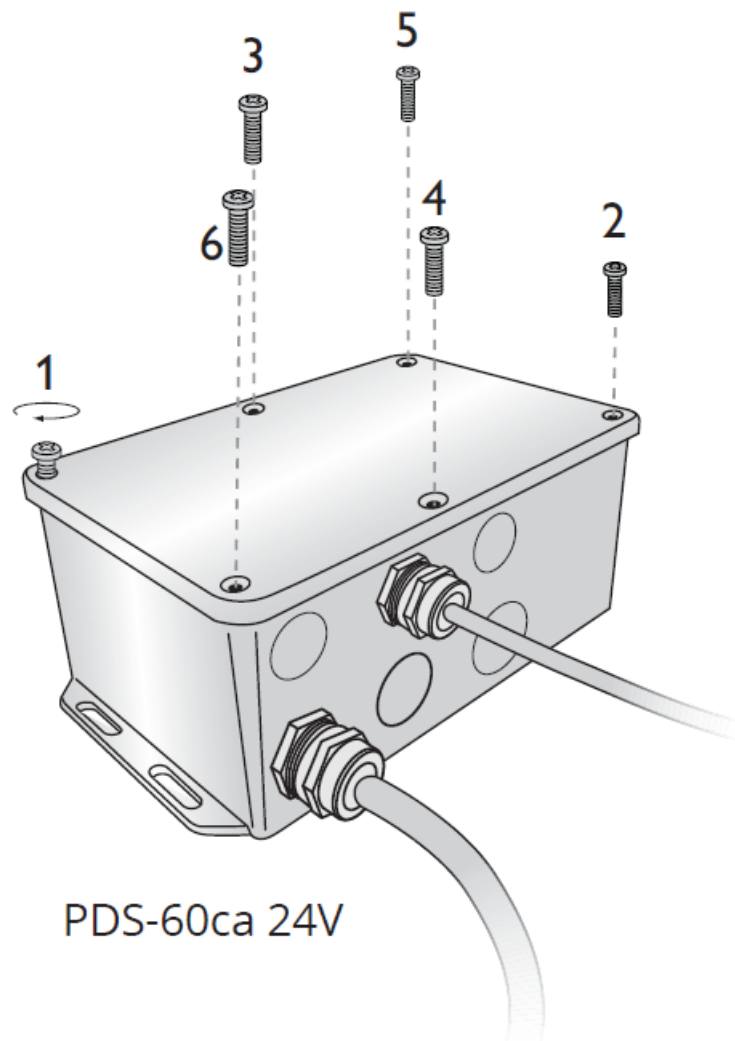

PDS-60ca 24V

9. For damp or wet locations seal all points of entry to prevent water infiltration. Use Electronic-grade RTV Silicone and weatherproof junction boxes.

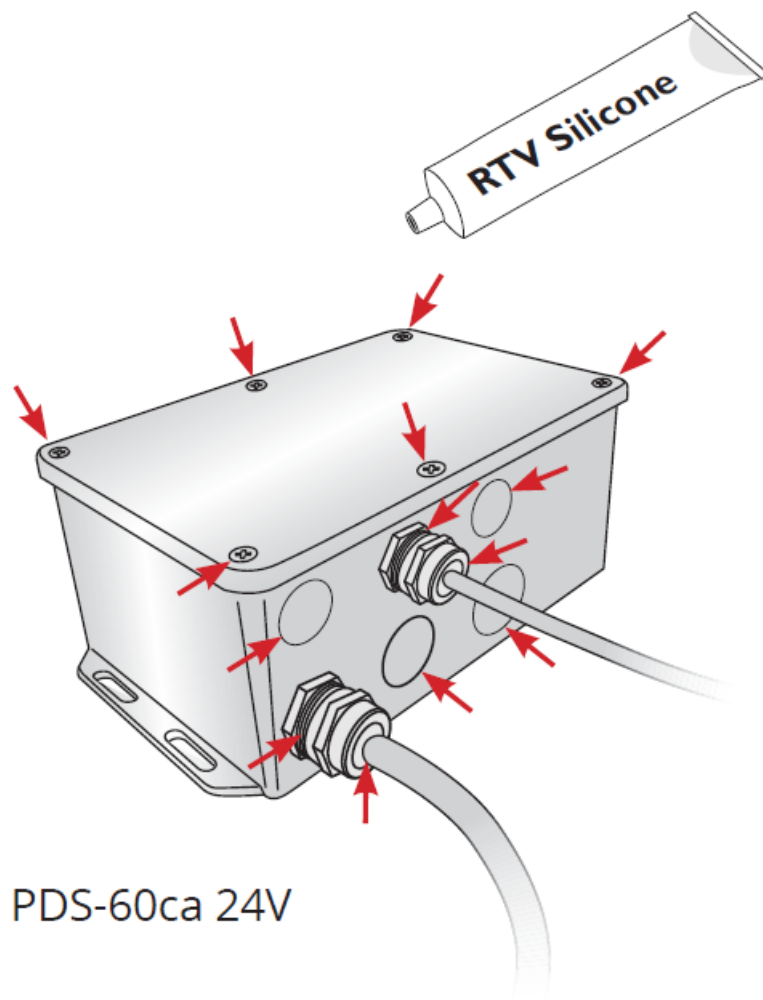

10. Turn the power ON

© 2021 Signify Holding. All rights reserved. Specifications are subject to change without notice. No representation or warranty as to the accuracy or completeness of the information included herein is given and any liability for any action in reliance thereon is disclaimed.

Documents / Resources

	<p>COLOR KINETICS Flex Compact eW Color Kinetics [pdf] Instruction Manual Flex Compact eW Color Kinetics</p>
---	--

References

- [Color Kinetics Official Website | Homepage](#)
- [Understanding Surge Protection For LED Lighting Systems - Knowledgebase](#)
- [Color Kinetics Energy Label information - Knowledgebase](#)