



Coleman Filter Pump Owner's Manual

[Home](#) » [Coleman](#) » Coleman Filter Pump Owner's Manual

Contents [[hide](#)]

- [1 Coleman Filter Pump](#)
- [2 READ AND FOLLOW ALL INSTRUCTIONS](#)
- [3 PUMP MAINTENANCE](#)
- [4 PUMP STORAGE](#)
- [5 PUMP WARRANTY](#)
- [6 FAQs](#)
- [7 Video](#)
- [8 Documents / Resources](#)
 - [8.1 References](#)
- [9 Related Posts](#)



Coleman Filter Pump



**#90403E
FILTER PUMP
OWNER'S MANUAL**

Website: www.bestwaycorp.com/support



**DO NOT RETURN THIS ITEM TO THE STORE OR
WEBSITE WHERE IT WAS PURCHASED. PLEASE
VISIT WWW.BESTWAYCORP.COM/SUPPORT
FOR QUESTIONS, OR FOR DEFECTIVE OR
WARRANTY CLAIMS.**

WARNING

IMPORTANT SAFETY INSTRUCTIONS

When installing and using this electrical equipment, basic safety precautions should always be followed, including the following:

READ AND FOLLOW ALL INSTRUCTIONS

WARNING – RISK OF ELECTRIC SHOCK – The pump cannot be used while people are inside the pool.

WARNING – TO REDUCE THE RISK OF INJURY, do not permit children to use this product unless they are closely supervised at all times.

WARNING – RISK OF ELECTRIC SHOCK. Connect only to a grounding-type receptacle. This product is provided with a ground-fault circuit interrupter. If replacement of the plug is needed, use only identical replacement parts.

WARNING: The unit is provided with a ground-fault circuit interrupter (GFCI). To test the GFCI, push the test button. The GFCI should interrupt power. Push the reset button. Power should be restored. If the GFCI fails to operate in this manner, the GFCI is defective. If the GFCI interrupts power to the pump without the test button being pushed, a ground current is flowing, indicating the possibility of an electric shock. Do not use this pump. Disconnect the pump and have the problem corrected by a qualified service representative before using.

CAUTION – To reduce the risk of electric shock the pool must be installed no closer than 6 feet (1.8 m) from any electrical outlet. Do not place portable appliances closer than 5 feet (1.5 m) from the pool.

WARNING: The pump is not intended to be bonded to the equipotential bonding grid.

DO NOT BURY CORD. Locate cord to minimize abuse from lawn mowers, hedge trimmers, and other equipment.

WARNING – To reduce the risk of electric shock, replace the damaged cord immediately. If the supply cord is damaged, it must be replaced by the manufacturer, its service agent or similarly qualified persons in order to avoid a hazard.

WARNING – To reduce the risk of electric shock, do not use an extension cord to connect the unit to the electric supply; provide a properly located outlet.

CAUTION – This pump is for use with storable pools only. Do not use with permanently installed pools. A storable pool is constructed so that it is capable of being readily disassembled for storage and reassembled to its original integrity. A permanently installed pool is constructed in or on the ground or in a building such that it cannot be readily disassembled for storage.

CAUTION – For continued protection against possible electric shock this unit is to be mounted to the base in accordance with the installation instructions.

IMPORTANT – Using the pump with an unmatched electrical supply is dangerous and will result in catastrophic failure of the pump.

RISK OF ELECTRIC SHOCK – When working with electricity, turn the electrical power off at the circuit breaker and lock the breaker door. Failure to do so will result in an increased risk of shock, injury, and possibly death.

DO NOT REMOVE THE GROUNDING PRONG OR MODIFY THE PLUG IN ANY WAY. DO NOT USE ADAPTOR PLUGS. Consult a qualified electrician for any questions related to the validity of your plugs grounding. Handle the pump with care. Do not pull or carry the pump by the power cord. Never pull a plug from the outlet by yanking the power cord. Keep cord free from abrasions. Sharp objects, oil, moving parts, and heat should never be exposed to the filter pump.

NOTE: Please examine equipment before use. Notify Bestway at the customer service address listed on this manual for any manufacturing defect or missing parts at the time of purchase. Verify that the equipment components represent the filter pump model that you had intended to purchase.

NOTE: Place pump on solid and level ground. Pay attention to the position of pool and pump so adequate ventilation, drainage, and access for cleaning is available. Never place pump in an area that may accumulate water, or in an area where foot traffic will flow around the pool.

NOTE: Atmospheric conditions may affect the performance and life span of your filter pump. Unnecessary wear and tear may occur during periods of cold, heat and exposure to sun. Whenever possible shelter the pump from these conditions.

NOTE: Do not add chemicals in the filter pump.

NOTE: Assembly and disassembly of this product should only be performed by adults.

- THERMALLY PROTECTED MOTOR CSA ENCLOSURE 3.

- FOR USE WITH SWIMMING POOLS ONLY.

CAUTION: TO ENSURE CONTINUED PROTECTION AGAINST SHOCK HAZARDS, USE ONLY IDENTICAL REPLACEMENT PARTS WHEN SERVICING.

WARNING: RISK OF ELECTRIC SHOCK. CONNECT ONLY TO A GROUNDING-TYPE RECEPTACLE.

CAUTION: THIS PUMP IS FOR USE WITH STORABLE POOLS ONLY – DO NOT USE IT WITH PERMANENTLY INSTALLED POOLS.

CAUTION: CONNECT ONLY TO GROUNDING TYPE RECEPTACLE PROTECTED BY A CLASS A GROUND FAULT CIRCUIT INTERRUPTER.

CAUTION: FOR CONTINUED PROTECTION AGAINST POSSIBLE ELECTRIC SHOCK THIS UNIT IS TO BE MOUNTED TO THE BASE IN ACCORDANCE WITH THE INSTALLATION INSTRUCTIONS.

WARNING – RISK OF ELECTROCUTION

1. Connect Only To Properly Grounded Outlet. Do Not Remove Ground Pin.
2. Inspect Cord Before Using – Do Not Use If Cord Is Damaged.
3. Keep Ground-Fault Circuit-Interrupter Dry And Off The Ground.
4. Do Not Touch Plug With Wet Hands.
5. Double Insulated – When Servicing Use Only Identical Replacement Parts.
6. Read Instruction Manual Before Using.

DO NOT REMOVE THIS TAG

SAVE THESE INSTRUCTIONS.

This device complies with part 15 of the FCC Rules. Operation is subject to the following two conditions:

(1) This device may not cause harmful interference, and (2) this device must accept any interference received, including interference that may cause undesired operation.

WARNING: Any changes or modifications to this unit not expressly approved by the party responsible for compliance could void the user's authority to operate the equipment.

NOTE: This equipment has been tested and found to comply with the limits for a Class B digital device, pursuant to part 15 of the FCC Rules. These limits are designed to provide reasonable protection against harmful interference in a residential installation. This equipment generates, uses, and can radiate radio frequency energy and, if not installed and used in accordance with the instructions, may cause harmful interference to radio communications. However, there is no guarantee that interference will not occur in a particular installation. If this equipment does cause harmful interference to radio or television reception, which can be determined by turning the equipment off and on, the user is encouraged to try to correct the interference by one or more of the following measures:

- Reorient or relocate the receiving antenna.
- Increase the separation between the equipment and receiver.
- Connect the equipment into an outlet on a circuit different from that to which the receiver is connected.
- Consult the dealer or an experienced radio/ TV technician for help.

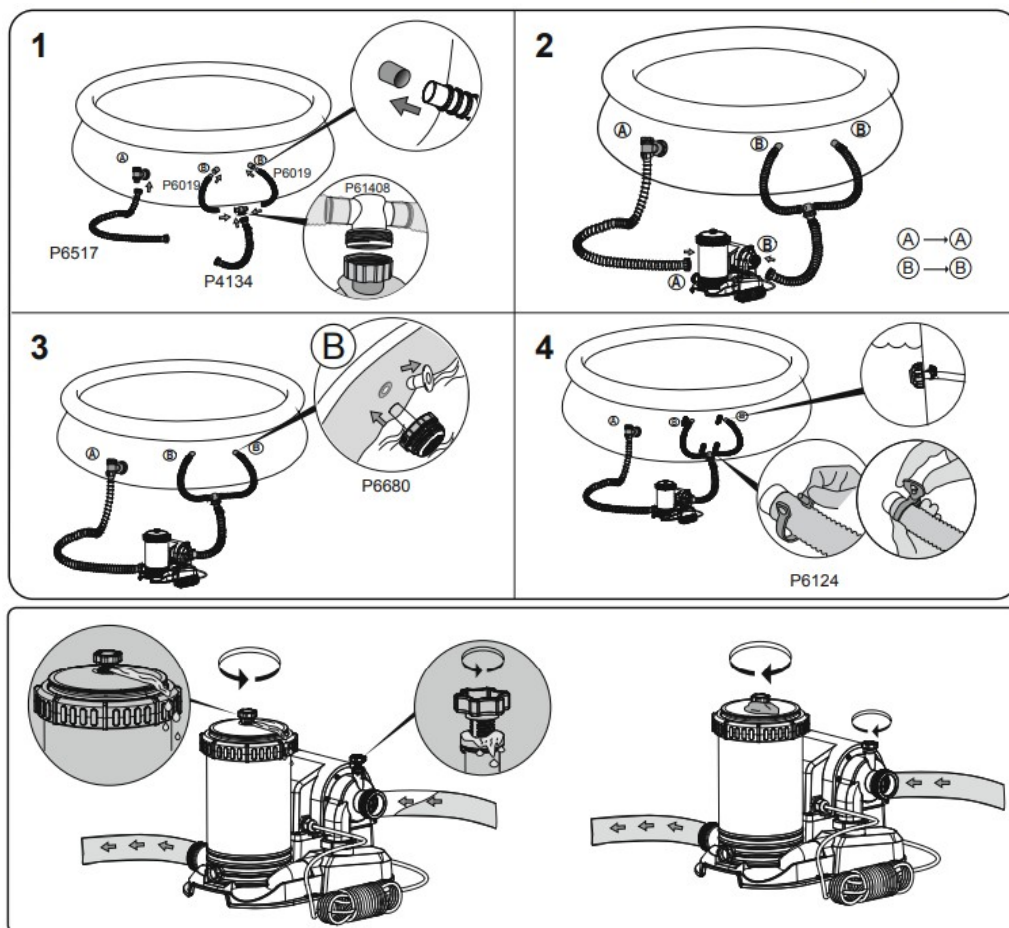
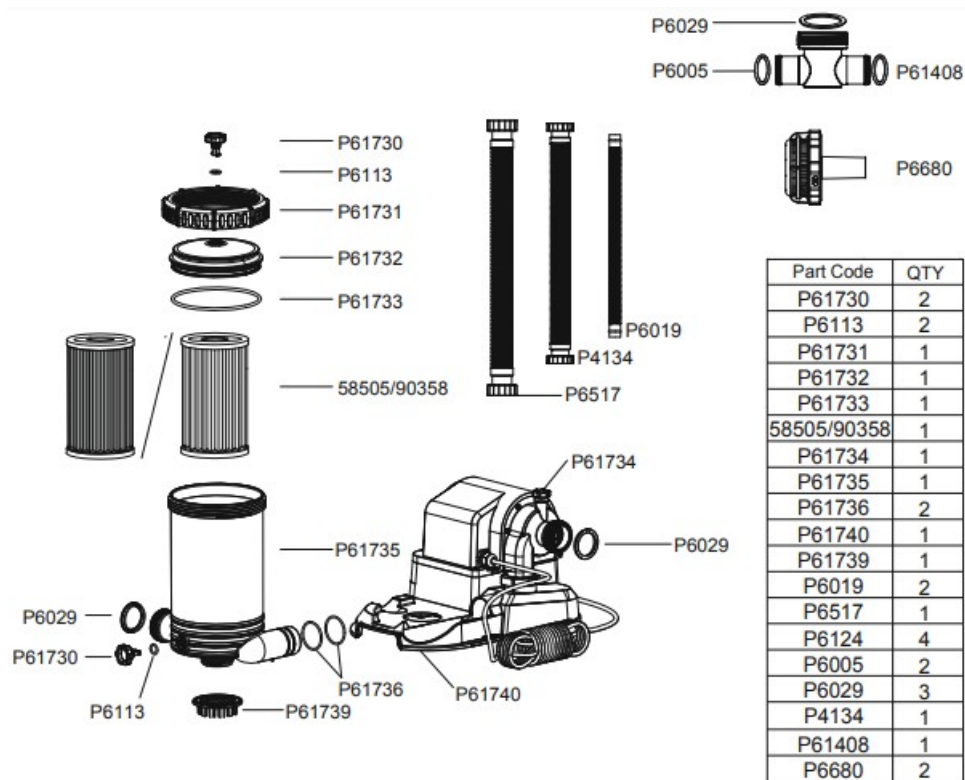

NOTE: You must clean the filter cartridge every day and open the top valve let the air out then close it before using the pump, otherwise the pump may not work.

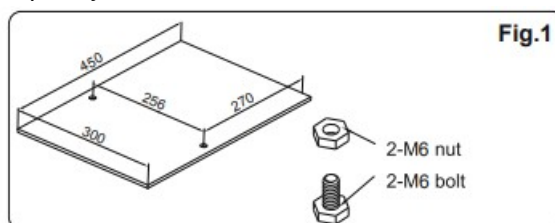

PEDESTAL FIXING Fig.1

The filter pump must be vertically fixed on the ground or a certain pedestal made of wood or concrete before use. There should be two holes 7mm in diameter on the pedestal, space between which should be 256mm. Put filter pump on the pedestal and fix them together by fastening the bolts and nuts. All the pedestal parts should weigh over 18kgs at least to prevent the pump from accidentally falling.

Operation

1. Open/unscrew the Air Purge Valve on the Filter Pump; air is released as water fills the Filter Pump.
2. When water comes out of the Air Purge Valves, close both the Air Purge Valves and wipe away any water.
3. Test the GFCI plug.
4. Start the Filter Pump by turning on the switch to the "I" position.

GFCI Test

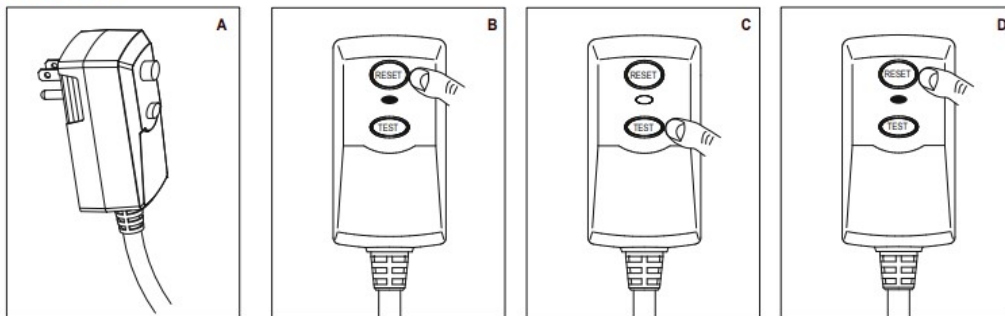

A. To test the GFCI plug, insert it into a grounding-type receptacle.

B. Press the "RESET" button; the indicator turns red.

NOTE: If the indicator light is not on, the test has failed.

C. Press the "TEST" button. The indicator turns off.

NOTE: If the indicator light is not off, the test has failed.

D. Press the "RESET" button, the indicator light turns red, and the filter pump is ready for use.

WARNING: RISK OF ELECTRIC SHOCK. THE GFCI MUST BE TESTED BEFORE EACH USE.

WARNING: DO NOT USE THE PUMP IF THE ABOVE TEST FAILS. Please contact your local Coleman Customer Service.

NOTE: Never operate the pump while the connection valves are closed.

NOTE: To prevent the risk of electrical shock, ensure your hands are completely dry when plugging in the Filter Pump.

IMPORTANT: DO NOT DRY RUN THE FILTER PUMP – Make sure both the pool's Inlet and Outlet valves are fully covered by water before operating the Filter Pump.

PUMP MAINTENANCE

CAUTION: YOU MUST ENSURE THE FILTER PUMP IS UNPLUGGED BEFORE ANY MAINTENANCE OR STORAGE BEGINS OR SEVERE RISK OF INJURY OR DEATH EXISTS.

1. Unplug the Filter Pump.
2. Stop water flowing to the Filter Pump refer to the pool's manual.
3. Unscrew the Filter Cap Retainer and remove the Filter Cap.
4. Clean the Filter Cartridge with a garden hose. If the filter cartridge remains soiled or discolored, it is necessary to replace it with a new one.
5. Insert the cleaned (or new) Filter Cartridge; ensure it is centered in the Filter Pump.
6. Check that the Filter Cap Seal is in place.

7. Replace the Filter Cap and screw the Filter Cap Retainer into position.
8. Open the Valve A and B.
9. Follow the PUMP INSTALLATION DIRECTIONS section to prepare the system for use.

IMPORTANT: To ensure pool water stays clean, please clean the filter cartridge every day. For sanitary reasons, we suggest replacing the Filter Cartridge with a new one every two weeks.

PUMP STORAGE

1. Unplug the Filter Pump.
2. Stop water flowing into the Filter Pump and to remove the Filter Cartridge.
3. Discard the Filter Cartridge.
4. Detach all Hoses.
5. Dry all components thoroughly.
6. Store the filter pump in a dry location out of the reach of children. Storage temperature: 4-40°C (39.2-104F)
7. Drain the pool according to the Pool Owner's Manual.

PUMP WARRANTY

For information concerning pump warranty please visit our website at: www.bestwaycorp.com



The product you have purchased comes with a limited warranty from the manufacturer Bestway®. Bestway® stands behind our quality guarantee and assures, through a replacement warranty, your product will be free from manufacturer's defects.

The limited warranty is valid as follows:

360 days for the motor pumps, 30 days for hoses, fitting and accessory included in the package, all from the original date of purchase.

To file a warranty claim, please contact your Bestway® After Sales Center at 1-855-838-3888 before sending any documents. They will provide full instructions of what is needed for your claim. Bestway® is not responsible for economic loss due to water or chemical costs and will not replace any products deemed to have been neglected or used outside of the owner's manual guidelines. Bestway's warranty covers manufacturing defects discovered while unpacking the product or during use, as recommended within the user manual. This warranty applies only to products that have not been modified by any 3rd parties. The product must be stored and handled in accordance with the technical recommendations.

The warranty does not cover damages caused by misuse, abuse, neglect, including but not limited to: collision, fire, excessive heat exposure, improper use of chemicals, exposure to extreme weather conditions, improper installation, or improper storage.

Replacements and repairs don't extend the duration of the warranty. The warranty start date is the date of sale shown on the original receipt/ purchase invoice.

Please copy the Batch Number found on the body of the filter pump.

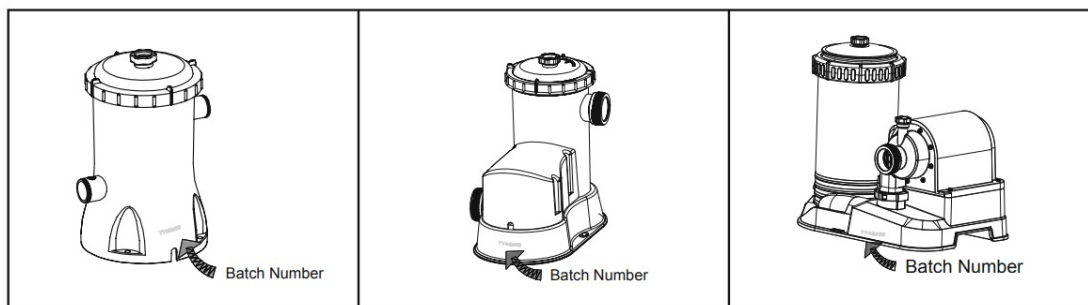

BATCH NUMBER: _____ Date of purchase: _____
 TO: Bestway@Service Department _____ Date: _____
 Website: www.bestwaycorp.com _____ Customer Code Number: _____
 Toll-Free: 1-855-838-3888

Please provide your address details in full.

Note: Incomplete address details will result in delayed shipments.

Bestway@reserves the right to charge for re-delivery of undelivered packages where the recipient is at fault.

REQUIRED INFORMATION – PLEASE WRITE THE SHIPPING ADDRESS

Name: _____ Address: _____
 City: _____ Country / State: _____
 Zip code: _____ Retailer: _____
 Mobile: _____ Telephone: _____
 Fax: _____ E-mail: _____

Please Clearly Write Your Item Code: _____

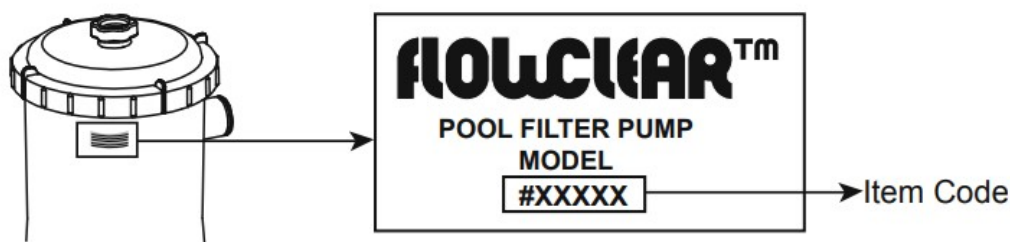

IMPORTANT: ONLY THE DAMAGED PART WILL BE REPLACED, NOT THE COMPLETE SET.

Bestway@reserves the right to request photographic evidence of defective parts, or to require sending the item for additional testing.

In order to best assist you, we request all information you provided to be complete.

FOR FAQ, MANUALS, VIDEOS OR SPARE PARTS, PLEASE VISIT OUR WEBSITE: www.bestwaycorp.com

VIDEOS ARE ALSO AVAILABLE ON OUR BESTWAY CHANNEL ON YOUTUBE:

www.youtube.com/user/BestwayService



© 2015 The Coleman Company, Inc.



and  are registered trademarks of The Coleman Company, Inc., used under license.

Manufactured by **Bestway**

©2015 Bestway (USA) Inc., 3411 E. Harbour Drive, Phoenix, Arizona 85034, United States of America

®™ Trademarks used in some countries under license to Bestway Inflatables & Material Corp., No.3065 Cao An Road, Shanghai, 201812, China

www.bestwaycorp.com

FAQs

How can I install the connection valve to Bestway's Hydrium Pools?

The connection valve has to be installed in the holes on the steel wall. Before installing the connection valve, fill the pool with water until it's 20 cm (9 in.) lower than the hole on the steel wall and cut the liner following the instructions in the User Manual.

How do I connect the pump to the pools with 2 connections (A-B), with a connection valve?

1. Connect the hoses to the port B of the filter pump, then connect to port B of pool. 2. Connect the hoses to the port A of the filter pump, then connect to port A of pool. 3. Open the connection valves to let water to flow. 4. Before starting the filter pump, open the purge valve to purge all residual air inside the filter pump.

How do I connect the pump to the pools with 3 connections (A-B-B), with a connection valve?

1. Connect the hoses to port B of the pool, then connect the T-connect to the hoses. 2. Connect the hoses to port B and port A of the filter pump. 3. Connect the port A of filter pump to port A of the pool. 4. Open the connection valves to let water to flow. 5. Before starting the filter pump, open the purge valve to purge all residual air inside the filter pump.

How do I perform the air purge operation?

To perform the the air purge operation, follow these steps: First step: after connecting the hoses, remove the plug and install the debris screen or open the connection valves. Second step: open the purge valve located on the top cover. The air will flow out until the water flows out. Third step: close the purge valve tightly to avoid leakage. Fourth step: plug in the filter pump, and it is ready to work. IMPORTANT: this operation must be repeated every time you perform any maintenance operation.

Why does the pump have to be under the water level?

The filter pump/sand filter is designed to be positioned on the ground. If the filter pump/sand filter is positioned at (or above) the water level, the motor will work without water. This will cause the filter pump/sand filter to be damaged.

Will this work with a summer waves quickset 10ft ring pool?

As long as the pool can with 300-15, 200 gal pools you should be fine.

How long are the hoses ?

Not 100% sure but believe they are 5 ft.

Does it come with the 1 1/4 adapter

It comes with everything to switch out the hoses for the pool

Dose this pump come with fliter

Mine did come with one filter.

How loud is this pump?

Not any louder than other pool pumps. Mine works great.

how can i get my filter cap to stop leaking?

Replace the rubber o-ring so it seals



<https://manuals.plus/wp-content/uploads/2021/07/Coleman-Filter-Pump-Owners-Manual-1.mp4>



Coleman Filter Pump
Website: www.bestwaycorp.com

Documents / Resources

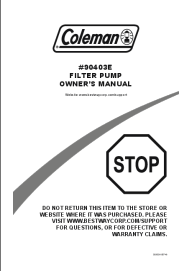
	<p>Coleman Filter Pump [pdf] Owner's Manual Filter Pump, 90403E</p>
---	---

References

- [B Home Page](#)
- [B Contact Us](#)
- [YouTube](#)