



CODELOCKS KL15 Mechanical Combination Lock Instruction Manual

[Home](#) » [CODELOCKS](#) » CODELOCKS KL15 Mechanical Combination Lock Instruction Manual 



KL15 Mechanical Combination Lock
Instruction Manual



Contents

- 1 SPECIAL NOTES
- 2 INSTALLATION GUIDE
- 3 FLUSH INSTALLATION
- 4 SURFACE MOUNT
INSTALLATION
- 5 FINDING THE CODE
- 6 Documents / Resources
 - 6.1 References

SPECIAL NOTES

Please read carefully:

- Before installing the lock, familiarise yourself with the installation and operating instructions.
- The factory preset combination is 0-0-0-0.
- Your KitLock is supplied ready to fit to doors up to 22mm (7/8") thick.
- Select the correct back plate to suit the door thickness.

INSTALLATION GUIDE

The KL15 can be fitted flush into a 20mm x 83mm (3/4" x 31/4") hole, or surface mounted, either for a new install or to replace an existing mechanical cam lock.

A Flush Fixing Pack

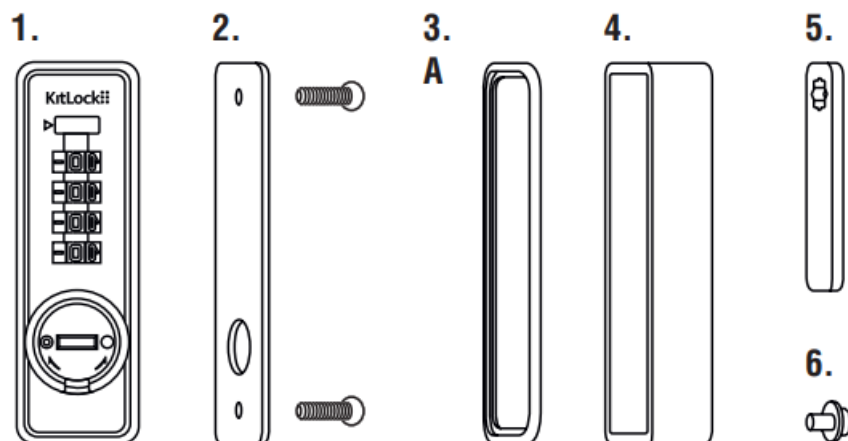

1. KitLock
2. Fixing Plate with 2 x screws
3. Surface Trim Plate A
4. Back Trim Plate
5. Straight Cam x 1
6. Cam Fixing Screw x 1

B Surface Mount Fixing Pack

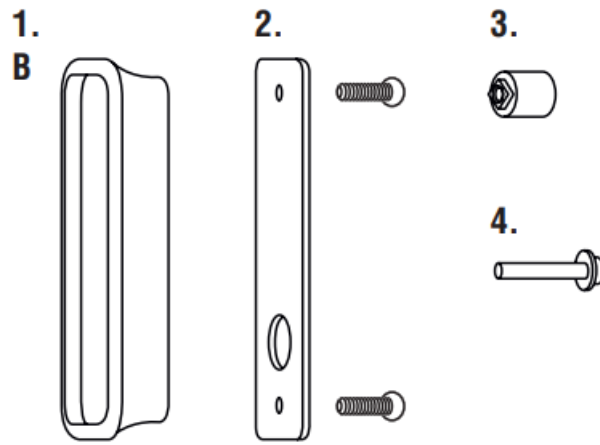

1. Surface Trim Plate B
2. Fixing Plate with 2 x screws
3. Spindle Extension

FLUSH INSTALLATION

1. Mark a position at a suitable distance from the door edge, ensuring enough clearance for the cam to work.
2. Mark a rectangular guide 20mm x 83mm ($3/4"$ x $3 1/4"$) to suit the chosen orientation.
3. Drill inside the four corners, then using a hacksaw or jigsaw, cut from the hole to hole to create the rectangle.
4. Hold the lock in place and secure with the correct back plate for the door thickness, using the 2 fixing screws supplied.
5. Fit cam and secure with cam fixing screw.
6. Now check the operation of the lock using the factory preset combination 0-0-0-0.
7. Change the code using the instructions overleaf.

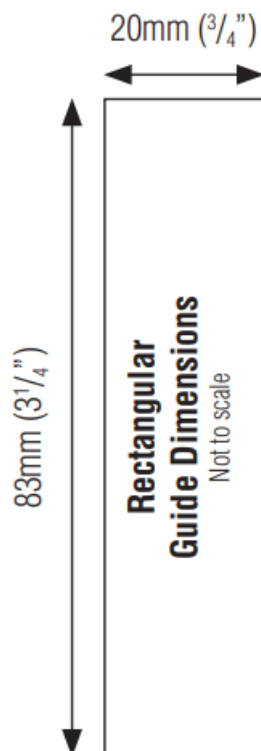

Installation Note

Do not overtighten the fixing screws as this may affect the lock function.

SURFACE MOUNT INSTALLATION

1. A – Replace Existing Cam Lock 1 Using fixing plate A as a guide, place the 16mm (5 /8") hole over the hole left after removing the cam lock, and mark the upper and lower fixing holes.
2. Drill the two 4mm (3 /16") fixing holes.
3. Ensure the surface fit trim plate B is in place, then fit lock to the door using appropriate length fixing bolts.
4. Select and fit appropriate spindle and cam with correct length fixing bolt.
5. Before closing the door check the operation of the lock with the User Code. Now check that the cam engages with the frame without bind or too much free play.
6. If not changed already, change the User Code.

B – New Installation

1. Mark a position at a suitable distance from the door edge, ensuring enough clearance for the cam to work.
2. Place the fixing plate on the door and mark upper and lower 4mm (3/16") fixing holes and 16mm (5/8") spindle hole.
3. Drill all three fixing holes. Continue installation from step 4 to 7 from section A.

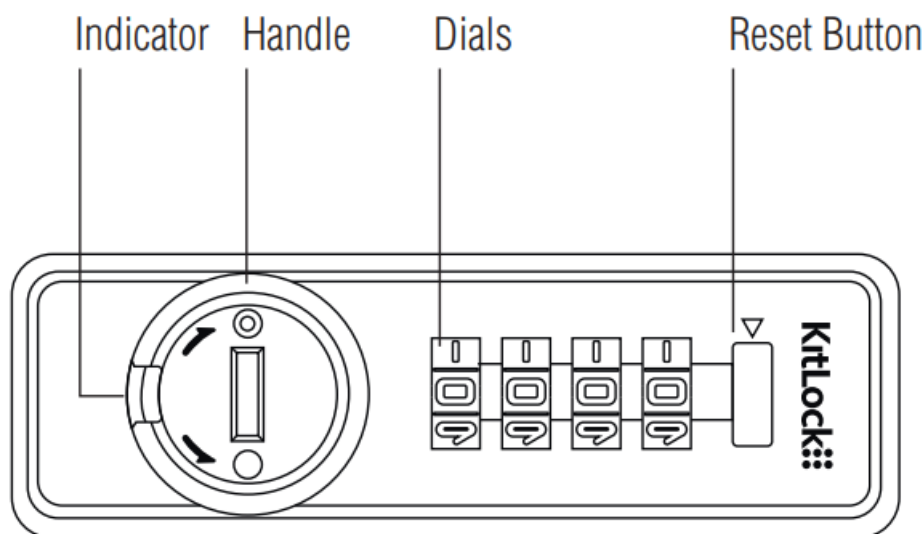
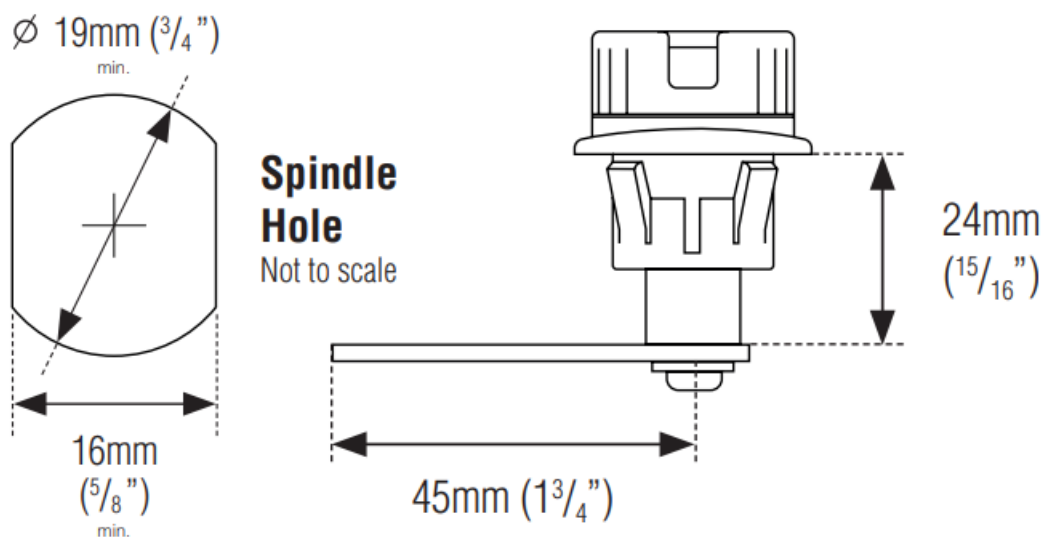

FINDING THE CODE

Note This function requires the Code Finding Key (sold separately). This method should only be used to open the lock in an emergency, or when the User Code has been forgotten.

1. When the indicator is in the locked position, insert the Code Finding Key and turn 90 degrees clockwise.
2. Holding the key firmly in place, rotate each dial until it stops. You will feel a click as each code number is found.
3. Turn the key 90 degrees counterclockwise when all four code numbers have been found. Make a note of the combination and ensure it unlocks the lock. You can now reset, or continue to use, the found combination.

<p>CODELOCKS Ltd. UK sales@codelocks.com www.codelocks.com Helpline, service & spares Phone: 0800 393 405</p>	<p>CODELOCKS EU B.V. sales@codelocks.eu www.codelocks.eu Helpline, service & spares Phone: +31 53 80 80 118</p>
<p>CODELOCKS Inc. US sales@codelocks.us www.codelocks.us Helpline, service & spares Toll free: 1.877.codelock</p>	<p>CODELOCKS (Australia) PTY LTD sales@codelocks.com.au www.codelocks.com.au Helpline, service & spares Toll free: 1800 052 131</p>



IOI-KL15PR-v1-0523 © 2023 Codelocks Ltd.
All rights reserved.

Documents / Resources

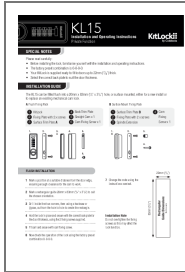

[CODELOCKS KL15 Mechanical Combination Lock](#) [pdf] Instruction Manual
KL15 Mechanical Combination Lock, KL15, Mechanical Combination Lock, Combination Lock, Lock

References

- [Codelocks - Specialists in design and distribution of access control solutions](#)
- [Codelocks Pty Ltd. | Mechanical, Electronic and Locker Locks](#)
- [Codelocks EU B.V. | Mechanical, Electronic and Locker Locks](#)
- [Codelocks Inc | Mechanical, Electronic and Locker Locks](#)

[Manuals+](#)