

CODEJUNKIES Tag Next Generation Auto Catcher



# CODEJUNKIES Tag Next Generation Auto Catcher User Guide

[Home](#) » [CODEJUNKIES](#) » CODEJUNKIES Tag Next Generation Auto Catcher User Guide 

## Contents

- [1 CODEJUNKIES Tag Next Generation Auto Catcher](#)
- [2 Product Specifications](#)
- [3 Pairing Your Tag](#)
- [4 Settings](#)
- [5 Selectable Go-Tcha settings](#)
- [6 Additional In-Game notifications](#)
- [7 Settings Configuration](#)
- [8 Documents / Resources](#)
  - [8.1 References](#)



**CODEJUNKIES Tag Next Generation Auto Catcher**



## Product Specifications

- Model: Gotcha Tag
- Colour: Black
- Connectivity: Bluetooth
- Battery Life: Up to 7 days

## Pairing Your Tag

1. From the main game screen, press the Red/White ball symbol at the bottom of the screen to enter the Selection screen.
2. Choose the settings symbol on the top right of the screen to enter the Settings screen.
3. On the settings screen, select the Connected Devices and Services option.
4. Press the button once on your GoTcha Tag – alternating White LEDs will indicate that it has entered pairing mode.
5. Once your Tag is connected, return to the game screen where your connected device is shown by the icon on the upper right of the screen.

## Quick Start Instructions

- Before connecting your GoTcha Tag, first make sure that it is fully charged. Using the charging cable provided, attach the round connector to the back of your Tag.
- This connector has built-in magnets to ensure that the pins are correctly orientated on the terminals of your Tag. Now connect the USB end of the cable to a suitable USB power source.
- This can be a PC or Laptop or any standard USB charger with a suitable socket. Check that the magnetic connector is correctly located and rest your Tag in a position where it will not become disconnected from the

charge lead.

- A full charge will take less than 1 hour at which point your Tag is ready to use.

Rear View



Charge Pins

Side View

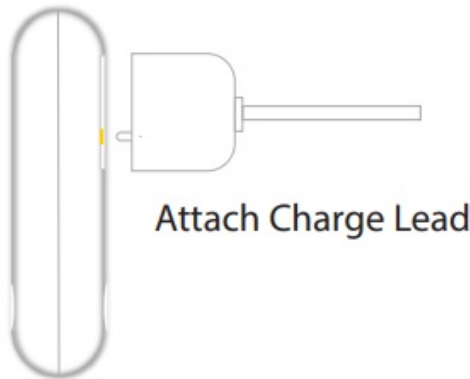

### Connecting your Tag to the Pokémon Go game



- When connecting your Tag for the first time, you will need to 'Pair your Tag to the game'.
- From the main game screen, press the Red/White ball symbol at the Bottom of the screen to enter the 'Selection screen'.
- Choose the 'settings' symbol on the top right of the screen to enter the Settings screen.

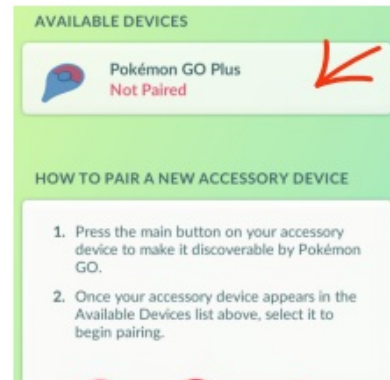
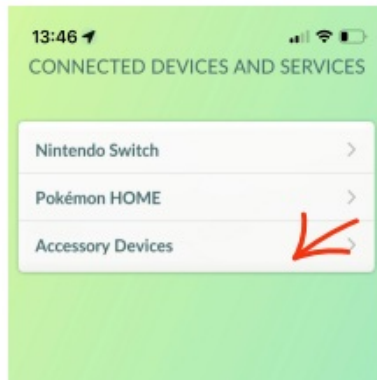
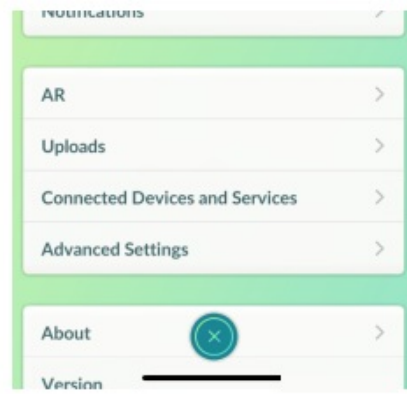
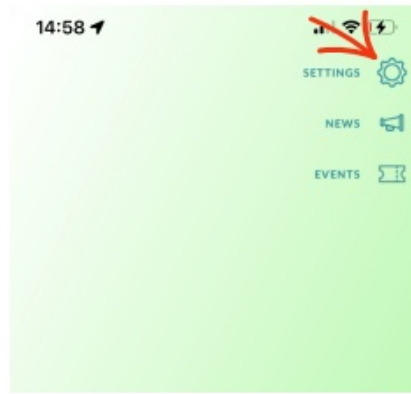

- On the settings screen, choose the 'Connected Devices and Services' option.
- On the 'Connected Devices and Services' screen, now choose the 'Accessory Devices' option.
- The following screen will display the 'Available Devices.'



- Your Tag will appear as a 'Pokémon Go Plus' that is currently 'Not Paired'
- Now press the button once on your GoTcha Tag – alternating White LEDs will indicate that it has entered pairing mode
- While the LEDs are still flashing, select the Pokémon Go Plus device on the 'Accessory Devices' screen and it will indicate that it is now pairing with your Tag.

- When you see that your Tag has connected you can return to the game screen where your connected device is shown by the icon on the upper right of the screen.

## **Settings**

- Your Tag is shipped with the Auto-Catching and Notification options already selected.
- This means that your Tag will automatically catch All Known & Unknown Pokémon and Automatically Collect Pokéstop items. Notifications and Vibration alerts are also enabled.
- You may wish to change some, or all of these settings. For example, you may want to auto-catch unknown Pokémon but not known Pokémon.
- Each of these settings can be simply toggled On or Off by using the button and the associated LED patterns.
- To access these settings press the button for about 1 second and then release.
- Below is a list of the 4 settings and the LED arrangements for the On & Off conditions for each one.
- Each time you press the button and release you will move through the settings in the order illustrated.
- If you miss the setting you were looking for, simply continue until that setting rolls around again.
- Each LED pattern indicates the current On/Off condition for that setting.
- To toggle a setting, quickly press the button once more while the LEDs are still on and the LEDs will indicate that the setting has changed from On to Off or Off to ON.
- These settings are retained until any changes are made.

## **Selectable Go-Tcha settings**



Pokéstop items OFF



Pokéstop items ON



Catch Unknown Pokémon OFF



Catch Unknown Pokémon ON



Catch Known Pokémon OFF



Catch Known Pokémon ON



Vibration Alerts LOW



Vibration Alerts HIGH

### Additional In-Game notifications



Unknown Pokémon Nearby



Known Pokémon Nearby



Unable to connect  
to internet or phone



Pokéstop Nearby



Bag Full



Pokemon/Pokéstop Item  
Catch Success



Pokémon Catch Fail



Missed Pokéstop



Low Battery



Battery Mostly Charged



Battery Slightly Reduced



Battery Greatly Reduced

## Settings Configuration

You can configure various settings on your GoTcha Tag:

- Vibration Alerts LOW
- Vibration Alerts HIGH
- Additional In-Game notifications
- Unable to connect to the internet or phone
- Bag Full
- Low Battery

- Battery Mostly Charged
- Battery Slightly Reduced
- Battery Greatly Reduced

---

## Documents / Resources



[CODEJUNKIES Tag Next Generation Auto Catcher](#) [pdf] User Guide  
Tag Next Generation Auto Catcher, Next Generation Auto Catcher, Auto Catcher, Catcher

## References

- [User Manual](#)

[Manuals](#), [Privacy Policy](#)

This website is an independent publication and is neither affiliated with nor endorsed by any of the trademark owners. The "Bluetooth®" word mark and logos are registered trademarks owned by Bluetooth SIG, Inc. The "Wi-Fi®" word mark and logos are registered trademarks owned by the Wi-Fi Alliance. Any use of these marks on this website does not imply any affiliation with or endorsement.