

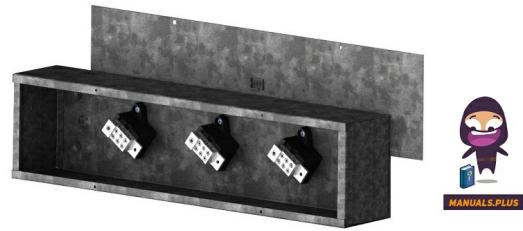

PAD-G Splitter Trough



CODE PAD-G Splitter Trough Owner's Manual

[Home](#) » [code](#) » CODE PAD-G Splitter Trough Owner's Manual 

Contents

- [1 CODE PAD-G Splitter Trough](#)
- [2 Specifications](#)
- [3 Product Usage Instructions](#)
- [4 DIMENSION](#)
- [5 FAQs](#)
- [6 Documents / Resources](#)
 - [6.1 References](#)



CODE PAD-G Splitter Trough

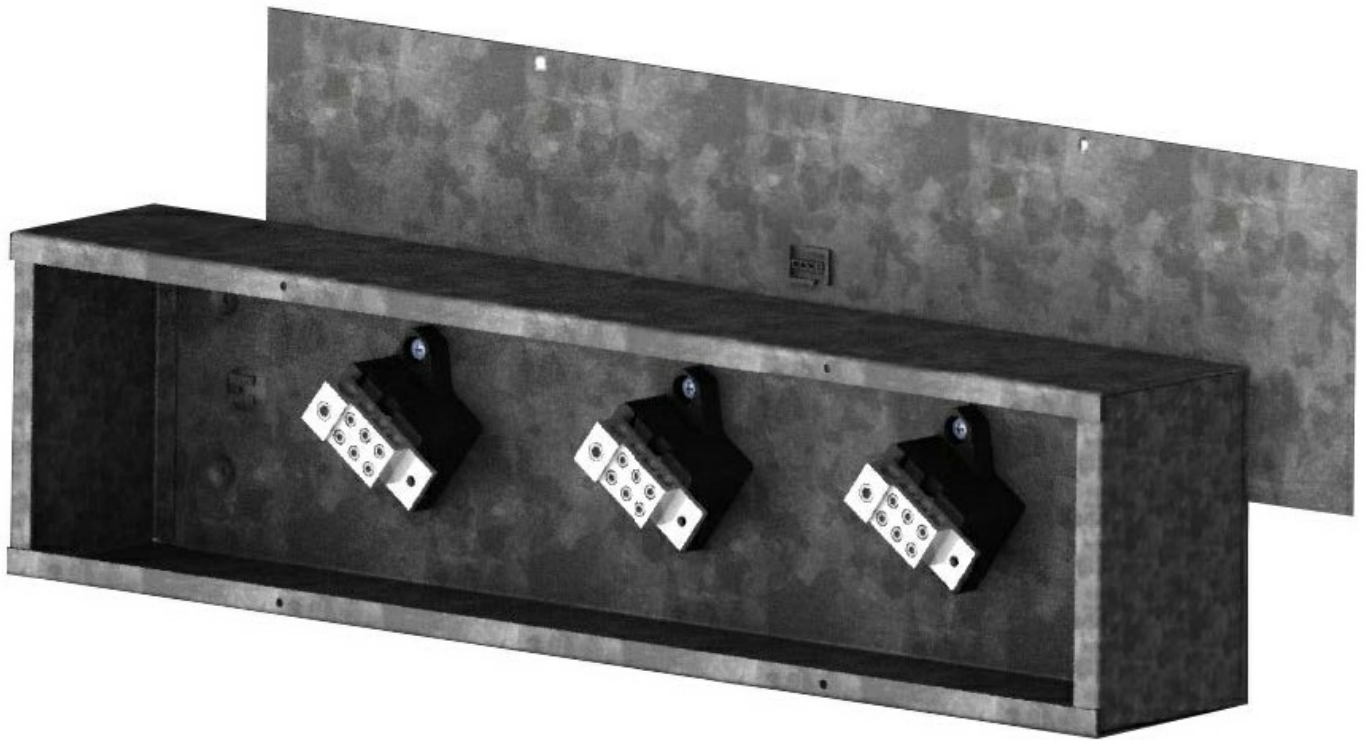

Specifications

- **Product Name:** PAD TYPE – SPLITTER TROUGH
- **Material:** Steel Galvanized
- **CSA Rating:** CSA 1 (125- 225 amp)
- **Service Voltage:** 600 V (max.)
- **Number of Wires:** 3 or 4

Product Usage Instructions

OVERVIEW

The PAD-G splitter troughs are designed for 600 V (max.) service, 3 or 4 wires.

- 14 Ga or 16 Ga galvanized steel
- Mounting holes in back
- Screw cover
- Factory Installed PADs
- CSA Certified
- Stocked in Port Coquitlam

Options include: hinged cover and custom powder coat colours.

DIMENSION

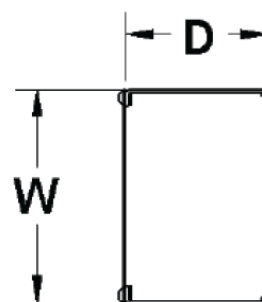
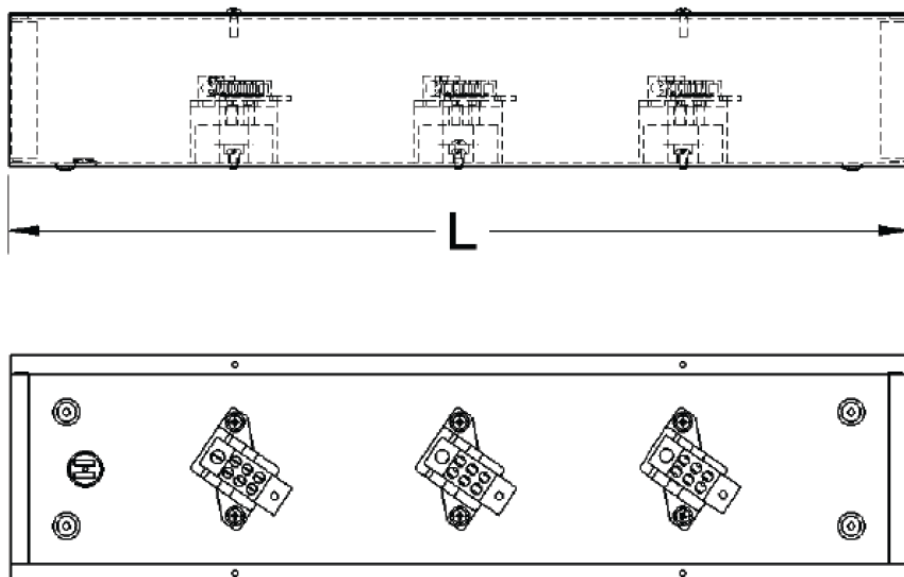

CAT No:		Main Lugs			Branch Lugs		Enclosure Size & Weight			
3 Wire	4 Wire	Amp	Qty.	Wires	Qty.	Wires	L	W	D	LBS
PAD-G-2413	_____	125	1	14-1/0	6	14-2	24	6	4	10.0
PAD-G-3613	PAD-G-3614						36	6	4	17.0
PAD-G-4813	PAD-G-4814						48	6	4	20.0
PAD-G-6013	PAD-G-6014						60	6	4	24.0
PAD-G-7213	PAD-G-7214						72	6	4	33.0
PAD-G-2423	_____	225	1	6-300 MC M	6	14-2/ 0	24	8	5	13.0
PAD-G-3623	PAD-G-3624						36	8	5	22.0
PAD-G-4823	PAD-G-4824						48	8	5	30.0
PAD-G-6023	PAD-G-6024						60	8	5	40.0
PAD-G-7223	PAD-G-7224						72	8	5	46.0

Custom sizes available codeelectric.com.

Tel: [604-540-0011](tel:604-540-0011)

FAQs

• Q: Are custom sizes available for the PAD-G splitter troughs?

- A: Yes, custom sizes are available to meet specific project requirements. Please contact our customer service at Tel: [604-540-0011](tel:604-540-0011) for more information on ordering custom sizes.

• Q: What are the options available for the PAD-G splitter troughs?

- A: The options include a hinged cover and the ability to select custom powder coat colors for the troughs.
- Contact us at Tel: [604-540-0011](tel:604-540-0011) or visit codeelectric.com for more information.

Documents / Resources



[CODE PAD-G Splitter Trough](#) [pdf] Owner's Manual

PAD-G-2413, PAD-G-3613, PAD-G-3614, PAD-G-4813, PAD-G-4814, PAD-G-6013, PAD-G-6014, PAD-G-7213, PAD-G-7214, PAD-G-2423, PAD-G-3623, PAD-G-3624, PAD-G-4823, PAD-G-4824, PAD-G-6023, PAD-G-6024, PAD-G-7223, PAD-G-7224, PAD-G Splitter Trough, Splitter Trough

References

- [User Manual](#)

[Manuals+](#), [Privacy Policy](#)

This website is an independent publication and is neither affiliated with nor endorsed by any of the trademark owners. The "Bluetooth®" word mark and logos are registered trademarks owned by Bluetooth SIG, Inc. The "Wi-Fi®" word mark and logos are registered trademarks owned by the Wi-Fi Alliance. Any use of these marks on this website does not imply any affiliation with or endorsement.