

CODE Acacia Shower Niche



CODE Acacia Shower Niche Installation Guide

[Home](#) » [code](#) » CODE Acacia Shower Niche Installation Guide 

Contents

- [1 CODE Acacia Shower Niche](#)
- [2 Product Information](#)
- [3 Product Usage Instructions](#)
- [4 INSTALLATION INSTRUCTION](#)
- [5 Care and Maintenance](#)
- [6 DIMENSION](#)
- [7 Documents / Resources](#)
 - [7.1 References](#)

CODE

CODE Acacia Shower Niche



Product Information

Specifications:

- **Product Name:** Acacia Exposed Shower Niche
- **Shape:** Arch and Rectangle
- **Material:** Acacia wood
- **Installation:** Requires Gib or villa board on walls

Product Usage Instructions

Installation Guide:

1. Gib or villa board the walls leaving the picture frame cut out ready for installation.
2. Ensure the lip screws over the wall fixings as shown in Diagram A.

Care and Maintenance:

For cleaning, wipe over with a damp microfibre cloth and rinse off after. Avoid contact with any nail polish removers or exit mould. If the niche comes into contact with these substances, wash off immediately to prevent damage.

FAQ

- **Q: Can the Acacia Exposed Shower Niche be used in wet areas?**

A: Yes, the Acacia Exposed Shower Niche is suitable for wet areas but should be maintained as per the care instructions.

- **Q: What tools are required for installation?**

A: You will need Gib or villa board, wall fixings, screws, and basic installation tools.

INSTALLATION INSTRUCTION

1. Unwrap the niche and check it over for any damage or manufacturing defects – If you are concerned at all please advise the retailer for a replacement – Once these items are installed it is a costly process to swap these out.
2. Plan exactly where you want the Niche situated – taking into account the tile size and tiling layout, you don't want any unsightly tile details once finished – sometimes it pays to check with your tiler on his expectations before deciding on exact placement.
3. Build a suitable-sized picture frame for the Niche to fit into – allowing a 5mm gap right around to help with levelling the shelves perfectly when screwing them into place.
4. Gib or villa board the walls leaving the picture frame cut out and ready for installation. (the lip screws over the wall fixings as seen in diagram A)
5. Test fit the niche over the wall lining and into the picture frame – level up then mark the fixing holes – pilot hole these points then use a counter sink piece to create clearance for the punched holes – the surrounding 50mm flange is intended to fit flush against the wall linings.
6. Once you have completed the dry fit to your satisfaction, please use the glue and screws provided to fit the unit using plenty of glue onto the back of the unit to provide support and plenty around the flange to seal it off to the wall lining – Fit screws and leave to dry overnight.
7. Once adhesives are dry please wipe the flange to be waterproofed with a white cleaning spirit and then waterproof over the wallboard lapping onto the 50mm outer flange – be careful not to get waterproofing product all over the portion of the finish that is exposed.
8. Once the waterproofing is dry – Complete tiling – again being very careful not to damage the exposed portion of the Niche.

Care and Maintenance

For cleaning wipe over with a damp microfibre cloth and rinse off after. Avoid contact with any nail polish removers, or exit mould if the niche comes into contact with these substances, please wash off immediately as it will.



DIMENSION

Diagram A
Shower Niche Arch

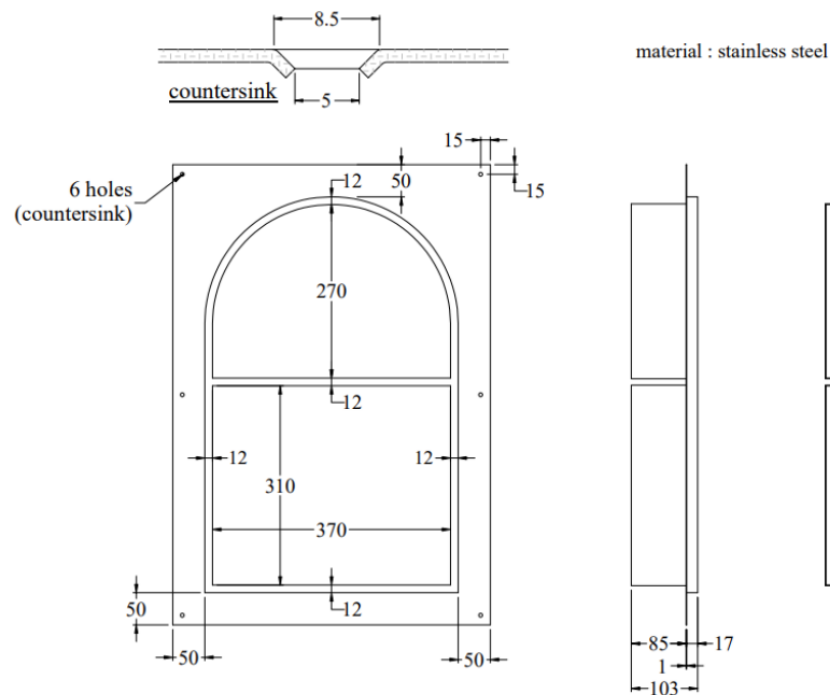

Diagram B
Shower Niche Rectangle

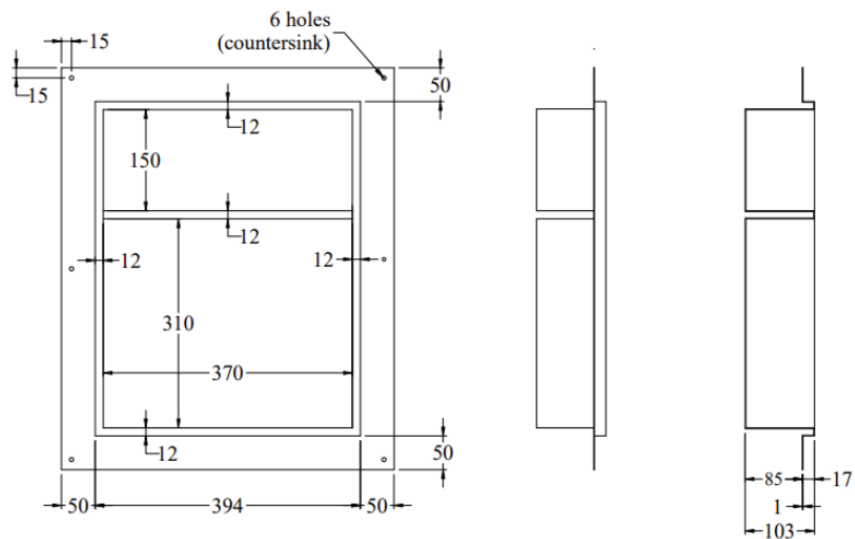
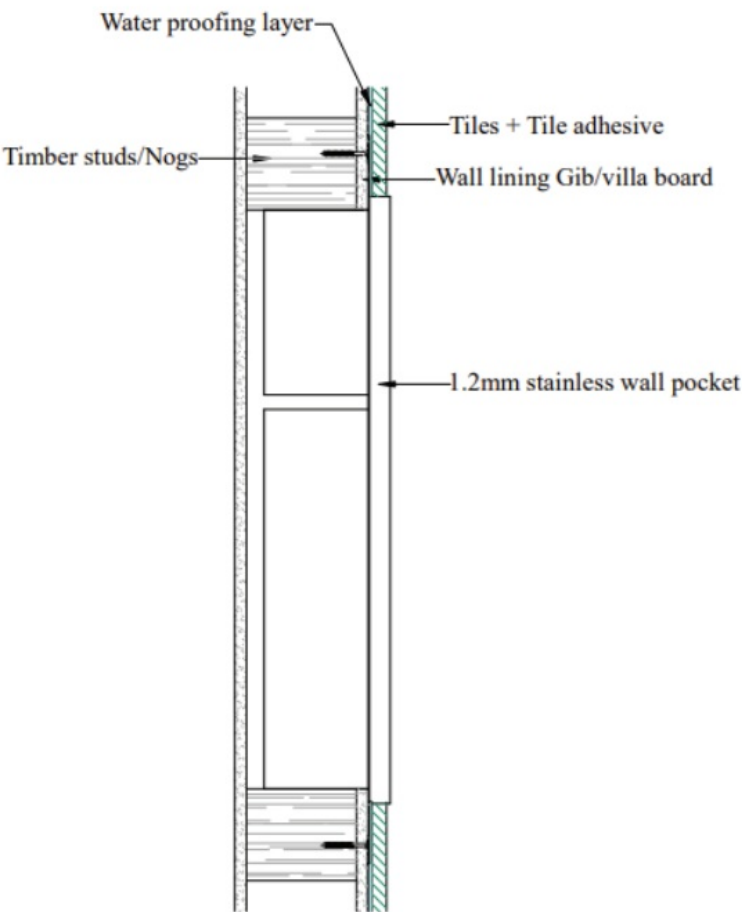

Diagram C



Documents / Resources

	<p>CODE Acacia Shower Niche [pdf] Installation Guide Acacia Shower Niche, Acacia, Shower Niche, Niche</p>
---	---

References

- [User Manual](#)

[Manuals+](#), [Privacy Policy](#)

This website is an independent publication and is neither affiliated with nor endorsed by any of the trademark owners. The "Bluetooth®" word mark and logos are registered trademarks owned by Bluetooth SIG, Inc. The "Wi-Fi®" word mark and logos are registered trademarks owned by the Wi-Fi Alliance. Any use of these marks on this website does not imply any affiliation with or endorsement.