

Contents [[hide](#)]

- 1 [Cocinare CES-223 Precision Coffee Scale](#)
- 2 [Product Diagram](#)
- 3 [Button Functions](#)
- 4 [Operation Guide](#)
- 5 [Weigh Mode](#)
- 6 [Match Mode](#)
- 7 [Cleaning and Maintenance](#)
- 8 [Documents / Resources](#)
 - 8.1 [References](#)

Cocinaré

Cocinare CES-223 Precision Coffee Scale



A team of diverse professionals united by our love for coffee and passion for innovation. With our expertise in engineering, design, and technology, we're confident in our ability to innovate and bring something new to the coffee industry. Our obsession with coffee drives us to create exceptional products and solutions that go beyond the norm. We can't wait to welcome you aboard our team.



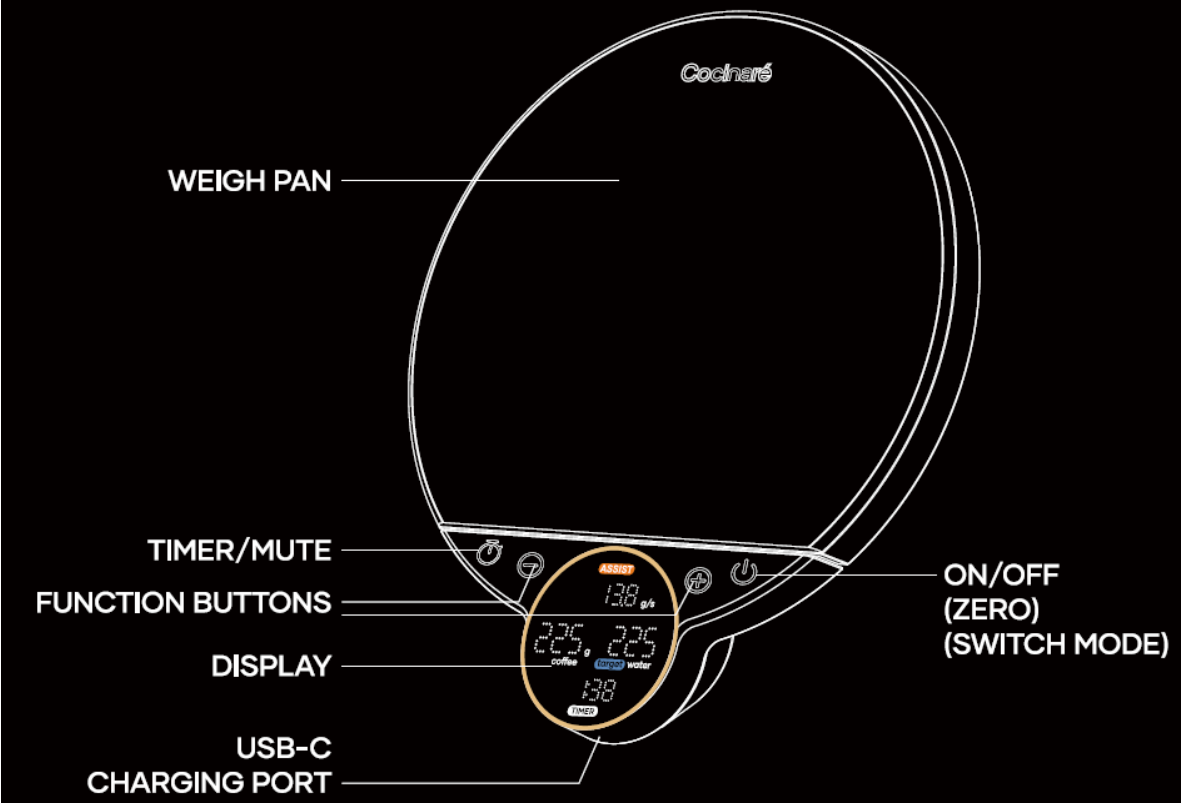

Product Diagram



| | | | |
|--------------|--|-------------------------|-------------------|
| Product Name | BALANCE Precision Coffee Scale | Accuracy | 0.1g/0.1ml/0.01oz |
| Model | CES-223 | Charging specifications | 5V/500mah |
| Weight | 380g | Battery Specifications | 3.7V 1000mah |
| Max Capacity | 3000g/105.82oz | Auto Shut-Off Time | 5 Minutes |

Button Functions

| Button | Function | Operation |
|--|--|---|
|  Power Button | Turn On | In the off state, press or hold the [Power Button] for 2 seconds. |
| | Turn Off | In any state, hold the [Power Button] for 2 seconds. |
| | Zero | 1. In the assist mode, press the [Power Button] to reset the current weight to 0.0g. 2. In the weigh mode, press the [Power Button] to reset the current weight to 0.0g/0.0ml/0.00oz. |
| | Switch Mode | Double-press the [Power Button] to switch between assist mode and weigh mode. |
|  Timer Button | Start Brewing Interface | 1. In the assist mode, press the [Timer Button]. 2. In the weigh mode, press the [Timer Button]. |
| | Start/Pause Timer | 1. When entering the assist mode - brewing interface, press the [Timer] button to manually start the timer. 2. When entering the weigh mode - brewing interface, press the [Timer] button to manually start the timer. |
| | Reset Timer | After starting the timer function, hold the [button] for 2 seconds. |
|  [-], [+] | Increase/Decrease Brew Ratio | In the assist mode, press [-] or [+] to adjust the brew ratio. |
| | Switch Units | In the weigh mode, press [-] or [+] to switch between different units: g/ml/oz. |
| | Start Match Mode and Record Sharing Cup Weight | Hold [-] and [+] simultaneously for 2 seconds to set a specific sharing pot. |
| | Exit Match Mode | Hold [-] and [+] simultaneously for 2 seconds to set the sharing pot weight to 0g. |

Operation Guide

Assist Mode

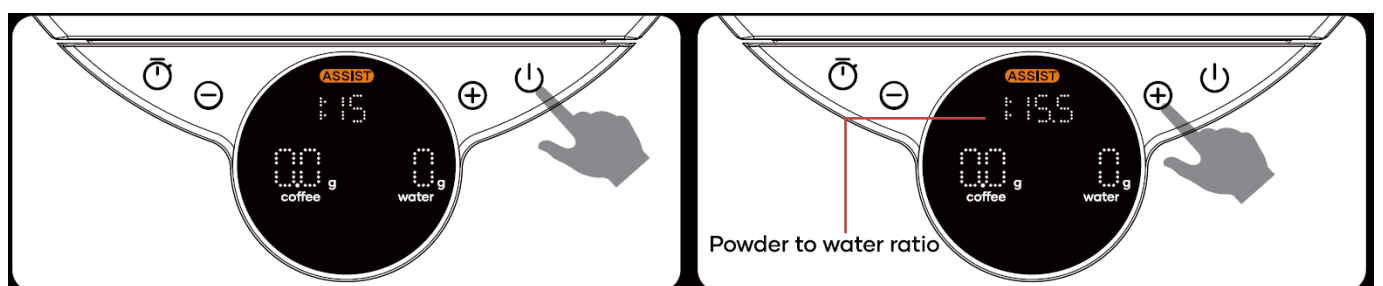

1. Start Assist Mode

Press and hold the [Power Button] for 2 seconds to turn on the device, which defaults to Assist Mode.

2. Setup and Preparation

Adjust your preferred brew ratio by pressing or holding the – or [+] buttons.

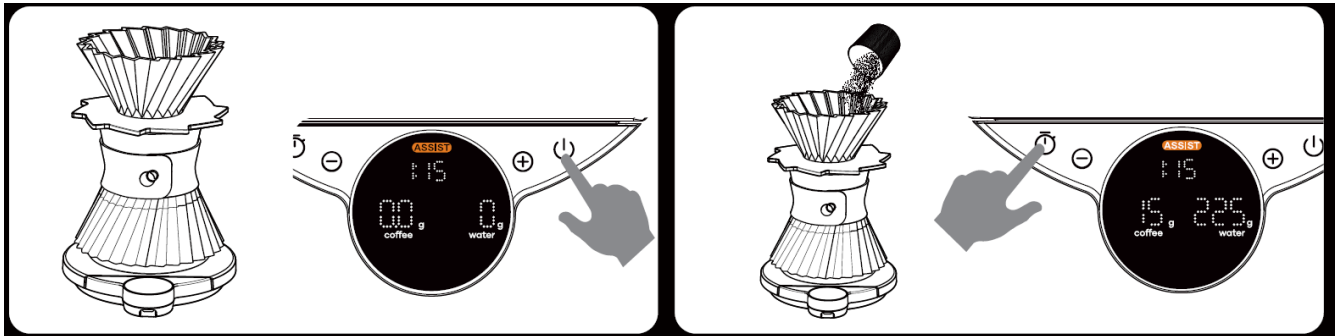

3. Place the equipment

Place the sharing pot and filter cup, then press the [Power Button] to zero the weight.

4. Start Brewing Interface

Add your ground coffee; the device automatically calculates the water needed. Tap the [Timer Button] to start brewing, with the timer and flow rate display enabled.

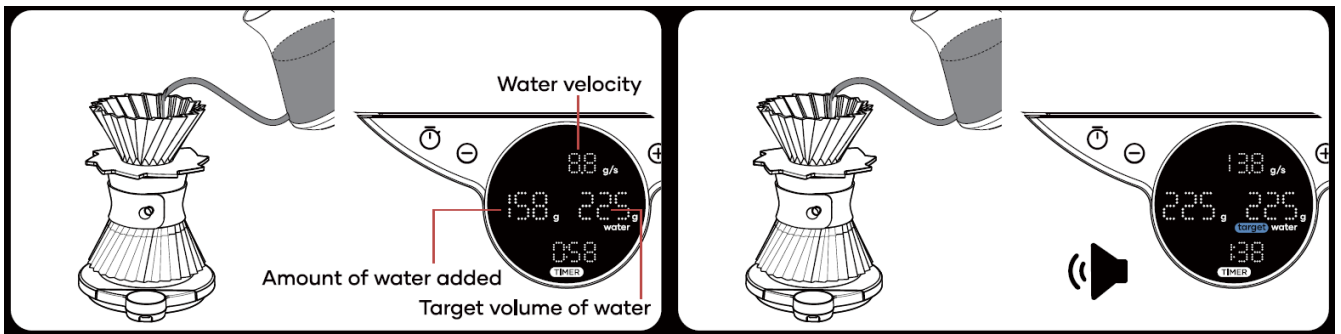

5. Start Brewing

Brew according to your method. The built in timer starts automatically, the top displays real-time flow rate, and upon completion of a brew, it shows the average flow rate for that session.

6. Brewing Complete

The device beeps when the water is 10g short of the target. Its beeps twice and the target icon lights up when the desired water amount is reached, signaling the end of brewing.

Weigh Mode

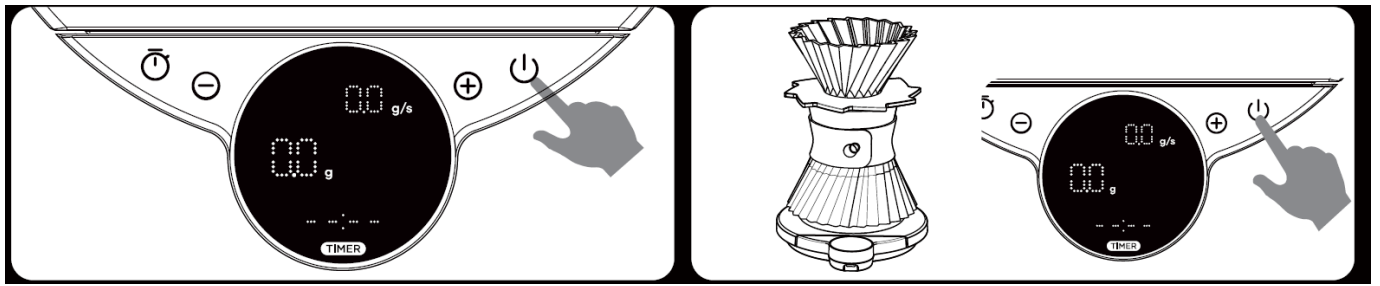

1. Weigh Mode

Double-press the [Power Button] to switch modes and enter Weigh Mode. You can then lightly touch the –/+ to select and switch between different units: g/ml/oz.

2. Preparation

Place the sharing pot and filter cup, then press the [Power Button] to zero.

3.

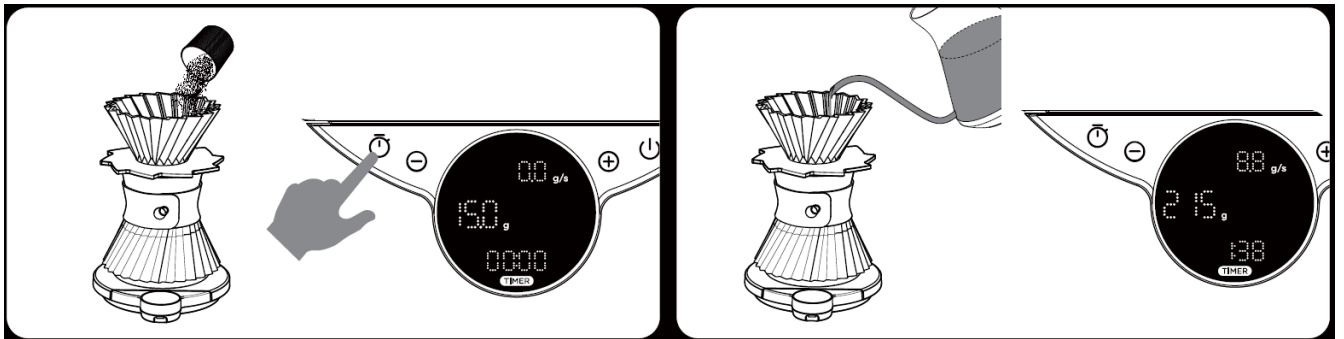

Start Brewing Interface

Add your ground coffee, then tap the [Timer Button] to enter the brewing interface and start the automatic timer.

4. Start Brewing

Add liquid, and the timer will start automatically, with the flow rate displayed at the top.

Match Mode

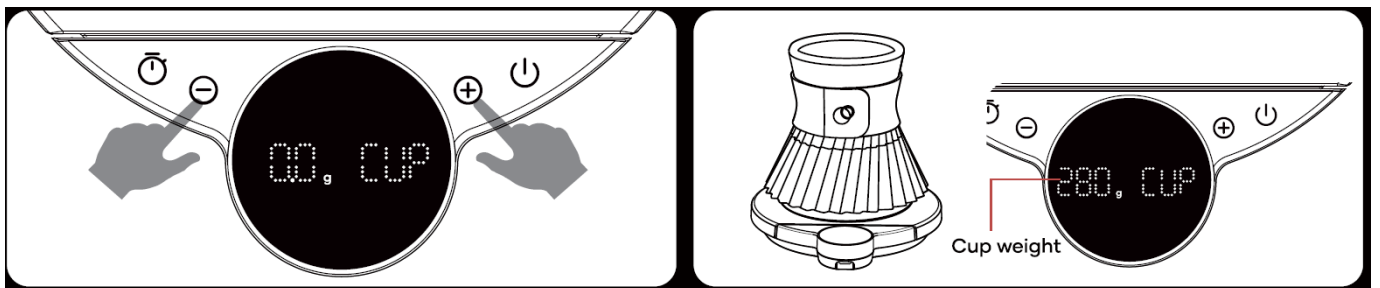

1. Enable Match Mode

Clear the weighing area, then press the [Power Button] to zero.

Hold – and + simultaneously for 2 seconds to enable Match Mode.

2. Set a Specific Sharing Cup

Place your designated sharing filter cup on the scale to enter its weight.

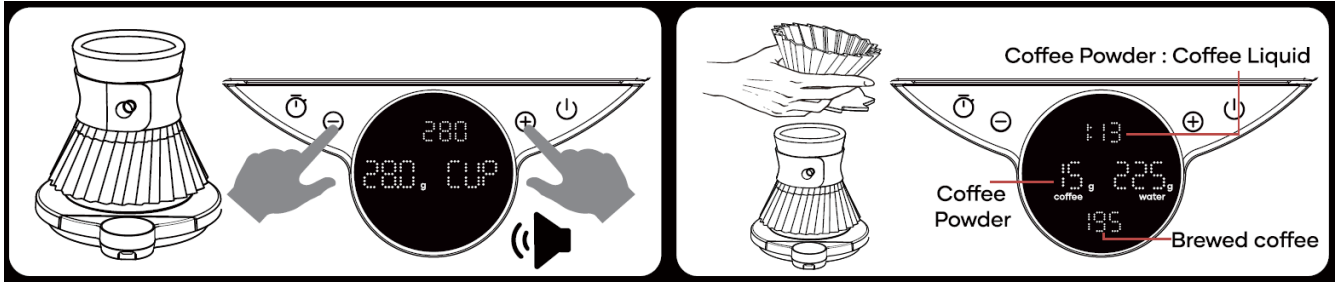

3. Complete Setup

Hold [-] and [+] for 2 seconds. When the weight flashes and the machine beeps twice, the filter cup weight is successfully entered and the device automatically returns to Assist Mode. Add coffee grounds and press the [Timer Button] to brew.

4. Display Extracted Coffee Liquid Weight After completing the brewing in Assist Mode, remove the filter cup to display the coffee liquid weight.

5. Disable Match Mode

Hold [-] and [+] simultaneously for 2 seconds to set the sharing pot weight to 0.

NOTE:

Cleaning and Maintenance

1. Coffee liquid can be corrosive. To prevent damage to the scale, please clean any residue from the weighing area promptly.
2. Avoid washing the weighing area With water directly; use a damp cloth to wipe and clean the area to prevent corrosion from coffee liquid.
3. Charging resets the scale to factory settings, clearing saved cup weights. To use Competition Mode again, you'll need to re-input the cup weight manually.
4. Low battery icon appears below 25%  . Charge soon to avoid power loss.

Questions?

If your product is defective and under warranty, please contact us at Email.

- Email: support@cocinare.com
- Phone: +1833 6551778(US)
- Available time:
Mon-Fri 9:00 am – 5:00 pm (PST/PDT)

Cocinare Offers a 12-Month Product Warranty.

6 MONTHSEXTENDED WARRANTY

Log in to cocinare.com within 3 months of purchase to extend your warranty to 18 months. Scan the QR code for registration or visit our official website.



@ Cocinarecoffee

Experience the charm of pour-over coffee with us! Follow for inspiring coffee gear content.

THANK YOU

Scan the QR code to access a more detailed electronic manual and additional language versions.



Documents / Resources

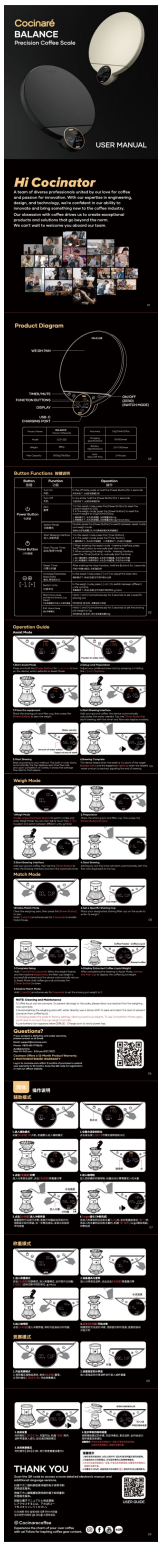

[Cocinare CES-223 Precision Coffee Scale \[pdf\]](#) User Manual

CES-223 Precision Coffee Scale, CES-223, Precision Coffee Scale, Coffee Scale, Scale

References

- [User Manual](#)

📄 CES-223, CES-223 Precision Coffee Scale, Cocinare, Coffee Scale, Precision Coffee Scale,

📁 Cocinare Scale

Leave a comment

Your email address will not be published. Required fields are marked *

Comment *

Name

Email

Website

☐ Save my name, email, and website in this browser for the next time I comment.

Post Comment

Search:

Search

[Manuals+](#) | [Upload](#) | [Deep Search](#) | [Privacy Policy](#) | [@manuals.plus](#) | [YouTube](#)

This website is an independent publication and is neither affiliated with nor endorsed by any of the trademark owners. The "Bluetooth®" word mark and logos are registered trademarks owned by Bluetooth SIG, Inc. The "Wi-Fi®" word mark and logos are registered trademarks owned by the Wi-Fi Alliance. Any use of these marks on this website does not imply any affiliation with or endorsement.