



clover C600 Card Reader User Guide

[Home](#) » [clover](#) » clover C600 Card Reader User Guide 

Contents

- 1 [clover C600 Card Reader](#)
- 2 [WHAT IN THE BOX](#)
- 3 [CONNECTIONS](#)
- 4 [Federal Communication Commission Statement](#)
- 5 [Documents / Resources](#)
 - 5.1 [References](#)
- 6 [Related Posts](#)



clover C600 Card Reader



WHAT IN THE BOX

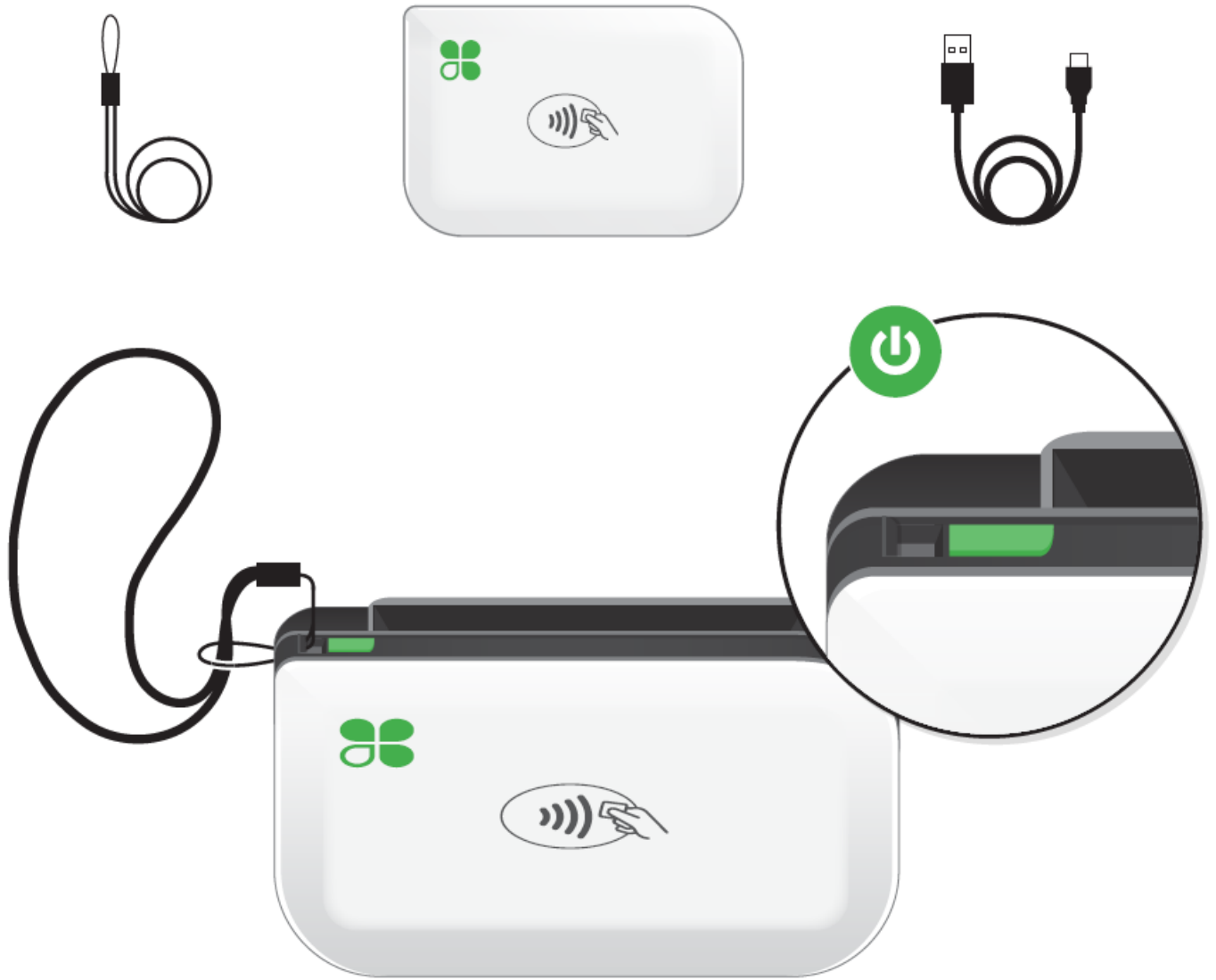

CONNECTIONS

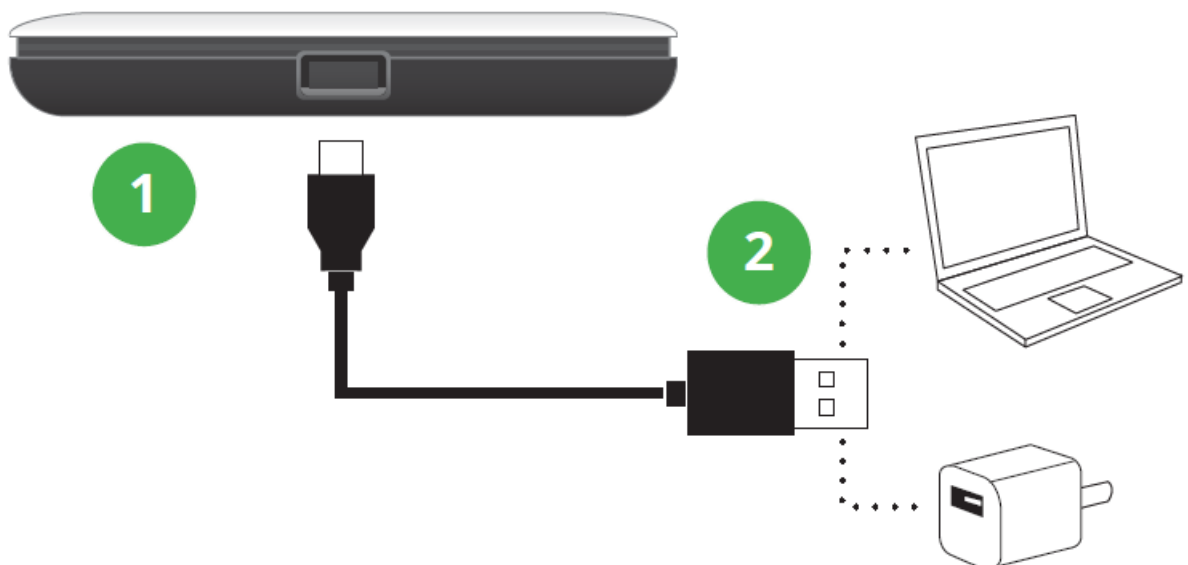

To set up your device and start taking payments, get the Clover Companion app on your phone.

Federal Communication Commission Statement

This device complies with Part 15 of the FCC Rules. Operation is subject to the following two conditions: (1) This device may not cause harmful interference, and (2) this device must accept any interference received, including interference that may cause undesired operation. This equipment has been tested and found to comply with the limits for a Class B digital device, pursuant to Part 15 of the FCC Rules. These limits are designed to provide reasonable protection against harmful interference in a residential installation. This equipment generates, uses and can radiate radio frequency energy and, if not installed and used in accordance with the instructions, may cause harmful interference to radio communications. However, there is no guarantee that interference will not occur in a particular installation. If this equipment does cause harmful interference to radio or television reception, which can be determined by turning the equipment off and on, the user is encouraged to try to correct the interference by one of the following measures:

- Reorient or relocate the receiving antenna.
- Increase the separation between the equipment and receiver.
- Connect the equipment into an outlet on a circuit different from that to which the receiver is connected.
- Consult the dealer or an experienced radio/TV technician for help.

FCC Caution: Any changes or modifications not expressly approved by the party responsible for compliance could void the user’s authority to operate this equipment.

Radiation Exposure Statement:

The product complies with the FCC portable RF exposure limit set forth for an uncontrolled environment and is safe for intended operation as described in this manual. The further RF exposure reduction can be achieved if the product can be kept as far as possible from the user body or set the device to low output power if such function is available.

Documents / Resources

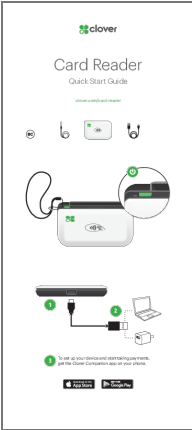
	<p>clover C600 Card Reader [pdf] User Guide</p> <p>C600, HFS-C600, HFSC600, C600 Card Reader, Card Reader, Reader</p>
---	---

References

- [POS System & Credit Card Readers | Clover](#)
- [POS System & Credit Card Readers | Clover](#)