



CloudVocal TWCLV38A Flash Track DSP Microphone User Manual

[Home](#) » [CloudVocal](#) » CloudVocal TWCLV38A Flash Track DSP Microphone User Manual 

Contents

- [1 CloudVocal TWCLV38A Flash Track DSP Microphone](#)
- [2 Product Usage Instructions](#)
- [3 Product Specifications](#)
- [4 FCC Certification](#)
- [5 Federal Communication Commission Interference](#)
- [6 Documents / Resources](#)
 - [6.1 References](#)
- [7 Related Posts](#)

CloudVocal

CloudVocal TWCLV38A Flash Track DSP Microphone



Product Specifications

1. Displays real-time signal strength and function operations.
2. OLED Display Screen
3. Switch Knob
4. VOL Button
5. EQ Button
6. COMP Button
7. REV Button
8. Microphone Head
9. LOGO Button
10. AUX Port
11. USB Data Port
12. Bluetooth Pairing Button
13. 5V DC Power Port
14. Headphone Jack
15. Microphone Stand

Product Usage Instructions

Power On

The screen will show an animation when the power is on. The LED will show the connection status by different

colors. Green = USB connected, Red = NO USB connection! Please check if you are using the original cable and connect to the USB data port if you see a constant red light.

*Some Android models may cause the green and red lights to flash due to USB power saving mechanisms. You can ignore that if it switches to a purple light during recording, which means the device is still working properly.

- **Volume EQ**

Press the EQ button to enter Hold EQ button on 'My EQ' page.

- **Compressor**

Press the COMP button to enter Hold COMP button on 'My COMP' page.

- **Reverb**

Press the REV button to enter Hold REV button on 'My REV' page.

- **Adjusting Volume**

Use the switch knob to adjust the microphone and monitoring headphone volume. After adjusting, press the switch knob to return to the home screen or access other adjustment functions.

EQ Settings

Use the switch knob to select different EQ presets: FLAT/WARM/CLEAR/BRIGHT. Press the EQ button to toggle between the following frequency points and use the switch knob to adjust.

Compressor Settings

Use the switch knob to select different presets: OFF/CAST+/PUNCH+/SING+/DYNA+. Press the COMP button to toggle between the following items and use the switch knob to adjust.

Reverb Settings

Use the switch knob to select different presets: OFF/MODERN/CONCERT/LIVE/CLASSIC/K-OK. Press the REV button to toggle between the following items and use the switch knob to adjust.

IR Loopback

Press LOGO button to enter the IR setting. Use the switch knob to select different IR presets.

Press LOGO button to enter the loopback setting. Use switch knob to control the loopback on/off by switch. *If you intend to perform multi-track recording, it is recommended to turn it off.

Microphone Stand

Used for mounting the microphone, with 1/4 inch thread.

Frequently Asked Questions

- **Q: How do I adjust the microphone and monitoring headphone volume?**

A: Press the VOL button and use the switch knob to adjust the volume.

- **Q: How do I change the EQ settings?**

A: Press the EQ button to enter the EQ settings page. Use the switch knob to select different EQ presets and adjust the frequency points.

- **Q: How do I change the compressor settings?**

A: Press the COMP button to enter the compressor settings page. Use the switch knob to select different presets and adjust the settings.

- **Q: How do I adjust the reverb settings?**

A: Press the REV button to enter the reverb settings page. Use the switch knob to select different presets and adjust the settings.

- **Q: How do I enable or disable the IR loopback?**

A: Press the LOGO button to enter the IR setting. Use the switchknob to select different IR presets. To enable or disable the loopback, press the LOGO button to enter the loopback setting and use the switch knob to control the loopback on/off.

Product Specifications

- **Dimensions** (excluding microphone stand)
- **Length: 65mm, Width: 64mm, Height: 108mm ±1%Weight: 270g ±1%**
- **Digital Interface:** USB-C (USB 2.0), Bluetooth 5.0
- **Analog Interfaces:** 3.5mm TRS *2 (Headphone/AUX)
- **Power Consumption: Normal: 0.6W, IR Startup: 1.2W Audio Specifications:** Bit Depth/Sample **Rate:** 24-bit/192kHz **Microphone Diameter:** Ø25mm, Condenser
- **Polar Pattern:** Cardioid
- **Frequency Response:** 20Hz-20,000Hz
- **Maximum Sound Pressure Level:** 130 dB
- **Gain Range:** 46dB

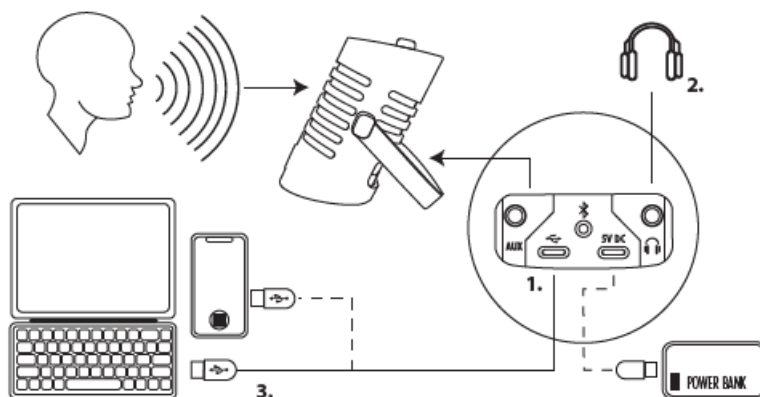

Usage Steps

1. Connect the USB device. The microphone's green light will turn on, and the opening animation will appear.
 2. Connect headphones and adjust microphone and monitor volume.
 3. Configure your recording software. A purple light indicates a successful connection, and ready for recording.
- If the microphone shows a red light, please ensure that you are using the original cable and it is plugged into the USB data port. If the issue persists, it means that the device does not support USB audio functionality and cannot be used with this product.
 - In case of power limitations on the connected USB device preventing the microphone from starting correctly, connect an external power source to the 5V DC power port to assist in starting the microphone.
 - During recording, you can connect external audio sources or add accompaniment tracks via Bluetooth. For related tutorials and information, please visit the FAQ page on our official website.

1. OLED Display Screen	Displays real-time signal strength and function operations.
2. Switch Knob	Rotates for function settings, press to return to the home screen.
3. VOL Button	Adjusts microphone and monitor volume.
4. EQ Button	Adjusts EQ settings.
5. COMP Button	Adjusts compressor settings.
6. REV Button	Adjusts reverb settings.
7. Microphone Head	<p>Controls microphone position and displays various indicators for the microphone's current status</p> <ul style="list-style-type: none"> • Green Light: Standby • Red Light: USB Device Not Found • Blue Light: IR On • Purple Light: USB Device Connected, Ready to Record • Flashing Light: Microphone Muted
8. LOGO Button	<ul style="list-style-type: none"> • Short Press: Adjusts IR and toggles Loop back function. • Long Press: Controls microphone mute function.
9. AUX Port	3.5mm TRS jack for external audio.
10. USB Data Port	Connects to USB Audio devices for recording. Flashtrack Device Name: FT_USB
11. Bluetooth Pairing Button	<p>Activates Bluetooth pairing for external audio via Bluetooth. Bluetooth Device Name: FT_BT</p> <ul style="list-style-type: none"> • No Light: Standby • Flashing: Pairing Mode Activated • Steady Light: Bluetooth Pairing Completed
12. 5V DC Power Port	Connecting to power adapter or external power.
13. Headphone Jack	3.5mm TRS jack for headphones output.
14. Microphone Stand	Used for mounting the microphone, with 1/4 inch thread.

FCC Certification

This device complies with Part 15 of the FCC Rules. Operation is subject to the following two conditions

1. This device may not cause harmful interference, and
2. This device must accept any interference received, including interference that may cause undesired operation.



Features	Icon	Description
Power On		The screen will show an animation when the power is on. The LED will show the connection status by different colors. Green = USB connected, Red = NO USB connection! Please check if you are using the original cable and connect to the USB data port if you see a constant red light. *Some Android models may cause the green and red lights to flash due to USB power saving mechanisms. You can ignore that if it switches to a purple light during recording, which means the device is still working properly.
Home Screen		Displays real-time signal strength for the microphone, external audio source, and total audio output. Please adjust the volume intensity for each within the two ranges indicated on the screen to achieve the best audio quality.
Volume		Press the VOL button and use the switch knob to adjust the microphone and monitoring headphone volume. After adjusting, press switch knob to return to the home screen or access other adjustment functions.
EQ	Press the EQ button to enter Hold EQ button on 'My EQ' page 	Use the switch knob to select different EQ presets: FLAT/WARM/CLEAR/BRIGHT Press the EQ button to toggle between the following frequency points and use the switch knob to adjust: · Low shelf: 100Hz · Bass: 250-500Hz · Low MID: 600-900Hz · High MID: 1K-2.5K · Treble: 3K-5K · High shelf: 8K
Compressor	Press the COMP button to enter Hold COMP button on 'My COMP' page 	Use the switch knob to select different presets: OFF/CAST+/PUNCH+/SING+/DYNA+ Press the COMP button to toggle between the following items and use the switch knob to adjust: · THRESHOLD · RATIO · GAIN · ATTACK TIME · RELEASE TIME
Reverb	Press the REV button to enter Hold REV button on 'My REV' page 	Use the switch knob to select different presets: OFF/MODERN/CONCERT/LIVE/CLASSIC/K-OK Press the REV button to toggle between the following items and use the switch knob to adjust: · TYPE · TONE · SPACE · BLEND
IR		Press LOGO button to enter the IR setting. Use switch knob to select different IR presets: · RBN : Based on a ribbon microphone · DYN : Based on a dynamic microphone When IR is enabled, the microphone light will turn blue.
Loopback		Press LOGO button to enter the loopback setting. Use switch knob to control the loopback on/off by switch. *If you intend to perform multi-track recording, it is recommended to turn it off.
Default Settings		While in the home screen, hold switch knob and LOGO button for five seconds to return to default settings.
Microphone mute		Hold LOGO button to mute the microphone. When the microphone is muted, the microphone light will flash. *Only the (microphone) audio will be muted, and it won't affect other input sources.

Safety Precautions

1. Please thoroughly read the quackster guide and keep it for reference.
2. Avoid direct contact with liquids and use the product in a dry, well-ventilated environment.
3. Use accessories and cables provided by the manufacturer.
4. Control headphone volume appropriately to prevent any hearing damage.
5. Do not attempt to disassemble the device . please contact customer service when encounter any issues.
6. Adjust cables and placement appropriately to prevent any accident.
7. Keep the product out of reach of children.
8. Serial number are local on the bottom of the products for reference.

Federal Communication Commission Interference

Statement

This equipment has been tested and found to comply with the limits for a Class B digital device, pursuant to Part 15 of the FCC Rules. These limits are designed to provide reasonable protection against harmful interference in a residential installation.

This equipment generates, uses and can radiate radio frequency energy and, if not installed and used in accordance with the instructions, may cause harmful interference to radio communications. However, there is no guarantee that interference will not occur in a particular installation. If this equipment does cause harmful interference to radio or television reception, which can be determined by turning the equipment off and on, the user is encouraged to try to correct the interference by one of the following measures

- Reorient or relocate the receiving antenna.
- Increase the separation between the equipment and receiver.
- Connect the equipment into an outlet on a circuit different from that to which the receiver is connected.
- Consult the dealer or an experienced radio/TV technician for help.

FCC Caution

To assure continued compliance, any changes or modifications not expressly approved by the party responsible for compliance could void the user's authority to operate this equipment. (Example – use only shielded interface cables when connecting to computer or peripheral devices).

FCC Radiation Exposure Statement

This equipment complies with FCC RF radiation exposure limits set forth for an uncontrolled environment. This equipment should be installed and operated with a minimum distance of 0.5 centimeters between the radiator and your body.

This transmitter must not be co-located or operating in conjunction with any other antenna or transmitter.

The antennas used for this transmitter must be installed to provide a separation distance of at least 0.5 cm from all persons and must not be co-located or operating in conjunction with any other antenna or transmitter.

FCC Certification

This device complies with Part 15 of the FCC Rules. Operation is subject to the following two conditions

1. This device may not cause harmful interference, and
2. This device must accept any interference received, including interference that may cause undesired operation.

Documents / Resources

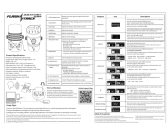

[CloudVocal TWCLV38A Flash Track DSP Microphone](#) [pdf] User Manual
TWCLV38A Flashtack DSP Microphone, TWCLV38A, Flashtack DSP Microphone, DSP Microphone, Microphone

References

- [User Manual](#)

[Manuals+](#), [Privacy Policy](#)