



CLIPSAL Mixed Flow Inline Fans Installation Guide

[Home](#) » [CLIPSAL](#) » CLIPSAL Mixed Flow Inline Fans Installation Guide 

Contents

- 1 CLIPSAL Mixed Flow Inline Fans
- 2 Safety, Installation and Operating Requirements
 - 2.1 NOTICE
- 3 Warranty and Contact Information
 - 3.1 Customer care—Australia
 - 3.2 Customer care—New Zealand
- 4 Mounting Options
- 5 Installation Diagrams
- 6 Maintenance and Cleaning Instructions
- 7 Documents / Resources
 - 7.1 References
- 8 Related Posts



CLIPSAL Mixed Flow Inline Fans



Safety, Installation and Operating Requirements

DANGER

RISK OF ELECTRIC SHOCK, EXPLOSION OR ARC FLASH

- This product must only be installed and serviced by appropriately qualified and/or licenced electrical personnel.
- Isolate the electrical supply before doing any work on this product.
- Ensure that the product has been correctly installed and tested for safe operation before reconnecting the electrical supply.
- The product must be installed so that the switches and other controls cannot be touched by a person in the bath or shower

Failure to follow these instructions will result in death or serious injury.

NOTICE

INSTALLATION HAZARD

- The fan is suitable for both horizontal or vertical mounting on the floor, wall or ceiling (see fig. 2) as one unit or connected in parallel or series sets (see fig. 3).
 - In case of horizontal fan mounting install an air duct on the side of the intake vent not less than 1 metre; in case of vertical fan mounting install an outer hood to prevent water ingress inside the fan.
 - The exhaust pipe must be connected to the air duct.
 - Check the fan for any visible damages of the impeller and casing before starting installation.
 - The casing internals must be free of any foreign objects which can damage the impeller blades.
- Failure to follow these instructions can in equipment damage or reduced lifespan of components.

USAGE HAZARD

- Do not misuse or make any unauthorised modifications to the product.
- Do not use the fan in an environment containing hazardous or explosive materials and vapours, such as spirits, gasoline, insecticides etc.
- Do not close or block the fan intake or extract vents in order to ensure the most effective air passage.
- Do not sit on the fan and do not put objects on the fan.
- Take steps to prevent ingress of smoke, carbon monoxide, and other combustion products into the room through open chimney flues or other fire-protection devices.
- Sufficient air supply must be provided for proper combustion and exhaust of gases through the chimney of fuel burning equipment to prevent back drafting.

Failure to follow these instructions can in equipment damage or reduced lifespan of components.

CAUTION

IMPORTANT CLEANING SAFEGUARDS

- Isolate the electrical supply before doing any work on this product.
- Clean the product surfaces regularly (once in 6 months) to remove dust and dirt (see fig. 18-25)
- To clean the fan use a soft cloth and brush with a mild detergent-water solution.
- Avoid water dripping on the electrical components and wipe surfaces dry after cleaning.

Failure to follow these instructions can result in injury or equipment damage.

EQUIPMENT OPERATION HAZARD

- This product is not intended for use by persons (including children) with reduced physical, sensory or mental capabilities, or lack of experience and knowledge, unless they have been given supervision or instruction by a person responsible for their safety.
- If the supply cord is damaged, it must be replaced by the manufacturer, its service agent or similarly qualified persons.

Failure to follow these instructions can result in injury.

Warranty and Contact Information

Customer care—Australia

We warrant this product for 3 years. For details, visit: <https://www.schneider-electric.com.au/en/about-us/legal/termsand-conditions.jsp>

Our goods also come with guarantees that cannot be excluded under the Australian Consumer Law. You are entitled to a replacement or refund for a major failure and compensation for any other reasonably foreseeable loss or damage. You are also entitled to have the goods repaired or replaced if the goods fail to be of acceptable quality and the failure does not amount to a major failure. Schneider Electric (Australia) Pty Ltd Customer Care: 1300 369 233

Email: customercare.au@schneider-electric.com

Customer care—New Zealand

We warrant this product for 2 years. For details, visit: <https://www.schneider-electric.co.nz/en/about-us/legal/terms-andconditions.jsp> Schneider Electric (NZ) Ltd Customer Care: 0800 652 999

Email: sales@nz.schneider-electric.com
www.schneider-electric.co.nz

Schneider Electric reserves the right to change specifications, modify designs and discontinue items without incurring obligation and whilst every effort is made to ensure that descriptions, specifications and other information in this catalogue are correct, no warranty is given in respect thereof and the company shall not be liable for any error therein.

© 2018 Schneider Electric.

This material is copyright under Australian, New Zealand and international laws. Except as permitted under the relevant law, no part of this work may be reproduced by any process without prior written permission of and acknowledgement to Schneider Electric.

Mounting Options

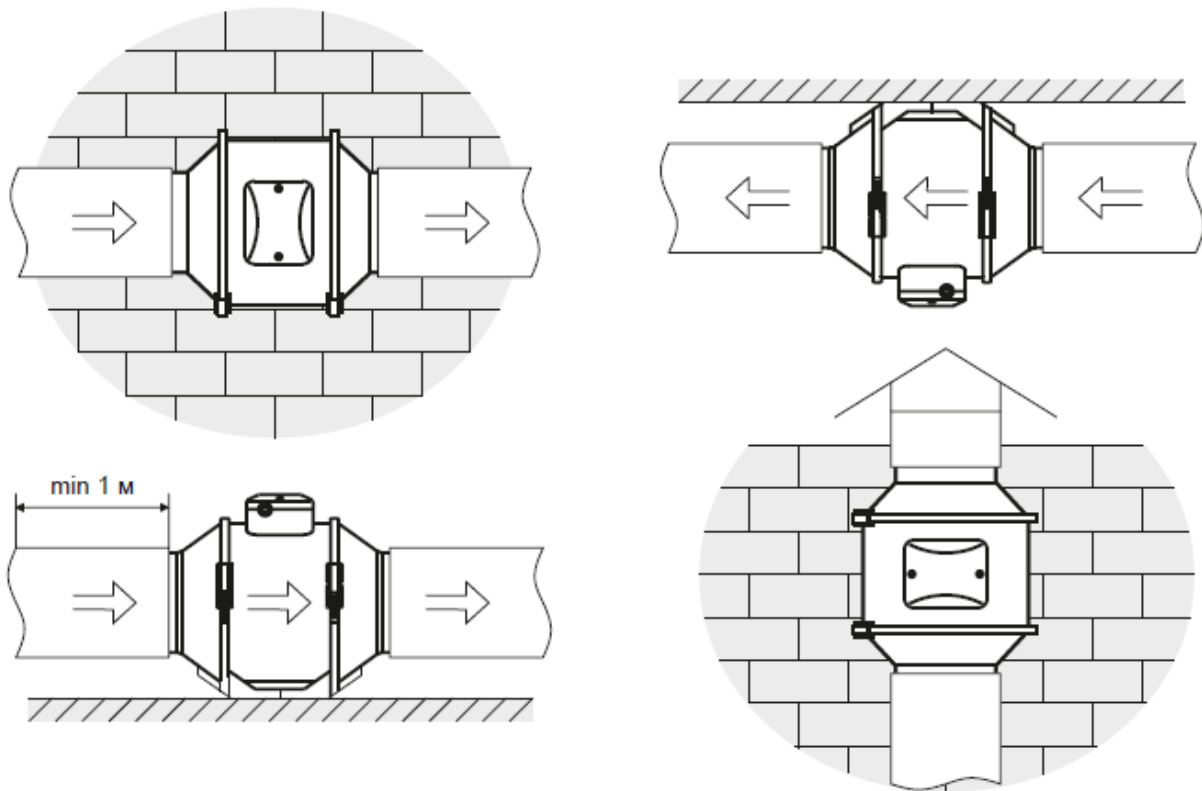

1

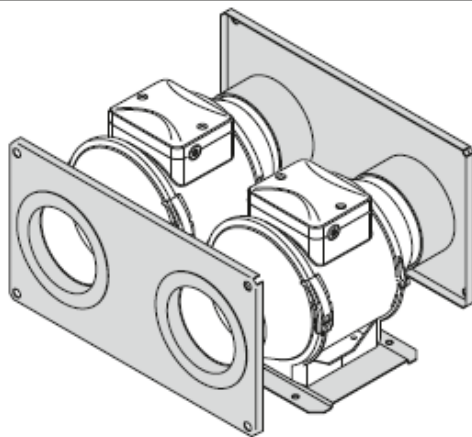

2

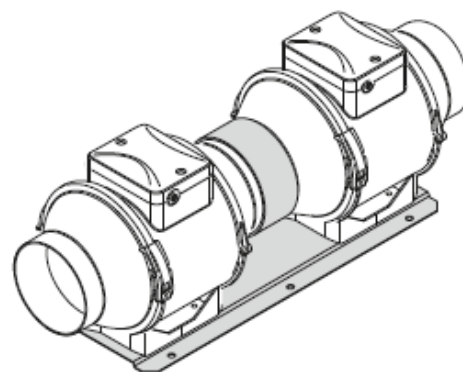

Installation Diagrams

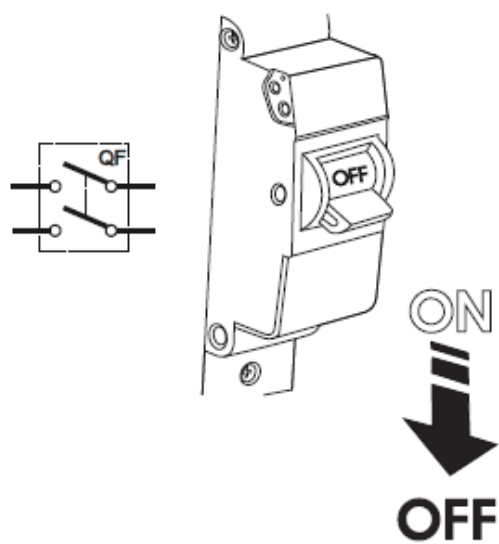

3

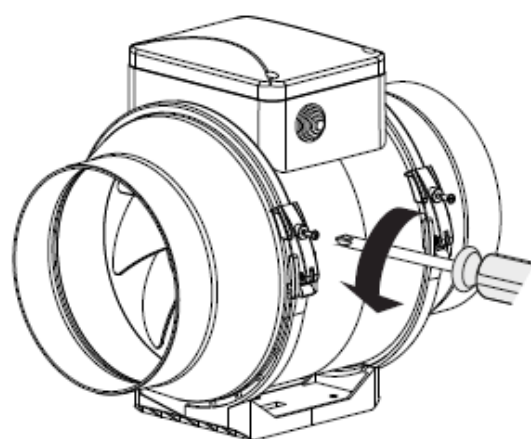

4

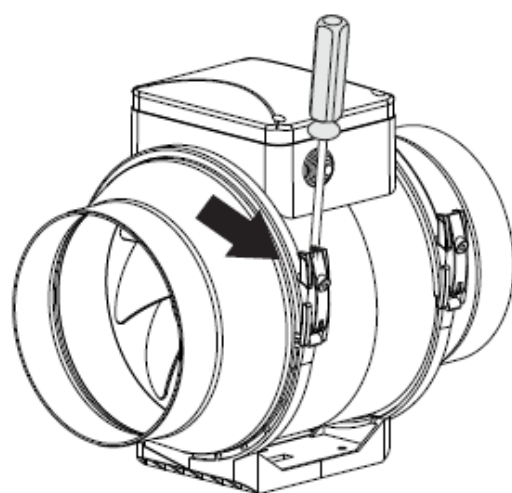

5

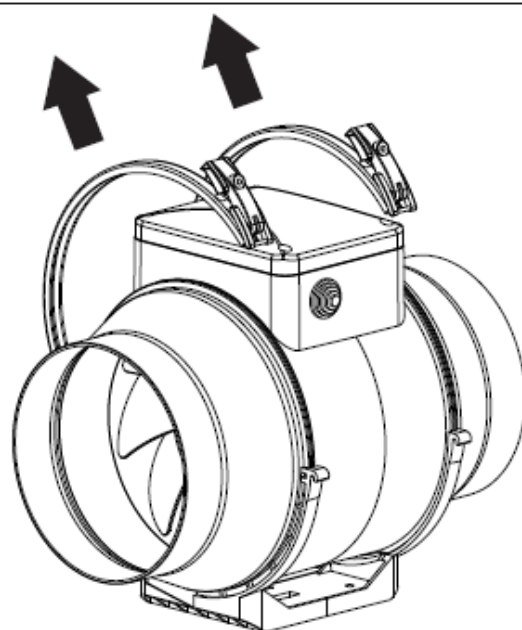

6

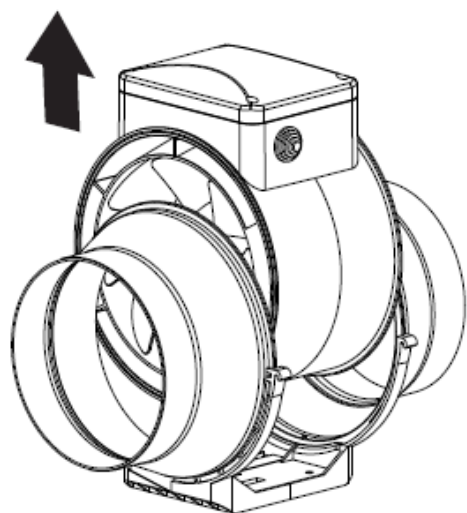

7

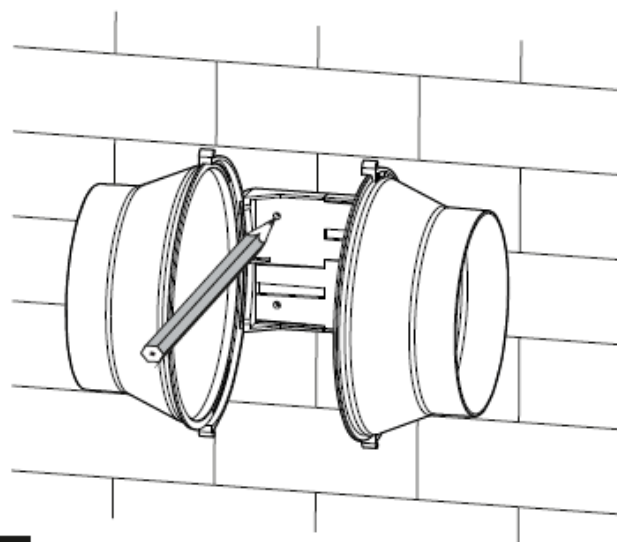

8

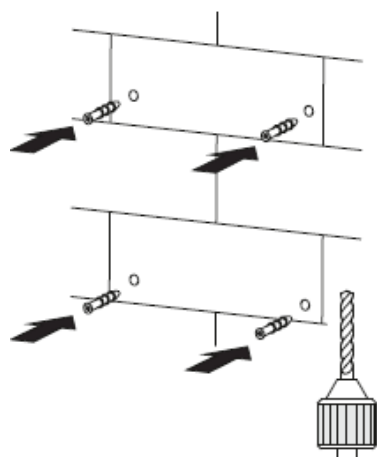

9

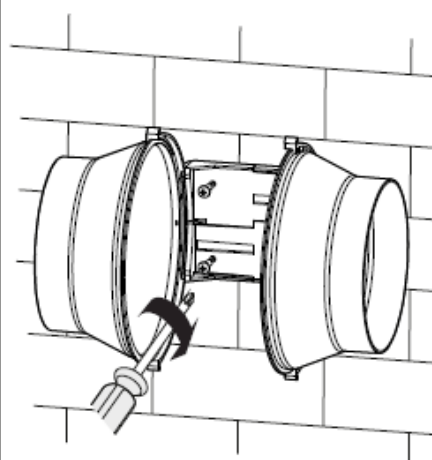

10

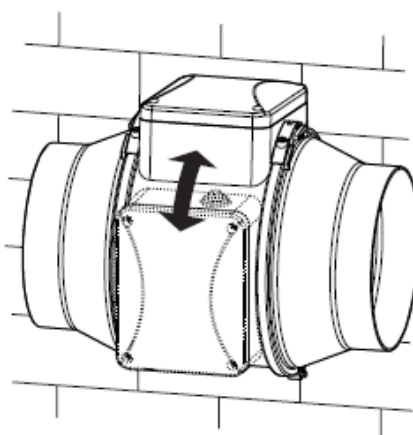

11

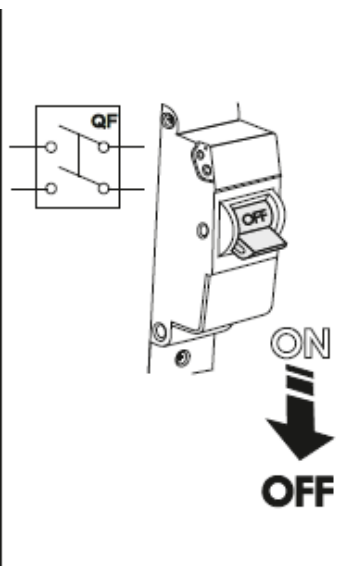

12

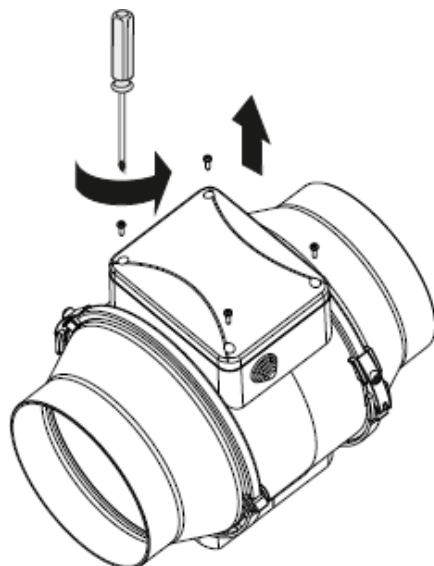

13

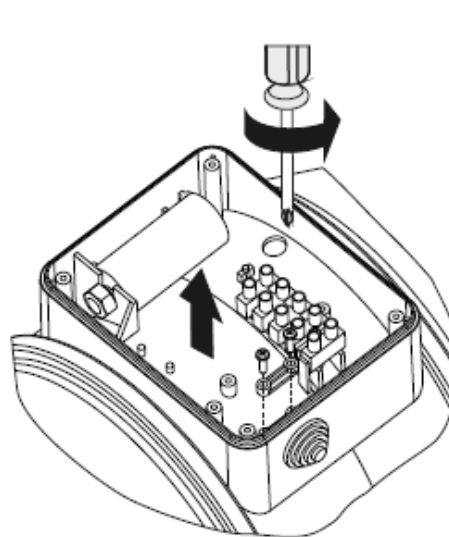

14

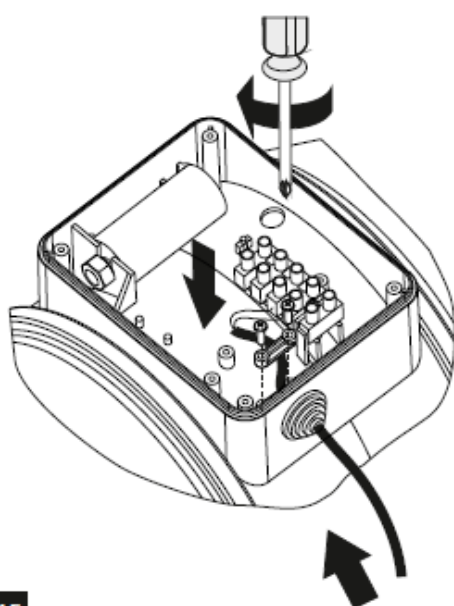

15

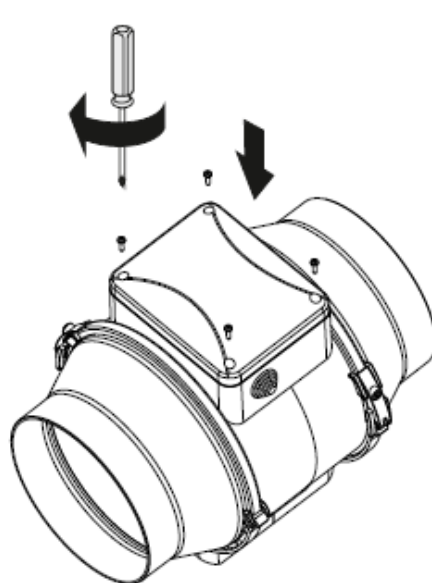

16



17

Maintenance and Cleaning Instructions

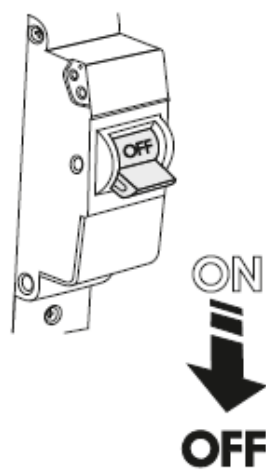

18

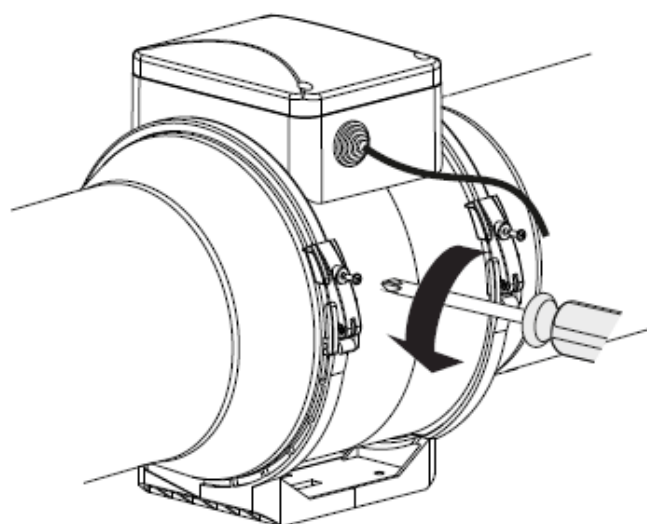

19

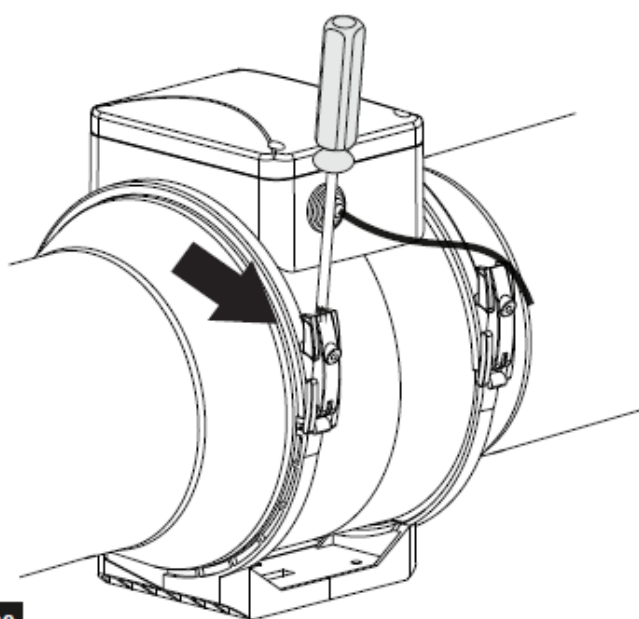

20

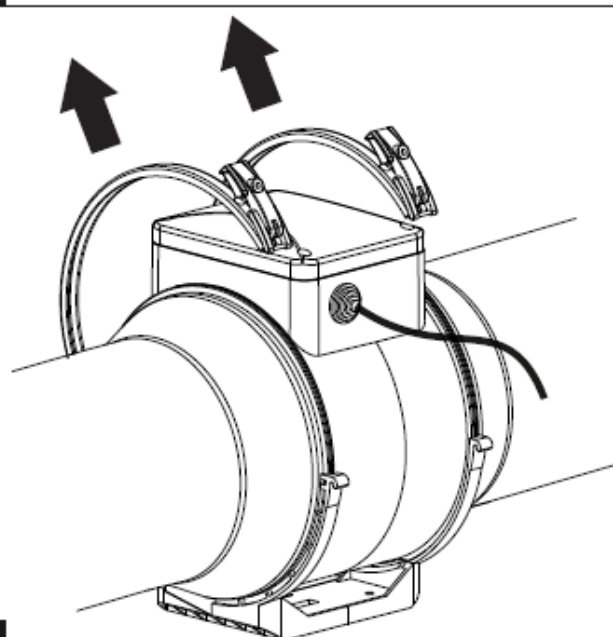

21

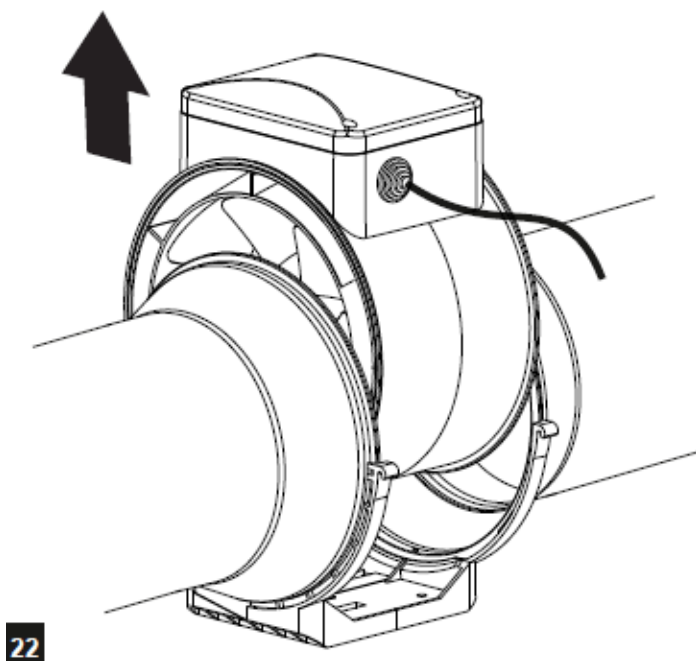

22

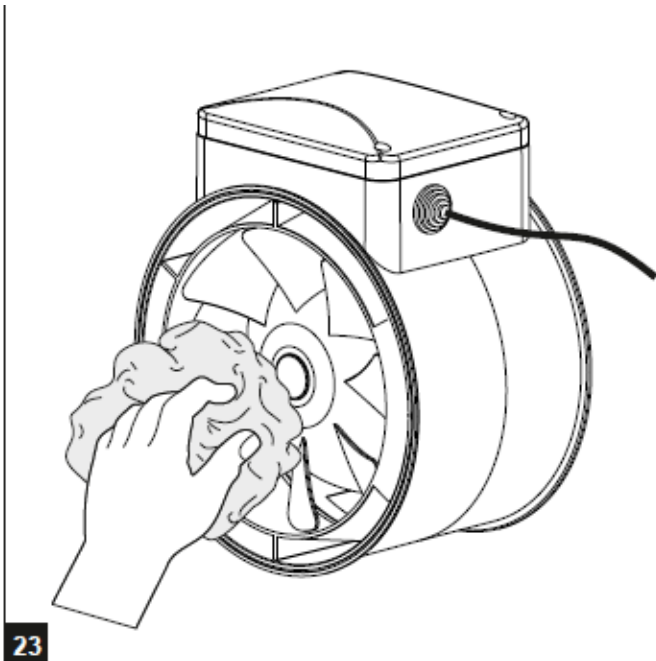

23

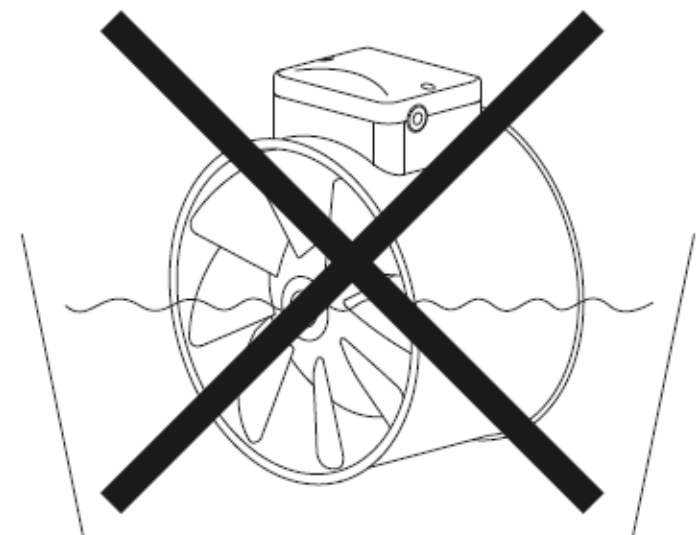

24



25

CLIPSAL[®]



Documents / Resources



[CLIPSAL Mixed Flow Inline Fans](#) [pdf] Installation Guide
Mixed Flow Inline Fans, MFINLINE-100, MFINLINE-150, MFINLINE-200

References

- [Electric](#) | The Largest Consumer Energy & Renewables Platform

-  [Schneider Electric Global | Global Specialist in Energy Management and Automation](#)
-  [Schneider Electric New Zealand | Global Specialist in Energy Management and Automation](#)
-  [Schneider Electric Australia | Global Specialist in Energy Management and Automation](#)

Manuals+.