

climax Technology  
PCU-3 Pull Cord  
Unit



## climax Technology PCU-3 Pull Cord Unit Instruction Manual

[Home](#) » [Climax Technology](#) » climax Technology PCU-3 Pull Cord Unit Instruction Manual 

### Contents

- 1 climax Technology PCU-3 Pull Cord Unit
- 2 Product Usage Instructions
- 3 Frequently Asked Questions
- 4 Parts Identification
- 5 Battery
- 6 Installation
- 7 Mounting Procedures
- 8 Federal Communication Commission Interference Statement
- 9 Documents / Resources
  - 9.1 References
- 10 Related Posts

# climax Technology

climax Technology PCU-3 Pull Cord Unit



## Product Specifications

- **Model Options:** PCU-3, PCU-5
- **PCU-5:** Includes IPX4 Waterproof standard
- **Battery Type:** CR2 3V lithium battery
- **LED Indicator:** Lights up when PCU is activated

## Product Usage Instructions

### Battery Installation

1. Open the lid of the PCU using a flat-headed screwdriver.
2. Loosen the screws to remove the stabilizer and access the battery compartment.
3. Insert the CR2 3V lithium battery into the compartment.
4. Reassemble the PCU by following the steps in reverse order.

### Cord Installation

1. Measure the mounting height and cord length for accessibility.
2. Cut or modify the long cord for easy gripping of the handle.
3. Tie the modified cord to the short cord attached to the PCU.
4. Ensure there are no obstructions for users to pull the handle.

## Frequently Asked Questions

### How do I know if the battery is low?

The PCU will flash the LED indicator 3 times when a low battery is detected. Additionally, it will transmit a low battery signal to the Control Panel.

### How do I activate the PCU in an emergency?

To activate the PCU in an emergency, simply pull the cord attached to the unit. This will transmit an emergency signal to the Control Panel and illuminate the LED indicator.

### Pull Cord Unit (PCU-3 / PCU-5)

- The Pull Cord Unit is used to activate an alarm when the cord is pulled. It can be quickly installed in easily accessible indoor locations for users to pull for emergency help.
- The PCU Pull Cord Unit includes the following models.
- **PCU-3:** Pull Cord Unit
- **PCU-5:** Pull Cord Unit with IPX4 Waterproof standard

### Parts Identification

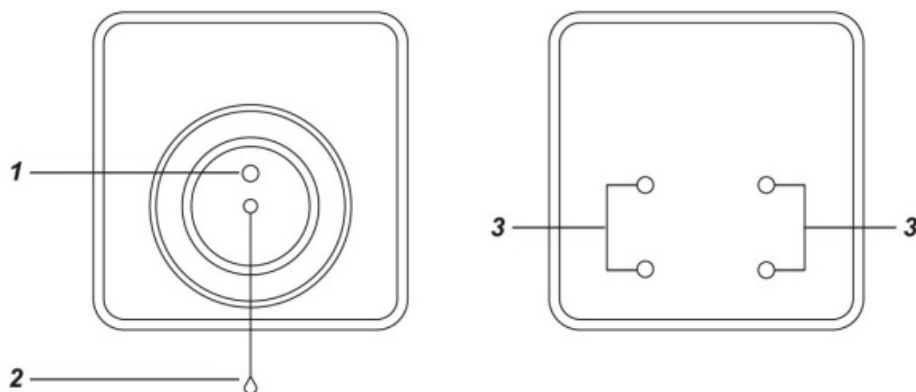

#### 1. LED Indicator

- The LED Indicator will light up when PCU is activated

#### 2. Pull Cord Switch

- Pull the attached cord to activate the PCU. For cord installation, see the Installation section below.

#### 3. Mounting Holes (Knockouts)

### Battery

- The PCU uses one CR2 3V lithium battery.
- The PCU can detect low battery automatically. When the low battery is detected, it will transmit a low battery signal to notify the Control Panel.
- When a battery is inserted, if the battery voltage is low, the LED indicator will flash 3 times to indicate.
- To insert the battery, please refer to Installation for details.

## Learning

- Put the Control Panel into learning mode (refer to the Control Panel manual for details), and pull the cord on PCU to transmit the learn code.
- Refer to the Control Panel manual to complete the learning process.

## Operation

- When in an emergency, pull the cord to activate the PCU, the PCU will transmit an emergency signal to the Control Panel, the LED will also light up.

## Installation

### Battery Installation

- Please follow the steps below to insert the battery
- **Step 1.** Open the lid of the PCU by using a flat-headed screwdriver (Pic 1.)
- **Step 2.** Open the upper cover of the PCU using the flat-headed screwdriver from two circled directions only (Pic 2 & 3)

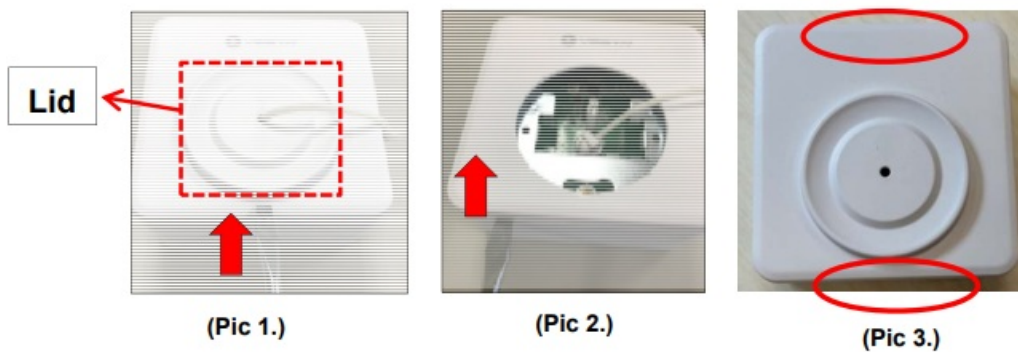

- **Step 3.** Loosen the two screws on the PCU base securing the stabilizer using a Philips screwdriver so that the stabilizer becomes mobile (Pic 4.) It is not mandatory to entirely remove both screws.

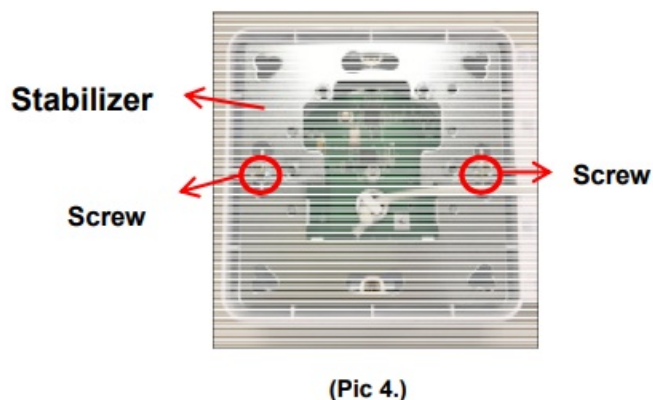

- **Step 4.** Rotate the stabilizer gently in an anti-clockwise direction until both screw heads meet the end of the screw holes as picture shown below (Pic 5.), then remove the stabilizer from the bottom case and flip it over, you will see the battery compartment as (Pic 6.)

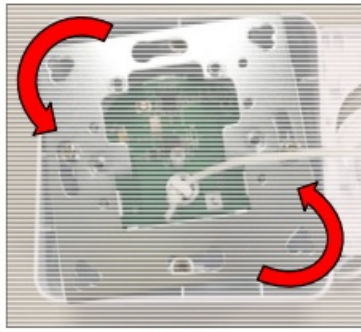

(Pic 5.)

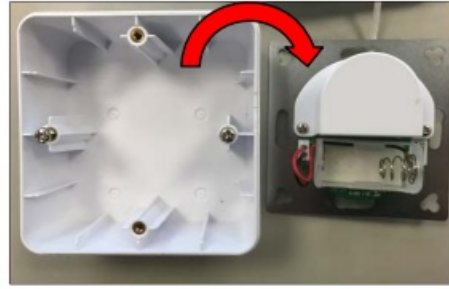

(Pic 6.)

- **Step 5.** PCU case removal is completed; you can now insert the battery.
- **Step 6.** Start the reassembly, replace, and screw back the stabilizer onto the base.
- **Step 7.** Replace the upper cover, and make sure the latches on the stabilizer are exposed from the upper cover hole (Pic 7).
- **Step 8.** Replace the lid. Please match the PCU LED with the LED mark behind the lid and match the latches accordingly when replacing (Pic 8.).

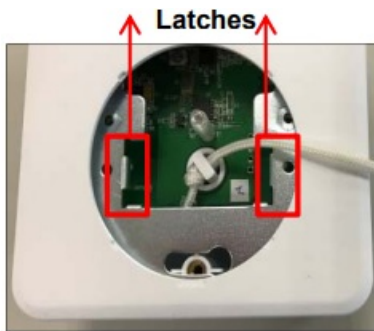

(Pic 7.)

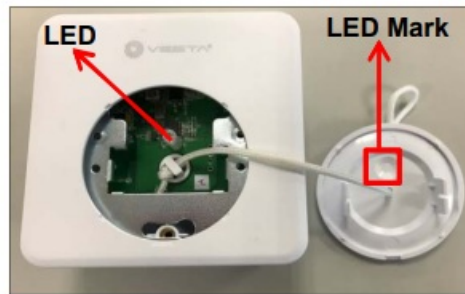

(Pic 8.)

## Cord Installation

- The PCU-3 or PCU-5 comes supplied with a long cord that incorporates a bell-shaped handle. Users can pull the handle to activate an alarm. Follow the steps below to tie the PCU-3 /PCU-5 with the cord.
- **Step 1.** Measure the height at which you intend to mount the PCU-3/PCU-5 and the length of the cord. Ensure that the PCU-3/PCU-5 and the cord must be accessible for users to grip and pull the handle without obstructions.
- **Step 2.** Cut or modify the length of the long cord so that a user can grip the handle easily.
- **Step 3.** A short cord is attached with the PCU-3/PCU-5 beforehand. Tie the cord you cut with the short cord attached to the PCU-3/PCU-5.
- **Step 4.** The Cord Installation is complete.

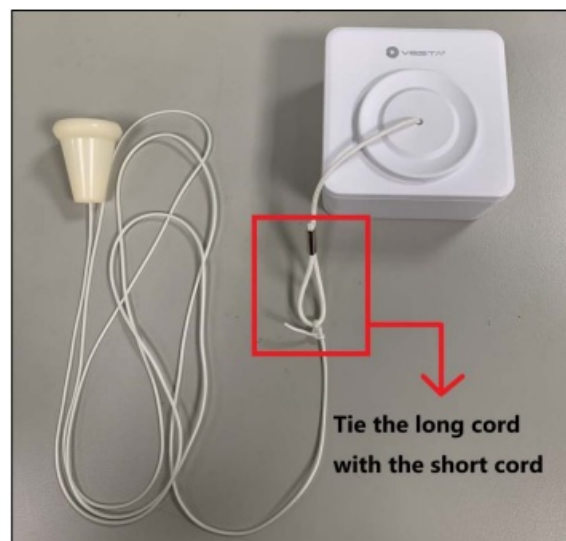
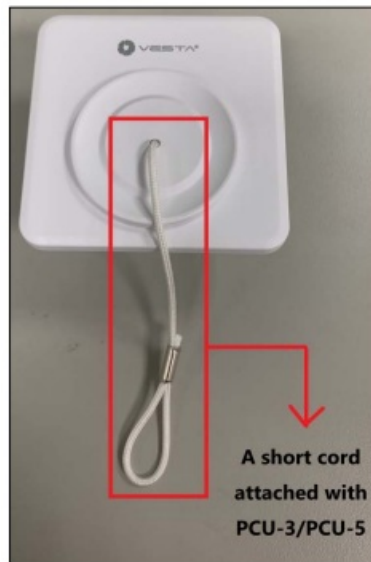

## Mounting Procedures

There are two ways to mount the PCU.

### Screw Mounting:

- **Step 1.** Open the PCU cover as instructed above (steps 1~4) under Battery Installation.
- **Step 2.** Break through the 4 appropriate knockouts on the base (Pic 8.).

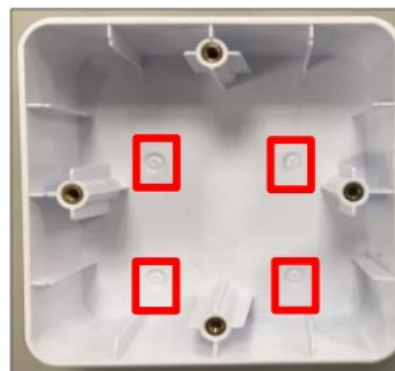

(Pic 8.)

- **Step 3.** Using the mounting holes as a template, drill holes into the surface.
- **Step 4.** Insert the wall plugs if fixing into a plaster or brick

- **Step 5.** Screw the base into the wall plugs using a Philips screwdriver
- **Step 6.** Reassemble the PCU to complete a mounting process (see steps 6~8 above).

### Wall Socket Mounting:

- **Step 1.** Open the PCU cover as instructed above (steps 1~4) under Battery Installation.
- **Step 2.** Insert the stabilizer into the hole (or box) in the wall and tighten the four screws at the corners of the stabilizer using a Phillips screwdriver.
- **Step 3.** Once the stabilizer is well inserted, replace the upper cover and the lid to complete mounting.

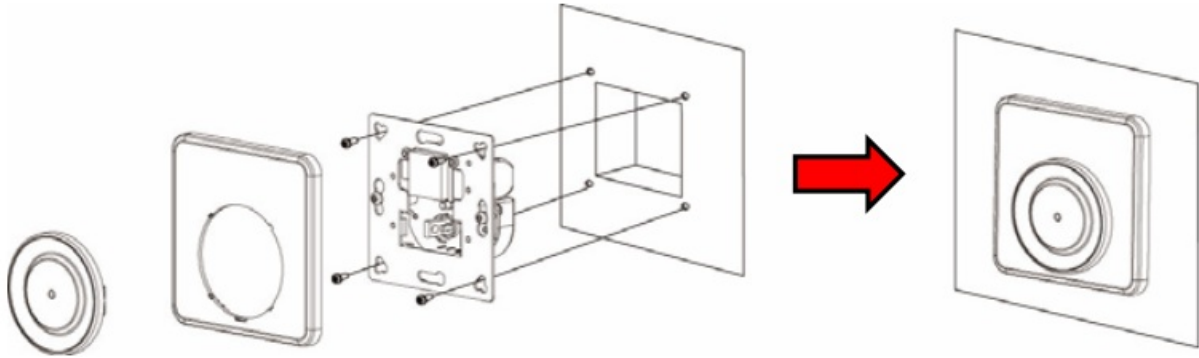

### Federal Communication Commission Interference Statement

This equipment has been tested and found to comply with the limits for a Class B digital device, under Part 15 of the FCC Rules. These limits are designed to provide reasonable protection against harmful interference in a residential installation.

This equipment generates, uses, and can radiate radio frequency energy and, if not installed and used under the instructions, may cause harmful interference to radio communications. However, there is no guarantee that interference will not occur in a particular installation. If this equipment does cause harmful interference to radio or television reception, which can be determined by turning the equipment off and on, the user is encouraged to try to correct the interference by one of the following measures:

- Reorient or relocate the receiving antenna.
- Increase the separation between the equipment and the receiver.
- Connect the equipment to an outlet on a circuit different from that to which the receiver is connected.
- Consult the dealer or an experienced radio/TV technician for help.

**FCC Caution:** To assure continued compliance, any changes or modifications not expressly approved by the party responsible for compliance could void the user's authority to operate this equipment. (Example – use only shielded interface cables when connecting to computer or peripheral devices).

### FCC Radiation Exposure Statement

This equipment complies with FCC RF radiation exposure limits set forth for an uncontrolled environment. This equipment should be installed and operated with a minimum distance of 20 centimeters between the radiator and your body.

This transmitter must not be co-located or operating in conjunction with any other antenna or transmitter.

The antennas used for this transmitter must be installed to provide a separation distance of at least 20 cm from all persons and must not be co-located or operating in conjunction with any other antenna or transmitter.

This device complies with Part 15 of the FCC Rules. Operation is subject to the following two conditions:

1. This device may not cause harmful interference,

2. This device must accept any interference received, including interference that may cause undesired operation.

Documents / Resources

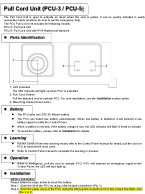
	<a href="#">climax Technology PCU-3 Pull Cord Unit</a> [pdf] Instruction Manual PCU-3, PCU-3 Pull Cord Unit, Pull Cord Unit, Cord Unit, Unit
---	---

References

- [User Manual](#)

[Manuals+](#). [Privacy Policy](#)

This website is an independent publication and is neither affiliated with nor endorsed by any of the trademark owners. The "Bluetooth®" word mark and logos are registered trademarks owned by Bluetooth SIG, Inc. The "Wi-Fi®" word mark and logos are registered trademarks owned by the Wi-Fi Alliance. Any use of these marks on this website does not imply any affiliation with or endorsement.