



ClimaRad V2X Ventilation Unit Instruction Manual

[Home](#) » [climaRAD](#) » ClimaRad V2X Ventilation Unit Instruction Manual 

Contents

- [1 ClimaRad V2X Ventilation Unit](#)
- [2 User Instructions ClimaRad Sensa V2X](#)
- [3 Documents / Resources](#)
- [4 Related Posts](#)

ClimaRad®

ClimaRad V2X Ventilation Unit



Operation of the ClimaRad ventilation unit

The ClimaRad ventilation unit optimises the air quality through ventilation and air filtration. The built-in heat exchanger minimises heat loss. The ClimaRad Sensa V2X is a vertical ventilation-unit with built-in heat exchanger and sensors for CO , relative humidity and inside and outside temperature.

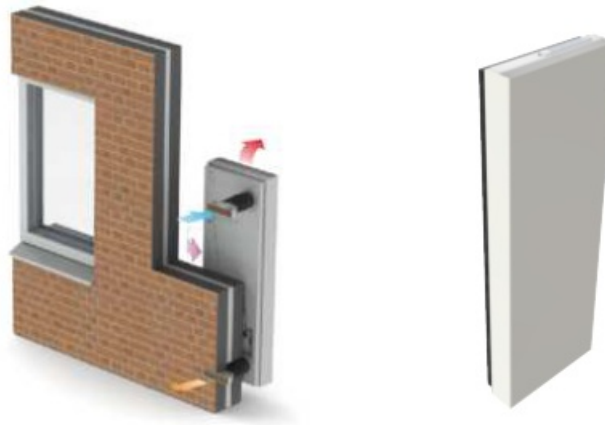

Operating the ClimaRad ventilation unit

The ClimaRad ventilation unit is operated with the control panel on top of the unit.

Control Panel

The installer will have adjusted the settings of the ClimaRad ventilation unit to the room in which it is installed. That is why we only explain the function keys you will need for daily use.

Function Keys



- Automatic control. The ventilation in the room is controlled automatically by your ClimaRad ventilation unit, which will ventilate the room based on CO measurements.
- You can set your desired ventilation speed with the + and – buttons on your control panel. After a period of 4 hours the ClimaRad switches back to automatic control.
- Pause. Use this function when you want to temporarily stop the ventilation. After a period of 4 hours the ClimaRad switches back to automatic control.
- Maximum ventilation. With this 'boost' function, the ClimaRad increases the ventilation to the maximum level. Use this function to remove unpleasant odours, such as smoke or cooking smells. After a period of 4 hours the ClimaRad switches back to automatic control.
- Ventilation with cooler outside air. The ClimaRad ventilates with outside air when the outside temperature is at least 2 degrees colder than the air in the room. After a period of 8 hours the ClimaRad switches back to automatic control. You can set the speed with the + and – buttons. Use this function, for instance, in summer when at night you want to reduce the temperature a few degrees in a warmed-up room.
- Child lock. This key combination locks your control panel. Press the indicated buttons simultaneously for 4 seconds. To override this lock you repeat the action.

Messages

- Child lock. The child lock is activated.
- Error. A fault has occurred. Please contact your installer or housing corporation.
- Dirty filter. Replace the air filters or contact your installer or housing corporation After replacing the filters, press the + and – buttons for 6 seconds.

Documents / Resources

| | |
|-----------------------------------------------------------------------------------|-------------------------------------------------------------------------------------------------------------------------------------|
|  | <p>ClimaRad V2X Ventilation Unit [pdf] Instruction Manual V2X Ventilation Unit, V2X, Ventilation Unit, Unit</p> |
|-----------------------------------------------------------------------------------|-------------------------------------------------------------------------------------------------------------------------------------|

Manuals+.