

# Climaproyectos ConnectLife App User Guide

[Home](#) » [Climaproyectos](#) » Climaproyectos ConnectLife App User Guide 

### Contents

- 1 Climaproyectos ConnectLife App
- 2 Product Information
- 3 Product Usage Instructions
- 4 Quick Start Guide
- 5 FCC Statement
- 6 Documents / Resources



**Climaproyectos ConnectLife App**

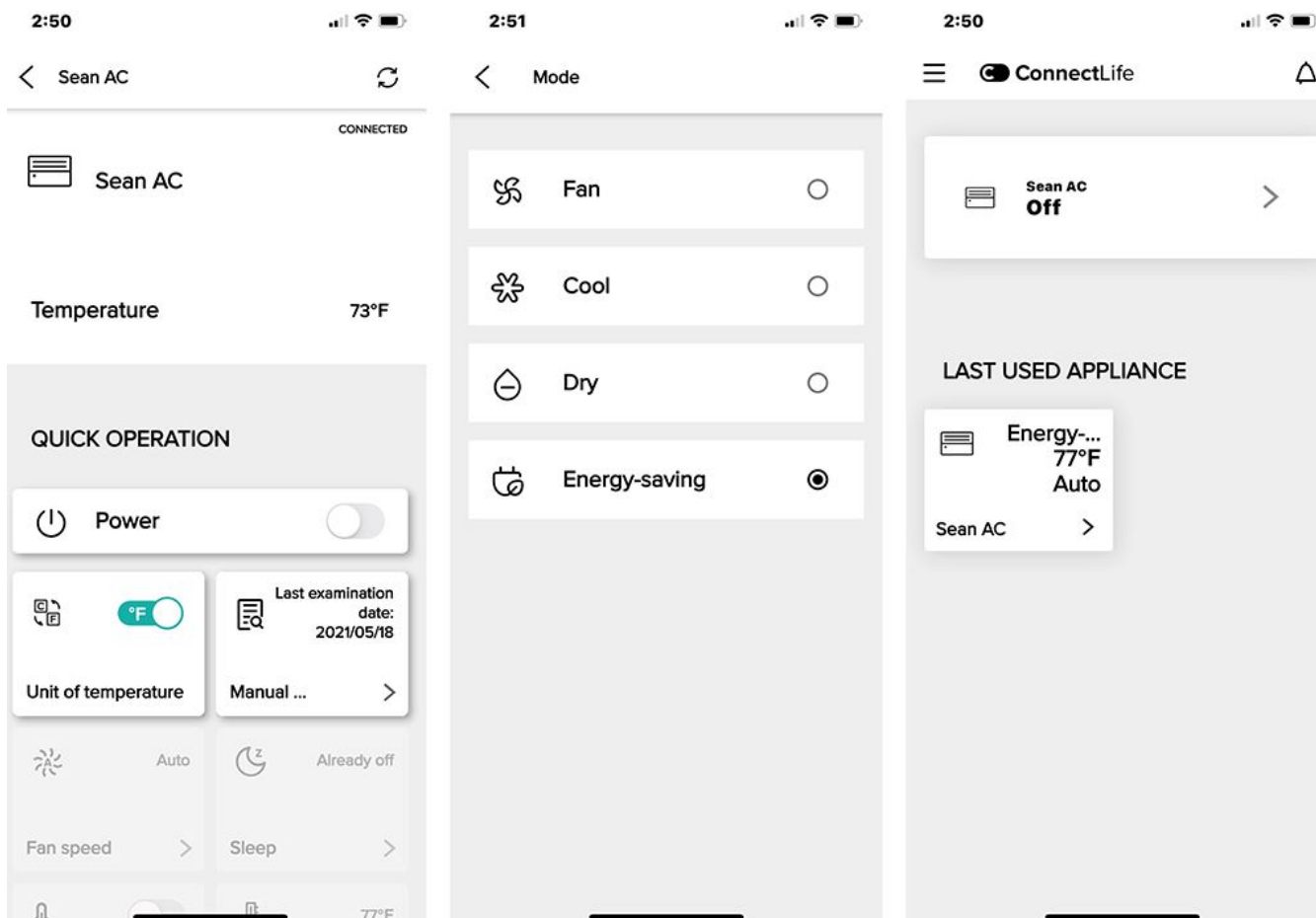

## Product Information

The ConnectLife is a device that can be downloaded as an application (app) on Android and iOS smartphones. It complies with the radiation exposure limits set forth by the FCC and Canada for uncontrolled environments. The device contains a transmitter module with FCC ID: 2AGCCA EH-W0G1/2AGCCA EH-W4G1/2AGCCA EH-W0G2/2AGCCA EH-W4G2 and IC: 20778-AEHW0G1/20778-AEHW4G1/20778-AEHW0G2/20778-AEHW4G2.

## Product Usage Instructions

1. Open the Android Play Store or iOS App Store on your smartphone.
2. In the search bar, type "ConnectLife" to find the latest version of the app.
3. Download and install the app on your smartphone.
4. When using the device, ensure that there is a minimum distance of 20cm between the radiator and your body.
5. The ConnectLife transmitter must not be co-located or operating in conjunction with any other antenna or transmitter.
6. To comply with FCC exterior labeling requirements, ensure that the following text is placed on the exterior of the end product: "Contains Transmitter module FCC ID: 2AGCCA EH-W0G1/2AGCCA EH-W4G1/2AGCCA EH-W0G2/2AGCCA EH-W4G2."
7. To comply with IESD exterior labeling requirements, ensure that the following text is placed on the exterior of the end product:

## Quick Start Guide

**Follow these four easy steps to set up your appliance**

1. Install the appliance and turn it on.
2. Open Android Play Store or IOS App Store on your smartphone, then enter "ConnectLife" in the Search bar to find the latest version. Download and install it.
3. Follow WiFi instructions to pair with your appliance ECTOS
4. Manage and enjoy complete control over your appliance.



QR Code for Android



QR Code for iOS

## FCC Statement

This equipment has been tested and found to comply with the limits for a Class B digital device, pursuant to part 15 of the FCC rules. These limits are designed to provide reasonable protection against harmful interference in a residential installation. This equipment generates, uses, and can radiate radio frequency energy and, if not installed and used in accordance with the instructions may cause harmful interference to radio communications. However, there is no guarantee that interference will not occur in a particular installation.

If this equipment does cause harmful interference to radio or television reception, which can be determined by turning the equipment off and on, the user is encouraged to try to correct the interference by one or more of the following measures:

- Reorient or relocate the receiving antenna.
- Increase the separation between the equipment and the receiver.
- Connect the equipment to an outlet on a circuit different from that to which the receiver is connected.
- Consult the dealer or an experienced radio/TV technician for help.

## Radiation Exposure Statement

This equipment complies with FCC radiation exposure limits set forth for an uncontrolled environment and it also complies with Part 15 of FCC RF Rules.

This equipment should be installed and operated with a minimum distance of 20cm between the radiator & your body. This transmitter must not be co-located or operating in conjunction with any other antenna or transmitter.

### CAUTION:

To comply with the limits of the Class B digital device, pursuant to Part 15 of the FCC Rules, this device is compliant with Class B limits. All peripherals must be shielded and grounded. Operation with non-certified peripherals or non-shielded cables may result in interference to radio or reception.

### MODIFICATION:

To assure continued compliance, Any changes or modifications not expressly approved by the grantee of this device could void the user's authority to operate the device.

### Label Statement

This device complies with part 15 of the FCC Rules. Operation is subject to the following two conditions:

1. This device may not cause harmful interference and
2. This device must accept any interference received including interference that may cause undesired operation.

IC Statement

This device complies with Industry Canada licence-exempt RSS standard(s). Operation is subject to the following two conditions:

- 1. This device may not cause interference, and
- 2. This device must accept any interference, including interference that may cause undesired operation of the device.

Radiation Exposure Statement

This equipment complies with Canada’s radiation exposure limits set forth for uncontrolled environments. This transmitter must not be co-located or operating in conjunction with any other antenna or transmitter.

NOTE:

To satisfy FCC exterior labeling requirements, the following text must be placed on the exterior of the end product. Contains Transmitter module FCC ID: 2AGCCAEH-WOG 1 /2AGCCAEH-W4G1/2AGCCAEH-WOG2/2AGCCAEH-W4 G2” To satisfy ESD exterior labeling requirements, the following text must be placed on the exterior of the end product.  
Transmitter module IC: 20778-AEHW0G1/20778-AEHW4G1 /20778-AEHW0G2/20778-AEHW4G2”.100

Documents / Resources

**Quick Start Guide**



Follow these four easy steps to set up your appliance

1. Install the appliance and turn it on.

2. Open Android/Play Store or iOS App Store to your smart phone, download ConnectLife® mobile application to mobile device, download and install.

3. Follow WiFi instructions to pair with your appliance.

4. Manage and enjoy complete control over your appliance.



QR Code for Android      QR Code for iOS

[Climaproyectos ConnectLife App](#) [pdf] User Guide  
AEHW0G1, AEHW4G1, AEHW0G2, AEHW4G2, ConnectLife, ConnectLife App, App