



cleverio 52219 Mini Remote Socket Kit User Guide

[Home](#) » [Cleverio](#) » cleverio 52219 Mini Remote Socket Kit User Guide 

cleverio

Mini Remote
Socket Kit
IP141
User guide
Item: 52219



Contents

- [1 Use](#)
- [2 Troubleshooting](#)
- [3 Safety information](#)
- [4 Specifications](#)
- [5 Documents / Resources](#)
 - [5.1 References](#)

Use

Remote control

Before using the remote control for the first time, open the battery compartment on the underside of the remote control and remove the plastic separating the battery from the battery compartment. Close the battery compartment.

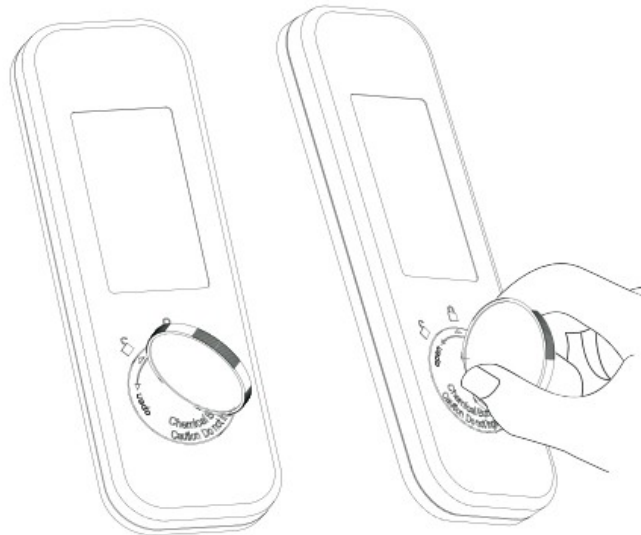

To replace a depleted battery, open the battery compartment and insert 1x CR2032 battery, mind the polarity.

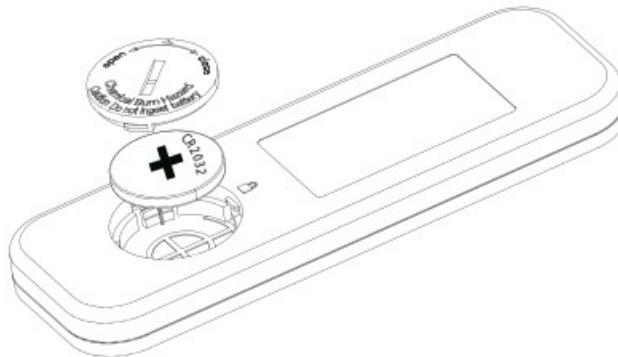

Note! It's important that the new battery does not touch the top of the battery compartment during installation as this can short circuit the remote control.

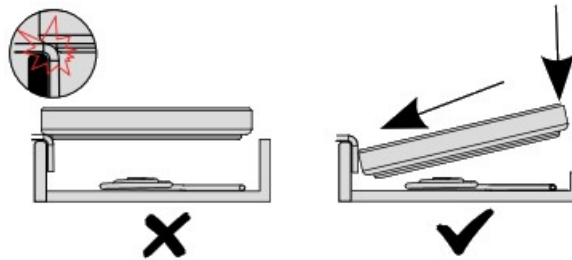

Pairing

1. Connect a plug to a wall socket.
2. Press and hold the button on the plug and release after 3 seconds to activate pairing mode. The indicator star flashing slowly.

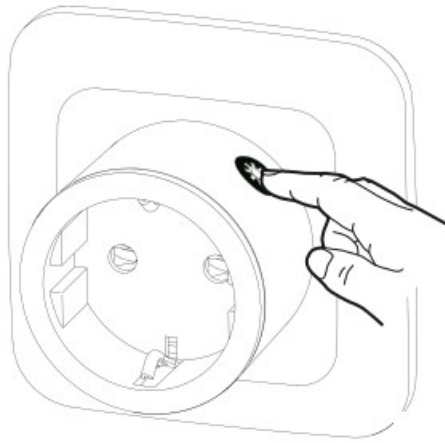

Note! If the indicator light starts flashing rapidly when you attempt to activate pairing mode, the button was held down for longer than 6 seconds and the receiver has entered reset mode (see “Resetting”). Make sure to release the button after 3 seconds.

3. Select a channel you want to use on the remote control (A, B, C or D) and press the On button in that row within 30 seconds to pair the plug with the remote. The indicator light on the remote control lights up and the plug indicator light changes to a solid light when the pairing is successful.

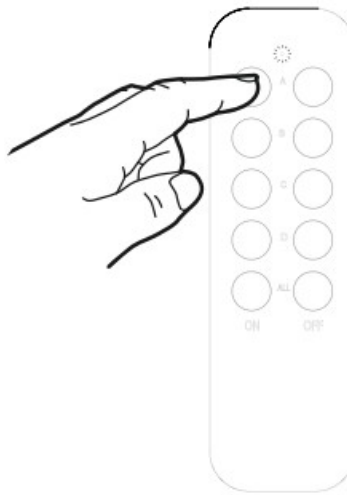

Repeat the steps for each plug you want to control. You can pair multiple plugs to the same channel. For example, to control all plugs in the living room using On/off on channel “A”.

Note! A plug can be paired to multiple control groups and remote controls, as each plug supports up to 8 memory slots. If another control group or remote control is paired after this, the earliest paired group is automatically disconnected. A remote control can control up to 50 plugs total over all control groups.

Controlling a plug

Press the On and Off button for the channel on the remote control to turn the paired plug on and off. The indicator on the remote control lights up and lingers for a moment when you send a command. Wait for the indicator on the remote control to turn off before pressing another button. The indicator on the plug lights up red when the plug is on. You can control all the plugs at the same time using the “All On/off” buttons.

To remove a paired plug from a channel, press and hold the button on the plug and release after 3 seconds, the indicator starts flashing slowly. Press the Off button in the channel row on the remote control to remove the pairing. The indicator on the plug flashes rapidly to confirm.

Pair with smart home controller (sold separately):

Search for nearby devices in the smart home controller interface within 30 seconds or initiating pairing for a plug. Add the remote socket when it is found in the controller. The indicator on the remote socket turns solid red to indicate that pairing was successful to your controller.

Resetting

Press and hold the button on the plug for 6 seconds until the LED indicator starts flashing rapidly to disconnect the socket from all paired remotes and smart home controllers. Remove the connection to the remote socket in the smart home-controller interface.

Troubleshooting

I'm having trouble pairing a plug to the remote control.

Make sure the remote control has enough battery power by pressing one of the buttons, the LED indicator on the remote should light up.

If the LED indicator on the plug is flashing rapidly, you have kept the button pressed for too long and the plug has instead been reset. Make sure you keep the button pressed for 3–6 seconds during pairing, as longer than 6 seconds will reset the plug.

Safety information

Caution! There is a difference between products using resistive load and inductive load which affects the maximum connected load this product can handle.

Examples of products that are resistive load are coffeemakers, lighting products.

Max resistive load: 10 A (2300 W).

Examples of products using inductive loads are washing machines, construction fans and any type of motors. Max inductive load: 2.5 A (575 W).

Exceeding these limits will cause the plug to stop working.

Only for use in wall sockets, do not connect to an extension cord.

Not suited for equipment that requires constant supervision, such as a clothes iron.

Only for use in temperatures from 0-35 °C. Not for outdoor use.

Do not open or modify the devices in any way, this should only be carried out by a qualified technician due to the risk of electric shocks or short circuit.

The range of 25 meters can vary due to concrete walls, electrical or electro-magnetic sources that can interfere with the signal.

Keep the remote control battery away and out of reach from children. A swallowed battery can result in severe injuries and a deadly outcome. Immediately consult a doctor if you suspect that a battery has been swallowed or entered the body in any other way.

Do not stack wireless remote sockets on each other or use two receivers in proximity.

Disconnect the sockets completely to assure there is no voltage output.

Only for use in dry areas.

Simplified EU Declaration of Conformity

Kjell & Company hereby declares that this device is in compliance with the essential requirements and other relevant provisions of Directive 2014/53/EU.

Full text of the EU declaration of conformity is available at www.kjell.com/52219

Specifications

Frequency:	433.92 MHz
Range:	Up to 25 meters
Max. load:	2300 W
Battery, remote control:	1x CR2032 (included)
Memory slots:	8 per plug, 50 per remote control
Wireless frequency:	433.050–434.790 MHz
Effective Radiated Power:	<20 mW

Documents / Resources

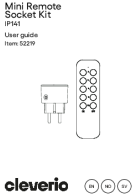
	<p>cleverio 52219 Mini Remote Socket Kit [pdf] User Guide</p> <p>52219 Mini Remote Socket Kit, 52219, Mini Remote Socket Kit, Remote Socket Kit, Socket Kit, Kit</p>
---	--

References

-  [Cleverio | Kjell.com](#)
-  [Cleverio Mini-fjärrströmbrytare med fjärrkontroll 4-pack - Startpaket | Kjell.com](#)
- [User Manual](#)

[Manuals+](#), [Privacy Policy](#)

This website is an independent publication and is neither affiliated with nor endorsed by any of the trademark owners. The "Bluetooth®" word mark and logos are registered trademarks owned by Bluetooth SIG, Inc. The "Wi-Fi®" word mark and logos are registered trademarks owned by the Wi-Fi Alliance. Any use of these marks on this website does not imply any affiliation with or endorsement.